

Historic East Isthmus Employment: 1900 - 1920 Factory District

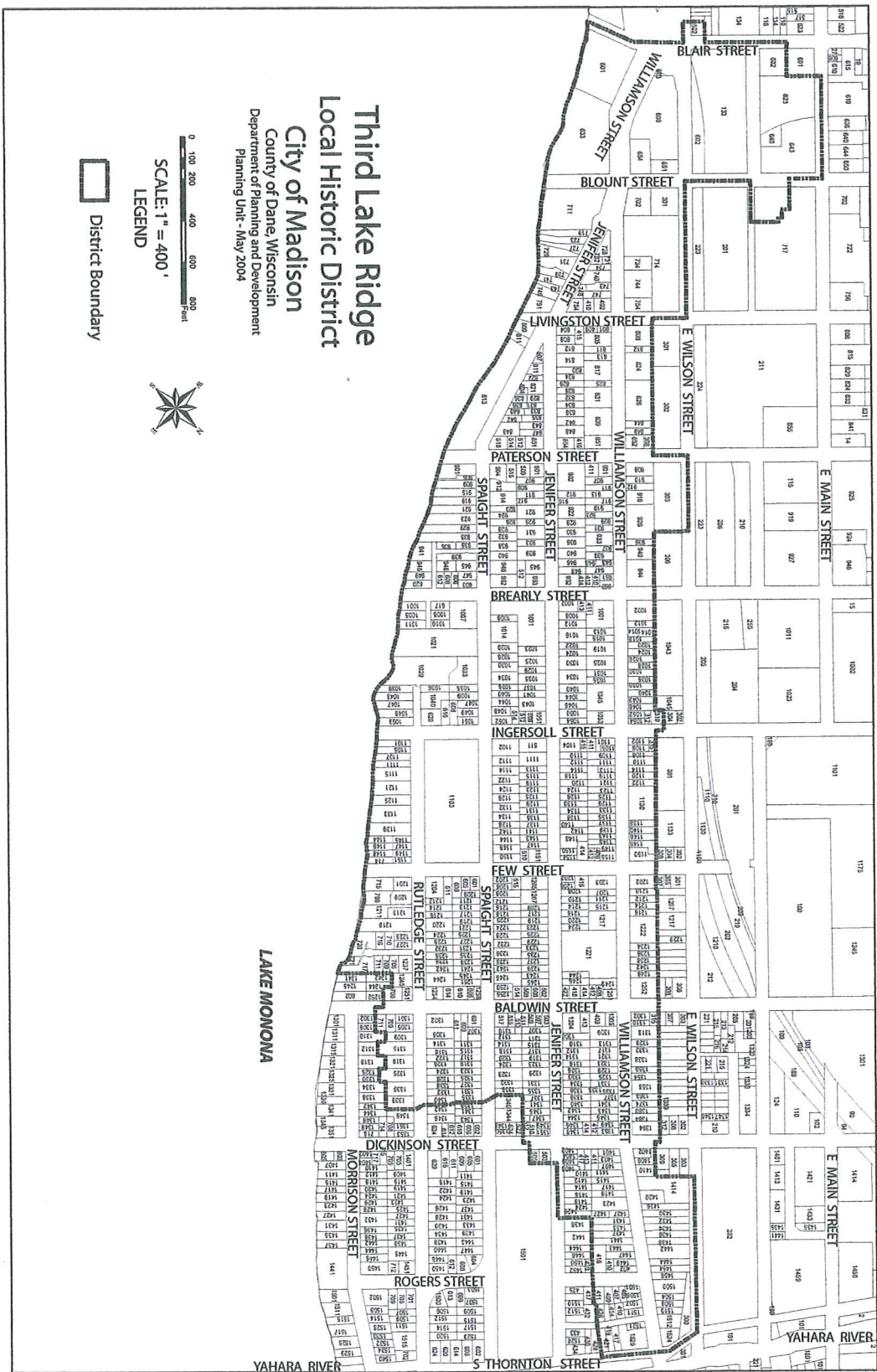

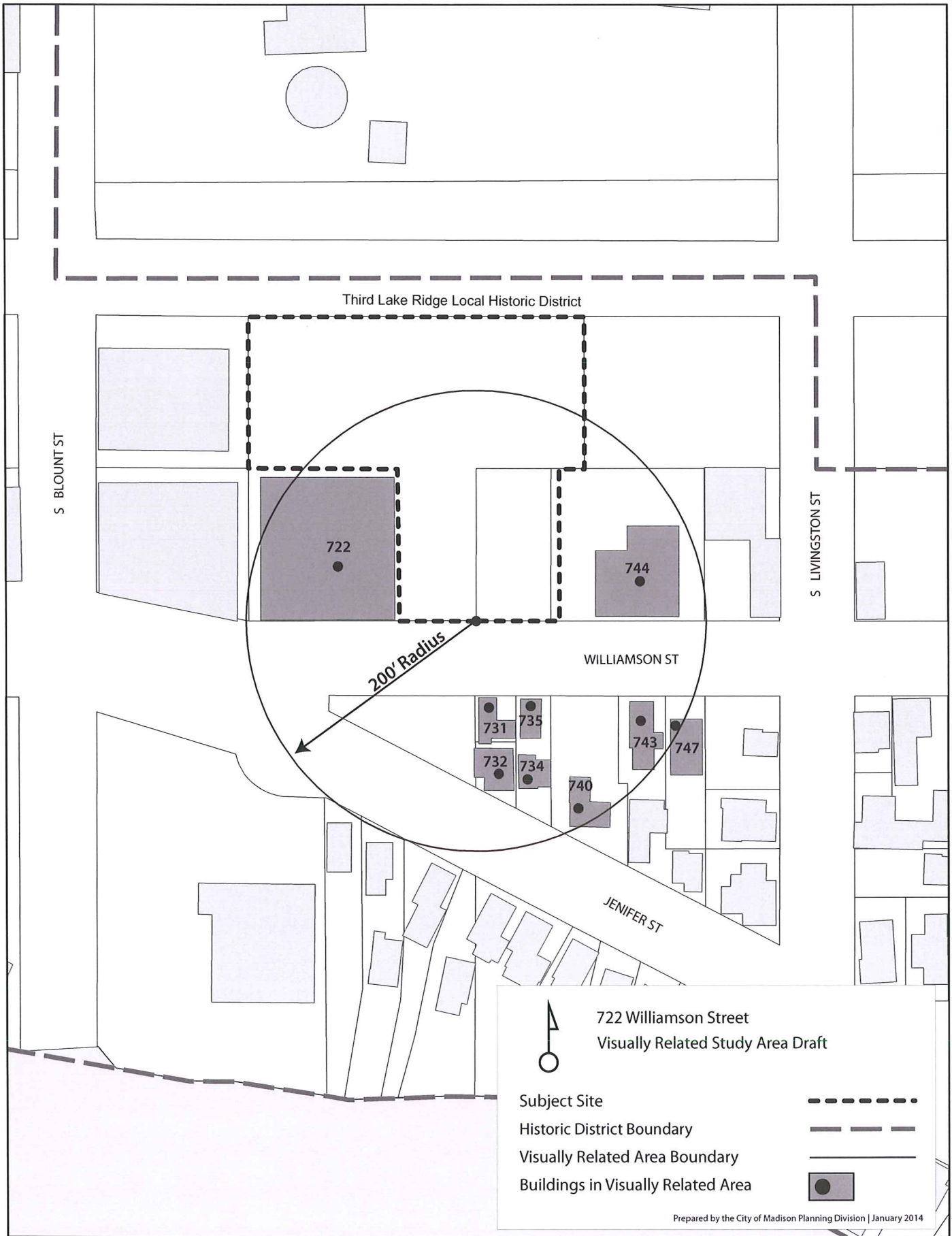

B



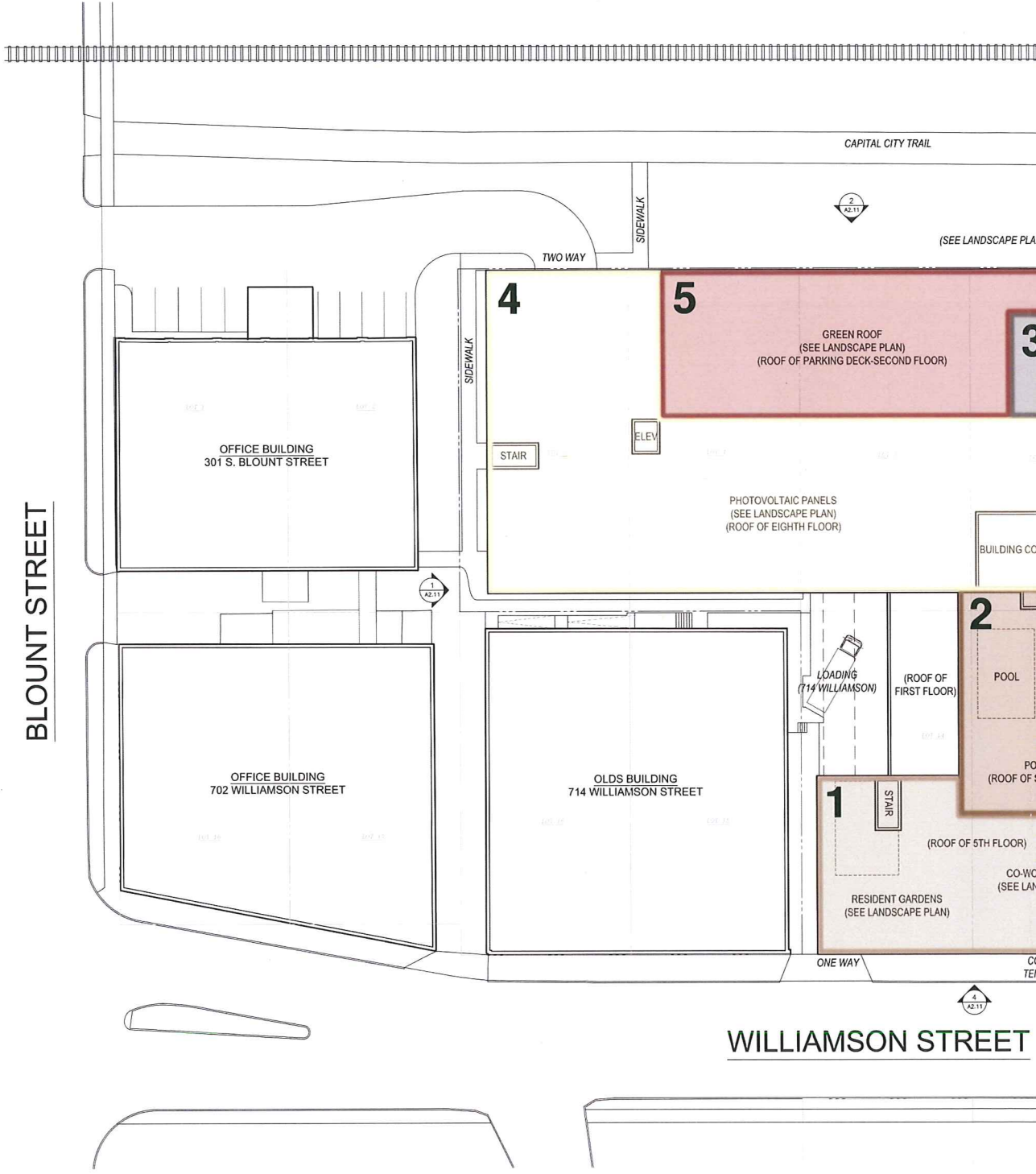

BLOUNT STREET

WILLIAMSON STREET

OFFICE BUILDING  
301 S. BLOUNT STREET

OFFICE BUILDING  
702 WILLIAMSON STREET

OLDS BUILDING  
714 WILLIAMSON STREET

GREEN ROOF  
(SEE LANDSCAPE PLAN)  
(ROOF OF PARKING DECK-SECOND FLOOR)

PHOTOVOLTAIC PANELS  
(SEE LANDSCAPE PLAN)  
(ROOF OF EIGHTH FLOOR)

POOL  
(ROOF OF FIRST FLOOR)

RESIDENT GARDENS  
(SEE LANDSCAPE PLAN)

CO-WO  
(SEE LAN

4

5

3

2

1

2  
A2.11

1  
A2.11

4  
A2.11

TWO WAY

SIDEWALK

SIDEWALK

CAPITAL CITY TRAIL

(SEE LANDSCAPE PLAN)

STAIR

ELEV.

LOADING  
(714 WILLIAMSON)

STAIR

ONE WAY

CO  
TER



**4** SOUTHEAST ELEVATION



**2** NORTHWEST ELEVATION





PERSPECTIVE VIEW ON WILLIAMSON STREET



PERSPECTIVE VIEW ON WILLIAMSON STREET

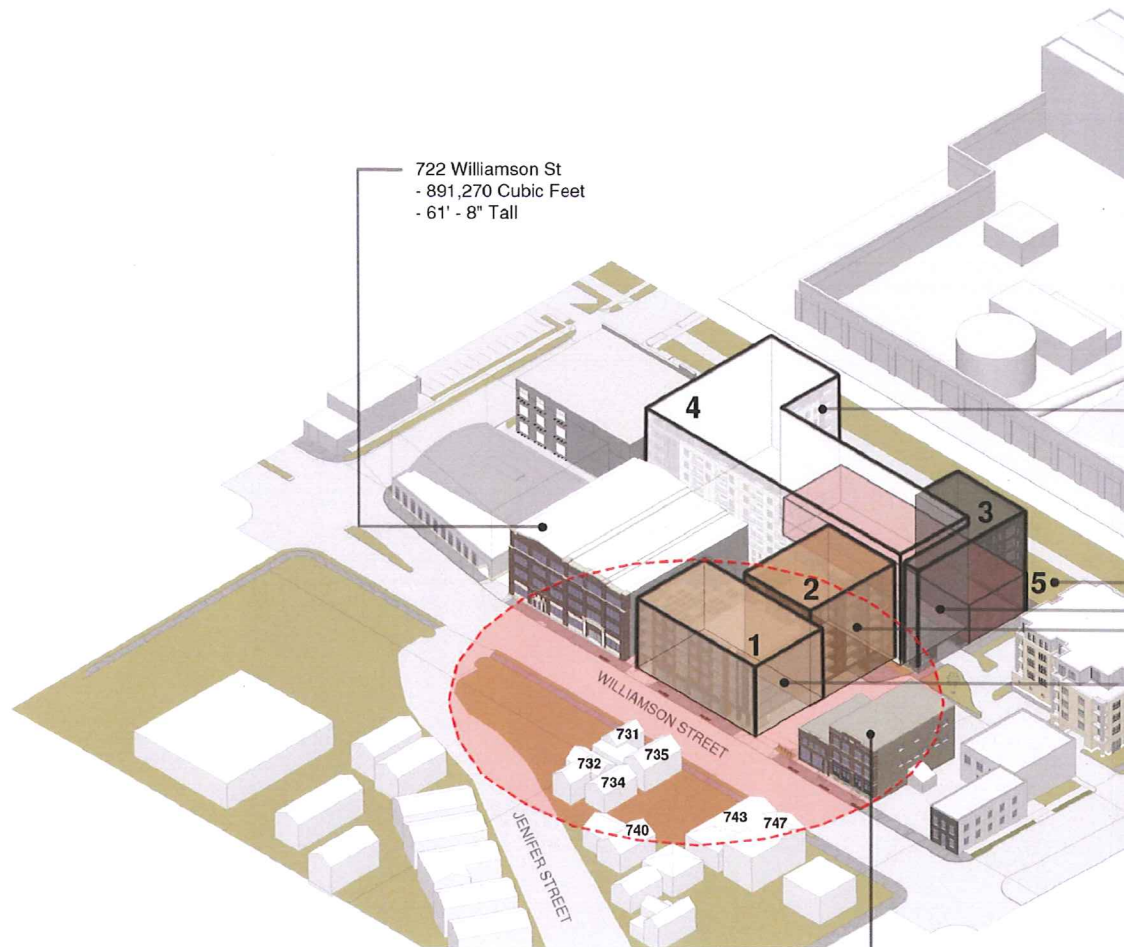

722 Williamson St  
 - 891,270 Cubic Feet  
 - 61' - 8" Tall

731 Williamson St - 19,645 Cubic Feet - 25' - 0" Tall  
 732 Jenifer St - 25,990 Cubic Feet - 28' - 0" Tall  
 734 Jenifer St - 19,710 Cubic Feet - 26' - 0" Tall  
 735 Williamson St - 24,060 Cubic Feet - 29' - 0" Tall  
 740 Jenifer St - 28,950 Cubic Feet - 25' - 0" Tall  
 743 Williamson St - 48,070 Cubic Feet - 24' - 0" Tall  
 747 Williamson St - 50,670 Cubic Feet - 36' - 0" Tall

744 Williamson St  
 - 216,225 Cubic Feet  
 - 47' - 0" Tall