

Yahara Place Park--Bulkhead Locations



CITY OF MADISON – PROPOSED PROJECT YAHARA PLACE PARK STEEL BULKHEAD REMOVAL



Yahara Place Park-Current Shoreline



Yahara Place Park-Location



Bulkhead Condition



- Metal is sound
- Displaced caps
- Sharp edges exposed
- Unclear purpose
 - Weed dumping location?
 - Boat landing?
 - Easy water access?

9/9/14

Bulkhead Condition-Cap Off



Bulkhead Removal, Shore Stabilization and Canoe/Kayak Access in Yahara Place Park



Other Similar Projects:

Riprap on the Yahara River



Other Similar Projects:

Limestone Steps on the Yahara River

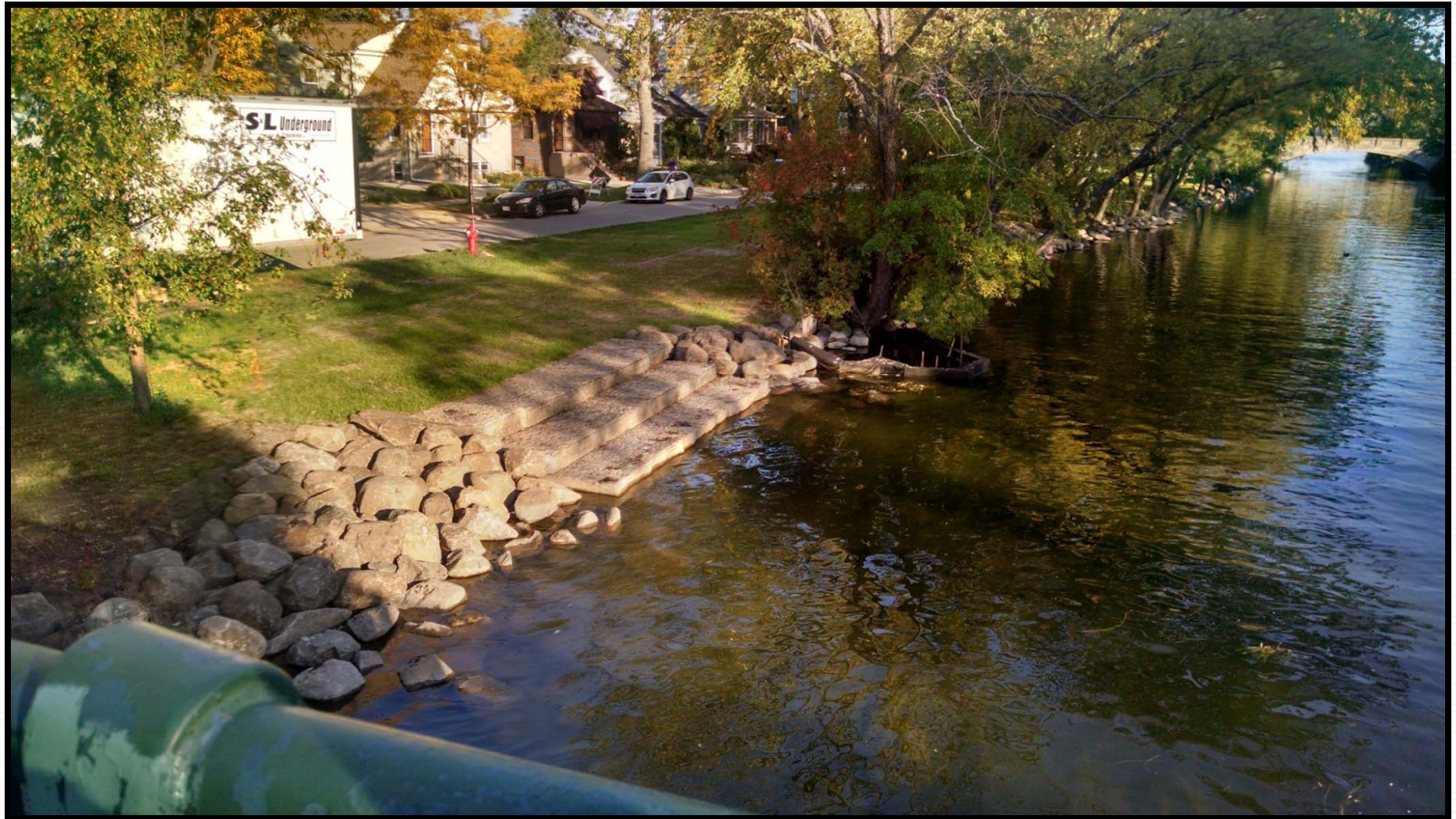

Rock Riprap Rendering To Scale

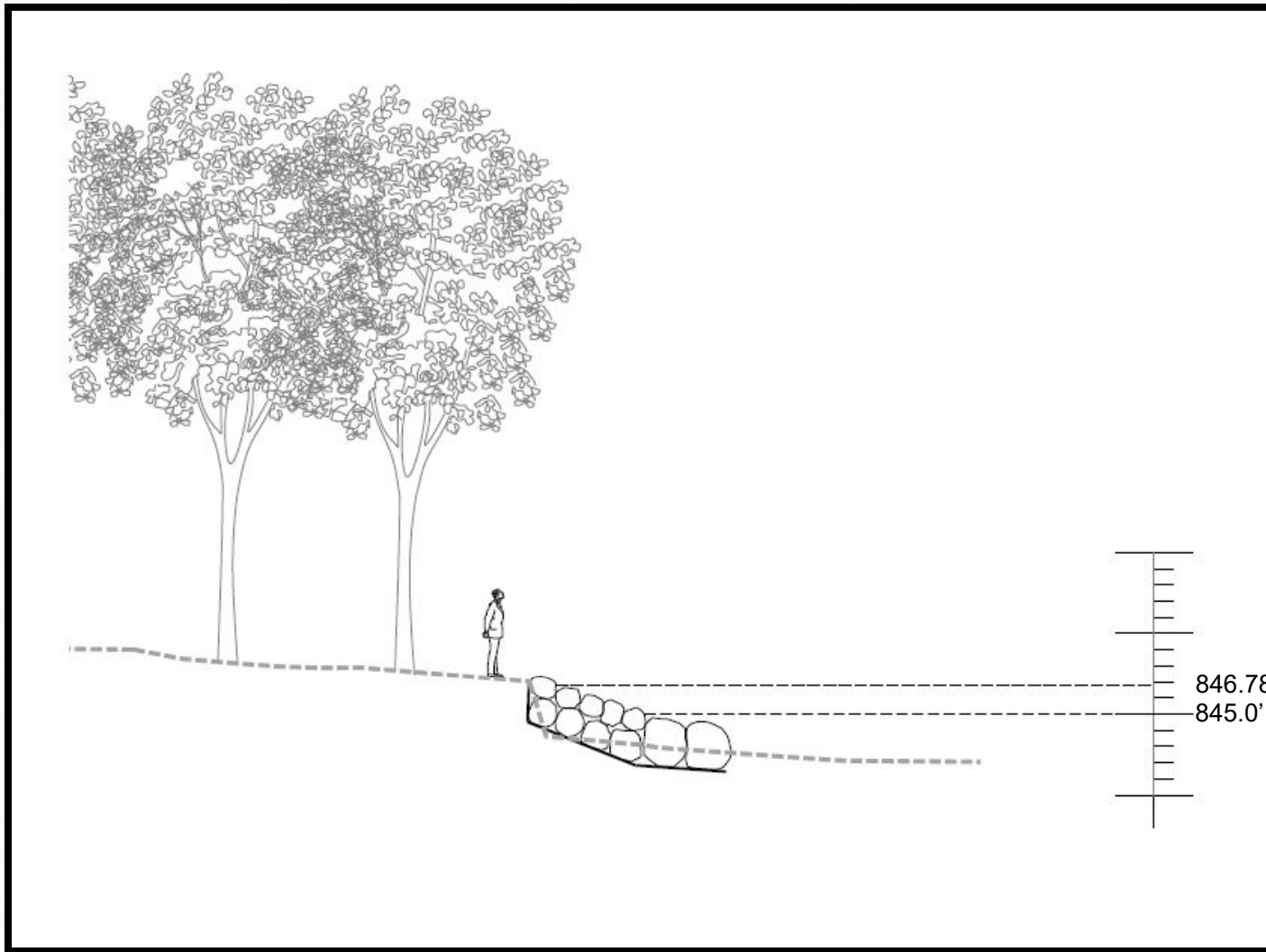

846.78'
845.0'

Storm Wave Height
Monona Target Summer Max

Multi-Use Lake Access

Types of Use:

- Swim
- Animal access
- Canoe/Kayaks/SUP
- Picnic/Sitting Area
- Wade
- Fish
- View Water
(kids/elderly/disabled)
- Bird Watch



Walton Place Bulkhead-Riprap Replacement

YAHARA PLACE PARK SHORELINE REPAIR	SHEET NO. 2
DNR PERMIT SUBMITTAL	
WALTON PLACE	CITY OF MADISON

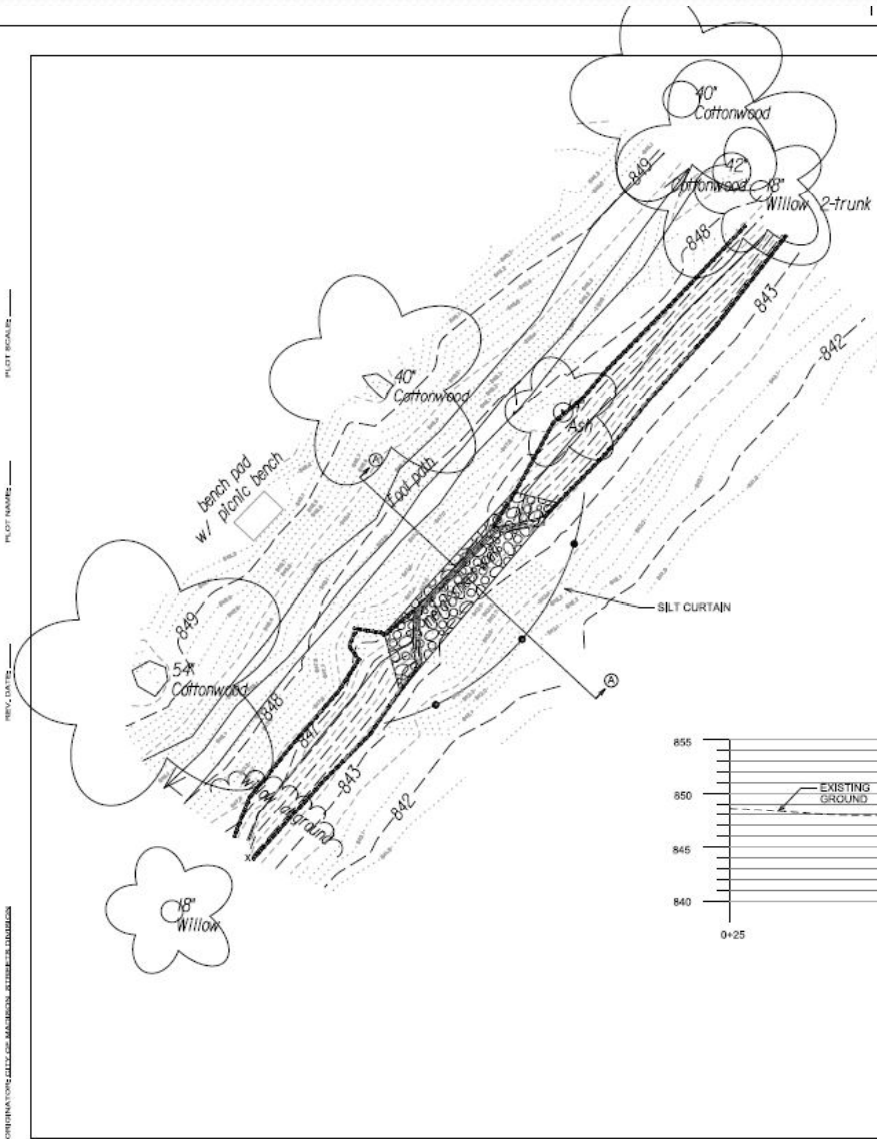

EROSION CONTROL NOTES:

- 1) PRIOR TO BEGINNING ANY EARTHWORK, THE CONTRACTOR SHALL INSTALL SILT CURTAIN PER WI DNR CONSERVATION PRACTICE STANDARD 1070.
- 2) ALL DISTURBED AREAS SHALL BE TOPSOILED, SEEDED WITH TERRACE SEED MIX, AND STABILIZED WITH EROSION CONTROL MATTING, CLASS I, URBAN TYPE A.
- 3) SILT FENCE OR SILT SOCK SHALL BE INSTALLED AS DIRECTED AND THAT THE DISCRETION OF THE CONSTRUCTION ENGINEER.
- 4) TEMPORARY POLYMER STABILIZATION SHALL BE PLACED AS DIRECTED BY THE CONSTRUCTION ENGINEER.
- 5) SILT FENCE SHALL BE PLACED DOWNSTREAM OF ALL STOCKPILE AREAS
- 6) THE PROJECT SITE SHALL BE INSPECTED WITHIN 24 HOURS OF A RAINFALL EXCEEDING 0.5" AND WEEKLY.

SECTION A-A: WALTON PLACE SHEET PILING

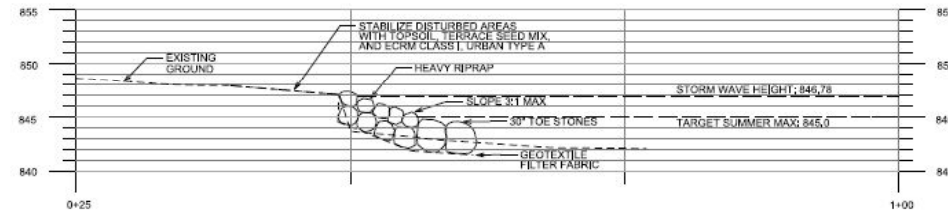

Russell Street Bulkhead-Lake Access Replacement

YAHARA PLACE PARK SHORELINE REPAIR	SHEET NO. 3
DNR PERMIT SUBMITTAL	
RUSSELL STREET	CITY OF MADISON

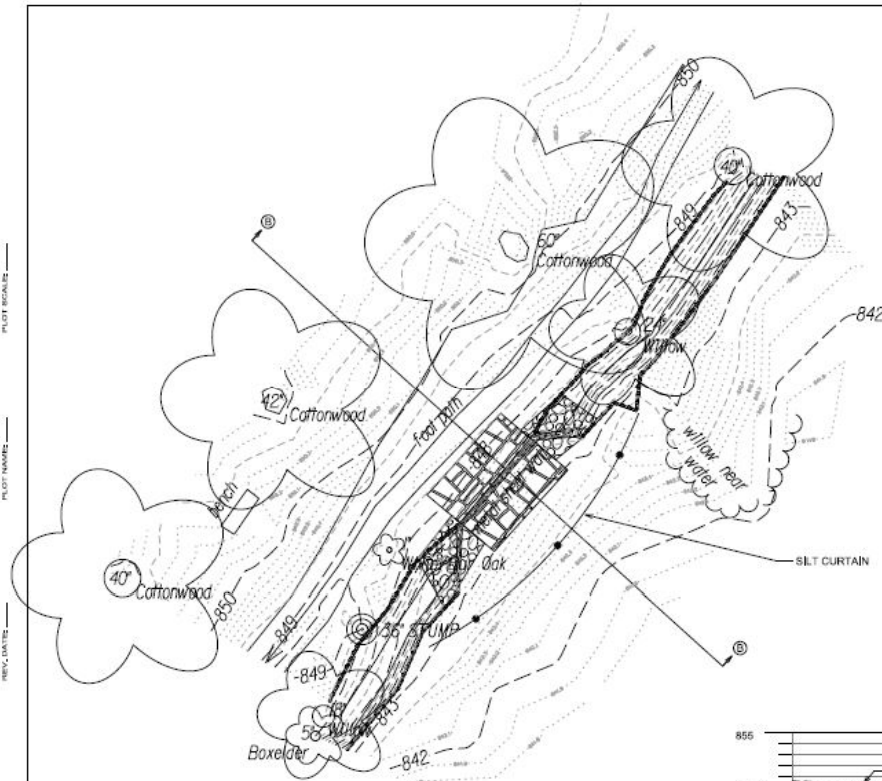

EROSION CONTROL NOTES:

- 1) PRIOR TO BEGINNING ANY EARTHWORK, THE CONTRACTOR SHALL INSTALL SILT CURTAIN PER WI DNR CONSERVATION PRACTICE STANDARD 1070.
- 2) ALL DISTURBED AREAS SHALL BE TOPSOILED, SEEDED WITH TERRACE SEED MIX, AND STABILIZED WITH EROSION CONTROL MATTING, CLASS I, URBAN TYPE A.
- 3) SILT FENCE OR SILT SOCK SHALL BE INSTALLED AS DIRECTED AND THAT THE DISCRETION OF THE CONSTRUCTION ENGINEER.
- 4) TEMPORARY POLYMER STABILIZATION SHALL BE PLACED AS DIRECTED BY THE CONSTRUCTION ENGINEER.
- 5) SILT FENCE SHALL BE PLACED DOWNSTREAM OF ALL STOCKPILE AREAS
- 6) THE PROJECT SITE SHALL BE INSPECTED WITHIN 24 HOURS OF A RAINFALL EXCEEDING 0.5" AND WEEKLY.

SECTION B-B: RUSSELL STREET SHEET PILING

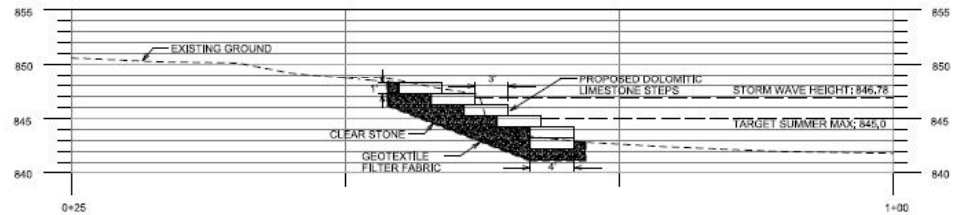

PLOT SIGNALS

PLOT NAMES

REV. DATE

COORDINATES: UTM, NAD 83, STATE PLANE, ILLINOIS

Schurz Ave Bulkhead-Lake Access Replacement

YAHARA PLACE PARK SHORELINE REPAIR	SHEET NO. 4
DNR PERMIT SUBMITTAL	
SCHURZ AVENUE	CITY OF MADISON

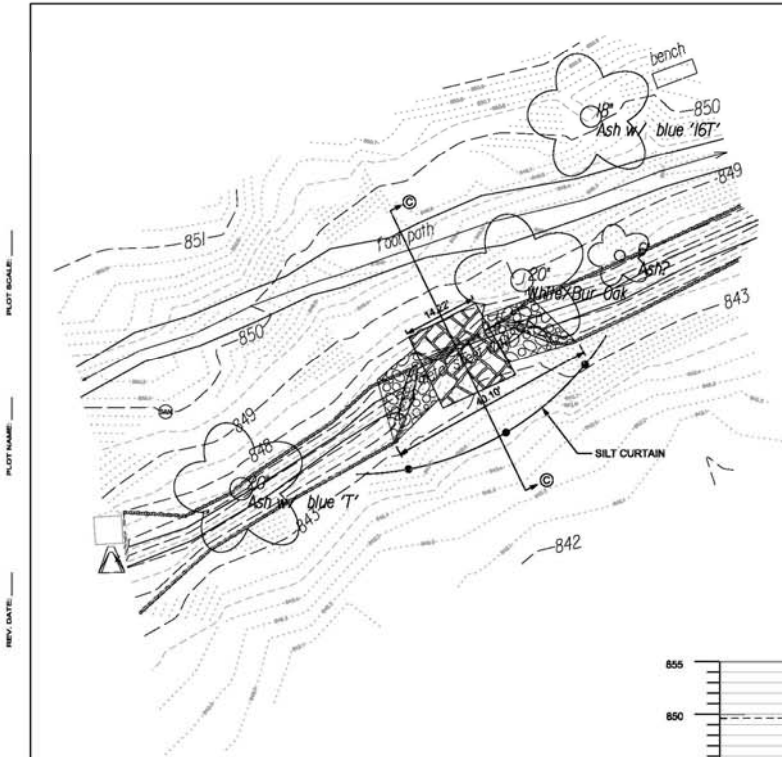

EROSION CONTROL NOTES:

- 1) PRIOR TO BEGINNING ANY EARTHWORK, THE CONTRACTOR SHALL INSTALL SILT CURTAIN PER WI DNR CONSERVATION PRACTICE STANDARD 1070.
- 2) ALL DISTURBED AREAS SHALL BE TOPSOILED, SEEDED WITH TERRACE SEED MIX, AND STABILIZED WITH EROSION CONTROL MATTING, CLASS I, URBAN TYPE A.
- 3) SILT FENCE OR SILT SOCK SHALL BE INSTALLED AS DIRECTED AND THAT THE DISCRETION OF THE CONSTRUCTION ENGINEER.
- 4) TEMPORARY POLYMER STABILIZATION SHALL BE PLACED AS DIRECTED BY THE CONSTRUCTION ENGINEER.
- 5) SILT FENCE SHALL BE PLACED DOWNSTREAM OF ALL STOCKPILE AREAS
- 6) THE PROJECT SITE SHALL BE INSPECTED WITHIN 24 HOURS OF A RAINFALL EXCEEDING 0.5" AND WEEKLY.

SECTION C-C: SCHURZ AVENUE SHEET PILING

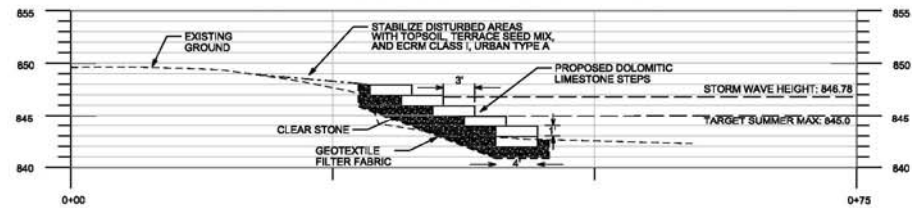

ORIGINATOR: CITY OF MADISON, STREET&S DESIGN

Floodway Information

- Larger structures are needed to prevent erosion. Between 2000 and today, Lake Monona has fluctuated between 842.49' and 848.93' ($\Delta 6.44$), not including storm wave height

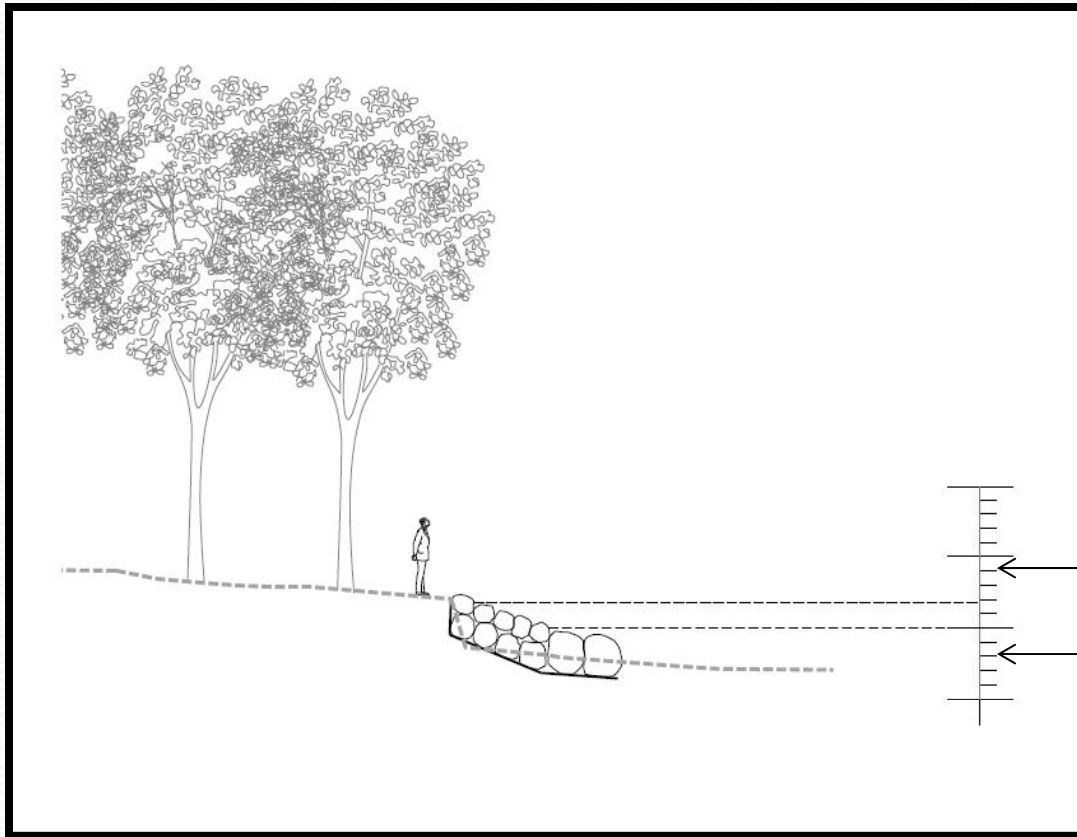

Lake Access Design Considerations

- Equitable, sustainable opportunity for water access for multiple purposes
- Signature design that provides opportunities to interact with the shoreline as well as:
 - Reduce maintenance and capitol costs
 - Provide shoreline protection from wave and ice damage
 - Can be permitted through the Wisconsin DNR and Army Corp of Engineers permitting process
 - Aesthetic integration into the shoreline
 - Reflective of the historical landscape (photos in next slides)
 - Stone looks natural, fits seamlessly into shoreline, and used to reflect the historical contextual design

Historical Design Inspiration



View across lawn and Yahara River towards the Hausmann Brewing Company's Malt House, circa 1850s-1985 [1].



QUESTIONS?

Contact Information:

Jojo O'Brien

266-9721

JO'Brien@cityofmadison.com

Citations

- [1] Wisconsin Historical Society, Unknown, The Malt House and Yahara River Bridge, 118109. Viewed online at <http://www.wisconsinhistory.org/Content.aspx?dsNav=Ny:True,Ro:0,N:4294963828-4294955414&dsNavOnly=Ntk:All%7cyahara%7c3%7c,Ny:True,Ro:0&dsRecordDetails=R:IM118109>.
- [2] Wisconsin Historical Society, Alphonse Joseph Motelet, Boating on Yahara River, 114790. Viewed online at <http://www.wisconsinhistory.org/Content.aspx?dsNav=Ny:True,Ro:20,N:4294963828-4294955414&dsNavOnly=Ntk:All%7cyahara%7c3%7c,Ny:True,Ro:0&dsRecordDetails=R:IM114790>.
- [3] Wisconsin Historical Society, Unknown, Yahara River Spillway at Lake Mendota, 121002. Viewed online at <http://www.wisconsinhistory.org/Content.aspx?dsNav=Ny:True,Ro:20,N:4294963828-4294955414&dsNavOnly=Ntk:All%7cyahara%7c3%7c,Ny:True,Ro:0&dsRecordDetails=R:IM121002>.