

ORIGINAL ALCOHOL BEVERAGE LICENSE APPLICATION

Submit to municipal clerk.

For the license period beginning MAY 7 20 08 ;
 ending MAY 31 20 08

TO THE GOVERNING BODY of the: Town of } Madison
 Village of }
 City of }

County of Dane Aldermanic Dist. No. _____ (if required by ordinance)

1. The named INDIVIDUAL PARTNERSHIP LIMITED LIABILITY COMPANY
 CORPORATION/NONPROFIT ORGANIZATION

hereby makes application for the alcohol beverage license(s) checked above.

- 2 Name (individual/partners give last name first middle; corporations/limited liability companies give registered name) THE FREQUENCY, LLC

Applicant's Wisconsin Seller's Permit Number: <u>456-1026419358-02</u>	
Federal Employer Identification Number (FEIN): <u>30-0165602</u>	
LICENSE REQUESTED	
TYPE	FEE
<input type="checkbox"/> Class A beer	\$
<input checked="" type="checkbox"/> Class B beer	\$
<input type="checkbox"/> Wholesale beer	\$
<input type="checkbox"/> Class C wine	\$
<input type="checkbox"/> Class A liquor	\$
<input checked="" type="checkbox"/> Class B liquor	\$
<input type="checkbox"/> Reserve Class B liquor	\$
Publication fee	\$
TOTAL FEE	\$

An "Auxiliary Questionnaire," Form AT-103, must be completed and attached to this application by each individual applicant, by each member of a partnership, and by each officer, director and agent of a corporation or nonprofit organization, and by each member/manager and agent of a limited liability company. List the name, title, and place of residence of each person

Title	Name	Home Address	Post Office & Zip Code
President/Member	<u>SOLE STOCKHOLDER DARWIN R. SAMPSON</u>	<u>3382 E WASHINGTON, AVE</u>	<u>53704</u>
Vice President/Member	<u>NONE</u>		
Secretary/Member	<u>NONE</u>		
Treasurer/Member	<u>NONE</u>		
Agent	<u>DARWIN R. SAMPSON</u>		
Directors/Managers	<u>DARWIN R. SAMPSON</u>		

- 3 Trade Name THE FREQUENCY Business Phone Number 608 443-9126
 4 Address of Premises 121 W. MAIN ST. MADISON Post Office & Zip Code 53703

- 5 Is individual, partners or agent of corporation/limited liability company subject to completion of the responsible beverage server training course for this license period? Yes No
 6 Is the applicant an employe or agent of, or acting on behalf of anyone except the named applicant? Yes No
 7 Does any other alcohol beverage retail licensee or wholesale permittee have any interest in or control of this business? Yes No
 8 (a) Corporate/limited liability company applicants only: Insert state WI and date 4/10/08 of registration.
 (b) Is applicant corporation/limited liability company a subsidiary of any other corporation or limited liability company? Yes No
 (c) Does the corporation, or any officer director, stockholder or agent or limited liability company, or any member/manager or agent hold any interest in any other alcohol beverage license or permit in Wisconsin? Yes No

(NOTE: All applicants explain fully on reverse side of this form every YES answer in sections 5, 6, 7 and 8 above)

- 9 Premises description: Describe building or buildings where alcohol beverages are to be sold and stored. The applicant must include all rooms including living quarters, if used, for the sales, service, and/or storage of alcohol beverages and records. (Alcohol beverages may be sold and stored only on the premises described) 1ST FLOOR 121 W. MAIN - BAR SETUP MANY YEARS LIQUOR/BEER STORED + A LOCKED IN BASEMENT

- 10 Legal description (omit if street address is given above): _____
 11 (a) Was this premises licensed for the sale of liquor or beer during the past license year? Yes No
 (b) If yes, under what name was license issued? RITA ADAIR. ADAIR LOUNGE
 12 Does the applicant understand they must file a Special Occupational Tax return (TTB form 5630 5) before beginning business? [phone 1-800-937-8864] Yes No
 13 Does the applicant understand a Wisconsin Seller's Permit must be applied for and issued in the same name as that shown in Section 2, above? [phone (608) 266-2776] Yes No
 14 Is the applicant indebted to any wholesaler beyond 15 days for beer or 30 days for liquor? Yes No

READ CAREFULLY BEFORE SIGNING: Under penalty provided by law the applicant states that each of the above questions has been truthfully answered to the best of the knowledge of the signers. Signers agree to operate this business according to law and that the rights and responsibilities conferred by the license(s), if granted, will not be assigned to another. (Individual applicants and each member of a partnership applicant must sign; corporate officer(s) members/managers of Limited Liability Companies must sign) Any lack of access to any portion of a licensed premises during inspection will be deemed a refusal to permit inspection. Such refusal is a misdemeanor and grounds for revocation of this license

SUBSCRIBED AND SWORN TO BEFORE ME

this 28th day of March, 2008 LARRY E. LINDEN Dane
 NOTARY PUBLIC (Officer of Corporation/Member/Manager of Limited Liability Company /Partner/Individual)
Arroyo E. Ficht
 (Clerk/Notary Public) My commission expires is permanent My commission is Permanent
 (Additional Partner(s)/Member/Manager of Limited Liability Company if Any)

TO BE COMPLETED BY CLERK

Date received and filed with municipal clerk <u>3-28-08</u>	Date reported to council/board	Date provisional license issued	Signature of Clerk / Deputy Clerk
Date license granted	Date license issued	License number issued <u>80380</u>	

POLICE SECTOR 405
 Alder 4 Verveer

09845

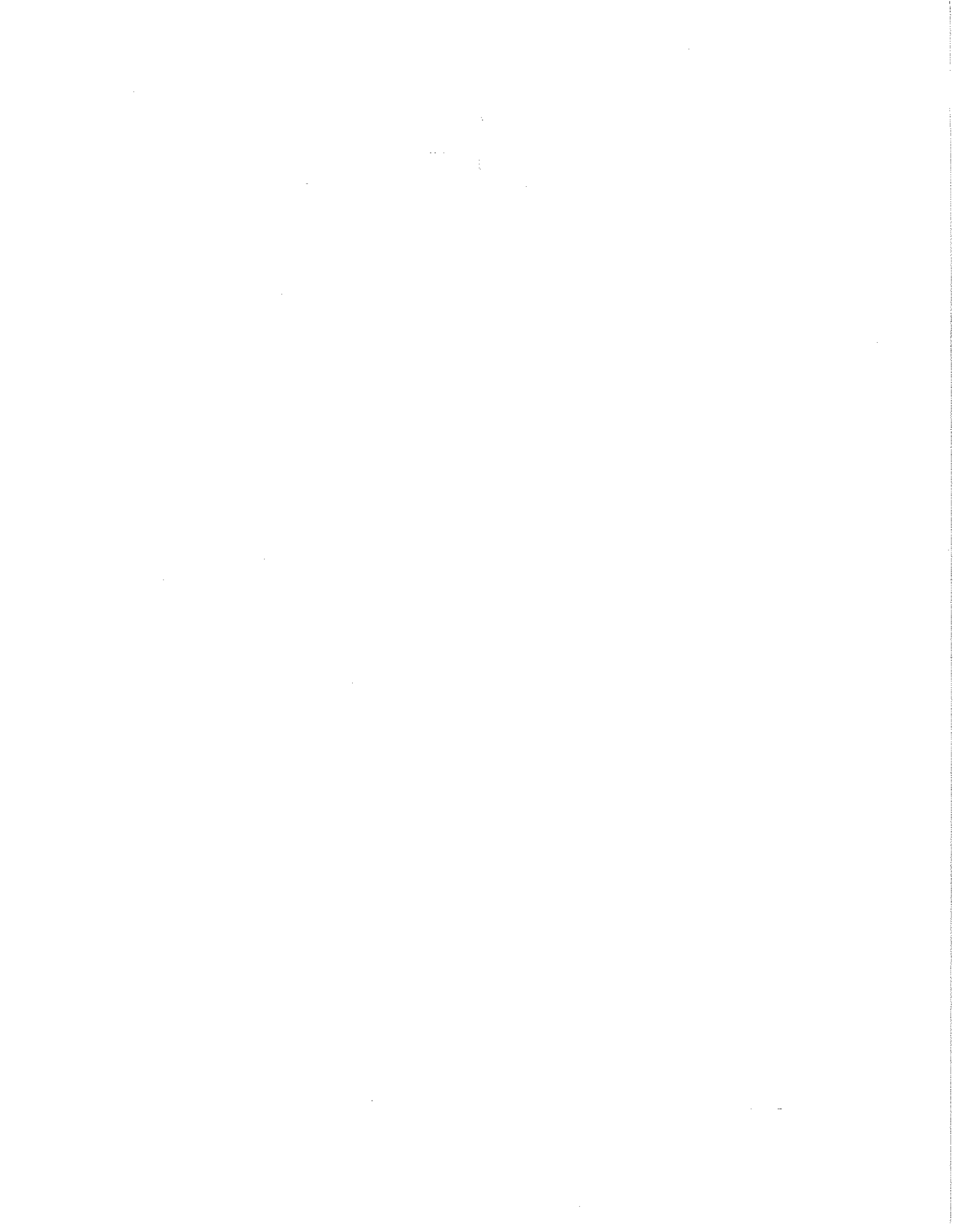

City of Madison Supplemental Class B License Application

<input type="checkbox"/> Seller's Permit Number <input checked="" type="checkbox"/> Federal Employer Identification Number <u>80 0165602</u> <input checked="" type="checkbox"/> Notarized Original Application Form <input checked="" type="checkbox"/> Notarized Supplemental Form	<input type="checkbox"/> Description of Licensed Premise <input checked="" type="checkbox"/> Notarized Appointment of Agent <input checked="" type="checkbox"/> Background Investigation Form(s) <input checked="" type="checkbox"/> Notarized Transfer of Ownership <input checked="" type="checkbox"/> Articles of Incorporation	<input type="checkbox"/> Floor Plans <input checked="" type="checkbox"/> Lease <input type="checkbox"/> Sample Menu <input type="checkbox"/> Business Plan * Corporation/LLC only
---	--	---

1. Name of Applicant/Partner/Corporation/LLC The Frequency, L.L.C.
2. Address of Licensed Premise 121 West Main
3. Telephone Number: 608.443.9126 4. Anticipated opening date: 5/15/2008
5. Mailing address if not opening immediately 3382 E WASHINGTON MADISON, WI 53704
6. Have you contacted the Alderperson, Police Department District Captain, Alcohol Policy Coordinator, and the neighborhood association representative for the area in which you intend to locate? Yes No
CANS BEING PLACED - WILL FOLLOW UP
7. Are there any special conditions desired by the neighborhood? Yes No

Explain. _____

8. Business Description, including hours of operation: Live music venue, 5PM-close daily - music on weekends to start.

9. Do you plan to have live entertainment? No Yes—What kind? Live music

10. Detailed written description of building, including overall dimensions, seating arrangements, capacity, bar size and all areas where alcohol beverages are to be sold and stored. **The licensed premise described below shall not be expanded or changed without the approval of the Common Council.**

Approx. 20' x 100' -
Seating - 50 stools total + bar rails, lounge
Capacity - 99/100 Bar size - 20' front bar 10' x 10' rear bar

11. Are any living quarters directly or indirectly accessible and under control of the applicant? Yes No
 Please note that alcohol may be sold and stored only on the licensed premise, not in living quarters.

12. Describe existing parking and how parking lot is to be monitored. (800 STALLS) Parking ramp, street parking

13. Describe your management experience, staffing levels, duties and employee training
10 months managing The Annex - staffing, management and coordination of all live entertainment

14. Identify the **registered agent** for your Corporation or LLC. This is your corporation's agent for service of process, notice or demand required or permitted by law to be served on the corporation.

DARWIN R. SAMPTON 3382 E Washington MADISON, WI 53704
 Name Address

15. Utilizing your market research, who would you project your target market to be?

Fans of live music

16. What age range would you hope to attract to your establishment? 21 +

17. Describe how you plan to advertise/promote your business What products will you be advertising?

Papers / Self promotion / street team - MUSIC

18. Are you operating under a lease or franchise agreement? Yes (attach a copy) No

19. Owner of building where establishment is located: Larry Lichte

Address of Owner: 123 W MAIN Phone Number 257-4808

N/A Private organizations (clubs): Do your membership policies contain any requirement of "Invidious" (likely to give offense) discrimination in regard to race, creed, color, or national origin? Yes No

21. List the Directors of your Corporation/LLC

DARWIN SAMPSON 3382 E WASHINGTON
Name Address

Name Address

Name Address

22. List the Stockholders of your Corporation/LLC

DARWIN SAMPSON 3382 E WASHINGTON 100%
Name Address % of Ownership

Name Address % of Ownership

Name Address % of Ownership

23. What type of establishment are you? (Check all that apply) Tavern Nightclub Restaurant

Other Please Explain _____

24. What type of food will you be serving, if any? N/A

Breakfast Lunch Dinner

25. Please submit a sample menu with your application, if possible. What might eventually be included on your operational menu when you open?

Appetizers Salads Soups Sandwiches Entrees

Desserts Pizza Full Dinners

26. During what hours of your operation do you plan to serve food? N/A

27. What hours, if any, will food service not be available? N/A
28. Indicate any other product/service offered. _____
29. Will your establishment have a kitchen manager? Yes No
30. Will you have a kitchen support staff? Yes No
31. How many wait staff do you anticipate will be employed at your establishment? N/A
During what hours do you anticipate they will be on duty? 5PM
32. Do you plan to have hosts or hostesses seating customers? Yes No
33. Do your plans call for a full-service bar? Yes No
If yes, how many bar stools do you anticipate having at your bar? 50
How many bartenders do you anticipate you would have working at one time on a busy night? 2
34. Will there be a kitchen facility separate from the bar? Yes No
35. Will there be a separate and specific area for eating only? Yes No
If yes, what will be the seating capacity for that area? _____
36. What type of cooking equipment will you have? Stove Oven Fryers Grill Microwave
37. Will you have a walk-in cooler and/or freezer dedicated solely to the storage of food products? Yes No
38. What percentage of your overall payroll do you anticipate will be devoted to food operation salaries?
N/A
39. If your business plan includes an advertising budget, what percentage of your advertising budget do you anticipate will be related to food? N/A
What percentage of your advertising budget do you anticipate will be drink related? N/A
40. Are you currently, or do you plan to become, a member of the Madison—Dane County Tavern League or the Tavern League of Wisconsin? Yes No * will look into becoming a member
41. Are you currently, or do you plan to become, a member of the Wisconsin Restaurant Association or the National Restaurant Association? Yes No

42. What is your estimated capacity? _____

43. Pursuant to Chapter 23 of the Madison General Ordinances, all restaurants and taverns serving alcohol beverages shall substantiate their gross receipts for food and alcohol beverage sales broken down by percentage. For new establishments, the percentage will be an estimate.

Gross Receipts from Alcoholic Beverages	88 %
Gross Receipts from Food and Non-Alcoholic Beverages	12 %
Gross Receipts from Other	%
Total Gross Receipts	100%

NEW BUSINESS

44. Do you have written records to document the percentages shown? Yes No
You may be required to submit documentation verifying the percentages you've indicated.

Read carefully before signing: Under penalty provided by law, the applicant states that the above information has been truthfully completed to the best of the knowledge of the signer. Signer agrees to operate this business according to law and that the rights and responsibilities conferred by the license(s), if granted will not be assigned to another. Any lack of access to any portion of a licensed premise during inspection will be deemed a refusal to permit inspection. Such refusal is a misdemeanor and grounds for revocation of this license.

Subscribed and Sworn to before me:

this 28TH day of MARCH, 2008

Don S...
(Officer of Corporation/Member/Manager of LLC/Partner/Individual)

Larry E. Lichte
(Clerk/Notary Public)

LARRY E. LICHT
NOTARY PUBLIC
STATE OF WISCONSIN
My commission is Permanent

My commission expires is permanent

LARRY E. LICHT
NOTARY PUBLIC
STATE OF WISCONSIN
My commission is Permanent

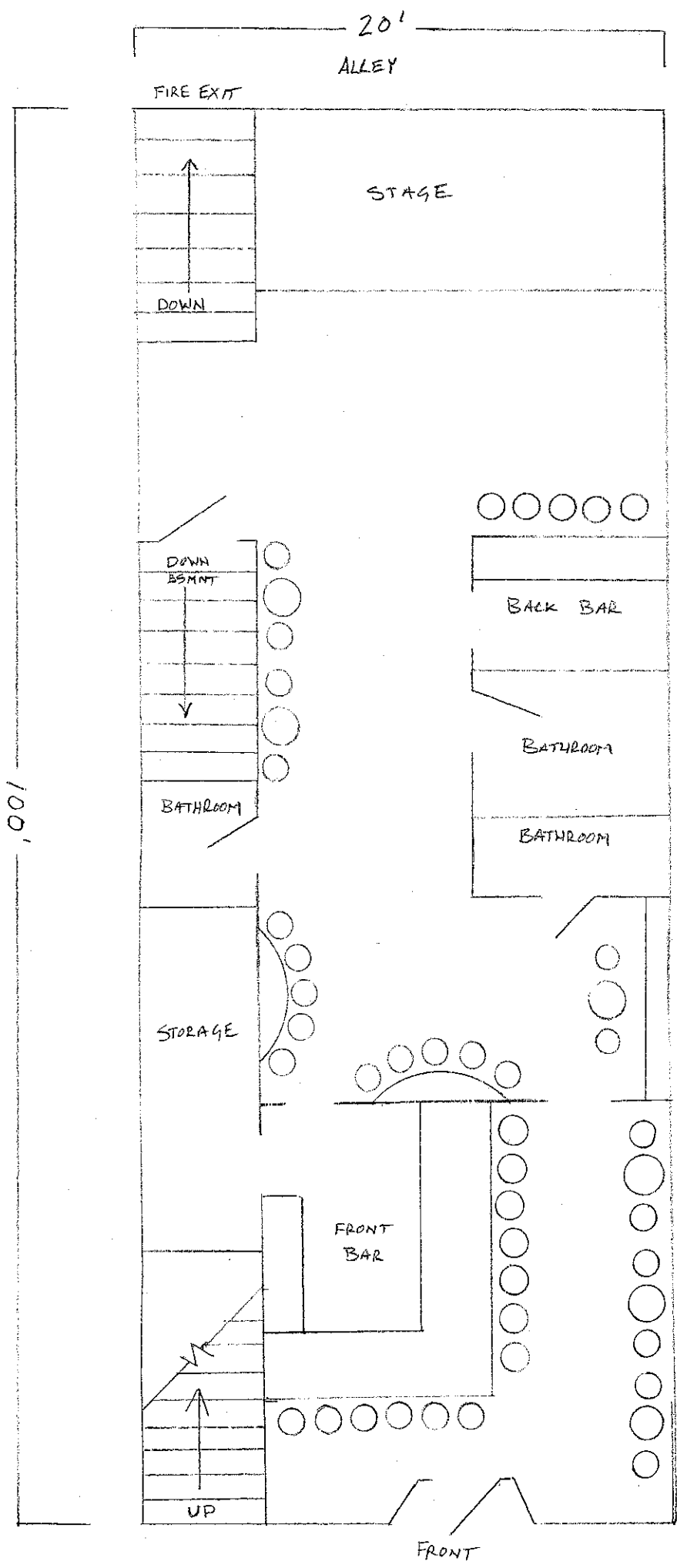

Description of Licensed Premise

121 West Main Street has been a bar for many years. As you enter the building, the main bar seats 15 at bar stools. Bar tables (for 2) line the wall for another six seats. The next room is a lounge with gas fireplace and bar lounge / chair seating.

The third area from mid point to the back of the building has table and chairs where there is a stage for music entertainment.

There are bathrooms, and a back exit.