

ID# 01058

RECEIVED CITY OF MADISON  
CLERKS OFFICE

05 APR -5 AM 9:28

**UNANIMOUS PETITION FOR ATTACHMENT**

In accordance with the Final City of Madison and Town of Middleton Cooperative Plan under Section 66.0307, Wisconsin Statutes, dated September 29, 2003 (the "Cooperative Plan"), namely, Section 12.01 of the Cooperative Plan and Section 66.0307(10) of the Wisconsin Statutes, the undersigned constituting all of the owners of real property in the following described territory of the Town of Middleton, Wisconsin (the "Town") hereby petition the City of Madison, Wisconsin (the "City") for attachment to the City of the property described in paragraph 1 below and in this regard request and represent as follows:

1. The undersigned are owners of the real property located in the Town as described on Exhibit A attached hereto referred to as the "Territory to be Attached". Further, the undersigned are desirous of having the Territory to be Attached detached from the Town and attached to the City. The purpose of this Petition is for attachment of said Territory to be Attached to the City.

2. A scale map showing the boundaries of the above described Territory to be Attached and showing the relation to the City and the Town is included in Exhibit B.

3. The Territory to be Attached is contiguous to the City and within the Boundary Adjustment Area of the Cooperative Plan.

4. The undersigned are of the belief that the Territory to be Attached meets all requirements for attachment under Section 66.0307(10) Wisconsin Statutes and under the Cooperative Plan.

5. The undersigned hereby further request that the Territory to be Attached be zoned as C3 Commercial District as defined under the Madison General Ordinances pursuant to the provisions of Section 12.01 of the Cooperative Plan

6. The Territory to be Attached has zero residents and zero electors.

WHEREFORE, the undersigned property owners respectfully request attachment of the Territory to be Attached described in Paragraph 1 above to the City of Madison pursuant to the provisions of Section 12.01 of the Cooperative Plan and Section 66.0307(10) Wisconsin Statutes and for zoning to be designated as set forth hereinabove.

Dated this 23<sup>rd</sup> day of MARCH, 2005.

<u>Signature of Petitioner</u>	<u>Owner</u>	<u>Description of Property</u>	<u>Date</u>
Dynatron Research Foundation By: <u>[Signature]</u> Helmut F. Prah, President	Owner	Exhibit A	3/23/05

c: Kitty Noonan  
Bill Roberts (4-6)  
Eric Pedersen  
Ken Seifert  
Sherri Melleville

**EXHIBIT "A"**

**Legal Description of Territory to Be Attached**

Part of the NE1/4 of the SW1/4 of Section 25, Town 7 North, Range 8 East, Town of Middleton, Dane County, Wisconsin, more fully described as follows:

Commencing at the South quarter corner of said Section 25; thence North 00°46'14" East, along the East line of the Southwest 1/4 of said Section 25 and the Easterly line of CSM 4104, 1432.14 feet to the North right-of-way line of Watts Road as platted in said CSM 4104, and the Point of Beginning of this description; thence continuing North 00°46'14" East, along the East line of the Southwest 1/4 of said Section 25, 348.71 feet more or less to the southeast corner of Certified Survey Map No. 4072; thence N 88°53'21" W, 697.04 feet more or less along the said south line of Certified Survey Map No. 4072, to the Easterly right-of-way line of Struck Street; thence S 00°52'48" W, 376.52 feet along the said Easterly right-of-way line of Struck Street to the Northerly right-of-way line of Watts Road, as presently located; thence North 88°49'39" East, on said North right-of-way line, 698.15 feet, more or less, to the East line of the Southwest 1/4 of said Section 25 and the Point of Beginning.

Presented ..... 4-19-05  
Referred to..... CC MTG 5-3-05  
Reported Back.....  
Adopted.....  
Unless Suspended.....  
Re-Referred to.....  
Placed on File.....  
Scanned 5-17-05

**City of Madison Current description (for reference only)**

(13) Part of the NE1/4 of the SW1/4 of Section 25, Town 7 North, Range 8 East, Town of Middleton, Dane County, Wisconsin, more fully described as follows:

Commencing at the South quarter corner of said Section 25; thence North 00°46'14" East, along the East line of the Southwest 1/4 of said Section 25 and the Easterly line of CSM 4104, 1432.14 feet to the North right-of-way line of Watts Road as platted in said CSM 4104, and the Point of Beginning of this description; thence South 88°47'08" West, on said North right-of-way line, 695 feet, more or less, to the Easterly right-of-way line of Struck Street; thence N 00°53'48" E, 60 feet along the said east right-of-way of Struck Street, to the Easterly prolongation of the Northerly right-of-way line of Watts Road, as presently located (2004) (Note: the Northerly right-of-way line of Watts Road shifts 60 feet to the North as it crosses Struck Street from East to West, as presently located (2004). However, future surplus Watts Road right-of-way vacation will relocate part of said Northerly right-of-way line.); thence North 00°53'48" East, 332.81 feet on said East right-of-way line of Struck Street; thence South 89°10'32" East, 3.00 feet on said East right-of-way line; thence North 00°53'48" East, 248.39 feet on the said East right-of-way line to the North right-of-way line of Seybold Road; thence South 88°35'19" West, 128.01 feet on said North right-of-way line; thence North 00°53'48" East 376.05 feet to a point on said Southerly right-of-way line of the West Beltline Highway; thence Northeasterly, Easterly and Southeasterly on said Southerly right-of-way line, 800 feet, more or less, to a point on the East line of the Southwest 1/4 of said Section 25; thence South 00°46'14" West on the last mentioned East line, 980 feet, more or less, to the Point of Beginning.

(12) Part of the North 1/2 of the Southwest 1/4 of Section 25, Town 7 North, Range 8 East, more fully described as follows:

Beginning at the point of intersection of the Southerly right\_of\_way line of the West Beltline Highway (U.S. Highway 12 and 14) as designated in Wisconsin State Highway Commission Project No. T04\_2(34) with the East line of relocated Gammon Road as designated in said project, 60.00 feet East of, measured at right angles to, a point in the

West line of said Section 25, 323.00 feet South of the said reference line, measured along the West line of said Section 25; thence Northeasterly, Easterly and Southeasterly along the said Southerly right\_of\_way line to the Northwest corner of the property described in Volume 9304 of Deeds, Page 49; thence South 01°07'57" West, 376.15 feet on the West line of said property to a point on the North right\_of\_way line of Seybold Road; thence North 88°35'39" East, 49.67 feet on said North right\_of\_way line; thence South 01°08'08" West, 330.14 feet; thence South 88°47'08" West, 25.00 feet; South 01°08'08" West, 250.22 feet to the North right\_of\_way line of Watts Road as presently located (2004); thence Westerly, 1380.94 feet, more or less, along the said Northerly right-of-way of Watts Road, to the Westerly line of CSM 2507 and Easterly line of CSM 6628; thence N01°05'18"E, 500.42 along the Easterly line of CSM 6628, to the Southerly right-of-way line of Seybold Road; thence continuing N01°05'18"E, 30 feet to a line within the right-of-way of Seybold Road, said line being parallel with and 30 feet Northerly of the Northerly line of Lots 1 and 2, CSM 6628; thence S88°47'08"W, 250.88 feet along said parallel line, to a point that is 60.00 feet East of, measured at right angles to, the West line of said Southwest 1/4; thence Northerly along a line that is parallel to and 60.00 feet East of, measured at right angles to, the West line of said Section 25, 207 feet, more or less, to the point of intersection of the South right\_of\_way line of the above mentioned West Beltline Highway with the Easterly right\_of\_way line of Gammon Road as presently located, and the point of beginning.

**EXHIBIT "B"**

**Scale Map of Territory to Be Attached**

**[ATTACHED]**

# ANNEXATION MAP

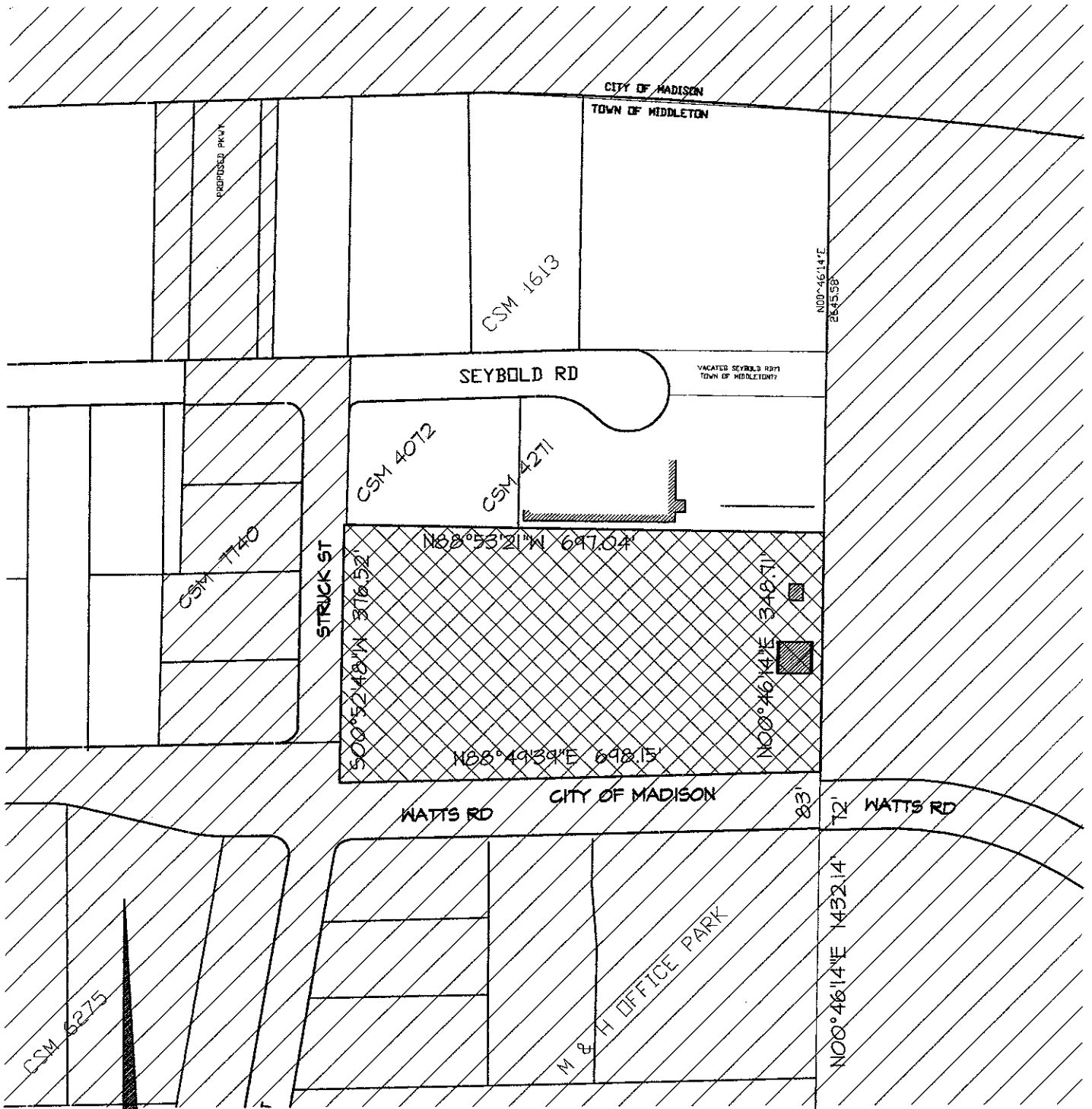

## LEGEND

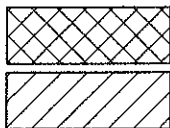

AREA TO BE ANNEXED

AREA WITHIN CITY OF MADISON

ALL BEARINGS ARE REFERENCED TO GRID NORTH OF THE WISCONSIN STATE PLANE COORDINATE SYSTEM NAD 27 - SOUTH ZONE

ORDINANCE ---  
 I.D. NUMBER ---  
 DATE ADOPTED ---  
 DATE PUBLISHED ---  
 ALD. DISTRICT ---  
 AREA SQ. MILES --- 0.009  
 DRAWN BY ARNOLD & O'SHERIDAN, INC.

