

EXHIBIT A
(TO BE DELETED)

Leased Premises – Area 1 (Part of Tax Parcel No. 062-0608-022-8000-0)

The area depicted on attached Exhibit B as “Leased Premises – Area 1,” being approximately 136,000 sq. ft. (3.1 acres) in area and being part of the following described larger parcel:

Part of the fractional North $\frac{1}{2}$ of Section 2, Town 6 North, Range 8 East (Township of Verona) described as follows:

Beginning at the Northwest corner of said Section 2; thence East 3687.74 feet more or less to a point 298 feet West of the Northeast corner of the fractional Northwest $\frac{1}{4}$ of the Northeast $\frac{1}{4}$ of said Section 2; thence S 635 feet, parallel to the East line of said fractional Northwest $\frac{1}{4}$ of the Northeast $\frac{1}{4}$, to the center line of a public highway; thence Southwesterly 1531.16 feet more or less along said center line to a point 285 feet Southwesterly (measured along said center line) of the North and South quarter line of said Section 2; thence West, parallel to said North line, to the West line of said Section 2; thence North 1320 feet along said West line to the point of beginning.

EXCEPT a parcel in the fractional Northeast $\frac{1}{4}$ of the Northwest $\frac{1}{4}$ of said Section 2, described as follows:

Beginning at a point in the center line of a Town Road which is 1540 feet West (measured along the North line of said Section) and 370 feet South (measured along said center line) from the Northeast corner of the fractional Northwest $\frac{1}{4}$ of the Northeast $\frac{1}{4}$ of said Section 2; thence N86°22'West 158.9 feet; thence South 92 feet; thence South 86°22'East 158.9 feet to the center of said Town Road; thence North 92 feet along said center line to the point of beginning.

Subject to existing public highways.

EXHIBIT A - REVISED 1/17/2007

(TO BE INSERTED)

Leased Premises – Area 1 (Part of Tax Parcel No. 062-0608-022-8000-0)

The area depicted on attached Exhibit C as “Leased Premises – Area 1,” being approximately 66,420 sq. ft. (1.5248 acres) in area and being part of the following described larger parcel:

Part of the fractional North $\frac{1}{2}$ of Section 2, Town 6 North, Range 8 East (Township of Verona) described as follows:

Beginning at the Northwest corner of said Section 2; thence East 3687.74 feet more or less to a point 298 feet West of the Northeast corner of the fractional Northwest $\frac{1}{4}$ of the Northeast $\frac{1}{4}$ of said Section 2; thence S 635 feet, parallel to the East line of said fractional Northwest $\frac{1}{4}$ of the Northeast $\frac{1}{4}$, to the center line of a public highway; thence Southwesterly 1531.16 feet more or less along said center line to a point 285 feet Southwesterly (measured along said center line) of the North and South quarter line of said Section 2; thence West, parallel to said North line, to the West line of said Section 2; thence North 1320 feet along said West line to the point of beginning.

EXCEPT a parcel in the fractional Northeast $\frac{1}{4}$ of the Northwest $\frac{1}{4}$ of said Section 2, described as follows:

Beginning at a point in the center line of a Town Road which is 1540 feet West (measured along the North line of said Section) and 370 feet South (measured along said center line) from the Northeast corner of the fractional Northwest $\frac{1}{4}$ of the Northeast $\frac{1}{4}$ of said Section 2; thence N86°22'West 158.9 feet; thence South 92 feet; thence South 86°22'East 158.9 feet to the center of said Town Road; thence North 92 feet along said center line to the point of beginning.

Subject to existing public highways.

EXHIBIT C (page 1 of 3)

(TO BE DELETED)

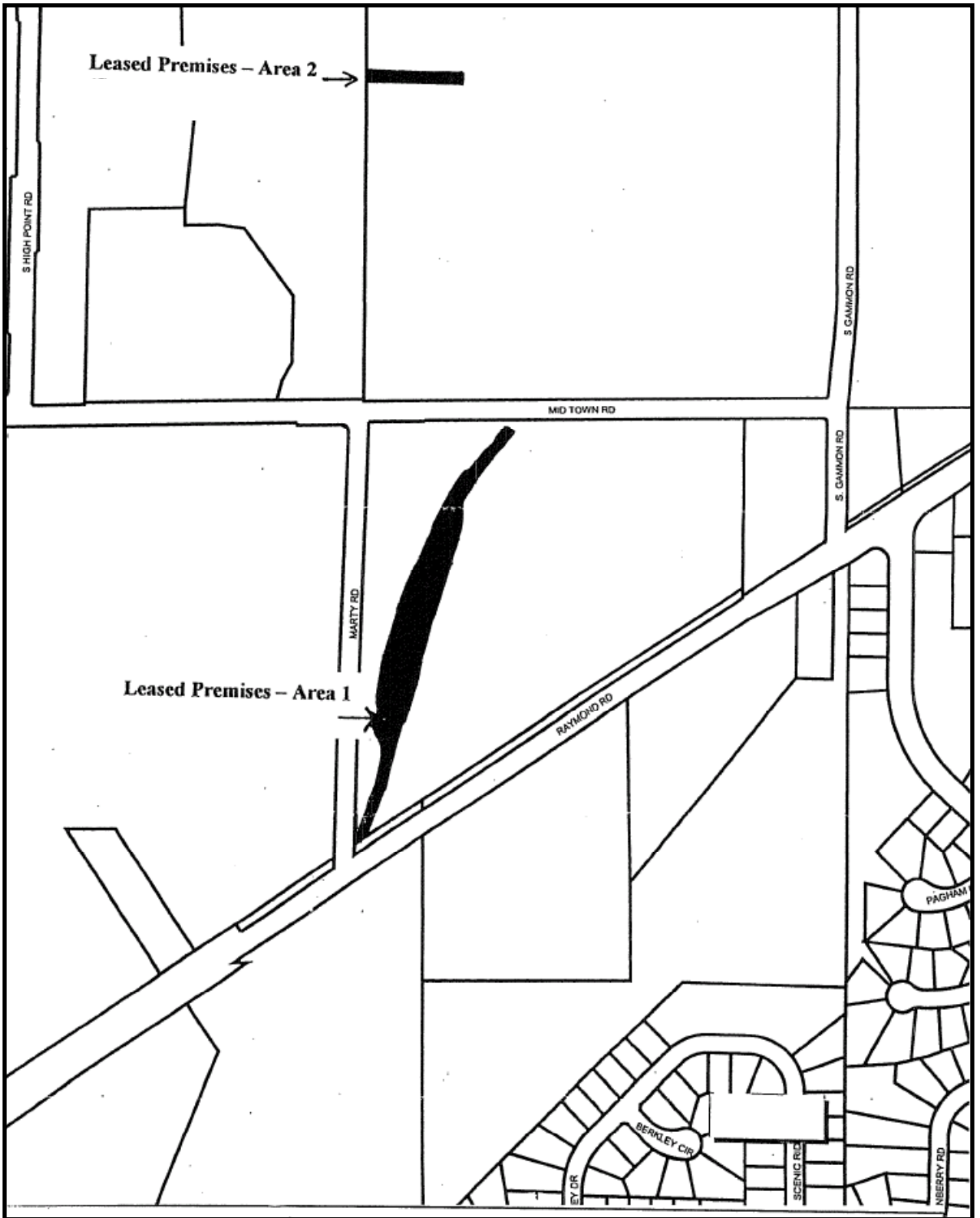

(TO BE INSERTED)

EXHIBIT C - REVISED 1/17/2007
(Page 1 of 3)



LOCATOR MAP

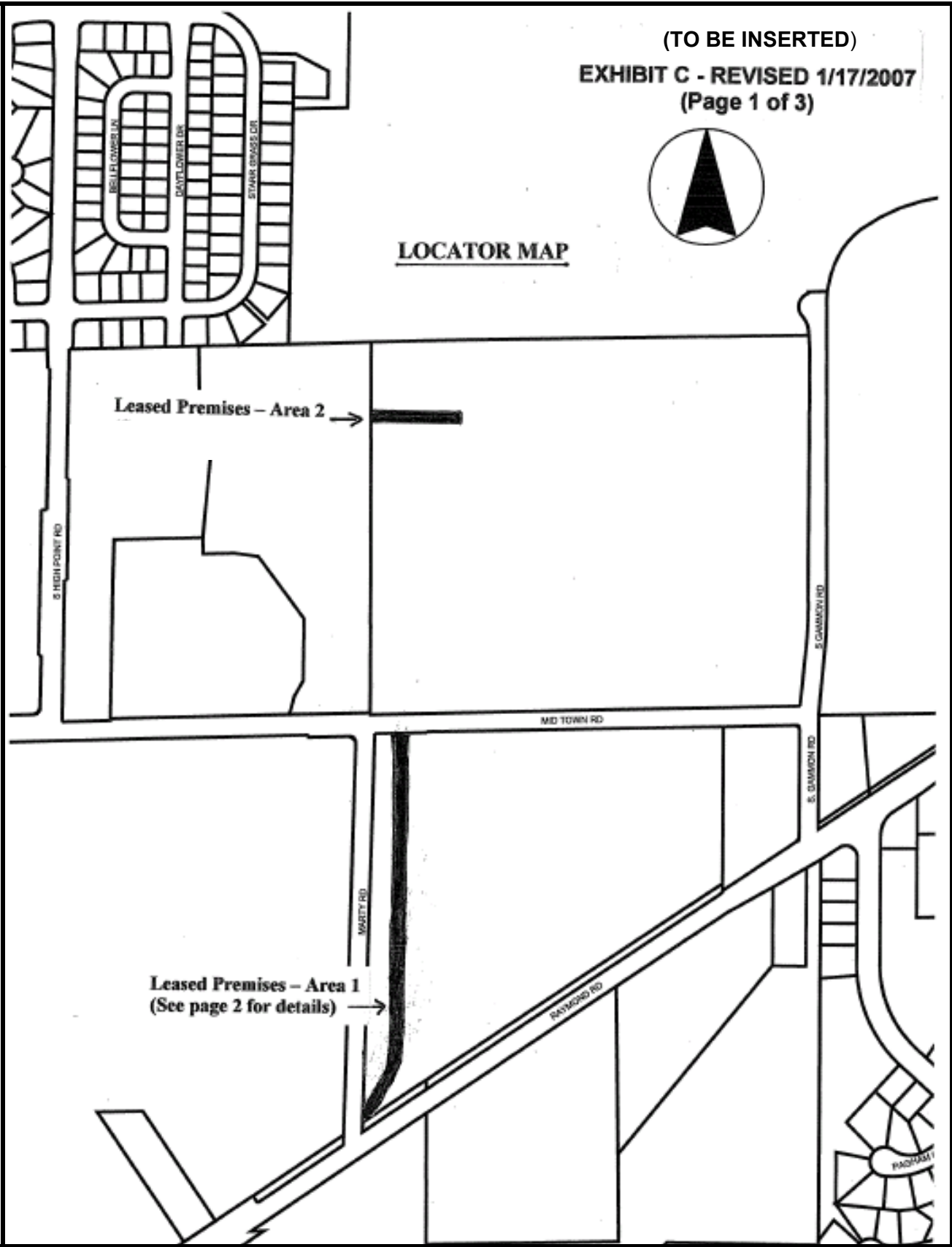

(TO BE DELETED)

