

ORIGINAL SIZE = 24" x 36"
 X:\4150\dwg\415002\101.dgn
 SCALE: 1/8"=1'-0"
 PLOTTED BY: Math

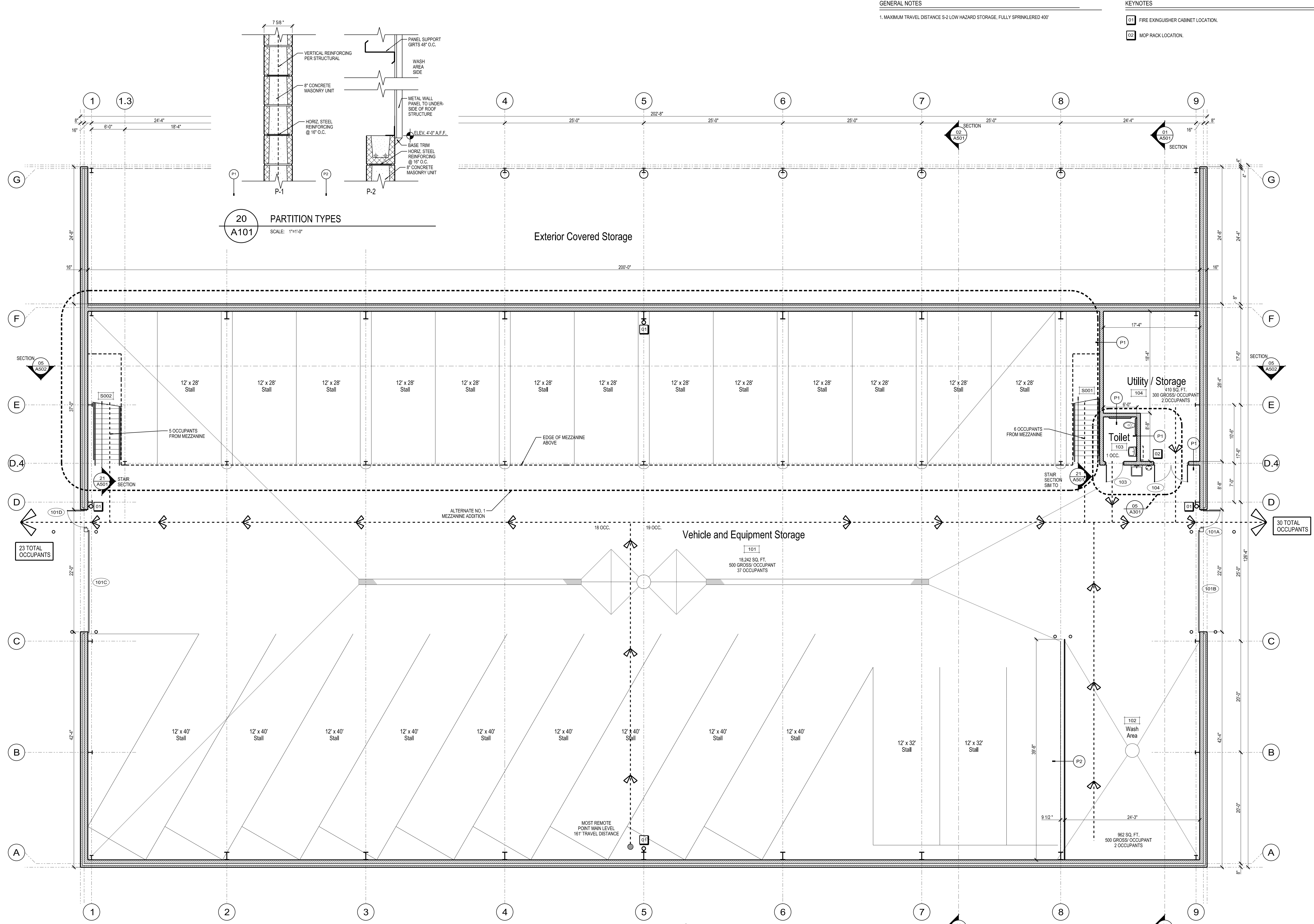

20 PARTITION TYPES
 A101 SCALE: 1"=1'-0"

GENERAL NOTES
 1. MAXIMUM TRAVEL DISTANCE S-2 LOW HAZARD STORAGE, FULLY SPRINKLERED 400'

KEYNOTES
 01 FIRE EXTINGUISHER CABINET LOCATION.
 02 MOP RACK LOCATION.

NORTH
 FLOOR PLAN - ALTERNATES
 SCALE: 1/8"=1'-0"

Due to electronic distribution, this drawing may not be printed to the scale indicated on the drawings. Do NOT use scale to determine dimensions or sizes.

Angus Young
 Architecture
 Engineering
 Interior Design
 Balance in Creativity
 555 South River Street, Ingleside, WI 53548-4783
 Ph: 608.756.2326 Fax: 608.756.0464
 www.angusyoung.com

**SOUTH POINT ROAD
 PUBLIC WORKS STORAGE BUILDING
 CITY OF MADISON
 MADISON, WISCONSIN**

PROJECT NUMBER: 48150
 APPROVED BY: [Signature]
 REVIEWED BY: [Signature]
 DRAWN BY: J.L.H.
 8/31/2012 12:42:18 PM

ISSUANCES
 UDC FINAL APPROVAL SUBMITTAL - 07/17/2012
 DESIGN DEVELOPMENT PACKET - 08/23/2012
 100% CONSTRUCTION DOCUMENTS 08.31.2012

REVISIONS

Copyright © 2012 Angus-Young Associates, Inc. All Rights Reserved

A101