

# EXHIBIT A



**BIRRENKOTT  
SURVEYING, INC.**

P.O. Box 237  
1677 N. Bristol Street  
Sun Prairie, WI. 53590  
Phone (608) 837-7463  
Fax (608) 837-1081

## ANNEXATION MAP

PART OF THE NORTHWEST 1/4 OF THE SOUTHWEST 1/4,  
PART OF THE SOUTHWEST 1/4 OF THE SOUTHWEST 1/4  
AND PART OF THE SOUTHEAST 1/4 OF THE SOUTHWEST  
1/4 OF SECTION 24, T8N, R9E, TOWN OF WESTPORT,  
DANE COUNTY, WISCONSIN

ANNEXATION TO THE  
CITY OF MADISON

ORDINANCE NUMBER \_\_\_\_\_  
I.D. NUMBER \_\_\_\_\_  
DATE ADOPTED \_\_\_\_\_  
DATE PUBLISHED \_\_\_\_\_  
ALDERMANIC DISTRICT  
ANNEXED TO \_\_\_\_\_  
AREA 0.1204071611 Sq. Miles

BEARINGS REFERENCED TO THE DANE  
COUNTY COORDINATE SYSTEM AND THE  
SOUTH LINE OF THE SOUTHWEST 1/4  
BEARING S89°22'11"E

CITY OF MADISON

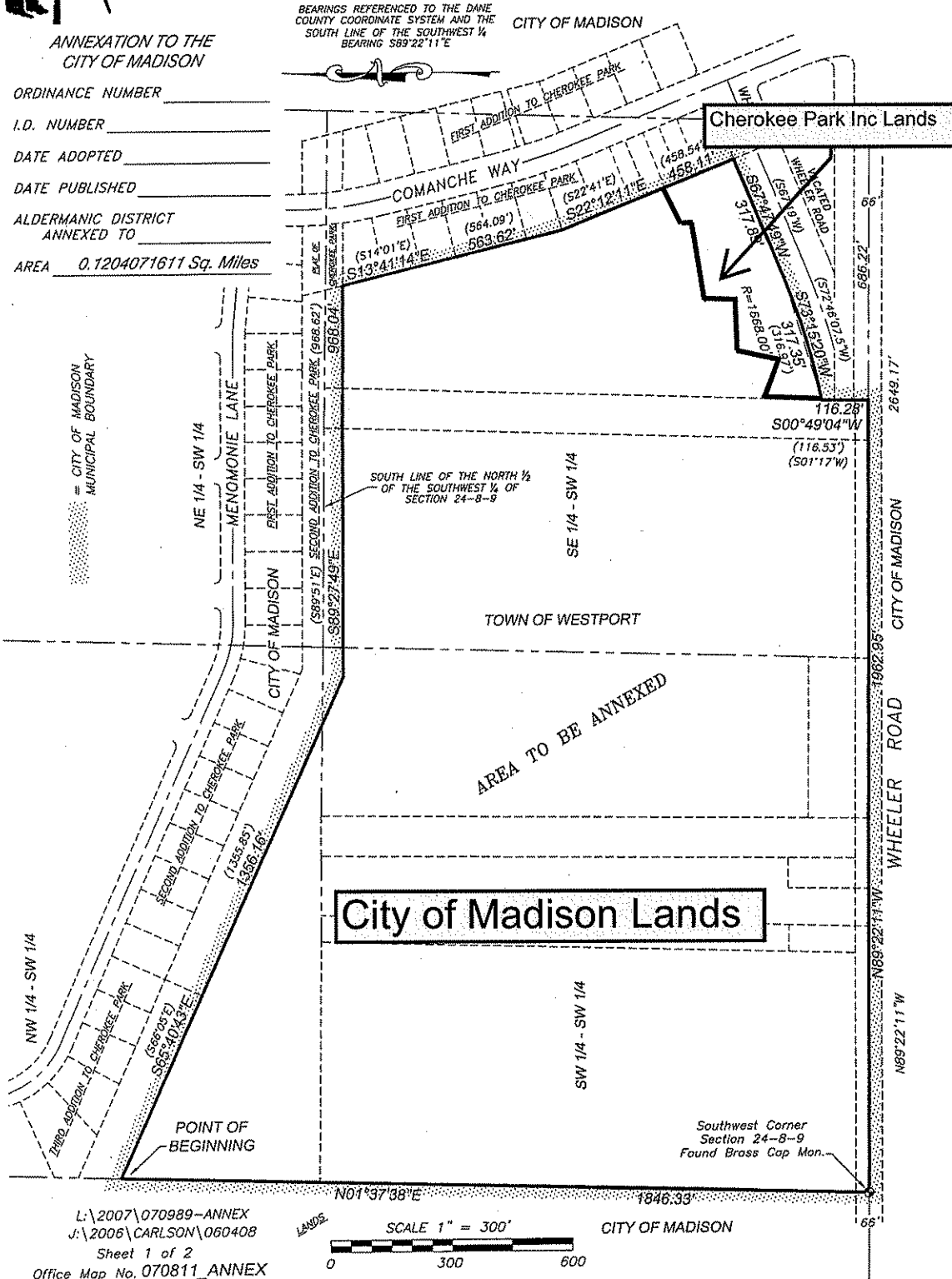

L:\2007\070989-ANNEX  
J:\2006\CARLSON\060408  
Sheet 1 of 2  
Office Map No. 070811\_ANNEX

SCALE 1" = 300'  
0 300 600  
CITY OF MADISON