

Redtail Dr. 2007 Traffic Calming Project (3) Circles from Lawn Brook Dr. to Redan Dr.

10/3/07

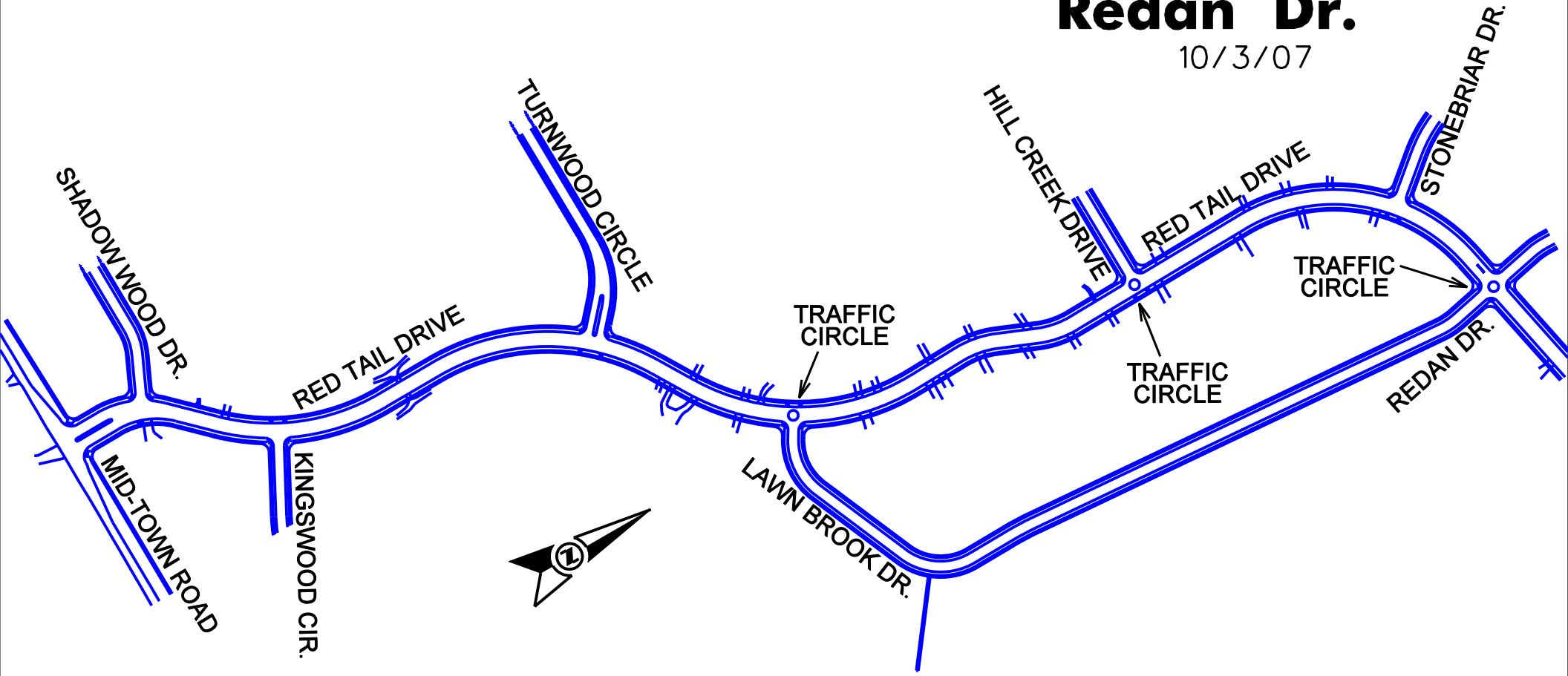

Redtail Dr. 2007 Traffic Calming Project (3) Circles from Lawn Brook Dr. to Redan Dr.

10/3/07

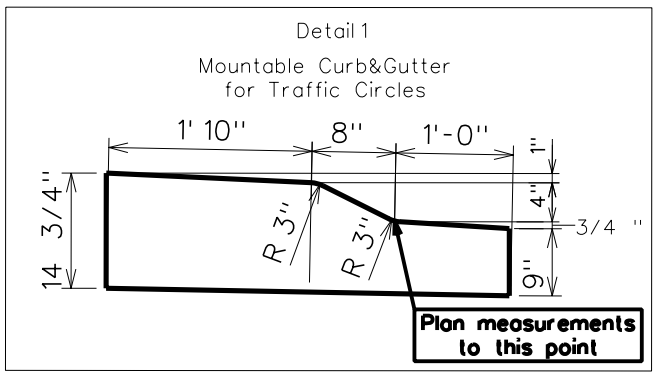

This plan was prepared based on approximate curb locations, which were obtained from an air photo. Field adjustments may be necessary to maintain the intent of the design. Contact the design engineer if conflicts are encountered or if there are any questions.

These plans may change based on neighborhood input, Alderperson requests, Fire Department and other emergency vehicle access requirements, Metro Transit access requirements and as determined by the Traffic Engineering Division.

Type 2 sidewalk ramps which are A.D.A. compliant shall be installed as shown.

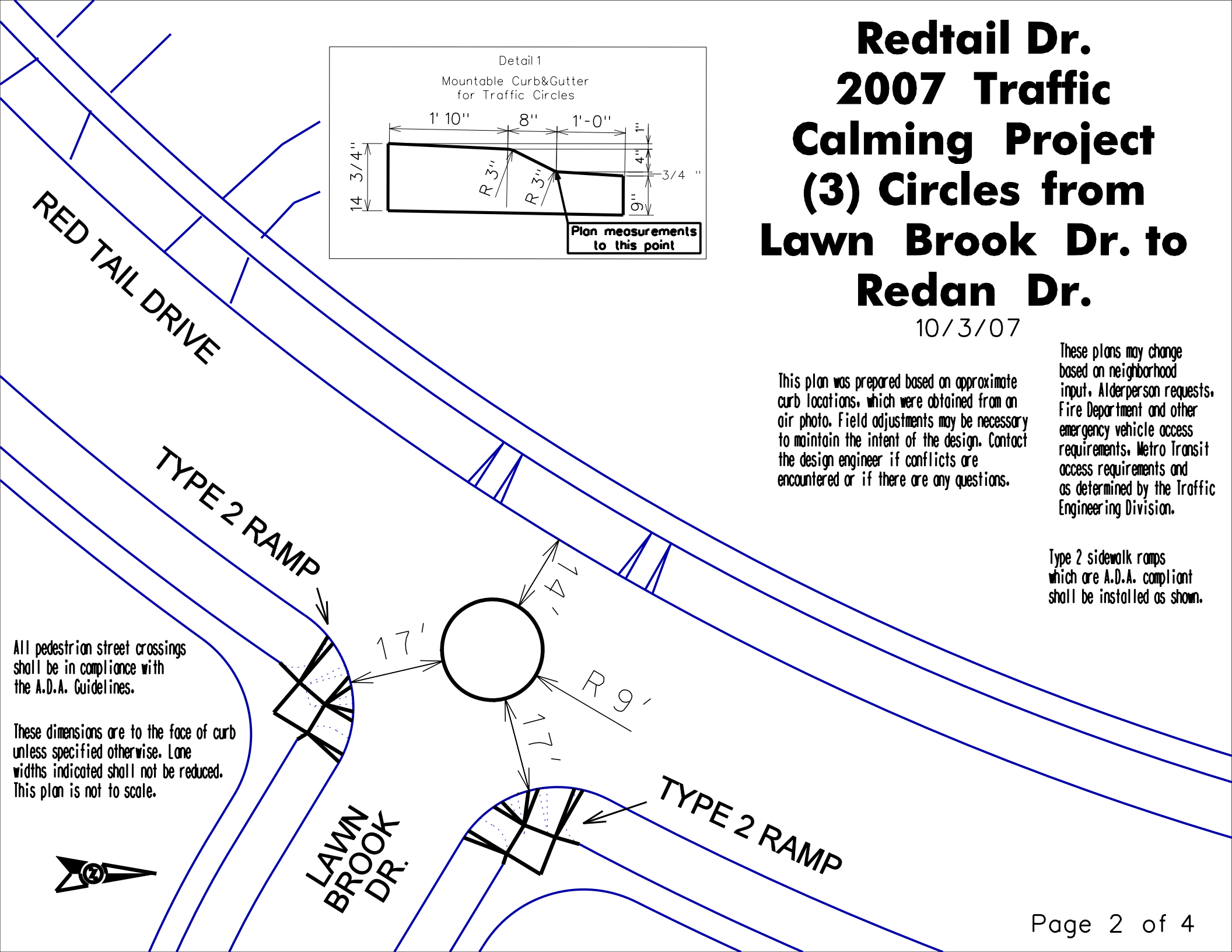

All pedestrian street crossings shall be in compliance with the A.D.A. Guidelines.

These dimensions are to the face of curb unless specified otherwise. Lane widths indicated shall not be reduced. This plan is not to scale.

Redtail Dr. 2007 Traffic Calming Project (3) Circles from Lawn Brook Dr. to Redan Dr.

10/3/07

These plans may change based on neighborhood input, Alderperson requests, Fire Department and other emergency vehicle access requirements, Metro Transit access requirements and as determined by the Traffic Engineering Division.

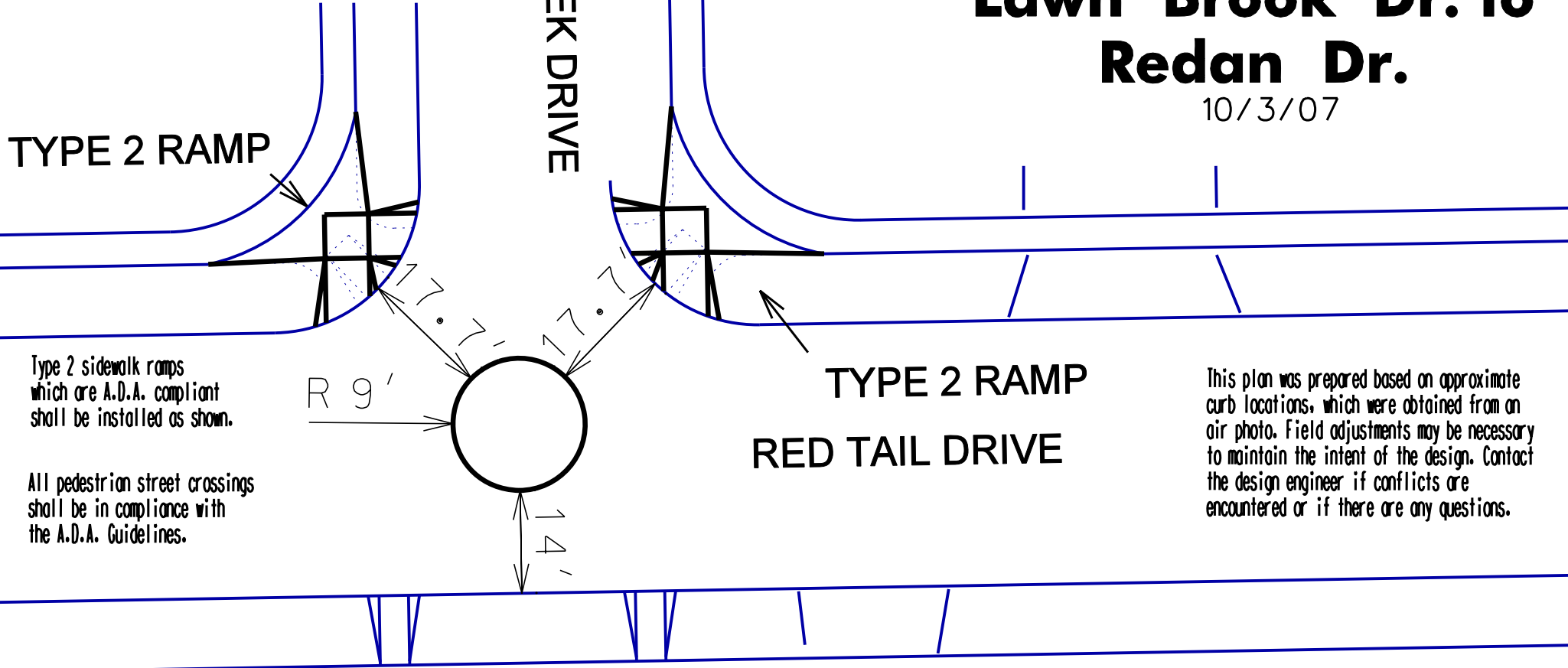
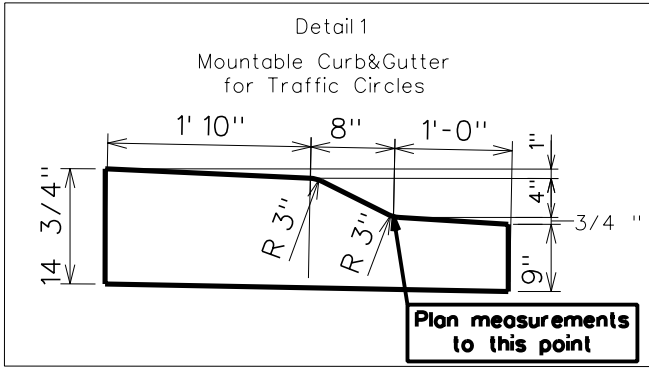

TYPE 2 RAMP

HILL CREEK DRIVE

TYPE 2 RAMP
RED TAIL DRIVE

Type 2 sidewalk ramps which are A.D.A. compliant shall be installed as shown.

All pedestrian street crossings shall be in compliance with the A.D.A. Guidelines.

This plan was prepared based on approximate curb locations, which were obtained from an air photo. Field adjustments may be necessary to maintain the intent of the design. Contact the design engineer if conflicts are encountered or if there are any questions.

These dimensions are to the face of curb unless specified otherwise. Lane widths indicated shall not be reduced. This plan is not to scale.



Redtail Dr. 2007 Traffic Calming Project (3) Circles from Lawn Brook Dr. to Redan Dr.

10/3/07

These plans may change based on neighborhood input, Alderperson requests, Fire Department and other emergency vehicle access requirements, Metro Transit access requirements and as determined by the Traffic Engineering Division.

Type 2 sidewalk ramps which are A.D.A. compliant shall be installed as shown.

All pedestrian street crossings shall be in compliance with the A.D.A. Guidelines.

These dimensions are to the face of curb unless specified otherwise. Lane widths indicated shall not be reduced. This plan is not to scale.

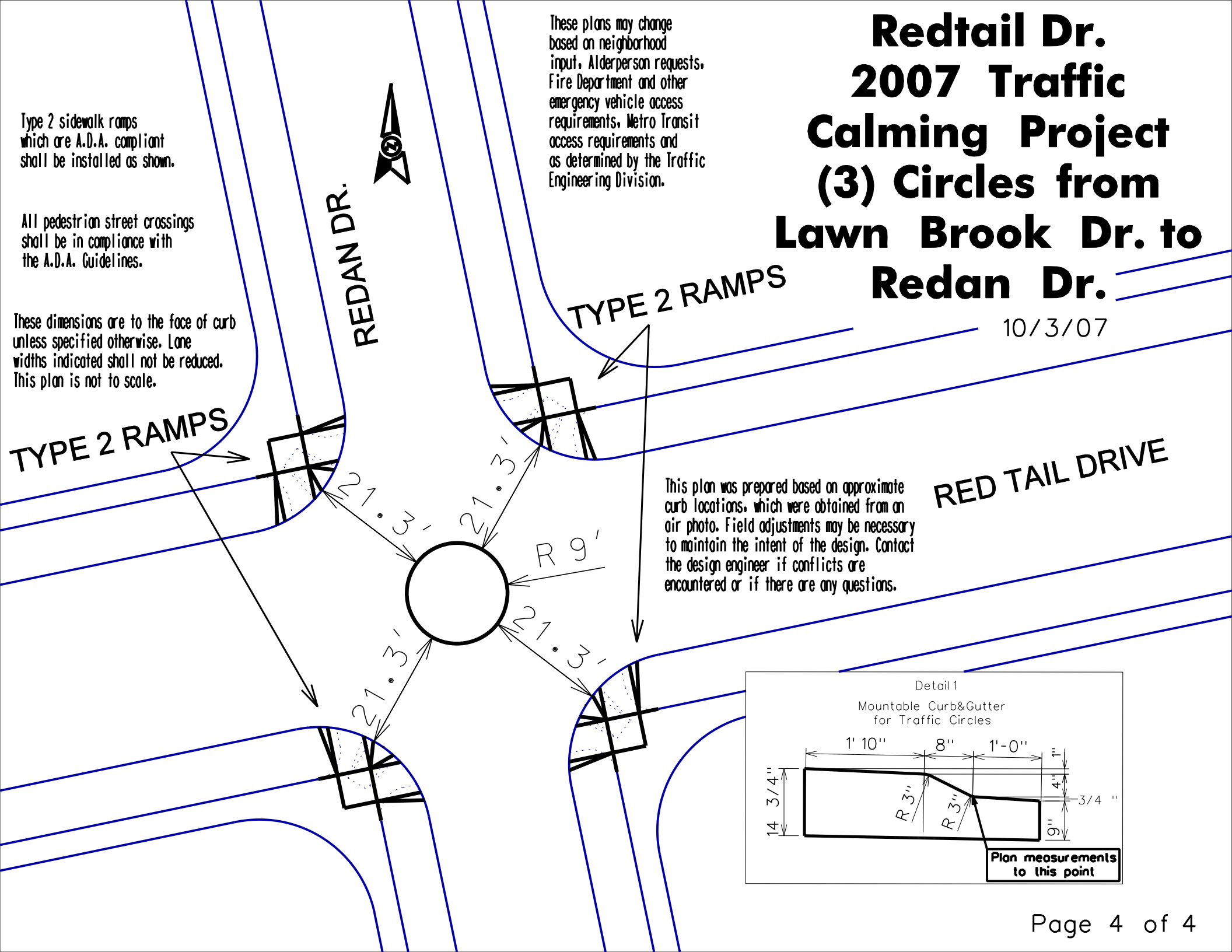

This plan was prepared based on approximate curb locations, which were obtained from an air photo. Field adjustments may be necessary to maintain the intent of the design. Contact the design engineer if conflicts are encountered or if there are any questions.

