

AFFIDAVIT OF MAILING

STATE OF WISCONSIN)
) ss.
COUNTY OF DANE)

 JOHANNA JOHNSON, being first duly sworn on oath, deposes and says that:

1. She is a Program Assistant 3 with the Office of the City Engineer, City of Madison, Dane County, Wisconsin, and did on the day of JANUARY 26, 2018 placed in envelopes addressed to each interested owner of respective addresses as indicated by attached assessment list, a true and correct copy of the notice of assessments for the project titled N. BLACKHAWK AVENUE, BRUCE COURT AND HEATHER CREST RESURFACING WITH UTILITIES attached hereto.
2. She did and delivered the envelopes to the Mail Room of the Dane County Printing and Services Division, 210 Martin Luther King, Jr. Blvd., in the city of Madison, Dane County Wisconsin, for postage and depositing in the United States Mail.

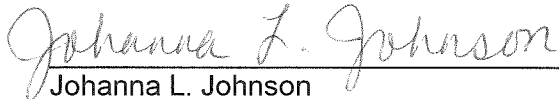

Johanna L. Johnson

Subscribed and sworn to before me
this 26 day of JANUARY, 2018



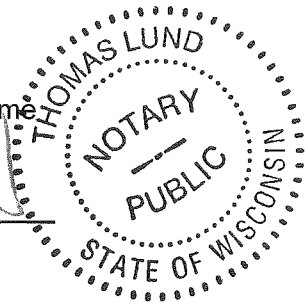

Notary Public, State of Wisconsin
My Commission expires:

05/24/2019



Department of Public Works
Engineering Division
Robert F. Phillips, P.E., City Engineer

City-County Building, Room 115
210 Martin Luther King, Jr. Boulevard
Madison, Wisconsin 53703
Phone: (608) 266-4751
Fax: (608) 264-9275
engineering@cityofmadison.com
www.cityofmadison.com/engineering

Parcel Number: 0709-201-0201-2
Situs Address: 3401 University Ave
SCHMIED, WILLIAM D
& ANNE E SCHMIED
721 PRAIRIE SMOKE RD
MADISON, WI 53717-0000

Assistant City Engineer
Gregory T. Fries, P.E.
Kathleen M. Cryan
Principal Engineer 2
Christopher J. Petykowski, P.E.
John S. Fahrney, P.E.
Principal Engineer 1
Christina M. Bachmann, P.E.
Mark D. Moder, P.E..
Facilities & Sustainability
Jeanne E. Hoffman, Manager
Mapping Section Manager
Eric T. Pederson, P.S.
Financial Manager
Steven B. Danner-Rivers

January 26, 2018

To: Property Owners along N. Blackhawk Ave, Bruce Ct, and Heather Crest

Re: Proposed Street Resurfacing with Utilities Project & Public Hearing

The City of Madison is proposing to resurface portions of N. Blackhawk Ave., Bruce Ct., and Heather Crest in 2018. Enclosed with this letter is a fact sheet with some details on the proposed project along with a notification for the Public Hearing before the Board of Public Works. The date, time and location of the public hearing can be found on the notification.

This project will involve special assessments to the owners of property adjacent to the project. The property owners will be assessed for various items included with this proposed project, and the costs of some of those items are assessed entirely to the owner. A table detailing the City's standard assessment policy for the street reconstruction items is included on the fact sheet.

Also enclosed is a Schedule of Assessments, which shows the estimated costs for each property adjacent to the project. After the work is complete, a final assessment will be calculated based on bid prices and work actually performed. The final assessment, which will be billed after the completion of the project, is payable in one lump sum or over a period of 8 years, with 3% interest charged on the unpaid balance.

To request accommodations for special needs or disabilities or if you have any other questions regarding this project, please contact the Project Engineer. This includes requests relating to the Public Hearing and also requests relating to the actual operations of construction. A list of contacts for this project can be found on the enclosed fact sheet.

Sincerely,

Robert F. Phillips, P.E.
City Engineer

January 26, 2018

Page 2

RFP:cwd

Cc by email:

Ald. Arvina Martin
Yang Tao, Traffic Engineering
Jeremy Nash, Traffic Engineering
Fadi El Musa Gonzalez, City Eng.
Tim Sobota, Madison Metro Transit
Cindy Mierow, Police Department
Dane County 911
Jeff Fedler, Madison School District Transportation Coordinator, jfedler@madison.k12.wi.us

Charlie Romines, Streets Division
Christy Bachmann, City Engineering
Mark Moder, City Engineering
Adam Wiederhoeft, Water Utility
Marla Eddy, City Forestry
Ed Ruckriegel, Fire Department
Jason Fenske, Badger Bus Lines, jasonf@badgerbus.com

**NOTICE OF PUBLIC HEARING
BEFORE THE BOARD OF PUBLIC WORKS
FOR
PLANS, SPECIFICATIONS, AND SPECIAL ASSESSMENTS
FOR
PUBLIC WORKS IMPROVEMENTS
MADISON, WISCONSIN**

PART I

The Common Council of the City of Madison, Wisconsin, having heretofore decided that it is expedient and necessary that the improvements as listed in Part II hereof be improved at the expense of the property thereby on which would be conferred some special benefit.

NOW, THEREFORE, NOTICE IS HEREBY GIVEN:

That the City Engineer has prepared plans, specifications, a proposed schedule of assessments, and an estimate of the entire costs of the improvement for each of the districts listed in Part II hereof, and;

That the plans, specifications, a proposed schedule of assessments, and an estimate of the entire cost of the improvements listed hereto are available and open to inspection by all interested persons in the office of the City Engineer, Room 115, City-County Building, 210 Martin Luther King Jr. Blvd., between the hours of 7:30 a.m. and 4:00 p.m., Monday through Friday, and will so continue to be for ten (10) working days from the first published date of this notice, and;

That on WEDNESDAY, FEBRUARY 7, 2018 AT 5:30 P.M., the Board of Public Works will hold a public hearing in ROOM 108 (PARKS CONFERENCE ROOM) OF THE CITY COUNTY BUILDING and will consider any objections that may be filed in writing or in person and hear all persons desiring to be heard, and;

That special assessments may be paid over an eight (8) year period, with the owner paying 1/8 of the principal each year plus three (3%) percent interest on the unpaid balance, as determined by the Board of Public Works.

That if the total assessment is paid in full before October 31st in the year that the billing is made, irrespective of project completion, then no interest shall be charged.

If you require an interpreter, materials in alternate formats, or other accommodations to access this public hearing, please contact the Engineering Division at phone (608) 266-4751 or email us at engineering@cityofmadison.com. Please make contact at least 24 hours prior to the date of this public hearing so that we can make proper accommodations.

PART II

DARBO DRIVE TO WEBB AVENUE NEW STREET CONNECTION ASSESSMENT DISTRICT – 2018

SCHENK STREET AND RICHARD STREET RESURFACING WITH UTILITIES ASSESSMENT DISTRICT – 2018

N. BLACKHAWK AVENUE, BRUCE COURT AND HEATHER CREST RESURFACING WITH UTILITIES

EMERSON STREET AND LOWELL STREET RECONSTRUCTION ASSESSMENT DISTRICT - 2018

By Order of the Board of Public Works
Madison, Wisconsin

PUB: WSJ JANUARY 26, 2018

Fact and Details Sheet

Proposed N Blackhawk Ave, Bruce Ct, and Heather Crest Resurfacing with Utilities— Project 11743

Project Details – Proposed Work

Sanitary Sewer: The City will replace existing mains (installed in 1945-1946), and in most cases replace laterals from the main to the property line (*laterals assessable*). In limited cases where the existing lateral is cast iron, appears to be in good condition upon inspection, or runs under a tree, the lateral will only be replaced to the back of curb. In those cases, the owner will not be assessed for the additional footage of replacement that is not completed. If you would like a full lateral replacement to the property line in cases such as these please contact the Sanitary Sewer Contact listed at right. Also, along Heather Crest where there are existing retaining walls adjacent to the sidewalk, lateral replacement may be stopped behind the curb rather than at the property line.

Water Main: Replace the existing water mains (installed in 1939) on N Blackhawk Ave from Stevens St to Harvey St, and reconnect services to the new main. Abandon existing water main beneath terrace on N Blackhawk Ave between Harvey St and University Ave and replace with water main under roadway. Water main work is not assessable.

Storm Sewer: Replace and extend storm sewer (installed in 1950-1959) from Bluff St to University Ave to improve drainage issues. If you are aware of any existing private storm sewer or private connections (either to the curb or to a structure) from your property, please contact the Storm Sewer contact listed at right (*private connections assessable*).

Street: Replace the pavement and make spot repairs to the existing curb, driveway aprons, and sidewalk (*assessable*). Grade changes will be made to the roadway on Blackhawk between Harvey and University to improve drainage. Overall street width on all streets will remain the same as exists today. Curb and sidewalk work will also need to be done for utility lateral replacements.

Terrace Areas: Existing concrete terrace walkways and concrete stairs will be replaced with the project (*assessable*), unless the property owner requests that they are removed. Owners may be asked to remove any encroaching plantings, structures or special landscaping features from the terrace area and public right-of-way (including the right-of-way on the east side of Blackhawk Ave, where there is no sidewalk), prior to the start of construction, including raised planting beds, stone landscaping, retaining walls, railings, pavers, planters, etc. Owners should contact the Project Manager for questions regarding the removal of encroaching features. If left in place, these items will be removed by the contractor. The contractor will not replace these items following completion of the project.

Trees: The majority of the existing trees will remain, but tree removals are planned at the following addresses Blackhawk: 513, 517, 717; Bruce: 709, 718; Heather: 3530 (2 trees), 3554, 3545; Lucia: 3534; Stevens: 3417, 3418; University: 3401 (2 trees), 3505, 3535, 3553. Tree removals are generally due to poor condition or are pre-emptive ash removals. If, during the course of construction, it is determined that any additional trees must be removed, adjacent property owners will be notified prior to removal of the tree. The trees within the project limits that remain may be pruned, and/or the roots may be trimmed. Some of the trimming may occur in advance of the project. Terrace areas will be evaluated by Forestry for new trees or replacements following the project. For additional information from Forestry, see the back of this sheet.

Project Website: Updates, including a copy of tonight's presentation will be posted here: <http://bit.ly/2IQ00EH>

Construction Schedule & Impacts

Tentative Schedule: May-October 2018

Traffic Impacts: The streets will be closed to through traffic within the project limits, but will be open to local traffic (residents). Parking will be restricted during the day for the project duration, however, overnight parking will be available to local traffic. Residential driveways may be closed for up to 20 days. Residents will be given advanced notice when access to driveways will be restricted.

Water Shut-offs: An average of two water shut-offs are expected for each property within the project limits. A minimum of 48 hours of notice will be provided prior to the shut-offs. Each shut-off may last up to 8 hours, but typically last about 4 hours. At the start of construction, the existing main will remain in service until the new main is installed and connected to; emergency shut-offs may occur if the existing main is damaged during construction.

Refuse Collection: It will be the contractor's responsibility to allow for refuse collection to continue during construction. Please mark your address on your cart to make sure it is returned if moved.

Project Location Map

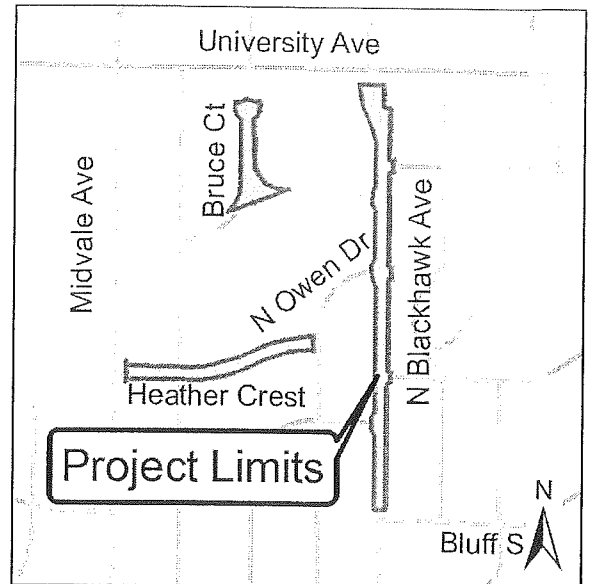

Project Contacts

Project Manager: Chris Dawson – 261-5537, cdawson@cityofmadison.com

Storm Sewer, Sanitary Sewer:
Fadi El Musa Gonzales – 243-5214
felmusagonzales@cityofmadison.com

Water: Amy Schockling – 261-9243,
aschockling@madisonwater.org

Construction: John Fahrney – 266-9091,
jfahrney@cityofmadison.com

Forestry: Wayne Buckley – 266-4816,
wbuckley@cityofmadison.com

Assessment Policy Breakdown

Item	City Share	Owner Share
Curb, sidewalk, drive aprons	50%	50%
Sanitary Laterals	75%	25%
Private Storm Connection	0%	100%
Asphalt Pavement	100%	0%
Sanitary & Storm Mains	100%	0%
Water Main	100%	0%
Sidewalk Ramps	100%	0%
Terrace Steps	0%	100%

Assessments are payable as a lump sum or over 8 years with 3% interest.

Supplemental Forestry Info

Tree pruning in advance of the project is required to reduce the risk of damage to the trees during construction. The City of Madison Forestry Section will perform the necessary work. For certain species, especially oak and elm trees, the pruning must be completed by April 1st to reduce the chance of disease. If additional trees need to be removed, City Forestry or City Engineering will notify the adjacent property owner prior to removal.

All ash street trees within the project limits have been or will be evaluated for potential chemical treatment for Emerald Ash Borer (EAB). Ash trees with trunks measuring less than 10" in diameter at 4.5 ft (DBH) from the ground, ash located under high voltage electric distribution lines, and ash that are structurally compromised or in poor condition will not be treated as outlined the City's EAB Plan. Ash trees that do not meet the treatment criteria will be removed prior to construction, and will be removed regardless of the construction project schedule. Including ash removals as part of the project will allow for a faster replacement timeframe. For more information about EAB and the City of Madison EAB response plan please see: <http://www.cityofmadison.com/parks/services/forestry/pests/EAB/index.cfm>.

Street trees provide many benefits to our city and are considered an important part of the city's infrastructure. Forestry Section staff will evaluate the terrace for new planting sites and potential replacement sites when the project is complete. There is no additional cost to the adjacent property owner for a tree planting. Street trees are typically planted in the spring of the year following the completion of the construction project. Per Madison General Ordinance 10.10, City Forestry determines tree species and planting locations. Residents cannot choose or plant their own tree in the terrace.

For any questions regarding street tree maintenance or planting, please contact Wayne Buckley at 266-4816.

City of Madison Engineering Division - Schedule of Assessments

01/25/2018

Project Name: N. Blackhawk Avenue, Bruce Court, and Heather Crest Resurfacing With Utilities Assessment District - 2018
 Project Limits: University to 150' S of Bluff, Bruce Ct, N Meadow to N Owen

*A factor has been applied for sidewalk and curb and gutter work adjacent to lots that abut more than one street and are single-family or two-family residential dwellings.

Parcel No./ Zoning	Owner's Name / Mailing Address	Parcel Location	Frontage	Remove Existing Drive Apron @				Replace Drive Apron @				Remove & Replace Sidewalk @				Remove & Replace Curb and Gutter @				Sanitary Sewer Reconnect @				Remove & Replace Sanitary Sewer Lateral @				Storm Sewer Items		Total Assessment
				\$1.50 SF	\$1.50 SF	\$6.00 SF	\$6.00 SF	Factor	\$5.00 SF	per SF	Cost	Factor	\$20.00 LF	per LF	Cost	Factor	\$25.00 LF	per LF	Cost	Sanitary Sewer Reconnect @ \$1,450.00 per Each	Each	Remove & Replace Sanitary Sewer Lateral @ \$25.00 LF	per LF	Cost	Private Storm Sewer Connection @ \$2,000.00	Each	Cost			
0709-201-1319-2 TR-C1	CITY OF MADISON CDA TELEPHONE 266-4675 PO BOX 1785 MADISON WI	222 N Blackhawk Ave	70.50 L.F.	80	\$120.00	80	\$480.00	1	100.00	\$500.00	1	63.00	\$1,260.00	1	\$1,450.00	1	\$1,450.00	1	\$1,450.00	40	\$1,000.00	40	\$1,000.00	0	\$0.00	\$4,810.00				
0709-201-1722-7 TR-C1	LOWE, CHRISTOPHER T & LAURA J LOWE 225 N BLACKHAWK AVE MADISON WI	225 N Blackhawk Ave	118.40 L.F.	0	\$0.00	0	\$0.00	0.5	0.00	\$0.00	0.5	35.00	\$350.00	1	\$1,450.00	1	\$1,450.00	1	\$1,450.00	40	\$1,000.00	40	\$1,000.00	0	\$0.00	\$2,800.00				
0709-201-1320-9 TR-C1	GAY, MICHAEL P 609 BORDNER DR MADISON WI	226 N Blackhawk Ave	70.50 L.F.	0	\$0.00	90	\$540.00	1	100.00	\$500.00	1	70.50	\$1,410.00	1	\$1,450.00	1	\$1,450.00	1	\$1,450.00	40	\$1,000.00	40	\$1,000.00	0	\$0.00	\$4,900.00				
0709-201-1321-7 TR-C1	CITY OF MADISON CDA TELEPHONE 266-4675 PO BOX 1785 MADISON WI	302 N Blackhawk Ave	70.50 L.F.	80	\$120.00	80	\$480.00	1	100.00	\$500.00	1	37.00	\$740.00	1	\$1,450.00	1	\$1,450.00	1	\$1,450.00	40	\$1,000.00	40	\$1,000.00	0	\$0.00	\$4,290.00				
0709-201-1322-5 TR-C1	PARK, HYEWON & HOON KIM 306 N BLACKHAWK AVE MADISON WI	306 N Blackhawk Ave	70.50 L.F.	80	\$120.00	80	\$480.00	1	100.00	\$500.00	1	46.00	\$920.00	1	\$1,450.00	1	\$1,450.00	1	\$1,450.00	40	\$1,000.00	40	\$1,000.00	0	\$0.00	\$4,470.00				
0709-201-1407-5 TR-C1	BLANKENHEIM REV TR, T & P 307 N BLACKHAWK AVE MADISON WI	307 N Blackhawk Ave	80.00 L.F.	0	\$0.00	0	\$0.00	0.5	0.00	\$0.00	0.5	24.00	\$240.00	1	\$1,450.00	1	\$1,450.00	1	\$1,450.00	40	\$1,000.00	40	\$1,000.00	0	\$0.00	\$2,690.00				
0709-201-1323-3 TR-C1	EYA, APRIL S 14 CRESTWOOD DR SAN RAFAEL, CA	310 N Blackhawk Ave	70.50 L.F.	80	\$120.00	80	\$480.00	1	100.00	\$500.00	1	70.50	\$1,410.00	1	\$1,450.00	1	\$1,450.00	1	\$1,450.00	40	\$1,000.00	40	\$1,000.00	0	\$0.00	\$4,960.00				
0709-201-1406-7 TR-C1	DENNISON, KIRSTEN STEPHEN EYNER 311 N BLACKHAWK AVE MADISON WI	311 N Blackhawk Ave	75.00 L.F.	0	\$0.00	80	\$480.00	1	0.00	\$0.00	1	37.00	\$740.00	1	\$1,450.00	1	\$1,450.00	1	\$1,450.00	40	\$1,000.00	40	\$1,000.00	0	\$0.00	\$3,670.00				
0709-201-1324-1 TR-C1	VANDERLOO, JOSHUA F & KAREN W VANDERLOO 314 N BLACKHAWK AVE MADISON WI	314 N Blackhawk Ave	70.50 L.F.	0	\$0.00	80	\$480.00	1	100.00	\$500.00	1	52.00	\$1,040.00	1	\$1,450.00	1	\$1,450.00	1	\$1,450.00	40	\$1,000.00	40	\$1,000.00	0	\$0.00	\$4,470.00				
0709-201-1405-9 TR-C1	FREDRICK, VICKIL 315 N BLACKHAWK AVE MADISON WI	315 N Blackhawk Ave	70.00 L.F.	0	\$0.00	0	\$0.00	1	0.00	\$0.00	1	30.00	\$600.00	1	\$1,450.00	1	\$1,450.00	1	\$1,450.00	40	\$1,000.00	40	\$1,000.00	0	\$0.00	\$3,050.00				
0709-201-1325-9 TR-C1	POST, MARG R 318 N BLACKHAWK AVE MADISON WI	318 N Blackhawk Ave	70.50 L.F.	80	\$120.00	80	\$480.00	1	100.00	\$500.00	1	70.50	\$1,410.00	1	\$1,450.00	1	\$1,450.00	1	\$1,450.00	40	\$1,000.00	40	\$1,000.00	0	\$0.00	\$4,960.00				
0709-201-1404-1 TR-C1	HERNANDEZ, SHAUN V SARA M MISURELLI 319 N BLACKHAWK AVE MADISON WI	319 N Blackhawk Ave	70.00 L.F.	60	\$90.00	60	\$360.00	1	0.00	\$0.00	1	20.00	\$400.00	1	\$1,450.00	1	\$1,450.00	1	\$1,450.00	40	\$1,000.00	40	\$1,000.00	0	\$0.00	\$3,300.00				
0709-201-1326-7 TR-C1	HODGSON, LINDSAY 322 N BLACKHAWK AVE MADISON WI	322 N Blackhawk Ave	60.50 L.F.	0	\$0.00	0	\$0.00	0.5	100.00	\$250.00	0.5	80.00	\$800.00	1	\$1,450.00	1	\$1,450.00	1	\$1,450.00	40	\$1,000.00	40	\$1,000.00	0	\$0.00	\$3,500.00				
0709-201-1403-3 TR-C1	DIETERLE, MICHAEL C & ULRIKE DIETERLE 323 N BLACKHAWK AVE MADISON WI	323 N Blackhawk Ave	75.00 L.F.	0	\$0.00	0	\$0.00	1	0.00	\$0.00	1	20.00	\$400.00	1	\$1,450.00	1	\$1,450.00	1	\$1,450.00	40	\$1,000.00	40	\$1,000.00	0	\$0.00	\$2,850.00				
0709-201-1402-5 TR-C1	CAPITAL CITY CHURCH 401 N BLACKHAWK AVE MADISON WI	401 N Blackhawk Ave	130.94 L.F.	0	\$0.00	0	\$0.00	1	0.00	\$0.00	1	36.00	\$720.00	1	\$1,450.00	1	\$1,450.00	1	\$1,450.00	40	\$1,000.00	40	\$1,000.00	0	\$0.00	\$3,170.00				
0709-201-1210-2 TR-C1	BRULLA, CHRISTOPHER J & COLLEEN M BRULLA 432 N BLACKHAWK AVE MADISON WI	432 N Blackhawk Ave	60.00 L.F.	0	\$0.00	0	\$0.00	0.5	100.00	\$250.00	0.5	30.00	\$300.00	1	\$1,450.00	1	\$1,450.00	1	\$1,450.00	40	\$1,000.00	40	\$1,000.00	0	\$0.00	\$3,000.00				

*A factor has been applied for sidewalk and curb and gutter work adjacent to lots that abut more than one street and are single-family or two-family residential dwellings.

Parcel No./ Zoning	Owner's Name / Mailing Address	Parcel Location	Street Reconstruction Items				Sanitary Sewer Items				Storm Sewer Items		Total Assessment							
			Remove Existing Apron @ LF	Replace Existing Apron @ SF	Remove & Replace Sidewalk @ SF	Remove & Replace Curb and Gutter @ LF	Remove & Replace Sanitary Sewer Lateral @ LF	Remove & Replace Sanitary Sewer Reseal @ Each	Remove & Replace Sanitary Sewer Lateral @ LF	Private Storm Sewer Connection @ Each										
0709-201-1211-0	REYNOLDS, BERNARD T 436 N BLACKHAWK AVE MADISON WI	436 N Blackhawk Ave	70.00 L.F.	65	\$97.50	65	\$930.00	1	100.00	\$500.00	1	100.00	\$500.00	1	\$1,450.00	40	\$1,000.00	0	\$0.00	\$3,937.50
0709-201-1212-8	POSTER, LEONA S 440 N BLACKHAWK AVE MADISON WI	440 N Blackhawk Ave	70.00 L.F.	70	\$105.00	70	\$420.00	1	100.00	\$500.00	1	100.00	\$500.00	1	\$1,450.00	40	\$1,000.00	0	\$0.00	\$4,595.00
0709-201-1213-6	SPRAGUE, MARIE L 444 N BLACKHAWK AVE MADISON WI	444 N Blackhawk Ave	70.00 L.F.	0	\$0.00	0	\$0.00	1	100.00	\$500.00	1	100.00	\$500.00	1	\$1,450.00	40	\$1,000.00	0	\$0.00	\$4,350.00
0709-201-1109-7	BERRET, JEROME C & JOYE L KUEHN 505 N BLACKHAWK AVE MADISON WI	505 N Blackhawk Ave	40.00 L.F.	140	\$210.00	140	\$840.00	0.5	0.00	\$0.00	0.5	20.00	\$200.00	1	\$1,450.00	40	\$1,000.00	0	\$0.00	\$3,700.00
0709-201-1108-9	JENSEN, BETTE L & MARLENE SLETTER 509 N BLACKHAWK AVE MADISON WI	509 N Blackhawk Ave	40.00 L.F.	0	\$0.00	0	\$0.00	1	30.00	\$150.00	0.5	20.00	\$200.00	1	\$1,450.00	40	\$1,000.00	0	\$0.00	\$2,800.00
0709-201-1214-4	MASTERS, JOAN G 510 N BLACKHAWK AVE MADISON WI	510 N Blackhawk Ave	70.00 L.F.	70	\$105.00	70	\$420.00	1	100.00	\$500.00	1	100.00	\$500.00	1	\$1,450.00	40	\$1,000.00	0	\$0.00	\$4,615.00
0709-201-1107-1	513 N BLACKHAWK LLC 7834 BRULE ST MADISON WI	513 N Blackhawk Ave	40.00 L.F.	140	\$210.00	140	\$840.00	0.5	0.00	\$0.00	0.5	20.00	\$200.00	1	\$1,450.00	40	\$1,000.00	0	\$0.00	\$3,700.00
0709-201-1215-2	BARTOLUCCI, THOMAS J 514 N BLACKHAWK AVE MADISON WI	514 N Blackhawk Ave	70.00 L.F.	70	\$105.00	70	\$420.00	1	100.00	\$500.00	1	100.00	\$500.00	1	\$1,450.00	40	\$1,000.00	0	\$0.00	\$4,615.00
0709-201-1106-3	GELYORK, ANNE S 2102 RED AGENCY TRL #1 FITCHBURG WI	517 N Blackhawk Ave	48.70 L.F.	0	\$0.00	0	\$0.00	0.5	0.00	\$0.00	0.5	20.00	\$200.00	1	\$1,450.00	40	\$1,000.00	0	\$0.00	\$2,650.00
0709-201-1216-0	ANDERSON, KYLE SHEAWN ANDERSON 518 N BLACKHAWK AVE MADISON WI	518 N Blackhawk Ave	70.00 L.F.	0	\$0.00	80	\$480.00	1	100.00	\$500.00	1	100.00	\$500.00	1	\$1,450.00	40	\$1,000.00	0	\$0.00	\$4,030.00
0709-201-1105-5	PORTER, BRIANT D SARAHE PORTER 521 N BLACKHAWK AVE MADISON WI	521 N Blackhawk Ave	50.00 L.F.	0	\$0.00	0	\$0.00	0.5	0.00	\$0.00	0.5	27.00	\$270.00	1	\$1,450.00	40	\$1,000.00	0	\$0.00	\$2,720.00
0709-201-1217-8	HANSON, DENISE M 625 CHATHAM TER MADISON WI	522 N Blackhawk Ave	70.00 L.F.	60	\$90.00	60	\$360.00	1	100.00	\$500.00	1	100.00	\$500.00	1	\$1,450.00	40	\$1,000.00	0	\$0.00	\$4,400.00
0709-201-1104-7	ALBUQUERQUE, STEVEN J 525 N BLACKHAWK AVE MADISON WI	525 N Blackhawk Ave	50.00 L.F.	0	\$0.00	0	\$0.00	0.5	0.00	\$0.00	0.5	20.00	\$200.00	1	\$1,450.00	40	\$1,000.00	0	\$0.00	\$2,650.00
0709-201-1103-9	TREDINICK, DAVID F & JENNIFER A TREDINICK 529 N BLACKHAWK AVE MADISON WI	529 N Blackhawk Ave	40.00 L.F.	0	\$0.00	0	\$0.00	0.5	30.00	\$75.00	0.5	20.00	\$200.00	1	\$1,450.00	40	\$1,000.00	0	\$0.00	\$2,725.00
0709-201-1102-1	MILLAR, LAUREN C ANDREW S MILLAR 533 N BLACKHAWK AVE MADISON WI	533 N Blackhawk Ave	40.00 L.F.	80	\$120.00	80	\$480.00	0.5	0.00	\$0.00	0.5	40.00	\$400.00	1	\$1,450.00	40	\$1,000.00	0	\$0.00	\$3,450.00
0709-201-1101-3	HOOPER, MARY W 517 N BLACKHAWK AVE MADISON WI	517 N Blackhawk Ave	40.00 L.F.	0	\$0.00	0	\$0.00	0.5	50.00	\$125.00	0.5	75.00	\$750.00	1	\$1,450.00	40	\$1,000.00	0	\$0.00	\$3,325.00

*A factor has been applied for sidewalk and curb and gutter work adjacent to lots that abut more than one street and are single-family or two-family residential dwellings.

Parcel No./ Zoning	Owner's Name / Mailing Address	Parcel Location	Frontage	Remove Existing Drive Apron @				Replace Drive Apron @				Remove & Replace Sidewalk @				Remove & Replace Curb and Gutter @				Sanitary Sewer Reconnect @				Remove & Replace Sanitary Sewer Lateral @				Storm Sewer Items		Total Assessment
				SF	per SF	Cost	LF	SF	per SF	Cost	Factor	SF	per SF	Cost	Factor	LF	per LF	Cost	Each	Cost	per LF	Cost	Each	Cost	Each	Cost				
0709-201-0903-2 TR-C2	TINBERG, MARK J JOE A TINBERG 601 N BLACKHAWK AVE MADISON WI	601 N Blackhawk Ave	40.00 L.F.	0	\$0.00	0	\$0.00	0.5	0.00	\$0.00	0.5	75.00	\$750.00	1	\$1,450.00	40	\$1,000.00	0	\$0.00	0	\$0.00	0	\$0.00	0	\$0.00	\$3,200.00				
0709-201-0831-7 TR-C1	DUERST, DARRRELL & DEBRA 602 N BLACKHAWK AVE MADISON WI	602 N Blackhawk Ave	100.00 L.F.	0	\$0.00	0	\$0.00	0.5	100.00	\$250.00	0.5	100.00	\$1,000.00	1	\$1,450.00	40	\$1,000.00	0	\$0.00	0	\$0.00	0	\$0.00	0	\$0.00	\$3,700.00				
0709-201-0908-4 TR-C2	MERHEMIC, PHIL 605 N BLACKHAWK AVE MADISON WI	605 N Blackhawk Ave	60.00 L.F.	0	\$0.00	70	\$420.00	1	0.00	\$0.00	1	60.00	\$1,200.00	1	\$1,450.00	40	\$1,000.00	0	\$0.00	0	\$0.00	0	\$0.00	0	\$0.00	\$4,070.00				
0709-201-0832-5 TR-C1	KEAN TR, DAVID & ANDREA 612 N BLACKHAWK AVE MADISON WI	612 N Blackhawk Ave	65.00 L.F.	0	\$0.00	0	\$0.00	1	100.00	\$500.00	1	52.00	\$1,040.00	1	\$1,450.00	40	\$1,000.00	0	\$0.00	0	\$0.00	0	\$0.00	0	\$0.00	\$3,990.00				
0709-201-0907-6 TR-C2	EVERS, STEVEN C 534 S WYDNER DR DANE WI	613 N Blackhawk Ave	100.00 L.F.	130	\$195.00	130	\$780.00	1	0.00	\$0.00	1	100.00	\$2,000.00	1	\$1,450.00	40	\$1,000.00	0	\$0.00	0	\$0.00	0	\$0.00	0	\$0.00	\$5,425.00				
0709-201-0334-1 TR-C1	BARETTE, JORDAN PAUL 620 N BLACKHAWK AVE MADISON WI	620 N Blackhawk Ave	147.00 L.F.	0	\$0.00	120	\$720.00	0.5	100.00	\$250.00	0.5	175.00	\$1,750.00	1	\$1,450.00	40	\$1,000.00	0	\$0.00	0	\$0.00	0	\$0.00	0	\$0.00	\$5,170.00				
0709-201-0908-8 TR-C2	HEFFRON, DANIEL & JILL 6801 ERDMAN BLVD MIDDLETON WI	625 N Blackhawk Ave	80.00 L.F.	180	\$270.00	180	\$1,080.00	1	25.00	\$125.00	1	80.00	\$1,600.00	1	\$1,450.00	40	\$1,000.00	0	\$0.00	0	\$0.00	0	\$0.00	0	\$0.00	\$5,525.00				
0709-201-0905-0 TR-C2	629 NORTH BLACKHAWK AVENUE LLC 5137 SPRING CT MADISON WI	629 N Blackhawk Ave	40.00 L.F.	0	\$0.00	130	\$780.00	1	0.00	\$0.00	1	40.00	\$800.00	1	\$1,450.00	40	\$1,000.00	0	\$0.00	0	\$0.00	0	\$0.00	0	\$0.00	\$4,030.00				
0709-201-0903-4 TR-C2	BEHRENS, BRENT C & KATHRYN BEHRENS 2155 BELGIAN ROAD COLUMBUS OH	637 N Blackhawk Ave	40.00 L.F.	0	\$0.00	130	\$780.00	1	0.00	\$0.00	1	40.00	\$800.00	1	\$1,450.00	40	\$1,000.00	0	\$0.00	0	\$0.00	0	\$0.00	0	\$0.00	\$4,225.00				
0709-201-0902-6 TR-C2	JOHNSON, SIRENA M 641 N BLACKHAWK AVE MADISON WI	641 N Blackhawk Ave	40.00 L.F.	0	\$0.00	0	\$0.00	0.5	0.00	\$0.00	0.5	70.00	\$700.00	1	\$1,450.00	40	\$1,000.00	0	\$0.00	0	\$0.00	0	\$0.00	0	\$0.00	\$3,150.00				
0709-201-0211-1 TR-C2	SHOFF, RICHARD & JOAN 12924 CHANDLER BLVD VAN NUYS CA	701 N Blackhawk Ave	40.00 L.F.	0	\$0.00	0	\$0.00	1	20.00	\$100.00	0.5	90.00	\$900.00	1	\$1,450.00	40	\$1,000.00	0	\$0.00	0	\$0.00	0	\$0.00	0	\$0.00	\$3,450.00				
0709-201-0210-3 TR-C2	DEWITT, MITCHELL KAYLEE DEWITT 707 N BLACKHAWK AVE MADISON WI	707 N Blackhawk Ave	60.00 L.F.	0	\$0.00	180	\$1,080.00	1	0.00	\$0.00	1	60.00	\$1,200.00	1	\$1,450.00	40	\$1,000.00	0	\$0.00	0	\$0.00	0	\$0.00	0	\$0.00	\$4,730.00				
0709-201-0209-6 TR-C2	PAITTONSON, KEVIN J ANDREA L BUISKER 713 N BLACKHAWK AVE MADISON WI	713 N Blackhawk Ave	60.00 L.F.	520	\$780.00	520	\$3,120.00	1	0.00	\$0.00	1	60.00	\$1,200.00	1	\$1,450.00	40	\$1,000.00	0	\$0.00	0	\$0.00	0	\$0.00	0	\$0.00	\$7,550.00				
0709-201-0208-8 TR-C2	BERGSTROM, LEANNE C 717 N BLACKHAWK AVE MADISON WI	717 N Blackhawk Ave	40.00 L.F.	0	\$0.00	500	\$3,000.00	1	0.00	\$0.00	1	40.00	\$800.00	1	\$1,450.00	40	\$1,000.00	0	\$0.00	0	\$0.00	0	\$0.00	0	\$0.00	\$6,250.00				
0709-201-0207-0 TR-C2	DARBER, JACK & ELIZABETH 721 N BLACKHAWK AVE MADISON WI	721 N Blackhawk Ave	40.00 L.F.	0	\$0.00	590	\$3,540.00	1	0.00	\$0.00	1	40.00	\$800.00	1	\$1,450.00	40	\$1,000.00	0	\$0.00	0	\$0.00	0	\$0.00	0	\$0.00	\$6,790.00				
0709-201-0314-3 TR-C1	HORNACEK, STEVE DARGY MCCANN 702 BRUCE CT MADISON WI	702 Bruce Ct	80.90 L.F.	0	\$0.00	0	\$0.00	1	100.00	\$500.00	1	20.00	\$400.00	1	\$1,450.00	40	\$1,000.00	0	\$0.00	0	\$0.00	0	\$0.00	0	\$0.00	\$3,350.00				

*A factor has been applied for sidewalk and curb and gutter work adjacent to lots that abut more than one street and are single-family or two-family residential dwellings.

Parcel No./Zoning	Owner's Name / Mailing Address	Parcel Location	Frontage	Remove Existing		Replace Drive Apron @		Street Reconstruction Items		Remove & Replace		Remove & Replace		Sanitary Sewer Items		Private Storm Sewer Connection		Total Assessment			
				LF	per SF	SF	per SF	Factor	SF	per SF	Factor	LF	per LF	Each	per Each	LF	per LF		Each	Cost	
0709-201-0325-0 TR-C1	NOACK LIVING TRUST 705 BRUCE CT MADISON WI	705 Bruce Ct	65.00 L.F.	90	\$135.00	90	\$540.00	1	100.00	1	\$500.00	1	20.00	\$400.00	1	\$1,450.00	40	\$1,000.00	0	\$0.00	\$4,025.00
0709-201-0315-1 TR-C1	KENT RONALD C & SARA H MARKHAM 706 BRUCE CT MADISON WI	706 Bruce Ct	65.00 L.F.	0	\$0.00	0	\$0.00	1	100.00	1	\$500.00	1	32.00	\$640.00	1	\$1,450.00	40	\$1,000.00	0	\$0.00	\$3,590.00
0709-201-0324-2 TR-C1	TURNER, TIMOTHY S & AMY L TURNER 709 BRUCE CT MADISON WI	709 Bruce Ct	65.00 L.F.	100	\$150.00	100	\$600.00	1	100.00	1	\$500.00	1	20.00	\$400.00	1	\$1,450.00	40	\$1,000.00	0	\$0.00	\$4,100.00
0709-201-0316-9 TR-C1	MOORE, SANDY L 710 BRUCE CT MADISON WI	710 Bruce Ct	65.00 L.F.	180	\$270.00	180	\$1,080.00	1	100.00	1	\$500.00	1	35.00	\$700.00	1	\$1,450.00	40	\$1,000.00	0	\$0.00	\$5,000.00
0709-201-0323-4 TR-C1	SCHMIDT, BENJAMIN J MOLLY A SCHMIDT 713 BRUCE CT MADISON WI	713 Bruce Ct	97.00 L.F.	100	\$150.00	100	\$600.00	1	100.00	1	\$500.00	1	20.00	\$400.00	1	\$1,450.00	40	\$1,000.00	0	\$0.00	\$4,100.00
0709-201-0317-7 TR-C1	HALLVORSON & HOLTZ LIVING TR 716 BRUCE CT MADISON WI	716 Bruce Ct	65.00 L.F.	95	\$142.50	95	\$570.00	1	100.00	1	\$500.00	1	20.00	\$400.00	1	\$1,450.00	40	\$1,000.00	0	\$0.00	\$4,062.50
0709-201-0322-6 TR-C1	GARVEY, EDWARD R ELIZABETH M GARVEY 48 OAK CREEK TRL MADISON WI	717 Bruce Ct	60.00 L.F.	230	\$345.00	230	\$1,380.00	1	100.00	1	\$500.00	1	20.00	\$400.00	1	\$1,450.00	70	\$1,750.00	0	\$0.00	\$5,825.00
0709-201-0318-5 TR-C1	GHAHSTIN, LUCYBERTA B & JUDITH A GHAHSTIN 718 BRUCE CT MADISON WI	718 Bruce Ct	97.00 L.F.	110	\$165.00	110	\$660.00	1	100.00	1	\$500.00	1	40.00	\$800.00	1	\$1,450.00	40	\$1,000.00	0	\$0.00	\$4,575.00
0709-201-0319-3 TR-C1	NICHOLS, KATHEBEN N 722 BRUCE CT MADISON WI	722 Bruce Ct	60.50 L.F.	210	\$315.00	210	\$1,260.00	1	100.00	1	\$500.00	1	40.00	\$800.00	1	\$1,450.00	70	\$1,750.00	0	\$0.00	\$6,075.00
0709-201-0316-9 TR-C2	JEPPERSON, REBECCA GREGGIA 602 Eugenia Ave MADISON WI	602 Eugenia Ave	46.00 L.F.	0	\$0.00	0	\$0.00	0.5	0.00	0.5	\$0.00	0	0.00	\$0.00	0	\$0.00	0	\$0.00	0	\$0.00	\$0.00
0709-201-0601-4 TR-C1	SHANKS, MARC A CHRISTAL SHANKS 3521 HEATHER CREST MADISON WI	3521 Heather Crest	82.00 L.F.	0	\$0.00	0	\$0.00	0.5	225.00	0.5	\$562.50	1	30.00	\$300.00	1	\$1,450.00	40	\$1,000.00	0	\$0.00	\$3,312.50
0709-201-0828-4 TR-C1	MORFON, JIYANA 3522 HEATHER CREST MADISON WI	3522 Heather Crest	70.00 L.F.	110	\$165.00	110	\$660.00	0.5	100.00	0.5	\$250.00	1	\$0.00	\$0.00	1	\$1,450.00	1	\$25.00	0	\$0.00	\$3,050.00
0709-201-0602-2 TR-C1	BHANDI, DEVIN C 3525 HEATHER CREST MADISON WI	3525 Heather Crest	81.00 L.F.	0	\$0.00	0	\$0.00	1	100.00	1	\$500.00	1	30.00	\$600.00	1	\$1,450.00	40	\$1,000.00	0	\$0.00	\$3,550.00
0709-201-0827-6 TR-C1	BESSERT, VIRGINIA K KATHERINE B KIMBER 3510 LUCIA CREST MADISON WI	3526 Heather Crest	60.00 L.F.	0	\$0.00	0	\$0.00	1	120.00	1	\$600.00	1	25.00	\$500.00	1	\$1,450.00	40	\$1,000.00	0	\$0.00	\$3,550.00
0709-201-0603-0 TR-C1	MEISSEN, THOMAS C MARGAN E WALSH 3529 HEATHER CREST MADISON WI	3529 Heather Crest	65.00 L.F.	0	\$0.00	0	\$0.00	1	100.00	1	\$500.00	1	20.00	\$400.00	1	\$1,450.00	40	\$1,000.00	0	\$0.00	\$3,550.00
0709-201-0828-4 TR-C1	DRIEY, JESSIE R KARIN M DRIEY 3526 HEATHER CREST MADISON WI	3530 Heather Crest	60.00 L.F.	0	\$0.00	0	\$0.00	1	100.00	1	\$500.00	1	32.00	\$640.00	1	\$1,450.00	40	\$1,000.00	0	\$0.00	\$3,590.00

*A factor has been applied for sidewalk and curb and gutter work adjacent to lots that abut more than one street and are single-family or two-family residential dwellings.

Parcel No./ Zoning	Owner's Name / Mailing Address	Parcel Location	Frontage	Remove Existing Drive Apron @				Replace Drive Apron @				Remove & Replace Sidewalk @				Remove & Replace Curb and Gutter @				Sanitary Sewer Reconnect @				Remove & Replace Sanitary Sewer Lateral @				Storm Sewer Items		Total Assessment
				\$1.50 per SF	\$6.00 per SF	\$6.00 per SF	\$6.00 per SF	Factor	\$5.00 per SF	Factor	\$20.00 per LF	Factor	\$1,450.00 per Each	Each	\$225.00 per LF	Factor	\$1,000.00 per LF	Each	\$2,000.00 per Each	Each	Cost	Cost								
0709-201-0604-8 TR-C1	JOCHIMSEN, ERIC J KATE J JOCHIMSEN 3533 HEATHER CREST MADISON WI	3533 Heather Crest	70.00 L.F.	120	\$180.00	120	\$720.00	1	100.00	\$500.00	1	40.00	\$800.00	1	\$1,450.00	1	\$1,450.00	40	\$1,000.00	0	\$0.00	\$4,650.00								
0709-201-0825-0 TR-C1	ABELLO, MADJORIE R 3534 HEATHER CREST MADISON WI	3534 Heather Crest	60.00 L.F.	120	\$180.00	120	\$720.00	1	100.00	\$800.00	1	41.00	\$820.00	1	\$1,450.00	1	\$1,450.00	40	\$1,000.00	0	\$0.00	\$4,670.00								
0709-201-0605-6 TR-C1	LIU, MAY 3537 HEATHER CREST MADISON WI	3537 Heather Crest	64.50 L.F.	120	\$180.00	120	\$720.00	1	100.00	\$500.00	1	30.00	\$600.00	1	\$1,450.00	1	\$1,450.00	40	\$1,000.00	0	\$0.00	\$4,450.00								
0709-201-0824-2 TR-C1	STROCK, BRADLEY R 3538 HEATHER CREST MADISON WI	3538 Heather Crest	60.00 L.F.	100	\$150.00	100	\$600.00	1	100.00	\$500.00	1	27.00	\$540.00	1	\$1,450.00	1	\$1,450.00	40	\$1,000.00	0	\$0.00	\$4,240.00								
0709-201-0606-4 TR-C1	WALSH, CHRISTOPHER A 3541 HEATHER CREST MADISON WI	3541 Heather Crest	60.00 L.F.	0	\$0.00	0	\$0.00	1	100.00	\$800.00	1	30.00	\$600.00	1	\$1,450.00	1	\$1,450.00	40	\$1,000.00	0	\$0.00	\$3,550.00								
0709-201-0823-4 TR-C1	HUSLT, NATHAN C 3542 HEATHER CREST MADISON WI	3542 Heather Crest	60.00 L.F.	0	\$0.00	140	\$840.00	1	100.00	\$500.00	1	32.00	\$640.00	1	\$1,450.00	1	\$1,450.00	40	\$1,000.00	0	\$0.00	\$4,430.00								
0709-201-0607-2 TR-C1	EVANS, NATALIE MICHAEL EVANS 3545 HEATHER CREST MADISON WI	3545 Heather Crest	60.00 L.F.	110	\$165.00	110	\$660.00	1	100.00	\$500.00	1	32.00	\$640.00	1	\$1,450.00	1	\$1,450.00	40	\$1,000.00	0	\$0.00	\$4,415.00								
0709-201-0822-6 TR-C1	BREUNIG, DANIEL V THERESA BREUNIG 3546 HEATHER CREST MADISON WI	3546 Heather Crest	70.00 L.F.	110	\$165.00	110	\$660.00	1	100.00	\$800.00	1	33.00	\$660.00	1	\$1,450.00	1	\$1,450.00	40	\$1,000.00	0	\$0.00	\$4,435.00								
0709-201-0608-0 TR-C1	HARTMAN, JEFFREY A APT 805 3450 N LAKE SHORE DR CHICAGO IL	3549 Heather Crest	73.80 L.F.	110	\$165.00	110	\$660.00	1	100.00	\$900.00	1	38.00	\$1,160.00	1	\$1,450.00	1	\$1,450.00	40	\$1,000.00	0	\$0.00	\$4,935.00								
0709-201-0821-8 TR-C1	SHANNON, WARREN A KATRYNA MONIKA SHANNON 3553 HEATHER CREST MADISON WI	3550 Heather Crest	100.00 L.F.	110	\$165.00	110	\$660.00	1	100.00	\$500.00	1	82.00	\$1,640.00	1	\$1,450.00	1	\$1,450.00	40	\$1,000.00	0	\$0.00	\$5,415.00								
0709-201-0609-8 TR-C1	RATHEN, LOGAN P KELLY N DANNER 3553 HEATHER CREST MADISON WI	3553 Heather Crest	86.30 L.F.	100	\$150.00	100	\$600.00	0.5	220.00	\$550.00	0.5	95.00	\$950.00	1	\$1,450.00	1	\$1,450.00	1	\$25.00	0	\$0.00	\$3,725.00								
0709-201-0820-0 TR-C1	EVA, APRIL S 14 CRESTWOOD DR SAN RAFAEL CA	3554 Heather Crest	90.00 L.F.	0	\$0.00	0	\$0.00	0.5	225.00	\$562.50	0.5	50.00	\$500.00	1	\$1,450.00	1	\$1,450.00	40	\$1,000.00	0	\$0.00	\$3,512.50								
0709-201-0801-0 TR-C1	SEBRAMK, JOSHUA J 347 RIVIERA ST OREGON WI	3501 Lucia Crest	90.00 L.F.	0	\$0.00	0	\$0.00	0.5	250.00	\$625.00	0.5	80.00	\$800.00	1	\$1,450.00	1	\$1,450.00	1	\$25.00	0	\$0.00	\$2,900.00								
0709-201-0327-6 TR-C1	ANDERSSON, INGRID & HANNU ANDERSSON 3510 LUCIA CREST MADISON WI	3530 Lucia Crest	64.75 L.F.	0	\$0.00	0	\$0.00	1	0.00	\$0.00	1	0.00	\$0.00	0	\$0.00	0	\$0.00	0	\$0.00	0	\$0.00	\$0.00								
0709-201-0326-8 TR-C1	KANE, SEAN P 3534 LUCIA CREST MADISON WI	3534 Lucia Crest	82.50 L.F.	110	\$165.00	110	\$660.00	0.5	100.00	\$250.00	0.5	32.00	\$320.00	1	\$1,450.00	1	\$1,450.00	70	\$1,750.00	0	\$0.00	\$4,595.00								
0709-201-0313-5 TR-C1	GOETZ TRUST, STEVEN SCOTT & CATHRYN R GOETZ TRUST 3540 LUCIA CREST MADISON WI	3540 Lucia Crest	104.50 L.F.	0	\$0.00	0	\$0.00	1	0.00	\$0.00	1	12.00	\$240.00	0	\$0.00	0	\$0.00	0	\$0.00	0	\$0.00	\$240.00								

Project Name: N. Blackhawk Avenue, Bruce Court, and Heather Crest Resurfacing With Utilities Assessment District - 2018
 Project Limit: University to 150' S of Bluff; Bruce Ct; N Meadow to N Owen
 11743

*A factor has been applied for sidewalk and curb and gutter work adjacent to lots that abut more than one street and are single-family or two-family residential dwellings.

Parcel No./ Zoning	Owner's Name / Mailing Address	Parcel Location	Frontage		Street Reconstruction Items										Sanitary Sewer Items				Storm Sewer Items		Total Assessment
			LF	SF	Remove Existing Drive Apron @ per SF Cost	Replace Drive Apron @ per SF Cost	Factor	Remove & Replace Sizable @ per SF Cost	Factor	Remove & Replace Curb and Gutter @ per LF Cost	Factor	Sanitary Sewer Reconnect @ per Each Cost	Remove & Replace Sanitary Sewer Lateral @ per LF Cost	Private Storm Sewer Connection @ Each Cost	Each	Each					
0709-201-1201-1 TR-C1	STOUT, JOSEPH D & KHELLEY M STOUT 517 N OWEN DR MADISON WI	517 N Owen Dr	120.00 L.F.	0	\$0.00	\$0.00	0.5	275.00	0.5	20.00	\$200.00	1	\$1,450.00	40	\$1,000.00	0	\$0.00	\$3,437.50			
0709-201-1110-4 TR-C2	RIBBAREN, LEONEL & NORMA 3418 STEVENS ST MADISON WI	3418 Stevens St	207.80 L.F.	0	\$0.00	\$0.00	0.5	0.00	0.5	20.00	\$200.00	1	\$1,450.00	40	\$1,000.00	0	\$0.00	\$2,650.00			
0709-201-1401-2 TR-C1	THEISEN-FAMM, Y 2017 TRUST 3417 STEVENS ST MADISON WI	3417 Stevens St	60.58 L.F.	0	\$0.00	\$0.00	0.5	0.00	0.5	25.00	\$250.00	1	\$1,450.00	40	\$1,000.00	0	\$0.00	\$2,700.00			
0709-201-1201-2 CC-1	SCHMIED, WILLIAM D & ANNE SCHMIED 721 BRABER SMOKE RD MADISON WI	3401 University Ave	198.58 L.F.	320	\$480.00	\$1,320.00	1	150.00	1	100.00	\$2,000.00	1	\$1,450.00	80	\$2,000.00	0	\$0.00	\$8,600.00			
0709-201-1035-9 CC-1	GENNIN PROPERTIES LLC 3505 UNIVERSITY AVE MADISON WI	3505 University Ave	140.96 L.F.	600	\$900.00	\$3,600.00	1	300.00	1	140.00	\$2,800.00	1	\$1,450.00	80	\$2,000.00	1	\$2,000.00	\$14,250.00			
0709-201-1037-5 CC-1	WELTON-FAMM, Y LTD PARTSHIP 3525 UNIVERSITY AVE STB 109 702 N BLACKHAWK AVE MADISON WI	3525 University Ave	78.08 L.F.	320	\$480.00	\$1,920.00	1	325.00	1	20.00	\$4,000.00	2	\$2,900.00	80	\$2,000.00	1	\$2,000.00	\$14,925.00			
TOTALS			5690	5690	\$8,535.00	7880	\$47,280.00	6645	\$28,537.50	4028.5	\$87,140.00	85	\$123,280.00	3453	\$88,325.00	2	\$4,000.00	\$365,087.50			