

City of Madison Landmarks Commission

APPLICATION



City of Madison Planning Division, 126 S Hamilton Street, P.O. Box 2985, Madison, WI 53701-2985

1. LOCATION

Project Address: 115 N. SPOONER ST. Aldermanic District:

2. PROJECT

Project Title / Description: WINDOW REPLACEMENT ON 2ND STORY 3-SEASON PORCH

This is an application for: (check all that apply)

- Alteration / Addition to a Designated Landmark
Land Division/Combination of Designated Landmark site
Alteration / Addition to a building adjacent to a Designated Landmark
[X] Alteration / Addition to a building in a Local Historic District (specify):
Mansion Hill Third Lake Ridge First Settlement
University Heights Marquette Bungalows
Land Division/Combination in a Local Historic District (specify):
Mansion Hill Third Lake Ridge First Settlement
University Heights Marquette Bungalows
New Construction in a Local Historic District (specify):
Mansion Hill Third Lake Ridge First Settlement
University Heights Marquette Bungalows
Demolition
Variance from the Historic Preservation Ordinance (Chapter 41)
Referral from Common Council, Plan Commission, or other referral
Landmark Nomination/Rescission or Historic District Nomination/Amendment
Other (specify):

PLANNING DIVISION USE ONLY
Registrar #

3. APPLICANT

Applicant's Name: Tony Trapp Company: TONY TRAPP REMODELING & REPAIRS, LLC
Address: 222 N. Midvale Blvd, Madison WI 53705
Telephone: 608-235-8982 E-mail: Tony@TonyTrappLLC.com

Property Owner (if not applicant): JIM RAYMO
Address: 115 N. Spooner St Madison WI 53726

Property Owner's Signature: [Signature] Date: 4/12/17

NOTICE REGARDING LOBBYING ORDINANCE: If you are seeking approval of a development that has over 40,000 square feet of non-residential space, or a residential development of over 10 dwelling units, or if you are seeking assistance from the City with a value of \$10,000 (including grants, loans, TIF or similar assistance), then you likely are subject to Madison's lobbying ordinance (Sec. 2.40, MGO). You are required to register and report your lobbying. Please consult the City Clerk's Office for more information. Failure to comply with the lobbying ordinance may result in fines.

4. APPLICATION SUBMISSION REQUIREMENTS (see checklist on reverse)

All applications must be filed by 4:30 p.m. on the submission date with the Preservation Planner, the Department of Planning & Community & Economic Development, Planning Division, located at 126 S Hamilton Street. Applications submitted after the submittal date or incomplete applications will be postponed to the next scheduled filing time.



---

www.tonytrapplc.com

tony@tonytrapplc.com

---

City of Madison Landmarks Commission  
City of Madison Planning Division  
126 S. Hamilton Street PO Box 2985  
Madison, WI 53701

4/14/17

**Letter of Intent: 115 N. Spooner St**

Dear Landmarks Commission,

Tony Trapp Remodeling & Repairs, LLC is submitting this Letter of Intent in regards to the single family residence located at 115 N. Spooner St. in the University Heights Historic District. We are writing on behalf of the home owner Jim Raymo.

We are asking for approval to replace (4) original single pane divided light wood storm windows on a 2<sup>nd</sup> story, unheated 3-season porch. These would be replaced with custom sized Marvin wood casement or awning insert windows with simulated divided lights that closely match the original divided light storm windows. Please refer to the attached elevation drawings, photos, and window specifications.

**Reason for work:**

- Mr. Raymo would like to replace the windows so that he does not have to switch out the wood storms for screens each season and has operating windows throughout the year for the 3-season porch

**Project Scope of Work/Notes:**

- Remove (2) original storm windows on the east side and (2) original storm windows on the west side of the 2<sup>nd</sup> story unheated 3- season porch and replace them with new Marvin wood casement or awning insert windows. Custom sized insert windows will closely match the size of the original storm windows and allow the original window frames/jambes to remain intact.
- The removed storm windows will be saved and stored on site
- The new windows will have a simulated mid-rail and simulated divided lights with a black spacer bar and are sized to closely match the original storm window divided lights.
- The new windows will have wood exteriors and will be painted to match the existing window color.
- The original windows that face north toward Hoyt St. are to remain in place.

Thank you very much for your consideration and we look forward to your reply.

Sincerely,

Tony Trapp

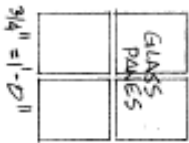

EAST & WEST SASHES  
GLASS = 8" x 9 3/16"  
MULLIONS = 3/4" (2)

NORTH FRANKING UNITS  
GLASS = 7" x 9 7/16"

UPPER GLASS IN CIRCLE PORTION  
= 8 1/2" x 12 1/2"

LOWER GLASS IN CENTER UNIT  
= 8 1/2" x 10"

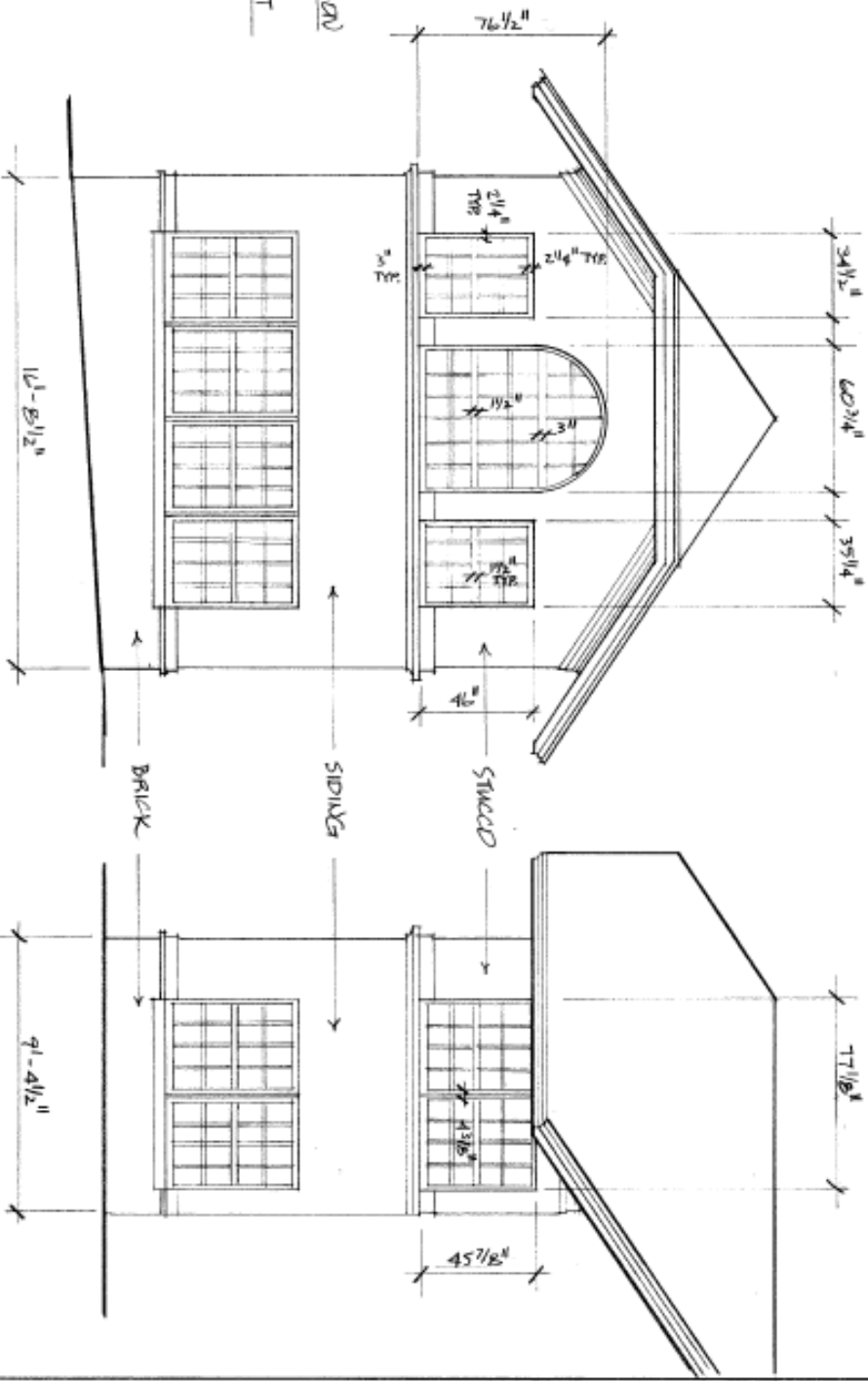

EAST ELEVATION 1 1/4" = 1'-0"  
(MIRROR IMAGE OF WEST ELEV.)

NORTH ELEVATION 1 1/4" = 1'-0"  
(HOT ST.)

WEST ELEVATION 1 1/4" = 1'-0"  
(SPANNER ST.)

EXISTING CONDITIONS 115 N. SPANNER ST.

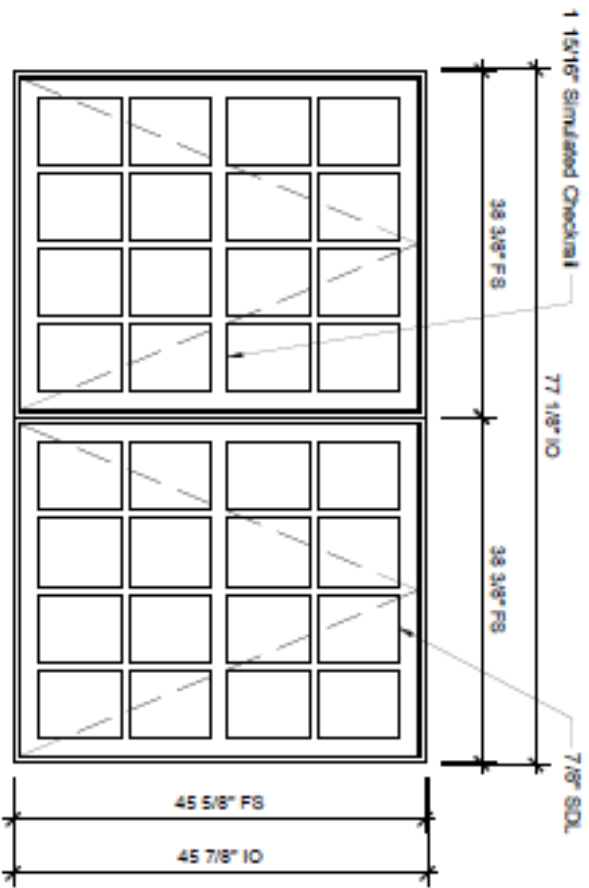

Head

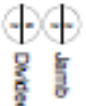

Jamb



Divided Lite



Vertical Muntin



Simulated Checkrail

### 2-WIDE AWNING

SCALE: 3/4" = 1'-0"

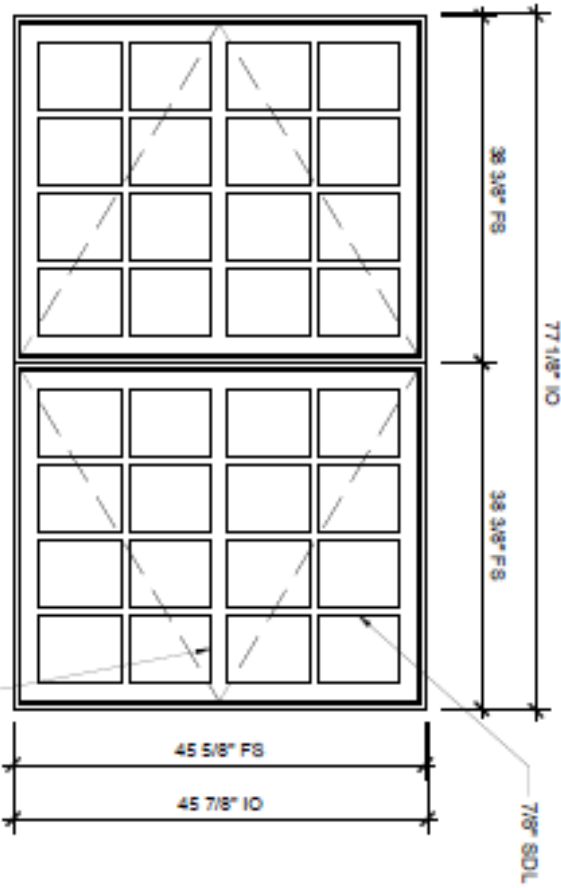

Head

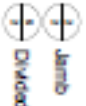

Jamb



Divided Lite



Vertical Muntin



Simulated Checkrail

### 2-WIDE CASEMENT

SCALE: 3/4" = 1'-0"

		<p>           O/P # : 17-07505            DRAWN: Jason            SCALE: 3/4" = 1'-0"            DATE: 4/8/17         </p>	<p>           Tony Trapp            Operator Windows            Marvin Wood         </p>
--	--	--	--

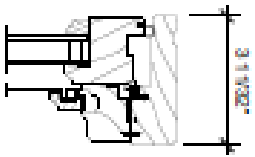

1 Head  
2 SCALE: 3" = 1'-0"

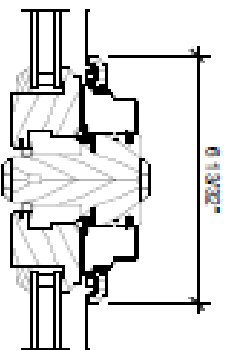

3 Vertical Mullion  
2 SCALE: 3" = 1'-0"

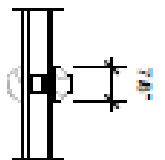

5 Divided Lite  
2 SCALE: 3" = 1'-0"

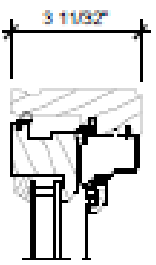

2 Jamb  
2 SCALE: 3" = 1'-0"

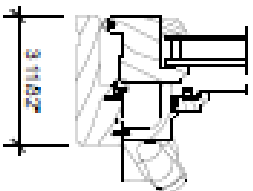

4 Sill  
2 SCALE: 3" = 1'-0"

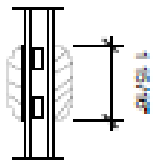

6 Simulated Checkrail  
2 SCALE: 3" = 1'-0"

Built around you.

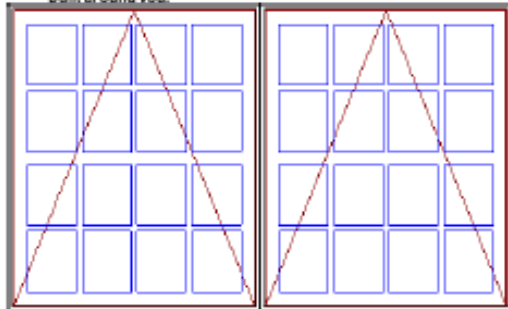

As Viewed From The Exterior

Entered As: IO  
FS 76 3/4" X 45 5/8"  
IO 77 1/8" X 45 7/8"

Primed Pine Exterior .....  
Primed Pine Interior .....  
2W1H - Rectangle Assembly  
Assembly Inside Opening  
77 1/8" X 45 7/8"  
Assembly Frame Size  
76 3/4" X 45 5/8"

Unit: A1 .....  
Wood Ultimate Replacement Awning - Roto Operating  
Basic Frame 38 3/8" X 45 5/8"  
Inside Opening 38 3/4" X 45 7/8"  
0 Degree Frame Bevel  
Primed Pine Sash Exterior  
Primed Pine Sash Interior  
IG  
Low E2 w/Argon  
Black Perimeter and Spacer Bar .....  
1 15/16" Simulated Rail Rectangular .....  
Standard 1.0:2.0  
7/8" SDL - With Spacer Bar - Black  
Top Cut 4W2H - Bottom Cut 4W2H  
16 Rect Lites  
Primed Pine Ext - Primed Pine Int  
Ogee Interior Glazing Profile  
Standard Bottom Rail  
Beige Weather Strip  
Oil Rubbed Bronze Folding Handle .....  
Oil Rubbed Bronze Multi - Point Lock  
Interior Wood Screen .....  
Charcoal Hi-Transparency Fbrgl's Mesh  
Primed Pine  
Ogee Interior Screen Profile  
\*\*\*Screen/Combo Ship Loose

Unit: A2 .....  
Wood Ultimate Replacement Awning - Roto Operating  
Basic Frame 38 3/8" X 45 5/8"  
Inside Opening 38 3/4" X 45 7/8"  
0 Degree Frame Bevel  
Primed Pine Sash Exterior  
Primed Pine Sash Interior  
IG  
Low E2 w/Argon  
Black Perimeter and Spacer Bar .....  
1 15/16" Simulated Rail Rectangular .....  
Standard 1.0:2.0  
7/8" SDL - With Spacer Bar - Black  
Top Cut 4W2H - Bottom Cut 4W2H  
16 Rect Lites  
Primed Pine Ext - Primed Pine Int  
Ogee Interior Glazing Profile  
Standard Bottom Rail  
Beige Weather Strip  
Oil Rubbed Bronze Folding Handle .....  
Oil Rubbed Bronze Multi - Point Lock  
Interior Wood Screen .....  
Charcoal Hi-Transparency Fbrgl's Mesh  
Primed Pine  
Ogee Interior Screen Profile  
\*\*\*Screen/Combo Ship Loose  
Primed Pine Exterior Mull Cover





Built around you!

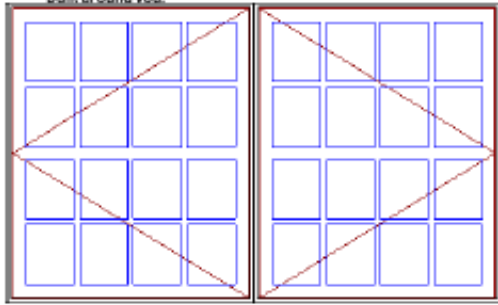

As Viewed From The Exterior

Entered As: IO  
FS 76 3/4" X 45 5/8"  
IO 77 1/8" X 45 7/8"

Primed Pine Exterior .....  
Primed Pine Interior .....  
2W1H - Rectangle Assembly  
Assembly Inside Opening  
77 1/8" X 45 7/8"  
Assembly Frame Size  
76 3/4" X 45 5/8"

Unit: A1 .....  
Wood Ultimate Replacement Casement - Left Hand  
Basic Frame 38 3/8" X 45 5/8"  
Inside Opening 38 3/4" X 45 7/8"  
0 Degree Frame Bevel  
Primed Pine Sash Exterior  
Primed Pine Sash Interior  
IG  
Low E2 w/Argon  
Black Perimeter and Spacer Bar .....  
1 15/16" Simulated Rail Rectangular .....  
Standard 1.0:2.0  
7/8" SDL - With Spacer Bar - Black  
Top Cut 4W2H - Bottom Cut 4W2H  
16 Rect Lites  
Primed Pine Ext - Primed Pine Int  
Ogee Interior Glazing Profile  
Standard Bottom Rail  
Beige Weather Strip  
Oil Rubbed Bronze Folding Handle .....  
Oil Rubbed Bronze Multi - Point Lock  
Interior Wood Screen .....  
Charcoal Hi-Transparency Fbrgl's Mesh  
Primed Pine  
Ogee Interior Screen Profile  
\*\*\*Screen/Combo Ship Loose

Unit: A2 .....  
Wood Ultimate Replacement Casement - Right Hand  
Basic Frame 38 3/8" X 45 5/8"  
Inside Opening 38 3/4" X 45 7/8"  
0 Degree Frame Bevel  
Primed Pine Sash Exterior  
Primed Pine Sash Interior  
IG  
Low E2 w/Argon  
Black Perimeter and Spacer Bar .....  
1 15/16" Simulated Rail Rectangular .....  
Standard 1.0:2.0  
7/8" SDL - With Spacer Bar - Black  
Top Cut 4W2H - Bottom Cut 4W2H  
16 Rect Lites  
Primed Pine Ext - Primed Pine Int  
Ogee Interior Glazing Profile  
Standard Bottom Rail  
Beige Weather Strip  
Oil Rubbed Bronze Folding Handle .....  
Oil Rubbed Bronze Multi - Point Lock  
Interior Wood Screen .....  
Charcoal Hi-Transparency Fbrgl's Mesh  
Primed Pine  
Ogee Interior Screen Profile  
\*\*\*Screen/Combo Ship Loose  
Primed Pine Exterior Mull Cover





Existing context view from Hoyt St





West side existing context viewed from Spooner St





West side upper porch windows to be replaced



East side upper porch windows to be replaced





East side lower porch windows (These windows are not being replaced and will remain as is)



West side lower porch windows (These windows are not being replaced and will remain as is)