

Application for Change of Licensed Premise

No Fee Required. Due at 12 Noon two weeks before ALRC meeting.

Applicants must appear before the ALRC. Detailed floor plans (no larger than 8 1/2 x 14) must accompany this form, or request will not be presented to the committee.

Please contact City Zoning (Municipal Building LL-100, 266-4560). A Conditional Use Permit may be required. There is a fee for the Conditional Use Permit.

Corporate/Owner Name WHISKEY RIVER LLC
 DBA REV. JIM'S Roadhouse
 Address 6402 MILIFORD RD
 Agent Kevin J. Weaver
 Capacity 180 % Alcohol 70 % Food 30

Description of Expansion Plans:

See attached sheet

Signature of Applicant [Signature] Date 5-30-08

To be considered at ALRC meeting of June 18, 2008

and Common Council Meeting of _____
 License Type CLASB COMBO License # _____ Registrar # 10742

Approved _____ Disapproved _____

Routed: City Zoning
 Building Inspection Unit - Permit Counter
 Madison Police Department
 Administrator _____

10742

**ATTACHMENT TO APPLICATION FOR CHANGE
OF LICENSED PREMISES
Whiskey River, LLC
6402 Millpond Road
Madison, Wisconsin**

The expanded licensed premises would include a portion of the parking lot as set forth in the attached drawing. This expansion area would only be used for specific events and/or dates during the course of the year, including the following (please note that event names and dates may vary from year-to-year and rain dates may be necessary):

1. All University of Wisconsin Football home games for tailgate parties;
2. Annual Thunder Run event – July 12, 2008 (typically held on the second Saturday of July);
3. Annual Women In Motion Riding for a Cause ASMI fundraiser – July 19, 2008 (typically held on the third Saturday of July);
4. Band Camp event pre- and post-party – July 26 and 27, 2008 (typically held during the last weekend of July or first weekend of August);
5. Annual Harley Davidson Anniversary Ride / Kick-Off to Milwaukee party – July 31, 2008 (typically held during the last week of July or first week of August);
6. Joe Murino Fundraiser Benefit – August 30, 2008;
7. Rev. Jim's Roadhouse "Bike Night" events typically held on Fridays from May through October (weather permitting).

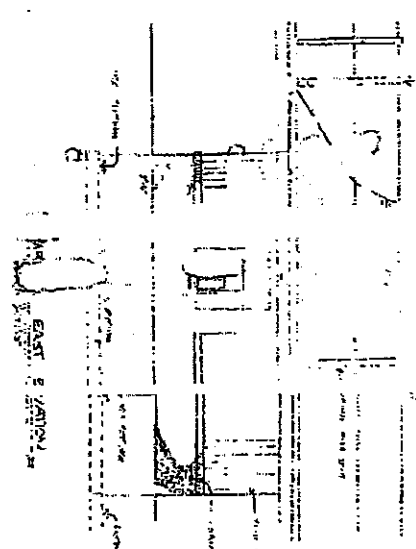
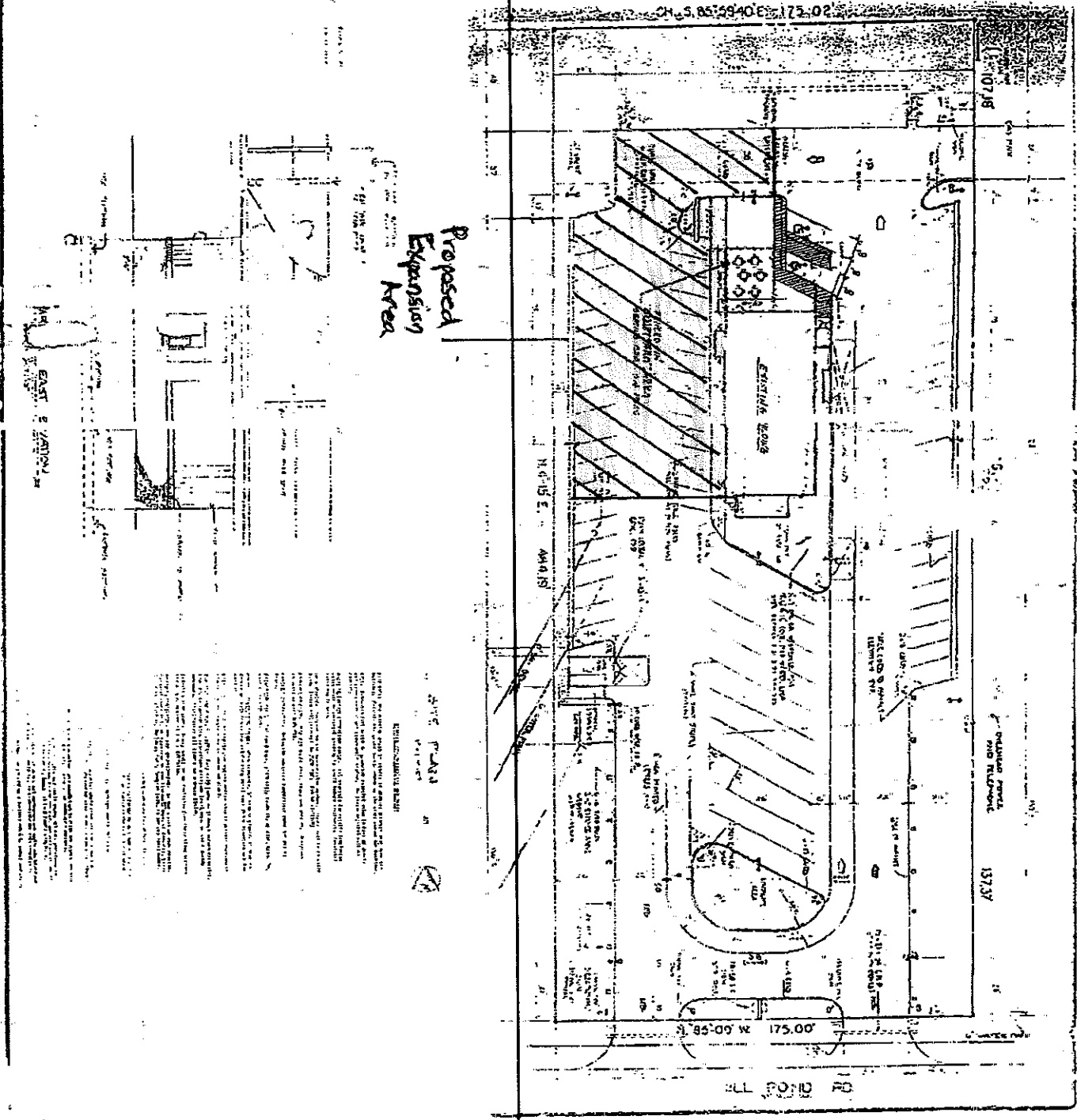

Proposed
Expansion
Area

EXPLANATION OF SYMBOLS

ALL DIMENSIONS ARE IN FEET AND DECIMALS THEREOF UNLESS OTHERWISE SPECIFIED.

ALL DIMENSIONS ARE TO FACE UNLESS OTHERWISE SPECIFIED.

ALL DIMENSIONS ARE TO CENTERLINE UNLESS OTHERWISE SPECIFIED.

ALL DIMENSIONS ARE TO SURFACE UNLESS OTHERWISE SPECIFIED.

ALL DIMENSIONS ARE TO CENTERLINE OF CURVE UNLESS OTHERWISE SPECIFIED.

ALL DIMENSIONS ARE TO CENTERLINE OF ROAD UNLESS OTHERWISE SPECIFIED.

ALL DIMENSIONS ARE TO CENTERLINE OF RAILROAD UNLESS OTHERWISE SPECIFIED.

ALL DIMENSIONS ARE TO CENTERLINE OF CANAL UNLESS OTHERWISE SPECIFIED.

ALL DIMENSIONS ARE TO CENTERLINE OF DRAINAGE CANAL UNLESS OTHERWISE SPECIFIED.

ALL DIMENSIONS ARE TO CENTERLINE OF UTILITY LINE UNLESS OTHERWISE SPECIFIED.

ALL DIMENSIONS ARE TO CENTERLINE OF POWER LINE UNLESS OTHERWISE SPECIFIED.

ALL DIMENSIONS ARE TO CENTERLINE OF TELEPHONE LINE UNLESS OTHERWISE SPECIFIED.

ALL DIMENSIONS ARE TO CENTERLINE OF GAS LINE UNLESS OTHERWISE SPECIFIED.

ALL DIMENSIONS ARE TO CENTERLINE OF WATER MAIN UNLESS OTHERWISE SPECIFIED.

ALL DIMENSIONS ARE TO CENTERLINE OF SEWER MAIN UNLESS OTHERWISE SPECIFIED.

ALL DIMENSIONS ARE TO CENTERLINE OF STORM SEWER UNLESS OTHERWISE SPECIFIED.

ALL DIMENSIONS ARE TO CENTERLINE OF EGRESS ROUTE UNLESS OTHERWISE SPECIFIED.

ALL DIMENSIONS ARE TO CENTERLINE OF FIRE ROUTE UNLESS OTHERWISE SPECIFIED.

ALL DIMENSIONS ARE TO CENTERLINE OF TRUCK ROUTE UNLESS OTHERWISE SPECIFIED.

ALL DIMENSIONS ARE TO CENTERLINE OF PEDESTRIAN ROUTE UNLESS OTHERWISE SPECIFIED.

ALL DIMENSIONS ARE TO CENTERLINE OF BIKE ROUTE UNLESS OTHERWISE SPECIFIED.

ALL DIMENSIONS ARE TO CENTERLINE OF HORSE ROUTE UNLESS OTHERWISE SPECIFIED.

ALL DIMENSIONS ARE TO CENTERLINE OF CART ROUTE UNLESS OTHERWISE SPECIFIED.

ALL DIMENSIONS ARE TO CENTERLINE OF WHEELBARROW ROUTE UNLESS OTHERWISE SPECIFIED.

ALL DIMENSIONS ARE TO CENTERLINE OF SHOVEL ROUTE UNLESS OTHERWISE SPECIFIED.

ALL DIMENSIONS ARE TO CENTERLINE OF PICKAXE ROUTE UNLESS OTHERWISE SPECIFIED.

ALL DIMENSIONS ARE TO CENTERLINE OF SHovel ROUTE UNLESS OTHERWISE SPECIFIED.

ALL DIMENSIONS ARE TO CENTERLINE OF PICKAXE ROUTE UNLESS OTHERWISE SPECIFIED.

DATE: 06/03/08
PROJECT: HILL POND RD

<p>PROJECT:</p> <p>OWNER:</p> <p>DATE:</p> <p>SCALE:</p>	<p>OWNER:</p> <p>DATE:</p> <p>SCALE:</p>	<p>T & C SERVICES</p> <p>2525 UNIVERSITY BLVD</p> <p>WISCONSIN 53706</p> <p>TEL: (608) 741-0229</p> <p>FAX: (608) 741-0229</p>	<p>DATE:</p> <p>SCALE:</p>
--	--	--	----------------------------