

# WEST BADGER ROAD

# PERRY STREET

NOTE: THE RIGHT OF WAY IS THE SOLE JURISDICTION OF THE CITY OF MADISON AND IS SUBJECT TO CHANGE AT ANY TIME PER THE RECOMMENDED PLAN BY TRAFFIC ENGINEERING AND CITY ENGINEERING DEPARTMENT

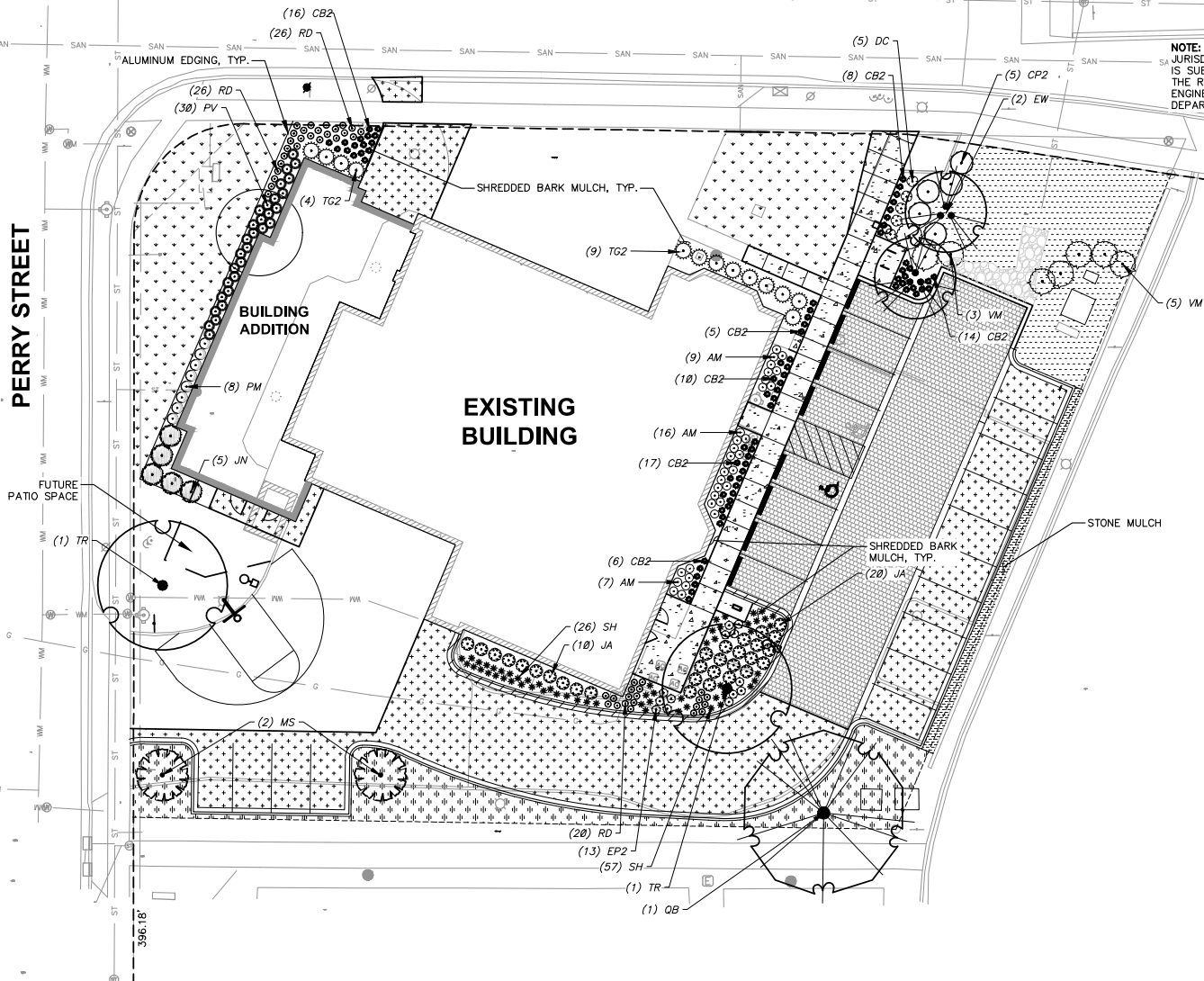

SCALE IN FEET



# L100

## MADISON FIRE STATION 6 REMODEL - LANDSCAPE PLAN

OCTOBER 6, 2021





1 NORTH ELEVATION  
1/16" = 1'-0"



2 WEST ELEVATION  
1/16" = 1'-0"



1 SOUTH ELEVATION  
1/16" = 1'-0"



2 EAST ELEVATION  
1/16" = 1'-0"