

City of Madison - S. High Point Rd Ext  
(Raymond Rd to Mid Town Plat Limit)  
Local Street  
Dane County  
Single Lane Roundabout with Two-Way Left Turn Lane

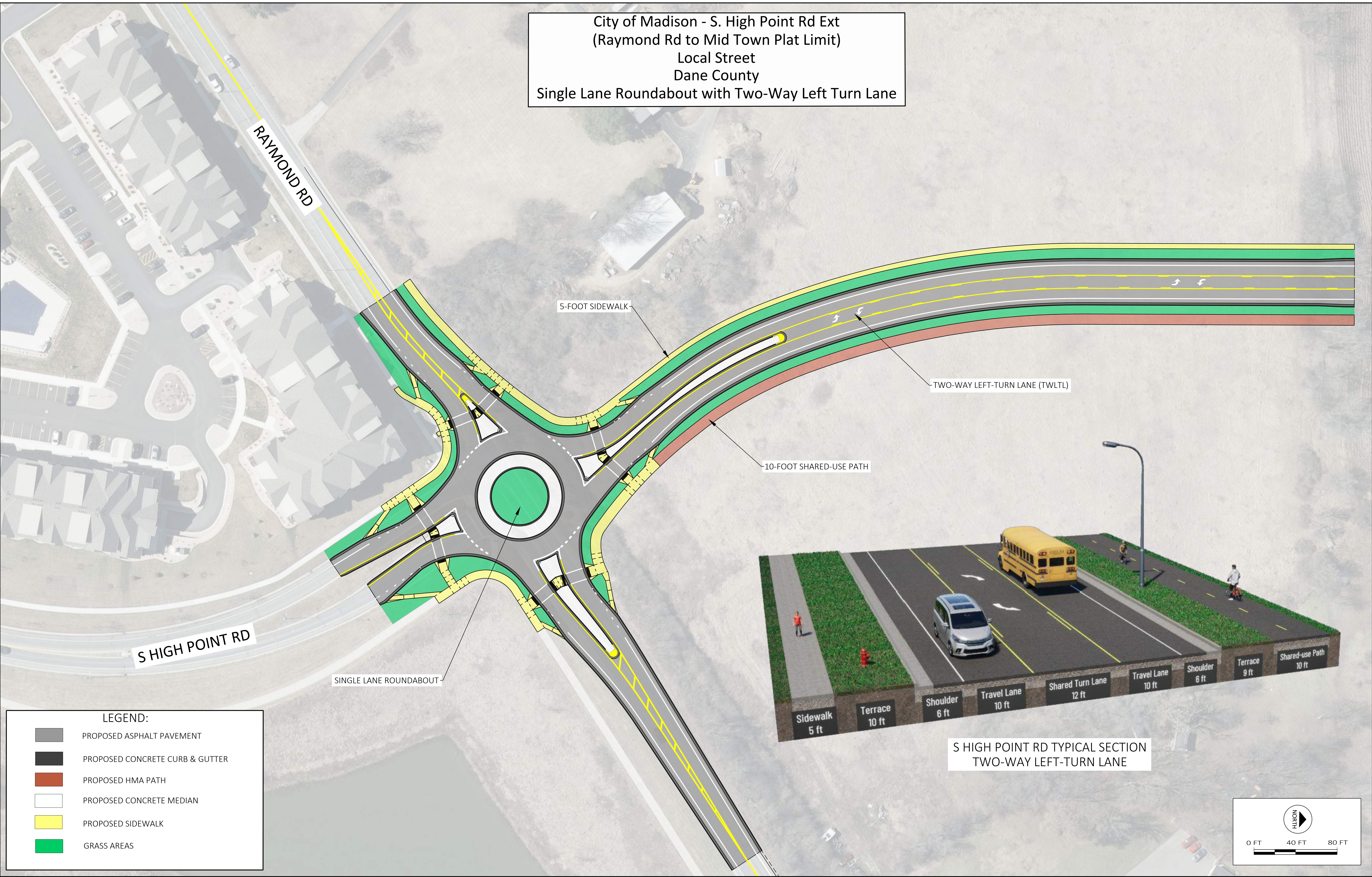

LEGEND:

- PROPOSED ASPHALT PAVEMENT
- PROPOSED CONCRETE CURB & GUTTER
- PROPOSED HMA PATH
- PROPOSED CONCRETE MEDIAN
- PROPOSED SIDEWALK
- GRASS AREAS

S HIGH POINT RD TYPICAL SECTION  
TWO-WAY LEFT-TURN LANE

