

MAILING AFFIDAVIT

DARWIN ROAD SIDEWALK ASSESSMENT DISTRICT - 2010

I, Kathleen Rideout, being duly sworn on oath, acting on behalf of the City Clerk, deposes and says that she did on the 21st day of MAY, 2010 place in envelopes, addressed to each interested owner of respective addresses indicated per attached, Assessment Notices and delivered the envelopes to the Mail Room of the Dane County Printing and Services Division for postage and depositing in the United States Mail.

Kathleen Rideout
SIGNATURE

Subscribed and sworn to me this 21ST day of MAY, 2010

JANET A PIEN Janet A. Pien
Notary Public, State of Wisconsin

My Commission Expires: 2/23/2014

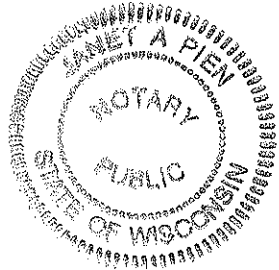

10/10/10



Department of Public Works
City Engineering Division

608 266 4751

Robert F. Phillips, P.E.
City Engineer

City-County Building, Room 115
210 Martin Luther King, Jr. Boulevard
Madison, Wisconsin 53703
608 264 9275 FAX
1 866 704 2315 Textnet

Principal Engineers
Michael R. Dailey, P.E.
Christina M. Bachmann, P.E.
John S. Fahrney, P.E.
Gregory T. Fries, P.E.
Facilities & Sustainability
Jeanne E. Hoffman, Manager
James C. Whitney, A.I.A.
Operations Manager
Kathleen M. Cryan
GIS Manager
David A. Davis, R.L.S.
Financial Officer
Steven B. Danner-Rivers
Hydrogeologist
Brynn Bemis

May 21, 2010

To: Property owners along Darwin Road

Re: Public Hearing before Board of Public Works (**REVISED ASSESSMENT HEARING**)
June 2, 2010 6:30 P.M. - Parks Conference Room, Room 108, City County Building
210 Martin Luther King Jr. Blvd.
Madison, WI

You are being sent this letter to notify you of the *revised schedule of assessments* for properties on Darwin Road. The project will involve sidewalk installed at 100% property owner cost. Attached to this letter is a revised Schedule of Assessments, which shows revised estimated costs for each property adjacent to the project.

The attached Schedule of Assessments shows a breakdown of costs for each sidewalk construction item and the total estimated cost to be assessed to each adjacent property owner. Please contact Eric Dundee, the Project Engineer, at 266-4913, with any questions regarding the street reconstruction.

Temporary Construction Easements/Retaining Walls

Temporary construction easements or retaining walls will be required for this project. The property owner has the option of either granting a temporary construction grading permit or having a split block retaining wall installed. A copy of the temporary construction grading permit is attached for reference. If a split block retaining wall is chosen by the property owner, the estimate assessment for the retaining wall is \$50.00 per face foot of retaining wall installed. Please contact Eric Dundee, the Project Engineer, at 266-4913, with any questions regarding the owner options for this portion of the project. If no contact is made by June 11, 2010, it will be assumed the property owner would like a split block retaining wall.

Special Assessments - General

A special assessment is a special charge for work that the City is planning to complete. The attached Schedule of Assessments shows an *estimate* of the property owners' share of the project costs based upon the City's assessment policy. After the project is bid, and work is complete, a final assessment will be calculated based on bid prices and work actually performed. The final assessment, which will be billed after the completion of the project, is payable in one lump sum or over a period of 8 years, with 3.5% interest charged on the unpaid balance.

Accommodation Requests

To request accommodations for special needs or disabilities or if you have any other questions regarding this project, please contact the Project Engineer, Eric Dundee at edundee@cityofmadison.com or 266-4913. This includes requests relating to the Public Hearing and also requests relating to the actual operations of construction.

Sincerely,

Robert F. Phillips, P.E., City Engineer

RFP:eld
cc:

Ald Satya Rhodes-Conway
Drew Beck, Madison Metro
Matt Mikolajewski, Planning
Dane County 911

Christy Bachmann
Ed Ruckriegel, Fire Dept
Al Schumacher, Streets

Marla Eddy, City Forestry
Cindy Mierow, Police Dept
Dan McCormick, Traffic Eng

**NOTICE OF PUBLIC HEARING
BEFORE THE BOARD OF PUBLIC WORKS
FOR
PLANS, SPECIFICATIONS, AND SPECIAL ASSESSMENTS
FOR
PUBLIC WORKS IMPROVEMENTS
MADISON, WISCONSIN**

PART I

The Common Council of the City of Madison, Wisconsin, having heretofore decided that it is expedient and necessary that the improvements as listed in Part II hereof be improved at the expense of the property thereby on which would be conferred some special benefit.

NOW, THEREFORE, NOTICE IS HEREBY GIVEN:

That the City Engineer has prepared plans, specifications, a proposed schedule of assessments, and an estimate of the entire costs of the improvement for each of the districts listed in Part II hereof, and;

That the plans, specifications, a proposed schedule of assessments, and an estimate of the entire cost of the improvements listed hereto are available and open to inspection by all interested persons in the office of the City Engineer, Room 115, City-County Building, 210 Martin Luther King Jr. Blvd., between the hours of 7:30 a.m. and 4:00 p.m., Monday through Friday, and will so continue to be for ten (10) working days from the first published date of this notice, and;

That on WEDNESDAY, JUNE 2, 2010, AT 6:30 P.M., the Board of Public Works will hold a public hearing in ROOM 108 (PARKS CONFERENCE ROOM) OF THE CITY COUNTY BUILDING, and will consider any objections that may be filed in writing or in person and hear all persons desiring to be heard, and;

That special assessments may be paid over an eight (8) year period or fifteen (15) year period, with the owner paying 1/8 or 1/15 of the principal each year plus three and a half (3.5%) percent interest on the unpaid balance, as determined by the Board of Public Works.

That if the total assessment is paid in full before October 31st in the year that the billing is made, irrespective of project completion, then no interest shall be charged.

The City's TDD number is (866)-704-2315

If you require an interpreter, materials in alternate formats, or other accommodations to access this public hearing, please contact the Engineering Division at phone (608) 266-4751. Please make contact at least 24 hours prior to the date of this public hearing so that we can make proper accommodations.

PART II

DARWIN ROAD SIDEWALK ASSESSMENT DISTRICT - 2010

By Order of the Board of Public Works
Madison, Wisconsin

PUB: WSJ MAY 21, 2010

City of Madison Engineering Division - Schedule of Assessments

May 4, 2010
REVISED MAY 17, 2010Project ID:
53W0968Project Name: Darwin Street Sidewalk Assessment District - 2010
Project Limits: Packers Ave. to Canadian Pacific Railroad

Frontages Listed are for Street Shown				Assessment Items				TOTAL ASSM'T
Parcel No./ Zoning	Owner's Name / Mailing Address	Parcel Location	Frontage LF	Split Block Retaining Wall @ \$50.00 per FF		Sidewalk @ \$7.00 per SF		
				SF	Cost	SF	Cost	
0810-304-0099-9 M1	TIEDEMAN'S LLC 10900 N CRESTLINE RD MEQUON WI	2101 Darwin Rd	344.24	400.00	\$20,000.00	1721.20	\$12048.40	\$32,048.40
0810-304-0092-3 M1	RICE ASSOCIATES PO BOX 8685 MADISON WI	2201 Darwin Rd	211.49	340.00	\$17,000.00	1057.45	\$7402.15	\$24,402.15
0810-304-0085-8 M1	RICE ASSOCIATES PO BOX 8685 MADISON WI	2223 Darwin Rd	248.44	230.00	\$11,500.00	1242.20	\$8695.40	\$20,195.40
TOTAL				970.00	\$48,500.00	4,020.85	\$28,145.95	\$76,645.95

CONSTRUCTION AND GRADING PERMIT

Date of Permit _____

Approximate Start Date of Work August 23, 2010

Project Name Darwin Road Sidewalk Assessment District - 2010

City of Madison Project No. 53W0968

The undersigned being the owner or designated representative for the property described as parcel number(s): _____, Madison, Wisconsin, in consideration of the work to be performed, do hereby grant the City of Madison (the City) and its authorized agents permission to enter upon our property with equipment and material required for the purposes of construction and grading for sidewalk construction.

Grading is required on the subject property to match the proposed sidewalk elevation to the existing topography. Disturbed areas will be restored with topsoil, seed, fertilizer and mulch. The area for entry will be confined to the area deemed necessary to complete the work. The attached Construction Plan illustrates the estimated area needed to complete the work. Prior approval by the owner shall be required if deviation from these limits as shown on the attached drawing shall become necessary.

Construction equipment storage and material staging and temporary facilities shall not be allowed on the area unless prior authorization is granted by the owner.

Any grading improvements whether temporary or permanent required that impact improvements completed by the owner and not accepted by the City shall be approved by the owner prior to improvements being made.

This permit shall terminate upon the earlier of completion of the work or at 12:00 a.m. on December 31, 2010.

Property Owner: _____

Name and Title

Date

Signature

Phone Number

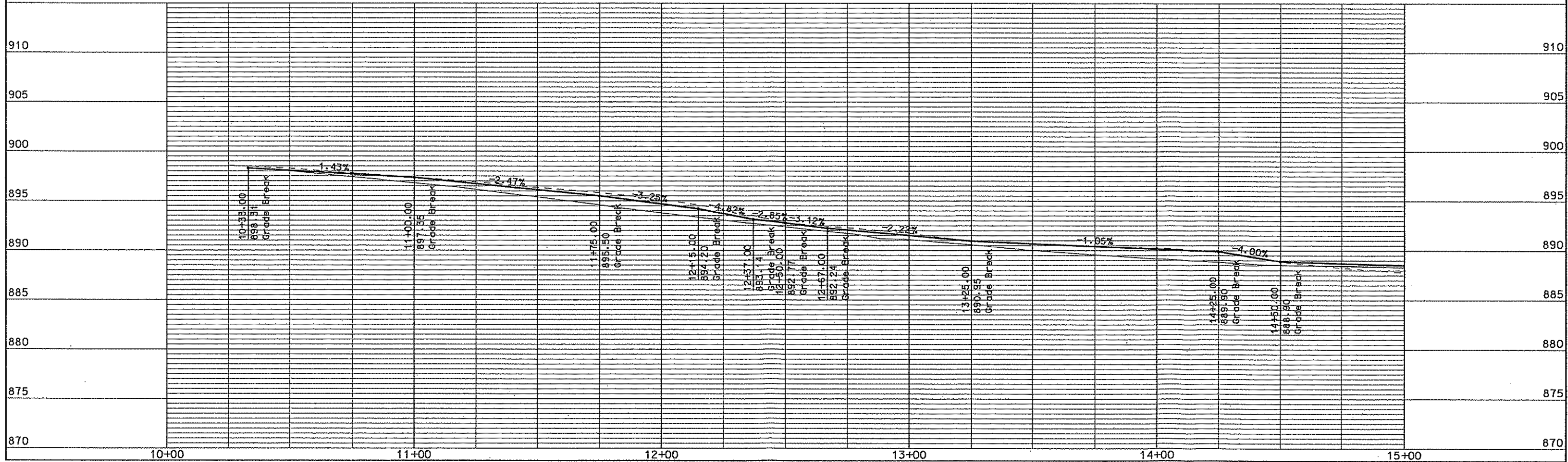
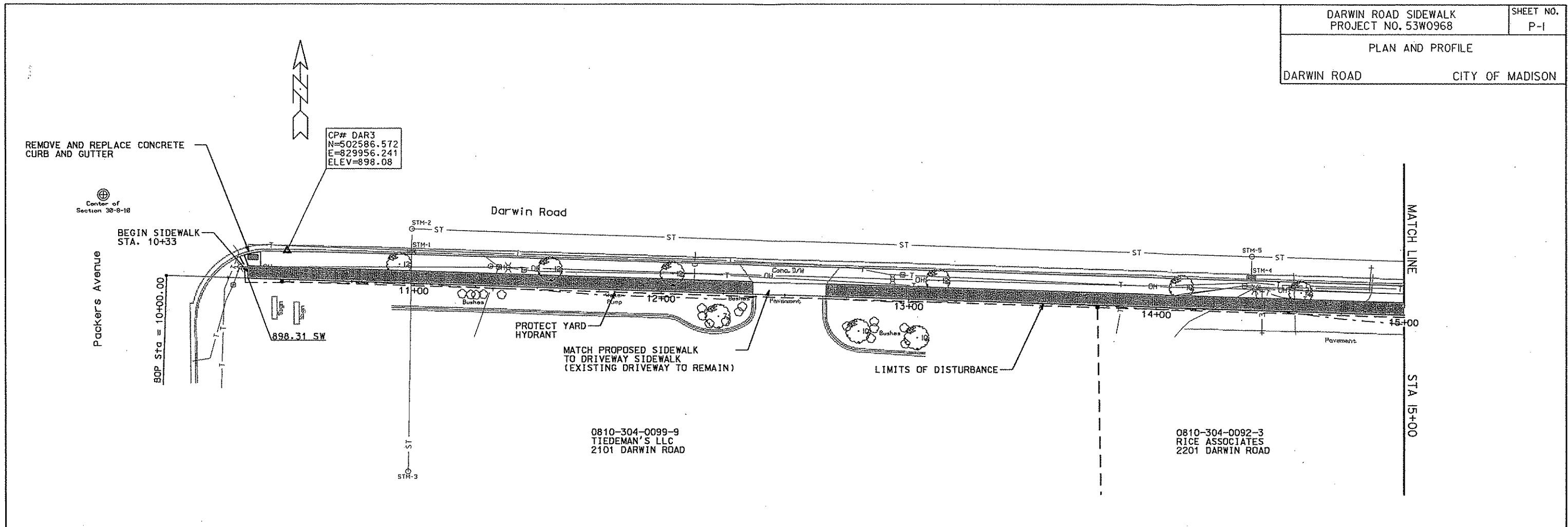

PLOT SCALE:
 PLOT NAME:
 REV. DATE:
 ORIGINATOR: CITY OF MADISON, STREETS DIVISION

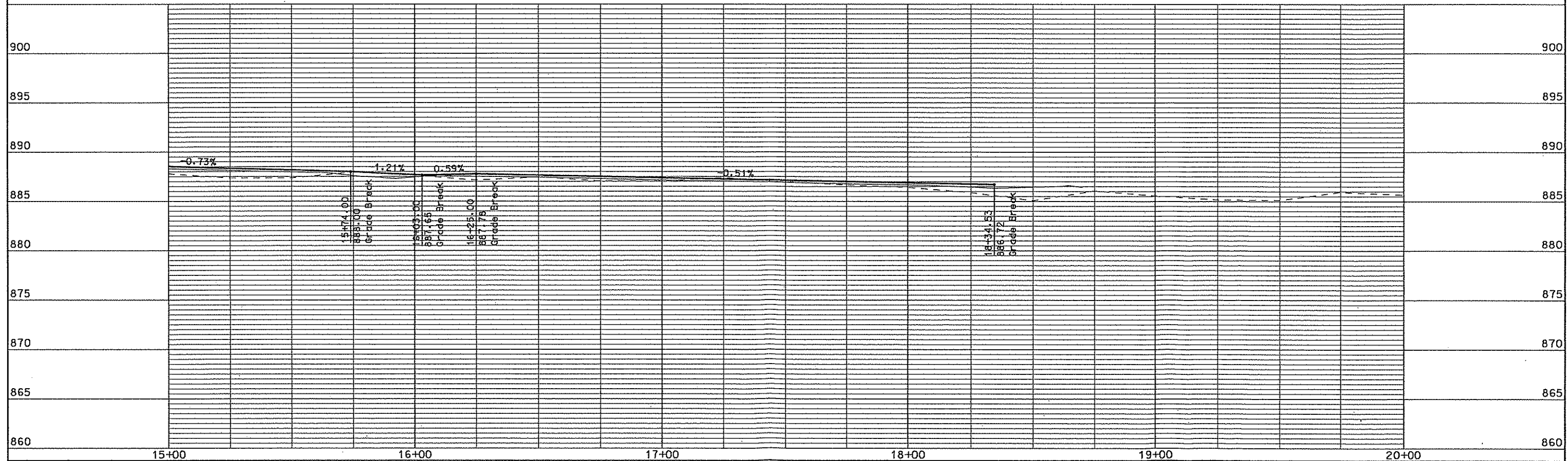
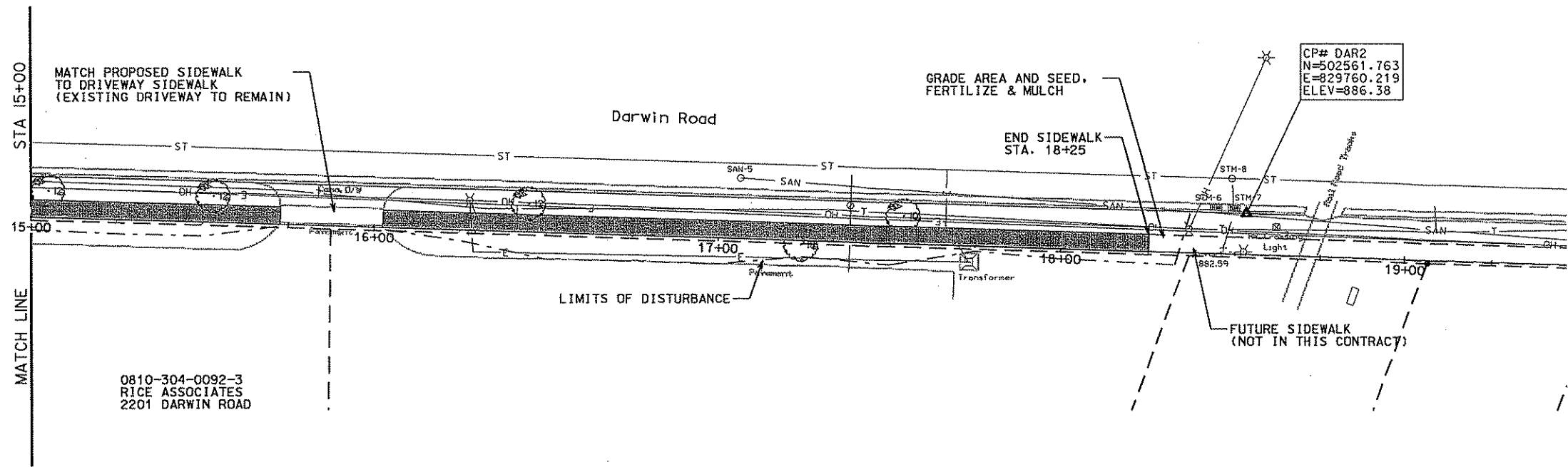

PLOT SCALE:

PLOT NAME:

REV. DATE:

