

WARNER PARK PARKING LOT DESIGN PHASING PLAN

PHASE 1 FALL/WINTER 2010

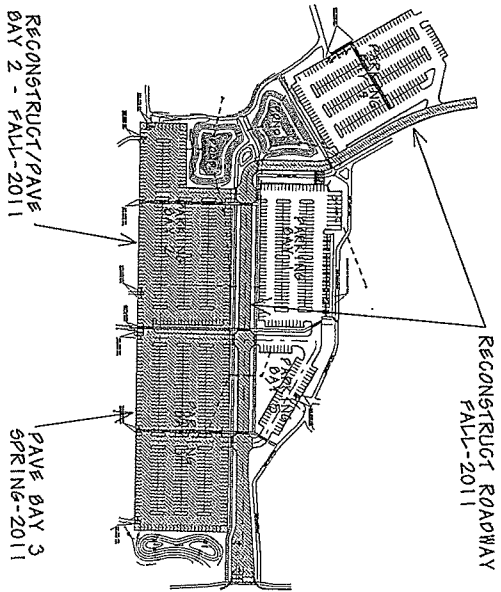

PHASE 2 SPRING/FALL 2011

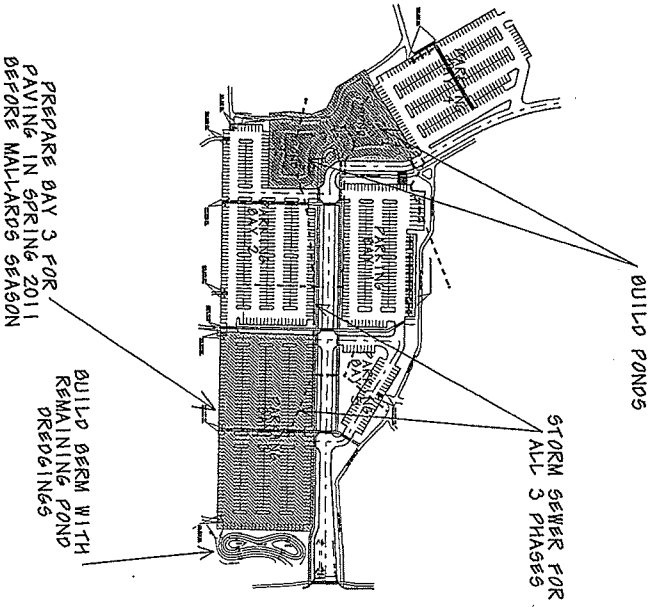
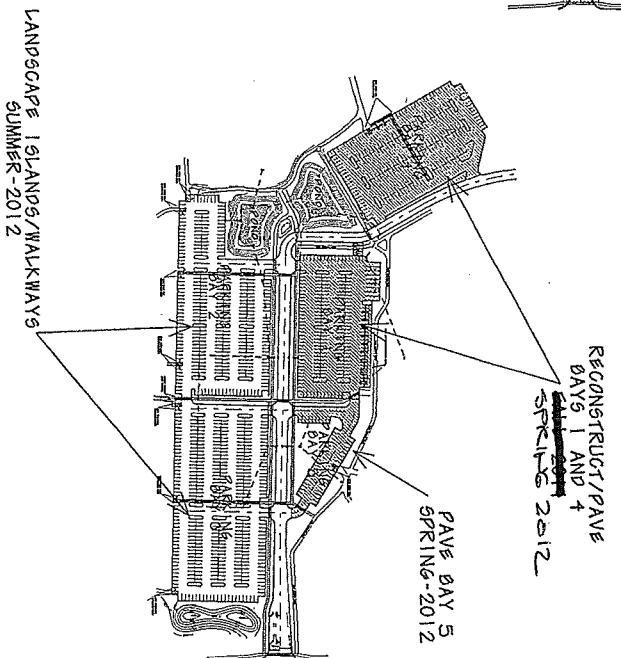

PHASE 3 SPRING 2012

WARNER PARK PARKING LOT RE-DESIGN PHASE 3 EROSION CONTROL PLAN

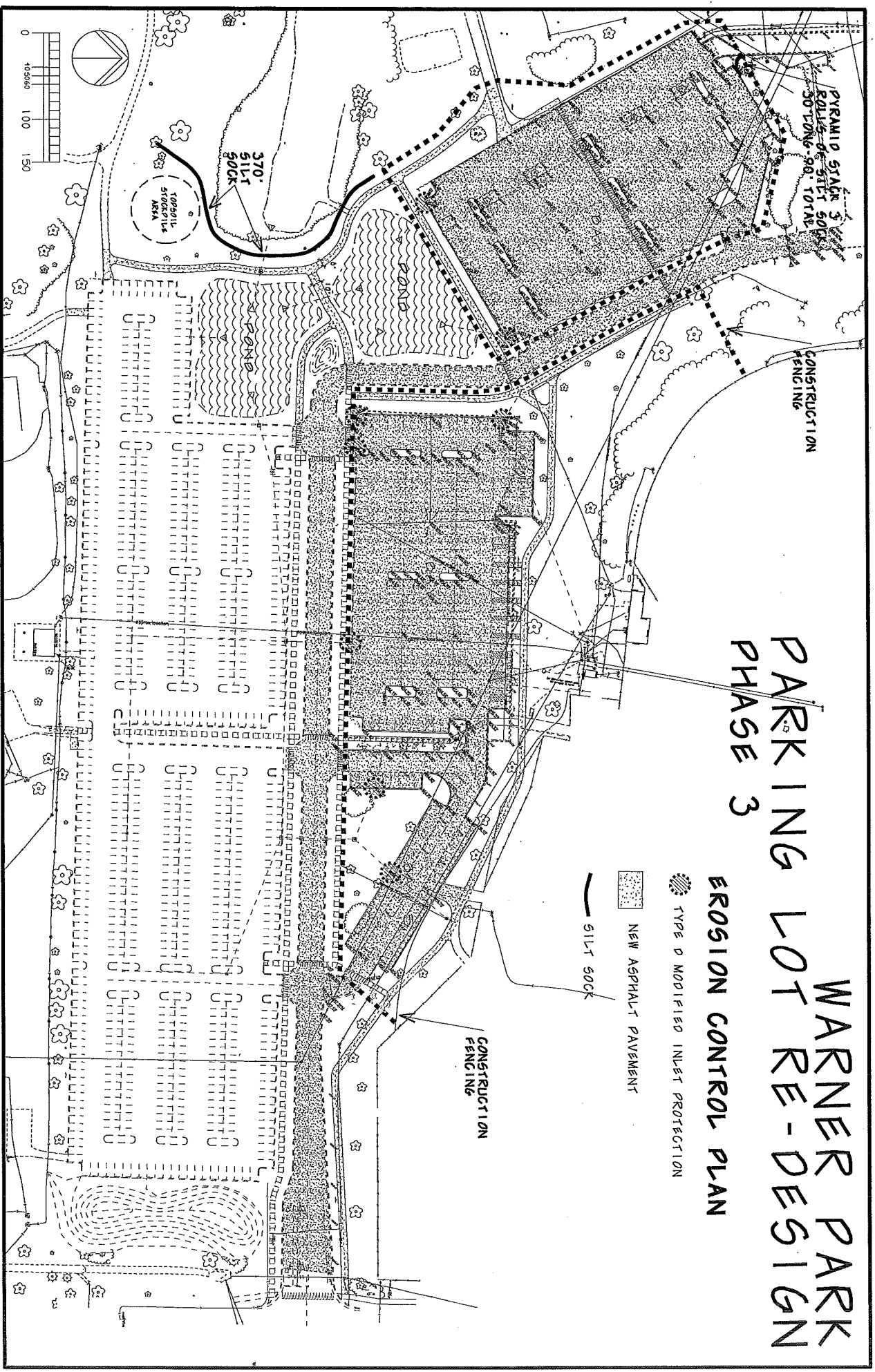

NEW ASPHALT PAVEMENT

TYPE D MODIFIED INLET PROTECTION

SILT SOCK

CONSTRUCTION FENCING



CONSTRUCTION FENCING

0 100 150

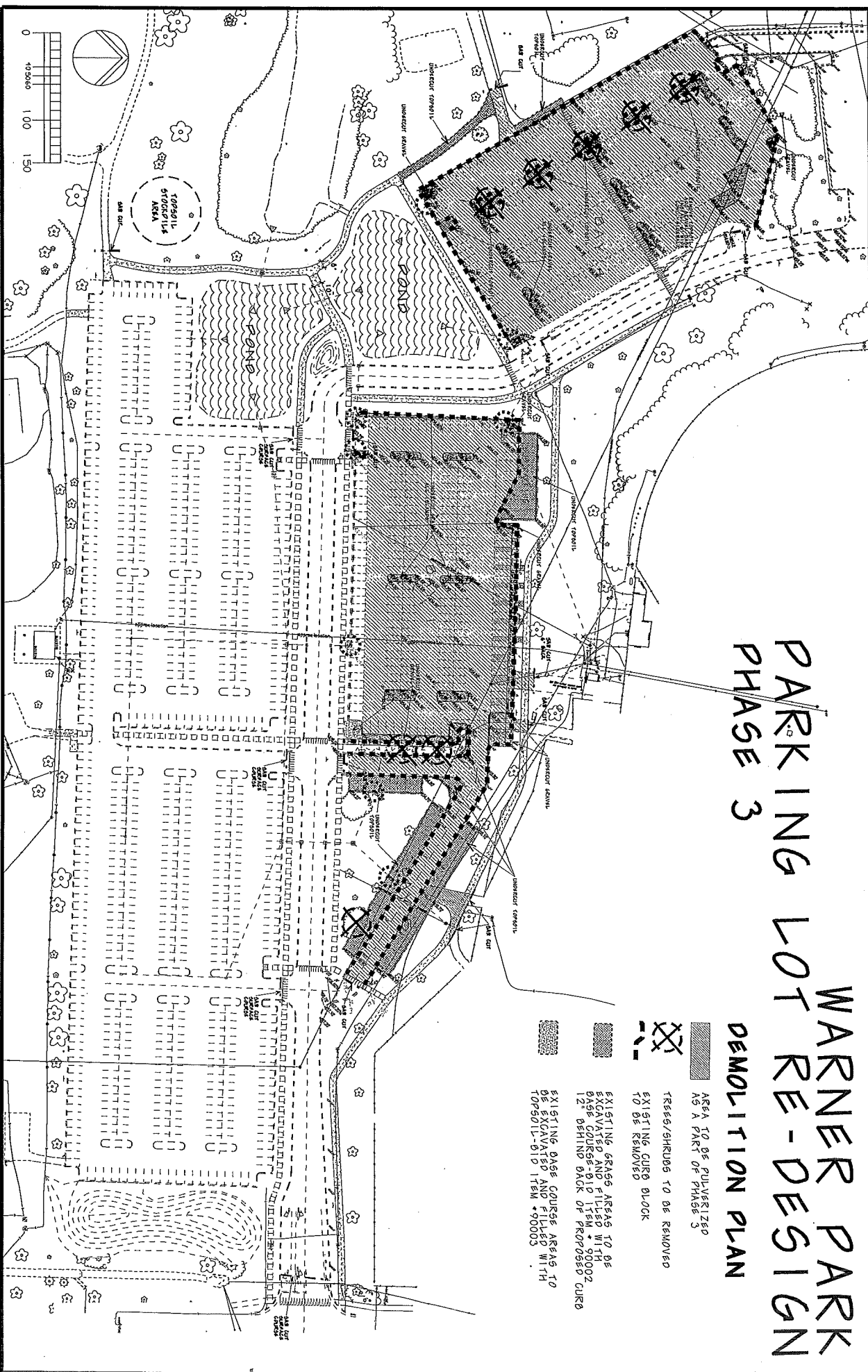

WARNER PARK PARKING LOT RE-DESIGN PHASE 3 DEMOLITION PLAN

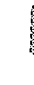
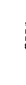

-  AREA TO BE PULVERIZED AS A PART OF PHASE 3
-  TREES/SHRUBS TO BE REMOVED TO BE REMOVED
-  EXISTING GRASS AREAS TO BE EXCAVATED AND FILLED WITH 12" BEHIND BACK OF PROPOSED CURB
-  EXISTING GRASS COURSE AREAS TO BE EXCAVATED AND FILLED WITH TOPSOIL-DIV ITEM #90003

WARNER PARK PARKING LOT RE-DESIGN PHASE 3 GRADING PLAN

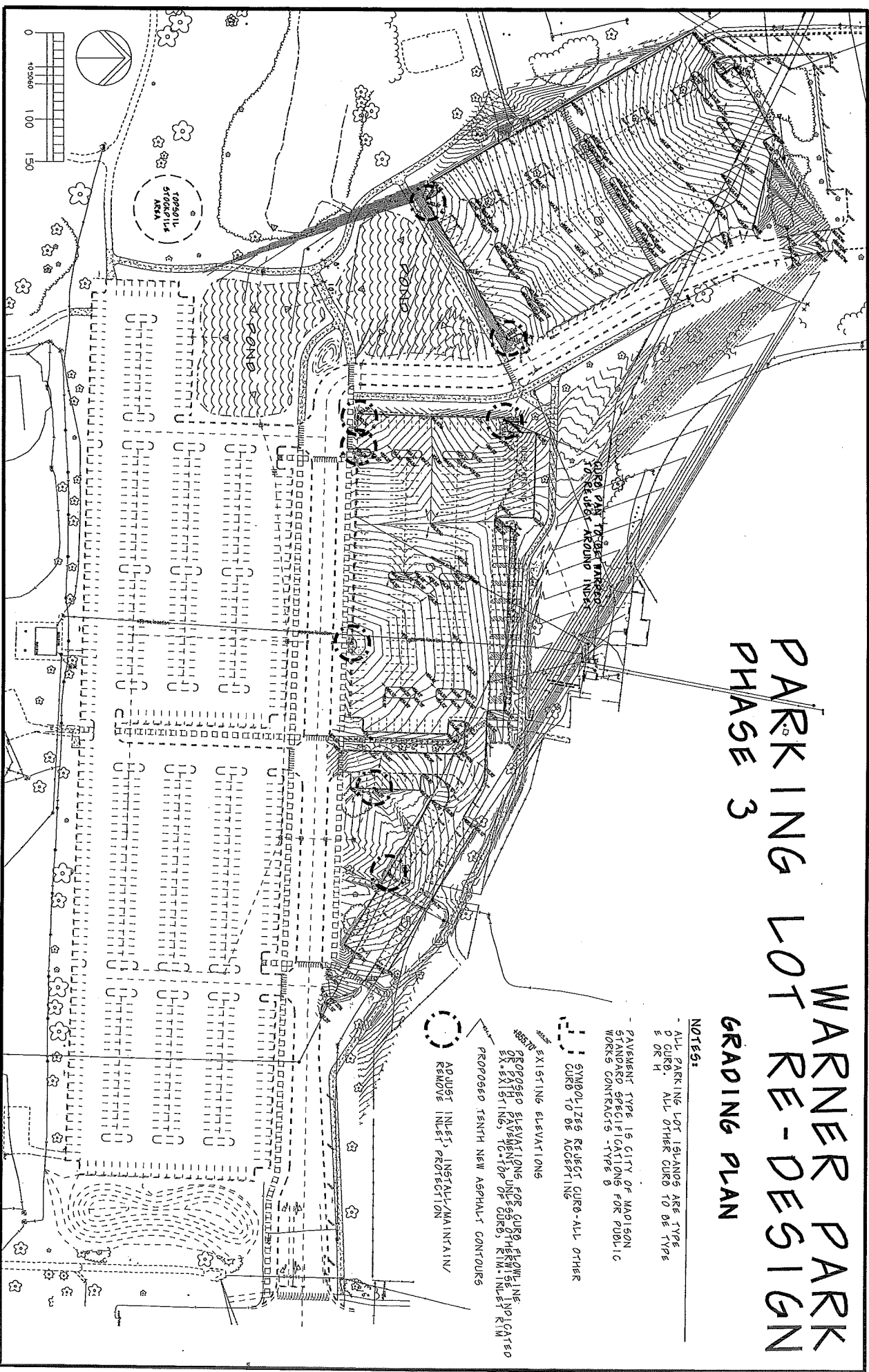

NOTES:

- ALL PARKING LOT ISLANDS ARE TYPE
P CURB. ALL OTHER CURB TO BE TYPE
E OR H

- PAVEMENT TYPE IS CITY OF MADISON
STANDARD SPECIFICATIONS FOR PUBLIC
WORKS CONTRACTS - TYPE B

- SYMBOLIZES REJECT CURB-ALL OTHER
CURB TO BE ACCEPTING

- EXISTING ELEVATIONS

- PROPOSED ELEVATIONS FOR CURB, SHOWING THE
EXISTING ELEVATIONS FOR THE EXISTING
CURED PAVE TO BE REDESIGNED TO BE
REAROUND INPDS

- PROPOSED TENTH NEW ASPHALT CONTOURS

- ADJUST INLETS, INSTALL/MAINTAIN/
REMOVE INLET PROTECTION

WARNER PARK PARKING LOT RE-DESIGN PHASE 3 LAYOUT PLAN

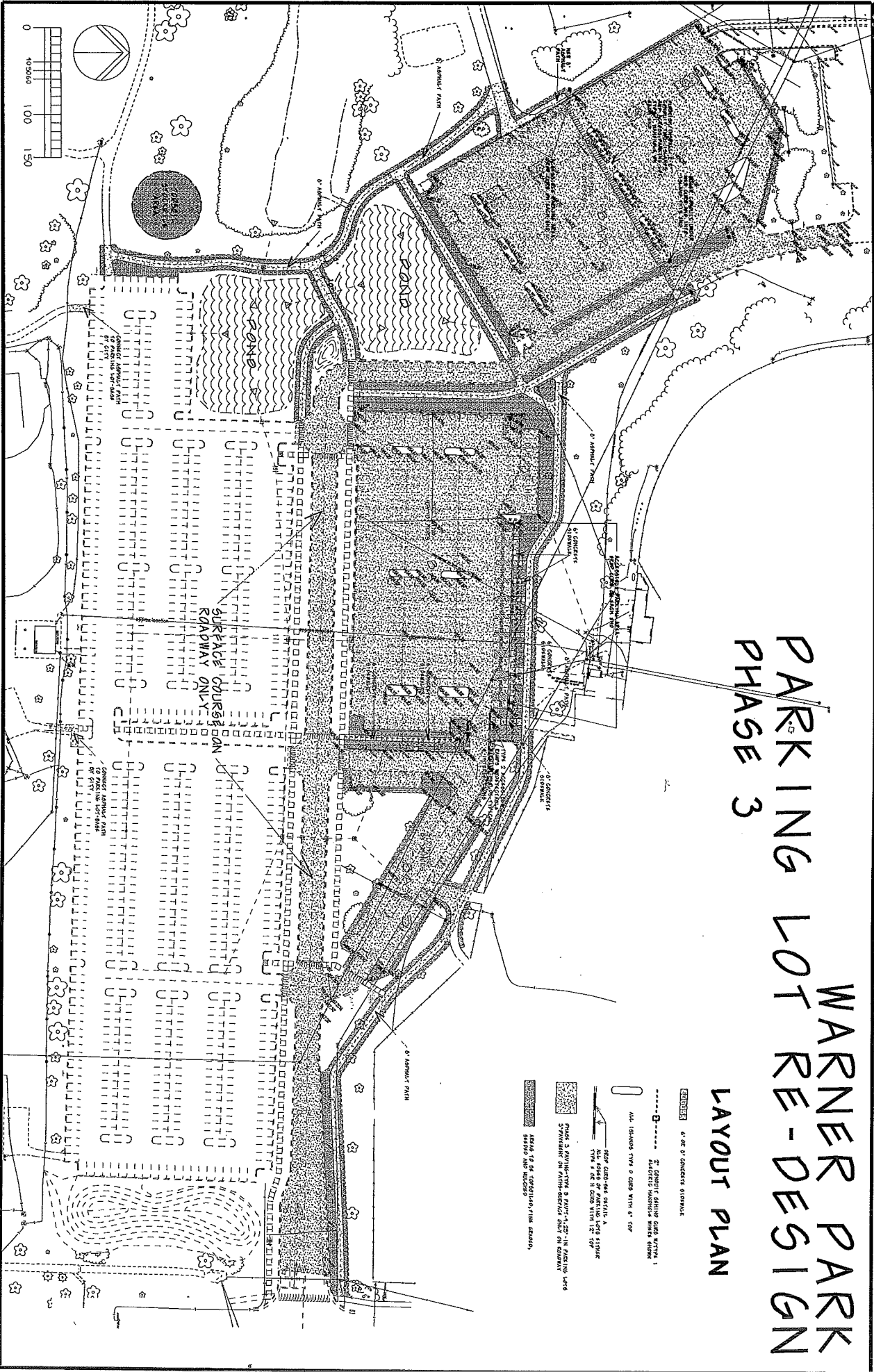

6" OR 8" CONCRETE SIDEWALK

2" CONCRETE SANDPAPER WITH 1" SCHEDULED REINFORCING BARS OR 2" CONCRETE SANDPAPER WITH 1" SCHEDULED REINFORCING BARS OR 2" CONCRETE SANDPAPER WITH 1" SCHEDULED REINFORCING BARS

1" CONCRETE SANDPAPER WITH 1" SCHEDULED REINFORCING BARS OR 1" CONCRETE SANDPAPER WITH 1" SCHEDULED REINFORCING BARS

PHASE 3 EXISTING DRIVE & DRIVE-UP DRIVE - IN PARKING LOTS 51508 & 51509 - IN DRIVE-UP DRIVE ONLY ON EXISTING DRIVE

AREAS TO BE COMPLETED IN PHASES 1 AND 2

