



100 State Street, Madison, WI 53703

608.256.6445 • www.madisonchildrensmuseum.org

Historic Log Cabin and Early-Learning Garden Deck

Outdoor Exhibits:

In order to provide outdoor exhibit space at street level, the Madison Children's Museum proposes to construct two exhibits to complement its new facility: a small historic log cabin, fully restored, to be located in an existing landscaped area of the parking ramp, and; a raised garden deck located over an existing planter that flanks the Hamilton Street entry to the parking ramp.

Operation:

Madison Children's Museum intends to operate the historic cabin and garden deck as year-round exhibit environments. In most cases, the cabin and deck will be open to museum visitors during normal operating hours; the only exceptions will be extended hours when the museum is open for special events or infrequent closings during extremely inclement weather.

Access:

The Museum's Visitor Services staff will monitor and maintain a safe environment in and around the historic cabin and garden deck. Individual visitors will be accompanied by parents, caregivers or staff during their explorations. The garden deck will be accessed directly from the new early learning exhibit space via a new glass door (per previous approval). School group visiting the cabin will be accompanied by museum staff at all times. Clearly marked pathways will guide visitors to the cabin from the parking lot entrance and/or the museum's second entrance, located within the parking lot. All routes are fully wheelchair accessible.

Security:

The cabin and the gate surrounding its site will be securely locked when the museum is closed. Security lighting will provide additional protection. There is no access to the garden deck from the street/parking lot level.

Location Map 

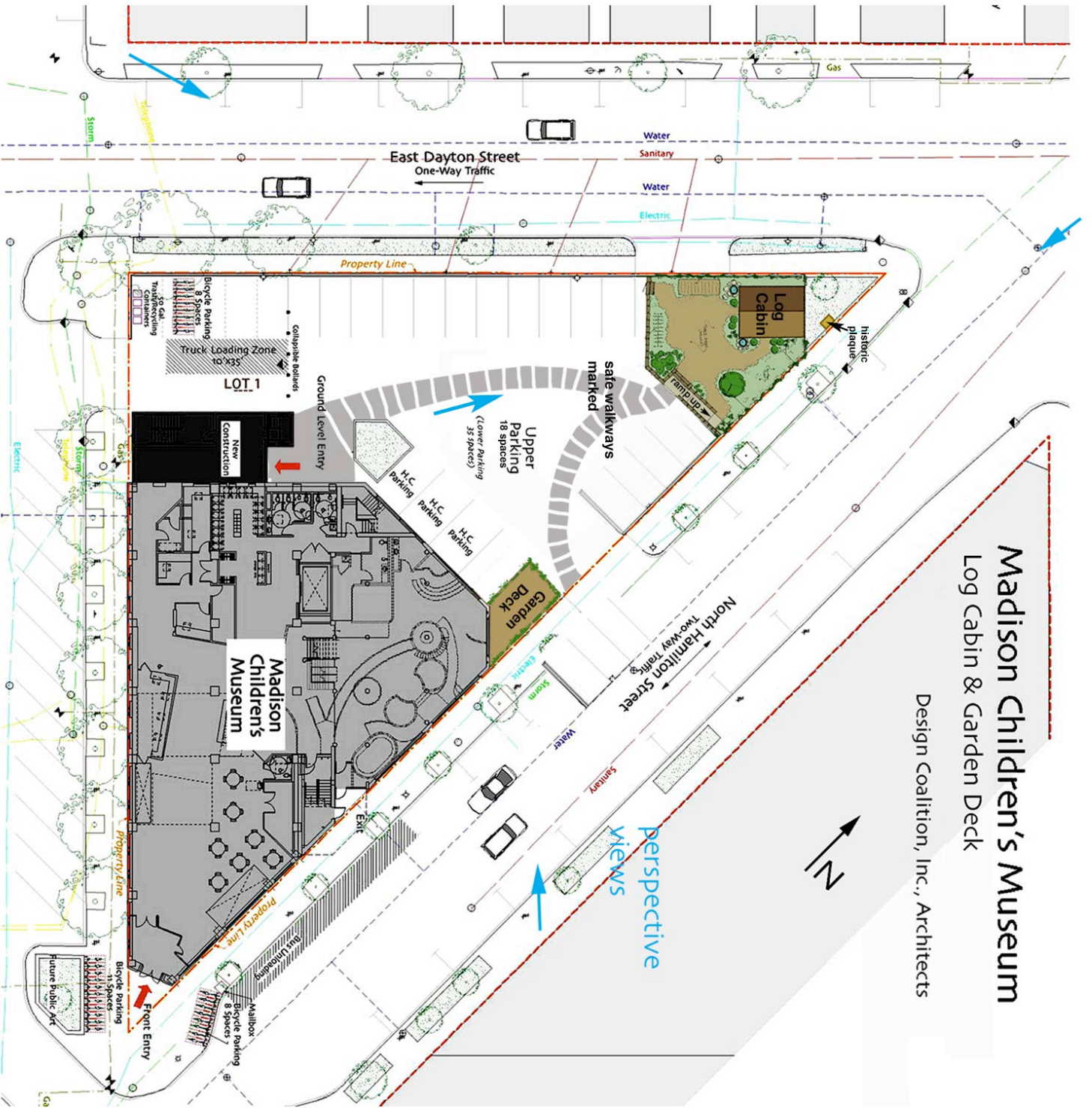

Madison Children's Museum Log Cabin & Garden Deck

Design Coalition, Inc., Architects



Madison Children's Museum Historic Log Cabin ~ Landscape Plan





Photo of the recently restored Gotten Cabin ~ very similar to Madison Children's Museum's historic 1838 log cabin

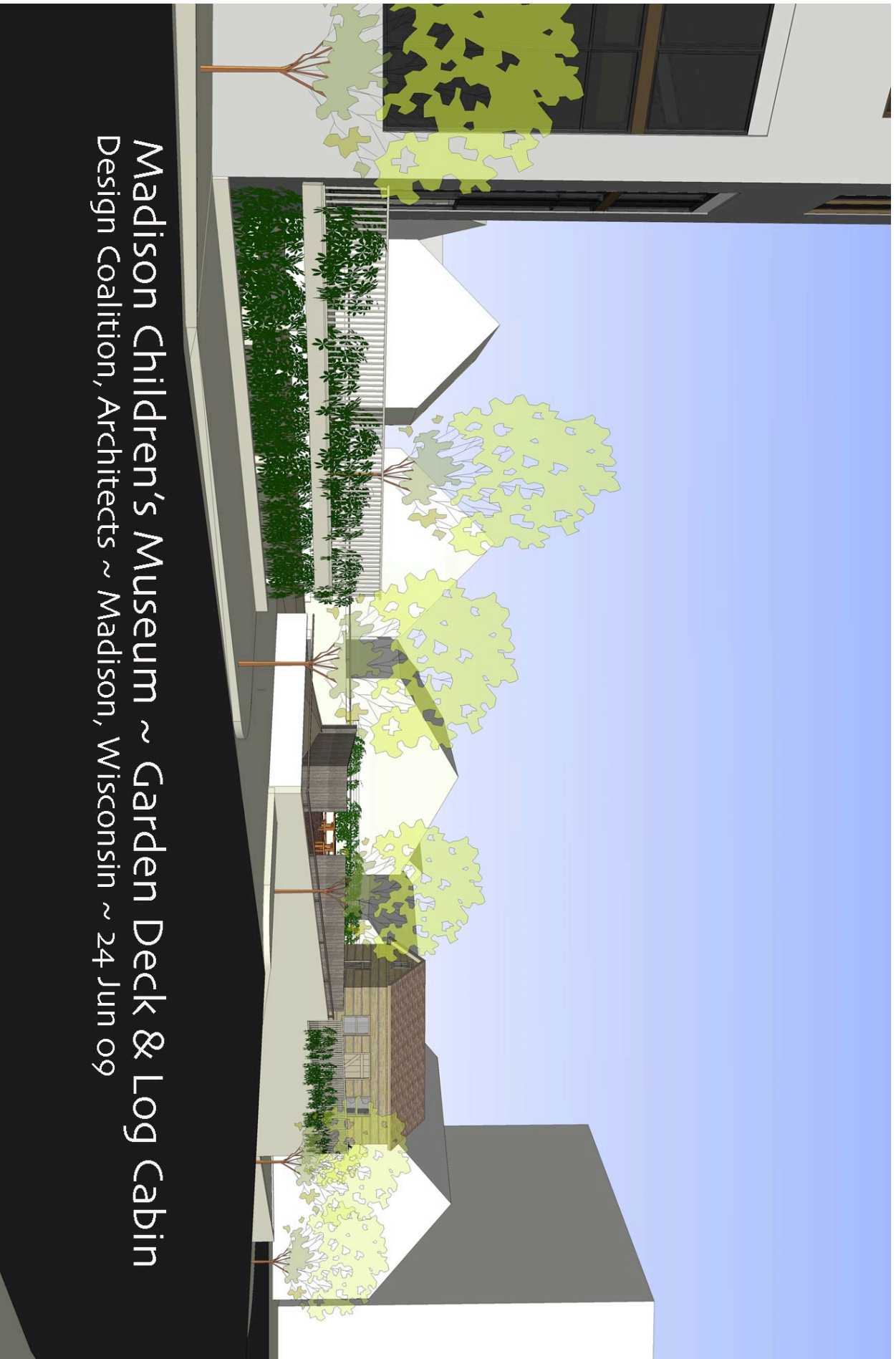

Madison Children's Museum ~ Garden Deck & Log Cabin
Design Coalition, Architects ~ Madison, Wisconsin ~ 24 Jun 09



Madison Children's Museum ~ Garden Deck & Log Cabin
Design Coalition, Architects ~ Madison, Wisconsin ~ 24 Jun 09



Madison Children's Museum ~ Garden Deck & Log Cabin
Design Coalition, Architects ~ Madison, Wisconsin ~ 24 Jun 09



Madison Children's Museum ~ Garden Deck & Log Cabin
Design Coalition, Architects ~ Madison, Wisconsin ~ 24 Jun 09

**APPLICATION FOR
URBAN DESIGN COMMISSION
REVIEW AND APPROVAL**

**AGENDA ITEM # _____
Project # _____**

DATE SUBMITTED: <u>24 June 2009</u>	Action Requested
UDC MEETING DATE: <u>1 July 2009</u>	<input type="checkbox"/> Informational Presentation
	<input type="checkbox"/> Initial Approval and/or Recommendation
	<input checked="" type="checkbox"/> Final Approval and/or Recommendation

PROJECT ADDRESS: 100 North Hamilton Street

ALDERMANIC DISTRICT: C4 District -- Verveer

OWNER/DEVELOPER (Partners and/or Principals) ARCHITECT/DESIGNER/OR AGENT:

Ruth G. Shelly, Executive Director Design Coalition, Inc,

Madison Children's Museum

Contact: Lou Host-Jablonski, AIA

100 State Street, Madison, WI 53703 2088 Atwood Ave., Madison, WI 5370

CONTACT PERSON: Michael Huffman, Huffman Facility Development

Address: 100 N. Hamilton Street

Madison, WI 53703

Phone: 608-332-4112

Fax: 608-204-3811

E-mail address: mhuffman@huffmanfd.com

TYPE OF PROJECT:

(See Section A for:)

Planned Unit Development (PUD)

General Development Plan (GDP)

Specific Implementation Plan (SIP)

Planned Community Development (PCD)

General Development Plan (GDP)

Specific Implementation Plan (SIP)

Planned Residential Development (PRD)

New Construction or Exterior Remodeling in an Urban Design District * (A public hearing is required as well as a fee)

School, Public Building or Space (Fee may be required)

New Construction or Addition to or Remodeling of a Retail, Hotel or Motel Building Exceeding 40,000 Sq. Ft.

Planned Commercial Site

(See Section B for:)

New Construction or Exterior Remodeling in C4 District (Fee required)

(See Section C for:)

R.P.S.M. Parking Variance (Fee required)

(See Section D for:)

Comprehensive Design Review* (Fee required)

Street Graphics Variance* (Fee required)

Other _____

*Public Hearing Required (Submission Deadline 3 Weeks in Advance of Meeting Date)

Where fees are required (as noted above) they apply with the first submittal for either initial or final approval of a project.