

**PETITION FOR INTERMEDIATE ATTACHMENT
PURSUANT TO THE
FINAL TOWN OF BURKE, VILLAGE OF DeFOREST, CITY OF SUN PRAIRIE
AND CITY OF MADISON COOPERATIVE PLAN**

TO:	City of Madison Attn: Ms. Maribeth Witzel-Behl, City Clerk 210 Martin Luther King Jr. Blvd. Room 103 Madison, WI 53703	Town of Burke Attn: PJ Lentz, Clerk Treasurer 5365 Reiner Road Madison, WI 53718
-----	--	---

OWNER: MH Madison, LLC
222 W. Washington Ave, Ste 360
Madison, WI 53703

The undersigned, MH Madison, LLC, a Wisconsin limited liability company (“Owner”), being the sole owner of the real property known as Tax Key No. 014/0810-152-9012-0 and as further described on the attached and incorporated Exhibit A and depicted on the scale map attached and incorporated as Exhibit B (the “Attachment Property”), hereby submits this petition (“Attachment Petition”) to the City of Madison Common Council to request that the Attachment Property be attached to the City of Madison as an Intermediate Attachment (the “Attachment”) pursuant to that certain Final Town of Burke, Village of DeForest, City of Sun Prairie and City of Madison Cooperative Plan dated January 5, 2007 (the “Cooperative Plan”). The Attachment Property is currently located within the Town of Burke and is contiguous to the City of Madison. The Attachment Property is vacant and the population is zero.

This Petition has been executed by all the owners of all of Attachment Property, which constitutes the entire real property within the territory to be attached to the City of Madison pursuant to this Petition, and is filed pursuant to the Cooperative Plan. Owner requests that the Attachment be approved pursuant to the Cooperative Plan.

Dated this 8 day of March, 2023.

OWNER:
MH MADISON, LLC

By: David Disanto
Name: David Disanto
Title: Manager

NOTE: A copy of this Petition will be filed with the Clerk of the City of Madison and with the Clerk of the Town of Burke.

EXHIBIT A

LEGAL DESCRIPTION OF ATTACHMENT PROPERTY

Part of the Southwest Quarter and the Southeast Quarter of the Northwest Quarter of Section 15, Township 8 North, Range 10 East, Town of Burke, Dane County, Wisconsin, more fully described as follows:

Commencing at the West Quarter Corner of said Section 15; thence North 01 degree 16 minutes 43 seconds East, along the west line of said Northwest Quarter, 527.71 feet to the point of beginning; thence continuing along said west line, and the existing corporate boundary of the City of Madison, North 01 degree 16 minutes 43 seconds East, 100.08 feet; North 88 degrees 59 minutes 58 seconds East, 825.29 feet; thence North 01 degrees 18 minutes 24 seconds East, 699.22 feet to the North line of the Southwest Quarter of the Northwest Quarter of said Section 15; thence along said North line, and the North line of the said Southeast Quarter of the Northwest Quarter and the existing corporate boundary of the City of Madison, North 88 degrees 50 minutes 35 seconds East, 1150.65 feet; thence South 01 degree 15 minutes 20 seconds West, 802.41 feet along the existing corporate boundary of the City of Madison; thence South 88 degrees 59 minutes 58 seconds West, 1976.48 feet along the existing corporate boundary of the City of Madison, to the west line of the Northwest Quarter of said Section 15 and the point of beginning. This description contains approximately 1,003,483 square feet or 23.04 acres or 0.0360 square miles.

EXHIBIT B

SCALE MAP

[See attached]

FOUND 1-1/4" SOLID IRON REBAR IN VALVE BOX AT THE NORTHWEST CORNER OF SECTION 15, T8N, R10E

(N00°52'52"E)
(N01°16'34"E)
MON. - MON. = N01°16'43"E 2649.47'

PORTACE ROAD

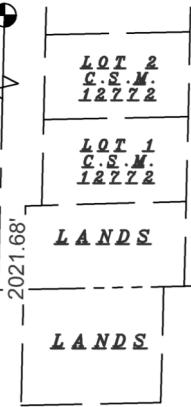

LOT 1
C.S.M.
3709

LOT 1
C.S.M.
12772

LANDS

LANDS

LANDS

LANDS

LANDS

CEMETERY
PLAT OF THE
BURKE
LUTHERAN
CHURCH FIRST
ADDITION

(S67°41'27"W)
N01°18'24"E 699.22'

LANDS

N88°50'35"E 1150.65'

490.45'

660.20'

PARCEL
1,003,483 SQ. FT.
23.04 ACRES
PARCEL #0810-152-9012-0

TOWN OF BURKE

(N00°51'35"E)
S01°15'20"W 802.41'

CITY OF MADISON

N88°59'58"E 825.29'

N01°16'43"E 100.08'

1282.61'

TOWN OF BURKE 660.84'

S88°59'58"W 1976.48'
(N88°34'57"E)

CITY OF MADISON

POINT OF BEGINNING

SW 1/4 - NW 1/4

LANDS

LANDS

SE 1/4 - NW 1/4

FOUND BRASS CAP MONUMENT IN WATER BOX AT THE WEST QUARTER CORNER OF SECTION 15, T8N, R10E

FOUND 1-1/4" SOLID IRON REBAR AT THE CENTER OF SECTION 15, T8N, R10E

33.03'

1282.40'

MON. - MON. = N88°57'09"E 2630.85'

1315.43'

ORDINANCE No. _____
FILE No. _____
DATE ADOPTED _____
DATE PUBLISHED _____

ALDER DISTRICT ANNEXED TO _____
AREA: 1,003,483 SQ. FT. OR 23.04 ACRES

BEARINGS ARE REFERENCED TO THE WISCONSIN COUNTY COORDINATE SYSTEM, DANE COUNTY, WISCONSIN, THE WEST LINE OF NORTHWEST QUARTER OF SECTION 15, T8N, R10E, MEASURED AS BEARING S01°16'43"W



SURVEYED FOR:
DiSanto - Madison
Development
654 N. Park Blvd.
Glen Ellyn, IL 60137

SURVEYED BY:
Snyder & Associates, Inc.
5010 Voges Road
Madison, WI 53718
(608) 838-0444
www.snyder-associates.com

ATTACHMENT MAP
PART OF THE SOUTHWEST QUARTER AND THE SOUTHEAST QUARTER OF THE NORTHWEST QUARTER OF SECTION 15, TOWNSHIP 8 NORTH, RANGE 10 EAST, TOWN OF BURKE, DANE COUNTY, WISCONSIN

FN: 122.0488.30
DATE: 03-01-23
REVISIONS:
REV1: 03-31-23
REV2
REV3

SHEET 1 OF 2

Legal Description of Property to be Attached :

Part of the Southwest Quarter and the Southeast Quarter of the Northwest Quarter of Section 15, Township 8 North, Range 10 East, Town of Burke, Dane County, Wisconsin, more fully described as follows:

Commencing at the West Quarter Corner of said Section 15; thence North 01 degree 16 minutes 43 seconds East, along the west line of said Northwest Quarter, 527.71 feet to the point of beginning; thence continuing along said west line, and the existing corporate boundary of the City of Madison, North 01 degree 16 minutes 43 seconds East, 100.08 feet; North 88 degrees 59 minutes 58 seconds East, 825.29 feet; thence North 01 degrees 18 minutes 24 seconds East, 699.22 feet to the North line of the Southwest Quarter of the Northwest Quarter of said Section 15; thence along said North line, and the North line of the said Southeast Quarter of the Northwest Quarter and the existing corporate boundary of the City of Madison, North 88 degrees 50 minutes 35 seconds East, 1150.65 feet; thence South 01 degree 15 minutes 20 seconds West, 802.41 feet along the existing corporate boundary of the City of Madison; thence South 88 degrees 59 minutes 58 seconds West, 1976.48 feet along the existing corporate boundary of the City of Madison, to the west line of the Northwest Quarter of said Section 15 and the point of beginning. This description contains approximately 1,003,483 square feet or 23.04 acres or 0.0360 square miles.



SURVEYED FOR:
DiSanto - Madison
Development
654 N. Park Blvd.
Glen Ellyn, IL 60137

SURVEYED BY:
Snyder & Associates, Inc.
5010 Voges Road
Madison, WI 53718
(608) 838-0444
www.snyder-assciates.com

ATTACHMENT MAP

PART OF THE SOUTHWEST QUARTER AND THE
SOUTHEAST QUARTER OF THE NORTHWEST QUARTER
OF SECTION 15, TOWNSHIP 8 NORTH, RANGE 10 EAST,
TOWN OF BURKE, DANE COUNTY, WISCONSIN

FN: 122.0488.30
DATE: 03-01-23
REVISIONS:
REV1: 03-31-23
REV2
REV3

SHEET 2 OF 2