

# CANNONBALL PATH: PH6 PROPOSED DESIGN

NOTE: EXISTING SANITARY SEWER MAIN WITHIN EASEMENT IN PARK WILL ALSO NEED TO BE REPLACED WITH THIS PROJECT. THE NEW MAIN WILL BE REALIGNED TO FOLLOW THE PATH ALIGNMENT.

BOWMAN FIELD

MADISON NEWSPAPERS

WRIGHT MIDDLE SCHOOL

MG&E SUBSTATION

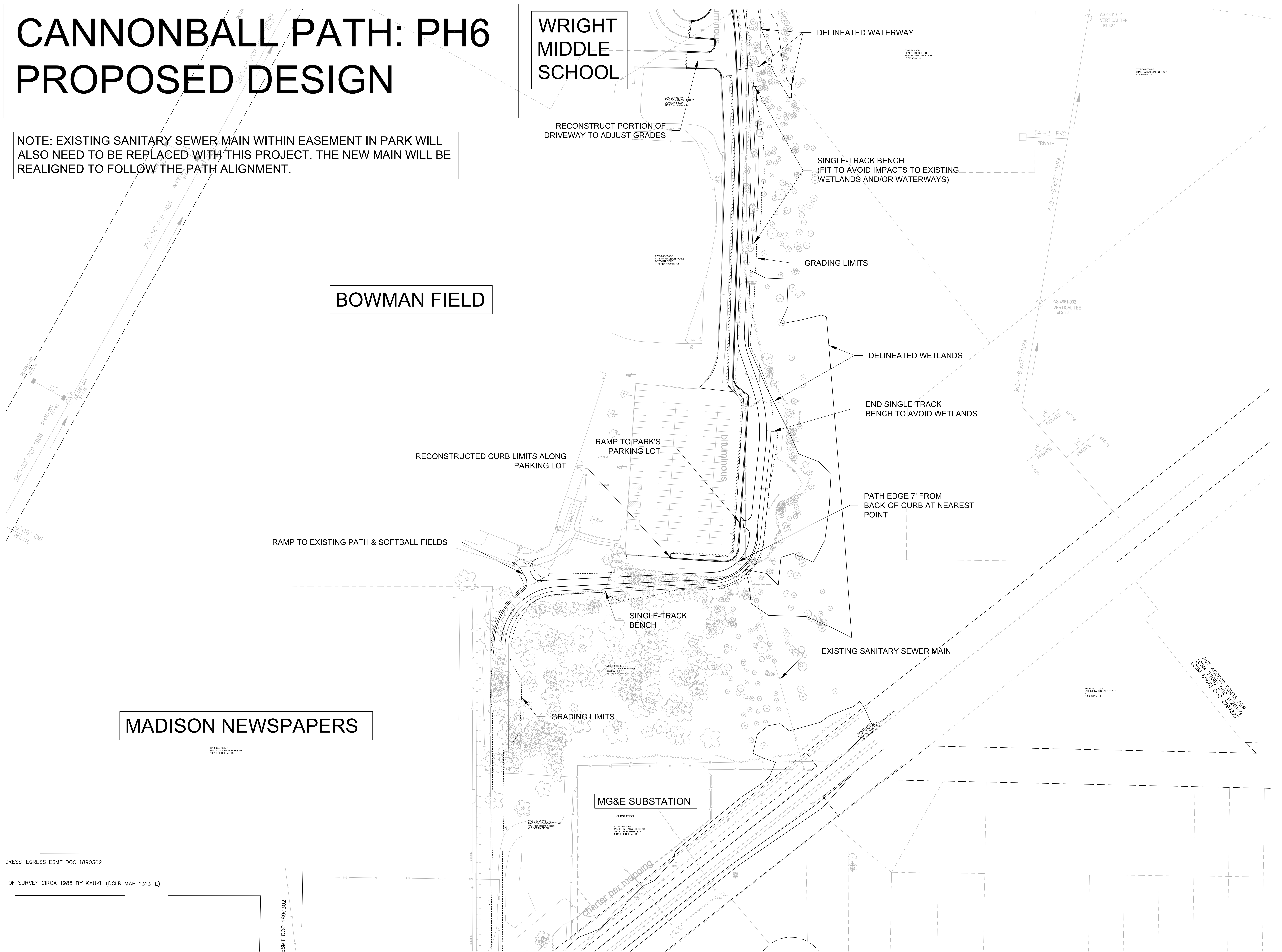

GRESS-EGRESS ESMT DOC 1890302  
 OF SURVEY CIRCA 1985 BY KAUKL (DCLR MAP 1313-L)

ESMT DOC 1890302

FOR ACCESS ESMTS PER  
 (SM 320) DOC 1824103  
 (SM 6369) DOC 2227327

charter per mapping