

# S. Owen Drive Neighborhood Meeting

Public Information Meeting  
December 1, 2014

# Informational Meeting Format

- ▶ 20 minute presentation on S. Owen Drive construction plan
- ▶ Comments and Questions: 40 minutes

# Project Scope

- ▶ Replace asphalt pavement & base
- ▶ Install new curb & gutter, replace drive aprons
- ▶ Replace sanitary sewer & water mains
- ▶ Install new storm sewer

# Location

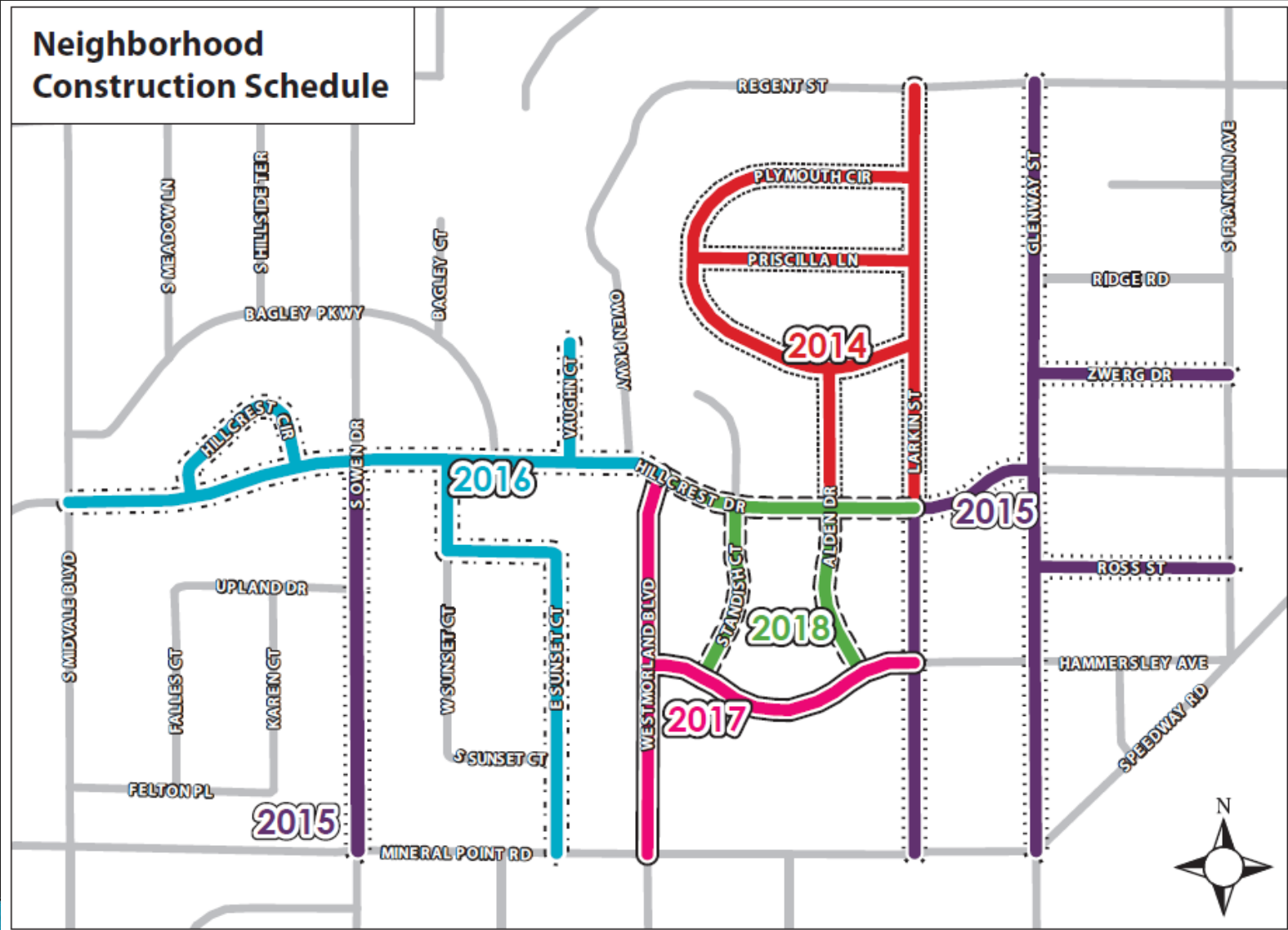

# Street Improvement Details

- ▶ Existing Street
  - Asphalt pavement, average rating 3 & 4 out of 10
  - No curb and gutter
  - Existing sidewalk
- ▶ Street Improvements
  - New asphalt pavement & stone base
  - Install concrete curb & gutter & drive aprons and replace sidewalk as needed for City utility work
  - New storm sewer as part of new curb & gutter

# City Utility Replacement Details

## ▶ Sanitary Sewer

- Existing main – 1941, 6” clay, located in terrace
- Proposed – 8” PVC, located under the pavement

## ▶ Water Main

- Existing main – 1940, 6” spun cast iron
- Proposed – 8” Ductile Iron

# City Utility Replacement Details

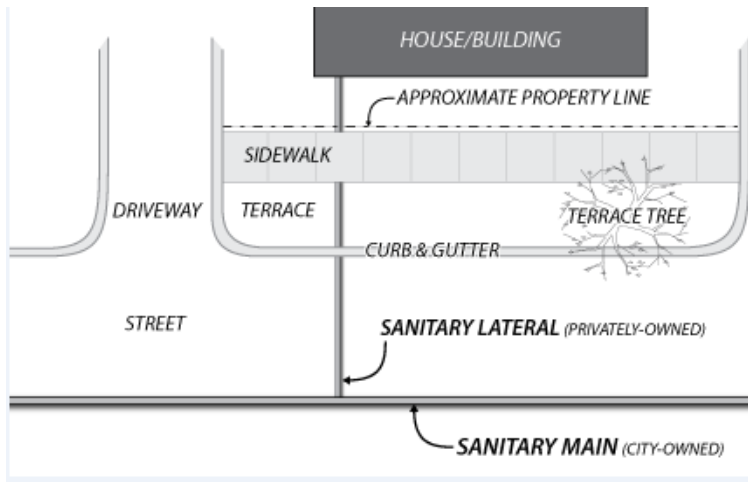

# New Parking Configuration

- ▶ Alternate side parking only applies to street blocks with parking on both sides
- ▶ Owen Drive is too narrow (28') to have parking on both sides
- ▶ Alternating the sides of the street that parking is on allows for alternate side parking and snow plowing



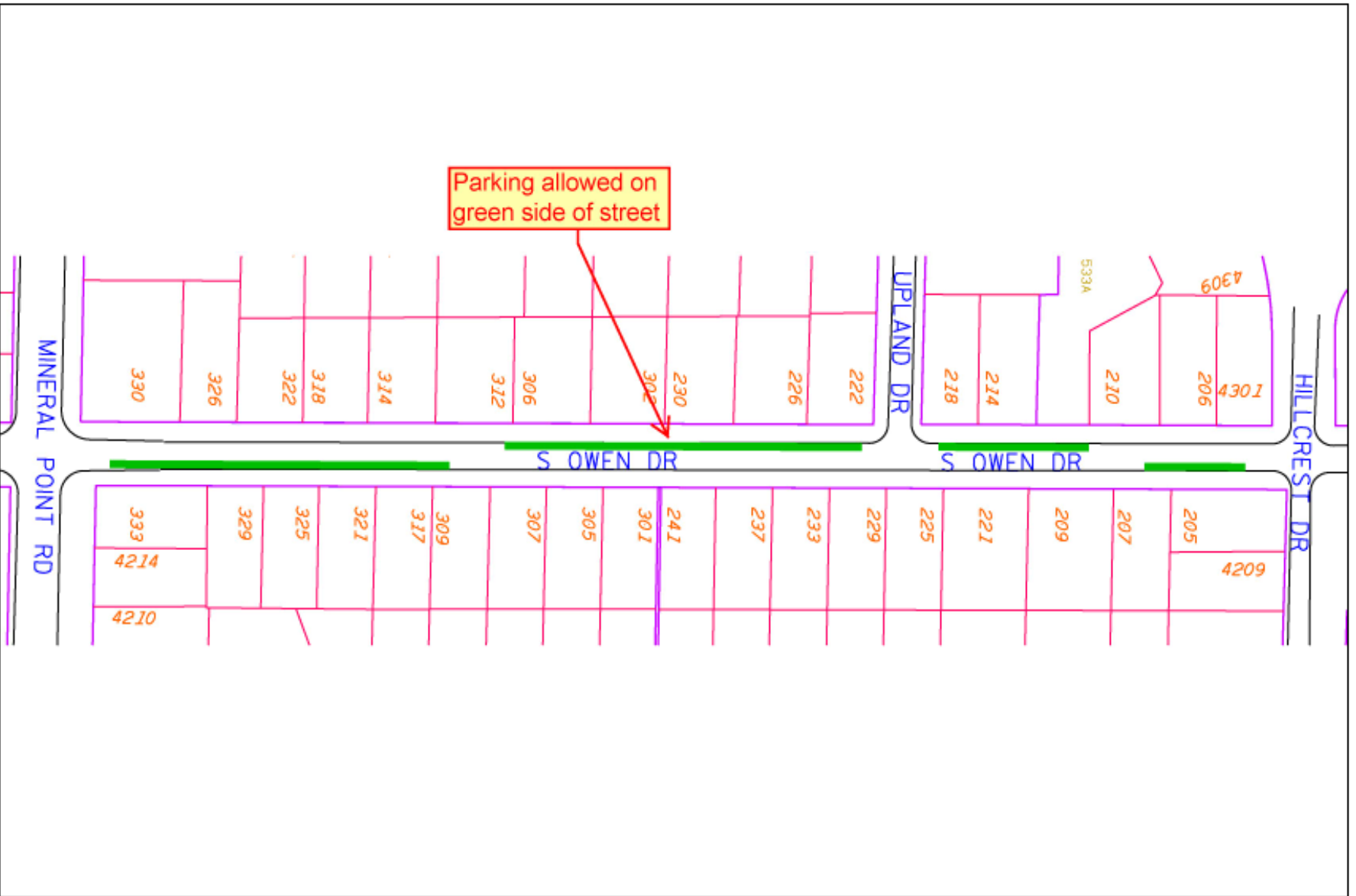

# Street Assessment Policy & Costs

(locations with no curb & gutter)

Item	Property Owner Share	City Share
Curb and Gutter*	100%	0%
Pavement*	Costs of 4 ft.	Remaining
Storm Sewer Main	0%	100%
Priv Storm Connects	100%	0%
Sanitary Sewer Main	0%	100%
Sanitary Laterals	25%	75%
Water Main	0%	100%

\* Curb & Pavement assessed per linear ft. of frontage

# PLAN

# Construction

- ▶ Road closed during project, local traffic only
- ▶ Street parking removed during working hours (7am–7pm) for project duration
- ▶ Residential driveways accessible for most of project but closed up to a cumulative total of 21 days, notified before
- ▶ Likely 2 planned water shutoffs, notified before
- ▶ Sanitary sewer will be out of service for a couple of hours when new lateral is connected to existing.
- ▶ Tree removals, as shown on plan, were identified by City Forestry.

# What's Next – Typical Project Timeline

- ▶ Mail estimated assessments and Public Hearing Notice, Fri. 12/5/14
- ▶ BPW Public Hearing 12/17/14
- ▶ CC Hearing 1/6/15
- ▶ Advertise for Bids 1/23/15
- ▶ Start Construction– 3/30/15 at earliest

# Contacts

- ▶ Project Manager – LeAnne Hannan, 266–4057  
[lhannan@cityofmadison.com](mailto:lhannan@cityofmadison.com)
- ▶ Street, LeAnne Hannan, 266–4057  
[lhannan@cityofmadison.com](mailto:lhannan@cityofmadison.com)
- ▶ Sanitary, Storm sewer – Eric Dundee  
266–4913, [edundee@cityofmadison.com](mailto:edundee@cityofmadison.com)
- ▶ Water Utility – Adam Wiederhoeft 266–9121  
[awiederhoeft@madisonwater.org](mailto:awiederhoeft@madisonwater.org)
- ▶ Traffic Control, Parking– Tom Mohr, 266–  
9121 [tmohr@cityofmadison.com](mailto:tmohr@cityofmadison.com)

# Discussion