

CONTEXT & LOCATOR MAP

HORIZON DEVELOPMENT
1 & 15 ELLIS POTTER COURT

UDC FINAL PRESENTATION | 01.10.2024 | KBA #2372

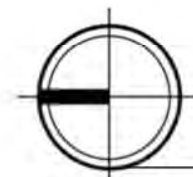

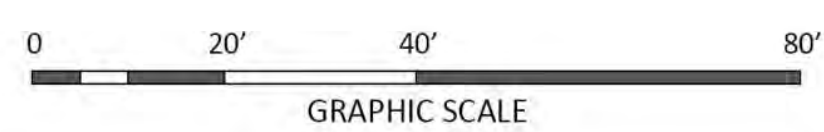
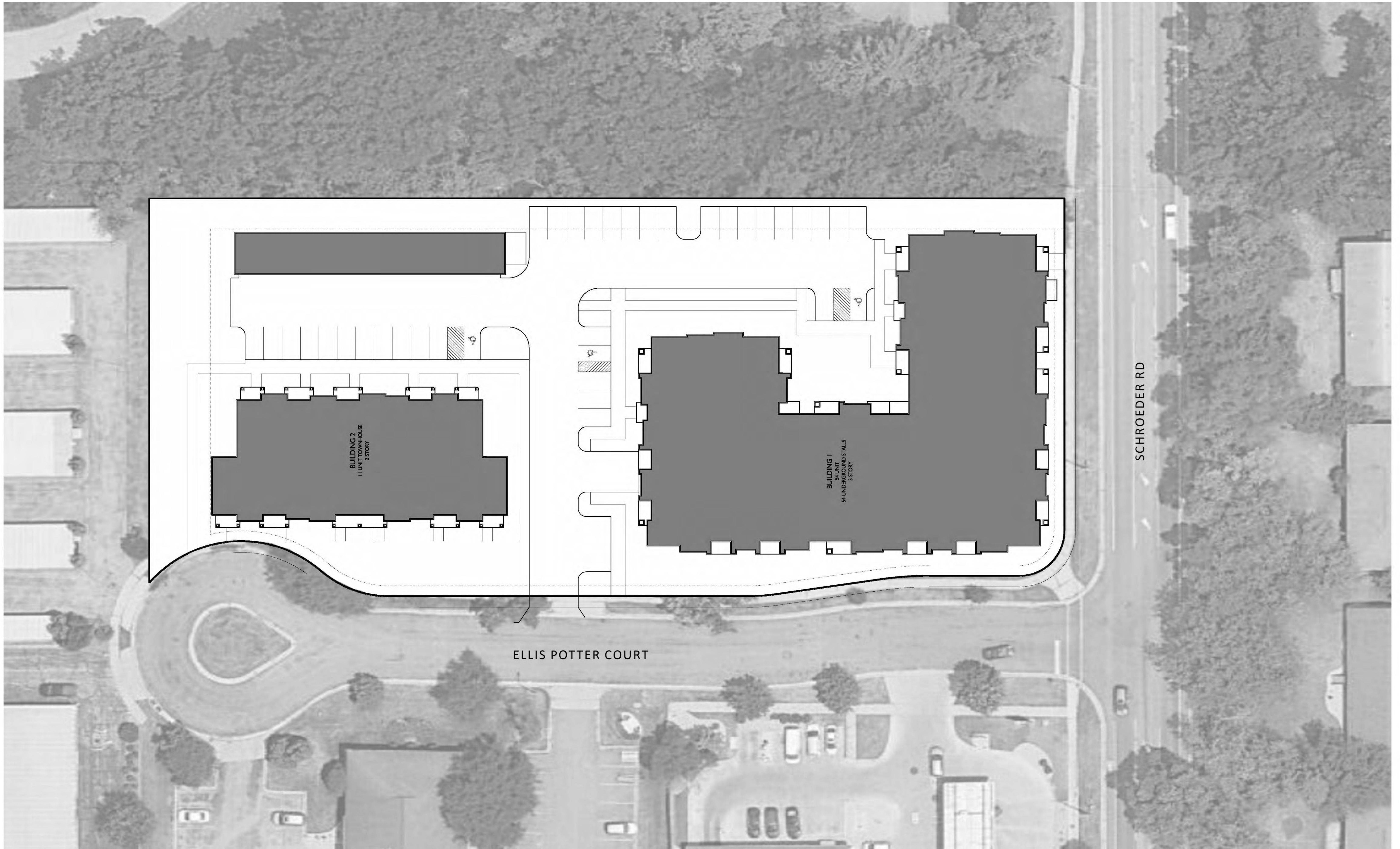

PREVIOUS SITE PLAN

ELLIS POTTER COURT DEVELOPMENT
1 & 15 ELLIS POTTER COURT, MADISON, WI

UDC INFORMATIONAL PRESENTATION | 11.08.2023 | KBA #2372





10 GARAGES

BUILDING 2
11 UNIT TOWNHOUSE
2 STORY

BUILDING 1
54 UNIT
54 UNDERGROUND STALLS
3 STORY

SCHROEDER ROAD

ELLIS POTTER COURT



SITE/LANDSCAPE PLAN





1 COLORED ELEVATION - SOUTH
A-2.4 1/8" = 1'-0"



2 COLORED ELEVATION - WEST
A-2.4 1/8" = 1'-0"

ISSUED
Issued for UDC Submittal - November 27, 2023
Issued for LUA Submittal - November 27, 2023

PROJECT TITLE
**Horizon
Development**

1 & 15 Ellis Potter Ct
Madison, Wisconsin
SHEET TITLE

**EXTERIOR
ELEVATIONS -
COLOR -
APARTMENT**
SHEET NUMBER

A-2.4

PROJECT NUMBER
2372

EXTERIOR MATERIAL SCHEDULE			
MARK	BUILDING ELEMENT	MANUFACTURER	COLOR
01	COMPOSITE LAP SIDING 6"	JAMES HARDIE	RICH ESPRESSO
02	COMPOSITE BOARD & BATTEN	JAMES HARDIE	AGED PEWTER
03	BRICK VENEER	INTERSTATE BRICK	TUMBLEWEED
04	CAST STONE	ROCKCAST	CREME BUFF
05	COMPOSITE TRIM	JAMES HARDIE	ARCTIC WHITE
10	COMPOSITE WINDOWS	ANDERSEN	WHITE
11	WRAPPED COLUMN	JAMES HARDIE	ARCTIC WHITE
12	RAILINGS & HANDRAILS	SUPERIOR	BLACK
13	ALUMINIUM STOREFRONT	TBD	BLACK
14	ASPHALT SHINGLE ROOF	TBD	TBD

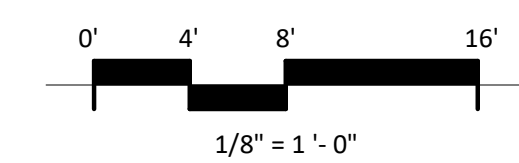



1 COLORED ELEVATION - NORTH
A-2.5 1/8" = 1'-0"



2 COLORED ELEVATION - EAST
A-2.5 1/8" = 1'-0"

ISSUED
Issued for UDC Submittal - November 27, 2023
Issued for LUA Submittal - November 27, 2023

PROJECT TITLE
**Horizon
Development**

1 & 15 Ellis Potter Ct
Madison, Wisconsin
SHEET TITLE

**EXTERIOR
ELEVATIONS -
COLOR -
APARTMENT**

SHEET NUMBER

A-2.5

PROJECT NUMBER
2372

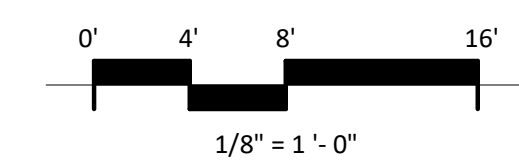

EXTERIOR MATERIAL SCHEDULE			
MARK	BUILDING ELEMENT	MANUFACTURER	COLOR
01	COMPOSITE LAP SIDING 6"	JAMES HARDIE	RICH ESPRESSO
02	COMPOSITE BOARD & BATTEN	JAMES HARDIE	AGED PEWTER
03	BRICK VENEER	INTERSTATE BRICK	TUMBLEWEED
04	CAST STONE	ROCKCAST	CREME BUFF
05	COMPOSITE TRIM	JAMES HARDIE	ARCTIC WHITE
10	COMPOSITE WINDOWS	ANDERSEN	WHITE
11	WRAPPED COLUMN	JAMES HARDIE	ARCTIC WHITE
12	RAILINGS & HANDRAILS	SUPERIOR	BLACK
13	ALUMINIUM STOREFRONT	TBD	BLACK
14	ASPHALT SHINGLE ROOF	TBD	TBD

ISSUED
Issued for UDC Submittal - November 27, 2023
Issued for LUA Submittal - November 27, 2023



2 COLORED ELEVATION - HIDDEN NORTH
A-2.6 1/8" = 1'-0"



1 COLORED ELEVATION - HIDDEN SOUTH
A-2.6 1/8" = 1'-0"

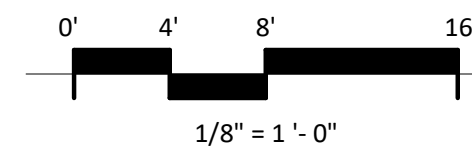

EXTERIOR MATERIAL SCHEDULE			
MARK	BUILDING ELEMENT	MANUFACTURER	COLOR
01	COMPOSITE LAP SIDING 6"	JAMES HARDIE	RICH ESPRESSO
02	COMPOSITE BOARD & BATTEN	JAMES HARDIE	AGED PEWTER
03	BRICK VENEER	INTERSTATE BRICK	TUMBLEWEED
04	CAST STONE	ROCKCAST	CREME BUFF
05	COMPOSITE TRIM	JAMES HARDIE	ARCTIC WHITE
10	COMPOSITE WINDOWS	ANDERSEN	WHITE
11	WRAPPED COLUMN	JAMES HARDIE	ARCTIC WHITE
12	RAILINGS & HANDRAILS	SUPERIOR	BLACK
13	ALUMINIUM STOREFRONT	TBD	BLACK
14	ASPHALT SHINGLE ROOF	TBD	TBD

PROJECT TITLE
**Horizon
Development**

1 & 15 Ellis Potter Ct
Madison, Wisconsin

SHEET TITLE
**EXTERIOR
ELEVATIONS -
COLOR -
APARTMENT**

SHEET NUMBER

A-2.6

PROJECT NUMBER

2372



1 COLORED ELEVATION - NORTH
A-2.2 1/8" = 1'-0"



2 COLORED ELEVATION - SOUTH
A-2.2 1/8" = 1'-0"



4 COLORED ELEVATION - WEST
A-2.2 1/8" = 1'-0"



3 COLORED ELEVATION - EAST
A-2.2 1/8" = 1'-0"

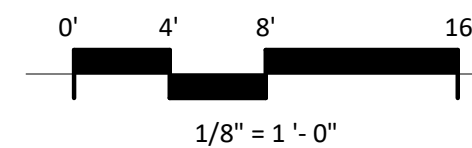

EXTERIOR MATERIAL SCHEDULE			
MARK	BUILDING ELEMENT	MANUFACTURER	COLOR
01	COMPOSITE LAP SIDING 8"	JAMES HARDIE	RICH ESPRESSO
02	COMPOSITE BOARD & BATTEN	JAMES HARDIE	AGED PEWTER
03	BRICK VENEER	INTERSTATE BRICK	TUMBLEWEED
04	CAST STONE	ROCKCAST	CREME BUFF
05	COMPOSITE TRIM	JAMES HARDIE	ARCTIC WHITE
10	COMPOSITE WINDOWS	ANDERSEN	WHITE
11	WRAPPED COLUMN	JAMES HARDIE	ARCTIC WHITE
12	RAILINGS & HANDRAILS	SUPERIOR	BLACK
13	STANDING SEAM METAL ROOF	CMG	SILVER
14	ASPHALT SHINGLE ROOF	TBD	TBD

ISSUED
Issued for UDC Submittal - November 27, 2023
Issued for LUA Submittal - November 27, 2023

PROJECT TITLE
**Horizon
Development**

1 & 15 Ellis Potter Ct
Madison, Wisconsin
SHEET TITLE

**EXTERIOR
ELEVATIONS -
COLORED -
TOWNHOME**

SHEET NUMBER

A-2.2

PROJECT NUMBER

2372



© Knothe & Bruce Architects, LLC



Horizon Development

1 & 15 Ellis Potter Ct, Madison, Wisconsin





© Knothe & Bruce Architects, LLC



Horizon Development

1 & 15 Ellis Potter Ct, Madison, Wisconsin





© Knothe & Bruce Architects, LLC



Horizon Development

1 & 15 Ellis Potter Ct, Madison, Wisconsin





© Knothe & Bruce Architects, LLC



Horizon Development

1 & 15 Ellis Potter Ct, Madison, Wisconsin





© Knothe & Bruce Architects, LLC



Horizon Development

1 & 15 Ellis Potter Ct, Madison, Wisconsin





© Knothe & Bruce Architects, LLC



Horizon Development

1 & 15 Ellis Potter Ct, Madison, Wisconsin

