

**SITE PLAN LEGEND**

- PROPERTY BOUNDARY
- CURB AND GUTTER (REVERSE CURB HATCHED)
- RETAINING WALL

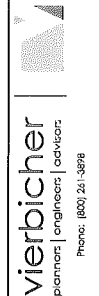

**Overall Site Plan**  
 Exact Sciences Campus  
 1 Exact Lane, 640 & 650 Forward Drive  
 Madison, Dane County, Wisconsin

REVISIONS		REVISIONS	
NO.	DATE	NO.	DATE

SCALE: AS SHOWN  
 DATE: 08/19/2019  
 DRAFTER: ANEA  
 CHECKED: JZM  
 PROJECT NO.: 170172  
 SHEET: 1 OF 1  
 DWG. NO.:

**NOT FOR CONSTRUCTION**

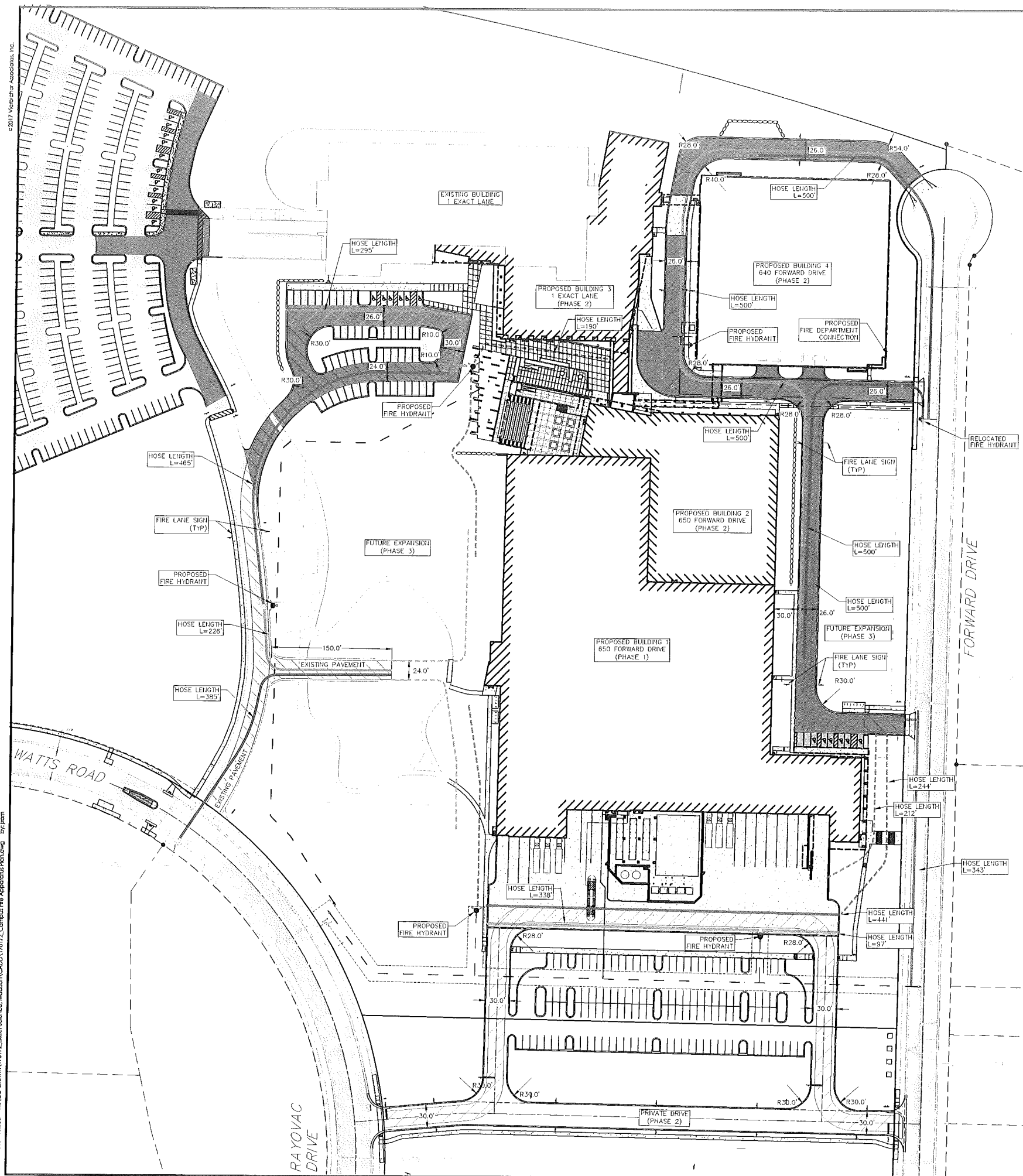

**FIRE APPARATUS PLAN LEGEND**

- EXISTING ASPHALT
- PROPOSED HEAVY DUTY ASPHALT
- PROPOSED LIGHT DUTY ASPHALT
- PROPOSED 20'-WIDE (MIN.) FIRE LANE
- PROPOSED 26'-WIDE AERIAL APPARATUS AREA
- HOSE ROUTE ALONG FIRE LANE (500 FT OR AS INDICATED ON PLAN, COLOR VARIES ON PLAN)
- HOSE ROUTE ALONG WALKING PATH (250 FT OR AS INDICATED ON PLAN, COLOR VARIES ON PLAN)
- FIRE LANE SIGN
- RETAINING WALL

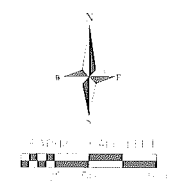

**SIGNAGE NOTES:**

1. ALL SIGNS SHALL BE FABRICATED AND INSTALLED IN ACCORDANCE WITH THE MANUAL ON UNIFORM TRAFFIC CONTROL DEVICES.
2. SIGNS SHALL BE A DISTANCE OF 7' FROM GROUND LEVEL TO THE BOTTOM OF THE SIGN MOUNTED ON THE POST AND LOCATED 3' BEHIND THE BACK OF CURB.
3. STREET NAME SIGNS SHALL HAVE WHITE LETTERS AND GREEN BACKGROUND.
4. SIGN POSTS SHALL BE 2-3/8" O.D., GALVANIZED 10 FT LONG, 13 GAUGE, AND 0.095 WALL THICKNESS. MOUNT SIGN AT TOP OF THE POST, AND INSTALL POSTS 3' DEEP AND MIX 1/2 BAG OF 80 LB SAKRETE CONCRETE, POURING IT AROUND THE POST BELOW THE GROUND BEFORE COVERING WITH 8" OF TOPSOIL.

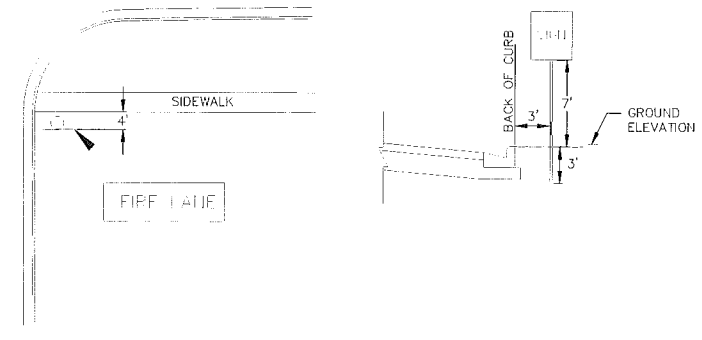

1 FIRE LANE SIGN  
NOT TO SCALE

22 Oct 2018 - 10:58a MA:CS Growth\170172\_Exact Science, Madison\CA\170172\_Campus Fire Apparatus Plan.dwg by:jam  
 © 2017 Vierbicher Associates, Inc.

**vierbicher**  
planners | engineers | advisors  
Phone: (608) 261-1389

**Fire Apparatus Plan**  
Exact Sciences Campus  
1 Exact Lane, 640 & 650 Forward Drive  
Madison, Dane County, WI

NO.	DATE	REVISIONS	REMARKS

SCALE: AS SHOWN  
DATE: 10/23/2018  
DRAFTER: CBCC  
CHECKED: JZM  
PROJECT NO.: 170172  
SHEET: 1 OF 1  
DWG. NO.: