

LEASED PORTION OF RAILROAD STREET FOR PAVED PARKING IMPROVEMENTS PER DOCUMENT NOS. 2947941, 4400113 AND 4899855

UNION PACIFIC RAILROAD
RAILROAD STREET
NORTHWEST RIGHT OF WAY LINE OF RAILROAD STREET, A PUBLIC STREET

LEGEND

- ◻ REQUIRED ACCESSIBLE EXIT
- ◻ EXISTING EXIT TO REAR
- ACCESSIBLE ROUTE
- APPROVED SIGNIFYING ACCESSIBLE ENTRANCE
- P/P POWER POLE
- O/E OVERHEAD ELECTRIC LINE
- EROSION CONTROL SILT FENCE
- EXISTING 260 WIRE H.F.S. ON 30' POLE (9'-14.5')
- FIRE HYDRANT

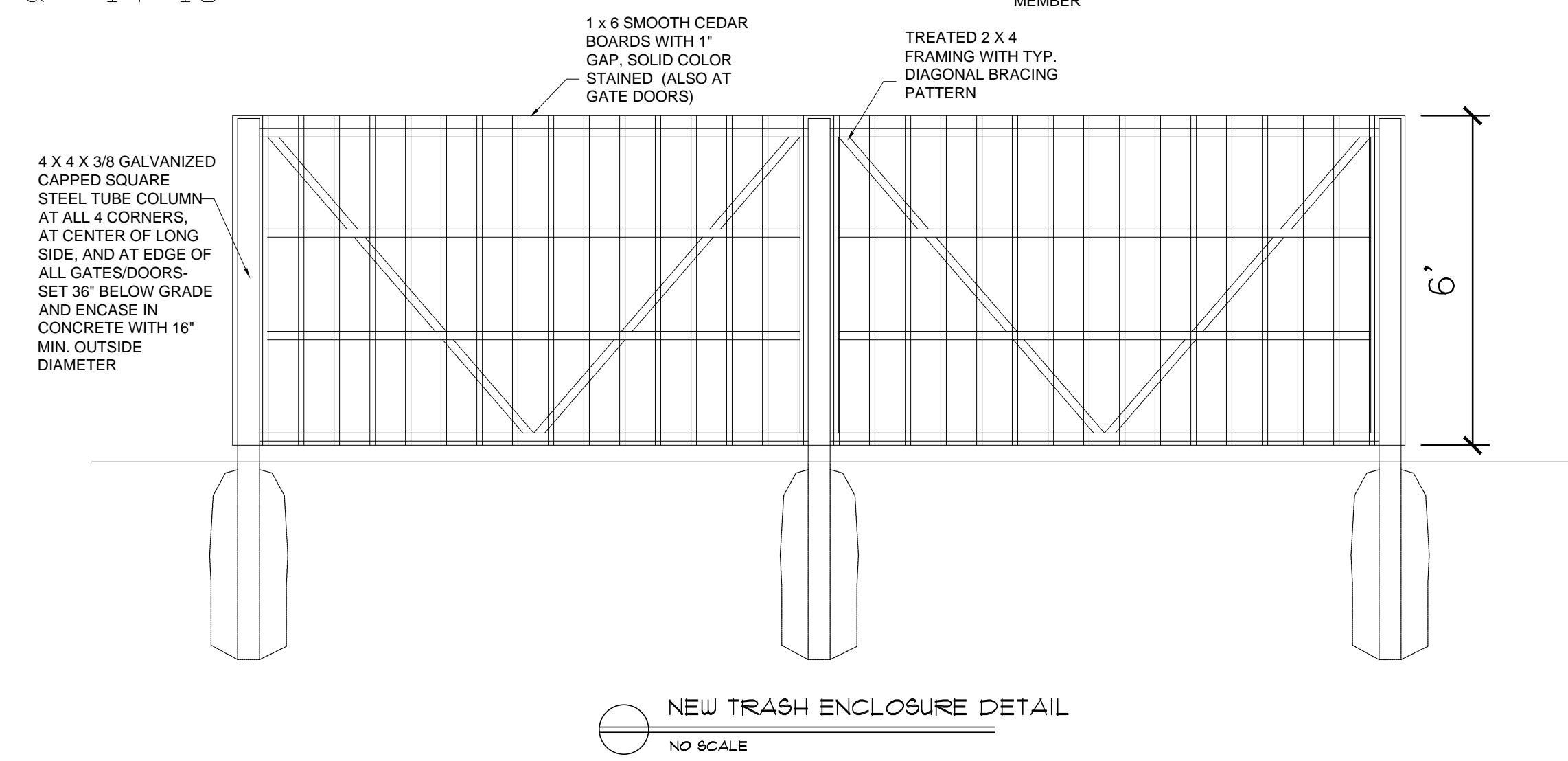

DOUBLE DOOR GATE WITH APPROPRIATE NON-CORROSIVE HARDWARE INCLUDING HINGES, LATCH, CAM-BRACE DOOR WITH GALVANIZED STEEL FRAME, 2 X 2 X 1/4 GALVANIZED ANGLES AROUND PERIMETER AND ACROSS CENTER HORIZONTALLY, WITH DIAGONAL MEMBER

NEW TRASH ENCLOSURE DETAIL
NO SCALE

LEGAL DESCRIPTION
Lots 6, 7, 8, 9, 10, 11, 12, and 13, Block 157,
Original plat of Madison, City of Madison,
Dane County, Wisconsin

REVISED SITE PLAN
SCALE ; 1" = 20'-0"

NOTE:
Revision based on information provided by the project owner to reflect expansion of parking into former railroad right of way. No changes to grading information have been performed as part of this revision.

ACCESSIBILITY NOTES :

- THIS SITE IS NOT SERVED BY PUBLIC TRANSPORTATION.
- THERE IS NO CURB AT THE STOOP FOR THE ACCESSIBLE ENTRANCES.
- MAXIMUM SLOPE OF PARKING ACCESS AISLES AND WALKS TO BUILDING ENTRANCE IS 2% (1:50).

PARKING SPACES:

- 37 LARGE CAR STALLS
- 9 SMALL CAR STALLS
- 3 ACCESSIBLE
- 45 TOTAL STALLS

10/30/17 REVISED

10/3/17	931 EAST MAIN STREET		9449
LIGHT INDUSTRIAL FACILITY RENOVATION FOR COMMON HEALTH DEVELOPMENT, INC. MADISON, WISCONSIN			116 North First Street, Madison, WI 53703 (608)251-2551

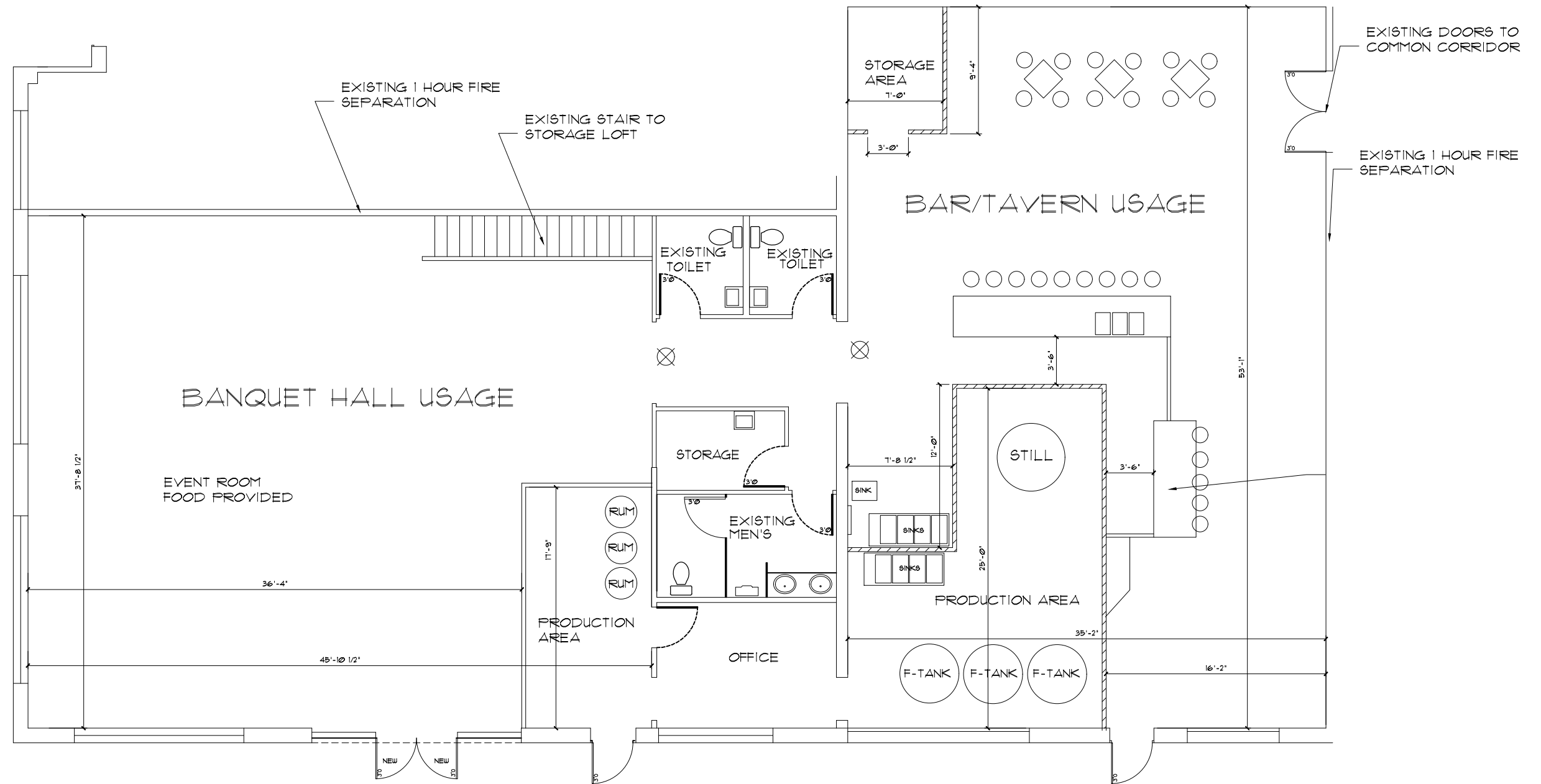

FLOOR PLAN

 0 2 4 6 8 feet