

*Mandarin Translator

ORIGINAL ALCOHOL BEVERAGE LICENSE APPLICATION

Submit to municipal clerk.

For the license period beginning 20 ending June 30 20 10

TO THE GOVERNING BODY of the: Madison City of

County of Aldermanic Dist. No (if required by ordinance)

Table with columns: TYPE, FEE. Rows include Class A beer, Class B beer, Wholesale beer, Class C wine, Class A liquor, Class B liquor, Reserve Class B liquor, Publication fee, TOTAL FEE.

- 1. The named [] INDIVIDUAL [] PARTNERSHIP [] LIMITED LIABILITY COMPANY [x] CORPORATION/NONPROFIT ORGANIZATION

hereby makes application for the alcohol beverage license(s) checked above

2 Name (individual/partners give last name, first, middle; corporations/limited liability companies give registered name): Guo Jian Enterprise INC

An "Auxiliary Questionnaire," Form AT-103, must be completed and attached to this application by each individual applicant, by each member of a partnership, and by each officer, director and agent of a corporation or nonprofit organization, and by each member/manager and agent of a limited liability company.

President/Member Title Guo Jian Lin Name Home Address 4617 Texas Trail Post Office & Zip Code Madison WI 53704

Vice President/Member

Secretary/Member

Treasurer/Member

Agent Guo Jian Lin

Directors/Managers

3. Trade Name Q&Q Asian Buffet Business Phone Number 608-819-6048

4. Address of Premises 1291 N. Sherman Blvd Post Office & Zip Code 53704

5. Is individual, partners or agent of corporation/limited liability company subject to completion of the responsible beverage server training course for this license period? [x] Yes [] No

6. Is the applicant an employe or agent of, or acting on behalf of anyone except the named applicant? [] Yes [x] No

7. Does any other alcohol beverage retail licensee or wholesale permittee have any interest in or control of this business? [] Yes [x] No

8. (a) Corporate/limited liability company applicants only: Insert state WI and date 5/27/10 of registration

(b) Is applicant corporation/limited liability company a subsidiary of any other corporation or limited liability company? [] Yes [x] No

(c) Does the corporation, or any officer, director, stockholder or agent or limited liability company, or any member/manager or agent hold any interest in any other alcohol beverage license or permit in Wisconsin? [] Yes [x] No

(NOTE: All applicants explain fully on reverse side of this form every YES answer in sections 5, 6, 7 and 8 above)

9. Premises description: Describe building or buildings where alcohol beverages are to be sold and stored. The applicant must include all rooms including living quarters, if used, for the sales, service, and/or storage of alcohol beverages and records (Alcohol beverages may be sold and stored only on the premises described) 1291 N. Sherman Blvd

10. Legal description (omit if street address is given above):

11. (a) Was this premises licensed for the sale of liquor or beer during the past license year? [x] Yes [] No

(b) If yes, under what name was license issued? Q&Q Asian Buffet

12. Does the applicant understand they must file a Special Occupational Tax return (TTB form 5630 5) before beginning business? [x] Yes [] No

13. Does the applicant understand a Wisconsin Seller's Permit must be applied for and issued in the same name as that shown in Section 2, above? [x] Yes [] No

14. Is the applicant indebted to any wholesaler beyond 15 days for beer or 30 days for liquor? [] Yes [x] No

READ CAREFULLY BEFORE SIGNING: Under penalty provided by law, the applicant states that each of the above questions has been truthfully answered to the best of the knowledge of the signers.

SUBSCRIBED AND SWORN TO BEFORE ME this 29th day of June, 20 10

Maibeth Witzel-Bell (Clerk/Notary Public)

My commission expires 8-20-12

Guo Jian Lin (Officer of Corporation/Member/Manager of Limited Liability Company/Partner/Individual)

(Officer of Corporation/Member/Manager of Limited Liability Company/Partner)

(Additional Partner(s)/Member/Manager of Limited Liability Company if Any)

TO BE COMPLETED BY CLERK

Table with columns: Date received and filed with municipal clerk, Date reported to council/board, Date provisional license issued, Signature of Clerk / Deputy Clerk, Date license granted, Date license issued, License number issued.

City of Madison Supplemental Class B License Application

| | | |
|--|--|--|
| <input checked="" type="checkbox"/> Seller's Permit Number <input checked="" type="checkbox"/> Federal Employer Identification # <input checked="" type="checkbox"/> Notarized Original Application Form <input checked="" type="checkbox"/> Notarized Supplemental Form <input type="checkbox"/> Orange Sign (Clerk's Office provides at time of application) | <input checked="" type="checkbox"/> Written Description of Premise <input checked="" type="checkbox"/> Background Investigation Form(s) <input type="checkbox"/> Notarized Transfer of Ownership <input checked="" type="checkbox"/> Articles of Incorporation <input type="checkbox"/> *Notarized Appointment of Agent <small>* Corporation/LLC only</small> | <input type="checkbox"/> Floor Plans <input type="checkbox"/> Lease <input type="checkbox"/> Sample Menu <input type="checkbox"/> Business Plan |
|--|--|--|

1. Name of Applicant/Partner/Corporation/LLC Guo Jian Enterprise INC
 2. Address of Licensed Premise 1291 North Sherman Ave Madison, WI 53704
 3. Telephone Number: 608-819-8448 4. Anticipated opening date: open
 5. Mailing address if not opening immediately _____

6. Have you contacted the Alderperson, Police Department District Captain, Alcohol Policy Coordinator, and the neighborhood association representative for the area in which you intend to locate? Yes No

7. Are there any special conditions desired by the neighborhood? Yes No

Explain. _____

8. Business Description, including hours of operation: Resort Restaurant
11am - 10pm

9. Do you plan to have live entertainment? No Yes—What kind? _____

10. Detailed written description of building, including overall dimensions, seating arrangements, capacity, bar size and all areas where alcohol beverages are to be sold and stored. **The licensed premise described below shall not be expanded or changed without the approval of the Common Council.**

6000 sq Ft
Dine in Area
refrigerator

11. Are any living quarters directly or indirectly accessible and under control of the applicant? Yes No
 Please note that alcohol may be sold and stored only on the licensed premise, not in living quarters.

12. Describe existing parking and how parking lot is to be monitored.
own 50 cars shared parking lots

13. Describe your management experience, staffing levels, duties and employee training.
Owner/Manager working all the time.
Five or six employee. After owner get train
he will train them.

14. Identify the **registered agent** for your Corporation or LLC. This is your corporation's agent for service of process, notice or demand required or permitted by law to be served on the corporation.
Guo Jian Lin 1291 N. Sherman Ave Madison WI
 Name Address 53704

15. Utilizing your market research, who would you project your target market to be?

All types of People

16. What age range would you hope to attract to your establishment?

All ages

17. Describe how you plan to advertise/promote your business. What products will you be advertising?

New paper & Food

18. Are you operating under a lease or franchise agreement? Yes (attach a copy) No

19. Owner of building where establishment is located: Alexander

Address of Owner: 145 E. Badger Rd Madison Phone Number 258-5580

20. Private organizations (clubs): Do your membership policies contain any requirement of "Invidious" (likely to give offense) discrimination in regard to race, creed, color, or national origin? Yes No

21. List the Directors of your Corporation/LLC

Guo Jian Lin 1291 N. Sherman Ave Madison, WI 53704
Name Address

Name Address

Name Address

22. List the Stockholders of your Corporation/LLC

Guo Jian Lin 1291 N. Sherman Ave 100%
Name Address % of Ownership
Enterprise Inc. Madison, WI 53704

Name Address % of Ownership

Name Address % of Ownership

23. What type of establishment are you? (Check all that apply) Tavern Nightclub Restaurant

Other Please Explain _____

24. What type of food will you be serving, if any? Chinese, American, Mexican &

Breakfast Lunch Dinner Japanese

25. Please submit a sample menu with your application, if possible. What might eventually be included on your operational menu when you open? Appetizers Salads Soups Sandwiches Entrees

Desserts Pizza Full Dinners

26. During what hours of your operation do you plan to serve food? 11am to 10pm

27. What hours, if any, will food service not be available? 11am NO
28. Indicate any other product/service offered NO
29. Will your establishment have a kitchen manager? Yes No
30. Will you have a kitchen support staff? Yes No
31. How many wait staff do you anticipate will be employed at your establishment? 1 to 2
 During what hours do you anticipate they will be on duty? 11am to 10pm
32. Do you plan to have hosts or hostesses seating customers? Yes No
33. Do your plans call for a full-service bar? Yes No
 If yes, how many bar stools do you anticipate having at your bar? 0
 How many bartenders do you anticipate you would have working at one time on a busy night? 1
34. Will there be a kitchen facility separate from the bar? Yes No
35. Will there be a separate and specific area for eating only? Yes No
 If yes, what will be the seating capacity for that area? _____
36. What type of cooking equipment will you have? Stove Oven Fryers Grill Microwave
37. Will you have a walk-in cooler and/or freezer dedicated solely to the storage of food products? Yes No
38. What percentage of your overall payroll do you anticipate will be devoted to food operation salaries?
55%
39. If your business plan includes an advertising budget, what percentage of your advertising budget do you anticipate will be related to food? 100%
 What percentage of your advertising budget do you anticipate will be drink related? 0%
40. Are you currently, or do you plan to become, a member of the Madison—Dane County Tavern League or the Tavern League of Wisconsin? Yes No
41. Are you currently, or do you plan to become, a member of the Wisconsin Restaurant Association or the National Restaurant Association? Yes No

42. What is your estimated capacity? about 200 seats

43. Pursuant to Chapter 23 of the Madison General Ordinances, all restaurants and taverns serving alcohol beverages shall substantiate their gross receipts for food and alcohol beverage sales broken down by percentage. For new establishments, the percentage will be an estimate.

| | |
|--|------|
| Gross Receipts from Alcoholic Beverages | 1 % |
| Gross Receipts from Food and Non-Alcoholic Beverages | 93 % |
| Gross Receipts from Other | % |
| Total Gross Receipts | 100% |

44. Do you have written records to document the percentages shown? Yes No
You may be required to submit documentation verifying the percentages you've indicated

Read carefully before signing: Under penalty provided by law, the applicant states that the above information has been truthfully completed to the best of the knowledge of the signer. Signer agrees to operate this business according to law and that the rights and responsibilities conferred by the license(s), if granted will not be assigned to another. Any lack of access to any portion of a licensed premise during inspection will be deemed a refusal to permit inspection. Such refusal is a misdemeanor and grounds for revocation of this license.

Subscribed and Sworn to before me:

this 29th day of June, 2010

Maibeyh Witzel-Behl
(Clerk/Notary Public)

My commission expires 8-26-12

Guo Jian Lin
(Officer of Corporation/Member of LLC/Partner/Individual)

Appointment of New Liquor/Beer Agent

To be completed by Corporate Officer or Member of LLC

I, Guo Jian Lin, officer/member for Guo Jian Enterprise Inc
(Corporation/LLC), doing business as Q Q Asian, authorize and appoint
Guo Jian Lin (Name) as the liquor/beer agent for the premise
located at 1291 N. Sherman St.

Subscribed and sworn to before me this

29th Day of June, 2010

Maibeth Witzel-Behl
Notary Public, Dane County, Wisconsin

My Commission Expires 8-26-12

Guo Jian Lin
Signature of Officer/Member

To be completed by appointed Liquor/Beer Agent

I, Guo Jian Lin, appointed liquor/beer agent for
Guo Jian Enterprise (name of Corporation or LLC), being first duly sworn
say I have vested in me, by properly authorized and executed written delegation, full authority
and control of the premise described in the license of such corporation or limited liability
company, and I am involved in the actual conduct of the business as an employee, or have a
direct financial interest in the business of the licensee, therein relating to the intoxicating
liquor/fermented malt beverage. The interest I have in the business is 100 %.

Subscribed and sworn to before me this

29th Day of June, 2010

Maibeth Witzel-Behl
Notary Public, Dane County, Wisconsin

My Commission Expires 8-26-12

Guo Jian Lin
Signature of Agent

The appointed Liquor/Beer Agent must complete the other side of this form.

This document is not yet filed.

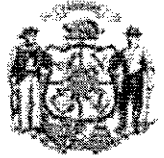

Sec. 180.0202
Wis. Stats.

State of Wisconsin
Department of Financial Institutions

ARTICLES OF INCORPORATION - STOCK FOR-PROFIT CORPORATION

Executed by the undersigned for the purpose of forming a Wisconsin Stock For-Profit Corporation under Chapter 180 of the Wisconsin Statutes:

- Article 1. **Name of the corporation:**
GUOJIAN ENTERPRISE INC. ✓
- Article 2. **The corporation is organized under Ch. 180 of the Wisconsin Statutes.**
- Article 3. **Name of the initial registered agent:**
GUOJIAN LIN
- Article 4. **Street address of the initial registered office:**
1291 N SHERMAN AVE
MADISON, WI 53704
United States of America
- Article 5. **Number of shares of stock the corporation shall be authorized to issue:**
Number of Shares Authorized: 10,000
Class: Common
- Article 6. **Name and complete address of each incorporator:**
XIANJING SHAN
5702 CLAREDON DR
FITCHBURG, WI 53711
United States of America
- Other provisions (optional). (No other provisions declared.)
- Other Information. **This document was drafted by:**
XIANJING SHAN
- Incorporator signature:**
XIANJING SHAN

First Floor Emergency Evacuation Plan

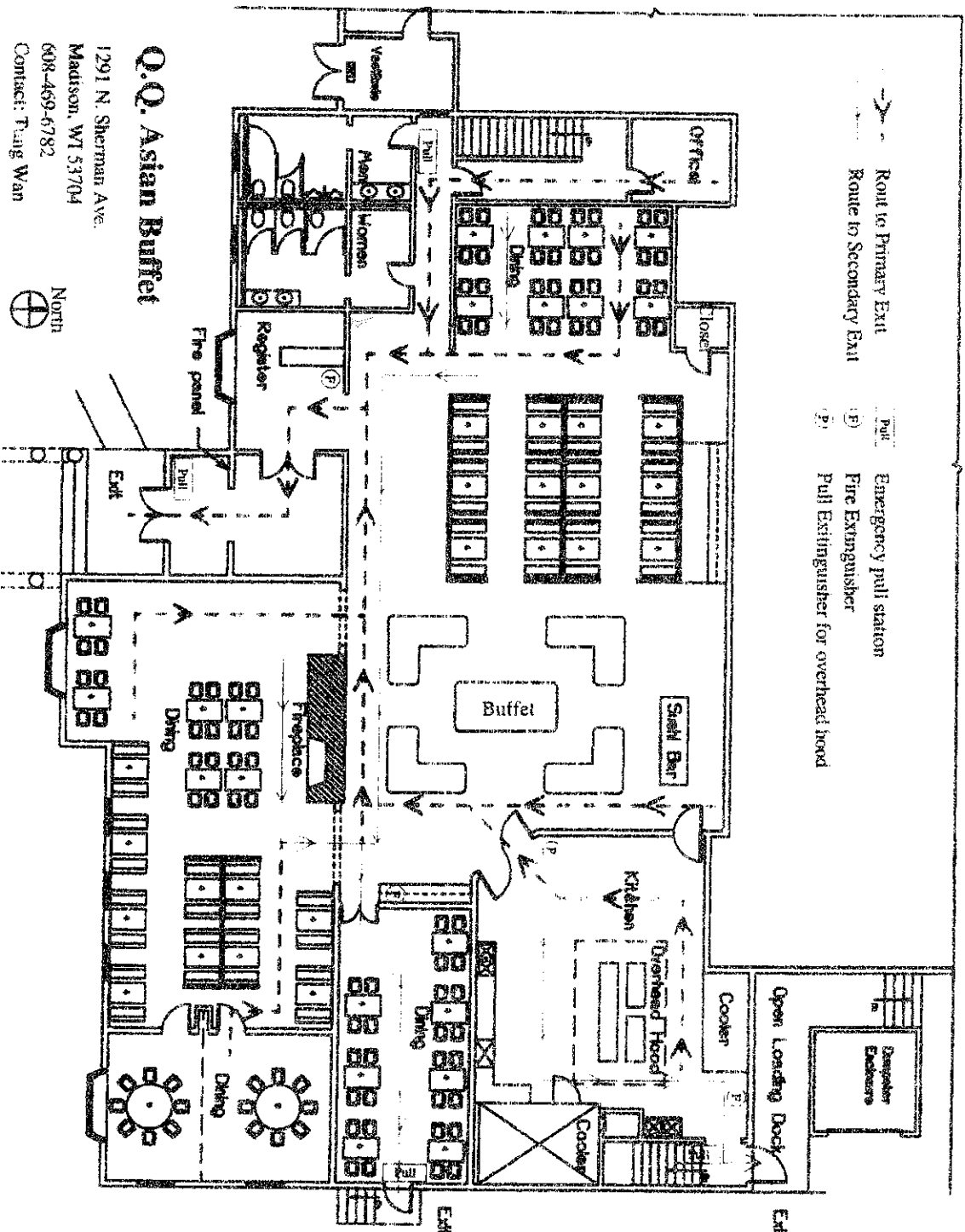

Emergency Procedures

1. Lead manager is responsible for evacuation and emergency medical aid.
2. When a fire is noticed or fire alarm sound, evacuate the building. This will be done by the primary route. Use the secondary route only if the primary route is blocked or unsafe.
 - a. Activate fire alarm system
 - b. Call 911
 - c. Evacuate the building
3. The manager can notify the occupants of a fire by pulling the fire alarm to activate the fire alarm system. The manager can follow up by voice or the intercom system. The manager will indicate the location of the exits.
4. After occupants have started to evacuate the building the manager will insure that everybody has left the building.
5. All customers and employees will go to the far south side of the parking lot at least 200 feet from the building. The manager will take an head count at this time.
6. When the Fire Department arrives, the manager will assist as much as possible.

Q.Q. Asian Buffet

1291 N. Sherman Ave.
 Madison, WI 53704
 608-469-6782
 Contact: Tsung Wan



Lower Level Emergency Evacuation Plan

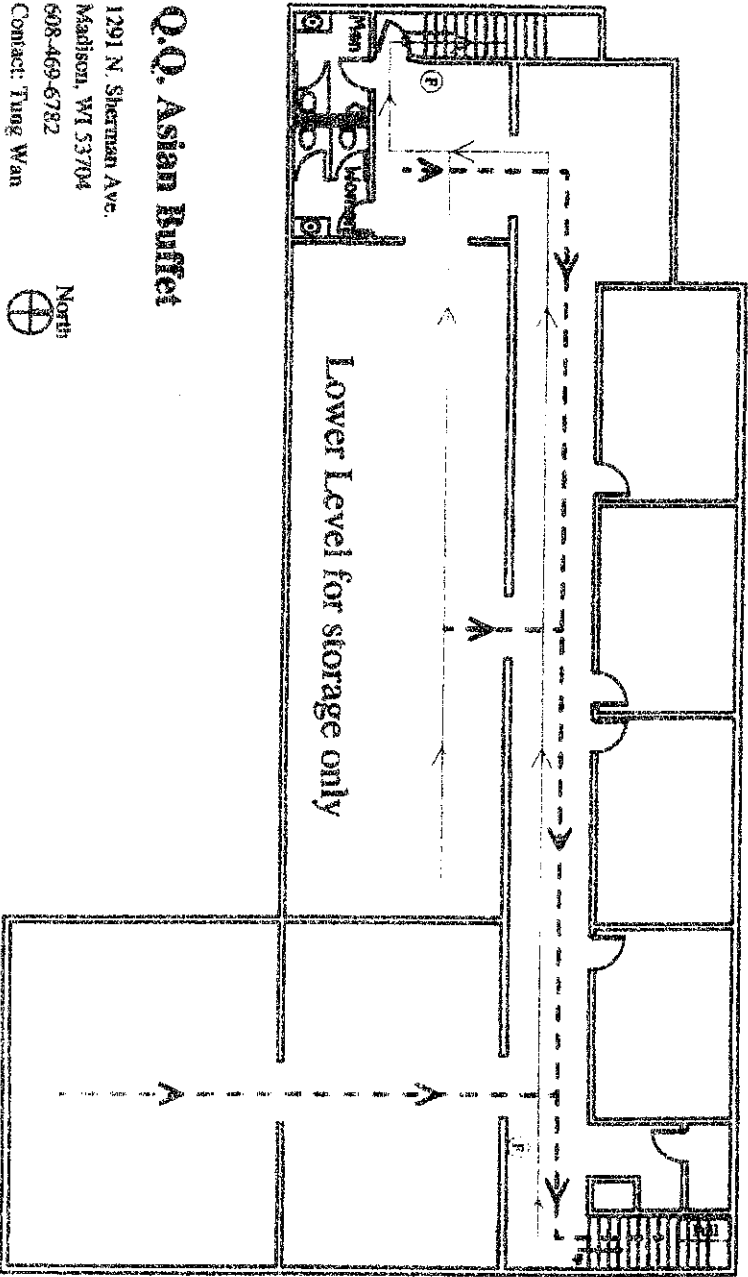
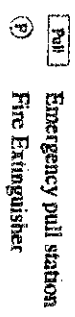
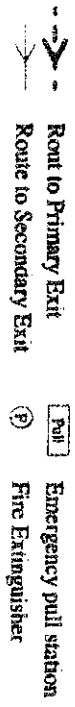

Q.Q. Asian Buffet
 1291 N. Sherman Ave.
 Madison, WI 53704
 608-469-6782
 Contact: Tung Wan



Emergency Procedures

1. Lead manager is responsible for evacuation and emergency medical aid.
2. When a fire is notice or fire alarms sound, evacuate the building. This will be done by the primary route. Use the secondary route only if the primary route is blocked or unsafe.
 - a. Activate fire alarm system
 - b. Call 911
 - c. Evacuate the building
3. The manager can notify the occupants of a fire by pulling the fire alarm to activate the fire alarm system. The manager can follow up by voice or intercom system. The manager will indicate the location of the exits.
4. After occupants have started to evacuate the building the manager will insure that everybody has left the building.
5. All customers and employees will go to the far south side of the parking lot at least 200 feet from the building. The manager will take an head count at this time.
6. When the Fire Department arrives, the manager will assist as much as possible.

APPETIZERS

| | | |
|---------------|---------------------------------------|-----------------|
| 1. | Roast Pork Egg Roll (2) | 1.75 |
| 2. | Shanghai Roll (2) | 1.75 |
| 3. | Chicken Egg Roll (1) | 1.20 |
| 4. | Crab Rangoon (8) | 3.75 |
| 5. | Onion Rings (15) | 3.95 |
| 6. | Fried Chicken Wing (8) | 4.50 |
| 7. | Boneless Spare Ribs (S) 4.95 (L) 8.75 | |
| 8. | Fried or Steamed Dumpling | 3.95 |
| 9. | Chinese Donuts | 3.00 |

SOUP

(w. Crispy Noodles)

| | Pt. | Qt. |
|-----|-----------------|-----------|
| 10. | Egg Drop Soup | 1.30 2.35 |
| 11. | Wonton Soup | 1.50 2.75 |
| 12. | Hot & Sour Soup | 1.95 3.95 |

FRIED RICE

| | Pt. | Qt. |
|-----|----------------------------------|-----------|
| 13. | Vegetable Fried Rice | 3.25 5.75 |
| 14. | Roast Pork or Chicken Fried Rice | 3.55 6.25 |
| 15. | Beef or Shrimp Fried Rice | 3.95 7.25 |
| 16. | House Special Fried Rice | 4.55 7.75 |

LO MEIN

(Soft Noodles)

| | | |
|-----|-------------------------------|-----------|
| 17. | Vegetable Lo Mein | 3.50 6.25 |
| 18. | Roast Pork or Chicken Lo Mein | 3.95 6.55 |
| 19. | Beef or Shrimp Lo Mein | 4.15 7.25 |
| 20. | House Special Lo Mein | 4.95 8.75 |

CHOW MEIN OR CHOP SUEY

(w. Steamed Rice & Dry Noodles)

| | Pt. | Qt. |
|-----|---------------------------|-----------|
| 21. | Chicken or Pork Chow Mein | 4.25 6.95 |
| 22. | Beef or Shrimp Chow Mein | 4.55 7.95 |
| 23. | Vegetable Chow Mein | 3.50 5.95 |
| 24. | House Special Chow Mein | 4.75 8.45 |

EGG FOO YOUNG

(w. Steamed Rice)

Order

| | | |
|-----|------------------------------|------|
| 25. | Vegetable Egg Foo Young | 5.45 |
| 26. | Roast Pork Egg Foo Young | 5.75 |
| 27. | Beef or Shrimp Egg Foo Young | 6.75 |
| 28. | Chicken Egg Foo Young | 5.75 |
| 29. | Mushroom Egg Foo Young | 5.45 |
| 30. | House Special Egg Foo Young | 6.95 |

Hot & Spicy

We can alter the spicy according to your taste

CHICKEN

(w. Steamed Rice)

Order

| | | |
|-----|-----------------------------|------|
| 31. | Moo Goo Gai Pan | 7.95 |
| 32. | Chicken w. Mushroom | 7.95 |
| 33. | Chicken w. Cashew Nuts | 7.95 |
| 34. | Chicken w. Mixed Vegetables | 7.95 |
| 35. | Chicken w. Broccoli | 7.95 |
| 36. | Sweet & Sour Chicken | 7.95 |
| 37. | Mongolian Chicken | 7.95 |
| 38. | Hunan Chicken | 7.95 |
| 39. | Chicken w. Szechuan Sauce | 7.95 |
| 40. | Kung Po Chicken | 7.95 |
| 41. | Chicken w. Garlic Sauce | 7.95 |
| 42. | Hot & Spicy Chicken | 7.95 |

PORK

(w. Steamed Rice)

Order

| | | |
|-----|---------------------------|------|
| 43. | Roast Pork w. Chinese Veg | 7.55 |
| 44. | Roast Pork w. Broccoli | 7.55 |
| 45. | Hunan Pork | 7.55 |
| 46. | Pork w. Garlic Sauce | 7.55 |
| 47. | Hot & Spicy Pork | 7.55 |
| 48. | Szechuan Pork | 7.55 |

BEEF

(w. Steamed Rice)

Order

| | | |
|-----|----------------------------|------|
| 49. | Pepper Steak w. Onion | 8.75 |
| 50. | Beef w. Chinese Vegetables | 8.75 |
| 51. | Beef w. Broccoli | 8.75 |
| 52. | Beef w. Mixed Vegetable | 8.75 |
| 53. | Mongolian Beef | 8.75 |
| 54. | Beef w. Curry Sauce | 8.75 |
| 55. | Beef w. Garlic Sauce | 8.75 |
| 56. | Hot & Spicy Beef | 8.75 |
| 57. | Szechuan Beef | 8.75 |

SEAFOOD

(w. Steamed Rice)

Order

| | | |
|-----|---------------------------|------|
| 58. | Shrimp w. Lobster Sauce | 9.35 |
| 59. | Shrimp w. Mixed Vegetable | 9.35 |
| 60. | Shrimp w. Broccoli | 9.35 |
| 61. | Shrimp w. Cashew Nuts | 9.35 |
| 62. | Hunan Shrimp | 9.35 |
| 63. | Shrimp w. Garlic Sauce | 9.35 |
| 64. | Kung Bo Shrimp | 9.35 |
| 65. | Hot & Spicy Shrimp | 9.35 |

MAI FUN

(Soft Rice Noodles)

Order

| | | |
|-----|-------------------------------|------|
| 66. | Vegetable Mai Fun | 6.50 |
| 67. | Beef or Shrimp Mai Fun | 7.50 |
| 68. | Chicken or Roast Pork Mai Fun | 7.25 |
| 69. | House Special Mai Fun | 8.75 |
| 70. | Singapore Mai Fun | 8.75 |

Lunch Special

(Mon. - Sat: 11:00 am to 3:00 pm)

All Served w. Pork Fried Rice

CHICKEN \$4.50

- L 1. MOO GOO GAI PAN
- L 2. CHICKEN W. CASHEW NUTS
- L 3. SWEET & SOUR CHICKEN
- L 4. CHICKEN W. BROCCOLI
- L 5. SESAME CHICKEN
- L 6. 🍴 GENERAL TSO's CHICKEN

BEEF \$4.75

- L 7. BEEF W. BROCCOLI
- L 8. BEEF W. MIXED VEGETABLES
- L 9. 🍴 MONGOLIAN BEEF

PORK \$4.50

- L10. ROAST PORK W. MIXED VEGETABLE
- L11. BONELESS RIBS

SEAFOOD \$5.15

- L12. SHRIMP W. LOBSTER SAUCE
- L13. 🍴 SHRIMP & CHICKEN SZECHUAN STYLE
- L14. 🍴 SHRIMP W. GARLIC SAUCE

VEGETABLE \$4.50

- L15. CHINESE VEGETABLE COMBO
- L16. 🍴 BROCCOLI W. GARLIC SAUCE



SPECIAL DIET FOOD

(All Steamed)

(w. White Rice) (Sauce on the Side)

(You can Choose from: White, Garlic or Brown Sauce)

- D 1. Mixed Vegetables 6.75
- D 2. Chicken w. Broccoli 7.95
- D 3. Jumbo Shrimp w. Mixed Vegetables 9.35
- D 4. Chicken w. Mixed Vegetables 7.95
- D 5. Jumbo Shrimp w. Broccoli 9.35
- D 6. Fresh Scallop w. Mixed Vegetables 9.50
- D 7. Fresh Scallop w. Broccoli 9.50
- D 8. Jumbo Shrimp, Scallop, Chicken
w. Mixed Vegetables 9.75

OUR CHEF'S SPECIALTIES

(w. White Rice)

- S 1. SEAFOOD DELIGHT 10.95
Lobster meat, jumbo shrimp, crab meat sauteed w. assorted Chinese vegetables.
- S 2. KING LOBSTER HONG KONG 10.95
Jumbo shrimp, lobster meat, crab meat, peas & straw mushrooms w. lobster in Cantonese sauce
- S 3. SPECIAL FOUR SEASONS 10.95
Fresh shrimp, scallop, roast pork & chicken w. straw mushrooms, baby corn, Chinese vegs. & broccoli.
- S 4. BONELESS CHICKEN 8.25
Boneless chicken breaded then fried to golden brown on top & variety Chinese vegetables
- S 5. LEMON CHICKEN 8.25
Tender chicken breast deep fried to golden brown on top & variety Chinese vegetables
- S 6. HAPPY FAMILY 10.50
Fresh shrimp, chicken, roast pork, beef w. broccoli & baby corn
- S 7. CRISPY SESAME BEEF 9.75
Perfectly aged beef carefully sliced, cooked w. chef's own recipe, sprinkled w. sesame seeds.
- S 8. CRISPY SESAME CHICKEN 9.25
- S 9. 🍴 GENERAL TSO's CHICKEN 9.25
The general favorite dish. Tender chunks of young chicken marinated in red sauce
- S10. 🍴 SZECHUAN DOUBLE DELIGHT 10.95
Szechuan beef & hot & spicy shrimp
- S11. 🍴 SUBGUM WONTON 9.95
Shrimp, chicken & pork with broccoli, baby corn, straw mushroom, snow peas & Chinese vegetables & fried wontons
- S12. 🍴 DRAGON & PHOENIX 9.95
General tso's chicken & shrimp in garlic sauce
- S13. 🍴 TRIPLE HUMAN STYLE 9.50
- S14. 🍴 DOUBLE DELIGHT W. GARLIC SAUCE 10.95
Fresh jumbo shrimp and sea scallops sauteed with snow peas, pepper, waterchestnuts & broccoli
- S15. TRIPLE DELIGHT 9.95
Beef, chicken, shrimp w. mixed vegetables
- S16. 🍴 STEAK W. ORANGE PEELS 9.75
Tender steak sliced braised in chef's special sauce
- S17. 🍴 KUNG PAO COMBINATION 9.50
Chicken & shrimp
- S18. HAWAIIAN Five " O" 10.95
Lobster, shrimp, chicken, roast pork & beef w. mixed Chinese vegs. in house special sauce
- S19. DICED CHICKEN & BABY SHRIMP 9.50
- S21. 🍴 ORANGE CHICKEN 9.25
- S22. HONEY CHICKEN 9.25

Any Dish Not Listed Can Be Made
Please Ask!!!

SIDE ORDER

- Steamed Rice (Pt.) 1.25 (Qt.) 2.25
- Fried Noodles (Bag) 0.50
- Fortune Cookies (5) 0.50
- Almond Cookies (4) 0.60
- Sweet & Sour Sauce (8oz) 0.50