



8 2 5 6 0 4 7
Tx:8158164

KRISTI CHLEBOWSKI
DANE COUNTY
REGISTER OF DEEDS

DOCUMENT #
4758935

04/20/2011 12:40 PM

Trans. Fee:

Exempt #:

Rec. Fee: 30.00

Pages: 5

Document Number

Document Title

ANNEXATION ORDINANCE

This is to certify that the foregoing ordinance was adopted by the Common Council of the City of Madison, Wisconsin at a meeting held on the 19th day of October, 2010.

Sturdevant Annexation
Ordinance #: ORD-10-00102
ID#: 19997

Name and Return Address

City Clerk
210 Martin Luther King Jr. Blvd.
Room 103
Madison, WI 53703

0810-344-9660-2

Parcel Identification Number (PIN)

April 20, 2011

Date

Maribeth Witzel-Behl
Signature of Clerk

Maribeth Witzel-Behl, City Clerk

*Name printed

Date

n/a
Signature of Grantor

*Name printed

STATE OF WISCONSIN, County of Dane

This document was drafted by:
(print or type name below)

Subscribed and sworn to before me on April 20, 2011 by the above named person(s).

Signature of notary or other person
authorized to administer an oath Eric
(as per s. 706.06, 706.07)

*Names of persons signing in any
capacity must be typed or printed below
their signature.

Print or type name: ERIC CHRISTIANSON

Title: NOTARY PUBLIC Date commission expires: 6/29/2014

This information must be completed by submitter: document title, name & return address, and PIN (if required). Other information such as the granting clauses, legal description, etc., may be placed on this first page of the document or may be placed on additional pages of the document. Note: Use of this cover page adds one page to your document and \$2.00 to the recording fee. Wisconsin Statutes, 59.43(2m). **USE BLACK INK.** WRDA 5/1999

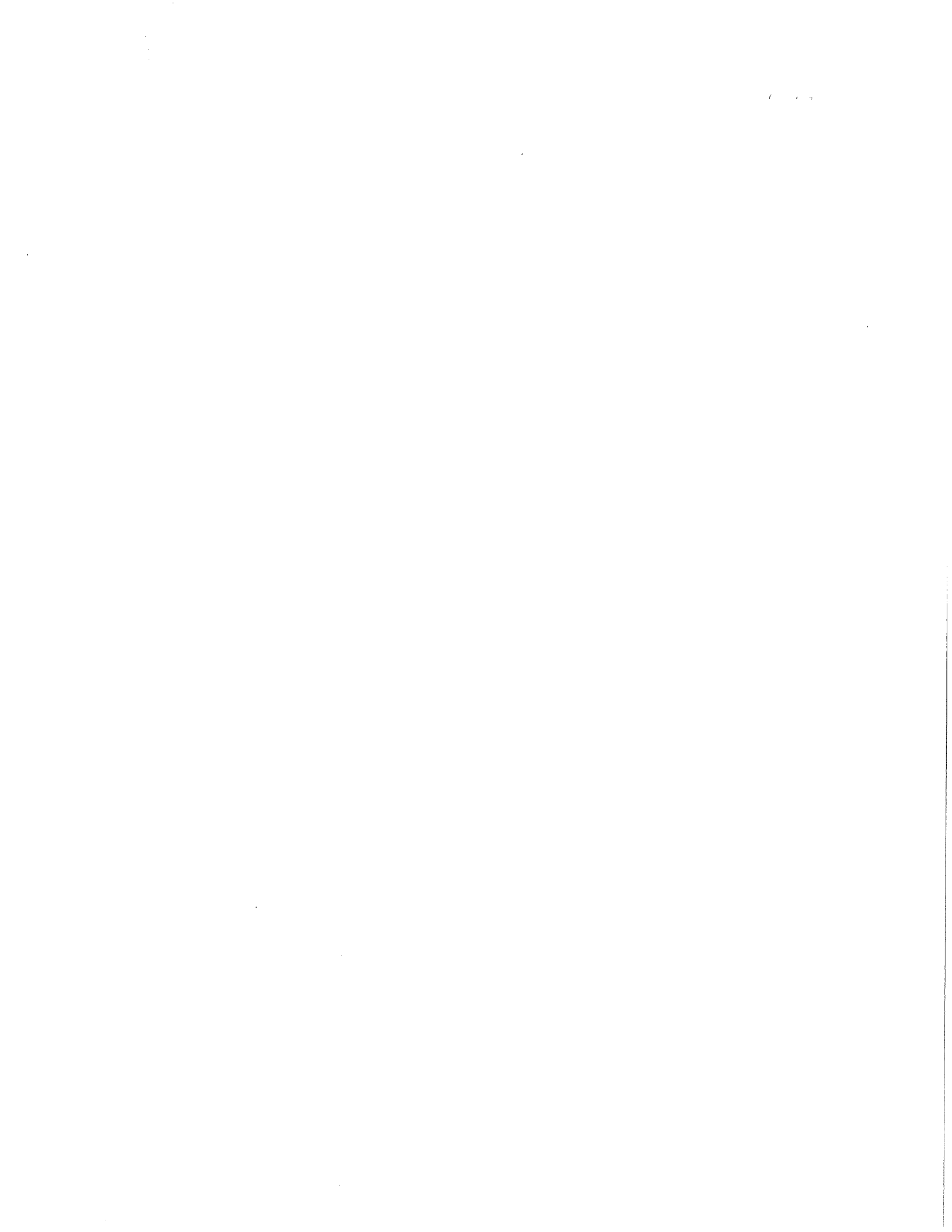



Madison City Clerk's Office

210 Martin Luther King, Jr. Boulevard, Room 103, Madison, WI 53703-3342
PH: 608 266 4601 • TDD: 608 266 6573 • FAX: 608 266 4666
voting@cityofmadison.com • licensing@cityofmadison.com • clerk@cityofmadison.com
www.cityofmadison.com/clerk • www.cityofmadison.com/election
We exist to assist.

April 20, 2011

Dane County Register of Deeds
City County Building Room 110
210 Martin Luther King Jr. Blvd.
Madison, WI 53703

Dear Register of Deeds,

ENACTMENT NO. ORD-10-00102
ID NO. 19997
Future Sturdevant Annexation

I, Maribeth Witzel-Behl, City Clerk of the City of Madison, County of Dane, State of Wisconsin, pursuant to Sections 66.0217(7)2., 66.0217(9)(a), and 66.0235, Wisconsin Statutes, do hereby certify adoption of an intent to annex Enactment No. ORD-10-00102, ID No. 19997 on October 19, 2010; thereby accepting the petition filed in our office on September 13, 2010, and thereby detaching territory from the Town of Burke and annexing same to the City of Madison as of November 1, 2015. The current property identification number is 0810-344-9660-2.

This letter shall serve as notice that the Common Council failed to reject the Petition for Annexation, accepted the Petition for Direct Annexation and adopted the above noted ordinance. A certified copy of Enactment No. ORD-10-00102, which contains an accurate metes and bounds description of the territory so affected, is attached. The Petition for Direct Annexation filed in this matter identifies the population in the annexed territory to be zero (0).

Sincerely,

Maribeth Witzel-Behl
Maribeth Witzel-Behl
City Clerk

SUBSCRIBED AND SWORN TO BEFORE ME

this 20th day of April, 2011

[Signature]

Notary Public

Commission Expires 6/29/2014

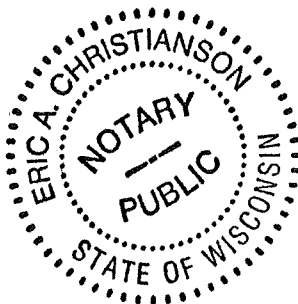

MWB:tel

Handwritten text, possibly a signature or name, located in the lower-left quadrant of the page.

Handwritten text, possibly a date or another signature, located in the lower-right quadrant of the page.





City of Madison

City of Madison
Madison, WI 53703
www.cityofmadison.com

Certified Copy

Ordinance: ORD-10-00102

File Number: 19997

Enactment Number: ORD-10-00102

Creating Section 15.01(575) of the Madison General Ordinances entitled "City Boundaries" attaching to the Sturdevant Attachment and assigning a temporary zoning classification of A Agriculture District.

DRAFTER'S ANALYSIS: This ordinance attaches land in the Town of Burke. Pursuant to the Cooperative Plan with the Town of Burke, City of Sun Prairie, Village of DeForest, a property owner may obtain municipal water and sewer with an agreement to pay for the costs of the service and attaching to the city in five (5) years.

An ordinance to create Subsection (575) of Section 15.01 of the General Ordinances of the City of Madison entitled "City Boundaries" and being part of the chapter entitled "Aldermanic Districts and Wards".

WHEREAS, a petition for attachment with scale map attached was filed with the City Clerk of Madison on September 13, 2010, and has been presented to the Madison Common Council requesting attachment of the below-described territory to the City of Madison from the Town of Burke; said petition having been signed by the owners of all of the land in the territory; there being no residents or electors; and notice of the proposed attachment having been given to the Town of Burke; and

WHEREAS, pursuant to Wis. Stat. § 66.0217(14)(a)1., the City of Madison agrees to pay annually to the Town of Burke, for five (5) years, an amount equal to the amount of property taxes that the town levied on the attached territory, as shown by the tax roll under Wis. Stat. § 70.65, in the year in which the attachment is final; and

WHEREAS, investigation by the City of Madison discloses that as of this date the above representations are true, the Common Council now accepts the petition as sufficient and determines that the said attachment proceeding meets the requirements of the City of Madison and Town of Burke Cooperative Plan approved pursuant to Wis. Stat. § 66.0307;

NOW, THEREFORE, the Common Council of the City of Madison do ordain as follows:

1. Subsection (575) of Section 15.01 of the Madison General Ordinances is hereby created to read as follows:

"15.01(575) - There is hereby attached to the City of Madison, Dane County, Wisconsin, the following described property:

Being a part of the Southeast Quarter of the SE ¼ of Section 34, Township 08N, Range 10E, Town of Burke, Dane County, Wisconsin, more fully described as follows:

Commencing at the southeast corner of Lot 1, Certified Survey Map Number 11073, as recorded in Volume 66 of Certified Survey Maps, on pages 265-268, as Document Number 3916860, Dane County Registry; thence S89°57'W along the south line of said CSM, 143.55 feet to the point of beginning; thence S00°02'12"W, 150.00 feet; thence S89°57'W, 178.1 feet, more or less, to the centerline of Eagle Crest Drive; thence N00°02'40"W to the westerly extension of the south line of the aforementioned Certified Survey Map Number 11073; thence N89°57'E along said south line, 178.31 feet, more or less, to the point of beginning. This parcel contains 26,730 square feet or 0.6136 acres.

Bearings are based upon the west line of the SE Quarter of the SE Quarter of said Section 34 assumed to bear N00°06'E per Andrew Dahlen Map 3332."

2. If any provision of this ordinance is invalid or unconstitutional, or if the application of this ordinance to any person or circumstances is invalid or unconstitutional, such invalidity or

unconstitutionality shall not affect the other provisions or applications of this ordinance which can be given effect without the invalid or unconstitutional provision or application.

3. This ordinance shall be effective on November 1, 2015.

EDITOR'S NOTE: At the time the attachment becomes effective, the land will be added to the appropriate aldermanic district and ward.

I, Maribeth Witzel-Behl, certify that this is a true copy of Ordinance No. 19997, passed by the COMMON COUNCIL on 10/19/2010.

Maribeth Witzel-Behl
Maribeth Witzel-Behl

4-18-2011
Date Certified

EXHIBIT B.

ATTACHMENT TO THE CITY OF MADISON

ORDINANCE No. _____
 I.D. No. _____
 DATE ADOPTED _____
 DATE PUBLISHED _____

ALD. DISTRICT ANNEXED TO _____
 AREA 26,730 SQ. FT. 0.6136 ACRES

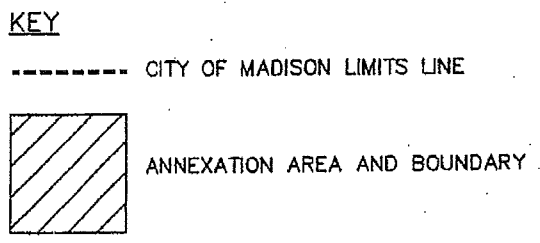
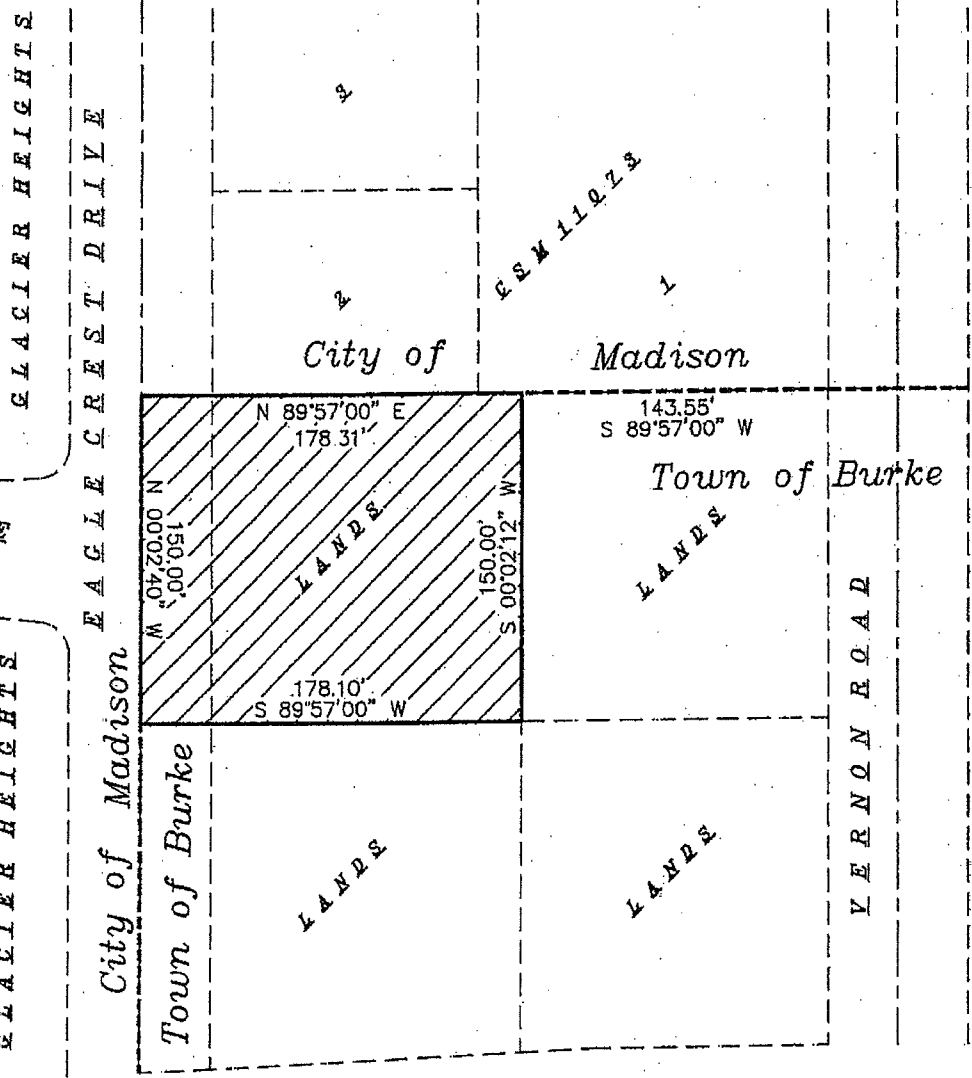
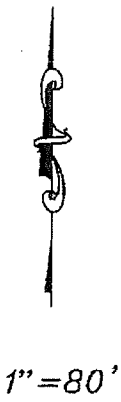

NOTE: Please be advised that the document grantor(s) hereby direct viewers to ignore the printed text material on this exhibit. Only the spatial relationships of the illustrations on the plan are being presented for your information.

Signed by grantor(s) or grantor's(s)' agent: Maribeth Witzel-Behl Date: _____ (USE BLACK INK ONLY)
 Name of grantor(s) or grantor's(s)' agent printed: Maribeth Witzel-Behl (USE BLACK INK ONLY)

