



Office of the Mayor

David J. Cieslewicz, Mayor

RECEIVED-CITY OF MADISON
CLERKS OFFICE

05 JUL 22 PM 2: 52

City-County Building, Room 403
210 Martin Luther King, Jr. Boulevard
Madison, Wisconsin 53703-3345
PH 608 266 4611
TTY 608 266 4443
FAX 608 267 8671
mayor@cityofmadison.com

March 22, 2005

TO ALL DEPARTMENTS, MADISON MUNICIPAL GOVERNMENT, AND
OTHER INTERESTED AGENCIES:

SUBJECT: Holley Attachment

ORDINANCE 05-00062, I D. 00655

The Common Council, at its meeting on Tuesday, March 15, 2005, adopted Ordinance, I D. 00655, annexing the territory as shown on the attached map to Aldermanic District 1, City of Madison. This annexed property includes vacant land

This territory is subject to all rules, regulations, and ordinances governing said district in the City of Madison. You are hereby requested to furnish the usual municipal services to this area, upon receipt of this notice. If you have any questions or require additional information, contact Bill Roberts or Sheri Milleville at 266-4635

APR 1 2005

ATTACHMENT TO THE CITY OF MADISON

ORDINANCE No. _____
 FILE No. _____
 DATE ADOPTED _____

DATE PUBLISHED _____
 ALD DISTRICT ATTACHED TO 1st
 AREA 16.6 ACRES OR 0.0259 SQ. MI.

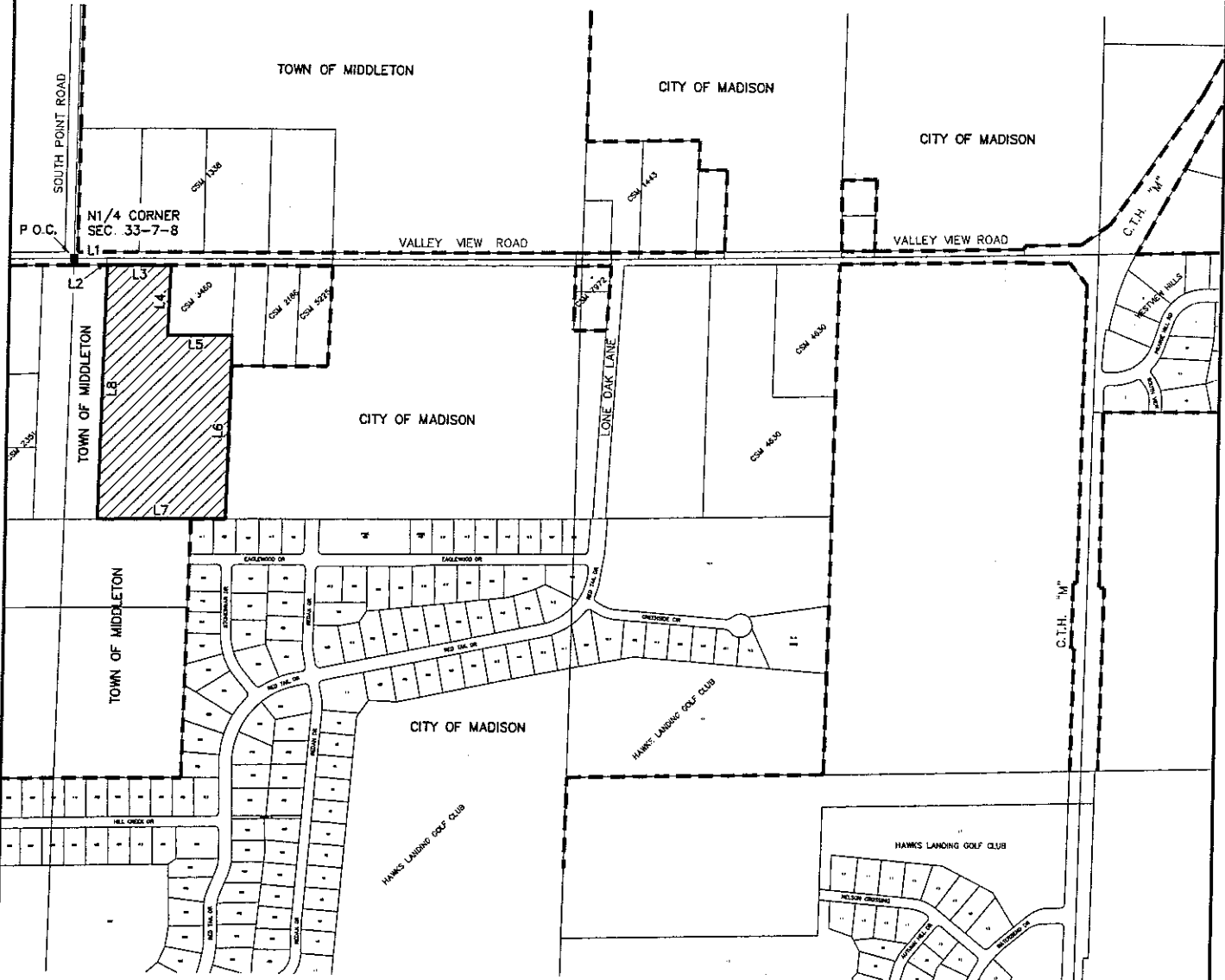

LINE TABLE

NUMBER	DIRECTION	DISTANCE
L1	N 90°00'00" E	172.36'
L2	S 01°49'54" W	33.02'
L3	N 90°00'00" E	320.43'
L4	S 01°49'00" W	358.44'
L5	N 90°00'00" E	334.00'
L6	S 01°49'00" W	931.84'
L7	S 89°55'27" W	654.80'
L8	N 01°49'54" E	1291.16'



SCALE: ONE INCH = EIGHT HUNDRED FEET

KEY

- CITY OF MADISON LIMITS LINE
- ATTACHMENT AREA AND BOUNDARY



BEARINGS REFERENCED TO THE
 NORTH LINE OF THE NE 1/4 OF
 SECTION 33-7-8 RECORDED
 AS N90°00'00"E.