



City of Madison Fire Department

314 W Dayton Street, Madison, WI 53703
Phone: 608-266-4420 • Fax: 608-267-1100 • E-mail: fire@cityofmadison.com

Project Address: 413-417 West Mifflin Street & 418-446 West Washington Avenue

Contact Name & Phone #: Johnathan Lilley, PE - Vierbicher 608-821-3983

FIRE APPARATUS ACCESS AND FIRE HYDRANT WORKSHEET

1. Is the building completely protected by an NFPA 13 or 13R automatic fire sprinkler system? If non-sprinklered , fire lanes extend to within 150-feet of all portions of the exterior wall? If sprinklered , fire lanes are within 250-feet of all portions of the exterior wall?	<input type="checkbox"/> Yes <input type="checkbox"/> Yes <input checked="" type="checkbox"/> Yes	<input checked="" type="checkbox"/> No <input type="checkbox"/> No <input type="checkbox"/> No	<input type="checkbox"/> N/A <input type="checkbox"/> N/A <input type="checkbox"/> N/A
2. Is the fire lane constructed of concrete or asphalt, designed to support a minimum load of 85,000 lbs? a) Is the fire lane a minimum unobstructed width of at least 20-feet? b) Is the fire lane unobstructed with a vertical clearance of at least 13½-feet? c) Is the minimum inside turning radius of the fire lane at least 28-feet? d) Is the grade of the fire lane not more than a slope of 8%? e) Is the fire lane posted as fire lane? (Provide detail of signage.) f) Is a roll-able curb used as part of the fire lane? (Provide detail of curb.) g) Is part of a sidewalk used as part of the required fire lane? (Must support +85,000 lbs.)	<input checked="" type="checkbox"/> Yes <input checked="" type="checkbox"/> Yes <input checked="" type="checkbox"/> Yes <input type="checkbox"/> Yes <input checked="" type="checkbox"/> Yes <input checked="" type="checkbox"/> Yes <input type="checkbox"/> Yes <input type="checkbox"/> Yes	<input type="checkbox"/> No <input type="checkbox"/> No <input type="checkbox"/> No <input type="checkbox"/> No <input type="checkbox"/> No <input type="checkbox"/> No <input type="checkbox"/> No <input checked="" type="checkbox"/> No <input checked="" type="checkbox"/> No	<input type="checkbox"/> N/A <input type="checkbox"/> N/A <input type="checkbox"/> N/A <input checked="" type="checkbox"/> N/A <input type="checkbox"/> N/A <input type="checkbox"/> N/A <input type="checkbox"/> N/A <input type="checkbox"/> N/A <input type="checkbox"/> N/A
3. Is the fire lane obstructed by security gates or barricades? If yes: a) Is the gate a minimum of 20-feet clear opening? b) Is an approved means of emergency operations installed, key vault, padlock or key switch?	<input type="checkbox"/> Yes <input type="checkbox"/> Yes <input type="checkbox"/> Yes	<input checked="" type="checkbox"/> No <input type="checkbox"/> No <input type="checkbox"/> No	<input type="checkbox"/> N/A <input checked="" type="checkbox"/> N/A <input checked="" type="checkbox"/> N/A
4. Is the Fire lane dead-ended with a length greater than 150-feet? If yes, does the area for turning around fire apparatus comply with IFC D103?	<input type="checkbox"/> Yes <input type="checkbox"/> Yes	<input checked="" type="checkbox"/> No <input type="checkbox"/> No	<input type="checkbox"/> N/A <input checked="" type="checkbox"/> N/A
5. Is any portion of the building to be used for high-piled storage in accordance with IFC Chapter 3206.6 If yes, see IFC 3206.6 for further requirements.	<input type="checkbox"/> Yes	<input checked="" type="checkbox"/> No	<input type="checkbox"/> N/A
6. Is any part of the building <u>greater than 30-feet</u> above the grade plane? If yes, answer the following questions: a) Is the aerial apparatus fire lane parallel to one entire side of the building and covering at least 25% of the perimeter? b) Is the near edge of the aerial apparatus fire lane between 15' and 30' from the building? c) Are there any overhead power or utility lines located across the aerial apparatus fire lane? d) Are there any tree canopies expected to grow across the aerial fire lane? (Based on mature canopy width of tree species) e) Does the aerial apparatus fire lane have a minimum unobstructed width of 26-feet? f) Is the space between the aerial lane and the building free of trees exceeding 20' in heights?	<input checked="" type="checkbox"/> Yes <input checked="" type="checkbox"/> Yes <input type="checkbox"/> Yes <input checked="" type="checkbox"/> Yes <input checked="" type="checkbox"/> Yes <input type="checkbox"/> Yes	<input type="checkbox"/> No <input type="checkbox"/> No <input checked="" type="checkbox"/> No <input type="checkbox"/> No <input type="checkbox"/> No <input type="checkbox"/> No	<input type="checkbox"/> N/A <input type="checkbox"/> N/A <input type="checkbox"/> N/A <input type="checkbox"/> N/A <input type="checkbox"/> N/A <input type="checkbox"/> N/A
7. Are all portions of the required fire lanes within 500-feet of at least (2) hydrants? <i>Note: Distances shall be measured along the path of the hose lay as it comes off the fire apparatus.</i> a) Is the fire lane at least 26' wide for at least 20-feet on each side of the hydrants? b) Is there at least 40' between a hydrant and the building? c) Are the hydrant(s) setback no less than 5-feet nor more than 10-feet from the curb or edge of the street or fire lane? d) Are hydrants located in parking lot islands a minimum of 3½-feet from the hydrant to the curb? e) Are there no obstructions, including but not limited to: power poles, trees, bushes, fences, posts located, or grade changes exceeding 1½-feet, within 5-feet of a fire hydrant? <i>Note: Hydrants shall be installed and in-service prior to combustible construction on the project site.</i>	<input checked="" type="checkbox"/> Yes <input checked="" type="checkbox"/> Yes <input checked="" type="checkbox"/> Yes <input checked="" type="checkbox"/> Yes <input type="checkbox"/> Yes <input checked="" type="checkbox"/> Yes	<input type="checkbox"/> No <input type="checkbox"/> No <input type="checkbox"/> No <input type="checkbox"/> No <input type="checkbox"/> No <input type="checkbox"/> No	<input type="checkbox"/> N/A <input type="checkbox"/> N/A <input type="checkbox"/> N/A <input type="checkbox"/> N/A <input checked="" type="checkbox"/> N/A <input type="checkbox"/> N/A

Attach an additional sheet if further explanation is required for any answers.

This worksheet is based on **MGO 34.503** and **IFC 2021 Edition Chapter 5 and Appendix D**; please see the codes for further information.

- FIRE ACCESS LEGEND**
- HOSE LAY FROM FIRE LANE
 - HOSE LAY FROM FIRE HYDRANT
 - 26' AERIAL FIRE LANE ACCESS
 - PROPOSED FIRE LANE (WIDTH NOTED)
 - EXISTING WATER MAIN
 - EXISTING FIRE HYDRANT
 - EXISTING FIRE DEPARTMENT CONNECTION
 - WATER MAIN
 - FIRE HYDRANT
 - FIRE DEPARTMENT CONNECTION
 - NO PARKING
FIRE LANE FIRE LANE NO PARKING SIGN (12"x18")
LOCATION(S) TO BE DETERMINED BY
FIRE DEPARTMENT OR MUNICIPALITY

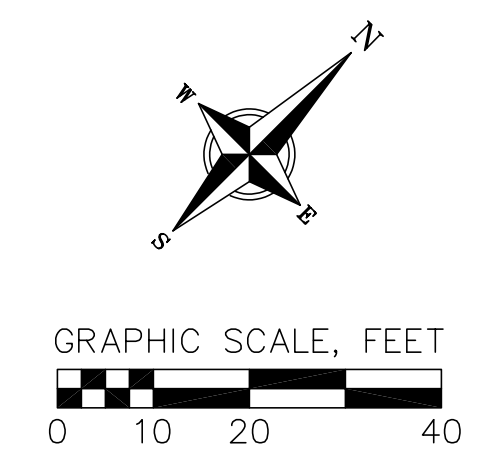

vierbicher
planners | engineers | advisors

909 FOURTH DRIVE, SUITE 100
MADISON, WI 53715
PH: 608.656.4525

Lamar Johnson Collaborative

35 EAST HACKER DRIVE, SUITE 100
CHICAGO, IL 60611
PH: 312.669.0747

MIFFLIN CHAPTER

CRG ADDRESS: LOTS 418-446 W WASHINGTON, AND 413-417 W MIFFLIN
LAND USE APPLICATION / UDC SUBMISSION

DRAWING ISSUE		
#	DESCRIPTION	DATE
1	LUA SUBMISSION	9/23/24
1	UDC SUBMISSION	9/23/24

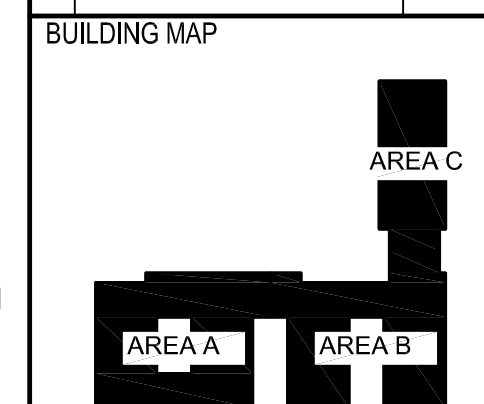

DRAWING TITLE
FIRE ACCESS PLAN

DRAWING NO.
EXH 1

Job # 230390

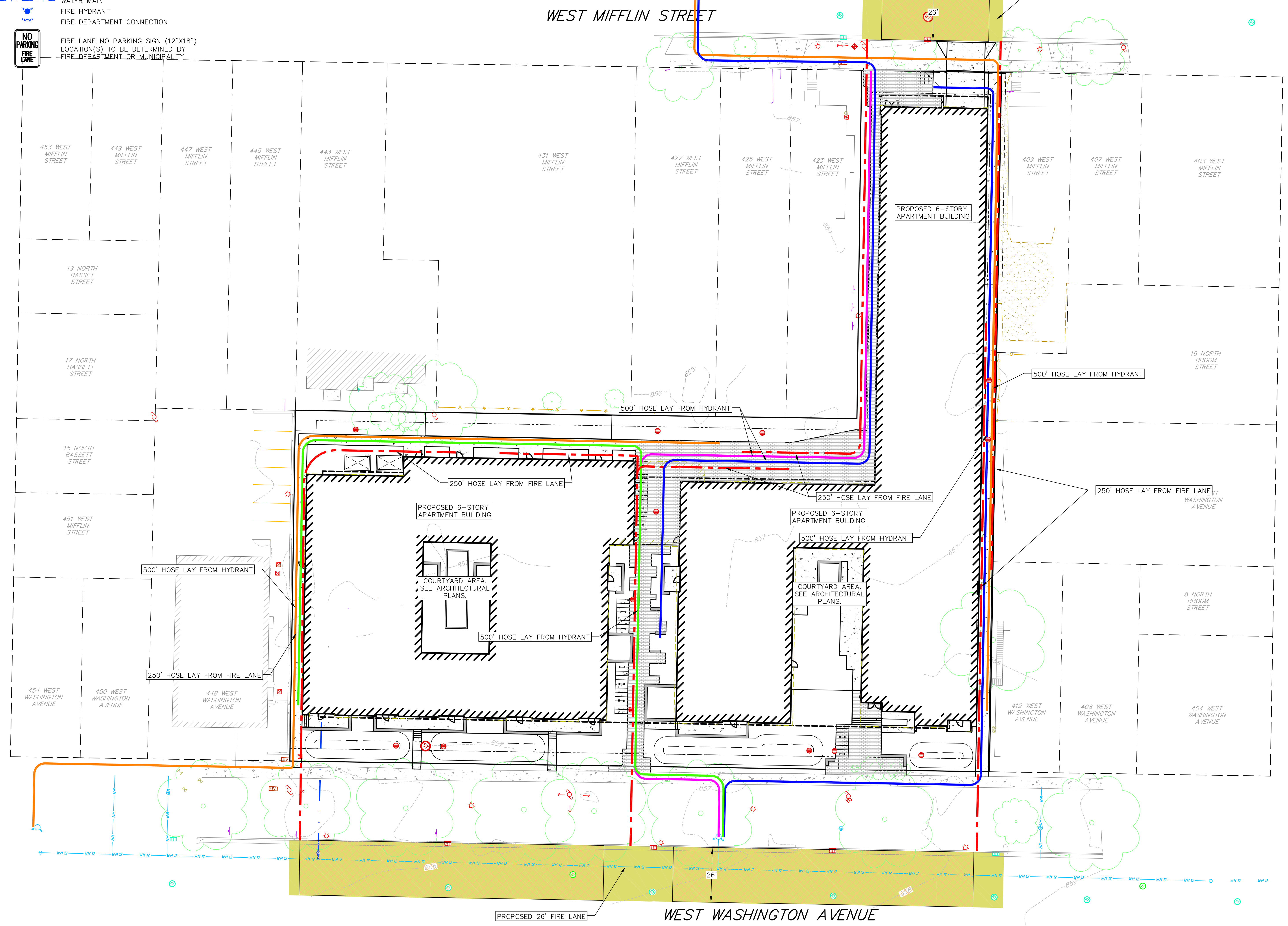

TITLE
1/16" = 1'-0"

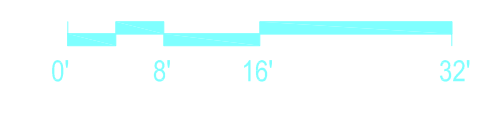

NOT FOR CONSTRUCTION