

Mr. Al Martin
Urban Design Commission
Madison Municipal Building
215 Martin Luther King Jr. Blvd., Suite LL 100
Madison, WI 53703

18 February 2010

Re: Danisco USA, Inc. – Sign Code Variance Request

Dear Mr. Martin:

With this letter we request a variance of the wall sign requirements as listed in Madison General Ordinance 33.24(8)(c)4a. Specifically we wish to take exception to items vii and viii.

The proposed wall sign as illustrated in the enclosed drawings depicts the Danisco corporate logo and is similar in look to the wall sign currently erected at the 3329 Agriculture Drive office located just east of the project site. The proposed sign is 84 square feet in size and is shown to be located approximately 19 feet above the adjacent ground surface.

The size and height of the sign were developed to give proper perspective to the sign in relation to the building façade. The size of the sign will allow it to be easily legible from Agriculture Drive while the height will center the sign within the white panel façade above the vestibule.

We believe that the variance from the sign size requirements will result in a better overall design and will fit the scale of the building better. Please consider these changes during review of the enclosed sign proposal.

Sincerely,



Gene A. Bohn
Project Engineer Manager, Danisco USA, Inc.

Enclosures

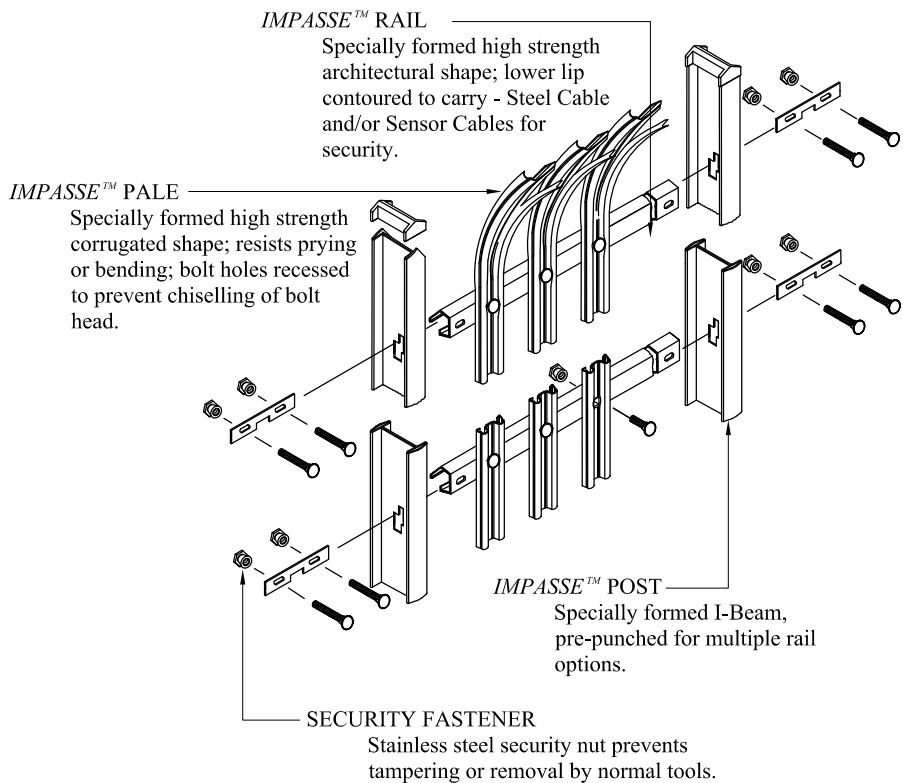
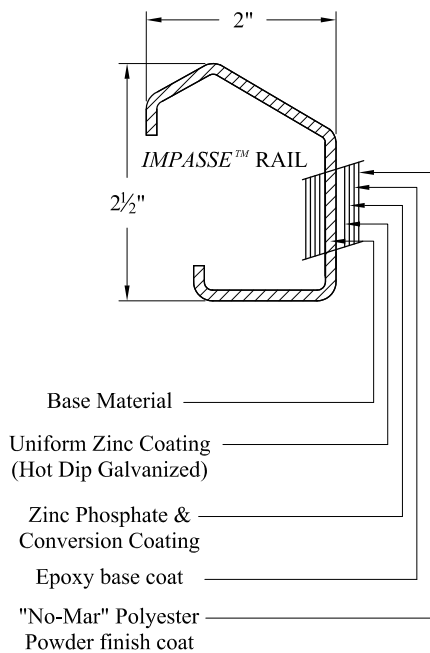
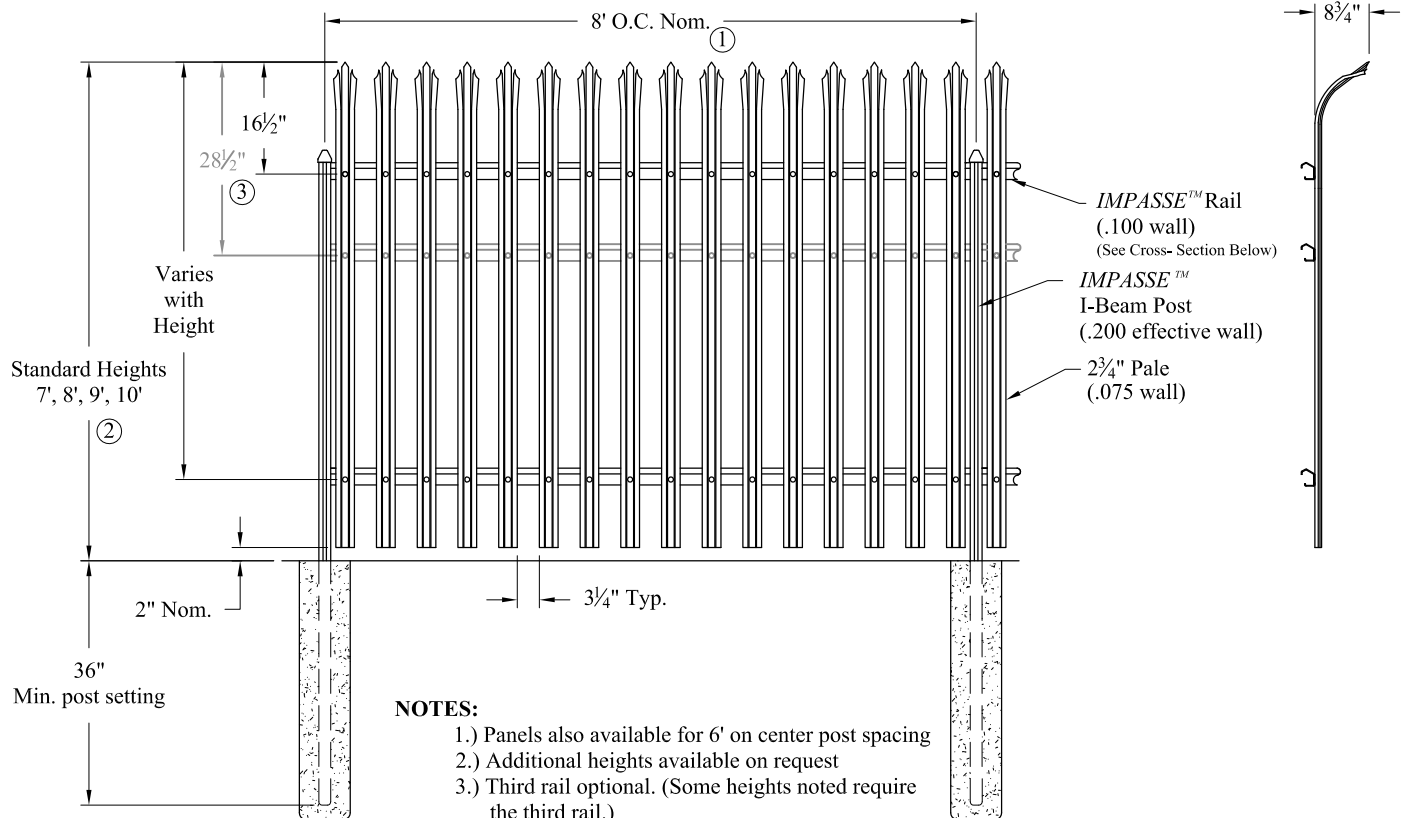

HIGH SECURITY STEEL FENCE

Title: IMPASSE GAUNTLET 2/3-RAIL			
DR: RTM	SH . 1 of 1	SCALE: DO NOT SCALE	
CK: MM	Date 5/15/06	REV: a	



AMERISTAR®

1555 N. Mingo
Tulsa, OK 74116
1-888-333-3422
www.ameristarfence.com

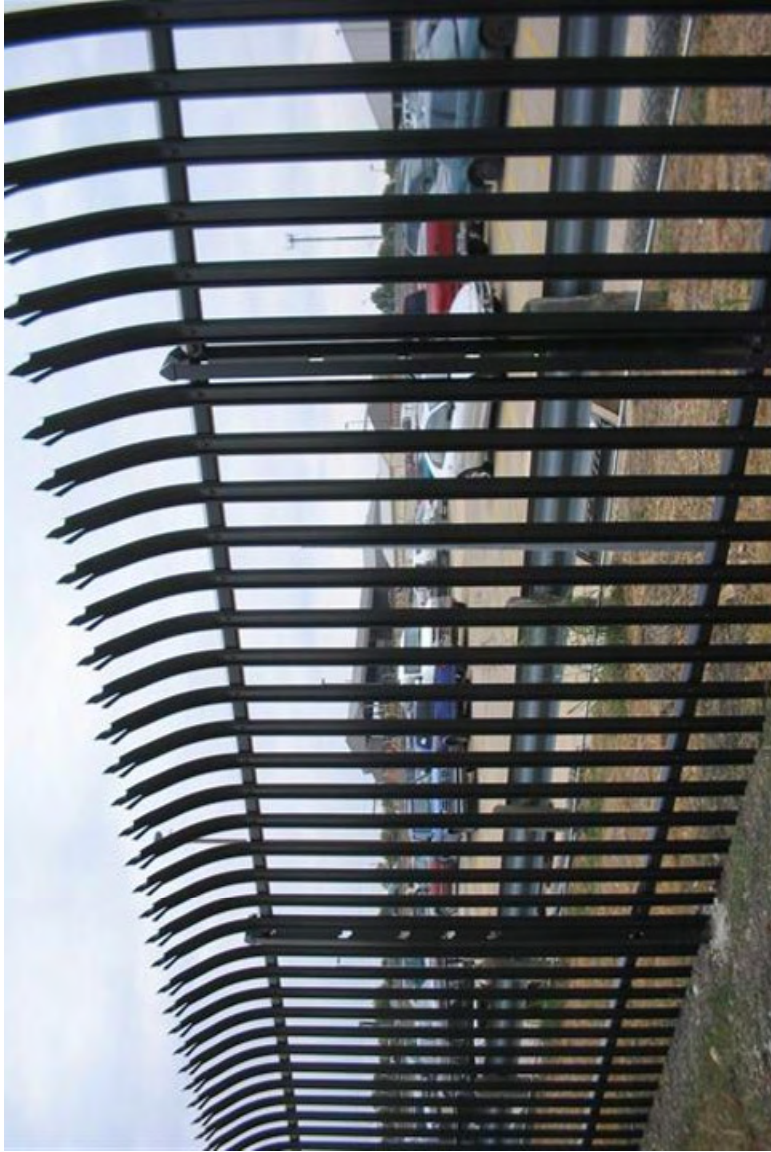

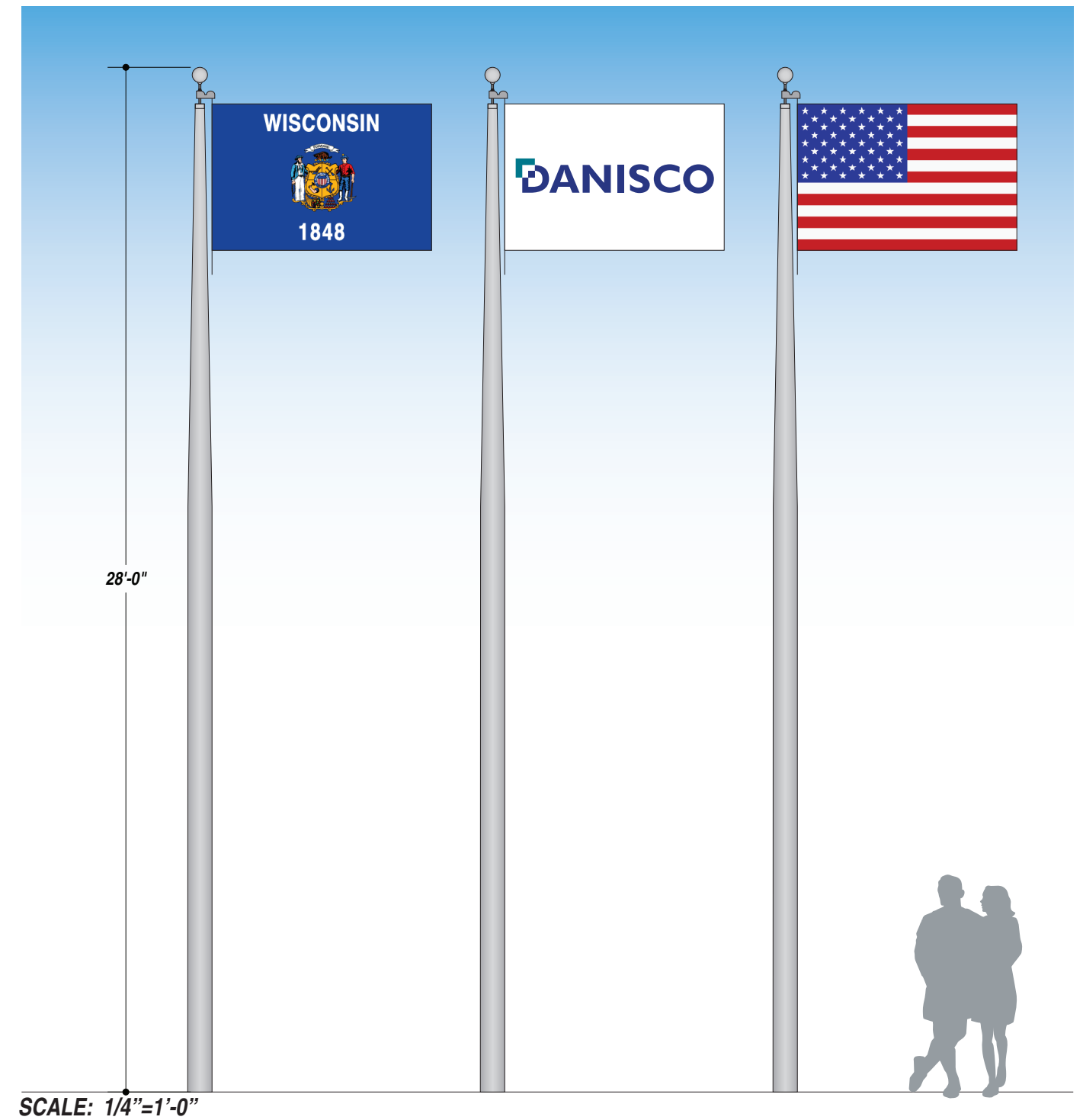

SCALE: 1/4"=1'-0"



FLAG #1

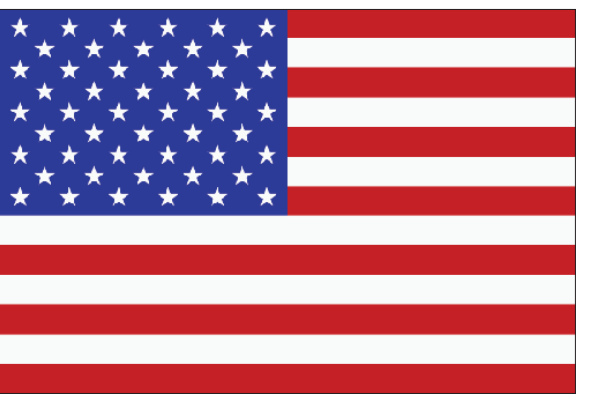

FLAG #2



FLAG #3

SCALE: 1/2"=1'-0"

JOB DESCRIPTION

NON-ILLUMINATED EXTERIOR FLAGS

- PROVIDE 3 FLAGS:
- AMERICAN FLAG
 - WISCONSIN STATE FLAG
 - CUSTOM FLAG

TOTAL SQ. FT. OF SIGNAGE: N/A

VIEWING DISTANCE OF PRIMARY SIGN COPY : VARIES

UNLESS OTHERWISE SPECIFIED:

- ALL FLUORESCENT LAMPS WILL BE T12-CW-HO LAMPS.
- ALL BALLASTS WILL BE COLD START ALL-WEATHER BALLASTS.
- ALL NEON TRANSFORMERS WILL BE 30 MILLIAMPS.
- 120V PRIMARY POWER TO SIGNS WILL BE BY OTHERS.
- ALL DATA LINES TO ELECTRONIC SIGNAGE WILL BE BY OTHERS.
- ALL PAINT COLORS WILL BE SEMI-GLOSS FINISH.

COLORS TO MATCH:

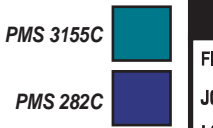

FILE NAME 23667-05-0 DATE 12.24.09 SCALE 1/2"=1'-0"
 JOB NAME DANISCO USA, INC.
 LOCATION 3322 AGRICULTURAL DR, MADISON, WI 53716
 DRAWN BY JER SALESMAN JOHN GIBBS

DESIGN APPROVED BY:
 AUTHORIZED SIGNATURE _____
 DATE _____



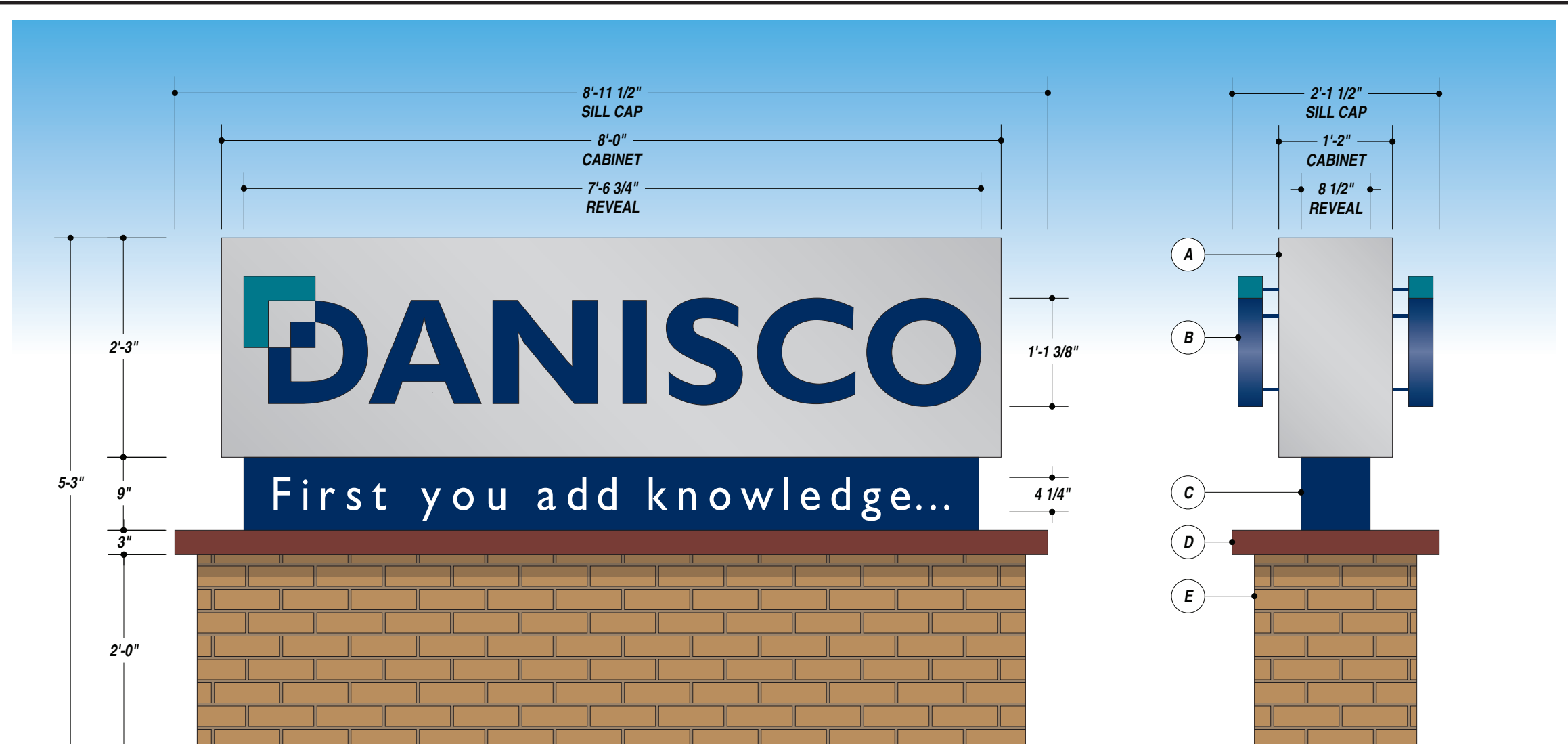

THESE ARE THE KEY ASSUMPTIONS THAT HAVE BEEN USED IN CALCULATING THE STRUCTURAL SUPPORT FOR YOUR SIGN:

- Centroid Height: 3.125 ft
- Sign Area: 50.000 sq ft
- Number of Support Columns: 1
- Steel type: new
- Wind Pressure: 30.000 lbs/ sq ft
- Section Modulus: 1.875 per column
- Schedule 40 pipe (in inches,ROUND): 3.500 each column
- Caisson type: Circular
- Base Diameter/Width: 1.500 ft
- Vert. Bearing Soil Pressure: 1500
- Lateral Bearing Soil Pressure: 1500
- Footing Depth: 6.000 ft per column
- Valid Footing Diameter: 1.500 ft per column
- Concrete Yards: 0.379 yards total

IF SOIL OR DIGGING CONDITIONS VARY FROM THESE ASSUMPTIONS, INCREMENTAL CHARGES MAY BE NECESSARY. PLEASE NOTIFY SIGN PRODUCTIONS IF YOU PREFER TO PAY FOR SOIL TESTS THAT WILL VERIFY YOUR CONDITIONS PRIOR TO INSTALLATION OF YOUR SIGN.

JOB DESCRIPTION
 D/F ILLUMINATED EXTERIOR MONUMENT SIGN

A) FABRICATE CABINET WITH 1 1/2" TUBE FRAME AND ALUMINUM. PAINT.

B) FABRICATE HALO-LIT CHANNEL LETTERS WITH:
 - ROUTED ALUMINUM FACES
 - PAINTED 3" RETURNS
 - ILLUMINATE WITH WHITE NEON
 - 60MA TRANSPONDERS HOUSED IN CABINET (A).

MOUNT LETTERS TO FACE OF CABINET (A) WITH 2" STAND-OFFS.

C) FABRICATE WITH 1 1/2" TUBE FRAME AND ALUMINUM. FACE WITH ROUTED ALUMINUM BACKED WITH 3/16" WHITE ACRYLIC. LAMP HORIZONTALLY WITH FLUORESCENTS. PAINT.

D) FABRICATE SILL CAP WITH 3" TUBE FRAME AND ALUMINUM. PAINT.

E) FABRICATE BASE WITH STEEL ANGLE FRAME, DUROCK, AND TOLEDO GREY BRICK BY GLEN-GERY BRICK.

INSTALL PER DETAILS.

WIRE SIGN FOR 277 V

R1: 02.18.10 • JER • REDUCED HEIGHT OF BASE TO 2'-0"

FILE NAME 23667-06-1 DATE 12.24.09 SCALE 3/4"=1'-0"

JOB NAME DANISCO USA, INC.

LOCATION 3322 AGRICULTURAL DR, MADISON, WI 53716

DRAWN BY JER SALESMAN JOHN GIBBS

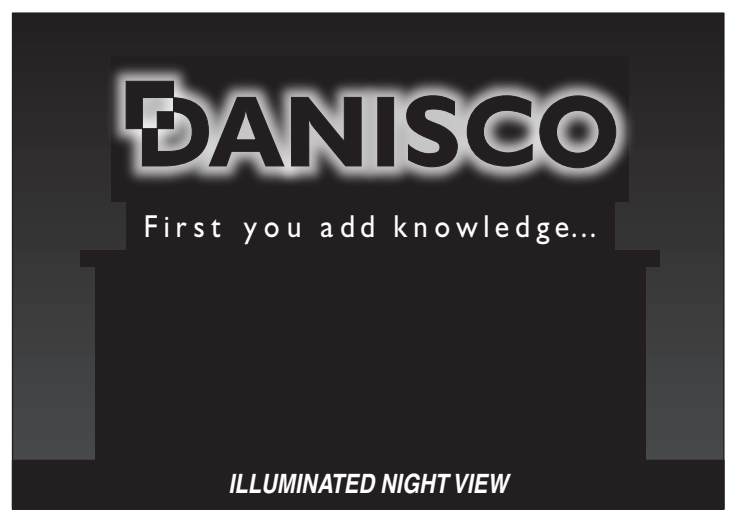
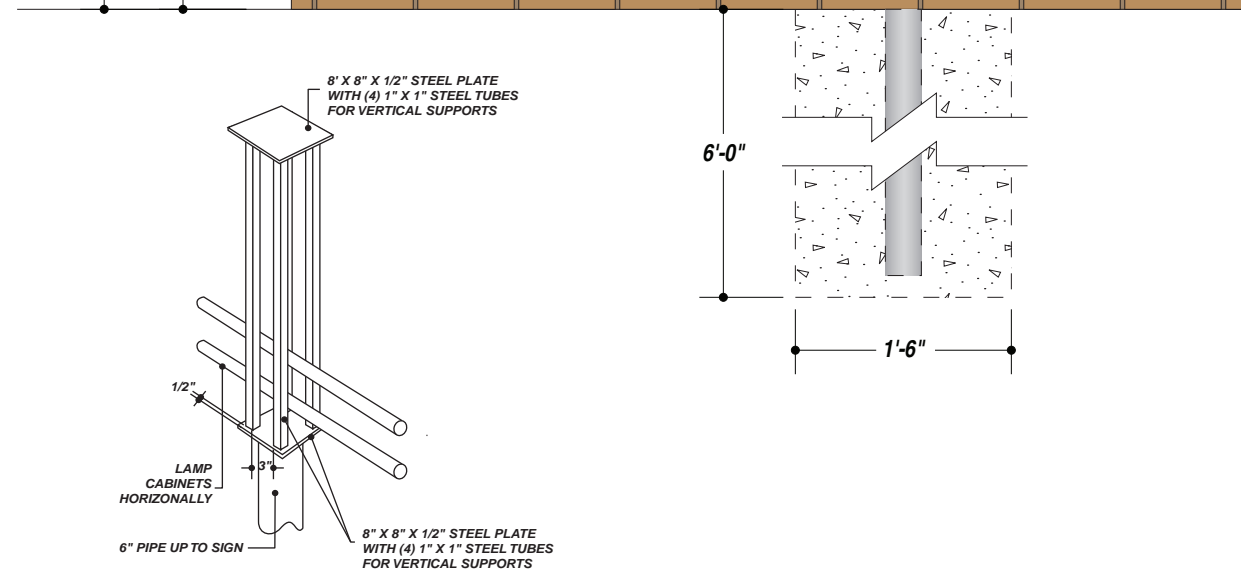

- 7725-29 RUSSET BROWN (PAINT)
- AKZO NOBEL BRUSHED ALUM. (PAINT)
- PMS 3155C (PAINT)
- AVERY 957 SC PMS 282C (PAINT)

TOTAL SQ. FT. OF SIGNAGE: 50 sq. ft. VIEWING DISTANCE OF PRIMARY SIGN COPY : 670 ft.

UNLESS OTHERWISE SPECIFIED:
 • ALL FLUORESCENT LAMPS WILL BE T12-CW-HO LAMPS. • ALL BALLASTS WILL BE COLD START ALL-WEATHER BALLASTS. • ALL NEON TRANSFORMERS WILL BE 30 MILLIAMPS. • 120V PRIMARY POWER TO SIGNS WILL BE BY OTHERS. • ALL DATA LINES TO ELECTRONIC SIGNAGE WILL BE BY OTHERS. • ALL PAINT COLORS WILL BE SEMI-GLOSS FINISH.

THIS IS AN ORIGINAL COMPUTER GENERATED COLOR PRINT. COLORS REPRESENTED ON THIS PRINT MAY NOT MATCH THE PMS CHIP, VINYL OR PAINT COLORS EXACTLY. IT IS TO BE VIEWED AS A REPRESENTATION ONLY. ALL DESIGNS & SPECIFICATIONS ARE THE SOLE PROPERTY OF SIGN PRODUCTIONS, INC. THEY ARE ONLY FOR THE CUSTOMERS USE IN CONNECTION WITH A PROPOSED PROJECT. ARTWORK AND PRINTED MATERIAL ARE NOT TO BE USED BY ANYONE OUTSIDE OF YOUR ORGANIZATION, NOR IS IT TO BE REPRODUCED, COPIED OR EXHIBITED IN ANY FORM WITHOUT THE CONSENT OF SIGN PRODUCTIONS, INC.

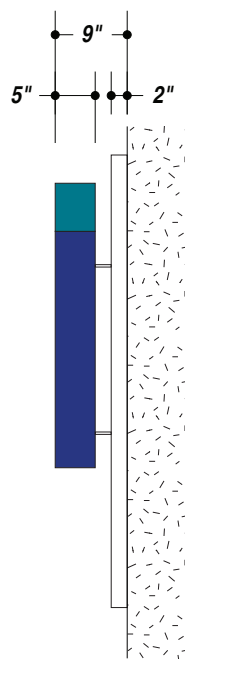
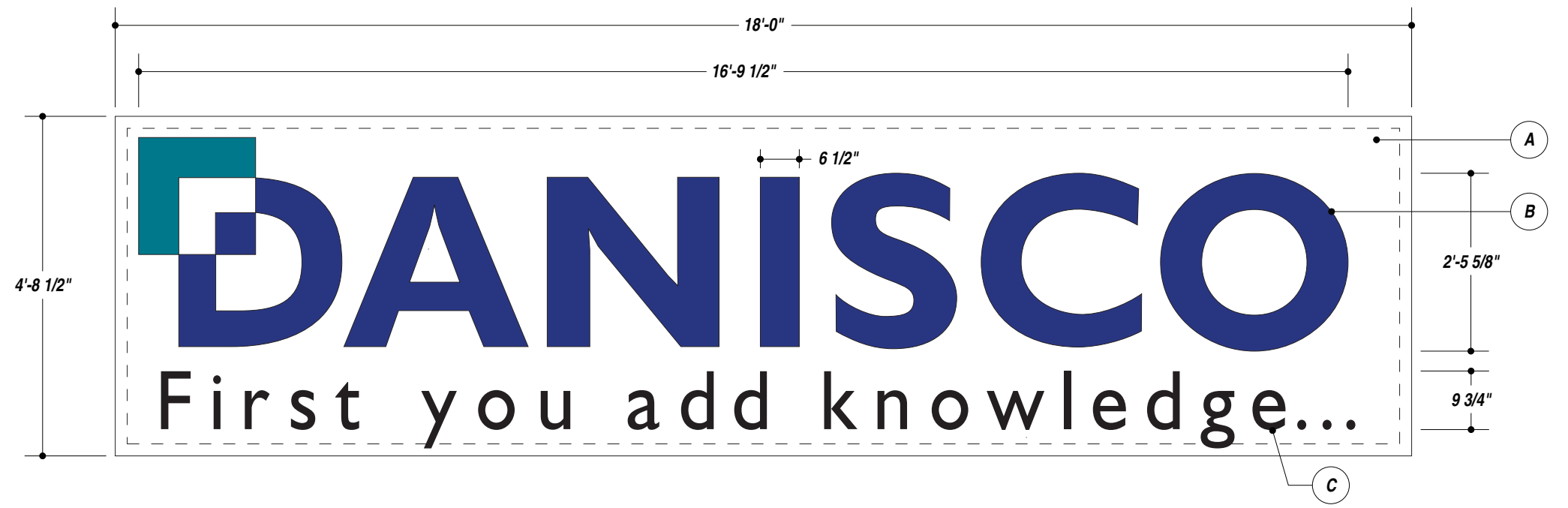

- 7725-12 BLACK (VINYL)
- 7725-10 WHITE (PAINT)
- PMS 3155C (PAINT)
- AVERY 957 SC
PMS 282C (PAINT)

ILLUMINATED NIGHT VIEW:

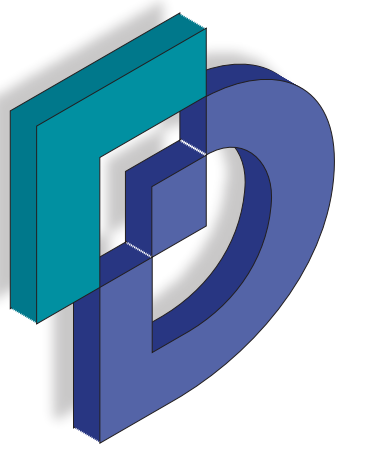

JOB DESCRIPTION

S/F ILLUMINATED EXTERIOR HALO CHANNEL LETTERS

- A) FABRICATE HALO-LIT CHANNEL LETTERS WITH:
- ROUTED ALUMINUM FACES
 - 3" PAINTED RETURNS
 - ILLUMINATED WITH WHITE NEON
 - REMOTE 60MA REMOTE TRANSFORMERS.

MOUNT TO BACKER PANEL (B) WITH 2" STAND-OFFS.

B) FABRICATE BACKER PANEL WITH 2" TUBE FRAME AND ALUMINUM. PAINT.

C) CUT, WEED, PAPER, & APPLY VINYL COPY TO BACKER PANEL (B).

MOUNT SIGN FLUSH TO BUILDING FASCIA.

VISUAL REPRESENTATION ONLY ***NOT TO SCALE***



TOTAL SQ. FT. OF SIGNAGE: 84.75 sq. ft. **VIEWING DISTANCE OF PRIMARY SIGN COPY : 1,475 ft.**

UNLESS OTHERWISE SPECIFIED:
 • ALL FLUORESCENT LAMPS WILL BE T12-CW-HO LAMPS. • ALL BALLASTS WILL BE COLD START ALL-WEATHER BALLASTS. • ALL NEON TRANSFORMERS WILL BE 30 MILLIAMPS. • 120V PRIMARY POWER TO SIGNS WILL BE BY OTHERS. • ALL DATA LINES TO ELECTRONIC SIGNAGE WILL BE BY OTHERS. • ALL PAINT COLORS WILL BE SEMI-GLOSS FINISH.

THIS IS AN ORIGINAL COMPUTER GENERATED COLOR PRINT. COLORS REPRESENTED ON THIS PRINT MAY NOT MATCH THE PMS CHIP, VINYL OR PAINT COLORS EXACTLY. IT IS TO BE VIEWED AS A REPRESENTATION ONLY. ALL DESIGNS & SPECIFICATIONS ARE THE SOLE PROPERTY OF SIGN PRODUCTIONS, INC. THEY ARE ONLY FOR THE CUSTOMERS USE IN CONNECTION WITH A PROPOSED PROJECT. ARTWORK AND PRINTED MATERIAL ARE NOT TO BE USED BY ANYONE OUTSIDE OF YOUR ORGANIZATION, NOR IS IT TO BE REPRODUCED, COPIED OR EXHIBITED IN ANY FORM WITHOUT THE CONSENT OF SIGN PRODUCTIONS, INC.

© COPYRIGHT 2009 BY GRANT SIGNS. 5119 - Terminal Dr. McFarland, Wisconsin 53558 • 608-838-7794

FILE NAME 23667-01-0 DATE 12.24.09 SCALE 1/2"=1'-0"
 JOB NAME DANISCO USA, INC.
 LOCATION 3322 AGRICULTURAL DR, MADISON, WI 53716
 DRAWN BY JER SALESMAN JOHN GIBBS

DESIGN APPROVED BY:
 AUTHORIZED SIGNATURE _____
 DATE _____



Model ECX25

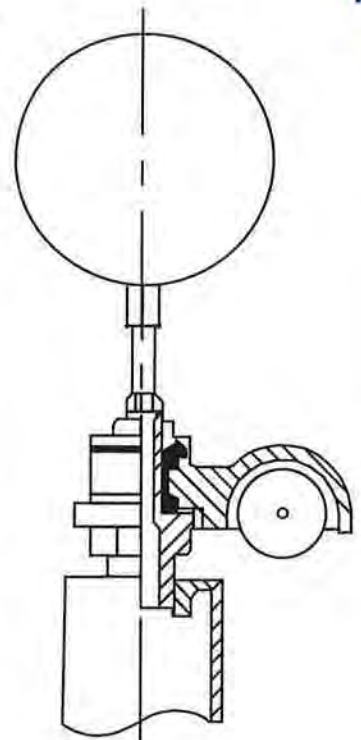
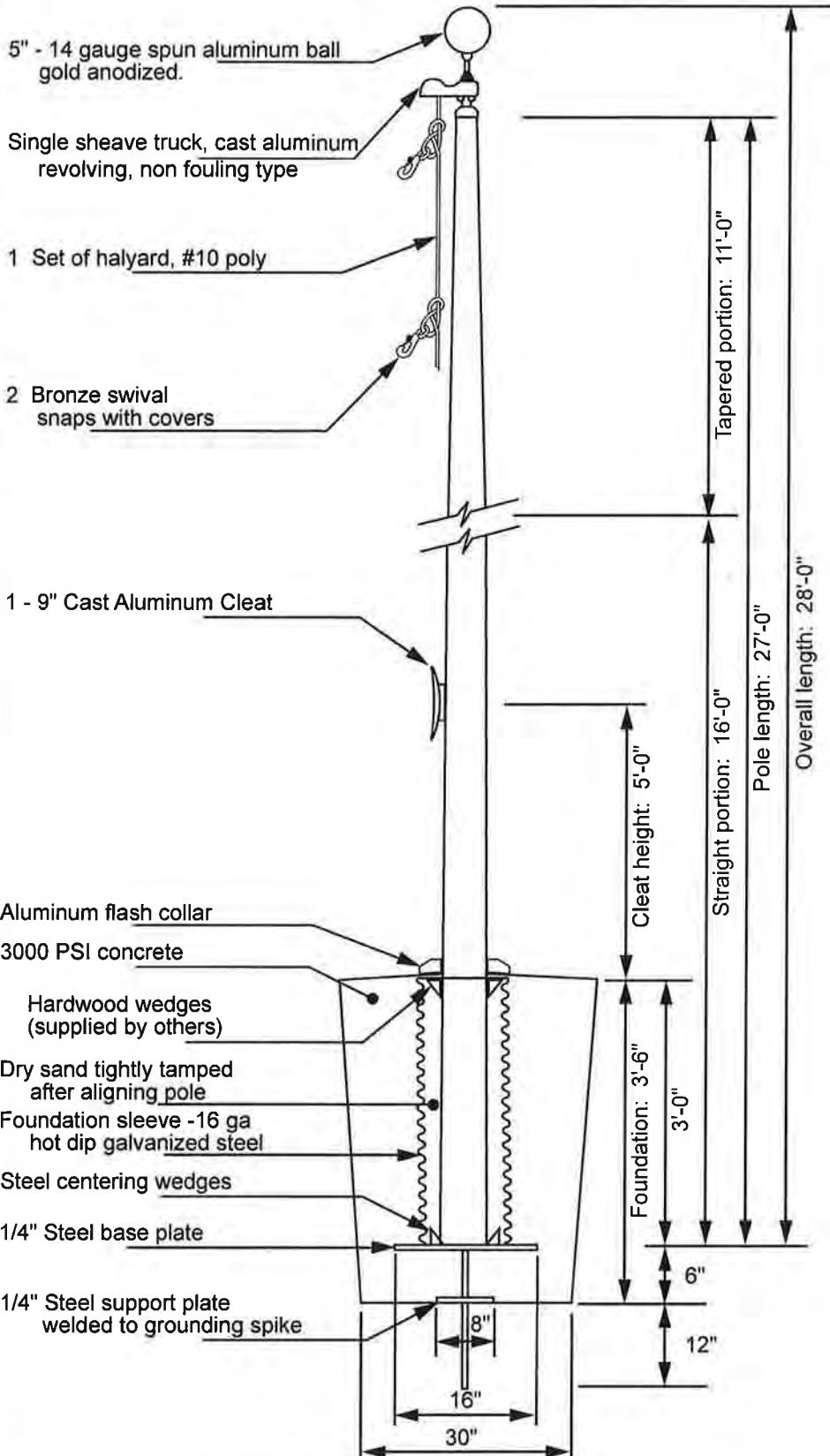

Truck Detail
 Aluminum body
 Stainless steel ball bearings
 Aluminum sheave
 Cast aluminum spindle

All shafts with overall length of more than 38'-6" are shipped in two sections.

Each section matched marked for field assembly. Exposed portion of jam sleeve must be **well lubricated** prior to assembly.

1-1/2" maximum shop gap allowed for field fitting (ram for tight joint)

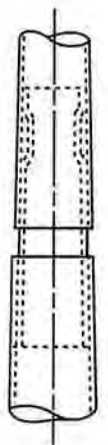

Project:	Ground set tapered aluminum flagpole: ALLOY: 6063T6	EDER FLAG	Date:
Location:	Exposed height: 25'-0" Pole length: 27'-0"	MANUFACTURING COMPANY	Revision:
Architect:	Ship in 1 section Butt diameter: 5"	1000 W. Rawson Avenue	
Contractor:	Top diameter: 3" Wall thickness: .125"	Oak Creek, WI 53154	
Customer:	Finish: 100 grit polish		Job:



Daylilies – Below Wall



VL - Wayfaring Viburnum



PO - Pin Oak



RM - Red Maple



HH - Hughes Creeping Juniper



CV - Cranberrybush Viburnum



CH - Thornless Hawthorn



KSJ - St. Johnswort



BR - Blue Rug Juniper

PLANT DATA CHART											
PLANT	COMMON NAME	SCIENTIFIC NAME	AVG. MATURE	SIZE WHEN	ROOT ZONE	MINIMUM SIZE				FERT. PACK.	MULCH
CODE			HEIGHT	PLANTED	MODE	MIN. BALL OR POT SIZE		MIN. HOLE SIZE		REQ'D	RING DIA.
						MIN. CONT. SIZE	MIN. CONT. DEPTH	MIN. HOLE DIA.	MIN. HOLE DEPTH		
LARGE GROWING DECIDUOUS TREES											
RM	Red Maple	Acer rubrum	55'	2" Cal.	B&B	24"	16"	40"	16"	4	48"
PO	Pin Oak	Quercus palustris	65'	2" Cal.	B&B	24"	16"	40"	16"	4	48"
MEDIUM GROWING DECIDUOUS TREES											
CH	Cockspur Hawthorn Thornless	Crataegus crusgalli var. inermis	25'	2" Cal.	B&B	24"	16"	40"	16"	4	48"
EVERGREEN TREES											
EA	Emerald Arborvitae	Thuja occidentalis 'Smaragd'	14'	6' HT	B&B	22"	15"	38"	15"	3	48"
LARGE DECIDUOUS SHRUBS											
VL	Wayfaringtree Viburnum	Viburnum lantana	12'	3' HT	B&B	12"	9"	24"	9"	2	36"
CV	American Highbush Cranberry	Viburnum trilobum 'Compacta'	6'	3' HT	B&B	16"	12"	28"	16"	2	Bed
SMALL DECIDUOUS SHRUBS											
KSJ	Kalm's St. Johnswort	Hypericum Kalmianum	3'	24" HT	POT	12"	9"	28"	9"	1	Bed
EVERGREEN SHRUBS											
HH	Hughes Juniper	Juniperus horizontalis 'Hughes'	18"	12" HT	POT	12"	9"	28"	9"	2	Bed
BR	Blue Rug Juniper	Juniperus horizontalis 'Wiltoni'	8"	12"	CAN	12"	9"	28"	9"	2	Bed
PERENNIALS											
DL	Tiger Lily	Lilium tigrinum	2'	12"	POT	12"	10"	24"	12"	1	-

FEMRITE DRIVE

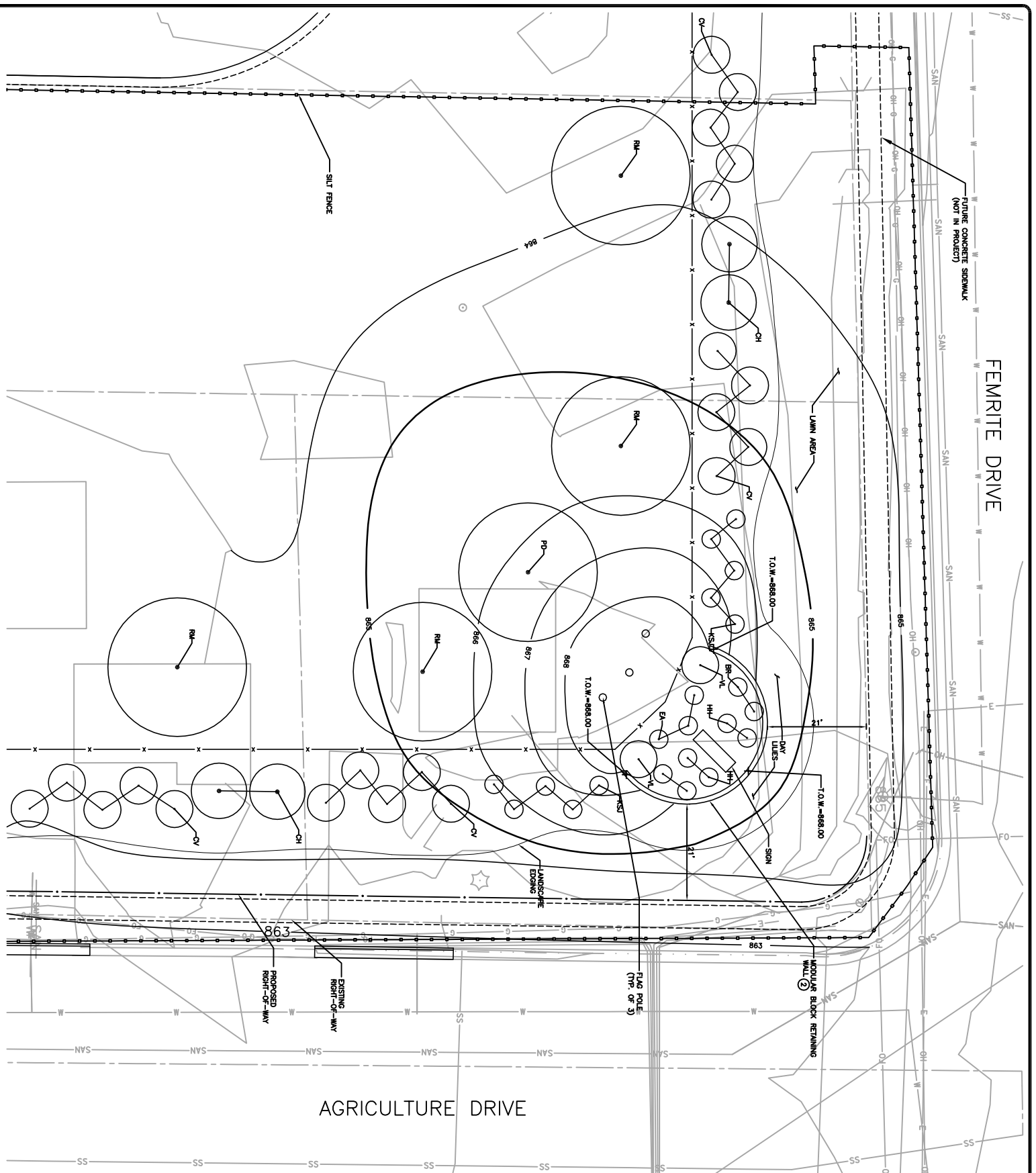

PLANT DATA CHART

PLANT	COMMON NAME	SCIENTIFIC NAME	PLANT MATERIAL	HEIGHT	SPREAD	LEAF	FRUIT	SEASONAL INTEREST	USDA ZONE	MOISTURE	SOIL	OTHER
LARGE TREES	EMERALD ANGIOLEAF	EA Emerald Angioleaf	14'	6'-8"	BBB	22'	15'	38'	15'	3	48'	
EMERGENCY TREES	WATERFRONT	WF Waterfront	12'	3'-11"	BBB	12'	24'	9'	24'	2	38'	
SMALL TREES	HYDRANGEA	HDR Hydrangea	6'	3'-11"	BBB	15'	25'	15'	15'	2	38'	
SHRUBS	HYDRANGEA	HDR Hydrangea	3'	3'-11"	TCV	12'	9'	28'	9'	1	38'	
PERENNIALS	HYDRANGEA	HDR Hydrangea	2'	12"	TCV	12'	10'	24'	12'	1	38'	

DANISCO POLICY FOR LANDSCAPING

FOOD MANUFACTURERS ARE REQUIRED TO KEEP LIMITED LANDSCAPING AROUND THE FACILITY TO REDUCE AND PREVENT THE RISK OF CONTAMINATION OF THE FACILITY AND ADJACENT AND CORPUSCULE FIELDS. THE FOLLOWING POLICY SHOULD BE FOLLOWED:

- ANY TYPE OF LANDSCAPING SHOULD REMAIN A MINIMUM OF 75 FEET AWAY FROM EXTERIOR DOORS.
- A PERMANENT 12 FEET BUFFER SHOULD BE MAINTAINED AT ALL ROADS OR CONCRETE WALKWAY PREFERRENT.
- TREES AND SHRUBS WITH FRUITS AND/OR FLOWERS ARE NOT ALLOWED WITHIN THE BUFFER ZONE.
- TREES AND SHRUBS THAT CAN BE SOURCES OF CONTAMINANTS THAT COULD POTENTIALLY BE TRACKED INTO THE FACILITY ARE NOT ALLOWED WITHIN THE BUFFER ZONE.
- HANGING BASKETS FOR PERENNIALS, HERBACEOUS PERENNIALS AND ANNUALS ARE NOT ALLOWED WITHIN THE BUFFER ZONE.
- RECOMMENDED TREES INCLUDE: SAKAKI, WATLE AND LOCUS.
- RECOMMENDED SHRUBS ARE: HYDRANGEA, SPICE BUSH, AND ROCKS SHOULD BE UTILIZED IN PLACE OF SHRUBS.
- PEAS, GRASS, AND ROCKS SHOULD BE UTILIZED IN PLACE OF SHRUBS.
- WATERFALLS AND FOUNTAINS AS THEY BECOME DRAINING AND BATHING AREAS FOR BIRDS AND PESTS.

THESE ARE NOT INCLUSIVE OF ALL REQUIREMENTS AND POTENTIAL LANDSCAPING SHOULD BE REVIEWED BY QUALITY ASSURANCE OR PLANT MANAGEMENT.

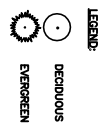

LEGEND:

- X - TOPOGRAPHIC ELEVATION
- E - ELECTRIC
- G - NATURAL GAS
- - LOT LINES
- S - SANITARY SEWER
- OH - OVERHEAD ELECTRICAL
- FO - FIBER OPTIC
- SS - STORM WATER
- W - WATERMAIN
- 865 - PROPOSED TOPOGRAPHIC ELEVATION

LEGEND:

- - TOPOGRAPHIC ELEVATION
- E - ELECTRIC
- G - NATURAL GAS
- - LOT LINES
- S - SANITARY SEWER
- OH - OVERHEAD ELECTRICAL
- FO - FIBER OPTIC
- SS - STORM WATER
- W - WATERMAIN
- 865 - PROPOSED TOPOGRAPHIC ELEVATION

STRAND ASSOCIATES, INC.
ENGINEERS

DIGERS & WITTING

Toll Free (800) 242-8311
Milwaukee Area (414) 223-1181
Head Office (414) 223-5289
www.diggersandwitting.com

SIGNAGE LANDSCAPE PLAN

PROJECT WILLOW
DANISCO USA, INC.
MADISON, WISCONSIN

DATE: FEBRUARY 2010
DES BY: RH CHK BY: JDT
RECORD DRAWING
BY:
DATE:
CONTRACTOR:

NO.	REVISIONS	DATE:
0	PERM APPLICATION	02/19/2010

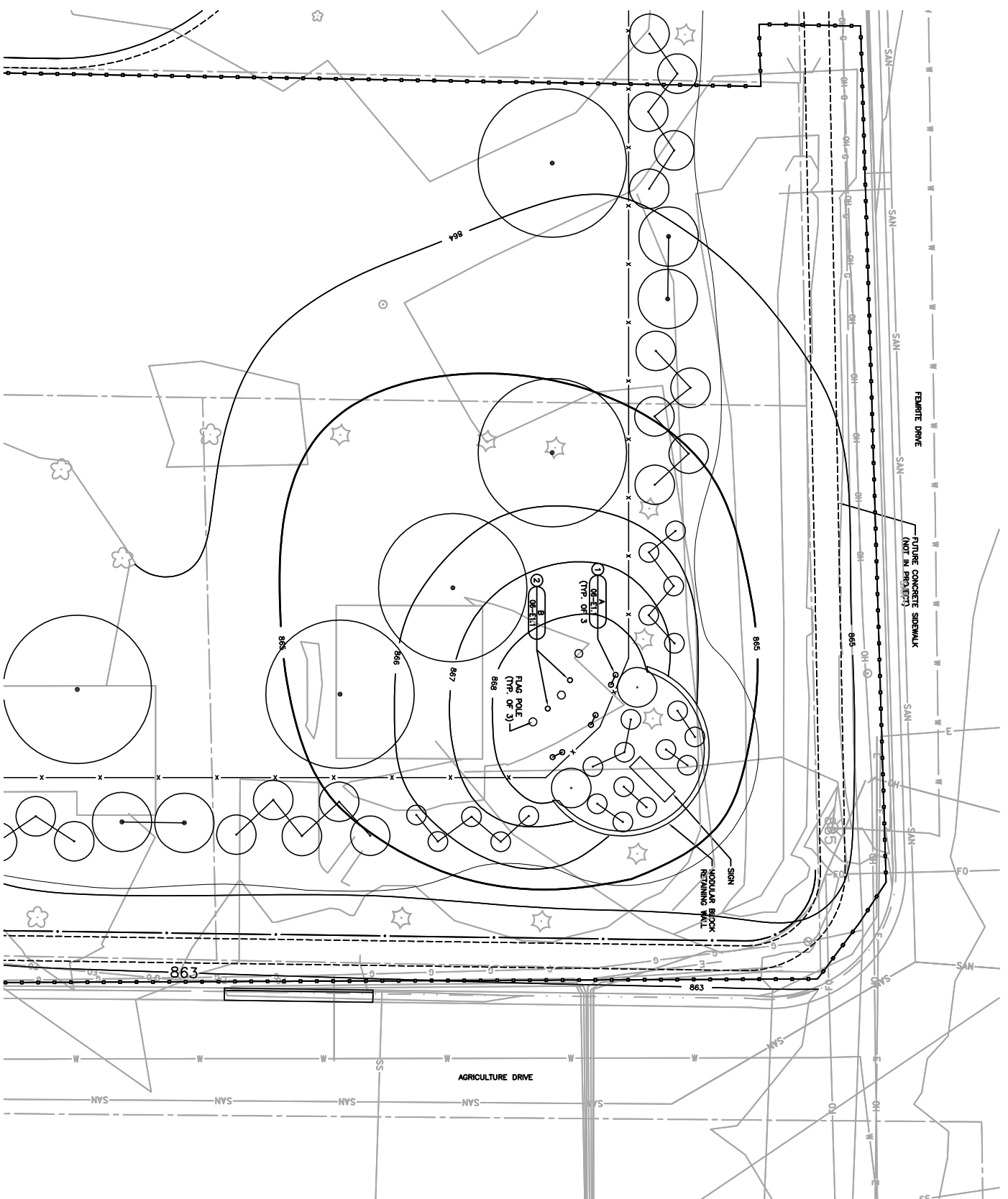

GENERAL NOTES

- POWER TO FLAG POLE LIGHTING AND FACILITY SIGN SHALL BE FROM PANEL #7-10 LOCATED IN ROOM 1014. PROVIDE SEPARATE CIRCUIT BREAKERS FOR LIGHTING AND FACILITY SIGN.

KEY NOTES

- PROVIDE FLAG POLE LIGHT AS MANUFACTURED BY INVE. MODEL VFS-K-102-48-07-16-FC-82-S4-82-TM-BZ. BASE OF FLAG POLE SHALL BE INSTALLED A MINIMUM OF 3 FEET FROM SIGN.
- PROVIDE FLAG POLE LIGHT AS MANUFACTURED BY INVE. MODEL VFS-K-102-48-07-16-FC-82-S4-82-TM-BZ. SIGN SHALL BE INSTALLED A MINIMUM OF 3 FEET FROM BASE OF FLAG POLE.

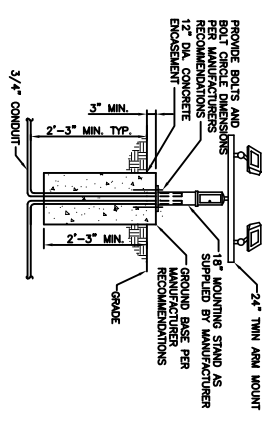

1 TWIN FLAG POLE FIXTURE MOUNTING STAND
NO SCALE

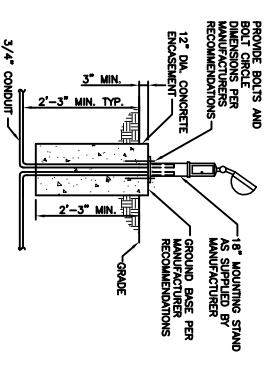

2 FLAG POLE FIXTURE MOUNTING STAND
NO SCALE

LEGEND:

X	TOPOGRAPHIC ELEVATION
E	ELECTRIC
G	NATURAL GAS
---	LOT LINES
S	SEWER
OH	OVERHEAD ELECTRICAL
FO	FIBER OPTIC
SW	STORM WATER
W	WATERMAIN
V	SILT FENCE
865	PROPOSED TOPOGRAPHIC ELEVATION

DIETRICH ENGINEERS
 1010 Wisconsin Ave. S.E.
 Atlanta, GA 30316
 Phone: (404) 525-1181
 Fax: (404) 525-2289
 www.dietrichengineers.com

**SIGNAGE
 ELECTRICAL SITE PLAN**

PROJECT WILLOW
 DANISCO USA, INC.
 MADISON, WISCONSIN

NO.	REVISIONS	DATE:

DATE: FEBRUARY 2010
 DES BY: MDC CHK BY: JDT
 RECORD DRAWING
 BY:
 DATE:
 CONTRACTOR:

STRAND ASSOCIATES, INC.
 ENGINEERS

SHEET
06-E1.1

TB NO. 1567/222

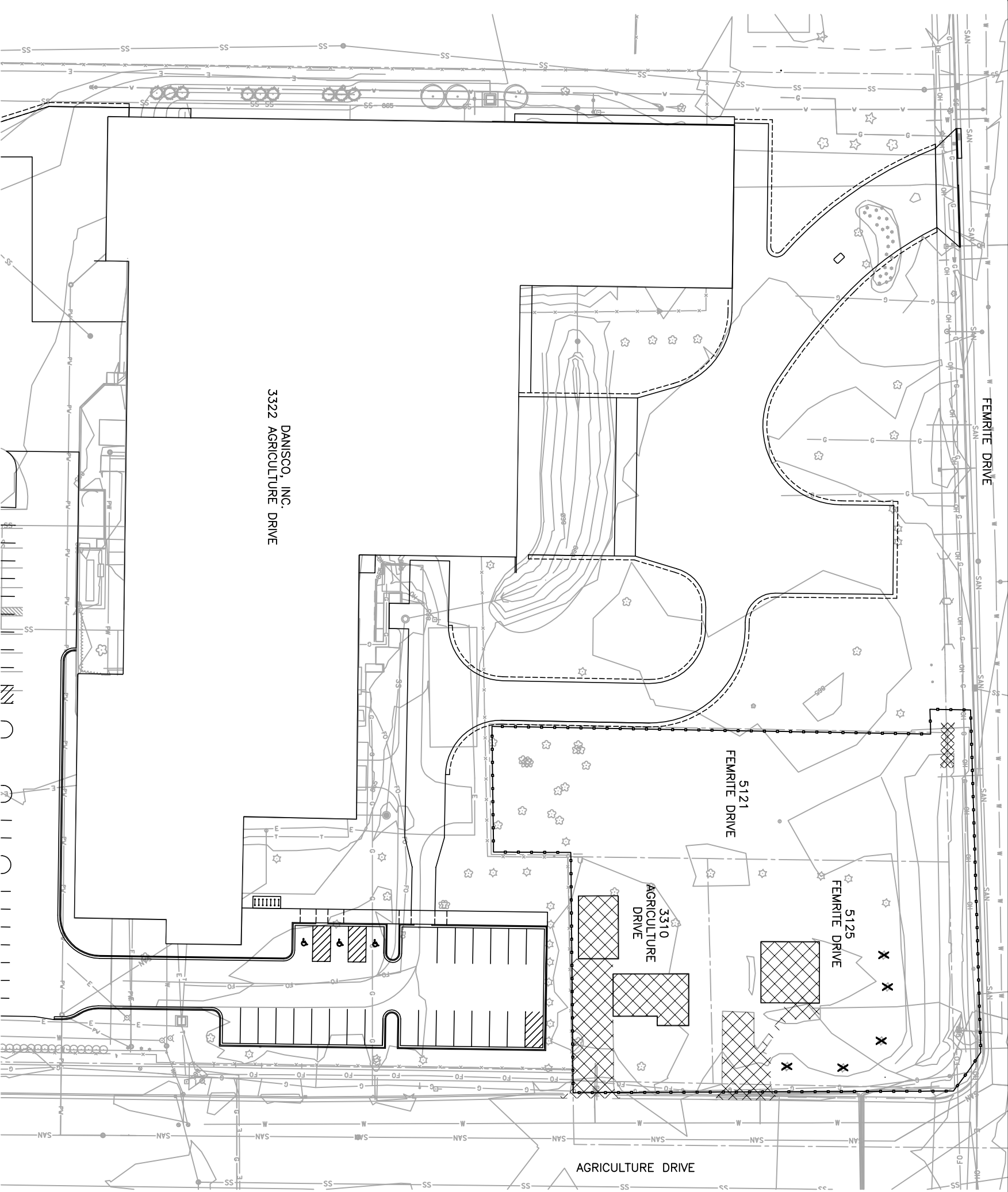

DANISCO, INC.
3322 AGRICULTURE DRIVE

5121
FEMRITE DRIVE

3310
AGRICULTURE DRIVE

5125
FEMRITE DRIVE

AGRICULTURE DRIVE

- GENERAL NOTES**
1. PRESERVE TREES, SHRUBS, SAND AND OTHER LANDSCAPING FEATURES TO THE MAXIMUM EXTENT POSSIBLE.
 2. REMOVE ALL EXISTING SURFACES AROUND THE HOUSE AT 5125 REMOVE EXISTING DRIVEWAY AND DRIVEWAY SURFACING. EXISTING DRIVEWAY SURFACING SHALL BE REPAIRED TO MATCH EXISTING DRIVEWAY SURFACING.
 3. SET FENCE AND GATE. TRACKING PAD SHALL BE INSTALLED TO ENCOMPASS PROJECT SITE PRIOR TO LAND DEMOLITION. ADDITIONAL MEASURES MAY BE REQUIRED AS REQUESTED BY THE GOVERNING AGENCY.
 4. CONTRACTOR SHALL LOCATE EXISTING UNDERGROUND UTILITIES IN ALL AREAS OF WORK.
 5. DEMOLISH AND COMPLETELY REMOVE ALL UNDERGROUND AND OVERHEAD UTILITIES FROM HOUSES AFTER UTILITY HAS BEEN CAPPED AND SEALED. ALL UTILITIES SHALL BE REMOVED BACK TO CURB OR NEAREST UTILITY SERVICE POINT. (CURE STRIP, POWER POLE), CONCRETE REMOVAL WITH PROPER UTILITY.
 6. REMOVE OPENINGS INCLUDING GRAVEL, ASPHALT, AND CONCRETE.
 7. DEMOLISH AND REMOVE ALL GARAGES, SHEDS, AND OTHER BUILDINGS LOCATED ON FRONTLOT.
 8. CONTRACTOR SHALL BACKFILL AND COMPACT ALL EXCAVATED AREAS.
 9. REMOVE EXISTING DRIVEWAY CURB OPENINGS AND REPLACE AREAS WITH CURB AND UTILITY TO MATCH ADJACENT. RESTORE TERRACE WITH GRASS.
 9. RESTORE ANY DAMAGED STREET PAVEMENT IN ACCORDANCE WITH THE CITY OF MADISON ENGINEERING PAVEMENTING CRITERIA.
- BACKFILL, COMPACTATION, AND GRADING**
1. EXCAVATIONS MAY BE BACKFILLED WITH EQUIPMENT FILL FOR AREAS TO BE REPAIRED. EXCAVATIONS SHALL BE BACKFILLED WITH EQUIPMENT FILL TO A MINIMUM OF 12 INCHES IN THICKNESS BEFORE COMPACTION. THE REQUIRED COMPACTION SHALL BE OBTAINED BY PLACING EQUIPMENT FILL IN LAYERS NOT EXCEEDING 12 INCHES IN THICKNESS. EQUIPMENT FILL SHALL BE OBTAINED FROM A SOURCE APPROVED BY THE ENGINEER. CONTRACTOR SHALL BE OBTAINED USING THE HULLING AND LEVELING EQUIPMENT, AND IN ADDITION, FINISHING ROLLERS, VIBRATING ROLLERS, AND OTHER EQUIPMENT TO PRODUCE THE DESIRED RESULTS.
 2. ALL FILL AND BACKFILL SHALL BE COMPACTED FILL PLACED TO WITHIN 4 INCHES OF THE BOTTOM OF THE TORSION.
 3. MATERIAL SHALL BE SEPARATED, SPREAD, AND LAYERED IN LAYERS GENERALLY NOT EXCEEDING 12 INCHES IN THICKNESS BEFORE COMPACTION. EACH LAYER OF THE FILL SHALL BE COMPACTED TO AT LEAST 90% OF THE REQUIRED DENSITY. THE DENSITY SHALL BE OBTAINED BY COMPACTING EQUIPMENT APPROVED BY THE ENGINEER.
 4. CONTRACTOR SHALL REMOVE ALL RUBBISH AND FINISH GRADING REQUIRED TO MATCH EXISTING FINISH. GRADING TOLERANCE FOR URM AREAS SHALL BE ±0.08 FEET.

LEGEND

XXXXXX	DEMOLITION
X	TOPOGRAPHIC ELEVATION
E	ELECTRIC
G	NATURAL GAS
—	LOT LINES
SW	SEWER
OH	OVERHEAD ELECTRICAL
FO	FIBER OPTIC
SS	STORM WATER
V	WATERMAIN

HOUSE SUMMARY

ADDRESS	PARCEL NO.	TOTAL AREA (SQ FT)	CONSTRUCTION	FOUNDATION	WALLS	ROOF
5125 FEMRITE DRIVE	071022001007	1008	CONCRETE	CONCRETE/BRICK/CMU	WOOD SHINGLES	ASPH/FLT
5121 AGRICULTURE DRIVE	071022001008	1008	CONCRETE	CONCRETE	WOOD SHINGLES	ASPH/FLT



Total Price (800) 244-8511
 1815
 Heating Equipment 700 (800) 544-2288
 www.dickerson.com

SITE DEMOLITION



STRAND ASSOCIATES, INC. ENGINEERS

SHEET
06-D1.1

109 NO. 1567/022

**SIGNAGE
SITE DEMOLITION PLAN**

PROJECT WILLOW
DANISCO USA, INC.
MADISON, WISCONSIN

DATE: FEBRUARY 2010	NO.	REVISIONS	DATE:
DES BY: CHK BY:	0	PERM APPLICATION	02/19/2010
RECORD DRAWING			
BY:			
DATE:			
CONTRACTOR:			



DANISCO, INC.
3322 AGRICULTURE DRIVE
MADISON, WISCONSIN

SITE PLAN
9" = 10' 20'

- GENERAL NOTES**
1. PRESERVE TREES, SHRUBS, SOIL AND OTHER LANDSCAPING FEATURES TO THE GREATEST EXTENT POSSIBLE.
 2. RESTORE ANY DAMAGED STREET PAVEMENT IN ACCORDANCE WITH THE CITY OF MADISON ENGINEERING PAVING ORDINANCE.
- KEY NOTES**
1. REMOVE EXISTING DRAINAGE GUTTER PAN AND REPLACE WITH NEW PAN AND GUTTER.
 2. COLOR SELECTION BY OWNER.
- EROSION CONTROL NOTES:**
1. SILT FENCE, STONE TRACKING PAD, AND SEDIMENT BASINS SHALL BE INSTALLED PRIOR TO LAND DISTURBANCE.
 2. THE EROSION CONTROL MEASURES INDICATED ON THE PLANS ARE THE MINIMUM REQUIREMENTS. ADDITIONAL MEASURES MAY BE REQUIRED AS REQUESTED BY ENGINEER OR GOVERNING AGENCY.
 3. ACCUMULATED SEDIMENT SHALL BE REMOVED FROM ALL AREAS. TEMPORARY SEDIMENT BASINS SHALL BE RESTORED UPON GRASS ESTABLISHMENT OVER THE SITE.
 4. ALL PROPOSED EROSION CONTROL MEASURES AND STRUCTURES MUST BE INSPECTED AT LEAST WEEKLY AND MAINTAINED AS NECESSARY. INSPECTIONS SHALL BE CONDUCTED WITHIN 24 HOURS OF DISTURBANCE.
 5. FOR THE FIRST SIX WEEKS AFTER INITIAL STABILIZATION OF A DISTURBED AREA, THE CONTRACTOR SHALL MAKE PROVISIONS FOR WEEDING WHENEVER MORE THAN 7 DAYS OF DRY WEATHER OCCURS.
 6. CONTRACTOR SHALL PROVIDE WOOD TYPED "CAUTION ALL TRUCKS MUST STOP HERE" SIGNAGE AT THE ENTRANCE TO THE STORM SEWER SYSTEM RECEIVING RUNOFF OTHER THAN FROM THE DISTURBED AREA. SIGNAGE SHALL BE REMOVED UPON COMPLETE FILL STABILIZATION IS COMPLETE.
 7. TEMPORARY STONE TRACKING PAD SHALL BE INSTALLED ACCORDING TO UNDER STANDARD 1057 TEMPORARY STONE TRACKING PAD SHALL BE A MINIMUM OF 50' LONG X 12" STONE. STONE SHALL BE FULL WIDTH OF THE EGRESS POINT.
 8. PROPOSED WEED CONTROL SHALL BE A TEMPORARY EROSION CONTROL MAT ON ALL DISTURBED AREAS WITH SLOPES OF 4:1 OR GREATER.

- BACKFILL, COMPACTION, AND GRADING**
1. EXCAVATIONS MAY BE BACKFILLED WITH GRANULAR FILL FOR AREAS TO BE SEED. GRANULAR FILL SHALL BE DEPOSITED, SPREAD, AND LEVELED IN LAYERS GENERALLY NOT EXCEEDING 6" TO 8" THICK. EACH LAYER SHALL BE COMPACTED TO AT LEAST 90% OF THE MAXIMUM DRY DENSITY APPROPRIATE FOR THE CONDITIONS.
 2. CONTRACTOR SHALL PROVIDE FERTILE AGRICULTURAL SOIL, TYPICAL FOR LOCALITY, CAPABLE OF SUSTAINING VEGETATION PLANT GROWTH, TAKEN FROM DRILLED SITE FREE OF CLAY OR IMPURITIES, PLANTS, WEEDS, AND ROOTS. PH VALUE OF MINIMUM 5.4 AND MAXIMUM 7.0. PLACE TOPSOIL IN ACCORDANCE WITH SECTION 623.13.
 3. SEED MIXTURE SHALL BE NO. 40 PER SECTION 630.2.
 4. FERTILIZER SHALL BE TYPE B PER SECTION 629. FERTILIZER SHALL BE APPLIED PER SECTION 629.
 5. ALL AREAS RECEIVING SEED SHALL BE MULCHED PER METHOD B OF SECTION 627.
 6. SILT FENCE SHALL BE INSTALLED PRIOR TO LAND DISTURBANCE.
 7. THE EROSION CONTROL MEASURES INDICATED ON THE PLANS SHALL BE MAINTAINED AND REPAIRED AS NECESSARY UNTIL THE AGENCY IS SATISFIED.
 8. ALL PROPOSED EROSION CONTROL MEASURES AND STRUCTURES MUST BE INSPECTED AT LEAST WEEKLY AND MAINTAINED AS NECESSARY. INSPECTIONS SHALL FOLLOW THE ORDINANCE WITHIN 24 HOURS.
- LEGEND:**
- | | |
|---|--------------------------------|
| X | TOPOGRAPHIC ELEVATION |
| E | ELECTRIC |
| G | NATURAL GAS |
| — | LOT LINES |
| — | SEWAGE SANITARY SEWER |
| — | OVERHEAD ELECTRICAL |
| — | FIBER OPTIC |
| — | STORM WATER |
| — | WATERMAIN |
| — | SILT FENCE |
| — | PROPOSED TOPOGRAPHIC ELEVATION |
| X | SECURITY FENCE |

NO.	REVISIONS	DATE:
0	PERM APPLICATION	02/19/2010

DATE: FEBRUARY 2010
DES BY: PJR CHK BY: JDT
RECORD DRAWING
BY:
DATE:
CONTRACTOR:

SIGNAGE
SITE PLAN

PROJECT WILLOW
DANISCO USA, INC.
MADISON, WISCONSIN

STRAND ASSOCIATES, INC.
ENGINEERS

06-C1.1
SHEET

Toll Free (800) 242-8911
Madison Area (608) 228-1811
Head Office (608) 228-5289
www.strandengineers.com

09B NO. 1567/222



PARTIAL SITE PLAN
 1" = 50'
 N



VIEW OF MONUMENTAL SIGN LOCATION



VIEW OF WALL SIGN LOCATION



VIEW OF EXISTING SIGNAGE AT DMC ACROSS STREET

DATE:	NO.	REVISIONS	DATE:
DES BY:KRT	0	PERMIT APPLICATION	02/19/2010
BY:			
DATE:			
CONTRACTOR:			

**SIGNAGE
SIGN LOCATION MAP**

PROJECT WILLOW
 DANISCO USA, INC.
 MADISON, WISCONSIN



SHEET
06-C0.2

JOB NO. 1567/022

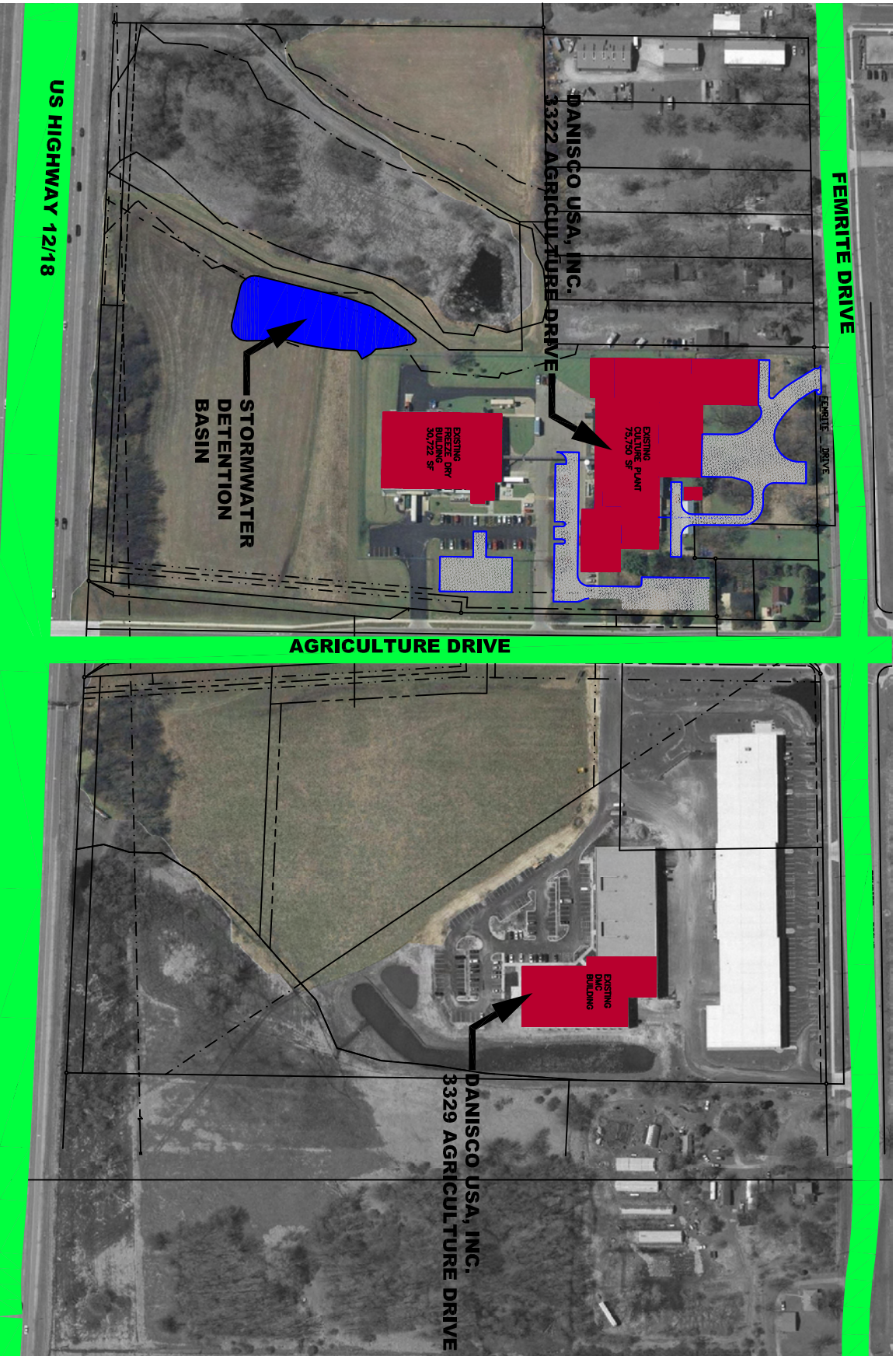

OVERALL SITE PLAN

**SIGNAGE
LOCATION MAP**

PROJECT WILLOW
DANISCO USA, INC.
MADISON, WISCONSIN

DATE: DES BY:KRT CHK BY:JDT
RECORD DRAWING
BY:
DATE:
CONTRACTOR:

NO.	REVISIONS	DATE:
0	PERMIT APPLICATION	02/19/2010

STRAND ASSOCIATES, INC. ENGINEERS

SHEET 06-CO-1

JOB NO. 1567-022



VIEW FROM AGRICULTURE DRIVE
NOT TO SCALE



VIEW FROM FERNITE DRIVE
NOT TO SCALE

**SIGNAGE
RENDERINGS**

PROJECT WILLOW
DANISCO USA, INC.
MADISON, WISCONSIN

DATE: FEBRUARY 2010
DES BY:KRT CHK BY:JDT
RECORD DRAWING
BY:
DATE:
CONTRACTOR:

NO.	REVISIONS	DATE:
0	PERM APPLICATION	02/19/2010



SHEET
06-46-1

JOB NO. 1567/022

DESCRIPTION

VISION FLOOD'S cylindrical form blends effortlessly to architectural and landscape environments. Available in wattages up to 1000 watt Metal Halide and Pulse Start Metal Halide, and in two (2) housing sizes, VISION FLOOD offers properly scaled solutions for any floodlighting application.

Catalog #		Type
Project		
Comments		Date
Prepared by		

SPECIFICATION FEATURES

A ... Housing

One-piece die-cast aluminum housing maintains a nominal .125" thickness to endure the toughest environments while maintaining precise tolerance control.

B ... Door

Die-cast aluminum door maintains a nominal .125" thickness and features concealed hinging to the housing. Door is secured with four (4) tamper resistant recessed stainless steel allen head fasteners. Door frame features an integral accessory channel for the mounting of optional light control accessories. Doorframe seals to housing with a continuous extruded silicone gasket. Lens is impact resistant .180" thick tempered clear flat glass, sealed to the door with a one-piece silicone gasket.

C ... Optical Assembly

Choice of six (6) high efficiency optical systems constructed of premium 95% reflective anodized aluminum sheet, or bright specular anodized polished spun aluminum. Available distributions include Narrow Spot, Narrow Flood, Medium Flood, Wide Flood, Horizontal Spot, and Vertical Flood. All reflector modules feature toolless removal, quick disconnect wire connections, and are field interchangeable. Small housing (VFS) optics feature medium-base lampholders.

D ... Knuckle

Heavy-duty die-cast aluminum knuckle utilizes a taper-lock adjustment mechanism for both solid engagement and infinite aiming adjustment. Knuckle adjustment is made via one (1) captive stainless steel allen head fastener consistent with doorframe fasteners.

D ... Knuckle (Cont'd.)

Tested to sustain 3G of vibration without losing aiming position. VFS knuckle features a 3/4" NPT nipple on bottom surface for rigid attachment to available mounting accessories. Optional slipfitter mount available for VFS.

E ... Electrical Components

High Power Factor (HPF) ballast components are strategically located and heat sunk to the housing for cooler operation and longer life. The VFS housing is rated for 40 degrees C (104 degrees F) ambient environments.

F ... Finish

Housing and arm finished in a 5 stage premium TGIC polyester powder coat paint, 2.5 mil nominal thickness for superior protection against fade and wear. Standard colors include black, bronze, grey, white, dark platinum, and graphite metallic. RAL and custom color matches available. Consult your INVUE Lighting Systems Representative for more information.

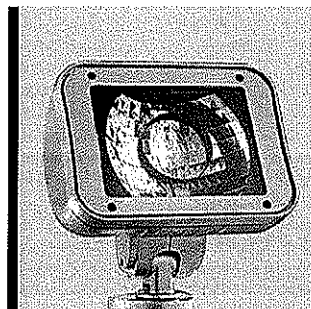

VFS VISION FLOOD SMALL

50 - 175W

Pulse Start Metal Halide
Metal Halide
High Pressure Sodium

ARCHITECTURAL
FLOOD LUMINAIRE

Certifications

IP65 Rated	U.L. 1598 Listed	3G Vibration Tested
CSA Listed	40°C Ambient	ISO 9001

Wattage Table

	VFS
Pulse Start Metal Halide	50, 70, 100, 150W
Metal Halide	175W
High Pressure Sodium	50, 70, 100, 150W

DIMENSIONS

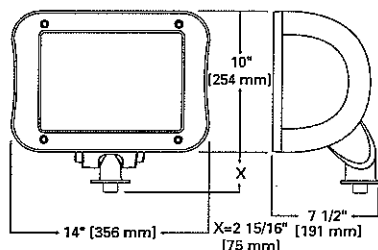

EPA (effected projected area)
1.19

SHIPPING DATA (approx.)
Net Weight (lbs.): 37

ORDERING INFORMATION

Sample Number: VFS-K-150-MP-120-NF-WH

Product Family VFS: Vision Flood Small	Lamp Wattage ¹ MP: 50W 70: 70W 100: 100W 150: 150W MH ² 175: 175W HPS 50: 50W 70: 70W 100: 100W 150: 150W	Voltage ³ 120: 120V 208: 208V 240: 240V 277: 277V 347: 347V 480: 480V DT: Dual-Tap wired 277V ⁴ MT: Multi-Tap wired 277V ⁵ TT: Triple-Tap wired 347V ⁶	Color ⁷ BK: Black AP: Grey BZ: Bronze WH: White DP: Dark Platinum GM: Graphite Metallic VR: Verde Green	Options ⁸ F: Single Fuse (120, 277 or 347V) Specify Voltage FF: Double Fuse (208, 240 or 480V) Specify Voltage PC: Button Type Photocontrol (Specify Voltage) L: Lamp Included	Accessories ⁹ JB-XX: Architectural J-Box with two 3/4" NPT Entries SM-XX: Stanchion Mount ST-XX: Stanchion Mount Tenon WM-XX: Wall Mount WMA-XX: Wall Mount Arm WMT-XX: Wall Mount Arm Tenon Mount TMA-XX: Twin Mount Arm - EPA 0.35 TMT-XX: Twin Mount Arm Tenon Mount - EPA 0.42 SMT-XX: Surface Mount Tenon SF-XX: Silpfilter PM1-XX: Post Mount Extension Single - EPA 0.12 PM2-XX: Post Mount Extension Double - EPA 0.12 VFS-CFR-XX: Color Filter Adaptor with Red Gel VFS-CFB-XX: Color Filter Adaptor with Bright Blue Gel VFS-CFG-XX: Color Filter Adaptor with Deep Green Gel VFS-CFO-XX: Color Filter Adaptor with Warm Orange Gel VFS-BD-XX: Barn Doors - EPA 1.01 VFS-TV-XX: Top Visor - EPA 0.6 VFS-VS: Vandal Shield VFS-GL1: External Grid Louver (NS and NF Optics Only) ¹⁰ VFS-GL2: External Grid Louver (MF, WF, VF and HS optics ¹⁰ only)	Optical System NS: Narrow Spot NF: Narrow Flood MF: Medium Flood WF: Wide Flood VF: Vertical Flood HS: Horizontal Spot	Lamp Type MP: Pulse Start Metal Halide MH: Metal Halide HPS: High Pressure Sodium	Mounting Type K: Knuckle			

- Notes: ¹ All HID lamps are medium-base.
² MH products available for non-U.S. markets only.
³ Products also available in non-US voltages and 50Hz for international markets. Consult factory for availability and ordering information.
⁴ Dual-tap is 120/277V wired 277V.
⁵ Multi-tap is 120/208/240/277V wired 277V.
⁶ Triple-tap is 120/277/347V wired 347V.
⁷ Custom and RAL color matching available upon request. Consult your INVUE Lighting Systems Representative for further information.
⁸ Add as suffix in the order shown.
⁹ Order separately, replace XX with color suffix.
¹⁰ Standard color is black powder coat.

DESCRIPTION

The Vision Flood Small (VFS) knuckle features a 3/4" NPT threaded nipple on its bottom surface for direct mounting to the following accessories: Junction Box (JB), Slipfitter (SF), Stanchion Mount (SM), Twin Arm Mount (TMA), Wall Mount Arm (WMA), Wall Mount (WM), and Post Mount Extensions (PM1, PM2). When coupled with the available slipfitter (SF), the VFS can be mounted to the following accessories: Surface Mount Tenon (SMT), Stanchion Mount Tenon (ST), Twin Mount Arm Tenon (TMT), and Wall Mount Arm Tenon (WMT).

Catalog #	Type
Project	
Comments	
Prepared by	Date

ACCESSORIES SPECIFICATIONS

JUNCTION BOX [JB]

U.L. and CSA listed for wet locations, the Vision J-Box is supplied with a 3/4" clearance hole on the top surface and two (2) 3/4" NPT openings on the bottom surface. An optional drilling consisting of one (1) 1/2" NPT opening on the bottom surface can be specified.

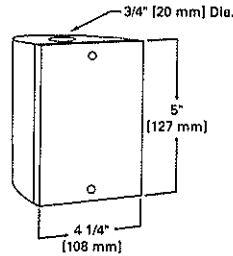

Junction Box [JB]

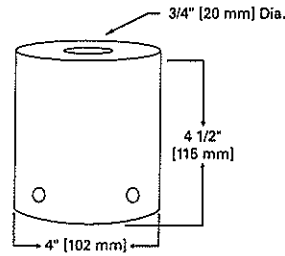

Slipfitter [SF]

SLIPFITTER [SF]

Die-cast aluminum slipfitter features a 3/4" NPT entry point on top surface to mate to standard VFS knuckle. Allows fixture assembly to be mounted to standard 2" pipe size (2 3/8" O.D.) tenons and tenon equipped accessories.

STANCHION MOUNT [SM]

Used to mount fixture above grade to solid surface, or partially buried when secured to concrete pad. Cast aluminum housing and mounting plate is 18" tall and is supplied with a single 3/4" clearance hole entry point.

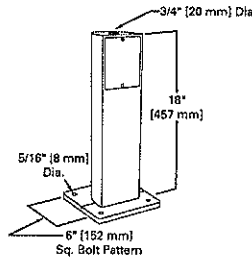

Stanchion Mount [SM]

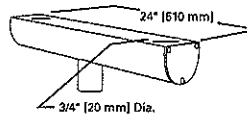

Twin Arm Mount [TMA]

TWIN ARM MOUNT [TMA]

Soft form extruded aluminum arm is 24" in length and features two (2) 3/4" clearance holes for twin fixture mount. Other lengths and drilling patterns available upon request. Twin arm base slip fits over standard 2" pipe size (2 3/8" O.D.) tenon. End caps are removable for wiring access. Useful in ground mount and pole mount applications.

WALL MOUNT ARM [WMA]

Extruded aluminum arm with cast mounting plate is 15" in length and is supplied with a 3/4" clearance hole entry point. Also useful as an arm extension off square area light poles.

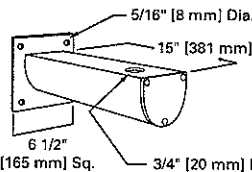

Wall Mount Arm [WMA]

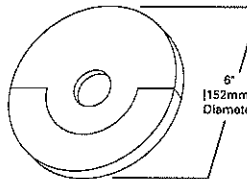

Wall Mount [WM]

WALL MOUNT [WM]

Cast aluminum mounting plate adapts around 4" square or octagonal J-box by others. Additional stud mounting is required beyond J-box attachment. Consists of mounting bracket and cast aluminum splice access cover providing a clean transition to the wall surface. Hanger mount integral to mounting plate allows for ease of installation.

POST MOUNT EXTENSION [PM1/PM2]

Cast aluminum assembly slip fits over standard 2" pipe size (2 3/8" O.D.) tenons, and allows for single (PM1), or double (PM2) mount configurations. Assembly allows for 360° of fixture rotation. Top cap provides splice access. Useful for single or twin, pole mounted downward aiming applications.

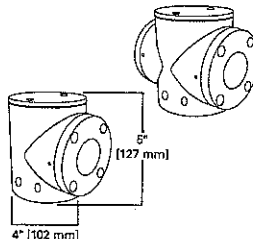

Post Mount Extension [PM1/PM2]

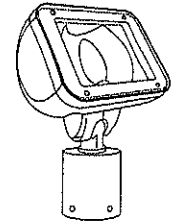

VFS VISION FLOOD SMALL ACCESSORIES

Aiming Range (From Center)

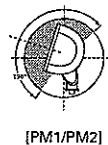
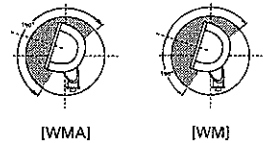
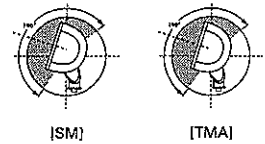
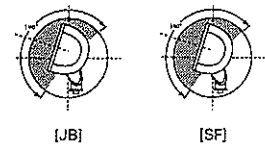

ACCESSORIES SPECIFICATIONS (CON'T.)

SURFACE MOUNT TENON [SMT]

For above-grade surface mount placement, the SMT is supplied with a 4" tall standard 2" pipe size (2 3/8" O.D.) tenon.

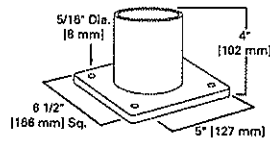

Surface Mount Tenon [SMT]

STANCHION MOUNT TENON [ST]

Used to mount fixture above grade to solid surface, or partially buried when secured to concrete pad. Cast aluminum housing and mounting plate is 18" tall and is supplied with a standard 2" pipe size (2 3/8" O.D.) tenon.

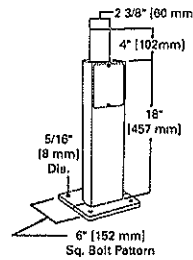

Stanchion Mount Tenon [ST]

TWIN ARM MOUNT TENON [TMT]

Soft form extruded aluminum arm is 24" in length and features two (2) standard 2" pipe size (2 3/8" O.D.) tenons for twin fixture mount. Other lengths and drilling patterns available upon request. Twin arm base slip fits over standard 2" pipe size (2 3/8" O.D.) tenon. End caps are removable for wiring access. Useful in ground mount and pole mount applications. For extended downward aiming, utilize PM1 or PM2 in conjunction with TMT.

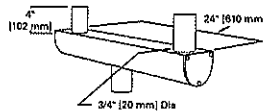

Twin Arm Mount Tenon [TMT]

WALL MOUNT ARM TENON [WMT]

Extruded aluminum arm with cast mounting plate is 15" in length and is supplied with a standard 2" pipe size (2 3/8" O.D.) tenon. Also useful as an arm extension off square area lightpole.

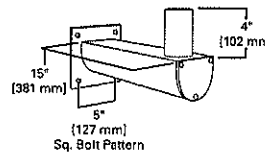

Wall Mount Arm Tenon [WMT]

TOP VISOR [VFS-TV]

Controls excess spill and glare on top portion of distribution. Especially useful in uplighting applications to limit light travel above intended wall surface or sign. Mounts to accessory channel in doorframe. Compatible with all distributions.

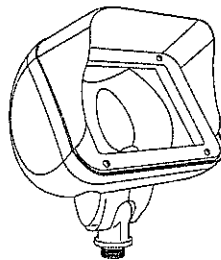

Top Visor [VFS-TV]

BARN DOORS [VFS-BD]

Four (4) independently mounted and adjustable doors control cutoff angles in all directions, allowing custom distribution control for any application. Compatible with all distributions.

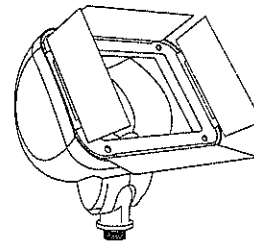

Barn Doors [VFS-BD]

VANDAL SHIELD [VFS-VS]

3/16" thick molded polycarbonate convex lens. Treated with UV inhibitor to discourage the gradual discoloration that results from exposure to sunlight and metal halide lamps.

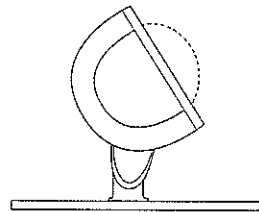

Vandal Shield [VFS-VS]

EXTERNAL GRID LOUVERS [VFS-GL1 / VFS-GL2]

Designed to control lamp glare and spill light while maintaining beam efficiency. Useful when aiming direction or intended target lies in close proximity to pedestrian and/or motor vehicle activity. Mounts to accessory channel in doorframe. Finished in black powder coat paint. GL1 for NS and NF optics only. GL2 for MF, WF, VF and HS optics only.

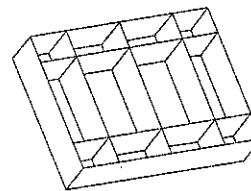

External Grid Louvers [VFS-GL1 / VFS-GL2]

Aiming Range (From Center)

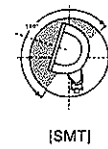

[SMT]

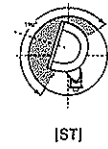

[ST]

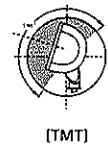

[TMT]

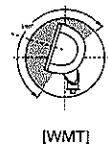

[WMT]

NOTE: Specifications and dimensions subject to change without notice

Visit our web site at www.cooperlighting.com

