

# SAMPLE MENU

## Entrees

*These dinners include your choice of Hibachi or French Garlic Shrimp, soup, salad, vegetables, and steamed rice. (Fried rice \$2.00 extra with dinner)*

TERIYAKI CHICKEN .....	\$16.45
<i>All white meat prepared with our own home made teriyaki sauce.</i>	
HIBACHI CHICKEN .....	\$16.45
<i>Tender white meat cooked until golden brown with a subtle touch of sesame seeds</i>	
HIBACHI SIRLOIN STEAK .....	\$20.95
<i>GINZA's hand trimmed sirloins are the best anywhere. Thick, juicy, delicious</i>	
FILET MIGNON .....	\$22.95
<i>Truly the ultimate cut of beef. Our extra tender filets will melt in your mouth.</i>	
HIBACHI SHRIMP .....	\$20.95
<i>Bright, fresh shrimp sautéed and spiked with a squeeze of Lemon.</i>	
GARLIC SHRIMP .....	\$20.95
<i>Large butterfied shrimp topped with our garlic sauce.</i>	
VEGETABLE DINNER .....	\$15.95
<i>Seasonal fresh vegetables.</i>	
SESAME SCALLOPS .....	\$20.95
<i>Sea scallops cooked until crisp, tender, and golden then glazed with toasted sesame seeds.</i>	
CALAMARI TERIYAKI .....	\$16.45
<i>Surprisingly tender steaks of squid, sautéed in our teriyaki sauce.</i>	
SALMON TERIYAKI .....	\$18.95
<i>Firm Northern Atlantic salmon filet smothered in teriyaki glaze.</i>	
TUNA STEAK TERIYAKI .....	\$18.95
<i>A GINZA original. White tuna in teriyaki sauce.</i>	
WHOLE LOBSTER TAIL .....	Market Price
<i>Fresh cold-water lobster.</i>	

## Sushi Bar

*All sushi dinners come with soup & salad.*

SUSHI SELECT .....	\$18.50
<i>1 Tuna roll, 1 Salmon roll and 7 pieces nigiri</i>	
SUSHI CHEF'S CHOICE SELECT .....	\$22.95
<i>1 California roll, 1 Salmon roll and 9 pieces nigiri.</i>	
CHIRASHI SUSHI .....	\$19.95
<i>12 pieces sashimi over sushi rice</i>	
TEKKA DON .....	\$18.95
<i>Fresh tuna served over a bed of sushi rice.</i>	
UNAGI DON .....	\$19.95
<i>Broiled fresh water eel glazed with sweet eel sauce served over rice.</i>	
SASHIMI DINNER .....	\$23.95
<i>16 piece of our finest cuts of fish.</i>	
3 SPICY COMBO ROLL DINNER .....	\$37.95
<i>1 Spicy Tuna roll, 1 Spicy Salmon roll and 1 Shrimp Tempura roll.</i>	
VEGETARIAN ROLL DINNER .....	\$14.95
<i>1 Avocado roll, 1 Kappa roll, 1 Kamayo roll, 1 Yamagobo roll.</i>	
SUSHI-SASHIMI COMBINATION .....	\$25.95
<i>1 California roll, 9 pieces sashimi, 6 pieces nigiri</i>	
GINZA SPECIAL FOR TWO .....	\$49.95
<i>9 pieces nigiri, Rainbow roll, and 24 piece sashimi.</i>	

**Combinations**

*Virtually every combination one could desire! These dinners include your choice of Hibachi or French Garlic Shrimp, soup, salad, vegetables, and steamed rice. (Fried rice \$2.00 extra with dinner)*

**GINZA CHICKEN**  
*Hibachi seasonings or Teriyaki*

and SHRIMP ( <i>Hibachi or Garlic</i> ).....	\$23.00
and SCALLOPS .....	\$24.00
and SALMON .....	\$22.00
and TUNA STEAK .....	\$22.00
and CALAMARI .....	\$22.00

**HIBACHI SIRLOIN STEAK**  
*Filet Mignon available for \$2.00 extra*

and SHRIMP ( <i>Hibachi or Garlic</i> ).....	\$27.50
and SCALLOPS .....	\$28.00
and SALMON .....	\$26.50
and TUNA STEAK .....	\$26.50
and CHICKEN .....	\$24.00
and CALAMARI .....	\$24.00

**IRRESISTIBLE SHRIMP (*Hibachi or Garlic*)**

and SCALLOPS .....	\$28.00
and SALMON .....	\$27.00
and TUNA STEAK .....	\$26.00
and CALAMARI .....	\$26.00

**LOBSTER FEAST**  
*Hibachi style*

and STEAK ( <i>Filet Mignon available for \$2.00 extra</i> ).....	\$37.00
and CHICKEN ( <i>Hibachi or Teriyaki</i> ).....	\$33.00
and SHRIMP ( <i>Hibachi, Golden or Garlic</i> ).....	\$37.00
and SCALLOPS .....	\$37.00
and CALAMARI .....	\$34.00
and SALMON .....	\$36.00
and TUNA STEAK .....	\$36.00

**GINZA SUMO SPECIAL** ..... Market Price  
*Are you big enough to wrestle with our champion? A twelve ounce lobster tail cooked with a six ounce filet mignon. Add a mound of vegetables, your choice of side order, and dessert. This is a meal fit for a Sumo champion.*

**Noodles**

NABEYAKI UDON .....	\$14.95
<i>A mixed pot of shrimp, scallop with udon noodles in special Ginza soup.</i>	
TEMPURA UDON .....	\$14.95
<i>Golden fried shrimp tempura over udon noodles in special Ginza soup.</i>	
YAKI UDON .....	\$14.95
<i>Pan fried noodles with chicken and vegetables.</i>	

**Starters**

TEMPURA APPETIZER ( <i>fried golden in our Japanese batter</i> )	
Shrimp \$7.00 Calamari \$6.00 Vegetables \$5.50	
ASPARAGUS BEEF ROLL .....	\$8.00
<i>Fresh asparagus tips rolled in boiled beef.</i>	
GYOZA .....	\$5.50
<i>Korean style pan fried beef dumplings.</i>	
YAKITORI .....	\$5.50
<i>Tender pieces of chicken stewered and glazed with our teriyaki sauce.</i>	
AGE-DASHI TOFU .....	\$5.00
<i>Deep fried tofu with special sauce.</i>	
SOFT SHELL CRAB .....	\$10.00
<i>Delicious whole crab battered and fried until crisp and tender.</i>	
EDA MAME .....	\$4.00
<i>Steamed green soybeans.</i>	
SUSHI APPETIZER .....	\$8.95
<i>Includes one piece tuna, white tuna, shrimp and red snapper</i>	
TUNA SASHIMI APPETIZER .....	\$12.95
<i>Sliced fresh tuna.</i>	
COMBINATION SASHIMI APETIZER .....	\$12.95
<i>Sliced fresh tuna and yellowtail</i>	
TAKO-SU .....	\$6.95
<i>Octopus and cucumber salad with our light vinaigrette dressing.</i>	
SASHIMI SALAD .....	\$8.95
<i>Fresh tuna, salmon, red snapper, radish, cucumber with hot spicy sauce.</i>	
SEAWEEED SALAD .....	\$4.50
SQUID SALAD.....	\$5.50
SHUMAI .....	\$5.00
<i>Japanese style steamed shrimp dumplings.</i>	
BEEF SASHIMI .....	\$9.95
<i>Thin slices of beef with ponju sauce</i>	

**Children Menu**

*For children 8 or younger*

CHICKEN (HIBACHI OR TERIYAKI).....	\$8.45
HIBACHI SIRLOIN STEAK.....	\$9.95
HIBACHI SHRIMP .....	\$9.95

*All children's dinners include choice of soup or salad, and steamed rice*

**Extras**

HIBACHI SHRIMP.....	\$7.00	VEGETABLES.....	\$3.00
GOLDEN SHRIMP.....	\$7.00	GINZA SOUP.....	\$3.00
GARLIC SHRIMP.....	\$7.00	GINZA SALAD.....	\$2.00
HIBACHI SCALLOPS.....	\$8.00	MISO SOUP.....	\$3.00
FRIED RICE .....	\$4.50		

THE ARCHITECTURAL PRACTICE  
 1050 W. 35th Street  
 Minneapolis, MN 55409  
 (612) 338-1234  
 www.thearchitecturalpractice.com

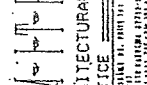

**HOOTERS**  
 OF PARKWOOD  
 MINERAL POINT ROAD  
 MINNEAPOLIS, MN 55409

PROJECT NO. 2323  
 DRAWING NO. 101  
 DATE 10/14/15  
 SHEET NO. 101

A.2

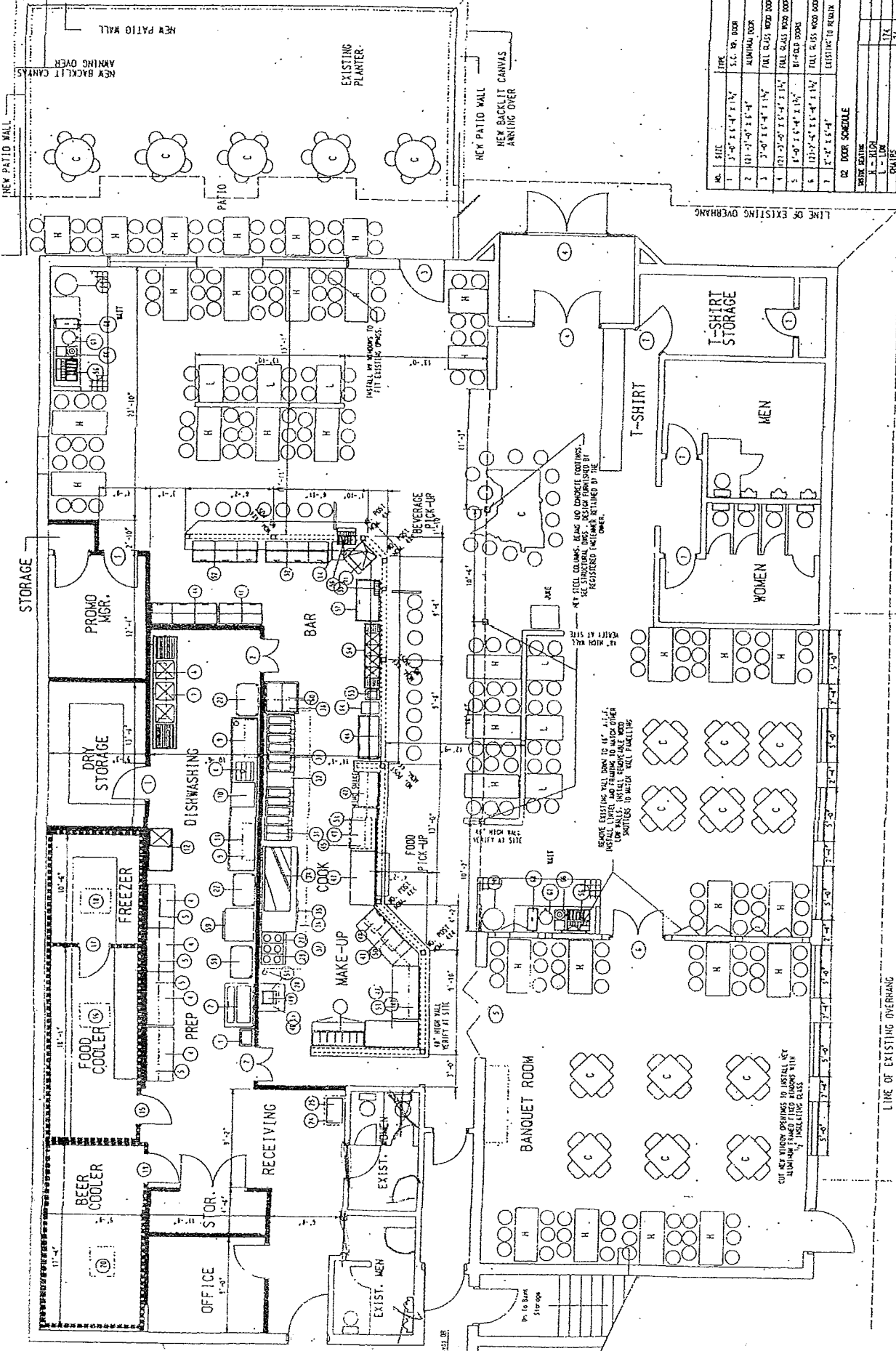

NO.	SIZE	TYPE	QTY.	NO. DOOR
1	3'-0" x 1'-4" x 1'-4"	GLASS DOOR	1	
2	3'-0" x 1'-4" x 1'-4"	ALUMINUM DOOR	1	
3	3'-0" x 1'-4" x 1'-4"	TALL GLASS WOOD DOOR	1	
4	3'-0" x 1'-4" x 1'-4"	TALL GLASS WOOD DOOR	1	
5	3'-0" x 1'-4" x 1'-4"	BI-FOLD DOOR	1	
6	3'-0" x 1'-4" x 1'-4"	TALL GLASS WOOD DOOR	1	
7	3'-0" x 1'-4" x 1'-4"	EXISTING TO REMAIN	1	

DOOR SCHEDULE

DOOR	TYPE	FR	FL	GL	HW	HT
1	GLASS DOOR			1/2"	1 1/4"	68"
2	ALUMINUM DOOR			1/2"	1 1/4"	68"
3	TALL GLASS WOOD DOOR			1/2"	1 1/4"	72"
4	TALL GLASS WOOD DOOR			1/2"	1 1/4"	72"
5	BI-FOLD DOOR			1/2"	1 1/4"	72"
6	TALL GLASS WOOD DOOR			1/2"	1 1/4"	72"
7	EXISTING TO REMAIN			1/2"	1 1/4"	68"

TOTAL SEATING 300

01 FLOOR PLAN