

**Application for Change of Licensed Premise**  
(No Fee Required)

**Applicants must appear before the ALRC. Detailed floor plans must accompany this form, or request will not be presented to the committee.**

**Please contact City Zoning (Municipal Building LL-100, 266-4560). A Conditional Use Permit may be required. There is a fee for the Conditional Use Permit.**

**Corporate/Owner Name** Creative Host Services, Inc.

**DBA** Cafe Ritazza

**Address** Dane County Regional Airport  
4000 International Lane, Madison, WI 53708

**Agent** Patricia Brand

**Capacity** 56 **% Alcohol** 15 **% Food** 85

**Description of Expansion Plans:**

Facility located on the ground level of airport with 1750 sq. ft. and  
125 sq. ft. of storage. Seating approximately 56. Customer seating  
includes 10 tables with 40 seats, one counter with 5 stools and a  
16' X 3' bar with 7 bar stools.

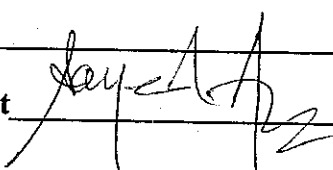
**Signature of Applicant**  **Date** 02/14/07

**To be considered at ALRC meeting of** \_\_\_\_\_

**and Common Council Meeting of** \_\_\_\_\_

**License Type** \_\_\_\_\_ **License #** \_\_\_\_\_ **Legistar #** \_\_\_\_\_

**Approved      Disapproved**

**Routed:**      **City Zoning**  
                  **Building Inspection Unit – Permit Counter**  
                  **Madison Police Department**  
                  **Aldersperson** \_\_\_\_\_

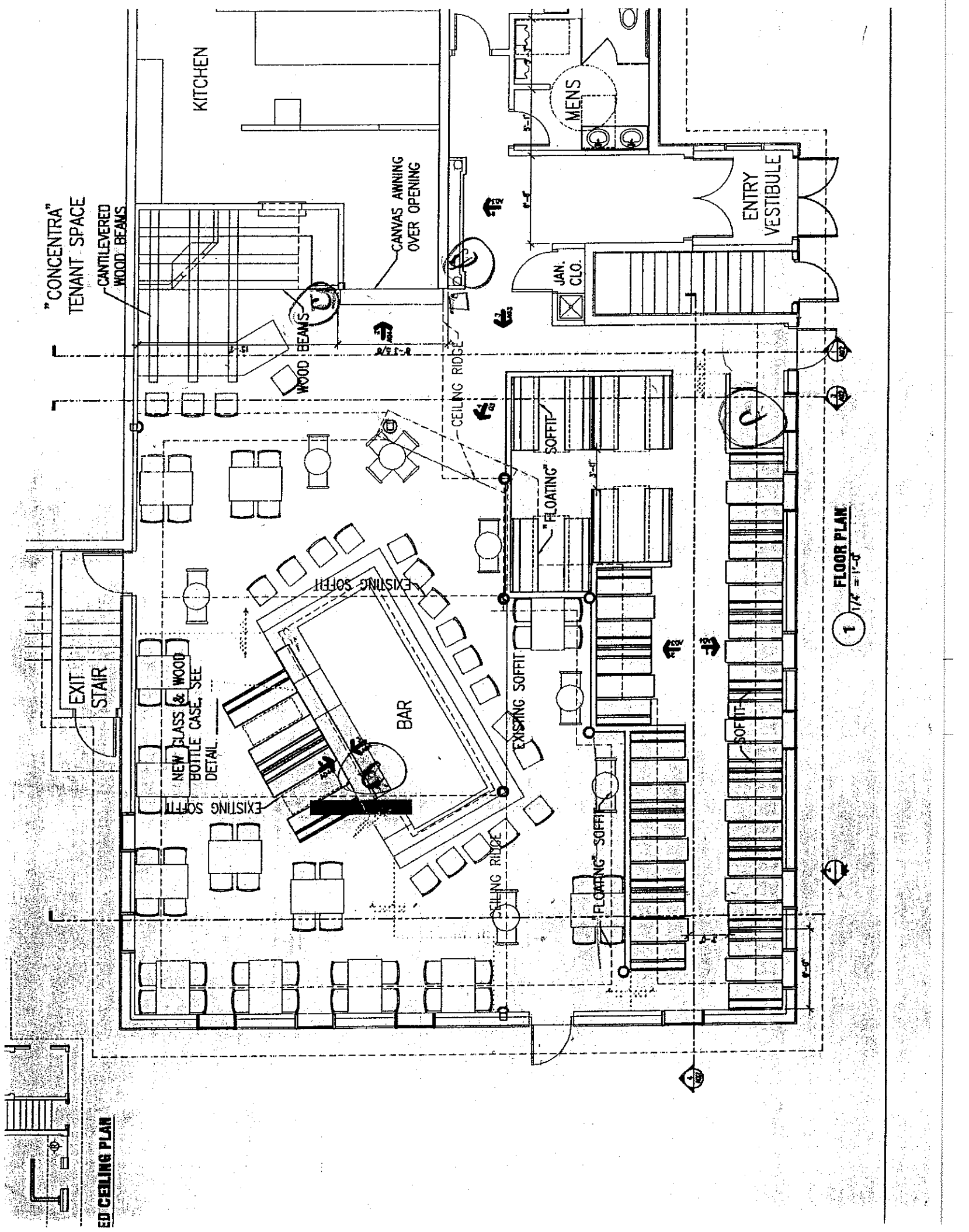

"CONCENTRA"  
TENANT SPACE

KITCHEN

MENS

ENTRY  
VESTIBULE

JAN.  
CLO.

CANVAS AWNING  
OVER OPENING

WOOD BEAMS

CEILING RIDGE

EXISTING SOFFIT

"FLOATING"  
SOFFIT

EXISTING SOFFIT

"FLOATING"  
SOFFIT

SOFFIT

NEW GLASS & WOOD  
BOTTLE CASE, SEE  
DETAIL

EXISTING SOFFIT

BAR

CEILING RIDGE

EXIT  
STAIR

FLOOR PLAN

1

1/2" = 1'-0"

ED CEILING PLAN