

JD# 02152

★ WAITING FOR CORRECTED MAP ★

PETITION FOR DIRECT ANNEXATION BY UNANIMOUS APPROVAL

TO: The Honorable Mayor of the City of Madison and the Common Council of the City of Madison, Dane County, Wisconsin

The undersigned Petitioner, Emma M. Lawry, Trustee for the Lawry Family Trust being the sole owner of all the real property in the territory to be annexed as described herein, does hereby petition the Mayor and the Common Council of the City of Madison to annex to the City of Madison the territory in the Town of Burke described as follows:

A parcel of land located in Township 8 North, Range 10 East, Town of Burke, Dane County, Wisconsin, to-wit:

CENTERLINE  
map

Part of SW1/4 SE1/4 lying South of Southwest right of way line of I-90 and North of <sup>THE</sup> ~~North~~ right-of-way line of Hoepker Road, Section 9, Township 8 North, Range 10 East, Dane County, Wisconsin.

This parcel contains 5 acres (217,800 square feet), more or less.

1. This Petition for Direct Annexation by Unanimous Approval is made by the sole owner of all the real property as described above and is submitted in accordance with and is authorized by Section 66.0217(2), Wisconsin Statutes, for the purpose of annexing the above described territory to the City of Madison from the Town of Burke.
2. The undersigned is the sole owner of all of the real property in the territory to be annexed. There are no electors residing in the territory.
3. The population of the territory to be annexed is zero.
4. The territory to be annexed is now in the Town of Burke, Dane County, Wisconsin.
5. The territory to be annexed is contiguous to the City of Madison on its South and West boundaries.
6. The territory to be annexed is further described in a scale map attached hereto as **Exhibit A** and incorporated herein by reference. **Exhibit A** shows the boundaries of such territory and the relationship of the territory to the municipalities involved and the surrounding lands.

Dated: 10-4-05

Emma M. Lawry  
Emma M. Lawry, Trustee for the Lawry Family Trust

RECEIVED-CITY OF MADISON  
CLERKS OFFICE  
05 OCT -4 AM 11:31

cc: Kitty Noonan, Attorney  
Al Martin, Planning

STATE OF WISCONSIN    )  
  ) ss.  
COUNTY OF DANE        )

Personally came before me this 4 day of October, 2005, the above-named, Emma M. Lawry, Trustee for the Lawry Family Trust, to me known to be the person who executed the above and foregoing instrument and acknowledged that she executed and delivered the same for the purposes stated therein.



Irina Porto

Notary Public, State of Wisconsin  
My Commission Expires: 11/16/2008

lawry\1\petition for direct annexation doc

RECEIVED-CITY OF MADISON  
CLERKS OFFICE  
05 OCT -4 AM 11:32

EXHIBIT A:  
LANDS TO BE ANNEXED  
FROM THE TOWN OF BURKE  
TO THE CITY OF MADISON

File No \_\_\_\_\_  
Date Adopted: \_\_\_\_\_  
Area: 5A

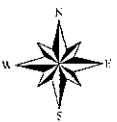
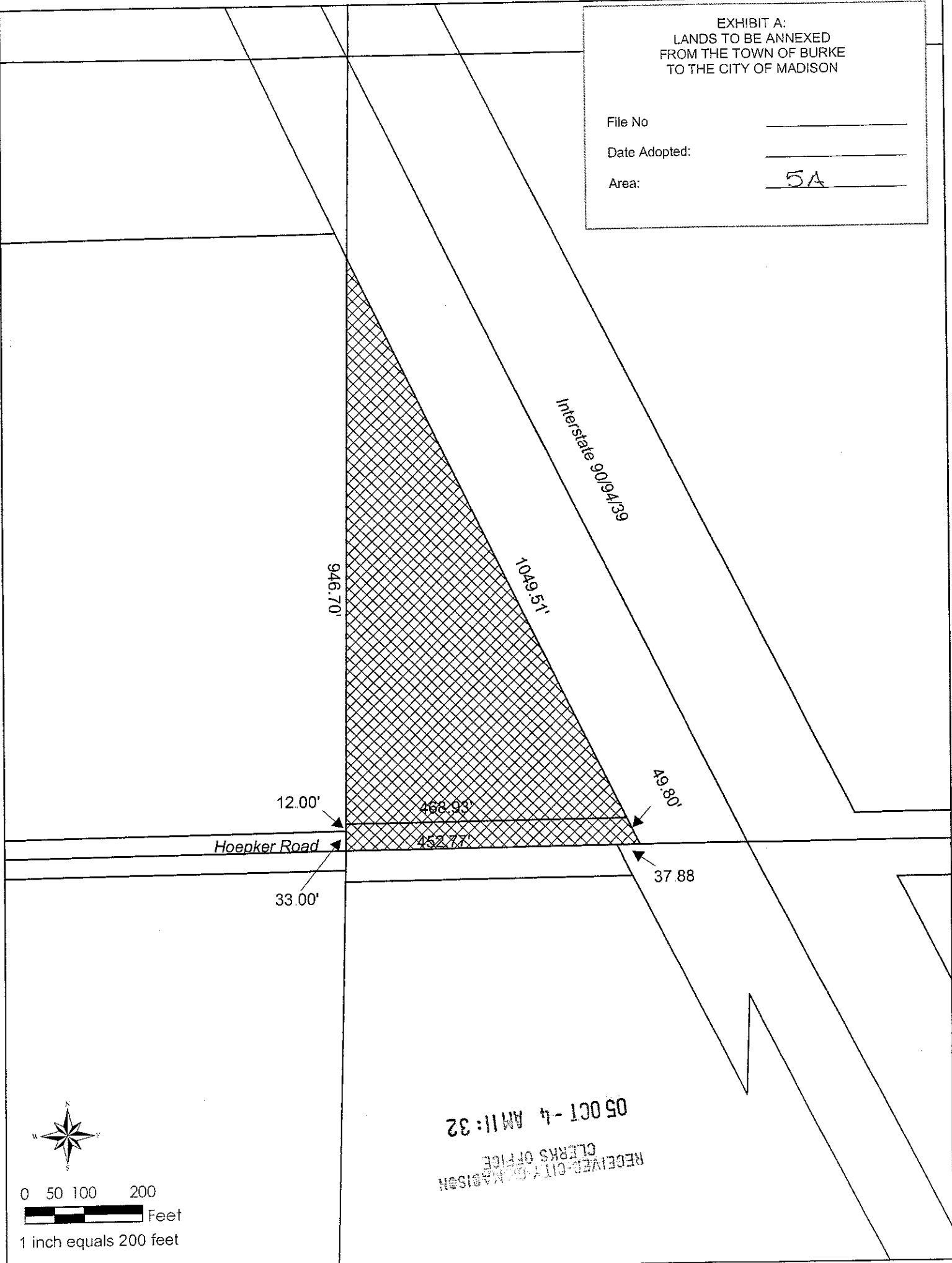

0 50 100 200  
Feet  
1 inch equals 200 feet

RECEIVED - CITY OF MADISON  
CLERKS OFFICE  
05 OCT - 4 AM 11:32