

DESCRIPTION

Eon 303-B1-LEDB1 is a compact, low profile, dimmable, LED bollard that provides downlight only via a fixed head. 303-B1-LEDB1 has a single head on one side of the luminaire. The bollard comes standard with universal input LED driver (120-277V, 50/60 Hz). Dimming is achieved with a standard ELV, reverse phase dimming driver or an optional 0-10V dimming driver. Eon fixtures may be used indoors or outdoors and carry an IP66 rating. The patented LumaLevel™ leveling system provides quick installation, easy adjustment, secure mounting and protection from vibration.

Catalog #		Type
Project		
Comments		Date
Prepared by		

SPECIFICATION FEATURES

Construction

The head of the 303-B1-LEDB1 is precision machined from corrosion-resistant 6061-T6 aluminum. Body is extruded aluminum and adjustable mounting base is cast from corrosion resistant aluminum alloy. Stainless steel hardware is included. Four (4) 3/8" x 12" galvanized anchor bolts and a galvanized steel anchor bolt template are standard. Specify option -LAB and order the anchor bolt/template kit separately (Catalog: 7581-01PK).

Optical

LightBAR™ and optical assembly are sealed by a clear, impact resistant tempered glass lens. The optical assembly is available in three distributions: T2 (lateral throw), T4 (forward throw) and T5X (Flood). Available in several color temperatures: 2700K, 3000K, 3500K,

4000K and TSAM (Amber). Both color temperature and distribution must be specified when ordering – see catalog logic for details. An edge-lit option is available.

Electrical

The bollard is standard with an ELV trailing edge phase dimmable driver that accepts a universal input (120-277, 50/60Hz). An optional 0-10V universal dimming driver is also available. Both driver options incorporate surge protection. The receptacle option incorporates a specification grade, 120V, 15A tamper proof and weather resistant duplex GFCI. The photocell option comes in either a 120V or 277V. Please see Option section for more detail.

Finish

Luminaire and mounting base are double protected by a RoHS compliant chemical film undercoating and polyester powdercoat paint finish. The mounting base is painted black. The luminaire housing and head are available in a variety of standard colors. RAL and custom color matches are available upon request. As an option, the Eon bollards are also available in colors to match other outdoor Eaton product lines, such as Invue. See the Finish section in the ordering detail for more detail.

Warranty

Lumière warrants the EON series of fixtures against defects in material and workmanship for five (5) years. Auxiliary equipment such as LED drivers carries the original manufacturer's warranty.

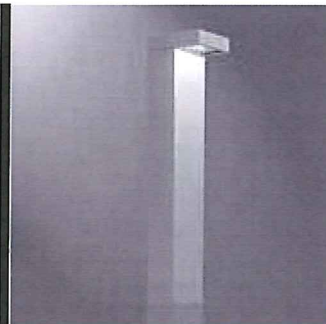

303-B1-LEDB1
EON LED

APPLICATIONS:
BOLLARD

CERTIFICATION DATA
UL and cUL Wet Location Listed
LM79 / LM80 Compliant
ROHS Compliant
IP66 Ingressed Protection Rated

TECHNICAL DATA
50°C Maximum Temperature Rating
External Supply Wiring 90°C Minimum

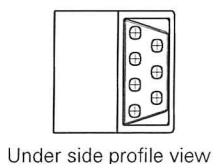
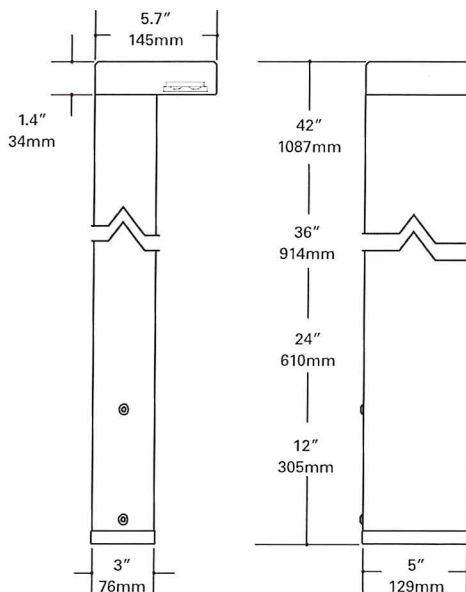

ORDERING INFORMATION

Sample Number: 303-B1-LEDB1-2700-120-T2-DIM10-BK-42-EDGE-PC1-RFL-LAB

Series ⁹	Color Temperature	Input Voltage	Optics	Dimming	Finish ³	Height ⁴	Options ⁶
303-B1-LEDB1 Head contains one (1) Mini LightBAR™	2700=2700K 3000=3000K 3500=3500K 4000= 4000K TSAM=Turtle Safe Amber (585-595nm)	UNV=120-277V ¹ 120=120V 277=277V ²	T2 =Type II, Lateral Throw T4 =Type IV, Forward Throw T5X = Type V, Extra Wide Flood	DIMELV=Trailing Edge Phase Dimming Driver DIM10=0-10V Dimming Driver	Painted BK=Black BZ=Bronze CS=City Silver WT=White Premium Paint AP=Grey DP=Dark Platinum GM=Graphite Metallic	12=12" ⁵ 24=24" 36=36" 42=42"	EDGE=Edge lit glass lens PC1=Photocontrol 120V ⁷ PC2=Photocontrol 208-277V ⁷ RIU=Receptacle - In Use (120V Only) ⁷ RFL=Receptacle - Flip-Lid (120V Only) ⁷ LAB=Less Anchor Bolts & Template ⁸

NOTES: 1 Universal Voltage (UNV) is standard unless specifying Photocontrol or Receptacle (RIU or RFL - 120V) options. 2 Specify for PC2 option only. 3 Custom and RAL color matching available upon request. Consult factory for further information. 4 Bollard heights are nominal (shown in inches). 5 12" length not available with RIU or RFL options. 6 Add suffix in the order shown. 7 Must specify voltage when ordering. 8 When specifying LAB option the anchor bolts and template need to be ordered separately 7581-01PK. 9 DesignLights Consortium™ Qualified and classified for DLC Standard. Refer to www.designlights.org for details on exact qualified EON 303-B1-LEDB1 product as not all configurations are DLC classified.



LUMEN MAINTENANCE

Ambient Temperature	TM-21 Lumen Maintenance (72,000 Hours)	TM-21 Reported L70(10k) (Hours)	Theoretical L70 (Hours)
25°C	> 94%	> 60,000	365,000
40°C			
50°C			

CURRENT DRAW

Model	Line Voltage	Current Draw
303-B1-LEDB1	120-277V, 50/60Hz	0.068A

MAX LOAD RATING

Options	Line Voltage	Max Load Rating
PC1	120V, 50/60Hz	1000VA, 8.3A
PC2	208-277V, 50/60Hz	
RIU or RFL	120V, 50/60Hz	1800VA, 15A

LUMENS - CRI/CCT TABLE

Optic Type	Distribution	Watts	Delivered Lumens	LPW	CCT (K) / Color	CRI nom. / Wavelength	B-U-G Rating
T2 (Lateral Throw)		8.5	361	44	2700	95	B0-U0-G0
			600	74	3000	75	
			419	51	3500	85	
			661	81	4000	75	
		6.5	184	28	TSAM (Amber)	585-595nm	
T4 (Forward Throw)		8.5	353	43	2700	95	B0-U0-G0
			587	72	3000	75	
			410	50	3500	85	
			647	79	4000	75	
		6.5	180	28	TSAM (Amber)	585-595nm	
T5X (Extra Wide Flood)		8.5	316	39	2700	95	B0-U0-G0
			525	65	3000	75	
			367	45	3500	85	
			579	71	4000	75	
		6.5	161	25	TSAM (Amber)	585-595nm	

OPTIONS

Receptacle Options (120V Only)

RIU - Receptacle In-Use

Rugged UV-resistant polycarbonate clear cover and gray body protects GFCI without cracking or breaking and is non-corrosive. Note: Cover is weatherproof with the cord plugged in and the receptacle is not required to be attended while in use. The receptacle incorporates a specification grade, 120V, 15A tamper proof and weather resistant duplex GFCI. Available on 24", 36" and 42" heights.

RFL - Receptacle Flip Lid

Cover is constructed of a durable, die-cast zinc alloy and is painted to match fixture. Cover is only weatherproof without the cord plugged in and the cover closed. The receptacle will need to be attended while in use. The receptacle incorporates a specification grade, 120V, 15A tamper proof and weather resistant duplex GFCI. Available on 24", 36" and 42" heights.

Photocontrol

PC1 (120V) or PC2 (277V)

Photocontrol cover is precision machined from corrosion-resistant 6061-T6 aluminum and is secured to bollard head with tamper resistant stainless steel hardware. The photocontrol option is available in dedicated 120V or 208-277V. When specifying a photocontrol option make sure to designate the appropriate voltage within the catalog logic.

Edge

When specifying with the EDGE option, the diffused glass becomes thicker adding a visible line of light around the edge accentuating the luminaires' aesthetics and styling.

TECHNICAL NOTES:

- Adjustable mounting base - Cast aluminum mounting base is equipped with the patented LumaLevel™ leveling system that includes mounting base, 70 shore neoprene base, stainless steel hardware and a slot to accommodate two inbound and outbound 3/4" conduits. It provides quick installation, easy adjustment, secure mounting and protection from vibration.



Excellence in Illumination Engineering Software
since 1984



sample banner copyright 2013 Lighting Analysts, Inc.

Photometric Report (Type C)

Filename: B1_303-B1-LEDB1-3000-UNV-T2-DIM10-BK.ies
 [TEST] P174930 TEST IS SCALED FROM IESNA LM-79-08 TEST
 DATA (P33867)
 [TESTLAB] INNOVATIONS CENTER-P3
 [ISSUEDATE] 6/4/2015
 [MANUFAC] EATON - LUMIERE (FORMER COOPER LIGHTING)
 [LUMCAT] 303-B1-LEDB1-3000-UNV-T2-DIM10-BK
 [LUMINAIRE] LUMIERE EON 303-B1, SINGLE HEAD BOLLARD,
 SINGLE LED BAR. TYPE II LATERAL THROW OPTICS, CLEAR
 GLASS LENS.
 [LAMP] (7) 3000K CCT, 75 CRI LEDS

Maximum Candela = 561.3 at 75 H 62.5 V

Classification:

Road Classification: Type II, Short, N.A. (deprecated)
 Upward Wast Light Ratio: 0.00
 Luminaire Efficacy Rating (LER): 73
 Indoor Classification: Direct
 BUG Rating : B0-U0-G0

Polar Candela Curves:

Vertical Plane Through:
 1) 75 - 255 Horizontal

Horizontal Cone Through:
 2) 62.5 Vertical

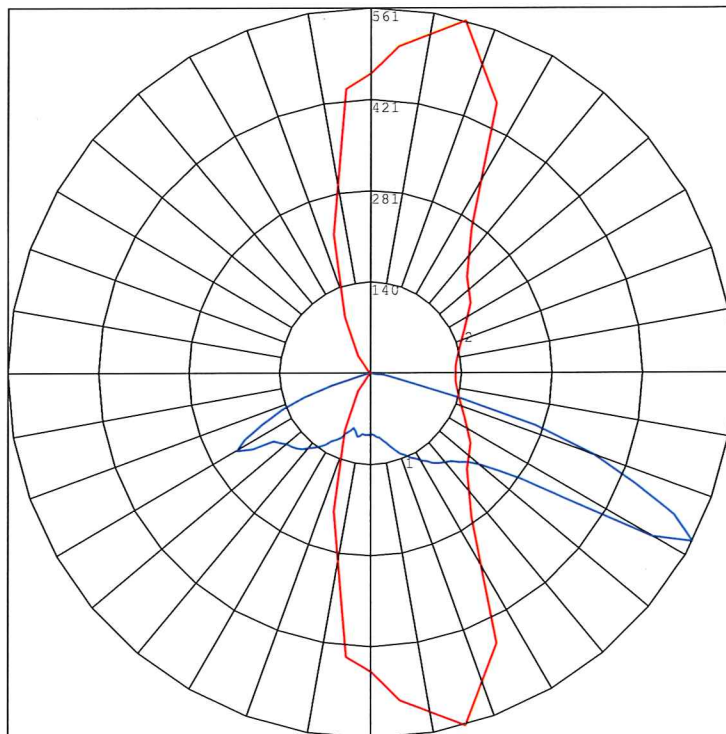



Excellence in Illumination Engineering Software
since 1984



sample banner copyright 2013 Lighting Analysts, Inc.

Photometric Report (Type C)

Filename: B1_303-B1-LEDB1-3000-UNV-T2-DIM10-BK.ies
[TEST] P174930 TEST IS SCALED FROM IESNA LM-79-08 TEST
DATA (P33867)
[TESTLAB] INNOVATIONS CENTER-P3
[ISSUEDATE] 6/4/2015
[MANUFAC] EATON - LUMIERE (FORMER COOPER LIGHTING)
[LUMCAT] 303-B1-LEDB1-3000-UNV-T2-DIM10-BK
[LUMINAIRE] LUMIERE EON 303-B1, SINGLE HEAD BOLLARD,
SINGLE LED BAR. TYPE II LATERAL THROW OPTICS, CLEAR
GLASS LENS.
[LAMP] (7) 3000K CCT, 75 CRI LEDS

Maximum Candela = 561.3 at 75 H 62.5 V

Classification:

Road Classification: Type II, Short, N.A. (deprecated)
Upward Waste Light Ratio: 0.00
Luminaire Efficacy Rating (LER): 73
Indoor Classification: Direct
BUG Rating : B0-U0-G0

LCS Summary:

LCS Zone	Lumens	%Lamp	%Lum
FL (0-30)	55.5	N.A.	9.3
FM (30-60)	250.1	N.A.	41.7
FH (60-80)	153.3	N.A.	25.6
FVH (80-90)	2.4	N.A.	0.4
BL (0-30)	18.7	N.A.	3.1
BM (30-60)	73.3	N.A.	12.2
BH (60-80)	45.8	N.A.	7.6
BVH (80-90)	0.4	N.A.	0.1
UL (90-100)	0.0	N.A.	0.0
UH (100-180)	0.0	N.A.	0.0
Total	599.5	N.A.	100.0
BUG Rating	B0-U0-G0		

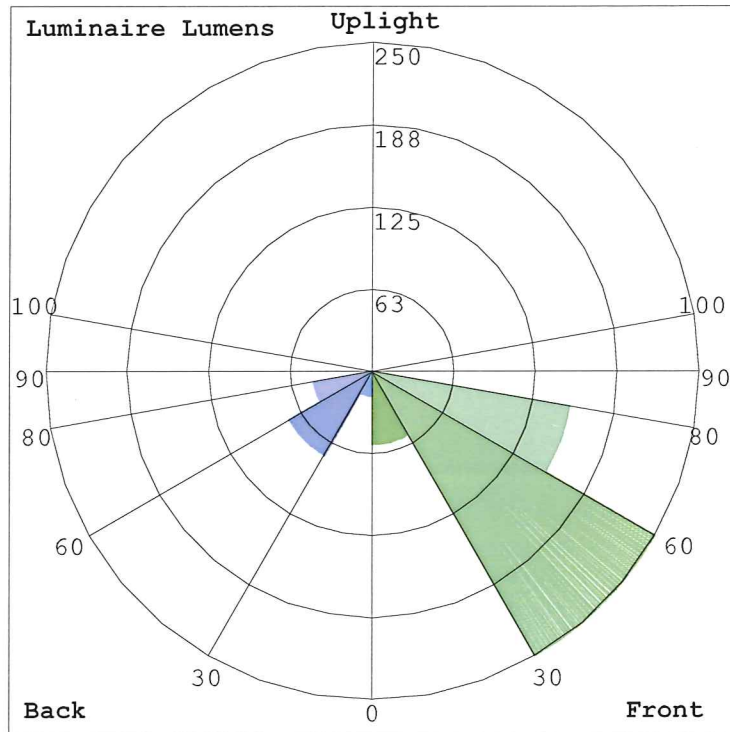

DESCRIPTION

Eon 303-B1-LEDB2 is a compact, low profile, dimmable, LED bollard that provides downlight only via a fixed head. 303-B1-LEDB2 has a single head on one side of the luminaire. The bollard comes standard with universal input LED drivers (120-277V, 50/60 Hz). Dimming is achieved with a standard ELV, reverse phase dimming driver or an optional 0-10V dimming driver. Eon fixtures may be used indoors or outdoors and carry an IP66 rating. The patented LumaLevel™ leveling system provides quick installation, easy adjustment, secure mounting and protection from vibration.

Catalog #		Type
Project		
Comments		Date
Prepared by		

SPECIFICATION FEATURES

Construction

The head of the 303-B1-LEDB2 is precision machined from corrosion-resistant 6061-T6 aluminum. Body is extruded aluminum and adjustable mounting base is cast from corrosion resistant aluminum alloy. Stainless steel hardware is included. Four (4) 3/8" x 12" galvanized anchor bolts and a galvanized steel anchor bolt template are standard. Specify option -LAB and order the anchor bolt/template kit separately (Catalog: 7581-01PK).

Optical

LightBAR™ and optical assembly are sealed by a clear, impact resistant tempered glass lens. The optical assembly is available in three distributions: T2 (lateral throw), T4 (forward throw) and T5X (Flood). Available in several color temperatures: 2700K, 3000K, 3500K,

4000K and TSAM (Amber). Both color temperature and distribution must be specified when ordering – see catalog logic for details. An edge-lit option is available.

Electrical

The bollard is standard with an ELV trailing edge phase dimmable driver that accepts a universal input (120-277, 50/60Hz). The standard driver is ELV trailing edge phase dimmable. An optional 0-10V dimming driver is also available. Both driver options incorporate surge protection. The receptacle option incorporates a specification grade, 120V, 15A tamper proof and weather resistant duplex GFCI. The photocell option comes in either a 120V or 277V. Please see Option section for more detail.

Finish

Luminaire and mounting base are double protected by a RoHS compliant chemical film undercoating and polyester powdercoat paint finish. The mounting base is painted black. The luminaire housing and head are available in a variety of standard colors. RAL and custom color matches are available upon request. As an option, the Eon bollards are also available in colors to match other outdoor Eaton product lines, such as Invue. See the Finish section in the ordering detail for more detail. The LightBAR™ cover plates are standard white.

Warranty

Lumiere warrants the EON series of fixtures against defects in material and workmanship for five (5) years. Auxiliary equipment such as LED drivers carries the original manufacturer's warranty.

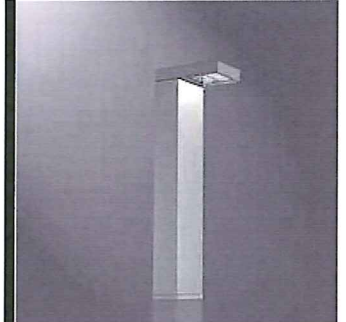

303-B1-LEDB2
EON LED

APPLICATIONS:
BOLLARD

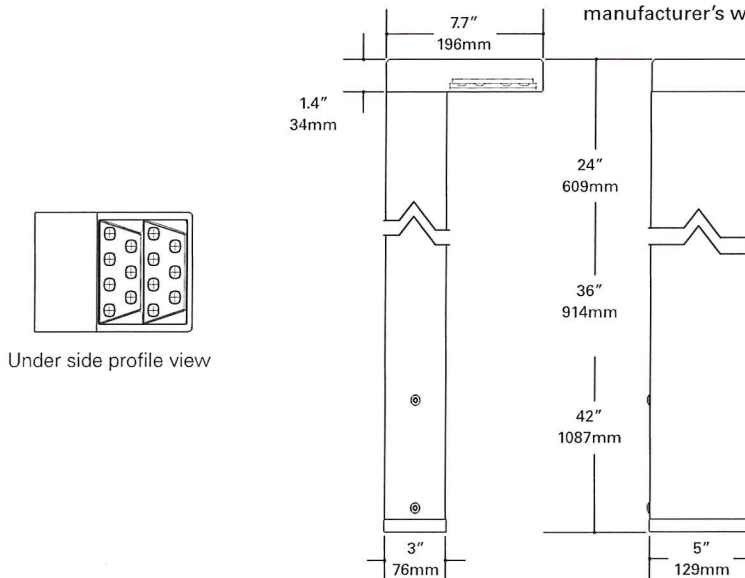

CERTIFICATION DATA

UL and cUL Wet Location Listed
LM79 / LM80 Compliant
ROHS Compliant
IP66 Ingress Protection Rated

TECHNICAL DATA

50°C Maximum Temperature Rating
External Supply Wiring 90°C Minimum



ORDERING INFORMATION

Sample Number: 303-B1-LEDB2-2700-120-T2-DIM10-BK-42-EDGE-PC1-RFL-LAB

Series ⁸	Color Temperature	Input Voltage	Optics	Dimming	Finish ³	Height ⁴	Options ⁵
303-B1-LEDB2	2700=2700K 3000=3000K 3500=3500K 4000=4000K TSAM=Turtle Safe Amber (585-595nm)	UNV=120-277V ¹ 120=120V 277=277V ²	T2=Type II, Lateral Throw T4=Type IV, Forward Throw T5X=Type V, Extra Wide Flood	DIMELV=Trailing Edge Phase Dim- ming Driver DIM10=0-10V Dimming Driver	Painted BK=Black BZ=Bronze CS=City Silver WT=White Premium Paint AP=Grey DP=Dark Platinum GM=Graphite Metallic	24=24" 36=36" 42=42"	EDGE=Edge lit glass lens PC1=Photocontrol 120V ⁶ PC2=Photocontrol 208-277V ⁶ RIU=Receptacle - In Use (120V Only) ⁶ RFL=Receptacle - Flip-Lid (120V Only) ⁶ LAB=Less Anchor Bolts & Template ⁷

NOTES: 1 Universal Voltage (UNV) is standard unless specifying Photocontrol or Receptacle (RIU or RFL - 120V) options. 2 Specify for PC2 option only. 3 Custom and RAL color matching available upon request. Consult factory for further information. 4 Bollard heights are nominal (shown in inches). 5 Add suffix in the order shown. 6 Must specify voltage when ordering. 7 When specifying LAB option the anchor bolts and template need to be ordered separately 7581-01PK. 8 DesignLights Consortium™ Qualified and classified for DLC Standard. Refer to www.designlights.org for details on exact qualified EON 303-B1-LEDB2 product as not all configurations are DLC classified.

LUMENS MAINTENANCE

Ambient Temperature	TM-21 Lumen Maintenance (72,000 Hours)	TM-21 Reported L70(10k) (Hours)	Theoretical L70 (Hours)
25°C	> 94%	> 60,000	365,000
40°C			
50°C			

CURRENT DRAW

Model	Line Voltage	Current Draw
303-B1-LEDB2	120-277V, 50/60Hz	0.13A

MAX LOAD RATING

Options	Line Voltage	Max Load Rating
PC1	120V, 50/60Hz	1000VA, 8.3A
PC2	208-277V, 50/60Hz	
RIU or RFL	120V, 50/60Hz	1800VA, 15A

LUMENS - CRI/CCT TABLE

Optic Type	Distribution	Watts	Delivered Lumens	LPW	CCT (K) / Color	CRI nom./ Wavelength	B-U-G Rating
T2 (Lateral Throw)		15.5	783	51	2700	95	B1-U0-G1
			1300	84	3000	75	
			909	59	3500	85	
			1433	93	4000	75	
T4 (Forward Throw)		15.5	747	48	2700	95	B0-U0-G0
			1241	80	3000	75	
			868	56	3500	85	
			1368	88	4000	75	
T5X (Extra Wide Flood)		15.5	682	44	2700	95	B1-U0-G0
			1132	73	3000	75	
			792	51	3500	85	
			1248	81	4000	75	
		12.1	398	31	TSAM (Amber)	585-595nm	
			380	29	TSAM (Amber)	585-595nm	
			347	27	TSAM (Amber)	585-595nm	

OPTIONS

Receptacle Options (120V Only)

RIU - Receptacle In-Use

Rugged UV-resistant polycarbonate clear cover and gray body protects GFCI without cracking or breaking and is non-corrosive. Note: Cover is weatherproof with the cord plugged in and the receptacle is not required to be attended while in use. The receptacle incorporates a specification grade, 120V, 15A tamper proof and weather resistant duplex GFCI. Available on 24", 36" and 42" heights.

RFL - Receptacle Flip Lid

Cover is constructed of a durable, die-cast zinc-alloy and is painted to match fixture. Cover is only weatherproof without the cord plugged in and the cover closed. The receptacle will need to be attended while in use. The receptacle incorporates a specification grade, 120V, 15A tamper proof and weather resistant duplex GFCI. Available on 24", 36" and 42" heights.

Photocontrol

PC1 (120V) or PC2 (277V)

Photocontrol cover is precision machined from corrosion-resistant 6061-T6 aluminum and is secured to bollard head with tamper resistant stainless steel hardware. The photocontrol option is available in dedicated 120V or 208-277V. When specifying a photocontrol option make sure to designate the appropriate voltage within the catalog logic.

Edge

When specifying with the EDGE option, the diffused glass becomes thicker adding a visible line of light around the edge accentuating the luminaries' aesthetics and styling.

TECHNICAL NOTES:

- Adjustable mounting base - Cast aluminum mounting base is equipped with the patented LumaLevel™ leveling system that includes mounting base, 70 shore neoprene base, stainless steel hardware and a slot to accommodate two inbound and outbound 3/4" conduits. It provides quick installation, easy adjustment, secure mounting and protection from vibration.



Excellence in Illumination Engineering Software
since 1984



sample banner copyright 2013 Lighting Analysts, Inc.

Photometric Report (Type C)

Filename: B3_303-B1-LEDB2-3000-UNV-T4-DIM10-BK.ies
 [TEST] P174954 TEST IS SCALED FROM IESNA LM-79-08 TEST
 DATA (P33871)
 [TESTLAB] INNOVATIONS CENTER-P3
 [ISSUEDATE] 6/4/2015
 [MANUFAC] EATON - LUMIERE (FORMER COOPER LIGHTING)
 [LUMCAT] 303-B1-LEDB2-3000-UNV-T4-DIM10-BK
 [LUMINAIRE] LUMIERE EON 303-B1, SINGLE HEAD BOLLARD,
 DOUBLE LED BAR. TYPE IV FORWARD THROW OPTICS, CLEAR
 GLASS LENS.
 [LAMP] (14) 3000K CCT, 75 CRI LEDS

Maximum Candela = 802.4 at 45 H 66 V

Classification:

Road Classification: Type IV, Short, N.A. (deprecated)
 Upward Wast Light Ratio: 0.00
 Luminaire Efficacy Rating (LER): 80
 Indoor Classification: Direct
 BUG Rating : B0-U0-G0

Polar Candela Curves:

Vertical Plane Through:
 1) 45 - 225 Horizontal

Horizontal Cone Through:
 2) 66 Vertical

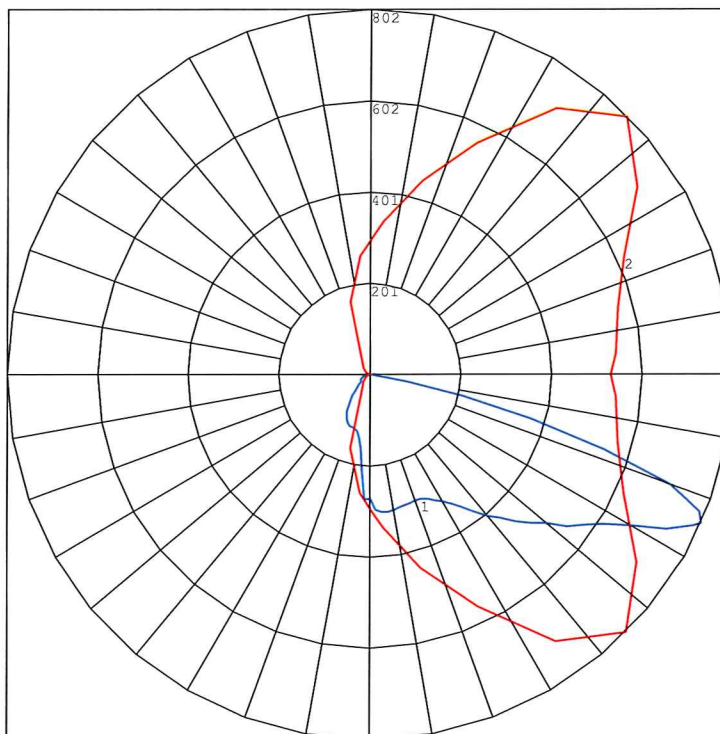



Excellence in Illumination Engineering Software
since 1984



sample banner copyright 2013 Lighting Analysts, Inc.

Photometric Report (Type C)

Filename: B3_303-B1-LEDB2-3000-UNV-T4-DIM10-BK.ies
[TEST] P174954 TEST IS SCALED FROM IESNA LM-79-08 TEST
DATA (P33871)
[TESTLAB] INNOVATIONS CENTER-P3
[ISSUEDATE] 6/4/2015
[MANUFAC] EATON - LUMIERE (FORMER COOPER LIGHTING)
[LUMCAT] 303-B1-LEDB2-3000-UNV-T4-DIM10-BK
[LUMINAIRE] LUMIERE EON 303-B1, SINGLE HEAD BOLLARD,
DOUBLE LED BAR. TYPE IV FORWARD THROW OPTICS, CLEAR
GLASS LENS.
[LAMP] (14) 3000K CCT, 75 CRI LEDS

Maximum Candela = 802.4 at 45 H 66 V

Classification:

Road Classification: Type IV, Short, N.A. (deprecated)
Upward Waste Light Ratio: 0.00
Luminaire Efficacy Rating (LER): 80
Indoor Classification: Direct
BUG Rating : B0-U0-G0

LCS Summary:

LCS Zone	Lumens	%Lamp	%Lum
FL (0-30)	125.6	N.A.	10.1
FM (30-60)	492.6	N.A.	39.7
FH (60-80)	420.6	N.A.	33.9
FVH (80-90)	8.2	N.A.	0.7
BL (0-30)	55.0	N.A.	4.4
BM (30-60)	91.8	N.A.	7.4
BH (60-80)	45.3	N.A.	3.7
BVH (80-90)	1.3	N.A.	0.1
UL (90-100)	0.0	N.A.	0.0
UH (100-180)	0.0	N.A.	0.0
Total	1240.4	N.A.	100.0
BUG Rating	B0-U0-G0		

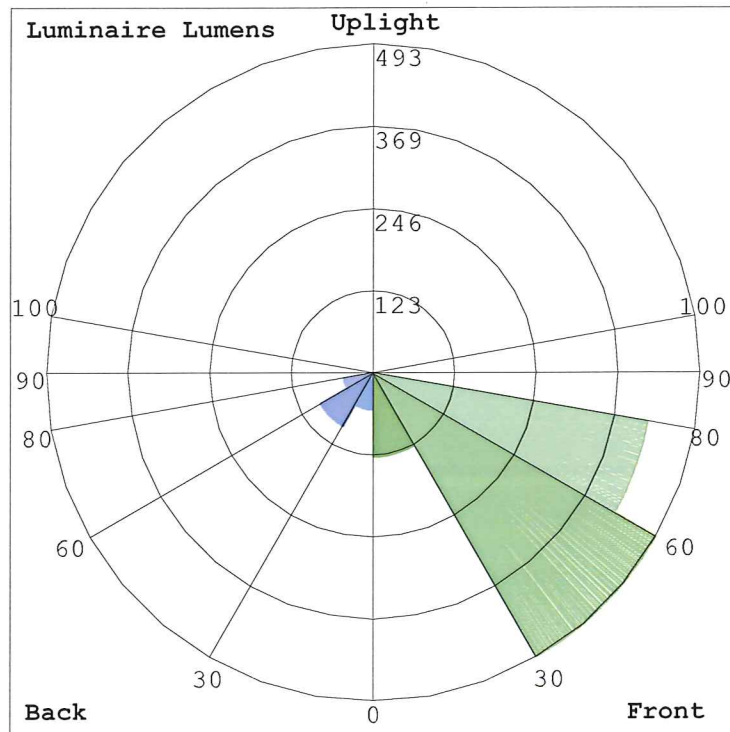

DESCRIPTION

The Galleon™ LED luminaire delivers exceptional performance in a highly scalable, low-profile design. Patented, high-efficiency AccuLED Optics™ system provides uniform and energy conscious illumination to walkways, parking lots, roadways, building areas and security lighting applications. IP66 rated and UL/cUL Listed for wet locations.

Catalog #		Type
Project		
Comments		Date
Prepared by		

SPECIFICATION FEATURES

Construction

Extruded aluminum driver enclosure thermally isolated from Light Squares for optimal thermal performance. Heavy-wall, die-cast aluminum end caps enclose housing and die-cast aluminum heat sinks. A unique, patent pending interlocking housing and heat sink provides scalability with superior structural rigidity. 3G vibration tested and rated. Optional tool-less hardware available for ease of entry into electrical chamber. Housing is IP66 rated.

Optics

Patented, high-efficiency injection-molded AccuLED Optics technology. Optics are precisely designed to shape the distribution maximizing efficiency and application spacing. AccuLED Optics create consistent distributions with the scalability to meet customized application requirements. Offered standard in 4000K (+/- 275K) CCT 70 CRI. Optional 3000K, 5000K and 6000K CCT.

Electrical

LED drivers are mounted to removable tray assembly for ease of maintenance. 120-277V 50/60Hz, 347V 60Hz or 480V 60Hz operation. 480V is compatible for use with 480V Wye systems only. Standard with 0-10V dimming. Shipped standard with Eaton proprietary circuit module designed to withstand 10kV of transient line surge. The Galleon LED luminaire is suitable for operation in -40°C to 40°C ambient environments. For applications with ambient temperatures exceeding 40°C, specify the HA (High Ambient) option. Light Squares are IP66 rated. Greater than 90% lumen maintenance expected at 60,000 hours. Available in standard 1A drive current and optional 600mA, 800mA and 1200mA drive currents (nominal).

Mounting

STANDARD ARM MOUNT: Extruded aluminum arm includes internal bolt guides allowing for easy positioning of fixture during mounting. When mounting two or more luminaires at 90° and 120° apart, the EA extended arm may be required. Refer to the

arm mounting requirement table. Round pole adapter included. For wall mounting, specify wall mount bracket option. **QUICK MOUNT ARM:** Adapter is bolted directly to the pole. Quick mount arm slide into place on the adapter and is secured via two screws, facilitating quick and easy installation. The versatile, patent pending, quick mount arm accommodates multiple drill patterns ranging from 1-1/2" to 4-7/8". Removal of the door on the quick mount arm enables wiring of the fixture without having to access the driver compartment. A knock-out enables round pole mounting.

Finish

Housing finished in super durable TGIC polyester powder coat paint, 2.5 mil nominal thickness for superior protection against fade and wear. Heat sink is powder coated black. Standard housing colors include black, bronze, grey, white, dark platinum and graphite metallic. RAL and custom color matches available.

Warranty

Five-year warranty.



GLEON GALLEON LED

**1-10 Light Squares
Solid State LED**

AREA/SITE LUMINAIRE

DIMENSIONS

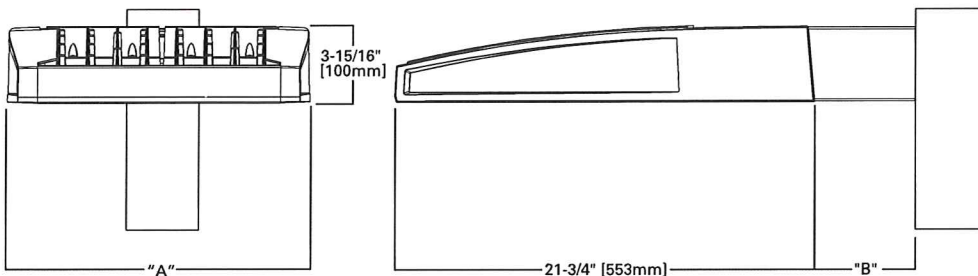

DIMENSION DATA

Number of Light Squares	"A" Width	"B" Standard Arm Length	"B" Optional Arm Length 1	Weight with Arm (lbs.)	EPA with Arm 2 (Sq. Ft.)
1-4	15-1/2" (394mm)	7" (178mm)	10" (254mm)	33 (15.0 kgs.)	0.86
5-6	21-5/8" (549mm)	7" (178mm)	10" (254mm)	44 (20.0 kgs.)	1.00
7-8	27-5/8" (702mm)	7" (178mm)	13" (330mm)	54 (24.5 kgs.)	1.07
9-10	33-3/4" (857mm)	7" (178mm)	16" (406mm)	63 (28.6 kgs.)	1.12

NOTES: 1. Optional arm length to be used when mounting two fixtures at 90° on a single pole. 2. EPA calculated with optional arm length.

DRILLING PATTERN

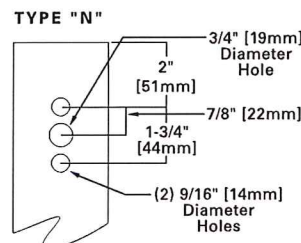

CERTIFICATION DATA

UL/cUL Wet Location Listed
ISO 9001
LM79 / LM80 Compliant
3G Vibration Rated
IP66 Rated
DesignLights Consortium™ Qualified*

ENERGY DATA

Electronic LED Driver
>0.9 Power Factor
<20% Total Harmonic Distortion
120V-277V 50/60Hz
347V & 480V 60Hz
-40°C Min. Temperature
40°C Max. Temperature
50°C Max. Temperature (HA Option)



ORDERING INFORMATION

Sample Number: GLEON-AF-04-LED-E1-T3-GM-QM

Product Family ^{1,2}	Light Engine	Number of Light Squares ³	Lamp Type	Voltage	Distribution	Color	Mounting
GLEON=Galleon	AF=1A Drive Current	01=1 02=2 03=3 04=4 05=5 06=6 07=7 ⁴ 08=8 ⁴ 09=9 ⁵ 10=10 ⁵	LED=Solid State Light Emitting Diodes	E1=120-277V 347=347V ^{6,7} 480=480V ^{6,7}	T2=Type II T2R=Type II Roadway T3=Type III T3R=Type III Roadway T4FT=Type IV Forward Throw T4W=Type IV Wide 5NQ=Type V Narrow 5MQ=Type V Square Medium 5WQ=Type V Square Wide SL2=Type II w/Spill Control SL3=Type III w/Spill Control SL4=Type IV w/Spill Control SLL=90° Spill Light Eliminator Left SLR=90° Spill Light Eliminator Right RW=Rectangular Wide Type I AFL=Automotive Frontline	AP=Grey BZ=Bronze BK=Black DP=Dark Platinum GM=Graphite Metallic WH=White	[Blank]=Arm for Round or Square Pole EA=Extended Arm ⁸ MA=Mast Arm Adapter ⁹ WM=Wall Mount QM=Quick Mount Arm (Standard Length) ¹⁰ QMEA=Quick Mount Arm (Extended Length) ¹¹

Options (Add as Suffix)	Accessories (Order Separately)
<p>7030=70 CRI 3000K ¹² 8030=80 CRI 3000K ¹³ 7050=70 CRI 5000K ¹² 7060=70 CRI 6000K ¹² 600=Drive Current Factory Set to Nominal 600mA ¹⁴ 800=Drive Current Factory Set to Nominal 800mA ¹⁴ 1200=Drive Current Factory Set to Nominal 1200mA ^{14,15} F=Single Fuse (120, 277 or 347V. Must Specify Voltage) FF=Double Fuse (208, 240 or 480V. Must Specify Voltage) 2L=Two Circuits ^{16,17} DIM=External 0-10V Dimming Leads P=Button Type Photocontrol (120, 208, 240 or 277V. Must Specify Voltage) PER7=NEMA 7-PIN Twistlock Photocontrol Receptacle R=NEMA Twistlock Photocontrol Receptacle AHD145=After Hours Dim, 5 Hours ¹⁸ AHD245=After Hours Dim, 6 Hours ¹⁸ AHD255=After Hours Dim, 7 Hours ¹⁸ AHD355=After Hours Dim, 8 Hours ¹⁸ HA=50°C High Ambient ¹⁹ MS/DIM-L08=Motion Sensor for Dimming Operation, Maximum 8' Mounting Height ^{20,21} MS/DIM-L20=Motion Sensor for Dimming Operation, 9' - 20' Mounting Height ^{20,22} MS/DIM-L40=Motion Sensor for Dimming Operation, 21' - 40' Mounting Height ^{20,23} MS/DIM-L40W=Motion Sensor for Dimming Operation, 21' - 40' Mounting Height (Wide Range) ^{20,24} MS/X-L08=Bi-Level Motion Sensor, Maximum 8' Mounting Height ^{20,21,25} MS/X-L20=Bi-Level Motion Sensor, 9' - 20' Mounting Height ^{20,22,25} MS/X-L40=Bi-Level Motion Sensor, 21' - 40' Mounting Height ^{20,23,25} MS/X-L40W=Bi-Level Motion Sensor, 21' - 40' Mounting Height (Wide Range) ^{20,24,25} MS-L08=Motion Sensor for ON/OFF Operation, Maximum 8' Mounting Height ^{20,21} MS-L20=Motion Sensor for ON/OFF Operation, 9' - 20' Mounting Height ^{20,22} MS-L40=Motion Sensor for ON/OFF Operation, 21' - 40' Mounting Height ^{20,23} MS-L40W=Motion Sensor for ON/OFF Operation, 21' - 40' Mounting Height (Wide Range) ^{20,24} LWR-LW=LumaWatt Wireless Sensor, Wide Lens for 8' - 16' Mounting Height ²⁶ LWR-LN=LumaWatt Wireless Sensor, Narrow Lens for 16' - 40' Mounting Height ²⁶ L90=Optics Rotated 90° Left R90=Optics Rotated 90° Right MT=Factory Installed Mesh Top TH=Tool-less Door Hardware LCF=Light Square Trim Plate Painted to Match Housing ²⁷ HSS=Factory Installed House Side Shield ²⁸ CE=CE Marking ²⁹</p>	<p>OA/RA1016=NEMA Photocontrol Multi-Tap - 105-285V OA/RA1027=NEMA Photocontrol - 480V OA/RA1201=NEMA Photocontrol - 347V OA/RA1013=Photocontrol Shorting Cap OA/RA1014=120V Photocontrol MA1252=10kV Surge Module Replacement MA1036-XX=Single Tenon Adapter for 2-3/8" O.D. Tenon MA1037-XX=2@180° Tenon Adapter for 2-3/8" O.D. Tenon MA1197-XX=3@120° Tenon Adapter for 2-3/8" O.D. Tenon MA1188-XX=4@90° Tenon Adapter for 2-3/8" O.D. Tenon MA1189-XX=2@90° Tenon Adapter for 2-3/8" O.D. Tenon MA1190-XX=3@90° Tenon Adapter for 2-3/8" O.D. Tenon MA1191-XX=2@120° Tenon Adapter for 2-3/8" O.D. Tenon MA1038-XX=Single Tenon Adapter for 3-1/2" O.D. Tenon MA1039-XX=2@180° Tenon Adapter for 3-1/2" O.D. Tenon MA1192-XX=3@120° Tenon Adapter for 3-1/2" O.D. Tenon MA1193-XX=4@90° Tenon Adapter for 3-1/2" O.D. Tenon MA1194-XX=2@90° Tenon Adapter for 3-1/2" O.D. Tenon MA1195-XX=3@90° Tenon Adapter for 3-1/2" O.D. Tenon FSIR-100=Wireless Configuration Tool for Occupancy Sensor ²⁰ GLEON-MT1=Field Installed Mesh Top for 1-4 Light Squares GLEON-MT2=Field Installed Mesh Top for 5-6 Light Squares GLEON-MT3=Field Installed Mesh Top for 7-8 Light Squares GLEON-MT4=Field Installed Mesh Top for 9-10 Light Squares GLEON-QM=Quick Mount Arm Kit GLEON-QMEA=Quick Mount Extended Arm Kit LS/HSS=Field Installed House Side Shield ^{28,30}</p>

NOTES:

- Customer is responsible for engineering analysis to confirm pole and fixture compatibility for all applications. Refer to our white paper WP513001EN for additional support information.
- DesignLights Consortium™ Qualified. Refer to www.designlights.org Qualified Products List under Family Models for details.
- Standard 4000K CCT and minimum 70 CRI.
- Not compatible with extended quick mount arm (QMEA).
- Not compatible with standard quick mount arm (QM) or extended quick mount arm (QMEA).
- Requires the use of an internal step down transformer when combined with sensor options. Not available with sensor at 1200mA. Not available in combination with the HA high ambient and sensor options at 1A.
- Only for use with 480V Wye systems. Per NEC, not for use with ungrounded systems, impedance grounded systems or corner grounded systems (commonly known as Three Phase Three Wire Delta, Three Phase High Leg Delta and Three Phase Corner Grounded Delta systems).
- May be required when two or more luminaires are oriented on a 90° or 120° drilling pattern. Refer to arm mounting requirement table.
- Factory installed.
- Maximum 8 light squares.
- Maximum 6 light squares.
- Extended lead times apply. Use dedicated IES files for 3000K, 5000K and 6000K when performing layouts. These files are published on the Galleon luminaire product page on the website.
- Extended lead times apply. Use dedicated IES files for 3000K, 5000K and 6000K when performing layouts. These files are published on the Galleon luminaire product page on the website.
- 1 Amp standard. Use dedicated IES files for 600mA, 800mA and 1200mA when performing layouts. These files are published on the Galleon luminaire product page on the website.
- Not available with HA option.
- 2L is not available with MS, MS/X or MS/DIM at 347V or 480V. 2L in AF-02 through AF-04 requires a larger housing, normally used for AF-05 or AF-06. Extended arm option may be required when mounting two or more fixtures per pole at 90° or 120°. Refer to arm mounting requirement table.
- Not available with LumaWatt wireless sensors.
- Requires the use of P photocontrol or the PER7 or R photocontrol receptacle with photocontrol accessory. See After Hours Dim supplemental guide for additional information.
- 50°C lumen maintenance data applies to 600mA, 800mA and 1200mA drive currents.
- The FSIR-100 configuration tool is required to adjust parameters including high and low modes, sensitivity, time delay, cutoff and more. Consult your lighting representative at Eaton for more information.
- Approximately 22' detection diameter at 8' mounting height.
- Approximately 40' detection diameter at 20' mounting height.
- Approximately 60' detection diameter at 40' mounting height.
- Approximately 100' detection diameter at 40' mounting height.
- Replace X with number of Light Squares operating in low output mode.
- LumaWatt wireless sensors are factory installed only requiring network components RF-EM-1, RF-GW-1 and RF-ROUT-1 in appropriate quantities. See www.eaton.com/lighting for LumaWatt application information.
- Not available with house side shield (HSS).
- Only for use with SL2, SL3, SL4 and AFL distributions. The Light Square trim plate is painted black when the HSS option is selected.
- CE is not available with the LWR, MS, MS/X, MS/DIM, P, R or PER7 options. Available in 120-277V only.
- One required for each Light Square.



Excellence in Illumination Engineering Software
since 1984



sample banner copyright 2013 Lighting Analysts, Inc.

Photometric Report (Type C)

Filename: PL1 GLEON-AF-01-LED-E1-SL2-7030-HSS.ies
 [TEST] P192789 TEST IS SCALED FROM IESNA LM-79-08 TEST
 DATA (P24287)
 [TESTLAB] Innovations Center P2
 [ISSUEDATE] 7/21/2016
 [MANUFAC] EATON - McGRAW-EDISON (FORMER COOPER
 LIGHTING)
 [LUMCAT] GLEON-AF-01-LED-E1-SL2-7030-HSS
 [LUMINAIRE] GALLEON AREA AND ROADWAY LUMINAIRE (1) 70
 CRI, 3000K, 1050mA LIGHTSQUARE WITH 16 LEDS EACH AND
 TYPE II SPILL LIGHT ELIMINATOR OPTICS WITH HOUSE SIDE SHIELD

Maximum Candela = 6291.8 at 67 H 67 V

Classification:

Road Classification: Type II, Short, N.A. (deprecated)
 Upward Wast Light Ratio: 0.00
 Luminaire Efficacy Rating (LER): 77
 Indoor Classification: Direct
 BUG Rating : B1-U0-G1

Polar Candela Curves:

Vertical Plane Through:
 1) 67 - 247 Horizontal

Horizontal Cone Through:
 2) 67 Vertical

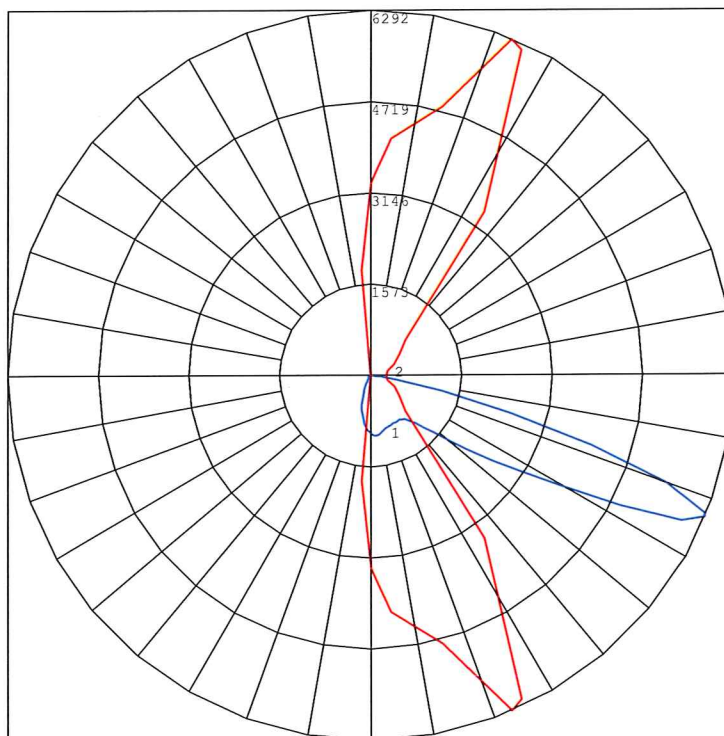



Excellence in Illumination Engineering Software
since 1984



sample banner copyright 2013 Lighting Analysts, Inc.

Photometric Report (Type C)

Filename: PL1 GLEON-AF-01-LED-E1-SL2-7030-HSS.ies
[TEST] P192789 TEST IS SCALED FROM IESNA LM-79-08 TEST
DATA (P24287)
[TESTLAB] Innovations Center P2
[ISSUEDATE] 7/21/2016
[MANUFAC] EATON - MCGRAW-EDISON (FORMER COOPER
LIGHTING)
[LUMCAT] GLEON-AF-01-LED-E1-SL2-7030-HSS
[LUMINAIRE] GALLEON AREA AND ROADWAY LUMINAIRE (1) 70
CRI, 3000K, 1050mA LIGHTSQUARE WITH 16 LEDS EACH AND
TYPE II SPILL LIGHT ELIMINATOR OPTICS WITH HOUSE SIDE SHIELD

Maximum Candela = 6291.8 at 67 H 67 V

Classification:

Road Classification: Type II, Short, N.A. (deprecated)
Upward Waste Light Ratio: 0.00
Luminaire Efficacy Rating (LER): 77
Indoor Classification: Direct
BUG Rating : B1-U0-G1

LCS Summary:

LCS Zone	Lumens	%Lamp	%Lum
FL (0-30)	368.6	N.A.	8.1
FM (30-60)	2036.0	N.A.	44.6
FH (60-80)	1638.0	N.A.	35.9
FVH (80-90)	52.0	N.A.	1.1
BL (0-30)	141.6	N.A.	3.1
BM (30-60)	170.5	N.A.	3.7
BH (60-80)	159.9	N.A.	3.5
BVH (80-90)	2.5	N.A.	0.1
UL (90-100)	0.0	N.A.	0.0
UH (100-180)	0.0	N.A.	0.0
Total	4569.1	N.A.	100.0
BUG Rating	B1-U0-G1		

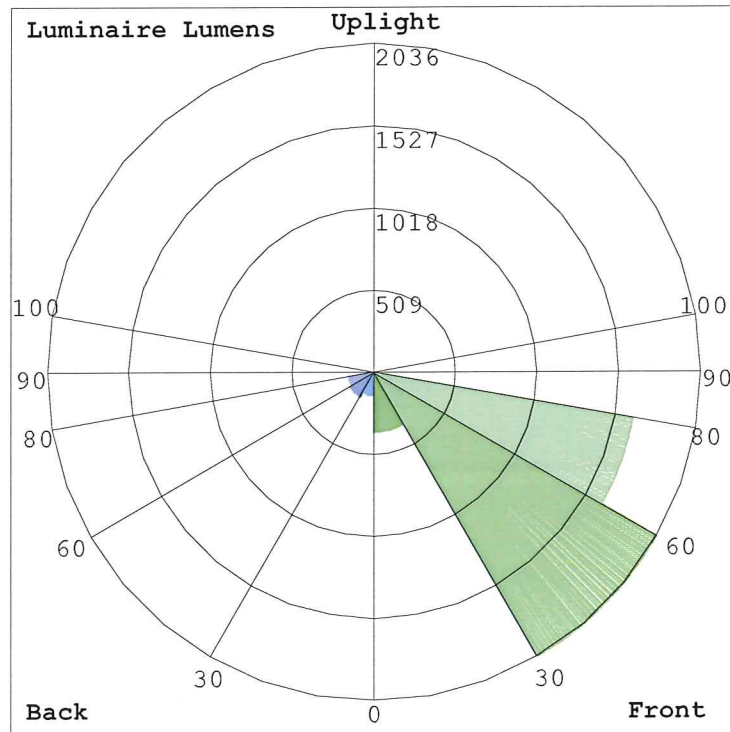

QRI374 LED

616-2321

1/3

we-ef

ST2

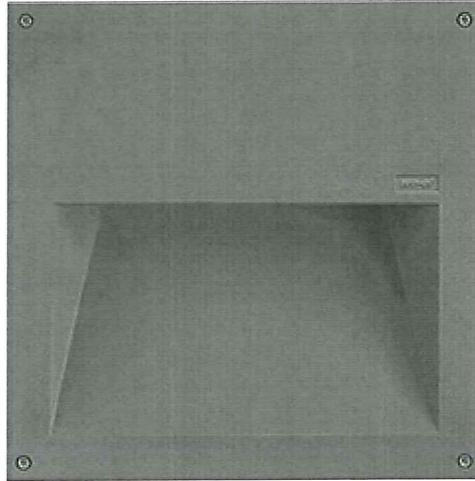

Description

IP55. Recessed LED wall luminaire. Shielded light source. Suitable for installation in cavity wall construction or concrete pour construction using optional installation blackout.

Beam Type asymmetric, forward-throw

Lamp Type 14 LED 14W (3000K)

CRI 80

Gear Type electronic gear

Nominal Luminous Flux (lm)

LED Lumens 100 lm

LEDs 14

Total Lumens 1400 lm

Tj 85 °C

Rated Luminous Flux (lm)

LED Lumens 63.9 lm

Total Lumens 894.2 lm

Ta 25 °C

Rated Input Power 18 W

QRI374 LED

616-2321

2/3

we-ef

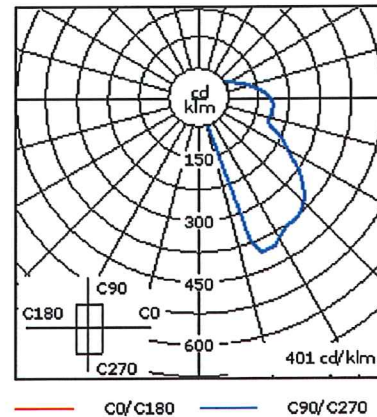
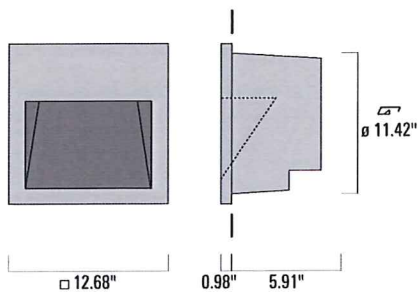

Material Specification

Body:	Luminaire body and lens frame constructed in die cast aluminum.
Weight (lbs):	16.00
Lens:	Tempered glass lens.
Gasket:	Silicone rubber gasket
Fasteners:	PCS polymer coated stainless steel
Ingress protection:	IP55
Impact protection:	IK10
Corrosion protection:	5CE
Finish:	Powder coat finish in Black RAL9004, White RAL9016, Grey Metallic RAL9007 or Dark Bronze RAL8019.
Mounting:	Suitable for installation in cavity wall construction or concrete pour construction using optional installation blackout.

Electrical Specification

Power supply:	Integral [ECG] LED driver in 120 or 277 volt. Specify voltage.
Cable:	Suitable for through wiring.

Ambient Temperature

Ta less than 25 deg C

QRI374 LED

616-2321

3/3



Mounting Accessories

Installation blackout

Optional mounting accessories for concrete pour installations. Installation blackout. Suitable for installing recesses wall luminaire in concrete pour installations. Serve as rough-in housing prior to installation of luminaire. Includes hardware necessary for attachment to formwork.

C1

■ 616-9330 Installation blackout BQR30-I

7.09

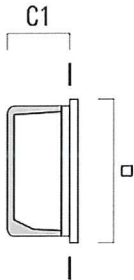



Excellence in Illumination Engineering Software
since 1984



sample banner copyright 2013 Lighting Analysts, Inc.

Photometric Report (Type C)

Filename: ST2 WE-EF_616-2321.ies

[TEST] LM 2473

[TESTLAB] WE-EF

[ISSUEDATE] 20 Sep 2013

[MANUFAC] WE-EF USA

[LUMCAT] 616-2321

[LUMINAIRE] QRI374-LED, Wall Luminaires / Recessed

QRI374-LD-14/14W Painted;QRI374-LED, Wall Luminaires /
Recessed

[LAMPCAT] 14 LED white 14W (3000K)

[LAMP] 14 LED, Warm White - 120° angle of beam

LEDLUMENS=100.0 lm, LEDs No=14, TOTALLUMENS= 1400.0 lm

, Tj=85° LEDLUMENS=63.9 lm, LEDs No=14, TOTALLUMENS= 894.2 lm, Ta=25°C

Maximum Candela = 561.4 at 0 H 22.5 V

Classification:

Road Classification: Type III, Very Short, N.A. (deprecated)

Upward Wast Light Ratio: 0.24

Luminaire Efficacy Rating (LER): 50

Indoor Classification: Semi-Direct

BUG Rating : B0-U3-G1

Polar Candela Curves:

Vertical Plane Through:

1) 0 - 180 Horizontal

Horizontal Cone Through:

2) 22.5 Vertical

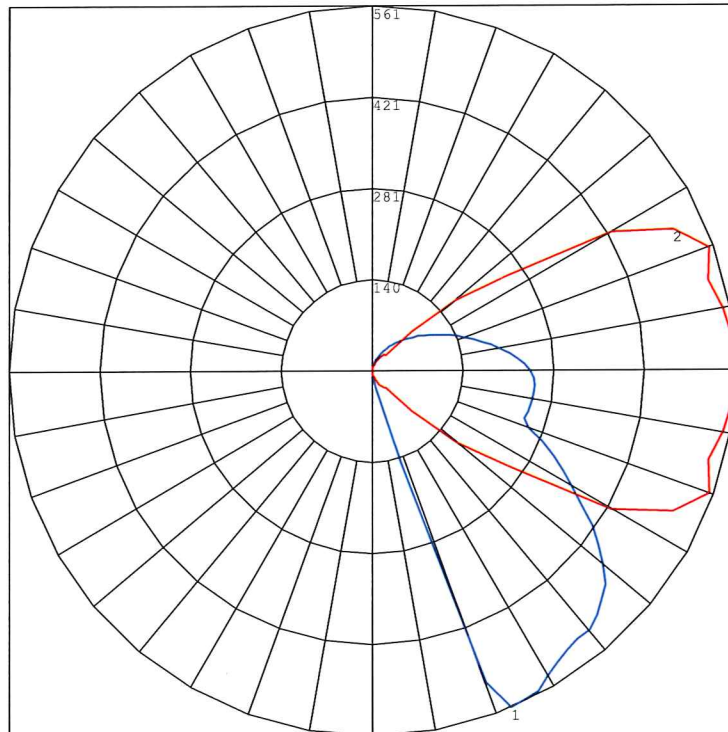



Excellence in Illumination Engineering Software
since 1984



sample banner copyright 2013 Lighting Analysts, Inc.

Photometric Report (Type C)

Filename: ST2 WE-EF_616-2321.ies

[TEST] LM 2473

[TESTLAB] WE-EF

[ISSUEDATE] 20 Sep 2013

[MANUFAC] WE-EF USA

[LUMCAT] 616-2321

[LUMINAIRE] QRI374-LED, Wall Luminaires / Recessed

QRI374-LD-14/14W Painted;QRI374-LED, Wall Luminaires /
Recessed

[LAMPCAT] 14 LED white 14W (3000K)

[LAMP] 14 LED, Warm White - 120° angle of beam

LEDLUMENS=100.0 lm, LEDs No=14, TOTALLUMENS= 1400.0 lm

, Tj=85° LEDLUMENS=63.9 lm, LEDs No=14, TOTALLUMENS= 894.2 lm, Ta=25°C

Maximum Candela = 561.4 at 0 H 22.5 V

Classification:

Road Classification: Type III, Very Short, N.A. (deprecated)

Upward Waste Light Ratio: 0.24

Luminaire Efficacy Rating (LER): 50

Indoor Classification: Semi-Direct

BUG Rating : B0-U3-G1

LCS Summary:

LCS Zone	Lumens	%Lamp	%Lum
FL (0-30)	66.2	N.A.	7.4
FM (30-60)	338.6	N.A.	37.9
FH (60-80)	195.0	N.A.	21.8
FVH (80-90)	82.5	N.A.	9.2
BL (0-30)	0.0	N.A.	0.0
BM (30-60)	0.0	N.A.	0.0
BH (60-80)	0.0	N.A.	0.0
BVH (80-90)	0.0	N.A.	0.0
UL (90-100)	70.3	N.A.	7.9
UH (100-180)	141.7	N.A.	15.9
Total	894.3	N.A.	100.0
BUG Rating	B0-U3-G1		

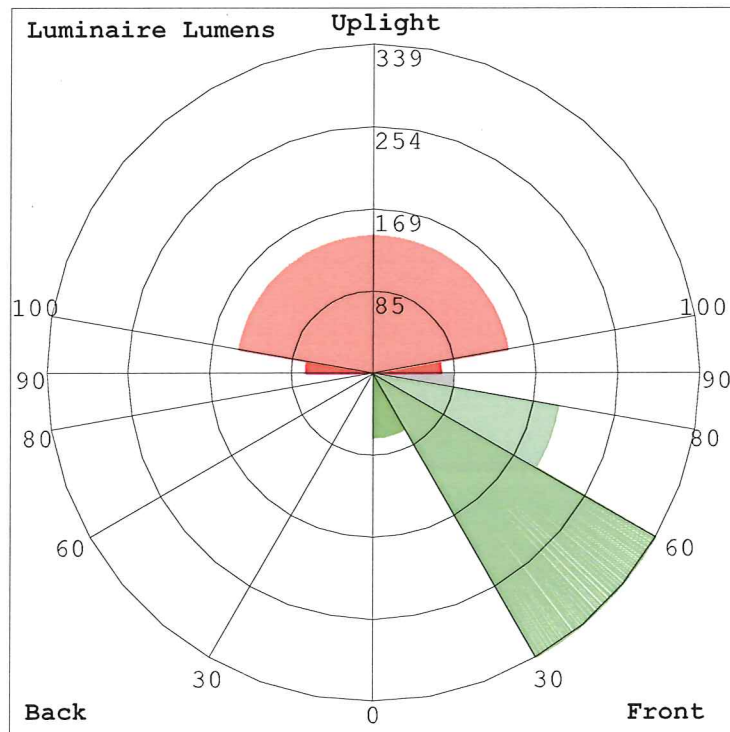

DESCRIPTION

The Impact Elite family of wall luminaires is the ideal complement to site design. Incorporating modular LightSquares technology, the Impact Elite luminaire provides outstanding uniformity and energy-conscious illumination. Combined with a rugged construction, the Impact Elite luminaire is the ideal facade and security luminaire for zones surrounding schools, office complexes, apartments and recreational facilities. UL/cUL listed for wet locations.

Catalog #		Type
Project		
Comments		Date
Prepared by		

SPECIFICATION FEATURES

Construction

Heavy-wall, die-cast aluminum housing and removable hinged door frame for precise tolerance control and repeatability. Hinged door inset for clean mating with housing surface and secured via two captive fasteners. Optional tamper-resistant Torx™ head fasteners offer vandal resistant access to the electrical chamber.

Optics

Choice of 10 patented, high-efficiency AccuLED Optics™ distributions. Optics are precisely designed to shape the light output, maximizing efficiency and application spacing. AccuLED Optics technology creates consistent distributions with the scalability to meet customized application requirements. Offered Standard in 4000K (+/- 275K) CCT and minimum 70 CRI. Optional 3000K, 5000K and 5700K CCT.

Electrical

LED drivers mount to die-cast aluminum back housing for optimal heat sinking, operation efficacy, and prolonged life. Standard drivers feature electronic universal voltage (120-277V 50/60Hz), 347V 60Hz or 480V 60Hz operation, greater than 0.9 power factor, less than 20% harmonic distortion, and are suitable for operation in -40°C to 40°C ambient environments. All fixtures are shipped standard with 10kV/10kA common – and differential – mode surge protection. LightSquares feature an IP66 enclosure rating and maintain greater than 90% lumen maintenance at 60,000 hours per IESNA TM-21. Emergency egress options for -20°C ambient environments and occupancy sensor available.

Mounting

Gasketed and zinc plated rigid steel mounting attachment fits directly to 4" j-box or wall with the Impact Elite "Hook-N-Lock" mechanism for quick installation. Secured with two captive corrosion resistant black oxide coated allen head set screws concealed but accessible from bottom of fixture.

Finish

Cast components finished in a five-stage super TGIC polyester powder coat paint, 2.5 mil nominal thickness for superior protection against fade and wear. Standard colors include black, bronze, grey, white, dark platinum and graphite metallic. RAL and custom color matches available. Consult the McGraw-Edison Architectural Colors brochure for the complete selection.

Warranty

Five-year warranty.



**ISC/ISS/IST/ISW
IMPACT ELITE LED**

**1 LightSquare
Solid State LED**

WALL MOUNT LUMINAIRE

CERTIFICATION DATA

UL/cUL Listed
LM79 / LM80 Compliant
IP66 LightSquare
DesignLights Consortium® Qualified*
ISO 9001

ENERGY DATA

Electronic LED Driver
>0.9 Power Factor
<20% Total Harmonic Distortion
120-277V/50 & 60Hz, 347V/60Hz,
480V/60Hz
-40°C Minimum Temperature
40°C Ambient Temperature Rating

SHIPPING DATA

Approximate Net Weight:
18 lbs. (8 kgs.)



TD514030EN
August 22, 2017 8:54 AM



*www.designlights.org

DIMENSIONS

Cylinder

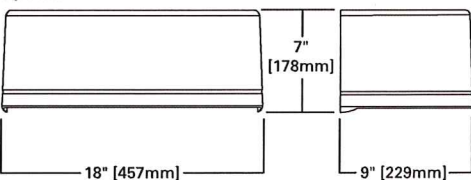

Quarter Sphere

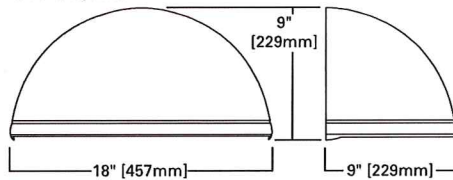

Trapezoid

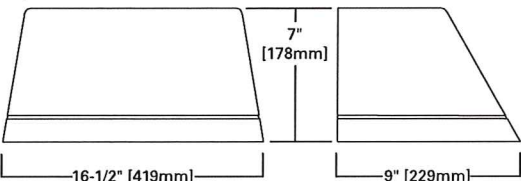

Wedge

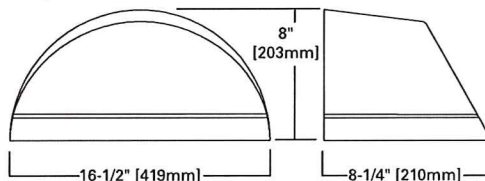

HOOK-N-LOCK MOUNTING

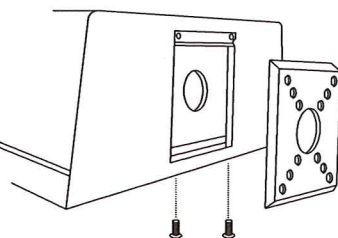

POWER AND LUMENS

1 LightSquare (AF)		Cylinder (ISC) and Quarter Sphere (ISS)						Trapezoid (IST) and Wedge (ISW)					
Drive Current (mA)		350	450	600	800	1000	1200	350	450	600	800	1000	1200
Power (Watts)	120-277V	20.3	25.5	33.4	43.9	55.1	66.2	20.3	25.5	33.4	43.9	55.1	66.2
Current (A)	120V	0.17	0.22	0.29	0.38	0.48	0.56	0.17	0.22	0.29	0.38	0.48	0.56
	277V	0.09	0.10	0.13	0.17	0.21	0.25	0.09	0.10	0.13	0.17	0.21	0.25
Power (Watts)	347V or 480V	23.3	28.7	36.6	49.5	60.7	70.1	23.3	28.7	36.6	49.5	60.7	70.1
Current (A)	347V	0.07	0.08	0.11	0.15	0.18	0.21	0.07	0.08	0.11	0.15	0.18	0.21
	480V	0.05	0.06	0.08	0.11	0.13	0.16	0.05	0.06	0.08	0.11	0.13	0.16
Optics													
T2	Lumens	2,336	2,934	3,827	4,791	5,663	6,444	2,498	3,136	4,091	5,122	6,054	6,889
	BUG Rating	B1-U0-G1	B1-U0-G1	B1-U0-G1	B1-U0-G1	B1-U0-G1	B1-U0-G1	B1-U1-G2	B1-U1-G2	B1-U1-G2	B1-U1-G2	B1-U1-G2	B1-U1-G2
T3	Lumens	2,385	2,994	3,906	4,889	5,779	6,577	2,504	3,144	4,101	5,133	6,068	6,905
	BUG Rating	B1-U0-G1	B1-U0-G1	B1-U0-G1	B1-U0-G1	B1-U0-G1	B1-U0-G1	B1-U1-G2	B1-U1-G2	B1-U1-G2	B1-U1-G2	B1-U1-G2	B1-U1-G2
T4FT	Lumens	2,360	2,963	3,866	4,839	5,720	6,509	2,530	3,177	4,145	5,188	6,133	6,979
	BUG Rating	B1-U0-G1	B1-U0-G1	B1-U0-G1	B1-U0-G1	B1-U0-G1	B1-U0-G1	B1-U1-G2	B1-U1-G2	B1-U1-G2	B1-U1-G2	B1-U1-G2	B1-U1-G2
T4W	Lumens	2,386	2,996	3,908	4,892	5,783	6,581	2,500	3,139	4,095	5,126	6,059	6,895
	BUG Rating	B1-U0-G1	B1-U0-G1	B1-U0-G1	B1-U0-G1	B1-U0-G1	B1-U0-G1	B1-U1-G2	B1-U1-G2	B1-U1-G2	B1-U1-G2	B1-U1-G2	B1-U1-G2
SL2	Lumens	2,257	2,834	3,697	4,628	5,470	6,225	2,413	3,030	3,953	4,948	5,849	6,656
	BUG Rating	B1-U0-G1	B1-U0-G1	B1-U0-G1	B1-U0-G1	B1-U0-G1	B1-U0-G1	B1-U1-G2	B1-U1-G2	B1-U1-G2	B1-U1-G2	B1-U1-G2	B1-U1-G2
SL3	Lumens	2,220	2,787	3,636	4,552	5,380	6,122	2,365	2,970	3,874	4,849	5,732	6,523
	BUG Rating	B1-U0-G1	B1-U0-G1	B1-U0-G1	B1-U0-G1	B1-U0-G1	B1-U0-G1	B1-U1-G2	B1-U1-G2	B1-U1-G2	B1-U1-G2	B1-U1-G2	B1-U1-G2
SL4	Lumens	2,110	2,649	3,456	4,326	5,113	5,818	2,234	2,805	3,660	4,581	5,415	6,162
	BUG Rating	B0-U0-G1	B0-U0-G1	B0-U0-G1	B0-U0-G1	B0-U0-G1	B0-U0-G1	B1-U1-G2	B1-U1-G2	B1-U1-G2	B1-U1-G2	B1-U1-G2	B1-U1-G2
SLL/SLR	Lumens	1,990	2,498	3,259	4,080	4,823	5,488	2,154	2,705	3,529	4,418	5,222	5,942
	BUG Rating	B1-U0-G1	B1-U0-G1	B1-U0-G1	B1-U0-G1	B1-U0-G1	B1-U0-G1	B1-U1-G2	B1-U1-G2	B1-U1-G2	B1-U1-G2	B1-U1-G2	B1-U1-G2
RW	Lumens	2,380	2,988	3,898	4,880	5,768	6,564	2,465	3,095	4,037	5,054	5,974	6,798
	BUG Rating	B2-U0-G0	B2-U0-G0	B2-U0-G0	B2-U0-G0	B2-U0-G0	B2-U0-G0	B3-U1-G1	B3-U1-G1	B3-U1-G1	B3-U1-G1	B3-U1-G1	B3-U1-G1

LUMEN MAINTENANCE

Current	Ambient Temperature	25000 Hours*	50000 Hours*	60000 Hours*	100000 Hours*	Theoretical L70 (Hours)*
Up to 1.2A	Up to 40°C	>95%	>91%	>90%	>83%	20,4000

*Data calculated based on TM-21 calculator.

LUMEN MULTIPLIER

Ambient Temperature	Lumen Multiplier
10 C	1.02
15 C	1.01
25 C	1.00
40 C	0.99

THRUWAY BACK BOX

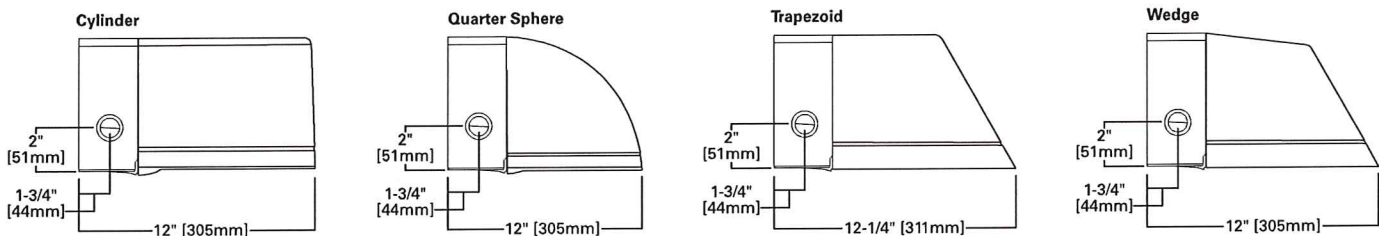

ORDERING INFORMATION

Sample Number: ISC-AF-1200-LED-E1-T3-BZ

Product Family ¹	Light Engine	Drive Current	Lamp Type	Voltage	Distribution	Color
ISC=Impact Elite LED Small Cylinder ISS=Impact Elite LED Small Quarter Sphere IST=Impact Elite LED Small Trapezoid ISW=Impact Elite LED Small Wedge	AF=(1) LightSquare	350=Drive Current Factory Set to 350mA 450=Drive Current Factory Set to 450mA 600=Drive Current Factory Set to 600mA 800=Drive Current Factory Set to 800mA 1000=Drive Current Factory Set to 1000mA 1200=Drive Current Factory Set to 1200mA ²	LED=Solid State Light Emitting Diodes	E1=Electronic (120-277V) 347=347V ² 480=480V ^{2,3}	T2=Type II T3=Type III T4FT=Type IV Forward Throw T4W=Type IV Wide SL2=Type II w/Spill Control SL3=Type III w/Spill Control SL4=Type IV w/Spill Control SLL=90° Spill Light Eliminator Left SLR=90° Spill Light Eliminator Right RW=Rectangular Wide Type I	AP=Grey BZ=Bronze BK=Black DP=Dark Platinum GM=Graphite Metallic WH=White
Options (Add as Suffix)				Accessories (Order Separately) ¹⁷		
7030=70 CRI / 3000K CCT ⁴ 7050=70 CRI / 5000K CCT ⁴ 7060=70 CRI / 5700K CCT ⁴ 8030=80 CRI / 3000K CCT ⁴ PER7=NEMA 7-PIN Twistlock Photocontrol Receptacle ^{2,5,6} P=Button Type Photocontrol (Available in 120, 208, 240 or 277V. Must Specify Voltage) HA=50°C High Ambient ⁷ AHD145=After Hours Dim, 5 Hours, 50% ⁸ AHD245=After Hours Dim, 6 Hours, 50% ⁸ AHD255=After Hours Dim, 7 Hours, 50% ⁸ AHD355=After Hours Dim, 8 Hours, 50% ⁸ MS/DIM-LXX=Motion Sensor for Dimming Operation ^{9, 10, 11} LWR-LW=LumaWatt Pro Wireless Sensor, Wide Lens for 8' - 16' Mounting Height ^{11, 12} LWR-LN=LumaWatt Pro Wireless Sensor, Narrow Lens for 16' - 40' Mounting Height ^{11, 12} BBB=Battery Pack with Back Box (Specify 120V or 277V) ¹³ CWB=Cold Weather Battery Pack with Back Box (Specify 120V or 277V) ¹⁴ LCF=LightSquare Trim Plate Matches Housing Finish HSS=Factory Installed House Side Shield ¹⁵ ULG=Uplight Glow ^{5,6} TR=Tamper Resistant Hardware X=Driver Surge Protection (6kV) Only ¹⁶				MA1253=10kV Circuit Module Replacement MA1254-XX=Thruway Back Box - Impact Elite Trapezoid MA1255-XX=Thruway Back Box - Impact Elite Cylinder MA1256-XX=Thruway Back Box - Impact Elite Quarter Sphere MA1257-XX=Thruway Back Box - Impact Elite Wedge FSIR-100=Wireless Configuration Tool for Occupancy Sensor		

NOTES:

1. Standard 4000K CCT and greater than 70 CRI.
2. Not available with ULG option.
3. Only for use with 480V Wye systems. Per NEC, not for use with ungrounded systems, impedance grounded systems or corner grounded systems (commonly known as Three Phase Three Wire Delta, Three Phase High Leg Delta and Three Phase Corner Grounded Delta systems).
4. Extended lead times apply.
5. Not available with ISS or ISW.
6. Not available with LWR-XX or MS/DIM-LXX.
7. Suitable for 50°C provided no options other than motion sensor are included and driver output set to 1.A or less.
8. Requires the use of P photocontrol or the PER7 photocontrol receptacle with photocontrol accessory. Not available with 350mA drive current. See After Hours Dim supplemental guide for additional information.
9. Specify lens in place of XX. Round to next highest option based on mounting height. Available options are 08, 20 and 40W.
10. The FSIR-100 configuration tool is required to adjust parameters including high and low modes, sensitivity, time delay, cutoff and more. Consult your lighting representative at Eaton for more information.
11. Includes integral photocell.
12. LumaWatt Pro wireless sensors are factory installed and requiring network components in appropriate quantities. See www.eaton.com/lighting for LumaWatt Pro application information.
13. LED standard integral battery pack is rated for minimum operating temperature 32°F (0°C). Operates downlight for 90-minutes.
14. LED cold weather integral battery pack is rated for minimum operating temperature -4°F (-20°C). Operates downlight for 90-minutes.
15. Only for use with SL2, SL3 and SL4 distributions. The LightSquare trim plate is painted black when the HSS option is selected.
16. Removes additional surge module.
17. Specify color in place of XX.



Excellence in Illumination Engineering Software
since 1984



sample banner copyright 2013 Lighting Analysts, Inc.

Photometric Report (Type C)

Filename: W5 Mc-Graw-Edisonn IST-AF-800-LED-E1-SL4-7030.ies
 [TEST] P227116 TEST IS SCALED FROM IESNA LM-79-08 TEST
 DATA (P35947)
 [TESTLAB] INNOVATION CENTER-P3
 [ISSUEDATE] 7/28/2017
 [MANUFAC] EATON - MCGRAW-EDISON (FORMER COOPER
 LIGHTING)
 [LUMCAT] IST-AF-800-LED-E1-SL4-7030
 [LUMINAIRE] IMPACT ELITE LED TRAPEZOID LUMINAIRE LIGHT
 SQUARE WITH ACCULED OPTICS-TYPE IV W/SPILL CONTROL
 [LAMP] (16) 3000K CCT, 70 CRI LEDs

Maximum Candela = 3452.6 at 39 H 69 V

Classification:

Road Classification: Type IV, Short, N.A. (deprecated)
 Upward Wast Light Ratio: 0.00
 Luminaire Efficacy Rating (LER): 93
 Indoor Classification: Direct
 BUG Rating : B1-U1-G1

Polar Candela Curves:

Vertical Plane Through:
 1) 39 - 219 Horizontal

Horizontal Cone Through:
 2) 69 Vertical

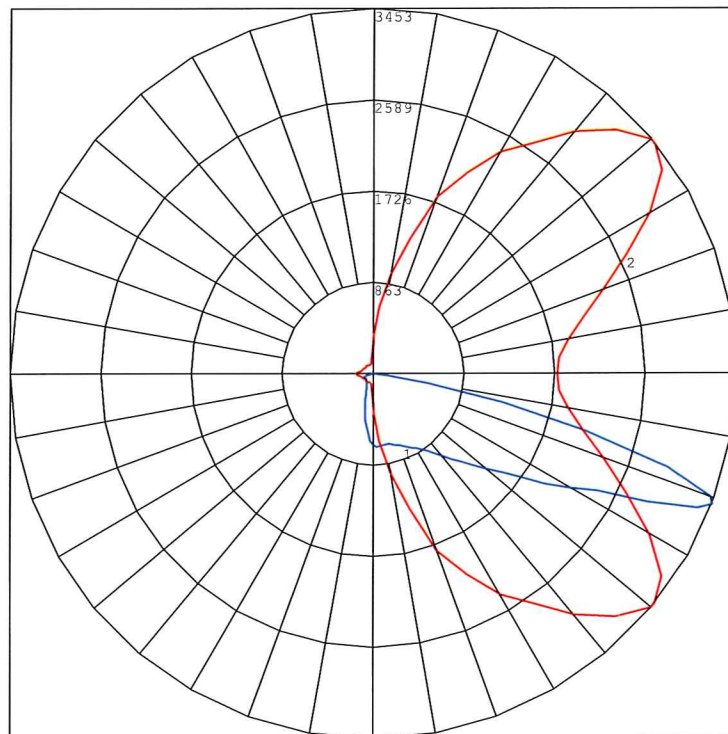



Excellence in Illumination Engineering Software
since 1984



sample banner copyright 2013 Lighting Analysts, Inc.

Photometric Report (Type C)

Filename: W5 Mc-Graw-Edisonn IST-AF-800-LED-E1-SL4-7030.ies
 [TEST] P227116 TEST IS SCALED FROM IESNA LM-79-08 TEST
 DATA (P35947)
 [TESTLAB] INNOVATION CENTER-P3
 [ISSUEDATE] 7/28/2017
 [MANUFAC] EATON - MCGRAW-EDISON (FORMER COOPER
 LIGHTING)
 [LUMCAT] IST-AF-800-LED-E1-SL4-7030
 [LUMINAIRE] IMPACT ELITE LED TRAPEZOID LUMINAIRE LIGHT
 SQUARE WITH ACCULED OPTICS-TYPE IV W/SPILL CONTROL
 [LAMP] (16) 3000K CCT, 70 CRI LEDs

Maximum Candela = 3452.6 at 39 H 69 V

Classification:

Road Classification: Type IV, Short, N.A. (deprecated)
 Upward Waste Light Ratio: 0.00
 Luminaire Efficacy Rating (LER): 93
 Indoor Classification: Direct
 BUG Rating : B1-U1-G1

LCS Summary:

LCS Zone	Lumens	%Lamp	%Lum
FL (0-30)	298.1	N.A.	7.4
FM (30-60)	1533.8	N.A.	37.8
FH (60-80)	1644.4	N.A.	40.6
FVH (80-90)	64.6	N.A.	1.6
BL (0-30)	138.4	N.A.	3.4
BM (30-60)	245.1	N.A.	6.0
BH (60-80)	117.4	N.A.	2.9
BVH (80-90)	12.1	N.A.	0.3
UL (90-100)	1.1	N.A.	0.0
UH (100-180)	0.0	N.A.	0.0
Total	4055.0	N.A.	100.0
BUG Rating	B1-U1-G1		

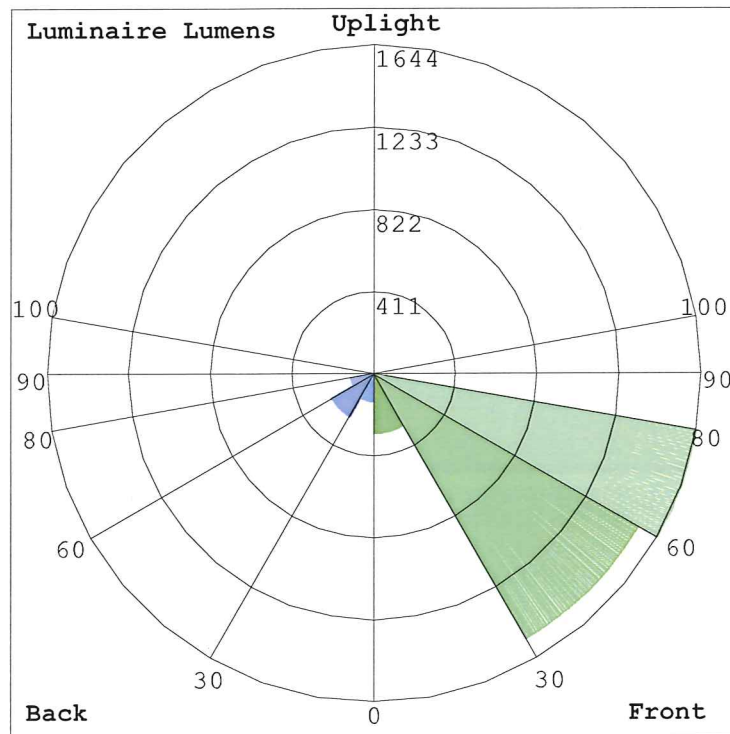

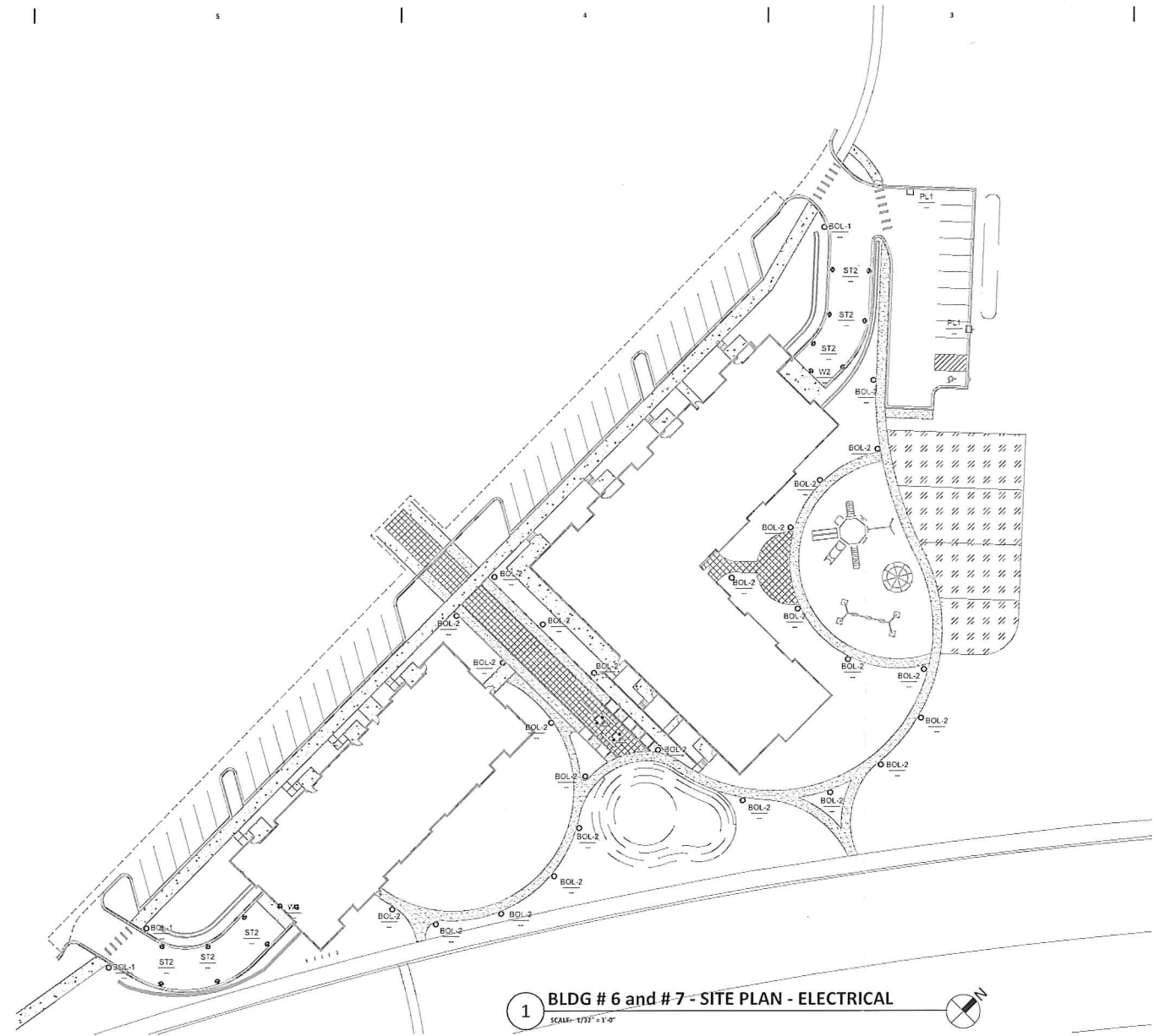

1 BLDG # 6 and # 7 - SITE PLAN - ELECTRICAL
SCALE: 1/32" = 1'-0"

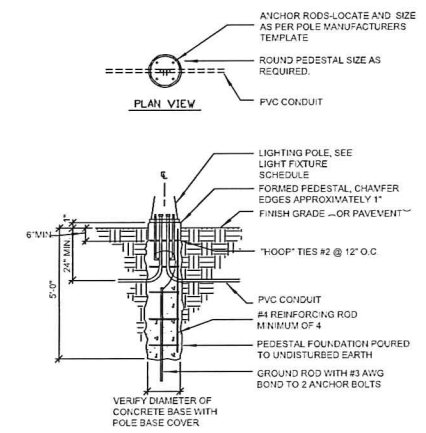

2 FIXTURE TYPY PL1 BASE MOUNTING DETAIL
SCALE: NTS

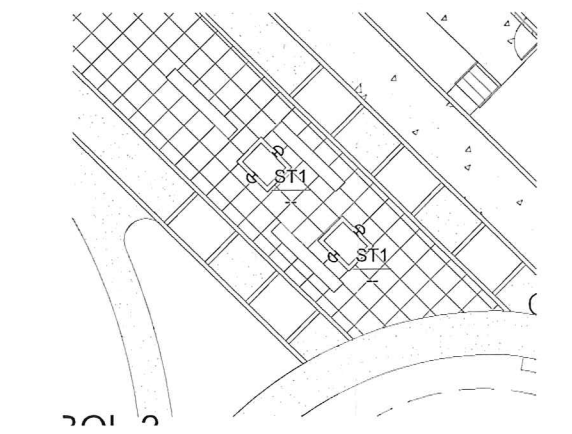

3 PLANTERS - SITE PLAN - ELECTRICAL
SCALE: 1/8" = 1'-0"

CIRCUITRY & LIGHTING CONTROL NOTES:

A. LIGHTING CIRCUITRY TO BE FED FROM BUILDING # XXX LIGHTING HOUSE PANEL "LP-1"

B. CIRCUIT NUMBERS FOR LIGHTING IS INDICATED BY NUMBER UNDER FIXTURE TYPE. "HOME RUNS" ARE SHOWN FOR OVERLAPPING OR VICE VERSA EXACT INTENTIONS.

C. TYPICAL FIXTURE TYPE AND CIRCUIT NUMBER:

AI	FIXTURE TYPE
10	CIRCUIT NO

D. CIRCUIT NUMBERS FOR POWER DEVICES/EQUIPMENT IS INDICATED ADJACENT TO THE SYMBOL.

E. PROVIDE LIGHTING CONTROL FROM LOW VOLTAGE LIGHTING CONTROL PANEL LVPR-1. SEE CIRCUITS LISTED ON THE PANELBOARD SCHEDULES AND LOW VOLTAGE RELAY SCHEDULE.

F. WIRING SCHEDULE:

1	2 #8 XHHW + GR, 2" PVC CONDUIT
2	4 #8 XHHW + GR, 2" PVC CONDUIT MINIMUM
3	8 #8 XHHW + GR, 2-1/2" PVC CONDUIT MINIMUM
4	3 #6 XHHW + GR, 2" PVC CONDUIT MINIMUM
5	3 #8 XHHW + GR, 2" PVC CONDUIT MINIMUM

SPECIFIC NOTES (POWER):

1 PROVIDE TRANSITION CABINET FOR SECONDARY SIDE OF TRANSFORMER TO BUILDING CABLE TRANSITIONS - COORDINATE WITH UTILITY, AND GC FOR EXACT LOCATION.

2 PEDESTAL MOUNTED WP RATED RECEPTACLE BOX WITH LOCKING COVER - COLE LTG # TL310-WCS-PED, WITH 2 DUPLEX RECEPTACLES - CONCRETE BASE TO BE COMBINED WITH BOLLARDS - COORDINATE WITH VFGRS

SPECIFIC NOTES (COMMUNICATIONS):

C1 COMMUNICATIONS CONDUITS - PROVIDE (TWO) 4" CONDUIT SETS, EACH FOR CABLE AND TELEPHONE, FOR ENTRANCE CABLES BY UTILITIES. COORDINATE EXACT LOCATION WITH UTILITIES AND CIVIL CONTRACTOR. RUN CONDUITS OUT 5' FROM BUILDING. PROVIDE LABELED RED FLAG, STAKED 24" ABOVE GRADE IF BACKFILLED PRIOR TO CABLES BEING INSTALLED (CAP ENDS OF CONDUITS) - SEE SHEET E100 FOR INTERIOR CONTINUATION.

C2 PROVIDE SECURITY ENTRANCE VIA "LONG READER" FOB KEY DOOR ENTRANCE/SECURITY SYSTEM READER FOR GARAGE DOOR OPERATION. MOUNT ABOVE GARAGE DOOR.

ELECTRICAL GENERAL NOTES:

A. CONTRACTOR TO PROVIDE QUANTITY OF CONDUITS AS REQUIRED. COORDINATE WITH GENERAL CONTRACTOR (GC) WHEN RUNNING CONDUIT IN EXPOSED STRUCTURE AREAS SO AS TO RUN CONDUIT IN PARALLEL AND PERPENDICULAR PATHS TO BUILDING ELEMENTS.

B. ALL PAINTING OF ALL EXPOSED CONDUIT WILL BE BY THE GC, AND WILL MATCH SURFACE UPON WHICH IT IS ATTACHED.

C. ALL CONDUIT SHALL BE ROUTED A MINIMUM OF 36" BELOW FINISHED GRADE. EXACT METHOD OF ROUTING OUTDOOR LIGHTING WIRING SHALL BE COORDINATED WITH THE GENERAL CONTRACTOR, UNLESS OTHERWISE NOTED. ALL EXTERIOR LIGHTING WIRING SHALL BE #8AWG COPPER AND SHALL BE ROUTED IN SCHEDULE 40 PVC. MINIMUM CONDUIT SIZE IS 1" (AT CONNECTION TO FIXTURES).

D. ELECTRICAL CONTRACTOR SHALL PROVIDE ALL APPURTENANCES NECESSARY FOR A COMPLETE AND CODE COMPLIANT INSTALLATION.

E. ALL FIXTURES, POLES, ARMS, BASES, ETC. SHALL BE PROVIDED WITH FACTORY APPLIED POWDER PAINT FINISH. THE ELECTRICAL CONTRACTOR SHALL PAINT ANY EXPOSED EQUIPMENT TO MATCH.

F. NO CONTINUOUS CONDUIT RUN SHALL EXCEED 100 FEET (30 METERS) WITHOUT A JUNCTION BOX.

G. CONTACT LOCAL ELECTRICAL UTILITY TO COORDINATE FINAL ELECTRICAL UTILITY CONNECTIONS, LOCATIONS, INSTALLATION, ETC. UTILITY IS TO PROVIDE PRIMARY CONDUIT AND WIRING TO PAD MOUNTED TRANSFORMERS (W/ PAD MOUNTED CT) LOCATED APPROXIMATELY WHERE SHOWN ON PLANS. SITE ELECTRICAL CONTRACTOR TO PROVIDE CONDUIT AND WIRING TO MAIN ELECTRICAL ROOM. COORDINATE LOCATIONS OF SERVICE ENTRANCE CONDUIT W/ GENERAL CONTRACTOR FOR EXACT LOCATIONS OF MAIN DISTRIBUTION PANELS.

H. CONTACT LOCAL TELEPHONE AND CABLE UTILITY TO COORDINATE FINAL CONNECTIONS, LOCATIONS, INSTALLATION, ETC. PROVIDE UNDERGROUND PVC CONDUIT FROM UTILITY CONNECTION POINT TO LOCATION OF COMMUNICATIONS BOARD LOCATED IN MAIN ELECTRICAL ROOM. OBTAIN PLAN APPROVAL PRIOR TO STARTING WORK. OWNER SHALL PAY CONNECTION CHARGES.

REAL ESTATE DEVELOPMENT & MANAGEMENT
200 N. MAIN STREET
OREGON, WI 53575

Seal

Consultant
BEAR VALLEY ENGINEERING, INC.
COMMERCIAL BUILDING SPECIALISTS
1250 FEMRITE DRIVE, SUITE 200
MADISON, WI 53716

**GRAND FAMILY HOUSING
UNION CORNERS
2507 WINNEBAGO STREET
MADISON, WISCONSIN 53704**

CONSTRUCTION DOCUMENTS

Project No. _____
Plot Date: December 27, 2017
Drawn by: BVE
USER

Date	Issue Description
December 27, 2017	Issued For Review
XXXXX	XXXXX

Sheet Title

SITE PLAN
- ELECTRICAL

Sheet No.

ES01

Symbol	Qty	Tag	Label	Description	Lum. Watts	Lum. Lumens	LLF
□	37	B1	B1 303-B1-LEDB1-3000-UNV-T2-D	303-B1-LEDB1-3000-UNV-T2-DIM10-BK	8.16	600	0.900
□	6	B2	B2 303-B1-LEDB2-3000-UNV-T4-D	303-B1-LEDB2-3000-UNV-T4-DIM10-BK	15.5	1240	0.900
□	2	PL1	PL1 GLEON-AF-01-LED-E1-SL2-70	GLEON-AF-01-LED-E1-SL2-7030-HSS	59	4569	1.000
□	5	ST2	ST2 WE-EF 616-2321	616-2321	18	894	0.900
□	2	W5	W2 Mc-Graw-Edisonn IST-AF-800	IST-AF-800-LED-E1-SL4-7030	43.5	4055	0.900

Label	CalcType	Units	Avg	Max	Min	Avg/Min	Max/Min
Building Left Garage Ramp 1 Plan	Illuminance	Fc	1.97	4.8	0.6	3.28	8.00
Building Left Garage Ramp Planar	Illuminance	Fc	2.92	17.0	0.6	4.87	28.33
Building Right Garage Ramp Planar	Illuminance	Fc	2.16	8.5	0.5	4.32	17.00
Ground Plane Calc Points	Illuminance	Fc	0.32	11.5	0.0	N.A.	N.A.

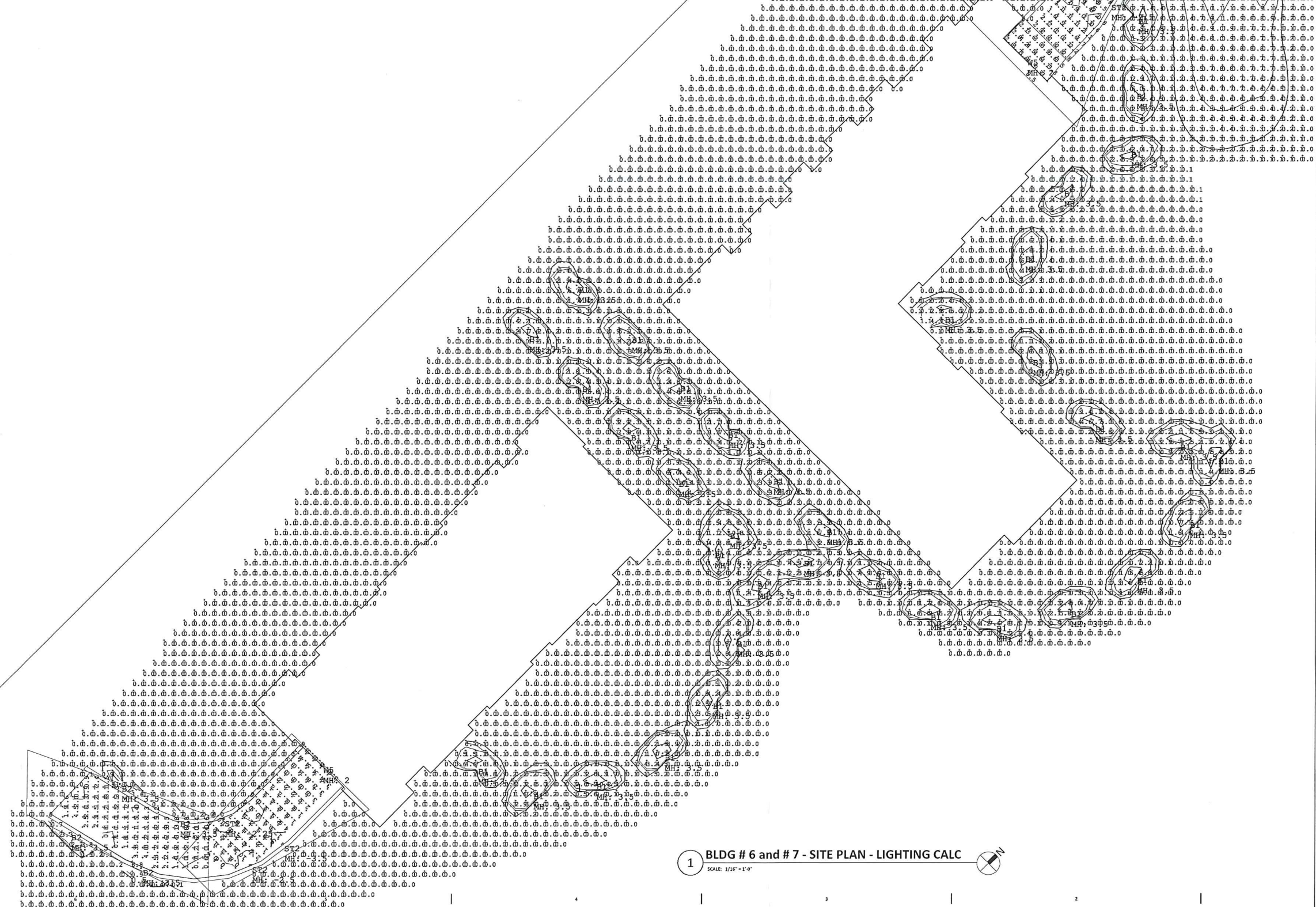

1 BLDG # 6 and # 7 - SITE PLAN - LIGHTING CALC
SCALE: 1/16" = 1'-0"

REAL ESTATE DEVELOPMENT & MANAGEMENT
200 N. MAIN STREET
OREGON, WI 53755

Consultant
BEAR VALLEY ENGINEERING, INC.
COMMERCIAL BUILDING SPECIALISTS
1250 FEMRITE DRIVE,
SUITE 200
MADISON, WI 53716

GRAND FAMILY HOUSING
UNION CORNERS
2507 WINNEBAGO STREET
MADISON, WISCONSIN 53704

CONSTRUCTION DOCUMENTS	
Project No.	
Plot Date:	December 27, 2017
Drawn by:	BVE USER
Date	Issue Description
December 27, 2017	Issued For Review
XXXXX	XXXXX

Sheet Title
SITE PLAN
- LIGHTING
CALCULATIONS
Sheet No.
ES01-CALC