

- All hard surfaces will incorporate brushed, scored, concrete; colored concrete; and / or patterned concrete. Colored concrete will be impregnated and / or stained. Graphics may be incorporated as approved by the Owner / Landscape Architect.
- The Mechanical building shall be pre-cast concrete / masonry block construction similar to but not limited to; [http://www.huffcutt.com/restroom\\_buildings.html](http://www.huffcutt.com/restroom_buildings.html), <http://www.walcon.com/showcase.html>, or equal and sized to include all mechanicals and HVAC as required for site. Building to be designed to provide site / screen wall with courtesy shower for public use and accessible drinking fountain and rooftop overlook. Access will be by steps and accessible ramp. Network data and phone service will also be required to and on the building.
- Passive recreation areas w/ fabric and / or solar shade canopies on single clustered post design similar but not limited to; <http://www.parasolnet.com>, <http://www.playlsi.com/Products/Accessories/CoolToppers/CoolToppersFullSail/>, or equal or varying areas and heights.
- Dry Play area segregated from the SprayPark to include toddler / infant swings, composite play structure and stand-alone play activities. Loose-fill rubber accessible, safety surface to be included. Area to include donor arch w/ naming rights associated to this playground only.
- Lighting to provide area lighting for security only. Night operation of facility is unlikely but should be considered in design as a Phase II option. Construction and power sources should accommodate for simple expansion of lighting system if / when required. All new and existing services on-site should be coordinated for underground distribution by MG & E
- Site is to be secured w/ a 6' welded or decorative wire fence w/ rolled top. Fence fabric and posts to be plastic coated, powder-coated and / or finished in a color as approved by the Owner / Landscape Architect. Pedestrian accessible passage gates and 12' wide service gates located at existing drive apron and into mechanical building to be included.
- Landscape beds to include ornamental trees and shrubs w/ shredded hardwood bark over 6 oz. permeable, non-woven landscape fabric and perennials w / only shredded hardwood bark or leaf mulch and be installed as per section 209 of BPW standard specifications to include warranty and maintenance as described.
- Other site amenities are to include facility signage, 'themed' way-finding and instructional signage. In addition, site furnishings are to include benches and table / bench combinations and bike racks all stationery. Banners / Flags may be incorporated into design concept for use during open hours/ season.
- A non-climbable Water Play Structure similar but not limited to Kompan Water Play Module, M-587 and / or Waterfall, M-591P should be accommodated for in Phase II.
- Recommendations or siting of a Public Art piece should be included in the schematic / conceptual designs and all related amenities, i.e. foundation / base, lighting, etc. to be incorporated into base contract for a Phase II completion. Madison Arts Commission will solicit artists for this project for a \$10,000 commission, which is in addition to the project costs available.

**Cypress SprayPark**  
**902 Magnolia Lane**

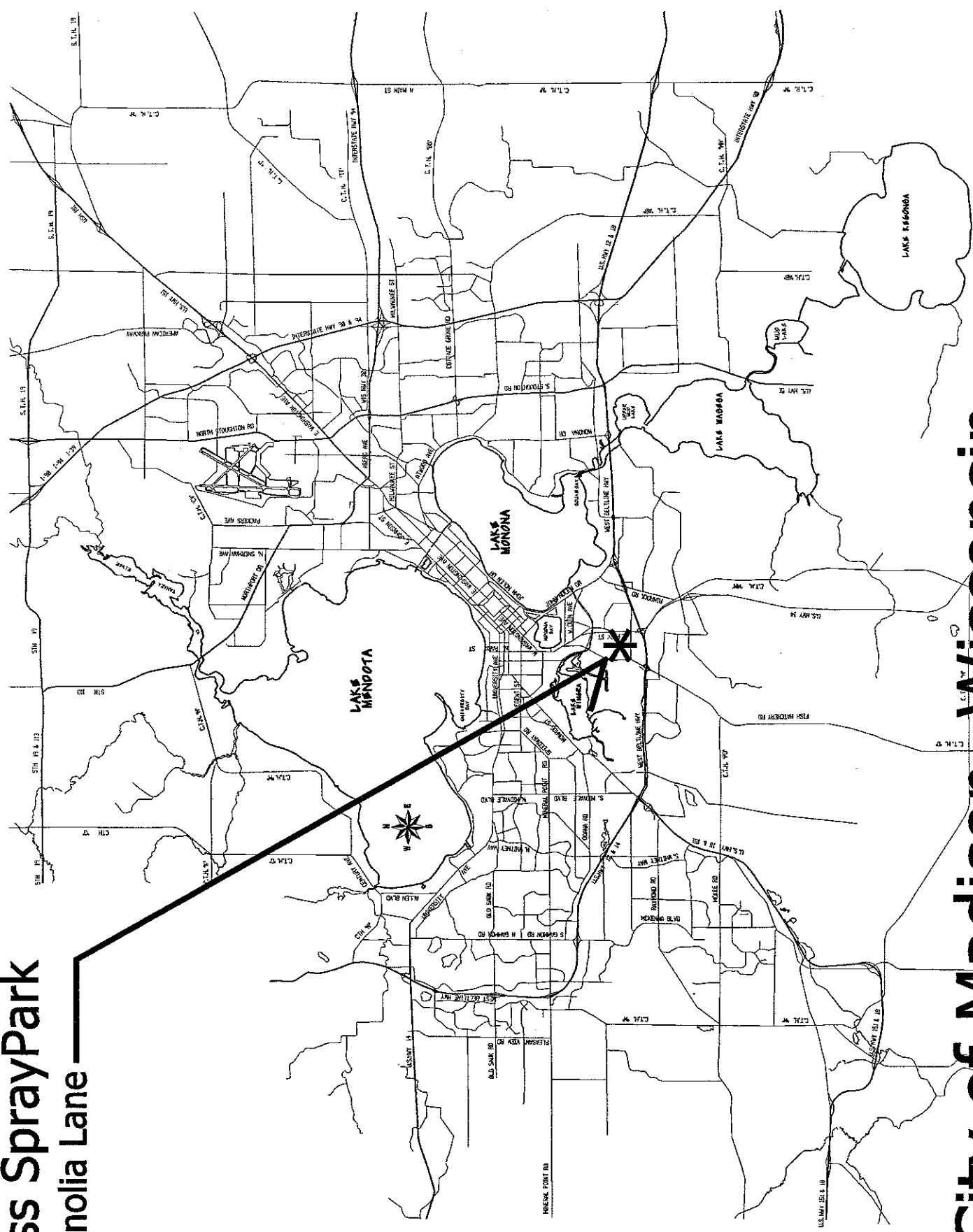

**City of Madison, Wisconsin**

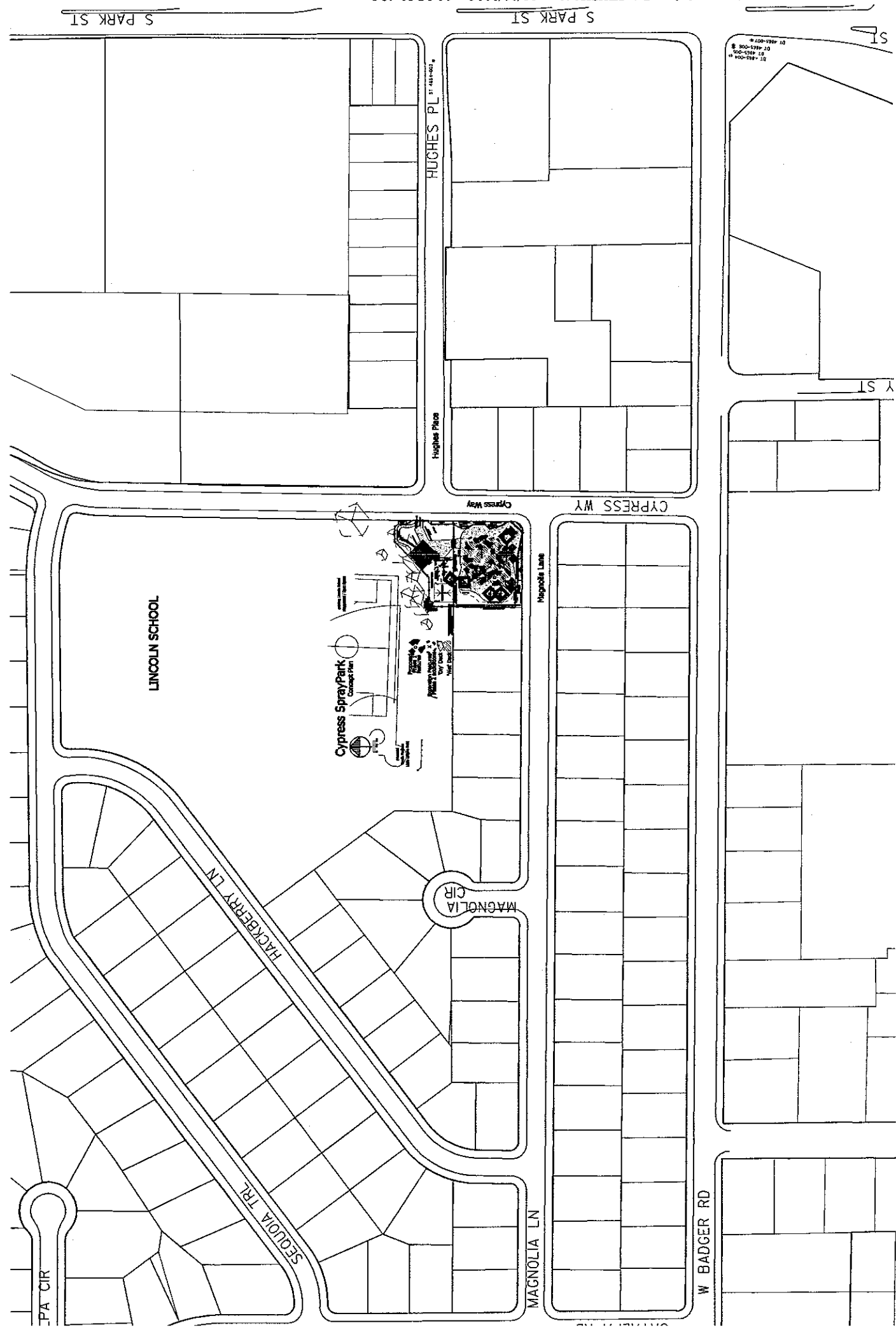

Cypress Splash m nlfiter by nawab from PA HWSK141 on 12/20/2006 at 10 27 50 AM

