

-Will complete after walk-through

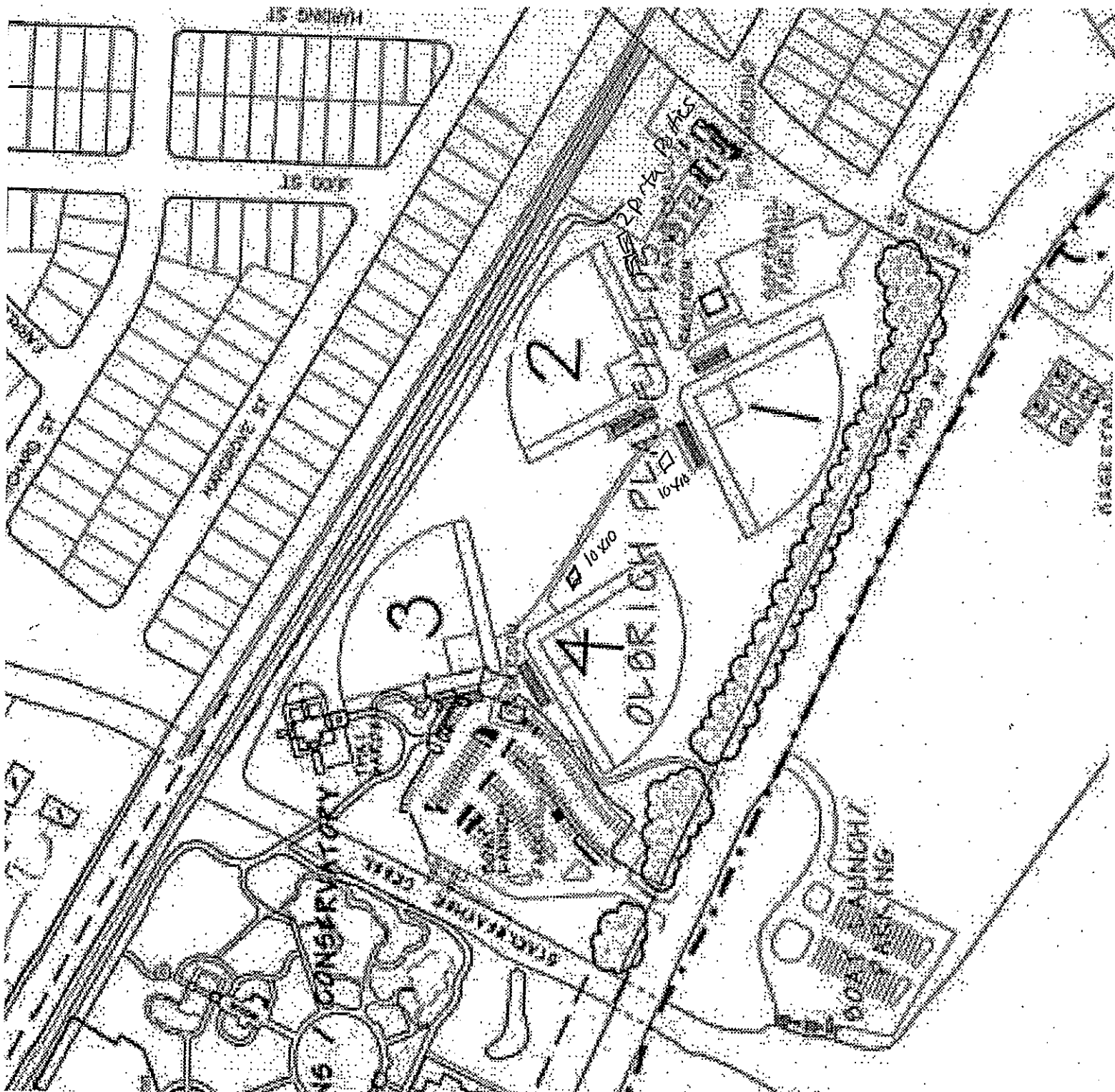

BASEBALL

stage Saturday
2 Pr. rta
17D
12/14/14

PARKING LOT

SOCCER



SOFTBALL

COMPLEX

4

3

2

NO LOW AREA

2 Bkts 10/14

IN AREA

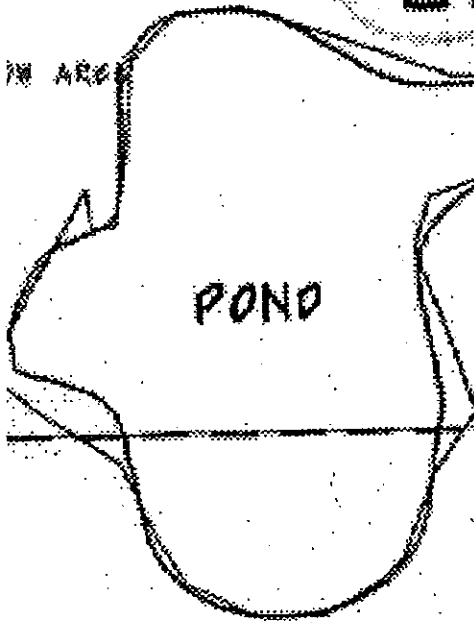

POND

NO

WOODS

ELVER

- Will complete after walk through

WOODS

