

STREET USE PERMIT APPLICATION

FOR OFFICE USE ONLY: Permit # _____ Date Submitted _____

EVENT INFORMATION

Name of Event Wisconsin Science Festival

Event Organizer/Sponsor Wisconsin Alumni Research Foundation

Is Organizer/Sponsor a 501(c)3 non-profit agency? Yes No

If Yes, provide State of Wisconsin Tax Exempt Number _____

Address 333 N. Orchard St

City/State/Zip Madison, WI 53597

Primary Contact Ann Feist FAX _____

Work Phone 608-316-4301 Phone During Event 608-712-5229

E-mail afeist@warf.org

Website _____

Secondary Contact _____

Work Phone _____ Phone During Event _____

E-mail _____

Annual Event? Yes No

Charitable Event? Yes No

If Yes, name of charity to receive donations: _____

Estimated Attendance 1000 (CERTIFICATE OF INSURANCE MAY BE REQUIRED)

Public Amplification (not allowed after 11 p.m.) Hours _____ to _____ Yes No

EVENT CATEGORY

Run/Walk Music/Concert Festival Rally Parking (i.e., bagging meters)

Other _____

LOCATION REQUESTED

Capitol Square (note specific blocks below) Podium/700-800 State Street

30 on the Square (a.k.a. top of 100 block of State Street) Other (specific blocks/streets requested below)

Street Names and Block Numbers: 300 Block of Orchard Street

EVENT DATE(S)/SCHEDULE

Date(s) of Event (including set-up and take-down) 9/23-9/25 Rain Date(s) none

Event Start Date(s)/Time(s) 9/23, 9:00am, 9/24, 10:00am, 9/25, 10:00am Set-Up Date(s)/Time for Event 9/23, 7:00am, 9/24, 8:00am, 9/25, 8:00am

Event End Date(s)/Time(s) 9/23, 4:00pm, 9/24, 9:00pm, 9/25, 4:00pm Take-Down Time 9/23, 10:00pm, 9/24, 10:00pm, 9/25, 5:00pm

Take-Down Time: start to streets reopened

APPLICATION SIGNATURE

I/We waive the 21-day decision requirement.

AF (PLEASE INITIAL)

Your signature below indicates that you have read and understand the instructions and guidelines for a community event. Further, the person/group named in this application will be responsible for the conduct of the group and for the condition of the reserved area. Falsification of information on the application will result in forfeiture of up to \$200 per falsified item.

In addition to the rules and regulations detailed in the permit application instructions and guidelines, Street Use Permits are subject to all applicable ordinances, statues and laws.

Signature Ann Feist

Date June 20 2011

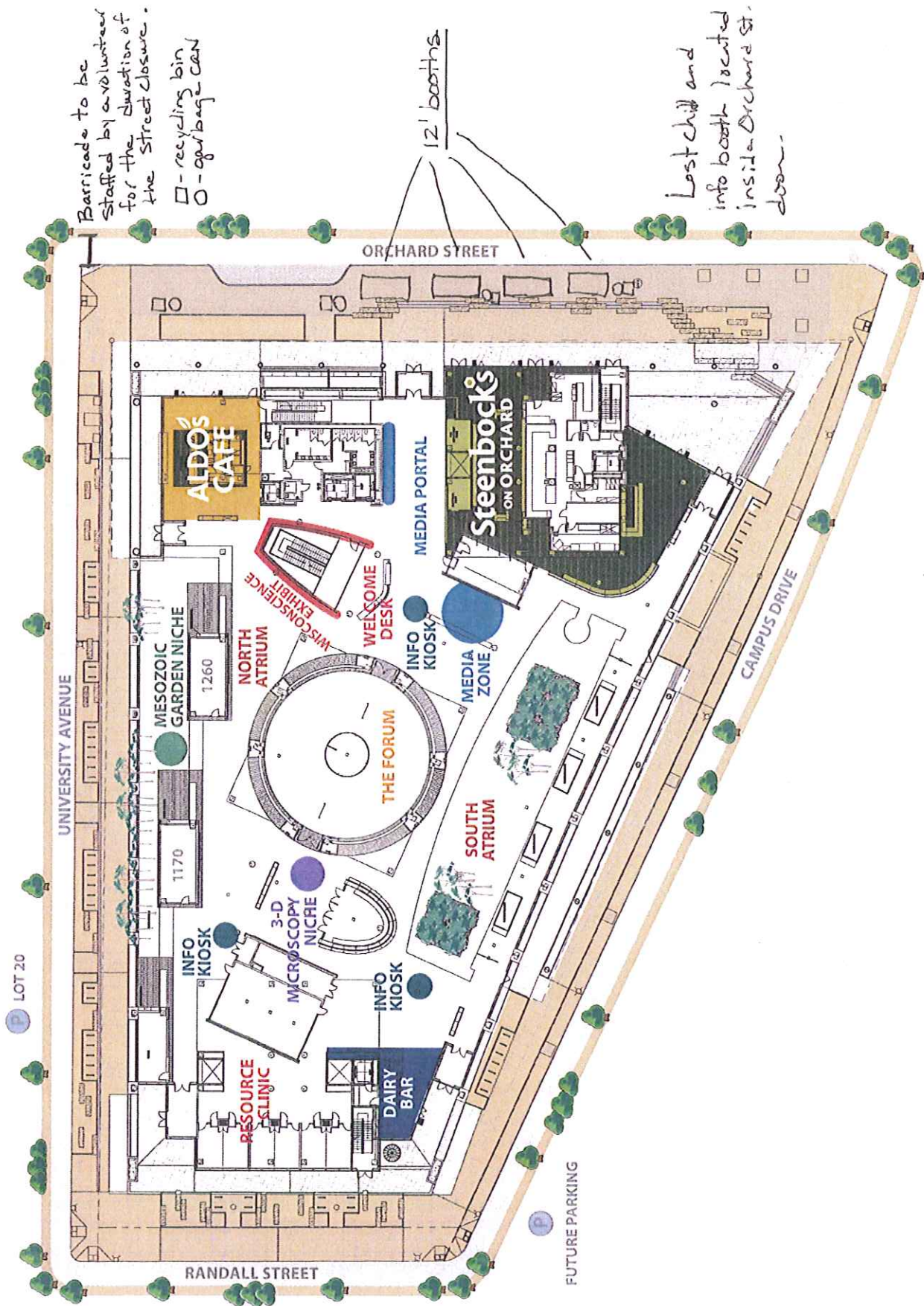

Barricade to be staffed by volunteers for the duration of the street closure.

- - recycling bin
- - garbage can

12' booths

Lost chill and info booth located inside Orchard St. door.

LOT 20

FUTURE PARKING