

©2013 Vierblicher Associates, Inc.

11 Mar 2015 - 4:41p M:\T\Wall Enterprises LLC\140245-Wingra Point Phase 2\CADD\140245\_Base\_eng.dwg by:cguy

**GRADING LEGEND**

- - - 820 - - - EXISTING MAJOR CONTOURS
- - - 818 - - - EXISTING MINOR CONTOURS
- ○ ○ SILT FENCE
- - - - - DISTURBED LIMITS
- ⇒ DRAINAGE DIRECTION
- ⊕1048.61 EXISTING SPOT ELEVATIONS
- 1048.61 PROPOSED SPOT ELEVATIONS
- ⊙ INLET PROTECTION
- ▨ TRACKING PAD

**SITE PLAN LEGEND**

- ▭ PROPERTY BOUNDARY
- ▨ CURB AND GUTTER (REVERSE CURB HATCHED)
- ▨ PROPOSED CONCRETE
- ▨ PROPOSED ASPHALT
- - - - - ADA ACCESSIBLE ROUTE

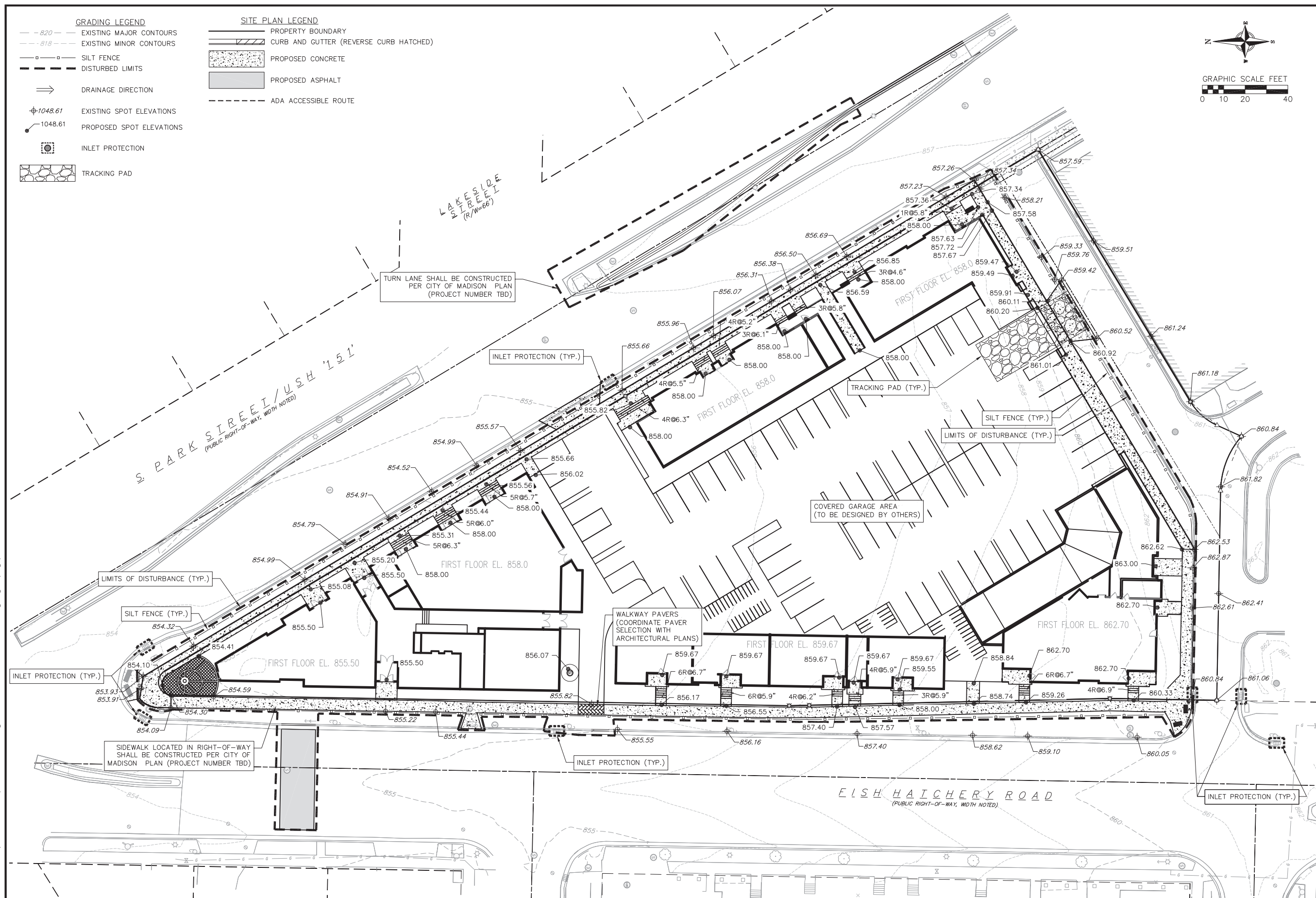
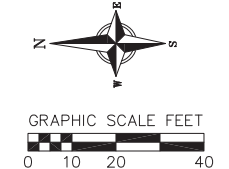

**vierblicher**  
 planners | engineers | advisors  
 REEDSBURG - MADISON - PRAIRIE DU CHIEN  
 997 Fourth Ave., Suite 200, Madison, Wisconsin, 53717  
 Phone: (608) 255-6662 Fax: (608) 255-6660

**Grading and Erosion Control Plan**  
 Wingra Point Phase 2  
 City of Madison  
 Dane County, Wisconsin

| REVISIONS | NO.     | DATE | REMARKS           |
|-----------|---------|------|-------------------|
| REVISIONS | NO.     | DATE | REMARKS           |
| 1         | 3/12/15 |      | SUBMITTAL TO CITY |

SCALE AS SHOWN  
 DATE 3/12/2015  
 DRAFTER CGUY  
 CHECKED JFEL  
 PROJECT NO. 140245  
 SHEET 2 OF 4  
 DWG. NO. C-2.0