

**3575 University Avenue**  
**Contract 9676**  
**MUNIS 15902**  
**Developer: University 3000 LLC**

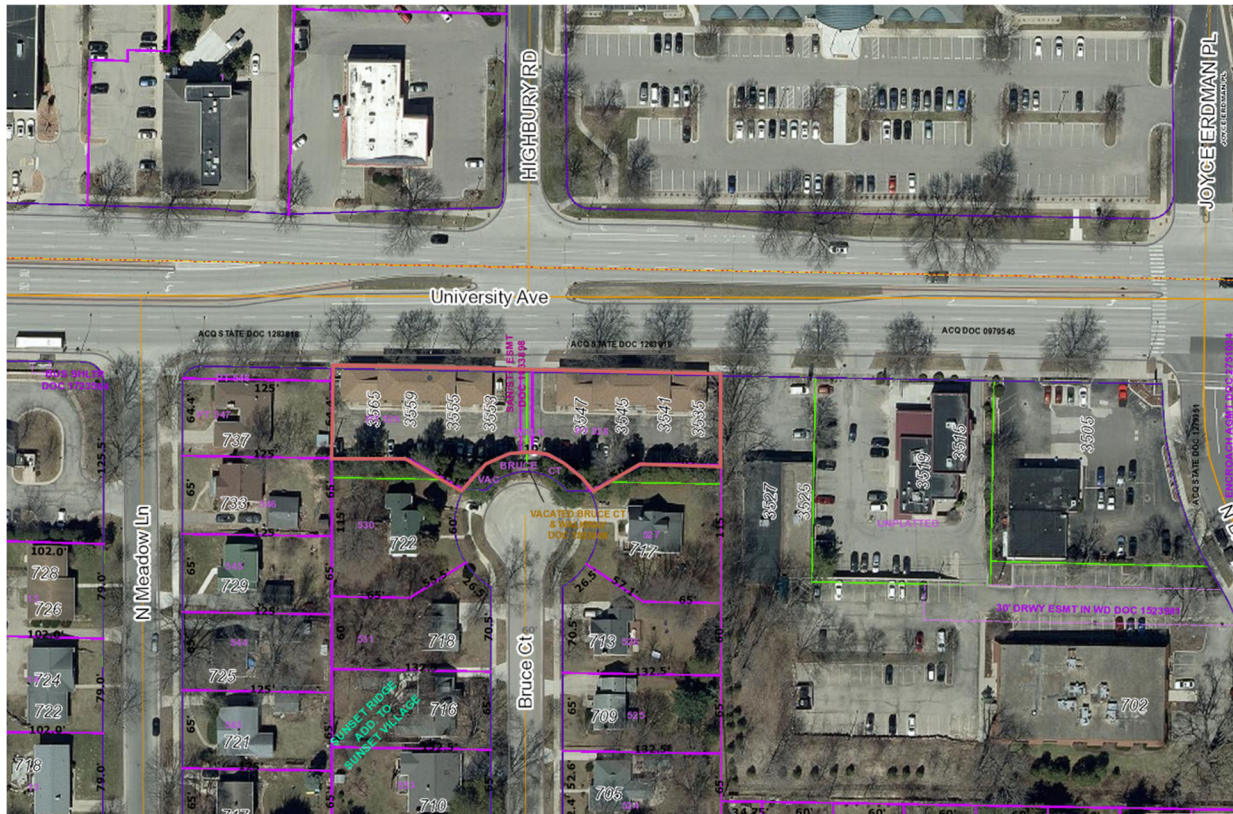

### Summary of Improvements:

- Complete Certified Survey Map (CSM) required for the redevelopment. Dedication of public sanitary sewer easement and public sidewalk, storm sewer and surface drainage easements on the CSM; including Consent to Occupy Easement and/or Privilege in Streets agreement as required by Engineering Mapping for private access, pedestrian, landscaping, building canopies and retaining wall improvements.
- Construct sidewalk, terrace, curb and gutter and pavement adjacent to the development along University Avenue and N Meadow Lane to a plan approved by the City Engineer.
- Construct new commercial drive aprons and ingress/egress to the development on University Avenue and N Meadow Lane to a plan approved by the City Traffic Engineer.
- Construct traffic signal(s), lighting, signing and marking to a plan approved by the City Traffic Engineer.

- Construct public sanitary sewer, storm sewer and drainage improvements to a plan approved by the City Engineer to serve the lot(s) within the CSM.
- Construct private sanitary, storm, and water service laterals as needed to serve the redevelopment.
- Protect existing public street terrace trees adjacent to the project, except for those approved for removal by City Forestry as part of the site plan verification approval for the redevelopment project.
- Protect public fiber cable located in University Avenue in coordination with Traffic Engineering.
- Repair or replace existing public sidewalk, street terrace, curb and gutter, street terrace, and street pavement as necessary to accommodate the private redevelopment project.



GENERAL NOTES

1. REFER TO THE EXISTING CONDITIONS SURVEY FOR EXISTING CONDITIONS NOTES AND LEGENDS.
2. ALL WORK IN THE RIGHT-OF-WAY AND/OR PUBLIC EASEMENTS SHALL BE IN ACCORDANCE WITH THE STANDARD SPECIFICATIONS, JURISDICTIONAL SPECIFICATIONS, AND APPROVED BY THE JURISDICTION HAVING AUTHORITY.
3. EXISTING GRADE SPOUT ELEVATIONS SHOWN FOR INFORMATIONAL PURPOSES. DURING CONSTRUCTION MATCH EXISTING GRADES AT CONSTRUCTION LIMITS.
4. NO SITE GRADING OUTSIDE OR DOWNSLOPE OF PROPOSED SILT FENCE LOCATION. NO LAND DISTURBANCE BEYOND PROPERTY LINES.
5. JSD SHALL BE HELD HARMLESS AND DOES NOT WARRANT ANY DEVIATIONS BY THE OWNER/CONTRACTOR FROM THE APPROVED CONSTRUCTION PLANS THAT MAY RESULT IN DISCIPLINARY ACTIONS BY ANY OR ALL REGULATORY AGENCIES.
6. CONTRACTOR SHALL RESTORE ALL BUILDINGS, PAVEMENT, PIPES, SLOPES, AND STRUCTURES DAMAGED BY THE CONTRACTOR TO PRE-EXISTING OR BETTER CONDITIONS.
7. THE RIGHT-OF-WAY IS THE SOLE JURISDICTION OF THE JURISDICTIONAL AUTHORITY AND IS SUBJECT TO CHANGE AT ANY TIME.
8. CONTRACTOR SHALL BE RESPONSIBLE FOR SITE SAFETY DURING THE CONSTRUCTION OF THESE IMPROVEMENTS.
9. ANY REFERENCES TO THE TERMS OR ENTITY ABBREVIATIONS IN THE FOLLOWING NOTES AND SPECIFICATIONS SHALL BE UNDERSTOOD AS FOLLOWS:
  - 1. "JURISDICTION" - THE LOCAL GOVERNMENT AGENCY (I.E. CITY, VILLAGE, TOWN, COUNTY, STATE, OR UTILITY SERVICE PROVIDER) HAVING AUTHORITY.
  - 2. "STATE HIGHWAY SPECIFICATIONS" - STATE OF WISCONSIN STANDARD SPECIFICATIONS FOR HIGHWAY AND STRUCTURE CONSTRUCTION, CURRENT EDITION AND SUPPLEMENTS.
  - 3. "STANDARD SPECIFICATIONS" - STANDARD SPECIFICATIONS FOR SEWER AND WATER CONSTRUCTION IN WISCONSIN, CURRENT EDITION AND SUPPLEMENTS.
  - 4. WISCONSIN DEPARTMENT OF TRANSPORTATION - "WISDOT".
  - 5. WISCONSIN DEPARTMENT OF NATURAL RESOURCES - "WDNR".
  - 6. DEPARTMENT OF SAFETY AND PROFESSIONAL SERVICES - "DSPS" OR "SPS".

DEMOLITION NOTES

1. THIS PLAN INDICATES ITEMS ON THE PROPERTY INTENDED FOR DEMOLITION BASED ON THE CURRENT SITE DESIGN THAT HAVE BEEN IDENTIFIED BY A REASONABLE OBSERVATION OF THE EXISTING CONDITIONS THROUGH FIELD SURVEY RECONNAISSANCE. "DEMOLITION" LOCATION AND TO GENERAL "STANDARD OF CARE" THERE MAY BE ADDITIONAL ITEMS THAT CAN NOT BE IDENTIFIED BY A REASONABLE ABOVEGROUND OBSERVATION, OF WHICH THE ENGINEER WOULD HAVE NO KNOWLEDGE OR MAY BE A PART OF ANOTHER DESIGN DISCIPLINE. IT IS THE CONTRACTOR'S RESPONSIBILITY TO REVIEW THE PLANS, INSPECT THE SITE, AND PROVIDE THEIR OWN DUE DILIGENCE TO INCLUDE IN THEIR BID WHAT ADDITIONAL ITEMS, IN THEIR OPINION, MAY BE NECESSARY FOR DEMOLITION. ANY ADDITIONAL ITEMS IDENTIFIED BY THE CONTRACTOR SHALL BE IDENTIFIED IN THE BID AND REPORTED TO THE ENGINEER OR RECORD. JSD TAKES NO RESPONSIBILITY FOR ITEMS ON THE PROPERTY THAT COULD NOT BE LOCATED BY A REASONABLE OBSERVATION OF THE PROPERTY OR OF WHICH THEY WOULD HAVE NO KNOWLEDGE.
2. CONTRACTOR SHALL KEEP ALL STREETS AND PRIVATE DRIVES FREE AND CLEAR OF ALL CONSTRUCTION-RELATED DIRT, DUST, AND DEBRIS.
3. ALL TREES WITHIN THE CONSTRUCTION LIMITS SHALL BE REMOVED UNLESS SPECIFICALLY CALLED OUT FOR PROTECTION. ALL TREES TO BE REMOVED SHALL BE REMOVED IN THEIR ENTIRETY. STUMPS MAY BE GROUND TO PROVIDED SUBGRADE IN GRASSSED AREAS ONLY UNLESS DIRECTED BY ENGINEER.
4. ALL LIGHT POLES TO BE REMOVED SHALL BE REMOVED IN THEIR ENTIRETY, INCLUDING BASE AND APPURTENANCES. SALVAGE FOR RELOCATION. COORDINATE RELOCATION AND/OR ABANDONMENT OF ALL ELECTRIC LINES WITH ELECTRICAL ENGINEER AND OWNER PRIOR TO DEMOLITION.
5. ABANDONED/REMOVED ITEMS SHALL BE LEGALLY DISPOSED OF OFFSITE UNLESS OTHERWISE NOTED.
6. CONTRACTOR TO REPLACE ALL SIDEWALK AND CURB AND GUTTER ABUTTING THE PROPERTIES THAT WERE DAMAGED BY THE CONSTRUCTION.
7. PRIOR TO CONSTRUCTION, THE CONTRACTOR SHALL BE RESPONSIBLE TO:
  - 7.1. EXAMINE ALL SITE CONDITIONS RELATIVE TO THE CONDITIONS INDICATED ON THE ENGINEERING DRAWINGS. ANY DISCREPANCIES ARE TO BE REPORTED IMMEDIATELY TO THE ENGINEER AND RESOLVED PRIOR TO THE START OF CONSTRUCTION.
  - 7.2. VERIFY UTILITY ELEVATIONS AND NOTIFY ENGINEER OF ANY DISCREPANCIES. NO WORK SHALL BE PERFORMED UNTIL THE DISCREPANCIES ARE RESOLVED.
  - 7.3. NOTIFY ALL UTILITIES OWNERS PRIOR TO THE REMOVAL OF ANY UNDERGROUND UTILITIES.
  - 7.4. NOTIFY THE DESIGN ENGINEER AND LOCAL GOVERNING MUNICIPALITY 48 HOURS PRIOR TO THE START OF CONSTRUCTION TO ARRANGE FOR APPROPRIATE CONSTRUCTION INSPECTION.
8. ANY UTILITIES THAT ARE DAMAGED BY THE CONTRACTORS SHALL BE REPAIRED TO THE OWNERS' SATISFACTION AT THE CONTRACTORS' EXPENSE.
9. CONTRACTOR SHALL COORDINATE PRIVATE UTILITY REMOVAL/ABANDONMENT AND NECESSARY REPAIRS WITH RESPECTIVE UTILITY COMPANY. CONTRACTOR SHALL COORDINATE WITH PRIVATE UTILITY COMPANIES PRIOR TO CONSTRUCTION.
10. ALL DEMOLITION SHALL BE IN ACCORDANCE WITH THE APPROVED JURISDICTION'S RECYCLING PLAN.
11. ANY CONTAMINATED SOILS ENCOUNTERED SHALL BE REMOVED IN ACCORDANCE WITH FEDERAL AND STATE REGULATIONS TO AN APPROPRIATE AND APPROVED LANDFILL.
12. ALL EXISTING UTILITIES SHALL BE FIELD LOCATED AND CLEARLY MARKED BY CONTRACTOR PRIOR TO ANY EXCAVATION. CONTRACTOR SHALL NOTIFY ENGINEER IMMEDIATELY IF ANY DISCREPANCIES OCCUR IN THE LOCATION SHOWN OR PROPOSED (INCLUDING EXISTING UTILITY LINE LOCATIONS). CONTRACTOR SHALL BE RESPONSIBLE FOR CONDUCTING UTILITY LINE OPENINGS (LO) TO CONFIRM LOCATIONS OR ELEVATIONS, AS REQUESTED BY THE ENGINEER.
13. SEWER ABANDONMENT SHALL BE IN ACCORDANCE WITH SECTION 3.2.24 OF THE STANDARD SPECIFICATIONS AND JURISDICTIONAL SPECIFICATIONS.
14. WATER ABANDONMENT SHALL BE IN ACCORDANCE WITH SECTION 4.14 OF THE STANDARD SPECIFICATIONS AND JURISDICTIONAL SPECIFICATIONS.
15. ALL PERMITTER EROSION CONTROL DEVICES SHALL BE INSTALLED PRIOR TO THE START OF DEMOLITION ACTIVITIES. CONTRACTOR SHALL KEEP ALL STREETS AND PAVEMENTS FREE AND CLEAR OF ALL CONSTRUCTION RELATED DIRT, DUST, AND DEBRIS.
16. BUILDING REMOVALS SHALL BE PERFORMED BY A QUALIFIED CONTRACTOR. CONTRACTOR SHALL FOLLOW ALL DEMOLITION REGULATIONS, DISCONNECT ALL UTILITIES, OBTAIN ALL APPLICABLE PERMITS, AND DISPOSE OF ALL BUILDING MATERIALS IN APPROPRIATE AND APPROVED LANDFILLS. DEMOLISHED MATERIALS SHALL NOT BE BURNED OR BURIED ON-SITE.
17. CONTRACTOR SHALL REMOVE EXISTING UTILITY PIPE OR PROVIDE PIPE BACKFILLING AFTER REMOVAL OF EXISTING UTILITIES WITHIN BUILDING FOOTPRINT USING LOW DENSITY CONCRETE/RIBBLE FILL.
18. RESTORATION OF THE EXISTING ROADWAY RIGHT-OF-WAYS ARE CONSIDERED INCIDENTAL, AND SHALL BE PART OF THE COST OF THE UNDERGROUND IMPROVEMENTS, DEMOLITION, AND REMOVAL. THIS INCLUDES CURB AND GUTTER, SIDEWALK, TOPSOIL, SEEDING, AND MULCHING.

PAVING NOTES

1. GENERAL:
    - 1.1. PAVING SHALL CONFORM TO STATE HIGHWAY SPECIFICATIONS, APPLICABLE JURISDICTIONAL SPECIFICATIONS, AND THE GEOTECHNICAL REPORT PREPARED BY GCG, INC. TITLED "GEOGRAPHICAL, EXPLORATION, REPORT, ISSUE DATE 1/2024". ALL REFERENCES TO THE "GEOTECHNICAL REPORT" SHALL BE UNDERSTOOD AS THE AFOREMENTIONED REPORT.
    - 1.2. ALL PAVEMENT AREAS ARE TO BE TO FACE OF CURB UNLESS SPECIFIED OTHERWISE.
    - 1.3. ALL SPOUT GRADES ARE TO EDGE OF PAVEMENT UNLESS SPECIFIED OTHERWISE.
    - 1.4. SURFACE PREPARATION - UTILITY ENGINEER/OWNER OF UNSATISFACTORY CONDITIONS. DO NOT BEGIN PAVING WORK UNTIL DEFICIENT SUBGRADE AREAS HAVE BEEN CORRECTED AND ARE READY TO RECEIVE PAVING.
    - 1.5. ANY REQUIRED REPLACEMENT OF PUBLIC CURB AND GUTTER, PAVEMENT, OR SIDEWALK SHALL MATCH EXISTING AND MEET JURISDICTIONAL REQUIREMENTS.
  2. CRUSHED AGGREGATE BASE COURSE SPECIFICATIONS:
    - 2.1. THE TOP LAYER OF BASE COURSE SHALL CONFORM TO SECTIONS 301 AND 305 OF THE STATE HIGHWAY SPECIFICATIONS.
    - 2.2. RECYCLED ASPHALT MAY NOT BE USED AS CRUSHED AGGREGATE BASE COURSE UNLESS SPECIFICALLY APPROVED BY THE ENGINEER OF RECORD. USE OF ANY OTHER REPROCESSSED OR BLENDED MATERIAL MUST FIRST BE APPROVED BY ENGINEER OF RECORD.
    - 2.3. DO NOT PLACE BASE ON FROZEN FOUNDATIONS UNLESS THE ENGINEER APPROVES OTHERWISE.
    - 2.4. DO NOT PLACE BASE ON FOUNDATIONS THAT ARE SIFT, SPONGY, OR COVERED BY ICE OR SNOW.
  3. HOT MIXED ASPHALT (HMA) PAVING SPECIFICATIONS:
    - 3.1. THE PLACING, COMPOSITION AND COMPOSITION OF THE BASE COURSE AND HMA SURFACE COURSE SHALL BE IN ACCORDANCE WITH THE REQUIREMENTS OF SECTIONS 405, 455, 460, AND 465 OF THE STATE HIGHWAY SPECIFICATIONS.
    - 3.2. WEATHER LIMITATIONS:
      - 3.2.1. DO NOT PLACE HMA WHEN BASE IS WET OR CONTAINS EXCESS MOISTURE.
      - 3.2.2. DO NOT PLACE ASPHALTIC MIXTURE WHEN THE AIR TEMPERATURE IS APPROXIMATELY 3° ABOVE GRADE, IN SHADE, AND AWAY FROM ARTIFICIAL HEAT SOURCES IS LESS THAN 40° UNLESS A VALID ENGINEER-ACCEPTED COLD WEATHER PAVING PLAN IS IN EFFECT.
    - 3.2.3. PLACE ASPHALTIC MIXTURE ONLY ON A PREPARED, FIRM AND COMPACTED BASE, FOUNDATION LAYER, OR EXISTING PAVEMENT SUBSTANTIALLY SURFACE-DRY AND FREE OF LOOSE AND FOREIGN MATERIAL. DO NOT PLACE OVER FROZEN SUBGRADE OR BASE.
    - 3.2.4. APPLY TACK COAT ONLY WHEN THE AIR TEMPERATURE IS 32°F OR MORE UNLESS THE ENGINEER APPROVES OTHERWISE IN WRITING.
    - 3.2.5. ALL ASPHALT (BOTH UPPER AND LOWER LAYERS) SHALL BE DELIVERED TO THE PROJECT SITE AT A TEMPERATURE NOT LOWER THAN 250°F.
  - 3.3. CONTRACTOR SHALL ESTABLISH AND MAINTAIN REQUIRED LINES AND ELEVATIONS FOR EACH COURSE DURING CONSTRUCTION.
  - 3.4. BINDER COURSE AGGREGATE:
    - 3.4.1. THE AGGREGATE FOR THE BINDER COURSE SHALL CONFORM TO SECTION 480 OF THE STATE HIGHWAY SPECIFICATIONS.
  - 3.5. LOCATION AND GENERAL AGGREGATE:
    - 3.5.1. THE AGGREGATE FOR THE SURFACE COURSE SHALL CONFORM TO SECTIONS 460 AND 465 OF THE STATE HIGHWAY SPECIFICATIONS.
  - 3.6.1. THE ASPHALTIC MATERIALS SHALL CONFORM TO SECTIONS 455, 460, AND 465 OF THE STATE HIGHWAY SPECIFICATIONS.
4. CONCRETE PAVING SPECIFICATIONS:
    - 4.1. CONCRETE PAVING SHALL BE IN ACCORDANCE WITH THE REQUIREMENTS OF SECTIONS 405, 415, AND 416 OF THE STATE HIGHWAY SPECIFICATIONS.
    - 4.2. CURING COMPOUND SHALL CONFORM TO SECTION 415 OF THE STATE HIGHWAY SPECIFICATIONS.
    - 4.3. CONTRACTOR SHALL PROVIDE A JOINTING PLAN TO ENGINEER IF NOT INCLUDED IN THE PLANS. CONTRACTOR SHALL PROVIDE CONTROL JOINTS AND CONSTRUCTION JOINTS OF ONE-QUARTER CONCRETE THICKNESS AT AN EQUAL RATIO OF LENGTH TO WIDTH WHEREVER POSSIBLE WITH A MAXIMUM LENGTH BETWEEN JOINTS OF 15' ON CENTER.
    - 4.4. CONTRACTOR SHALL PROVIDE EXPANSION JOINTS IN SIDEWALKS AT A MAXIMUM 100' APART.
      - 4.4.1. PLACE EXPANSION JOINTS IN CURB, GUTTER, OR CURB AND GUTTER CONSTRUCTION NEXT TO ASPHALTIC PAVEMENT. EXPANSION JOINTS IN CONCRETE SHALL BE LOCATED AT THE INTERSECTION OF CURB OR CURB AND GUTTER MEET, ON EACH SIDE OF EVERY INLET 3' FROM THE INLET, BUT NO CLOSER THAN 6' FROM ANOTHER JOINT, AND ON TANGENT SECTIONS PLACE BETWEEN 6' AND 300'.
    - 4.5. IF CONSTRUCTING CURB, GUTTER, OR CURB AND GUTTER NEXT TO, OR ON, CONCRETE PAVEMENT CONSTRUCTED WITH EXPANSION JOINTS, THEN PLACE EXPANSION JOINTS TO MATCH THE EXPANSION JOINT LOCATIONS IN THE PAVEMENT.
    - 4.7. FOR CURB AND GUTTER, FORM CONSTRUCTION JOINTS BY SAWING OR FORMING AN INDUCED PLANE OF WEAKNESS AT LEAST 2" DEEP IN THE CURB, GUTTER, OR CURB AND GUTTER JOINTS DIRECTLY OPPOSITE CONSTRUCTION OR CONSTRUCTION JOINTS IN ADJOINING CONCRETE PAVEMENT AND AT THE REQUIRED SPACING IN CURB, GUTTER, OR CURB AND GUTTER ADJOINING ASPHALTIC PAVEMENT. SPACE JOINTS BETWEEN AND APPROXIMATELY 22" APART.
    - 4.8. EXTERIOR CONCRETE SURFACES SHALL BE BROOM FINISHED.
    - 4.9. CONTRACTOR SHALL INSTALL TRUNKED DOME WARNING DETECTION FIELD SHALL BE PLACED AT ALL ADA RAMPS AS SPECIFIED ON PLANS AND IN ACCORDANCE WITH STATE AND FEDERAL REQUIREMENTS.
  5. PAVEMENT MARKING SPECIFICATIONS:
    - 5.1. ALL PARKING STALL MARKS SHALL BE 4" WIDE, HIGH VISIBILITY YELLOW LATEX PAINT.
    - 6. ALL PAVEMENT MARKINGS INCLUDING STOP BARS, CROSSWALKS, DIRECTIONAL ARROWS, PARKING STALL LINES, ADA STALL MARKINGS, NO PARKING ZONES, AND DROP-OFF/PICK-UP ZONES SHALL BE PAINTED WITH WHITE PAVEMENT SPECIFICATIONS.

CONSTRUCTION SEQUENCING

1. INSTALL PERMITTER SILT FENCE, WATTELS, INLET PROTECTION, AND CONSTRUCTION ENTRANCE.
2. STRIP AND STOCKPILE TOPSOIL AND INSTALL SILT FENCE AROUND PERIMETER OF STOCKPILE.
3. CONDUCT ROUGH GRADING EFFORTS AND INSTALL CHECK DAMS WITHIN DRAINAGE DITCHES.
4. INSTALL UTILITY PIPING AND STRUCTURES, IMMEDIATELY INSTALL INLET PROTECTION.
5. COMPLETE FINAL GRADING, INSTALLATION OF GRAVEL BASE COURSES, PLACEMENT OF CURBS, PAVEMENTS, WALKS, ETC.
6. PLACE TOPSOIL AND IMMEDIATELY STABILIZE DISTURBED AREAS WITH EROSION CONTROL MEASURES AS INDICATED ON PLANS.
7. EROSION CONTROLS SHALL NOT BE REMOVED UNTIL SITE IS FULLY STABILIZED OR 70% CONTIGUOUS VEGETATIVE COVER IS ESTABLISHED.

CONTRACTOR MAY MODIFY SEQUENCING AFTER ITEM NO. 1 AS NEEDED TO COMPLETE CONSTRUCTION IF EROSION CONTROLS ARE MAINTAINED IN ACCORDANCE WITH THE CONSTRUCTION SITE EROSION CONTROL REQUIREMENTS.

CITY FORESTRY NOTES

1. ALL PROPOSED STREET TREE REMOVALS WITHIN THE RIGHT OF WAY SHALL BE REVIEWED BY CITY FORESTRY BEFORE THE PLAN COMMISSION MEETING. STREET TREE REMOVALS REQUIRE APPROVAL AND A TREE REMOVAL PERMIT ISSUED BY CITY FORESTRY. ANY STREET TREE REMOVALS REQUESTED AFTER THE DEVELOPMENT PLAN IS APPROVED BY THE PLAN COMMISSION OR THE BOARD OF PUBLIC WORKS AND CITY FORESTRY WILL REQUIRE A MINIMUM OF A 72-HOUR REVIEW PERIOD WHICH SHALL INCLUDE THE NOTIFICATION OF THE ALDERPERSON WITHIN WHICH DISTRICT IS AFFECTED BY THE STREET TREE REMOVAL(S) PRIOR TO A TREE REMOVAL PERMIT BEING ISSUED.
2. AS DEFINED BY THE SECTION 107.13 OF CITY OF MADISON STANDARD SPECIFICATIONS FOR PUBLIC WORKS CONSTRUCTION: NO EXCAVATION IS PERMITTED WITHIN 5 FEET OF THE TRUNK OF THE STREET TREE OR WHEN CUTTING ROOTS OVER 3 INCHES IN DIAMETER. IF EXCAVATION IS NECESSARY, THE CONTRACTOR SHALL CONTACT MADISON CITY FORESTRY (268-4616) PRIOR TO EXCAVATION. CITY OF MADISON FORESTRY PERSONNEL SHALL ASSESS THE IMPACT TO THE TREE AND TO ITS ROOT SYSTEM PRIOR TO WORK COMMENCING. TREE PROTECTION SPECIFICATIONS CAN BE FOUND ON THE FOLLOWING WEBSITE: <https://www.cityofmadison.com/business/pwsp/pecs.cfm>
3. CONTRACTOR SHALL TAKE PRECAUTIONS DURING CONSTRUCTION TO NOT DISFIGURE, SCAR, OR IMPAIR THE HEALTH OF ANY STREET TREE. CONTRACTOR SHALL OPERATE EQUIPMENT IN A MANNER AS TO NOT DAMAGE THE BRANCHES OF THE STREET TREES. THIS MAY REQUIRE USING SMALLER EQUIPMENT AND LOADING AND UNLOADING MATERIALS IN A DESIGNATED SPACE AWAY FROM TREES ON THE CONSTRUCTION SITE. ANY DAMAGE OR INJURY TO EXISTING STREET TREES (EITHER ABOVE OR BELOW GROUND) SHALL BE REPORTED IMMEDIATELY TO CITY FORESTRY AT 268-4616. PENALTIES AND REMEDIATION SHALL BE REQUIRED.
4. SECTION 107.13(G) OF CITY OF MADISON STANDARD SPECIFICATIONS FOR PUBLIC WORKS CONSTRUCTION ADDRESSES SOIL COMPACTION NEAR STREET TREES AND SHALL BE FOLLOWED BY CONTRACTOR. THE STORAGE OF PARKED VEHICLES, CONSTRUCTION EQUIPMENT, BUILDING MATERIALS, REFUSE, EXCAVATED SPILLS OR DUMPS OF POISONOUS MATERIALS ON OR AROUND TREES AND ROOTS WITHIN FIVE (5) FEET OF THE TREE OR WITHIN THE PROTECTION ZONE IS PROHIBITED.
5. ON THIS PROJECT, STREET TREE PROTECTION ZONE FENCING IS REQUIRED. THE FENCING SHALL BE ERECTED BEFORE THE DEMOLITION, GRADING OR CONSTRUCTION BEGINS. THE FENCE SHALL INCLUDE THE ENTIRE WIDTH OF TERRACE AND EXTEND AT LEAST 5 FEET ON BOTH SIDES OF THE OUTSIDE EDGE OF THE TREE TRUNK. DO NOT REMOVE THE FENCING TO ALLOW FOR DELIVERIES OR EQUIPMENT ACCESS THROUGH THE TREE PROTECTION ZONE.
6. STREET TREE PRUNING SHALL BE COORDINATED WITH MADISON FORESTRY AT A MINIMUM OF TWO WEEKS PRIOR TO THE START OF CONSTRUCTION FOR THIS PROJECT. ALL PRUNING SHALL FOLLOW THE AMERICAN NATIONAL STANDARDS INSTITUTE (ANSI) A300 - PART 1 STANDARDS FOR PRUNING.
7. ADDITIONAL STREET TREES ARE NEEDED FOR THIS PROJECT. TREE PLANTING SPECIFICATIONS CAN BE FOUND IN SECTION 208 OF CITY OF MADISON STANDARD SPECIFICATIONS FOR PUBLIC WORKS CONSTRUCTION (WEBSITE: <https://www.cityofmadison.com/business/pwsp/pecs.cfm>) - ALL STREET TREE PLANTING LOCATIONS AND TREE SPECIES WITHIN THE RIGHT OF WAY SHALL BE DETERMINED BY CITY FORESTRY. A LANDSCAPE PLAN AND STREET TREE PLANTING PLAN SHALL BE SUBMITTED IN PDF FORMAT TO CITY FORESTRY FOR APPROVAL OF PLANTING LOCATIONS WITHIN THE RIGHT OF WAY AND TREE SPECIES. ALL AVAILABLE STREET TREE PLANTING LOCATIONS SHALL BE PLANTED WITHIN THE PROJECT BOUNDARIES.
8. AT LEAST ONE WEEK PRIOR TO STREET TREE PLANTING, CONTRACTOR SHALL CONTACT CITY FORESTRY AT (608) 268-4616 TO SCHEDULE INSPECTION AND APPROVAL OF NURSERY TREE STOCK AND REVIEW PLANTING SPECIFICATIONS WITH THE LANDSCAPER.

UTILITY NOTES

1. ALL EXISTING UTILITIES ARE SHOWN FOR INFORMATIONAL PURPOSES ONLY AND ARE NOT GUARANTEED TO BE ACCURATE OR ALL INCLUDE. THE CONTRACTOR IS RESPONSIBLE FOR MAKING THEIR OWN DETERMINATION AS TO THE TYPE AND LOCATIONS OF UNDERGROUND UTILITIES AS MAY BE NECESSARY TO AVOID DAMAGE THERETO. CONTRACTOR SHALL BE RESPONSIBLE FOR THE PROTECTION OF ALL UTILITIES PRIOR TO CONSTRUCTION.
2. PRIOR TO CONSTRUCTION, THE PRIME CONTRACTOR IS RESPONSIBLE FOR:
  - 2.1. EXAMINING ALL SITE CONDITIONS RELATIVE TO THE CONDITIONS INDICATED ON THE ENGINEERING DRAWINGS. ANY DISCREPANCIES ARE TO BE REPORTED TO THE ENGINEER AND RESOLVED PRIOR TO THE START OF CONSTRUCTION.
  - 2.2. OBTAINING ALL PERMITS INCLUDING PERMIT COSTS, TAP FEES, METER DEPOSITS, BONDS, AND ALL OTHER FEES PRIOR TO CONSTRUCTION.
  - 2.3. VERIFYING ALL ELEVATIONS, LOCATIONS, AND SIZES OF SANITARY, WATER, AND STORM LATERALS AND CHECK ALL UTILITY CROSSINGS FOR CONFLICTS. NOTIFY ENGINEER OF ANY DISCREPANCY. NO WORK SHALL BE PERFORMED UNTIL THE DISCREPANCY IS RESOLVED.
  - 2.4. NOTIFYING ALL UTILITIES PRIOR TO INSTALLATION OF ANY UNDERGROUND IMPROVEMENTS.
  - 2.5. DEPENDENT ON LOCAL JURISDICTION, THE CONTRACTOR SHALL BE RESPONSIBLE FOR THE START OF CONSTRUCTION TO ARRANGE FOR APPROPRIATE CONSTRUCTION OBSERVATION.
  - 2.6. COORDINATING ALL CONSTRUCTION WITH OTHER CONTRACTORS INVOLVED WITH CONSTRUCTION OF THE PROPOSED DEVELOPMENT AND FOR REPORTING ANY ERRORS OR DISCREPANCIES BETWEEN THESE PLANS AND PLANS PREPARED BY OTHERS.
3. ALL UTILITY WORK SHALL BE DONE IN ACCORDANCE WITH THE STANDARD SPECIFICATIONS FOR PUBLIC UTILITIES AND STATE DSPS/SPS AND LOCAL CODES AND SPECIFICATIONS. IT IS THE CONTRACTORS RESPONSIBILITY TO DETERMINE SPECIFICATIONS AND CODES APPLY, AND TO COORDINATE ALL CONSTRUCTION ACTIVITIES WITH THE APPROPRIATE JURISDICTIONAL AUTHORITIES.
4. SPECIFICATIONS SHALL COMPLY WITH THE JURISDICTIONAL AUTHORITY'S SPECIAL PROVISIONS.
5. LENGTHS OF ALL UTILITIES ARE TO CENTER OF STRUCTURES OR FITTINGS AND MAY VARY SLIGHTLY FROM PLANS. LENGTHS SHALL BE VERIFIED IN THE FIELD DURING CONSTRUCTION.
6. CONTRACTOR SHALL BE RESPONSIBLE FOR SITE SAFETY DURING THE CONSTRUCTION OF IMPROVEMENTS.
7. CONTRACTOR SHALL INSTALL A PEDESTRIAN FENCE AROUND ALL EXCAVATIONS TO BE LEFT OPEN OVERNIGHT AS REQUIRED IN CONSTRUCTION SITES WHERE THE POTENTIAL FOR PEDESTRIAN INJURY EXISTS.
8. CONTRACTOR SHALL ADJUST AND/OR RECONSTRUCT ALL UTILITY COVERS (SUCH AS MANHOLE COVERS, VALVE BOX COVERS, ETC.) TO MATCH THE FINISHED GRADE AND THE AREAS AFFECTED BY THE CONSTRUCTION.
9. ALL NON-METALLIC UTILITY PIPES (SANITARY SEWER, STORM SEWER, WATER PIPING) SHALL BE INSTALLED IN CONJUNCTION WITH TRACER WIRE (REQUIRED BY SPS 382.301(1)(b), SPS 382.387(1)(c), AND SPS 382.408(b)) COLOR OF TRACER WIRE SHALL BE: SANITARY SEWER - GREEN, STORM SEWER - BROWN, WATER - BLUE, NON-POSSIBLE WATER - RED.
10. DRY UTILITIES (COMMUNICATION, TELEPHONE, GAS, ELECTRIC, ETC.) ARE SHOWN FOR GENERAL ROUTING ONLY. CONTRACTOR SHALL COORDINATE DESIGN AND FINAL LOCATION WITH APPROPRIATE UTILITY COMPANY.
11. THE PRIME CONTRACTOR SHALL BE RESPONSIBLE FOR COORDINATING ALL CONSTRUCTION WITH OTHER CONTRACTORS INVOLVED WITH CONSTRUCTION OF THE PROPOSED DEVELOPMENT AND FOR REPORTING ANY ERRORS OR DISCREPANCIES BETWEEN THESE PLANS AND PLANS PREPARED BY OTHERS.
12. ANY SANITARY SEWER, SANITARY SEWER SERVICES, WATER MAIN, WATER SERVICES, STORM SEWER, OR OTHER UTILITIES, WHICH ARE DAMAGED BY THE CONTRACTORS, SHALL BE REPAIRED TO THE JURISDICTIONAL AUTHORITY'S SATISFACTION AT THE CONTRACTORS' EXPENSE.
13. THE CONTRACTOR IS RESPONSIBLE FOR PROVIDING THE ENGINEER WITH AS-BUILT CONDITIONS OF THE INSTALLED IMPROVEMENTS IN ORDER THAT THE APPROPRIATE DRAWINGS CAN BE PREPARED. IF REQUIRED, ANY CHANGES TO THE DRAWINGS OR ADDITIONAL ITEMS MUST BE REPORTED TO THE ENGINEER AS WORK PROGRESSES.
14. IN ANY LOCATIONS WHERE BUILDING SEWERS (STORM AND SANITARY) ARE INSTALLED WITH LESS THAN THE MINIMUM COVER AS SPECIFIED IN SPS 382.301(1)(c) OR WATER PIPING 382.408(a), CONTRACTOR SHALL INSTALL INSULATION IN ACCORDANCE WITH SPS 382.301(1)(c) FOR PROTECTION FROM FROST.
15. STORM SEWER SPECIFICATIONS:
  - 15.1. PIPE:
    - 15.1.1. REINFORCED CONCRETE PIPE (RCP) SHALL MEET THE REQUIREMENTS OF ASTM CLASS III (MINIMUM) OR WITH RUBBER GASKET JOINTS CONFORMING TO ASTM C443.
    - 15.1.2. HIGH DENSITY POLYETHYLENE CORRUGATED PIPE (HDPE) SHALL BE AS MANUFACTURED BY THE MANUFACTURER. ALL JOINTS SHALL BE GASKETED JOINTS AND SHALL MEET THE REQUIREMENTS OF DESIGNATION M294 TYPE "S".
  - 15.1.3. POLYVINYL CHLORIDE (PVC) SHALL MEET REQUIREMENTS OF ASTM D2034, SDR 35 FOR PIPE SIZES 8"-15" WITH INTEGRAL BELL TYPE FLEXIBLE ELECTROMETRIC JOINTS, MEETING THE REQUIREMENTS OF ASTM D2312, ASTM 1788 SCHEDULE 40 FOR PIPE DIAMETERS 4"-8", SDR 35 SHALL BE USED FOR DEPTHS 3'-15" AND SDR 26 FOR DEPTHS 16'-28" DEPENDENT ON LOCAL JURISDICTION.
  - 15.2. INLETS AND TRENCHES SHALL BE CONSTRUCTED IN ACCORDANCE WITH CHAPTER 3.5.3 AND DETAIL DRAWINGS FILE NO. 28 OR 28 OF THE STANDARD SPECIFICATIONS, OR APPROVED EQUIVALENT WITH A 2'X3' MAXIMUM OPENING.
  - 15.2.1. POLYVINYL CHLORIDE (PVC) INLETS BY NYLON LOST ONLY WHEN SPECIFIED ON PLANS, CONFORMING TO LATER PANT PER SPECIFICATIONS.
  - 15.2.2. MANHOLE FRAMES AND COVERS SHALL BE NEENAH R-1550, HEAVY DUTY WITH NON-ROCKING SOLID LID OR GRATE SPECIFICATION.
- 15.3. FRAME AND GRATES:
  - 15.3.2.1. CURB FRAME AND GRATES SHALL BE NEENAH R-3067 WITH TYPE "R" GRATE OR EQUAL, UNLESS AS SPECIFIED IN THE PLANS.
  - 15.3.2.2. SOLID LID FRAME AND GRATES SHALL BE NEENAH R-1550, HEAVY DUTY NON-ROCKING SOLID LID OR EQUAL, UNLESS AS SPECIFIED IN THE PLANS.
  - 15.3.2.3. CURB STOPS AND COVERS SHALL BE NEENAH R-1550, HEAVY DUTY WITH A R-2578 GRATE OR EQUAL, UNLESS AS SPECIFIED IN THE PLANS.
- 15.4. MANHOLES:
  - 15.4.1. MANHOLES SHALL BE CONSTRUCTED IN ACCORDANCE WITH CHAPTER 3.5.0 AND DETAIL DRAWINGS FILE NO. 11 AND/OR 12 OF THE STANDARD SPECIFICATIONS.
  - 15.4.2. MANHOLE FRAMES AND COVERS SHALL BE NEENAH R-1550, HEAVY DUTY NON-ROCKING SOLID LID OR EQUAL, UNLESS AS SPECIFIED IN THE PLANS.
- 15.5. BACKFILL AND BEDDING:
  - 15.5.1. STORM SEWER SHALL BE CONSTRUCTED WITH GRAVEL BACKFILL AND CLASS "B" BEDDING IN ALL PAVED AREAS AND TO A POINT 5' BEYOND THE EDGE OF PAVEMENT. TRENCHES RUNNING PARALLEL TO AND LESS THAN 6' FROM THE EDGE OF PAVEMENT SHALL ALSO REQUIRE GRAVEL BACKFILL.
  - 15.5.2. LANDSCAPED AREAS MAY BE BACKFILLED WITH EXCAVATED MATERIAL IN CONFORMANCE WITH SECTION 6.4.3.5 OF THE STANDARD SPECIFICATIONS.
- 15.6. FIELD TILE CONNECTIONS:
  - 15.6.1. ALL FIELD TILE ENCOUNTERED DURING CONSTRUCTION SHALL BE INCLUDED IN THE UNIT PRICE(S) FOR STORM SEWER. THE FIELD TILE ENCOUNTERED BY THE TRENCH SHALL BE REPLACED WITH THE SAME MATERIAL AS THE STORM SEWER.
16. WATER MAIN & WATER LATERAL SPECIFICATIONS:
  - 16.1. PIPE:
    - 16.1.1. DUCTILE IRON PIPE SHALL BE CLASS 52 CONFORMING TO AWWA C151 AND CHAPTER 8.1.8.0 OF THE STANDARD SPECIFICATIONS.
    - 16.1.2. POLYVINYL CHLORIDE PRESSURE PIPE (PVC) SHALL BE MANUFACTURED IN ACCORDANCE WITH AWWA C900 DRY (CLASS 305) FOR SIZES UP TO 4" AND AWWA C900 DR18 (CLASS 230) UP TO 30" WITH INTEGRAL ELASTOMERIC BELL AND SPIGOT JOINTS.
    - 16.1.3. COPPER TYPE "K" TUBING SHALL CONFORM TO ASTM DESIGNATION B88 FOR WATER SERVICES LESS THAN 2" IN DIAMETER.
    - 16.1.4. HIGH DENSITY POLYETHYLENE (HDPE) SHALL CONFORM TO THE REQUIREMENTS OF AWWA C901, SDR 9 MINIMUM FOR SIZES UP TO 3" AND TO AWWA C906, SDR 17 MINIMUM FOR SIZES GREATER THAN 3".
  - 17.2. VALVES AND VALVE BOXES:
    - 17.2.1. GATE VALVES SHALL BE AWWA GATE VALVES MEETING THE REQUIREMENTS OF AWWA C500 AND CHAPTER 8.2.7.0 OF THE STANDARD SPECIFICATIONS.
    - 17.2.2. CURB STOPS AND COVERS SHALL BE NEENAH R-1550, HEAVY DUTY WITH A R-2578 GRATE OR EQUAL, UNLESS AS SPECIFIED IN THE PLANS.
  - 17.3. WATER SERVICES CONNECTIONS:
    - 17.3.1. SERVICES 2" IN DIAMETER OR LESS SHALL USE A TAP SERVICE WITH A CORPORATION STOP AND CURB STOP VALVE WITH SERVICE BOX PER JURISDICTIONAL REQUIREMENTS.
    - 17.3.2. SERVICES GREATER THAN 2" IN DIAMETER SHALL USE A TAPPING SLEEVE OR CUT-IN TEE CONNECTION WITH VALVE OF EQUIVALENT PIPE DIAMETER AND VALVE BOX PER JURISDICTIONAL REQUIREMENTS.
  - 17.4. HYDRANTS:
    - 17.4.1. HYDRANTS SHALL CONFORM TO THE SPECIFICATIONS OF THE JURISDICTIONAL AUTHORITIES. THE DISTANCE FROM THE GROUND LINE TO THE CENTERLINE OF THE LOWEST NOZZLE AND THE LOWEST CONNECTION OF THE FIRE DEPARTMENT SHALL BE NO LESS THAN 15' AND NO GREATER THAN 23' (SEE DETAIL).
  - 17.5. JOINT RESTRAINT:
    - 17.5.1. WHERE SPECIFIED, DUCTILE IRON PIPE SHALL INCLUDE MECHANICAL JOINTS CONFORMING TO CHAPTER 4.4.2(b) OF THE STANDARD SPECIFICATIONS. POLYETHYLENE WRAP SHALL BE USED AROUND ALL MECHANICAL CONNECTIONS.
  - 17.6. BEDDING AND COVER MATERIAL:
    - 17.6.1. PIPE BEDDING AND COVER MATERIAL SHALL BE SAND, CRUSHED STONE CHIPS OR CRUSHED STONE SCREENINGS CONFORMING TO CHAPTER 8.4.3.2 OF THE STANDARD SPECIFICATIONS.
    - 17.6.2. BURY DEPTH SHALL CONFORM TO LOCAL JURISDICTION REQUIREMENTS, OR DSPS REQUIREMENTS AT A MINIMUM, WHERE THERE IS NO LOCAL JURISDICTION REQUIREMENTS.
  - 17.7. BACKFILL:
    - 17.7.1. BACKFILL MATERIAL AND INSTALLATION SHALL BE IN ACCORDANCE WITH CHAPTERS 2.6.0 AND 4.17.0 OF THE STANDARD SPECIFICATIONS. GRAVEL BACKFILL IS REQUIRED IN ALL PAVED AREAS AND TO A POINT 5' BEYOND THE EDGE OF PAVEMENT. TRENCHES RUNNING PARALLEL TO AND LESS THAN 6' FROM THE EDGE OF PAVEMENT SHALL ALSO REQUIRE GRAVEL BACKFILL.
    - 17.7.2. LANDSCAPED AREAS MAY BE BACKFILLED WITH EXCAVATED MATERIAL IN CONFORMANCE WITH SECTION 6.4.3.5 OF THE STANDARD SPECIFICATIONS.
  - 18. SEPARATION DISTANCES:
    - 18.1. WHERE PRIVATE WATER MAIN OR WATER SERVICES CROSSSES A SANITARY SEWER OR SANITARY LATERAL, THE WATER PIPE WITHIN 5 FEET OF THE CROSSING SHALL BE INSTALLED WITH THE FOLLOWING:
      - 18.1.1. WATER PIPING SHALL BE INSTALLED AT LEAST 12 INCHES ABOVE THE TOP OF SANITARY PIPING.
      - 18.1.2. WATER PIPING SHALL BE INSTALLED AT LEAST 18 INCHES BELOW THE BOTTOM OF SANITARY PIPING.

SANITARY SEWER SPECIFICATIONS

1. PIPE:
  - 1.1.1. POLYVINYL CHLORIDE (PVC) MEETING REQUIREMENTS OF ASTM D 3034, WITH INTEGRAL BELL TYPE FLEXIBLE ELASTOMERIC JOINTS, MEETING THE REQUIREMENTS OF ASTM D2312, ASTM 1788 SCHEDULE 40 FOR PIPE DIAMETERS 4"-8", SDR 35 SHALL BE USED FOR DEPTHS 3'-15' AND SDR 26 FOR DEPTHS 16'-25' DEPENDENT ON LOCAL JURISDICTION.
  - 1.1.2. CONNECTION TO DISMISSAL PIPE MATERIALS SHALL CONFORM TO CHAPTER 3.4.2 OF THE STANDARD SPECIFICATIONS. FENOCO COUPLER MAY BE USED WITH APPROVAL OF ENGINEER.
2. MANHOLES:
  - 2.1. MANHOLES SHALL BE CONSTRUCTED IN ACCORDANCE WITH CHAPTER 3.5.0 AND DETAIL DRAWINGS FILE NOS. 12, 13 AND 15 OF THE STANDARD SPECIFICATIONS AND SPECIAL PROVISIONS OF THE JURISDICTIONAL AUTHORITIES.
  - 2.2. MANHOLES SHALL HAVE INTERNAL CHIMNEY SEALS INSTALLED IN ALL SANITARY MANHOLES IN ACCORDANCE WITH CHAPTER 3.5.4(f) AND DETAIL DRAWING FILE NO. 12A OF THE STANDARD SPECIFICATIONS.
  - 2.3. MANHOLES SHALL HAVE ALL EXTERNAL JOINTS WRAPPED WITH MAC WARP OR EQUAL RUBBERIZED JOINT WRAP PER ASTM C923.
3. BEDDING AND COVER MATERIAL:
  - 3.1. MATERIAL SHALL CONFORM TO THE APPROPRIATE SECTIONS OF THE STANDARD SPECIFICATIONS WITH THE FOLLOWING MODIFICATION: "COVER MATERIAL SHALL BE THE SAME AS USED FOR BEDDING AND SHALL CONFORM TO SECTION 8.4.3.2 (A)."
  - 3.2. MATERIAL SHALL BE PLACED IN A MINIMUM OF THREE SEPARATE LIFTS, OR AS REQUIRED TO ENSURE ADEQUATE COMPACTION OF THESE MATERIALS, WITH ONE LIFT OF BEDDING MATERIAL ENDING AT OR NEAR THE SPRINGLINE OF THE PIPE. THE CONTRACTOR SHALL TAKE CARE TO COMPLETELY WORK BEDDING MATERIAL UNDER THE HAUNCH OF THE PIPE TO PROVIDE ADEQUATE SIDE SUPPORT."
4. BACKFILL:
  - 4.1. MATERIAL AND INSTALLATION SHALL BE IN ACCORDANCE CHAPTER 2.6.0 OF THE STANDARD SPECIFICATIONS. GRAVEL BACKFILL IS REQUIRED IN ALL PAVED AREAS AND TO A POINT 5' BEYOND THE EDGE OF PAVEMENT. TRENCHES RUNNING PARALLEL TO AND LESS THAN 6' FROM THE EDGE OF PAVEMENT SHALL ALSO REQUIRE GRAVEL BACKFILL.
  - 4.2. LANDSCAPED AREAS MAY BE BACKFILLED WITH EXCAVATED MATERIAL IN CONFORMANCE WITH SECTION 6.4.3.5 OF THE STANDARD SPECIFICATIONS.
5. SEEDING SPECIFICATIONS:
  - 5.1. TURF LAWN SEED MIXTURE: REFER TO LANDSCAPING PLAN FOR SEED MIXTURE.
  - 5.2. NO-MOW AREA SEED MIXTURE: NO-MOW LAWN SEED MIX, AS PROVIDED BY PRAIRIE NURSERY, P.O. BOX 306, WESTFIELD, WISCONSIN, 53984, TEL. 608-268-3679 (OR APPROVED EQUIVALENT). SEEDING RATE SHALL BE PER MANUFACTURER'S RECOMMENDATIONS.
6. SEED PREPARATION SPECIFICATIONS:
  - 6.1. SCARP SUBSOILS TO A DEPTH OF 3" WHERE TOPSOIL SHALL BE PLACED TO REPLACE COMPACTION.
  - 6.2. PLACE TOPSOIL AT A MINIMUM DEPTH OF 6" UNLESS OTHERWISE NOTED ON THE PLANS.
  - 6.3. APPLY FERTILIZER IN ACCORDANCE WITH SEED MIX MANUFACTURERS RECOMMENDATIONS.
  - 6.4. SOW SEED AT RATES SPECIFIED USING METHOD "A" OR METHOD "B" AS SPECIFIED IN SECTION 630 OF THE STATE HIGHWAY SPECIFICATIONS.
7. SEED MULCHING/EROSION MATTING SPECIFICATIONS:
  - 7.1. ALL SEEDED AREAS WITH SLOPES FLATTER THAN 4:1, UNLESS OTHERWISE NOTED ON THE PLANS, SHALL BE STABILIZED WITH WEED-FREE WHEAT STRAW MULCH WITH METHOD AND RATES IN ACCORDANCE WITH SECTION 627 OF THE STATE HIGHWAY SPECIFICATIONS.
  - 7.2. ALL SEEDED AREAS WITH SLOPES EQUAL TO OR STEEPER THAN 4:1, UNLESS OTHERWISE NOTED ON THE PLANS, SHALL BE STABILIZED WITH EROSION MATTING MATERIALS AS SPECIFIED ON THE PLANS. EROSION MATTING SHALL BE IN ACCORDANCE WITH SECTION 628 OF THE STATE HIGHWAY SPECIFICATIONS.

EROSION CONTROL NOTES

1. CONTRACTOR IS RESPONSIBLE TO NOTIFY ENGINEER OF RECORD AND OFFICIALS OF ANY CHANGES TO THE EROSION CONTROL AND STORMWATER MANAGEMENT PLANS.
2. ALL EROSION CONTROL MEASURES SHALL BE CONSTRUCTED AND MAINTAINED BY THE CONTRACTOR IN ACCORDANCE WITH WDMR TECHNICAL STANDARDS AND JURISDICTIONAL REQUIREMENTS. IT SHALL BE THE CONTRACTORS RESPONSIBILITY TO OBTAIN ALL NECESSARY PERMITS PRIOR TO CONSTRUCTION. REQUESTS FOR ANY ADDITIONAL EROSION CONTROL MEASURES WHICH MAY BE NECESSARY TO MEET UNFORESEEN FIELD CONDITIONS.
3. INSTALL PERIMETER EROSION CONTROL MEASURES (SUCH AS CONSTRUCTION ENTRANCES, SILT FENCE, AND EXISTING INLET PROTECTION) PRIOR TO ANY GRADING OR PAVING OF THE CONSTRUCTION SITE. MODIFICATIONS TO THE APPROVED EROSION CONTROL DESIGN IN ORDER TO MEET UNFORESEEN FIELD CONDITIONS IS ALLOWED IF MODIFICATIONS CONFORM TO WDMR TECHNICAL STANDARDS AND JURISDICTIONAL REQUIREMENTS. ALL MODIFICATIONS MUST BE APPROVED BY THE JURISDICTIONAL AUTHORITIES PRIOR TO DEVIATION OF THE APPROVED PLAN.
4. ADDITIONAL EROSION CONTROL MEASURES, AS REQUESTED BY JURISDICTIONS HAVING AUTHORITY AND/OR ENGINEER OF RECORD SHALL BE INSTALLED WITHIN 24 HOURS OF REQUEST.
5. INSPECTIONS AND MAINTENANCE OF ALL EROSION CONTROL MEASURES SHALL BE ROUTINE (ONCE PER WEEK MINIMUM) TO ENSURE PROPER FUNCTION OF EROSION CONTROL MEASURES AT ALL TIMES. EROSION CONTROL MEASURES ARE TO BE IN WORKING ORDER AT THE END OF EACH WORK DAY.
6. ALL EROSION AND SEDIMENT CONTROL ITEMS SHALL BE INSPECTED WITHIN 24 HOURS OF ALL RAIN EVENTS EXCEEDING 0.5". ANY DAMAGED EROSION CONTROL MEASURES SHALL BE REPAIRED OR REPLACED IMMEDIATELY UPON INSPECTION.
7. CONSTRUCTION ENTRANCES SHALL BE INSTALLED AT ALL LOCATIONS OF VEHICLE INGRESS/EGRESS POINTS. ADDITIONAL LOCATIONS OTHER THAN AS SHOWN ON THE PLANS MUST BE PRE-APPROVED BY THE JURISDICTION. CONSTRUCTION ENTRANCES SHALL BE 6' BY 10' LONG AND NO LESS THAN 12" THICK BY USE OF 3" SELECTED CRUSHED GRANULAR MATERIAL. CONSTRUCTION ENTRANCES SHALL BE MAINTAINED BY THE CONTRACTOR IN A CONDITION WHICH WILL PREVENT THE TRACKING OF MUD OR DRY SEDIMENT OFF-SITE AFTER EACH WORKING DAY OR MORE FREQUENTLY AS REQUIRED.
8. PAVED SURFACES ADJACENT TO CONSTRUCTION SITE VEHICLE ACCESS SHALL BE SWEEP AND/OR SCRAPPED TO REMOVE ACCUMULATED SOIL, DIRT, AND/OR DUST AFTER THE END OF EACH WORK DAY AND AS REQUESTED BY THE JURISDICTIONAL AUTHORITIES.
9. INLET PROTECTION SHALL BE IMMEDIATELY FITTED AT THE INLETS OF ALL INSTALLED STORM SEWER. STONE DITCH CHECKS FENCE SHALL BE IMMEDIATELY FITTED AT ALL INSTALLED CULVERT INLETS TO PREVENT SEDIMENT DEPOSITION WITHIN STORM SEWER SYSTEMS.
10. INSTALL EROSION CONTROLS ON THE DOWNSTREAM SIDE OF STOCKPILES. IF STOCKPILE REMAINS UNDISTURBED FOR MORE THAN SEVEN (7) DAYS, TEMPORARY SEEDING AND STABILIZATION IN ACCORDANCE WITH BEST MANAGEMENT PRACTICES IS REQUIRED. IF DISTURBED OCCURS BETWEEN NOVEMBER 15TH AND MAY 15TH, THE MULCHING SHALL BE REPLACED BY HYDRO-MULCHING WITH A TACKIFIER.
11. DITCH CHECKS AND APPLICABLE EROSION NETTING/MATTING SHALL BE INSTALLED IMMEDIATELY AFTER COMPLETION OF GRADING EFFORTS WITHIN DITCHES/SLOPES TO PREVENT SOIL TRANSPORTATION.
12. EROSION CONTROL FOR UTILITY CONSTRUCTION (STORM SEWER, SANITARY SEWER, WATER MAIN, ETC.):
  - 12.1. PLACE EXCAVATED TRENCH MATERIAL ON THE HIGH SIDE OF THE TRENCH.
  - 12.2. MULCHING SHALL BE INSTALLED IMMEDIATELY AFTER PIPE CONSTRUCTION.
  - 12.3. DISCHARGE TRENCH WATER INTO A SEDIMENTATION BASIN OR FILTERING TANK IN ACCORDANCE WITH THE WDMR DRAINAGE TECHNIQUE STANDARD NO. 1061 PRIOR TO RELEASE INTO THE STORM SEWER, RECEIVING STREAM, OR DRAINAGE DITCH.
13. ALL SLOPES 4:1 OR GREATER SHALL BE STABILIZED WITH CLASS 1 TYPE B EROSION MATTING PER STATE HIGHWAY SPECIFICATIONS, OR APPLICATION OF A WISDOT APPROVED POLYMER SOIL STABILIZATION TREATMENT OR A COMBINATION THEREOF AS REQUESTED BY ENGINEER. WITHIN SEVEN (7) DAYS OF GRADING, EROSION MATTING SHALL BE STABILIZED WITH CLASS II TYPE B EROSION MATTING PER STATE HIGHWAY SPECIFICATIONS. EROSION MATTING AND/OR NETTING USED ON-SITE SHALL BE INSTALLED IN ACCORDANCE WITH MANUFACTURERS GUIDELINES AND VENDOR SPECIFICATIONS 1052 AND 1053.
14. CONTRACTOR SHALL TAKE ALL NECESSARY STEPS TO CONTROL DUST ARISING FROM CONSTRUCTION OPERATIONS. REFER TO WDMR TECHNICAL STANDARD 1068.
15. A CONCRETE WASHOUT AREA SHALL BE DESIGNATED ON-SITE. CONTRACTOR SHALL USE PRE-MANUFACTURED ABOVE GROUND WASHOUT TOTE OR EQUIVALENT CONTAINMENT AREA FOR ALL CONCRETE WASTE. CONCRETE WASTE SHALL ONLY BE CONTAINED ABOVE WATER TIGHT JOINTS AND SHALL MEET THE REQUIREMENTS OF THE CONTAINMENT AREA AND IT SHALL BE THE RESPONSIBILITY OF THE CONTRACTOR TO FREQUENTLY DISPOSE OF SITE IN ACCORDANCE WITH LOCAL, STATE AND FEDERAL REQUIREMENTS TO MAINTAIN THE SYSTEMS EFFECTIVENESS.
16. STABILIZATION MEASURES SHALL BE INITIATED AS SOON AS PRACTICABLE IN PORTIONS OF THE SITE WHERE CONSTRUCTION ACTIVITIES HAVE TEMPORARILY OR PERMANENTLY CEASED. NO MORE THAN SEVEN (7) DAYS SHALL ELAPSE AFTER THE CONSTRUCTION ACTIVITY HAS CEASED.
  - 16.1. THE INITIATION STABILIZATION MEASURES BY THE SEVENTH (7) DAY AFTER CONSTRUCTION ACTIVITY HAS CEASED OR IS PRECLUDED BY SNOW COVER. IN THAT EVENT, STABILIZATION SHALL BE INITIATED AS SOON AS PRACTICABLE.
  - 16.2. CONSTRUCTION ACTIVITY WILL RESUME ON A PORTION OF THE SITE WITHIN FOURTEEN (14) DAYS FROM WHEN ACTIVITY CEASED. IF THE TOTAL TIME PERIOD THAT THE CONSTRUCTION ACTIVITY IS TEMPORARILY CEASED IS LESS THAN FOURTEEN (14) DAY, IN THAT EVENT, STABILIZATION MEASURES DO NOT HAVE TO BE INITIATED ON THAT PORTION OF THE SITE BY THE SEVENTH (7) DAY AFTER CONSTRUCTION ACTIVITY HAS TEMPORARILY CEASED.
- 16.3. STABILIZATION MEASURES SHALL BE DETERMINED BASED ON-SITE CONDITIONS WHEN CONSTRUCTION ACTIVITY HAS TEMPORARILY CEASED. STABILIZATION MEASURES SHALL BE DETERMINED BASED ON-SITE CONDITIONS AND LENGTH OF TIME THE MEASURE MUST BE EFFECTIVE. THE FOLLOWING ARE ACCEPTABLE STABILIZATION MEASURES:
  - 16.3.1. PERMANENT SEEDING, IN ACCORDANCE WITH APPROVED CONSTRUCTION SPECIFICATION.
  - 16.3.2. TEMPORARY SEEDING, WHICH CONSIST OF SPRING CLOVER (150 LBS/ACRE) IN SPRINGS/SUMMERS OR WHEAT OR CEREAL RYE (150 LBS/ACRE) IN FALL.
  - 16.3.3. MANHOLE FRAMES AND COVERS SHALL BE NEENAH R-1550, HEAVY



File: USDINC\project\2024\4414862\DWG\CD\Sheet\4414862 - C200.dwg Layout: C200 User: cadd\kenneth Printed: Sep 14, 2025 - 2:51pm Scale: As Shown

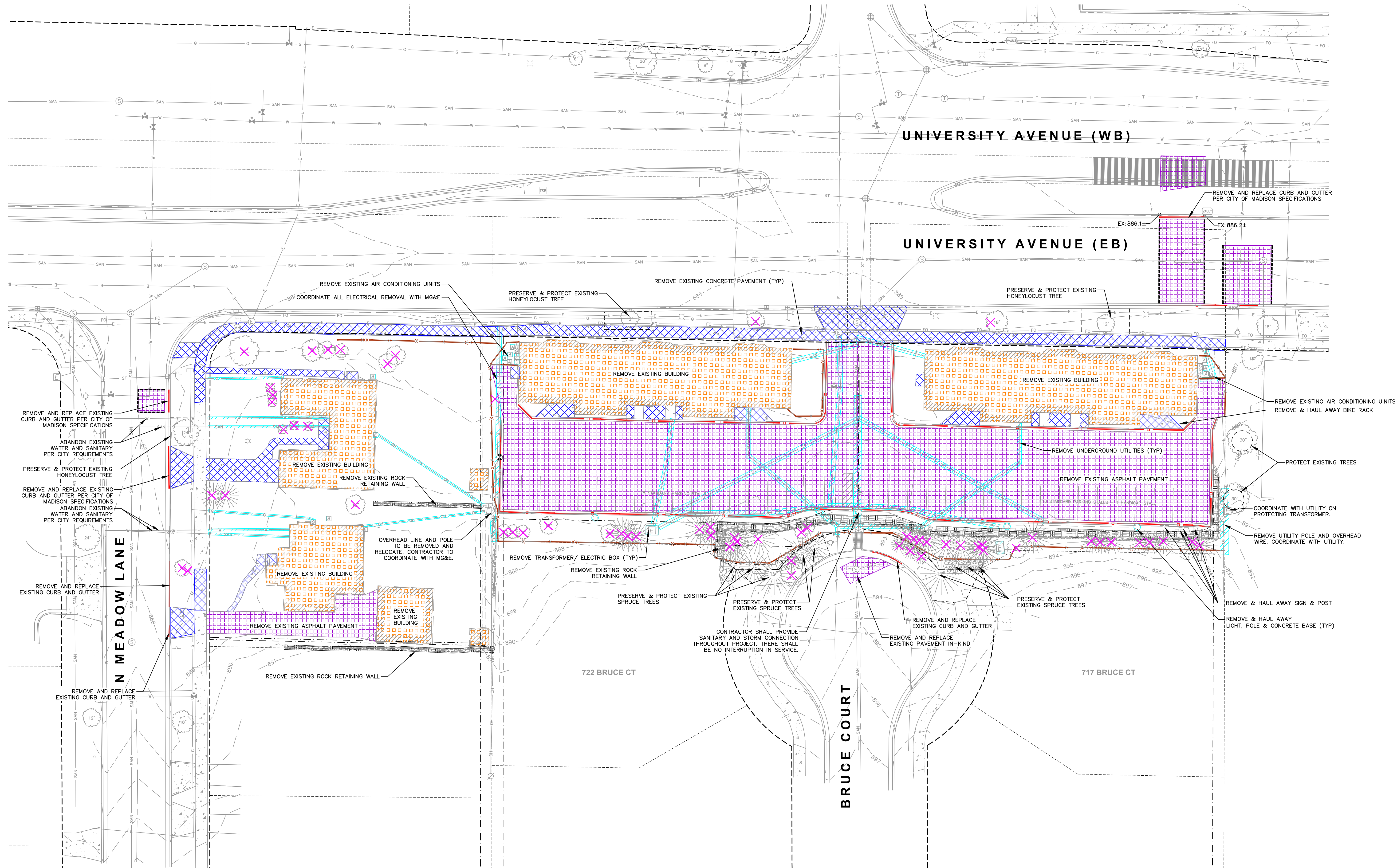

CURVE TABLE						
CURVE	LENGTH	RADIUS	TANGENT	DELTA	CHORD	CHORD BEARING
C-10	81.58'	44.00'	58.63	106°13'46"	70.39'	S89°51'52"W
C-11	81.58'	44.00'	58.63	106°13'46"	70.39'	S89°51'52"W
C-12	81.58'	44.00'	58.63	106°13'46"	70.39'	S89°51'52"W

CITY FORESTRY WILL ISSUE A STREET TREE REMOVAL PERMIT FOR (9) TREES: (6) UNMAINTAINED TREES AT BRUCE CT CUL-DE-SAC, (2) HONEYLOCUST ALONG UNIVERSITY AVE FOR BUILDING CLEARANCE, AND (1) PLANE TREE ALONG N MEADOW LN FOR DRIVEWAY INSTALLATION. THE CONTRACTOR SHALL CONTACT CITY FORESTRY AT (608) 266-4816 TO OBTAIN PERMIT.

LEGEND	
	PROPERTY LINE
	RIGHT-OF-WAY
	EASEMENT LINE
	DEMOLITION - REMOVAL OF ONSITE CURB SURFACES AND BASE COURSE
	DEMOLITION - REMOVAL OF RETAINING WALL
	DEMOLITION - REMOVAL OF ASPHALT SURFACES
	DEMOLITION - REMOVAL OF CONCRETE SURFACES
	DEMOLITION - REMOVAL OF BUILDINGS/STRUCTURES
	DEMOLITION - REMOVAL OF UTILITIES
	DEMOLITION - REMOVAL OF FENCE
	TREE REMOVAL
	PROTECT EXISTING TREE

CREATE THE VISION TELL THE STORY

jsdinc.com

MADISON REGIONAL OFFICE  
507 WEST VERONA AVENUE, SUITE 500  
VERONA, WISCONSIN 53593  
P. 608.848.5060

CLIENT:  
**UNIVERSITY 3000, LLC**

CLIENT ADDRESS:  
**1741 COMMERCIAL AVENUE  
MADISON, WI 53704**

PROJECT:  
**UNIVERSITY 3000  
MIXED-USE**

PROJECT LOCATION:  
**3535 UNIVERSITY AVENUE  
MADISON, WI 53705**

**NOT FOR  
CONSTRUCTION**

#	Date	Description
1	03.17.2025	LAND USE AND UDC SUBMITTAL
2	07.18.2025	SITE PLAN VERIFICATION
3	08.16.2025	PERMIT SET
4	08.29.2025	PERMIT SET
5	09.04.2025	DOORWAYS
6		
7		
8		
9		
10		
11		
12		
13		
14		
15		

Designed By: CNG  
Reviewed By: ACC  
Approved By: ACC

SHEET TITLE:  
**DEMOLITION PLAN**

SHEET NUMBER:  
**C200**

JSD PROJECT NO: 24-14862

THE RIGHT OF WAY IS THE SOLE JURISDICTION OF THE CITY OF MADISON AND IS SUBJECT TO CHANGE AT ANY TIME PER THE RECOMMENDED PLAN BY TRAFFIC ENGINEERING AND CITY ENGINEERING DEPARTMENT

ALL PROPOSED IMPROVEMENTS WITHIN THE PUBLIC RIGHT-OF-WAY OR CONNECTIONS TO CITY OWNED UTILITIES SHALL BE COMPLETED PER THE CITY ISSUED IMPROVEMENTS PLAN (CONTRACT NO. 9676, PROJECT NO. 15902)

SCALE IN FEET

Toll Free (800) 242-8511



File: USDINC\project\2024\241482\DWG\Civil\Sheet\241482\_C300.dwg Layout: C300 User: cadda\lennette Printed: Sep 14, 2025 - 2:51pm PltFr: 1

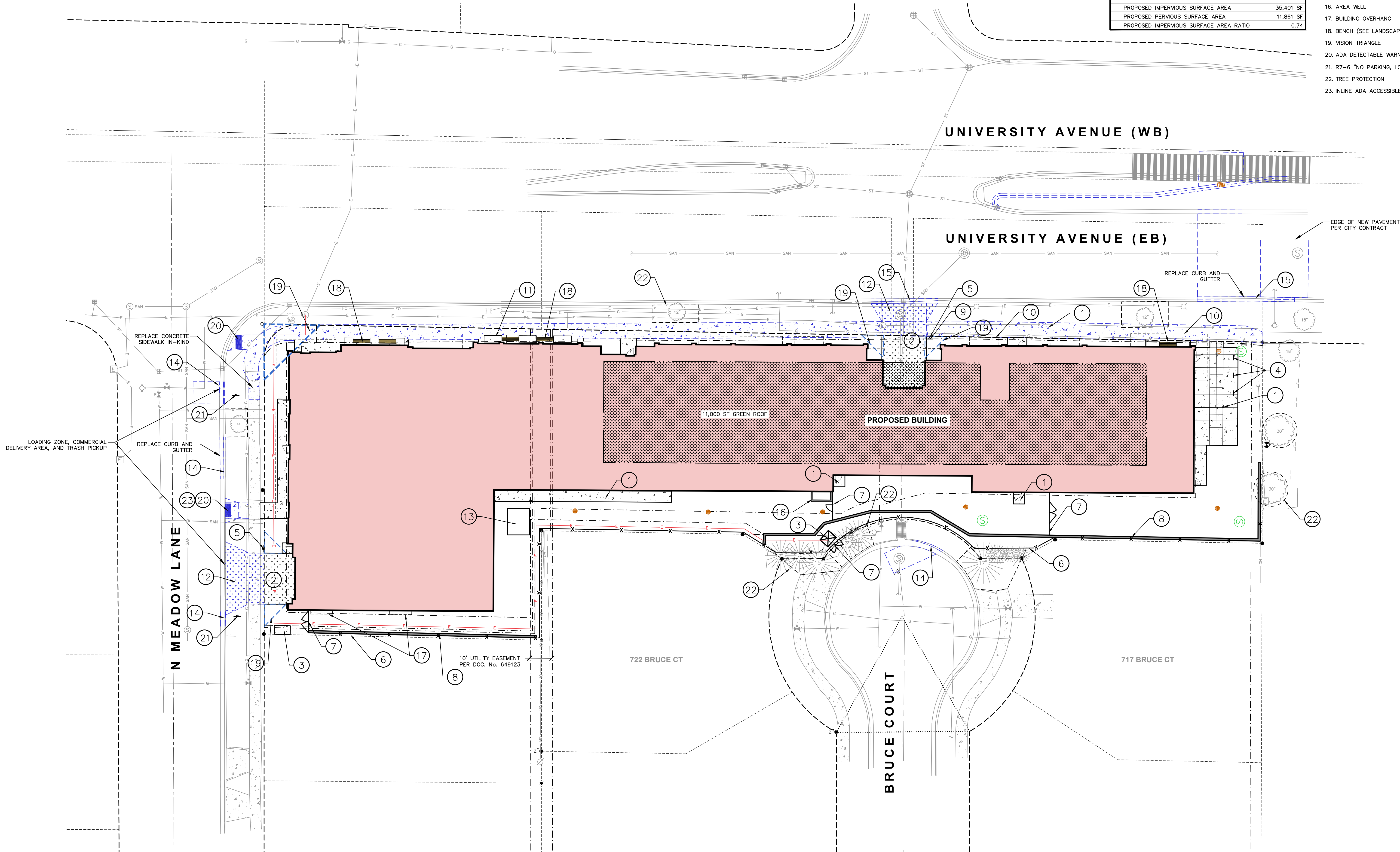

SITE INFORMATION BLOCK	
SITE ADDRESS	3535 UNIVERSITY AVE
PROPERTY ACREAGE	1.09 ACRES ACRES
NUMBER OF BUILDING STORIES	5
TOTAL BUILDING SQUARE FOOTAGE	30,982 SF
GREEN ROOF SQUARE FOOTAGE	11,000 SF
NUMBER OF PARKING STALLS	0
UNDERGROUND	166
ACCESSIBLE	6
TOTAL UNDERGROUND	172
NUMBER OF SURFACE BICYCLE STALLS:	6
NUMBER OF UNDERGROUND BICYCLE STALLS:	167
EXISTING VS. PROPOSED SITE COVERAGE	
EXISTING IMPERVIOUS SURFACE AREA	28,163 SF
EXISTING PERVIOUS SURFACE AREA	19,099 SF
EXISTING IMPERVIOUS SURFACE AREA RATIO	0.60
PROPOSED IMPERVIOUS SURFACE AREA	35,401 SF
PROPOSED PERVIOUS SURFACE AREA	11,861 SF
PROPOSED IMPERVIOUS SURFACE AREA RATIO	0.74

- KEYNOTES**
1. CONCRETE SIDEWALK (REFER TO DETAIL)
  2. COMMERCIAL ENTRANCE CONCRETE PAVEMENT (REFER TO DETAIL)
  3. TRANSFORMER PAD
  4. BIKE RACK
  5. R1-1 STOP SIGN
  6. 6' FENCE (SEE DETAIL)
  7. 4' VINYL COATED CHAIN LINK FENCE WITH GATE (SEE DETAIL)
  8. EARTH RETENTION SYSTEM, I BEAM AND LAGGING BY CONTRACTOR. PERMANENT, ABOVE GROUND PORTION. (SEE LANDSCAPE PLAN FOR COVERING)
  9. R3-2 "NO LEFT TURN 7-9 AM, 4-6 PM" SIGN
  10. BUILDING AWNING
  11. PLANTER BOX
  12. COMMERCIAL ENTRANCE PER CITY DETAIL
  13. GENERATOR PAD
  14. CURB AND GUTTER, 30" TYPE 'A' PER CITY DETAIL
  15. CURB AND GUTTER, 30" TYPE 'H' PER CITY DETAIL
  16. AREA WELL
  17. BUILDING OVERHANG
  18. BENCH (SEE LANDSCAPE PLAN)
  19. VISION TRIANGLE
  20. ADA DETECTABLE WARNING FIELD
  21. R7-6 "NO PARKING, LOADING ZONE"
  22. TREE PROTECTION
  23. INLINE ADA ACCESSIBLE RAMP



CREATE THE VISION TELL THE STORY

jsdinc.com

**MADISON REGIONAL OFFICE**  
507 WEST VERONA AVENUE, SUITE 500  
VERONA, WISCONSIN 53593  
P. 608.848.5060

CLIENT:  
**UNIVERSITY 3000, LLC**

CLIENT ADDRESS:  
**1741 COMMERCIAL AVENUE  
MADISON, WI 53704**

PROJECT:  
**UNIVERSITY 3000  
MIXED-USE**

PROJECT LOCATION:  
**3535 UNIVERSITY AVENUE  
MADISON, WI 53705**

**NOT FOR  
CONSTRUCTION**

#	Date:	Description:
1	03.17.2025	LAND USE AND UDC SUBMITTAL
2	07.18.2025	SITE PLAN VERIFICATION
3	08.18.2025	PERMIT SET
4	08.29.2025	PERMIT SET
5	09.04.2025	DOORWAYS
6		
7		
8		
9		
10		
11		
12		
13		
14		
15		

Designed By: CHG  
Reviewed By: ACC  
Approved By: ACC

SHEET TITLE:  
**ANNOTATED SITE PLAN**

SHEET NUMBER:  
**C300**

JSD PROJECT NO: 24-1482

THE RIGHT OF WAY IS THE SOLE JURISDICTION  
OF THE CITY OF MADISON AND IS SUBJECT TO  
CHANGE AT ANY TIME PER THE RECOMMENDED  
PLAN BY TRAFFIC ENGINEERING AND CITY  
ENGINEERING DEPARTMENT

ALL PROPOSED IMPROVEMENTS WITHIN THE  
PUBLIC RIGHT-OF-WAY OR CONNECTIONS  
TO CITY OWNED UTILITIES SHALL BE  
COMPLETED PER THE CITY ISSUED  
IMPROVEMENTS PLAN (CONTRACT NO.  
9676, PROJECT NO. 15902)

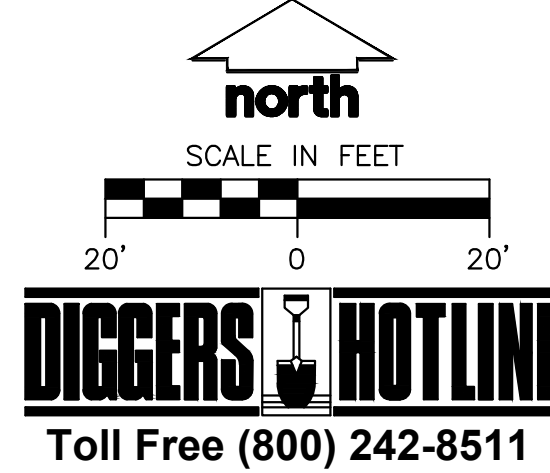



File: USDINC\project\2024\4414862\DWG\Sheet\4414862 - ConfDocs.dwg Layout: C301 User: cadda\humble Printed: Sep 14, 2025 - 2:51pm Scale: 1/8"=1'-0"

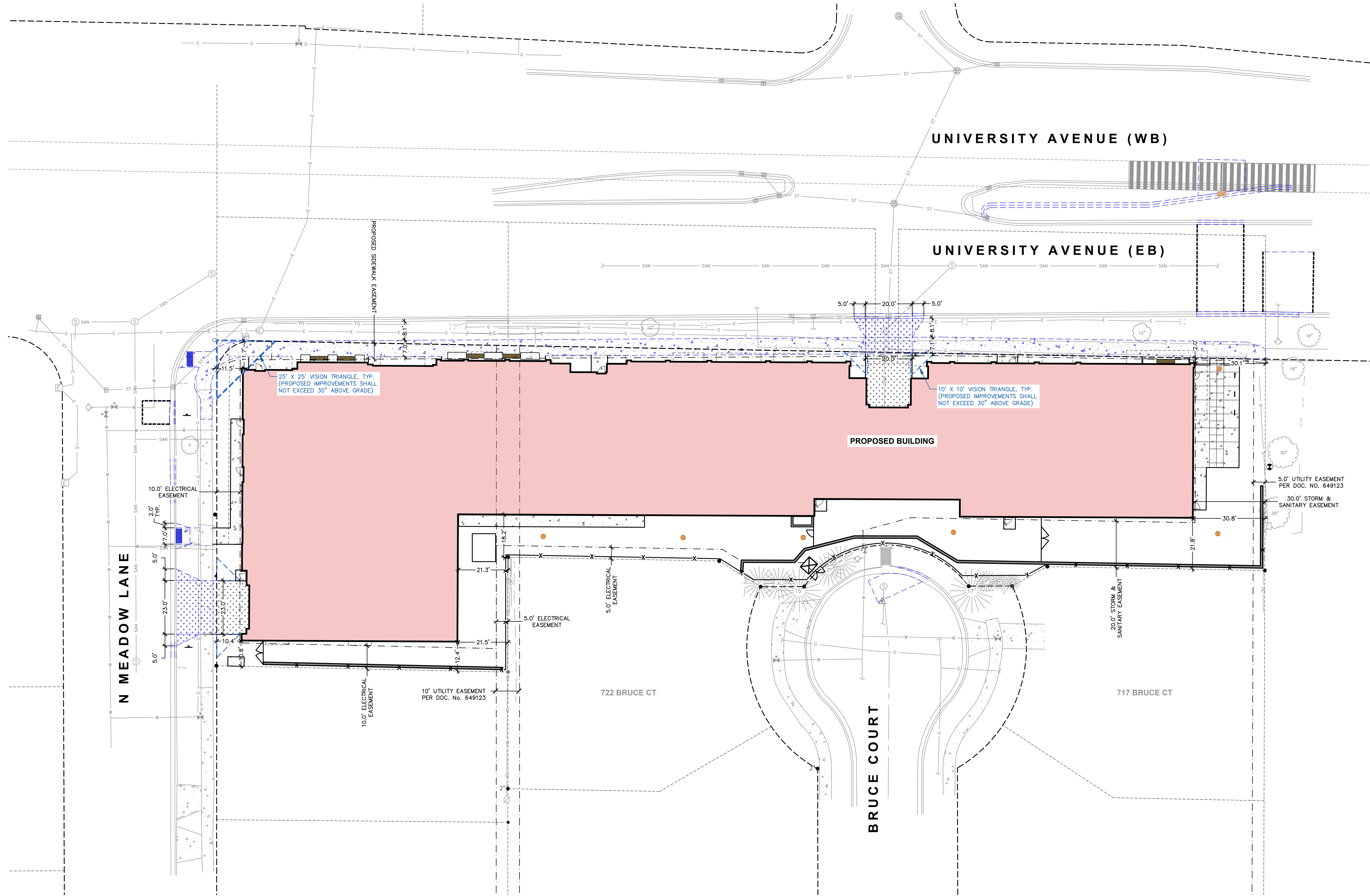

THE RIGHT OF WAY IS THE SOLE JURISDICTION OF THE CITY OF MADISON AND IS SUBJECT TO CHANGE AT ANY TIME PER THE RECOMMENDED PLAN BY TRAFFIC ENGINEERING AND CITY ENGINEERING DEPARTMENT

ALL PROPOSED IMPROVEMENTS WITHIN THE PUBLIC RIGHT-OF-WAY OR CONNECTIONS TO CITY OWNED UTILITIES SHALL BE COMPLETED PER THE CITY ISSUED IMPROVEMENTS PLAN (CONTRACT NO. 9676, PROJECT NO. 15902)

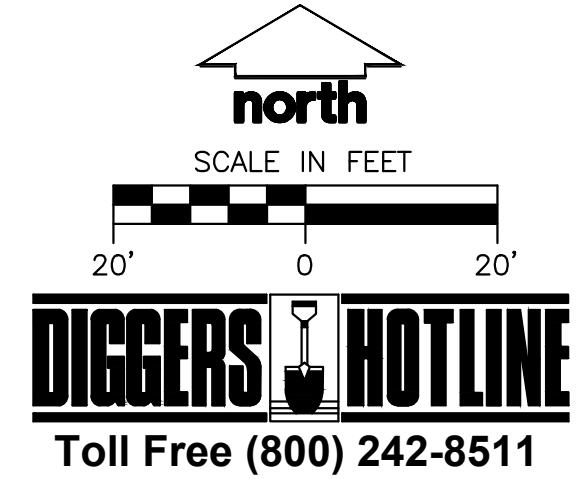

jsdinc.com

MADISON REGIONAL OFFICE  
507 WEST VERONA AVENUE, SUITE 500  
VERONA, WISCONSIN 53593  
P. 608.848.5060

CLIENT:  
UNIVERSITY 3000, LLC

CLIENT ADDRESS:  
1741 COMMERCIAL AVENUE  
MADISON, WI 53704

PROJECT:  
UNIVERSITY 3000  
MIXED-USE

PROJECT LOCATION:  
3535 UNIVERSITY AVENUE  
MADISON, WI 53705

**NOT FOR CONSTRUCTION**

#	Date	Description
1	03.17.2025	LAND USE AND UDC SUBMITTAL
2	07.18.2025	SITE PLAN VERIFICATION
3	08.18.2025	PERMIT SET
4	08.29.2025	PERMIT SET
5	09.04.2025	DOORWAYS
6		
7		
8		
9		
10		
11		
12		
13		
14		
15		

Designed By: CHG  
Reviewed By: ACC  
Approved By: ACC

SHEET TITLE:  
DIMENSIONED SITE PLAN

SHEET NUMBER:  
**C301**

JSD PROJECT NO: 24-14862

THESE PLANS AND DESIGNS ARE COPYRIGHT PROTECTED AND MAY NOT BE USED IN WHOLE OR IN PART WITHOUT THE WRITTEN CONSENT OF JSD PROFESSIONAL SERVICES, INC.



PLAN MODIFICATIONS:		
#	Date:	Description:
1	03.17.2025	LAND USE AND UDC SUBMITTALS
2	07.18.2025	SITE PLAN VERIFICATION
3	08.18.2025	PERMIT SET
4	08.29.2025	PERMIT SET
5	09.04.2025	DOORWAYS
6		
7		
8		
9		
10		
11		
12		
13		
14		
15		

Designed By:	CH
Reviewed By:	AC
Approved By:	AC

SHEET TITLE:  
**GRADING PLAN**

DATE RECEIVED

\_\_\_\_\_

\_\_\_\_\_

\_\_\_\_\_

**SHEET NUMBER:**

## C400

## C400

ISD PROJECT NO: 24-1496

JSD PROJECT NO: 24-1496

File: \\SPINC\projects\2024\2414962\DWG\Civil Sheets\2414962 - ConDocs.dwg Layout: C400 User: cade femrite Plotted: Sep 04, 2025 - 2:51pm Xrefs:

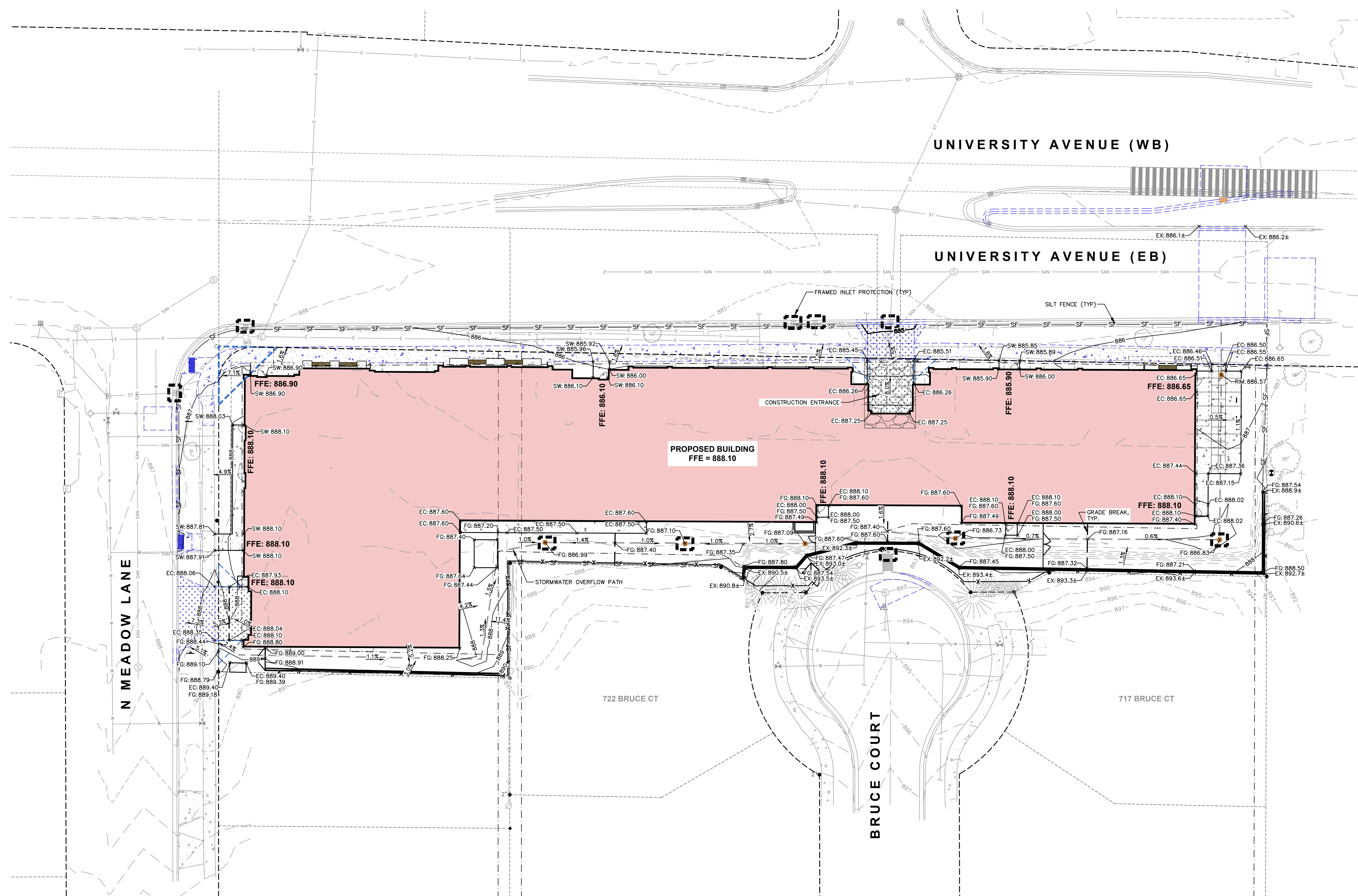

THE RIGHT OF WAY IS THE SOLE JURISDICTION  
OF THE CITY OF MADISON AND IS SUBJECT TO  
CHANGE AT ANY TIME PER THE RECOMMENDED  
PLAN BY TRAFFIC ENGINEERING AND CITY  
ENGINEERING DEPARTMENT

ALL PROPOSED IMPROVEMENTS WITHIN THE PUBLIC RIGHT-OF-WAY OR CONNECTIONS TO CITY OWNED UTILITIES SHALL BE COMPLETED PER THE CITY ISSUED IMPROVEMENTS PLAN (CONTRACT NO. 9676, PROJECT NO. 15902)





File: USDINC\projects\2024\4414862\DWG\Sheet\Sheet0414862 - Conflicts.dwg Layout: C500 User: cadd\kenneth Printed: Sep 14, 2025 - 2:52pm Scale:

PROPOSED STORM SEWER STRUCTURE TABLE					
LABEL	RIM EL. (FT)	INVERT EL. (FT)	DEPTH (FT)	STRUCTURE DESC.	FRAME & GRATE
STO CB A-2	886.83	N INV: 880.64 (24") W INV: 880.74 (24")	6.2	60 IN MH (FLAT)	R-2050 TYPE D
STO CB A-3	886.73	E INV: 881.53 (24") W INV: 881.63 (24")	5.2	60 IN MH (FLAT)	R-2050 TYPE D
STO CB A-4	897.66	E INV: 891.84 (24") N INV: 891.85 (18") W INV: 882.34 (18")	15.8	56"x42" MH	EXISTING CURB INLET
STO CB A-5	887.09	E INV: 882.59 (18") W INV: 882.69 (18")	4.5	48 IN MH (FLAT)	R-2050 TYPE D
STO CB A-6	887.10	E INV: 883.05 (18") W INV: 883.15 (18")	4.0	36 IN MH (FLAT)	R-2050 TYPE D
STO CB A-7	886.99	E INV: 883.50 (18")	3.5	36 IN MH (FLAT)	R-2050 TYPE D
STO MH A	886.44	E INV: 872.72 (144") S INV: 879.52 (24") W INV: 872.72 (144")	13.7	48 IN MH (FLAT)	R-3067 TYPE L
STO MH A-1	886.57	N INV: 880.04 (24") S INV: 880.14 (24")	6.5	48 IN MH (FLAT)	R-2050 TYPE D

PROPOSED STORM SEWER PIPE TABLE							
LABEL	FROM	TO	LENGTH	INVERT EL. (FT)	DISCHARGE EL. (FT)	SLOPE	SIZE & MATERIAL
STO A-1	STO MH A-1	STO MH A	76'	880.04	879.52	0.68%	24 IN RCP
STO A-2	STO CB A-2	STO MH A-1	71'	880.64	880.14	0.70%	24 IN RCP
STO A-3	STO CB A-3	STO CB A-2	113'	881.53	880.74	0.70%	24 IN HDPE (HP)
STO A-4	STO CB A-4	STO CB A-3	30'	881.84	881.63	0.70%	24 IN RCP
STO A-5	STO CB A-5	STO CB A-4	36'	882.59	882.34	0.70%	18 IN RCP
STO A-6	STO CB A-6	STO CB A-5	52'	883.05	882.69	0.70%	18 IN HDPE
STO A-7	STO CB A-7	STO CB A-6	60'	883.50	883.15	0.58%	18 IN HDPE

PROPOSED SANITARY SEWER STRUCTURE TABLE					
LABEL	RIM EL. (FT)	INVERT EL. (FT)	DEPTH (FT)	STRUCTURE DESC.	FRAME & GRATE
EX SAN MH A	890.54	E INV: 870.66 (24") SW INV: 872.57 (8") W INV: 870.67 (24")	19.9	48 IN MH	R-1550 SOLID LID
EX SAN MH A-4	892.41	NE INV: 884.50 (8") S INV: 884.60 (8")	7.4	48 IN MH	R-1550 SOLID LID
SAN MH A-1	886.68	NE INV: 873.59 (8") S INV: 874.09 (8")	13.1	48 IN MH	R-1550 SOLID LID
SAN MH A-2	887.65	N INV: 875.62 (8") W INV: 877.45 (8")	12.2	48 IN MH	R-1550 SOLID LID
SAN MH A-3	887.14	E INV: 879.77 (8") SW INV: 881.67 (8")	7.5	48 IN MH	R-1550 SOLID LID

PROPOSED SANITARY SEWER PIPE TABLE							
LABEL	FROM	TO	LENGTH	INVERT EL. (FT)	DISCHARGE EL. (FT)	SLOPE	SIZE & MATERIAL
SAN A-1	SAN MH A-1	EX SAN MH A	51'	873.59	872.57	2.00%	8 IN PVC
SAN A-2	SAN MH A-2	SAN MH A-1	77'	875.62	874.09	2.00%	8 IN PVC
SAN A-3	SAN MH A-3	SAN MH A-2	116'	879.77	877.45	2.00%	8 IN PVC
SAN A-4	EX SAN MH A-4	SAN MH A-3	41'	884.50	881.67	6.85%	8 IN PVC
SAN B-1	BUILDING	EX SAN MH B-2	34'	878.62	878.28	1.00%	8 IN PVC

\*PUBLIC STORMWATER BOX CULVERT & PIPE ELEVATIONS TO BE DETERMINED

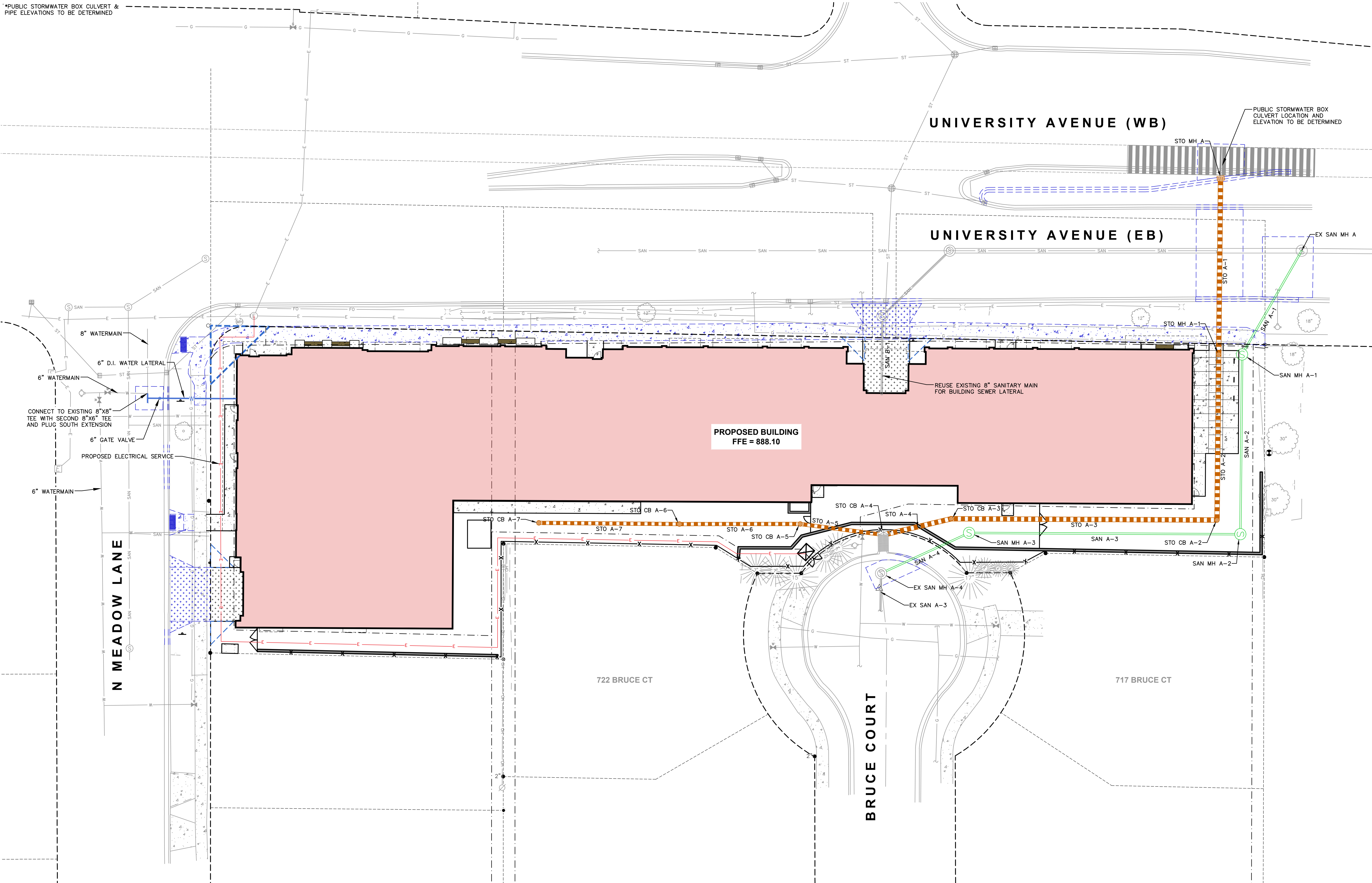

THE RIGHT OF WAY IS THE SOLE JURISDICTION OF THE CITY OF MADISON AND IS SUBJECT TO CHANGE AT ANY TIME PER THE RECOMMENDED PLAN BY TRAFFIC ENGINEERING AND CITY ENGINEERING DEPARTMENT

ALL PROPOSED IMPROVEMENTS WITHIN THE PUBLIC RIGHT-OF-WAY OR CONNECTIONS TO CITY OWNED UTILITIES SHALL BE COMPLETED PER THE CITY ISSUED IMPROVEMENTS PLAN (CONTRACT NO. 9676, PROJECT NO. 15902)



CREATE THE VISION TELL THE STORY

jsdinc.com

MADISON REGIONAL OFFICE  
507 WEST VERONA AVENUE, SUITE 500  
VERONA, WISCONSIN 53593  
P. 608.848.5060

CLIENT:  
UNIVERSITY 3000, LLC

CLIENT ADDRESS:  
1741 COMMERCIAL AVENUE  
MADISON, WI 53704

PROJECT:  
UNIVERSITY 3000  
MIXED-USE

PROJECT LOCATION:  
3535 UNIVERSITY AVENUE  
MADISON, WI 53705

NOT FOR  
CONSTRUCTION

#	Date:	Description:
1	03.17.2025	LAND USE AND UDC SUBMITTAL
2	07.18.2025	SITE PLAN VERIFICATION
3	08.18.2025	PERMIT SET
4	08.29.2025	PERMIT SET
5	09.04.2025	DOORWAYS
6		
7		
8		
9		
10		
11		
12		
13		
14		
15		

Designed By: CHG  
Reviewed By: ACC  
Approved By: ACC

SHEET TITLE:  
UTILITY PLAN

SHEET NUMBER:  
C500

JSD PROJECT NO: 24-14962

THESE PLANS AND DESIGNS ARE COPYRIGHT PROTECTED AND MAY NOT BE USED IN WHOLE OR IN PART WITHOUT THE WRITTEN CONSENT OF JSD PROFESSIONAL SERVICES, INC.



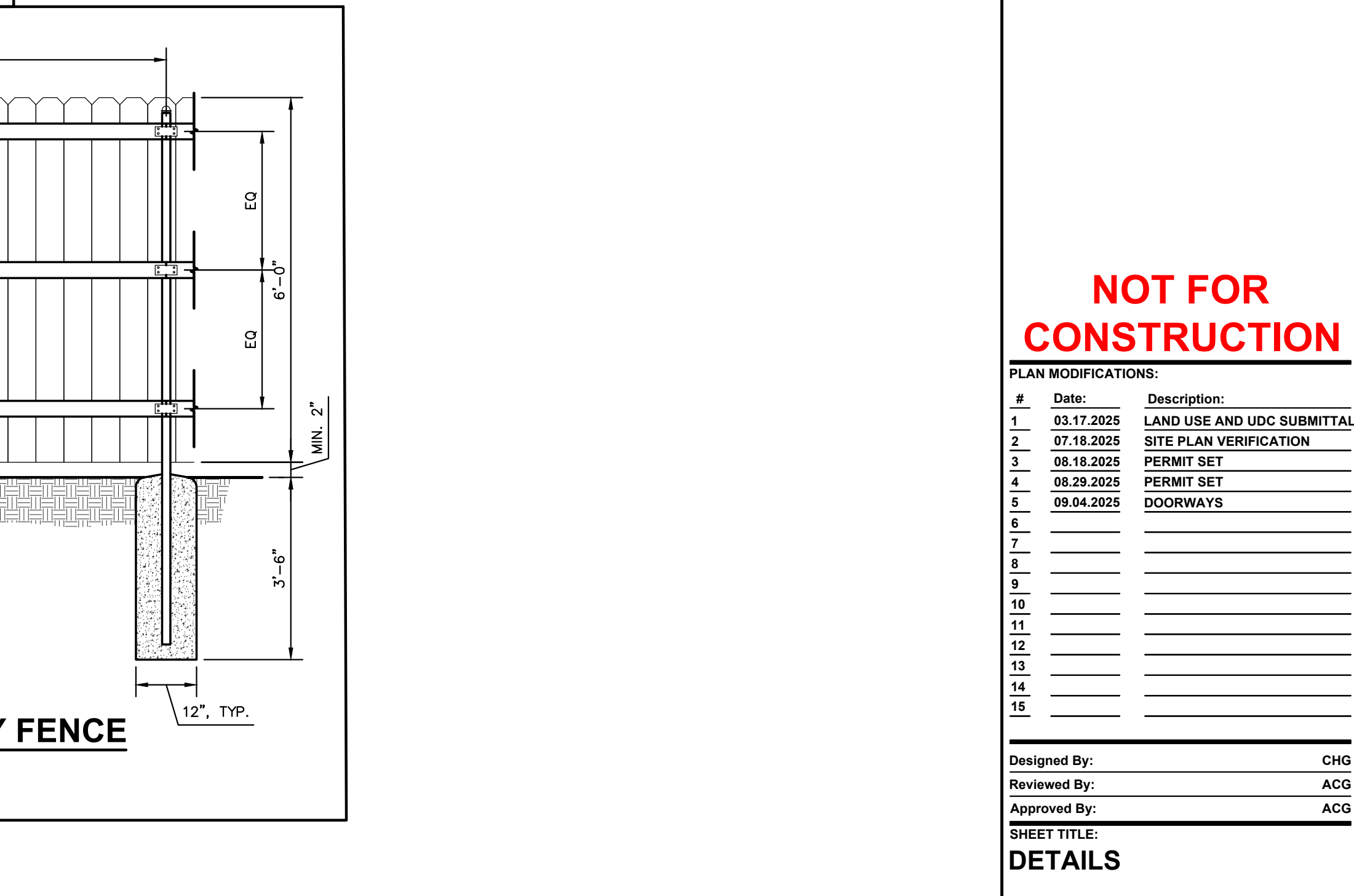
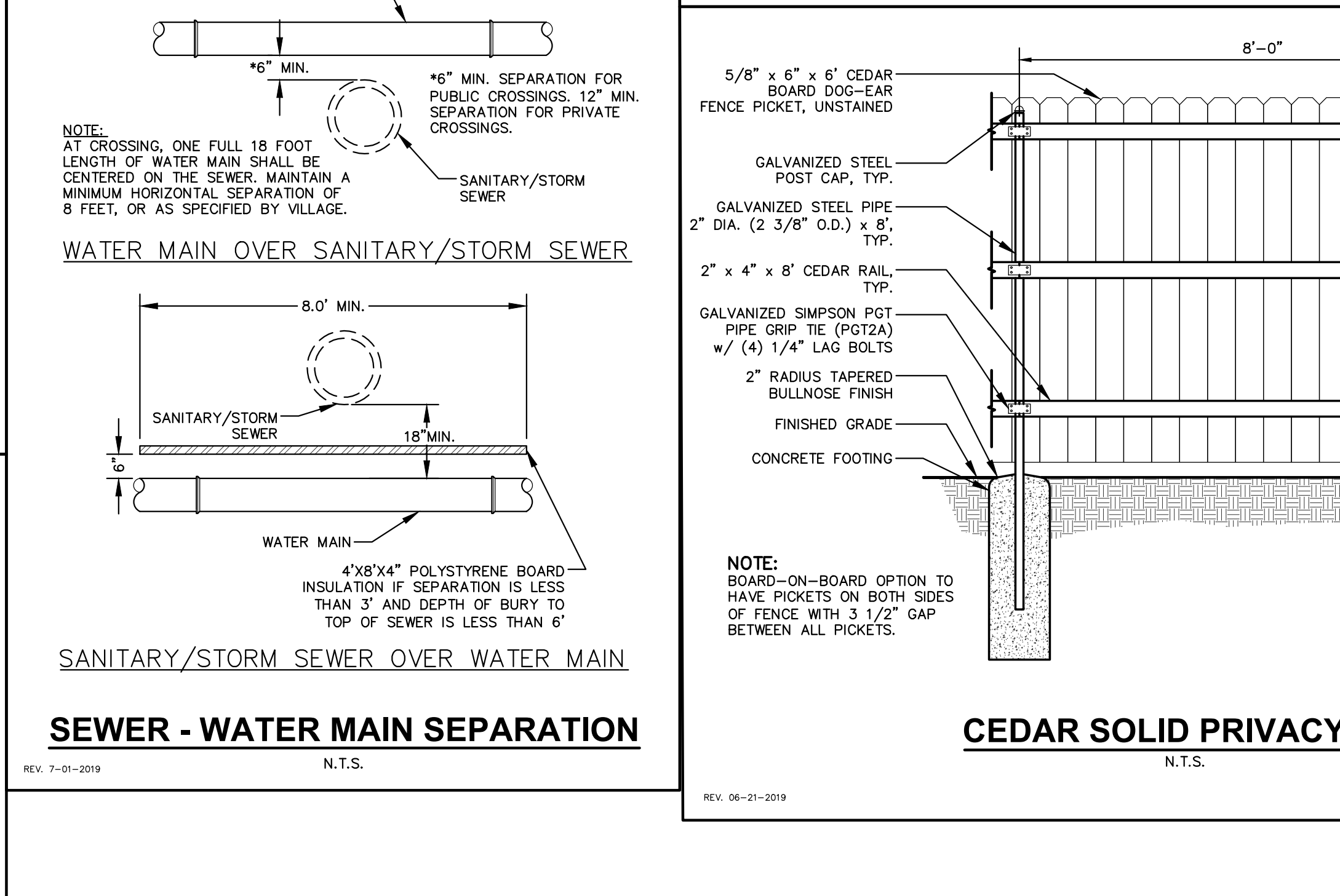
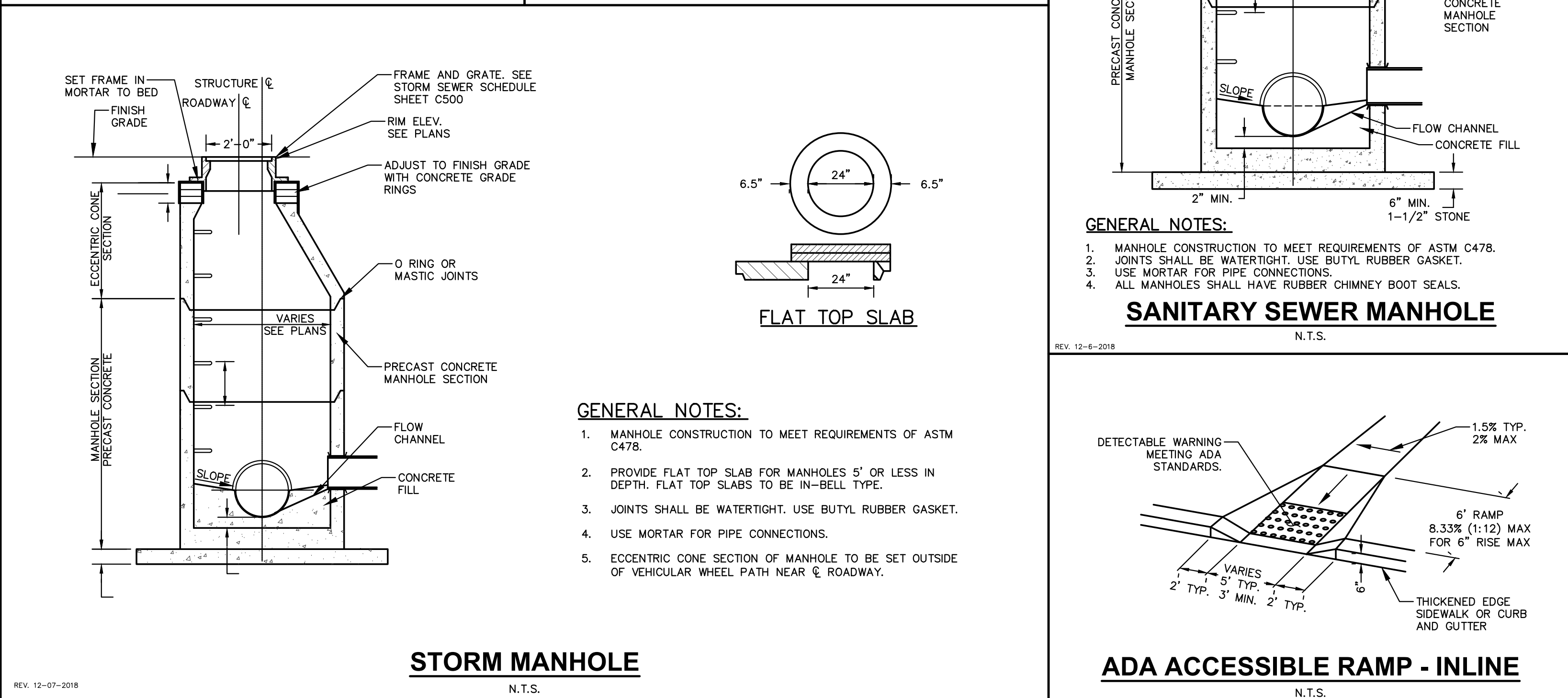
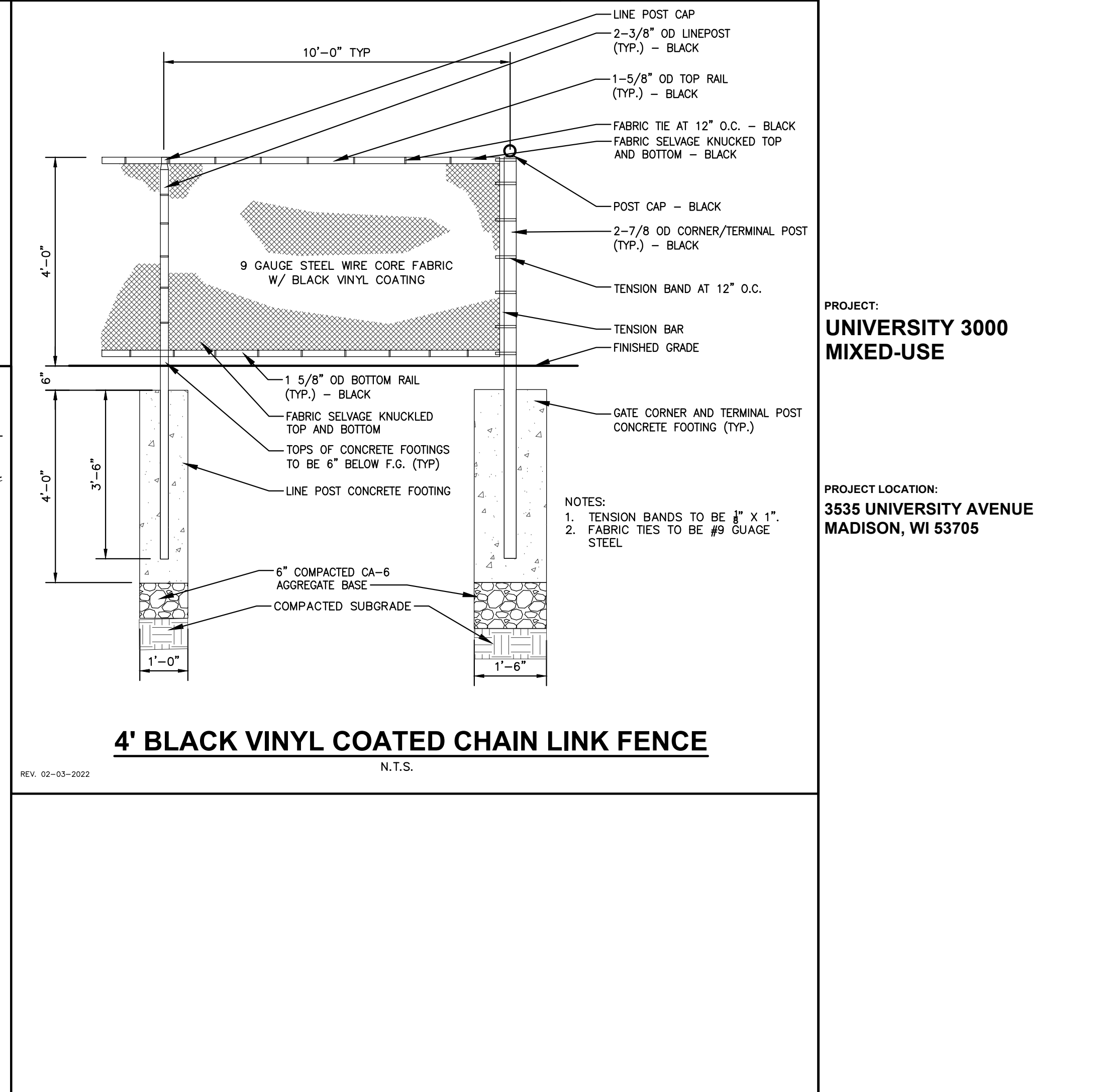
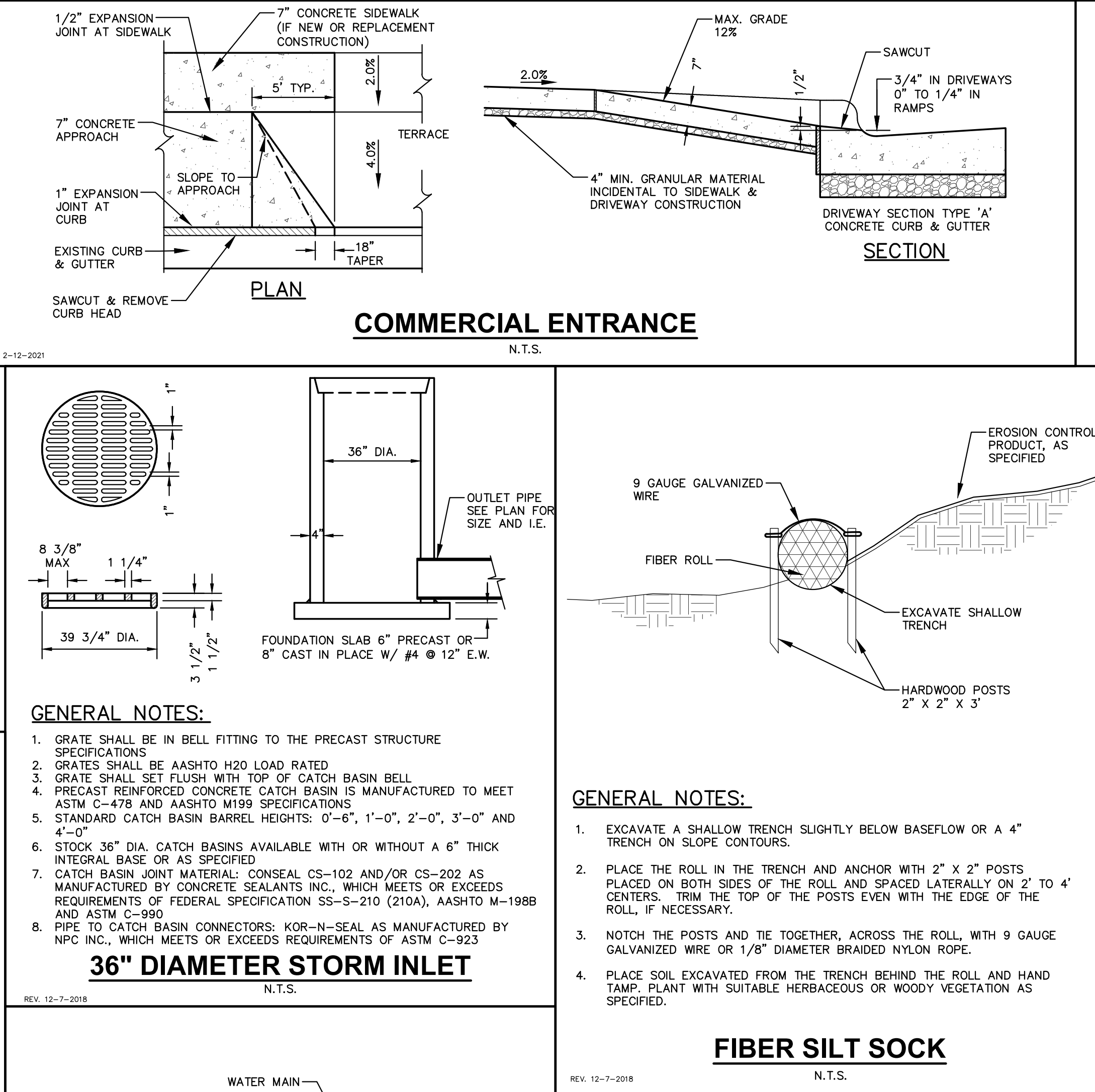
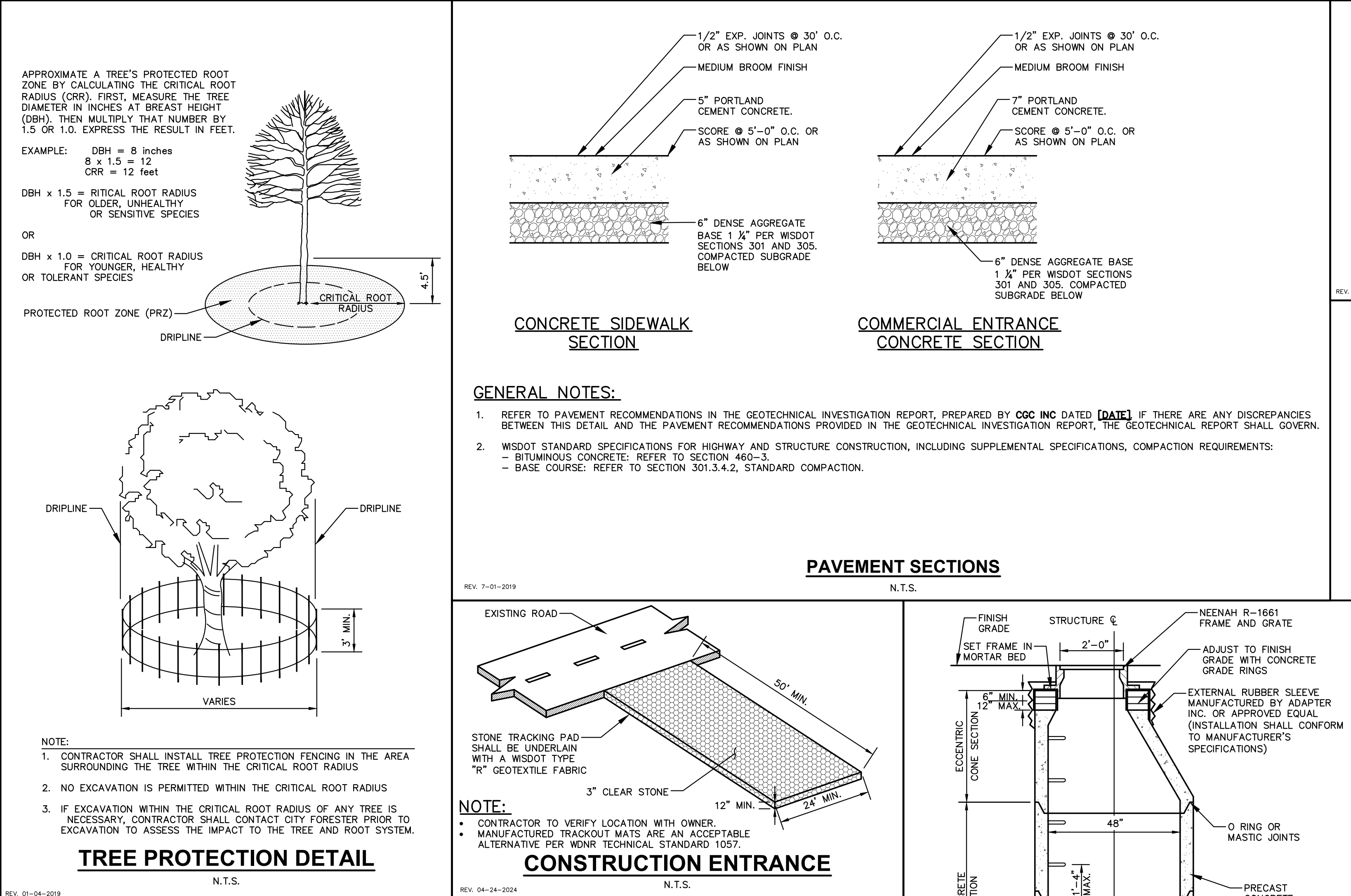
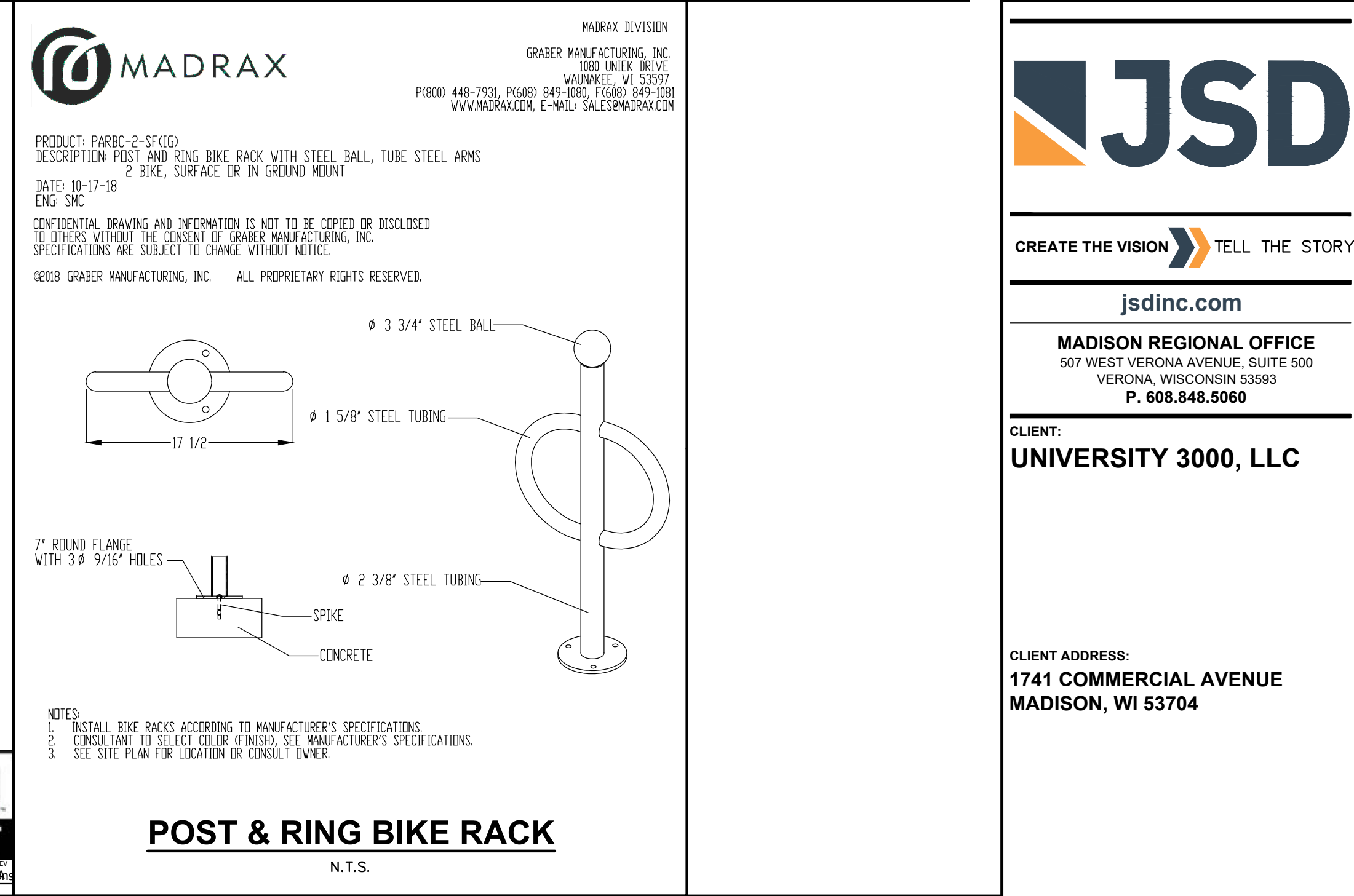
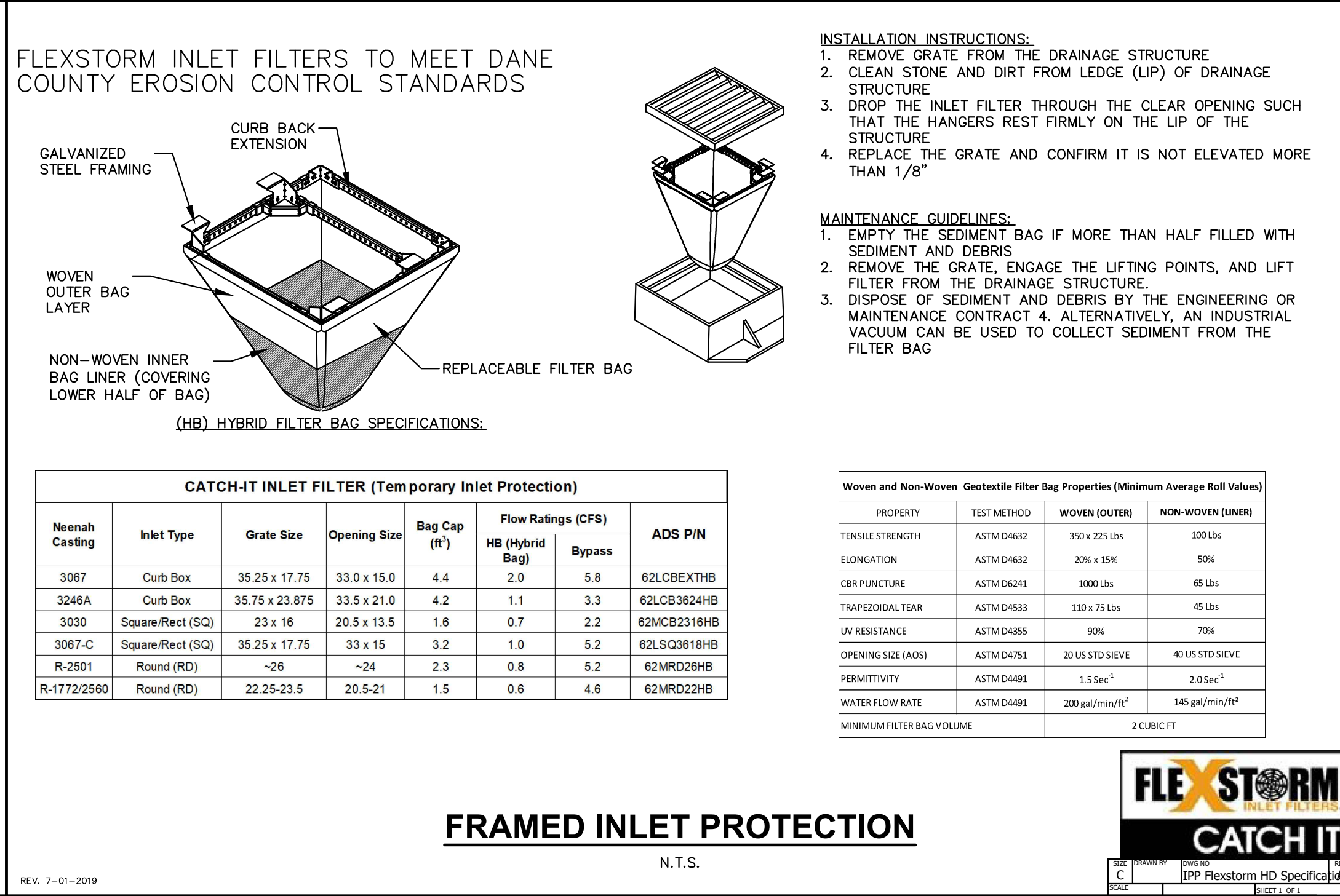
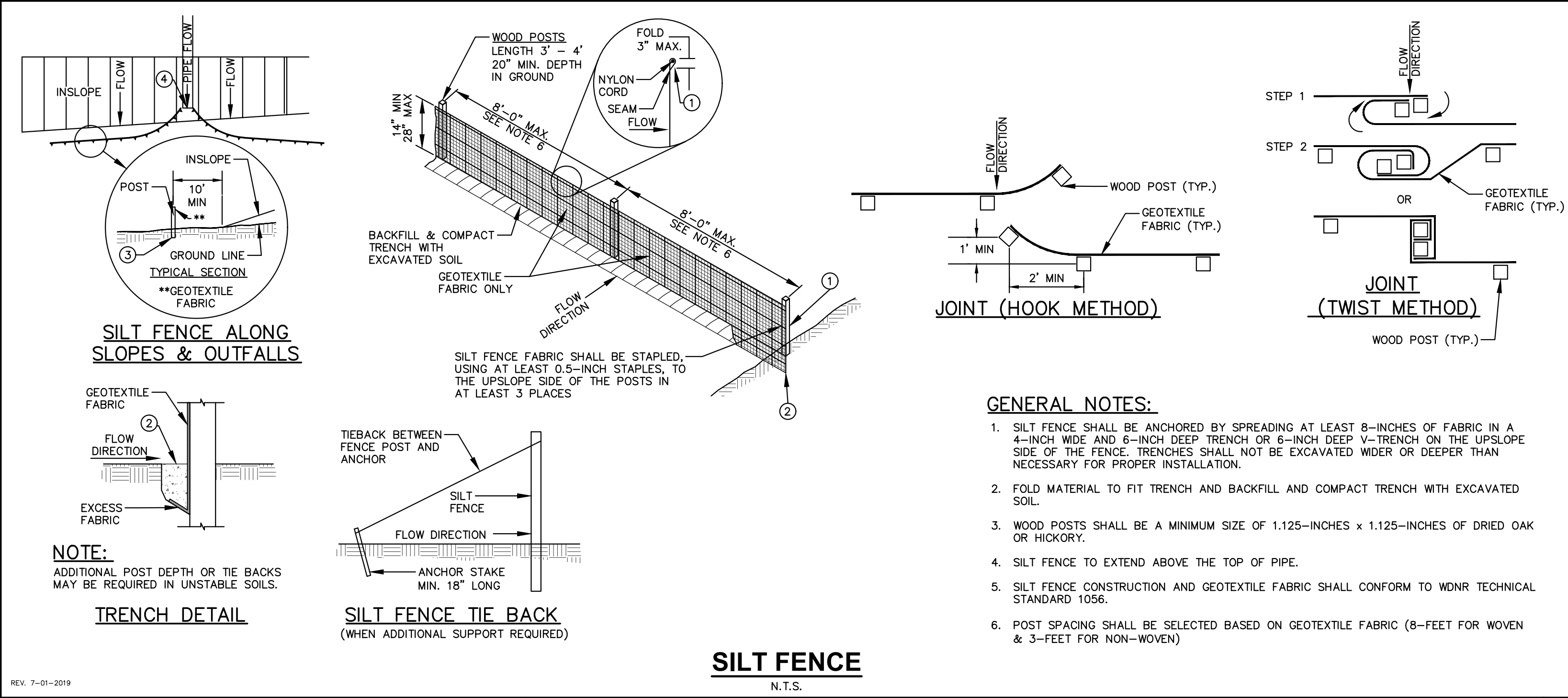

File: USDINC\projects\2024\441462\DWG\DWG\SheetC600.dwg Layout: C600 User: cadda@tanner Printed: Sep 14, 2025 - 2:22pm Scale:

THESE PLANS AND DESIGNS ARE COPYRIGHT PROTECTED AND MAY NOT BE USED IN WHOLE OR IN PART WITHOUT THE WRITTEN CONSENT OF JSD PROFESSIONAL SERVICES, INC.



