

# HAMMERSLEY RD 2022 RESURFACING

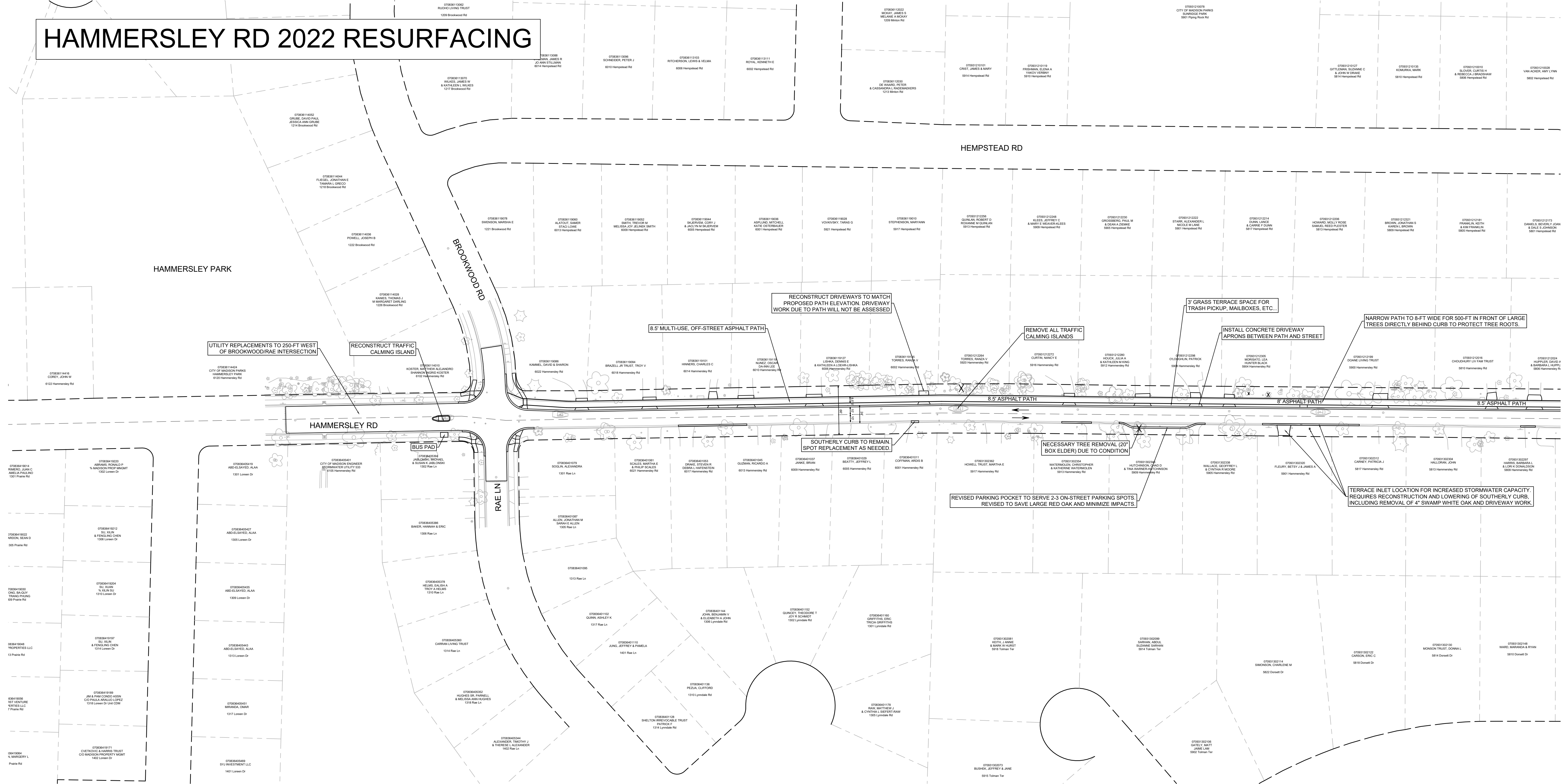

HAMMERSLEY PARK

HEMPSTEAD RD

HAMMERSLEY RD

RAE LN

BROOKWOOD RD

UTILITY REPLACEMENTS TO 250-FT WEST OF BROOKWOOD/RAE INTERSECTION

RECONSTRUCT TRAFFIC CALMING ISLAND

8.5' MULTI-USE, OFF-STREET ASPHALT PATH

RECONSTRUCT DRIVEWAYS TO MATCH PROPOSED PATH ELEVATION. DRIVEWAY WORK DUE TO PATH WILL NOT BE ASSESSED

REMOVE ALL TRAFFIC CALMING ISLANDS

3' GRASS TERRACE SPACE FOR TRASH PICKUP, MAILBOXES, ETC.

INSTALL CONCRETE DRIVEWAY APRONS BETWEEN PATH AND STREET

NARROW PATH TO 8-FT WIDE FOR 500-FT IN FRONT OF LARGE TREES DIRECTLY BEHIND CURB TO PROTECT TREE ROOTS

SOUTHERLY CURB TO REMAIN. SPOT REPLACEMENT AS NEEDED

NECESSARY TREE REMOVAL (20' BOX ELDER) DUE TO CONDITION

REVISED PARKING POCKET TO SERVE 2-3 ON-STREET PARKING SPOTS. REVISED TO SAVE LARGE RED OAK AND MINIMIZE IMPACTS

TERRACE INLET LOCATION FOR INCREASED STORMWATER CAPACITY. REQUIRES RECONSTRUCTION AND LOWERING OF SOUTHERLY CURB, INCLUDING REMOVAL OF 4' SWAMP WHITE OAK AND DRIVEWAY WORK

# HAMMERSLEY RD 2022 RESURFACING

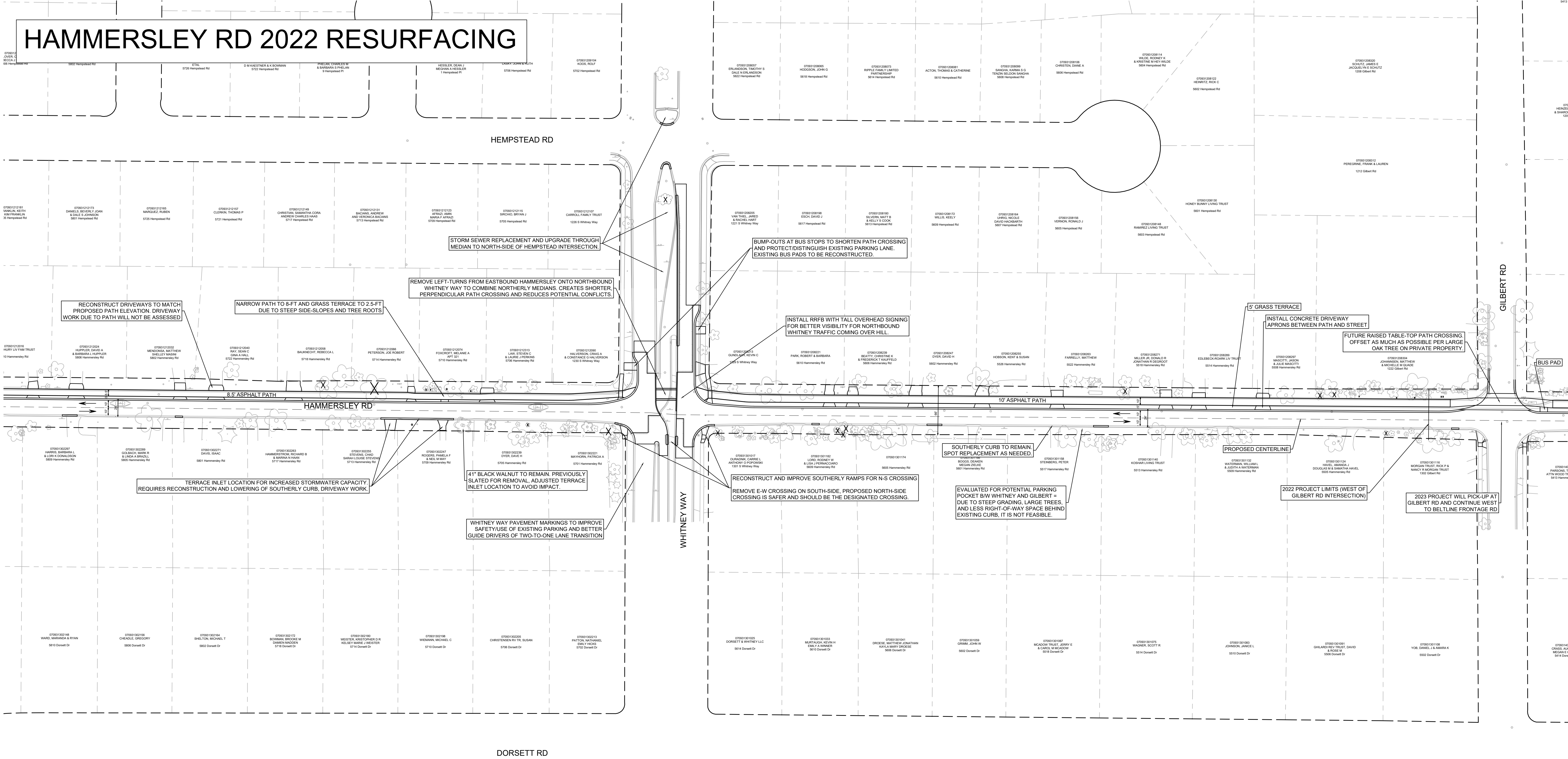

DORSETT RD