

How Does A Project Make it into the City's Transportation Budget

- Safety
- Deteriorated Pavement Condition
- Pedestrian & Bicycle Improvements
- Bridge Deteriorated Condition
- Utility Infrastructure
- Requests by Adjoining Municipalities
- Timely Ability to get Developer Contributions
- Extensions or Realignment in Accordance with Adopted Neighborhood Plans
- Roadway Congestion

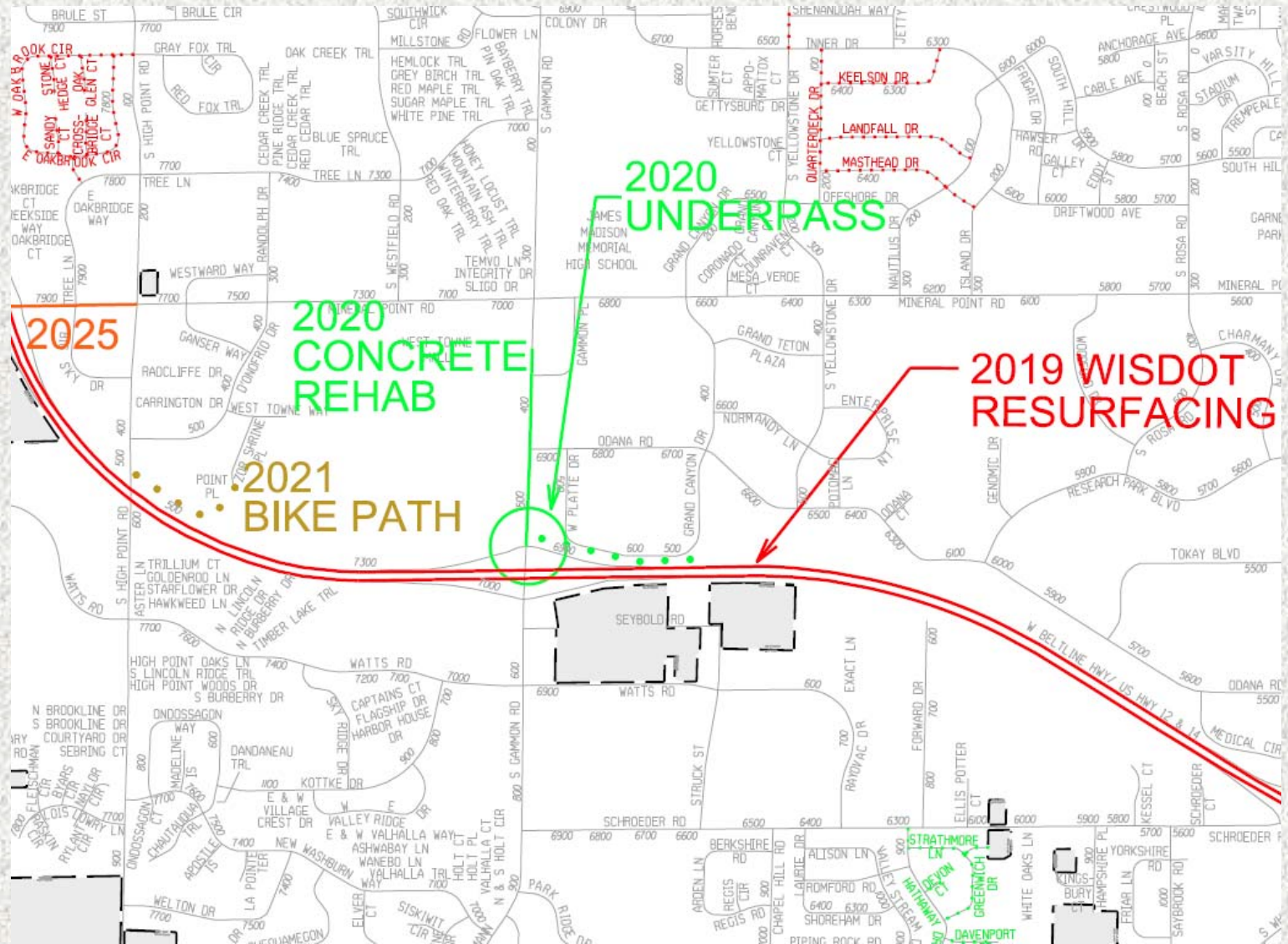

Gammon Rd / West Towne Path



Cottage Grove Road

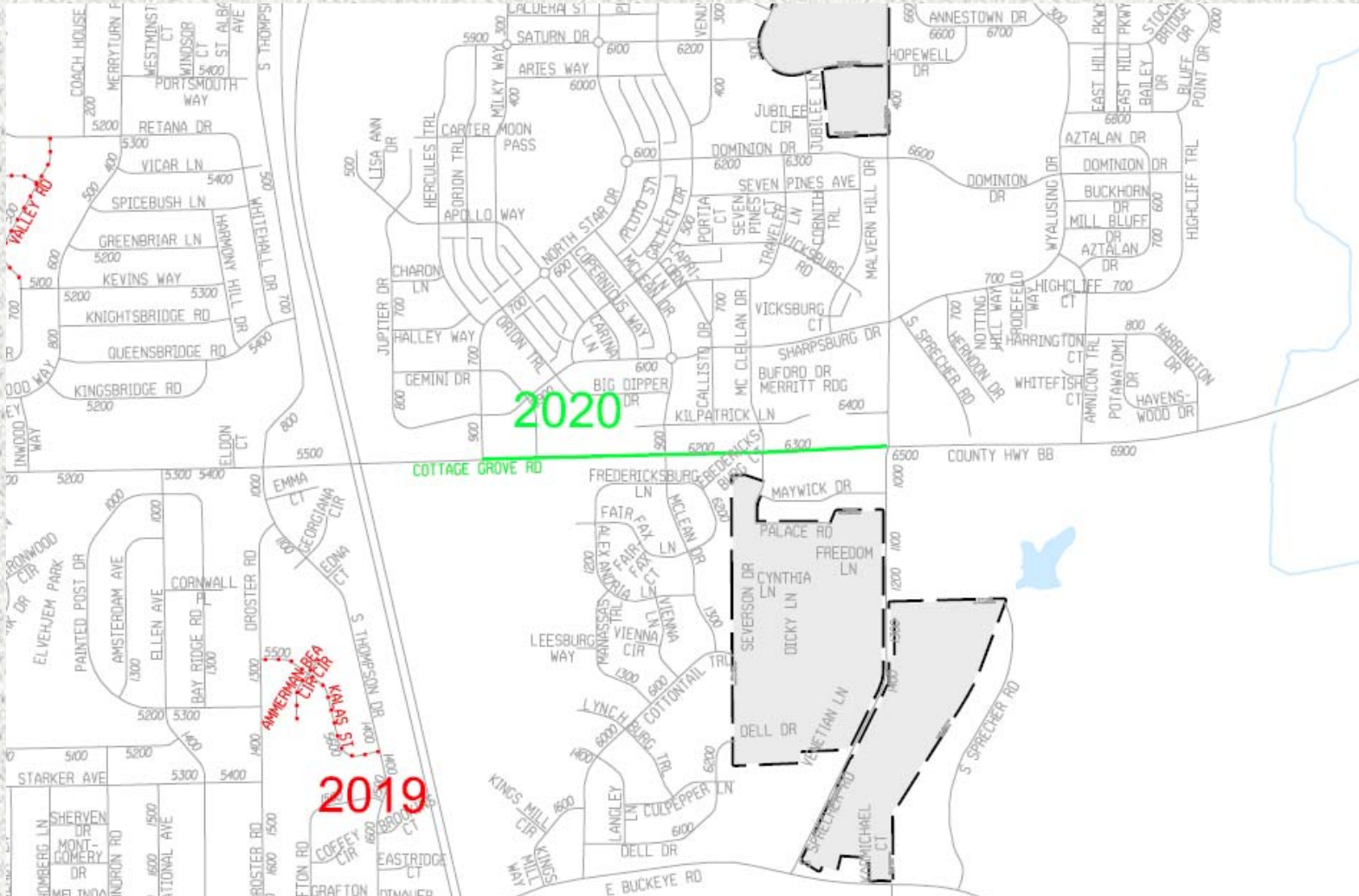

Downtown

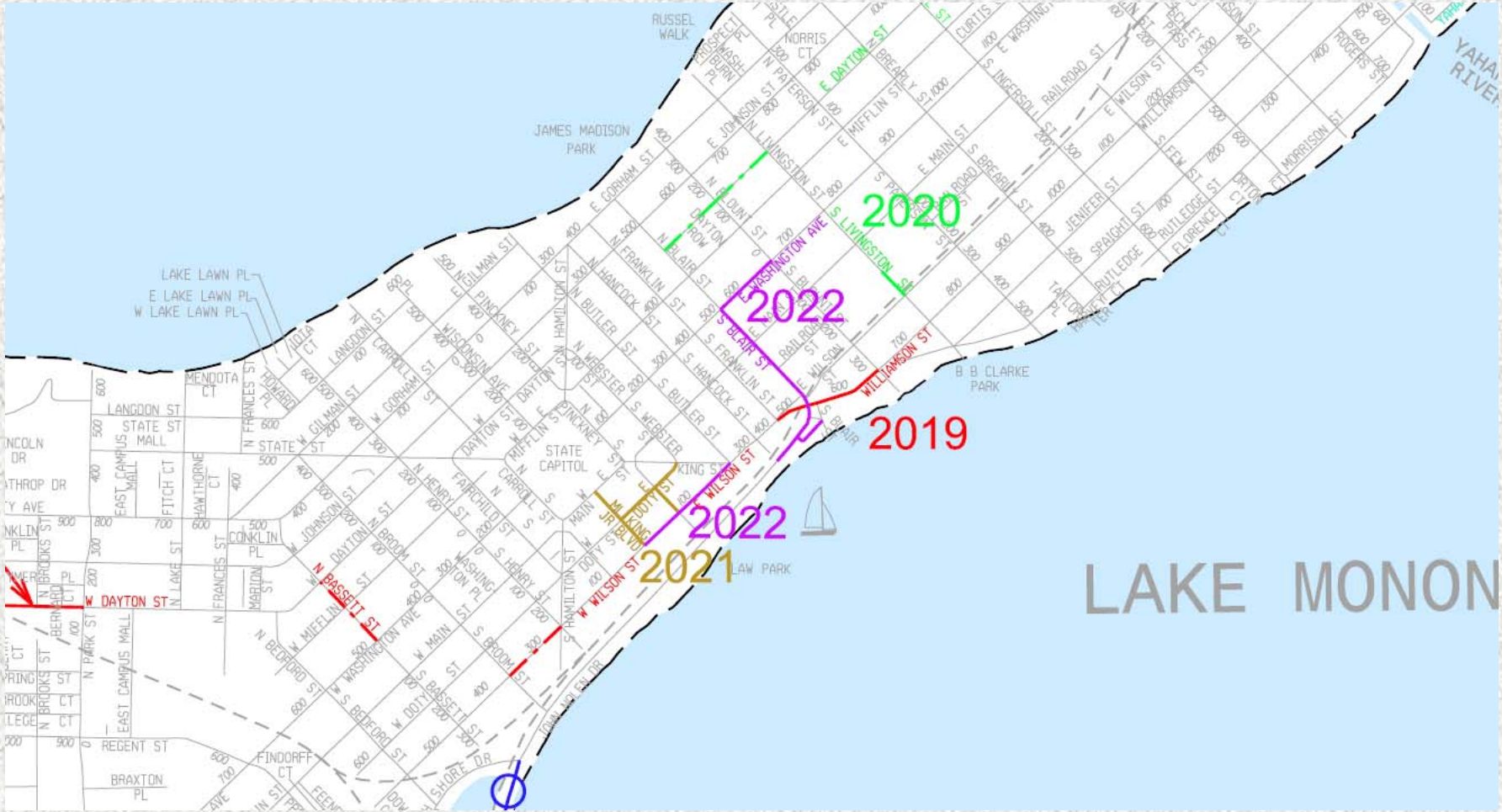

LAKE MONONA



City of Madison Engineering

Doty Pavement rating = 4
 Wilson Pavement rating = 4
 Blair Pavement rating = 3

University Ave

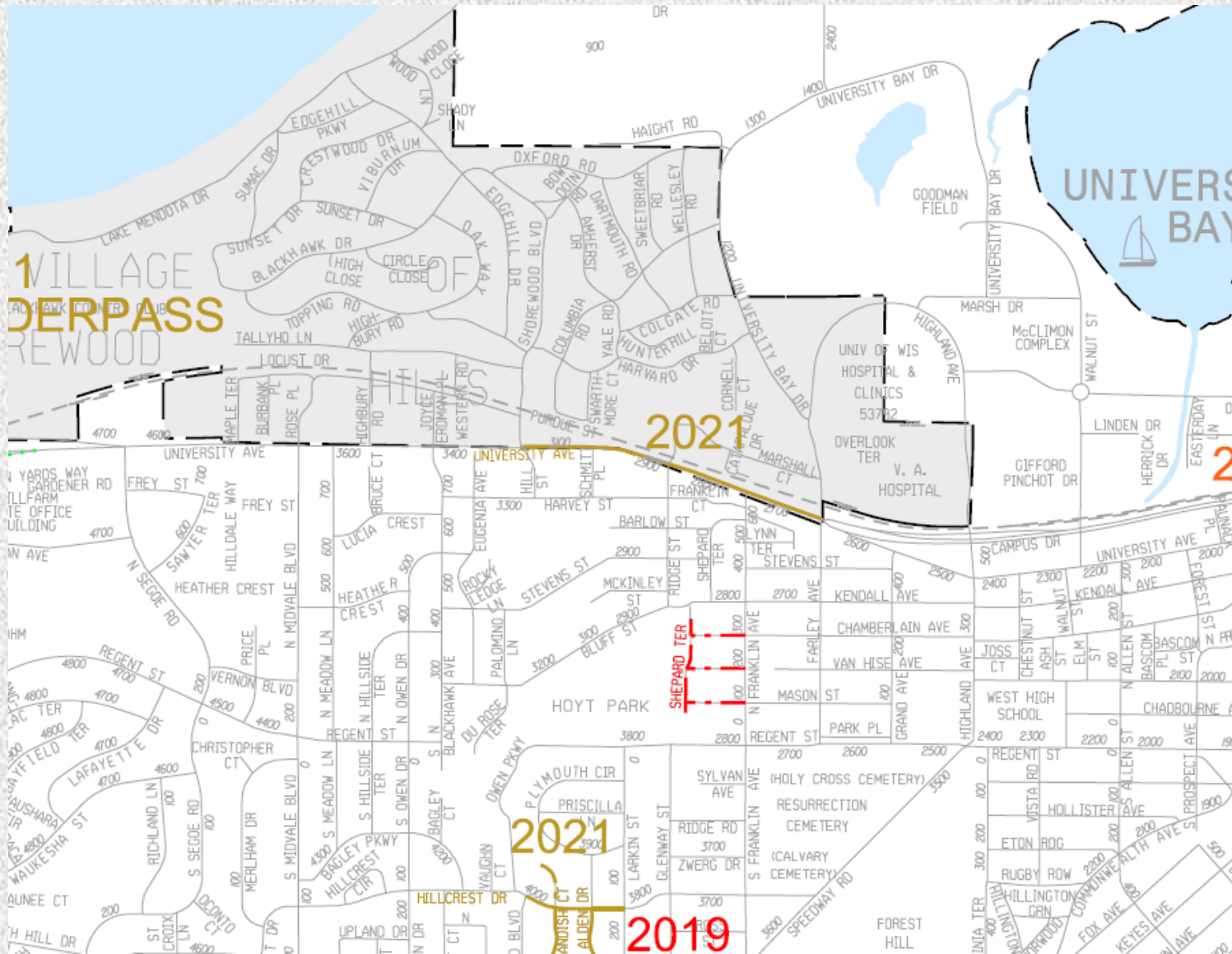

Garver Path

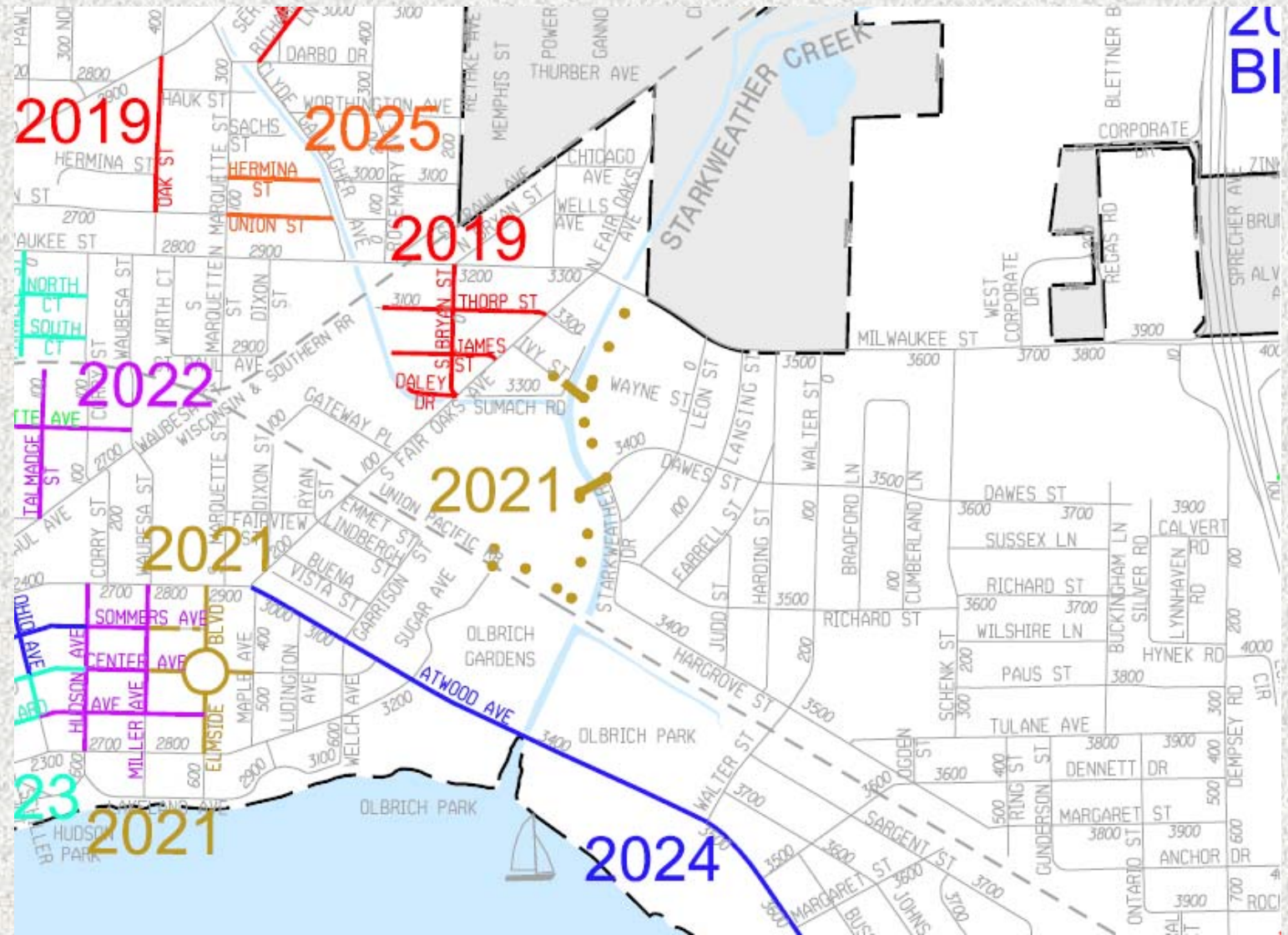

South Park Street

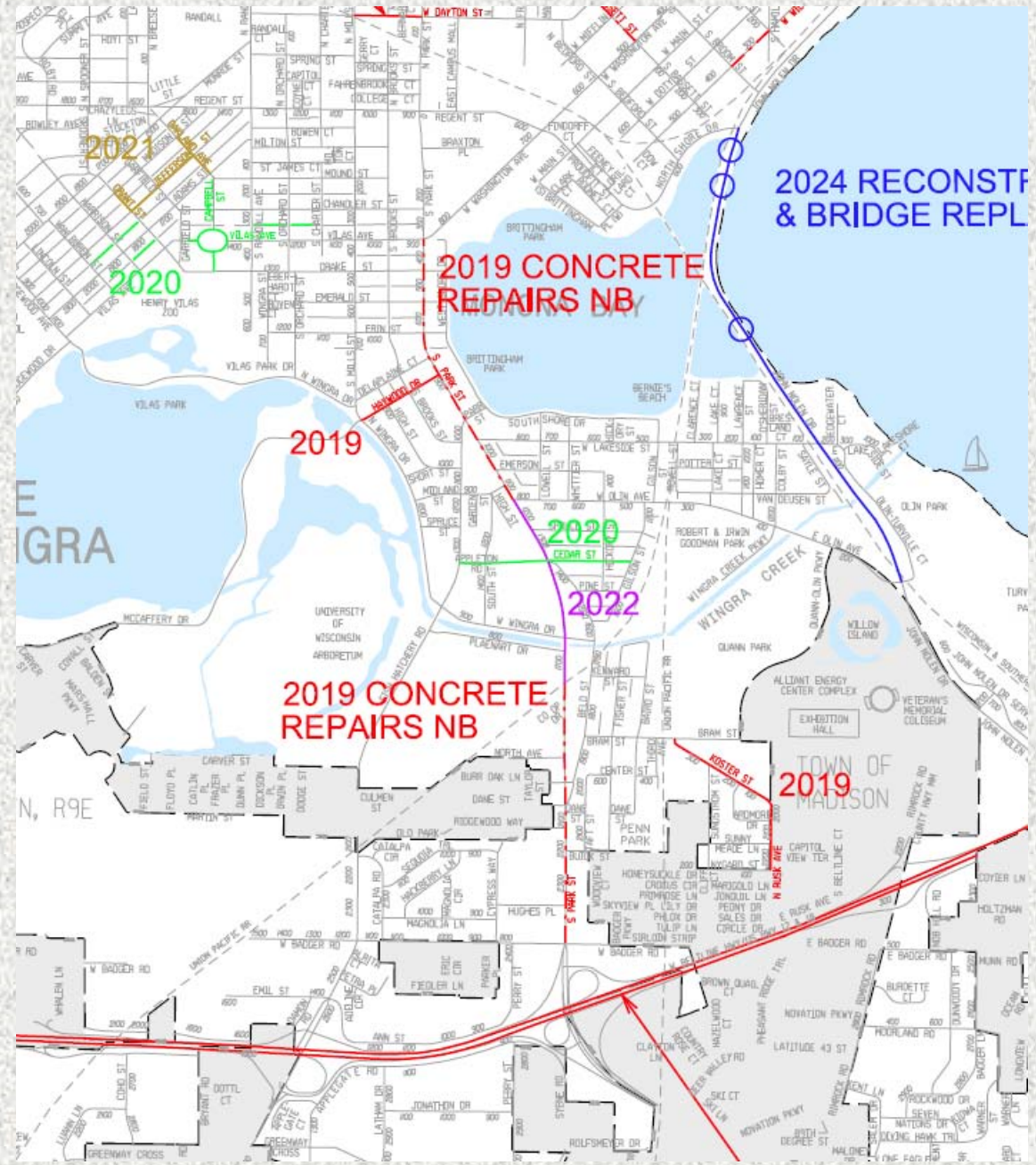

Atwood

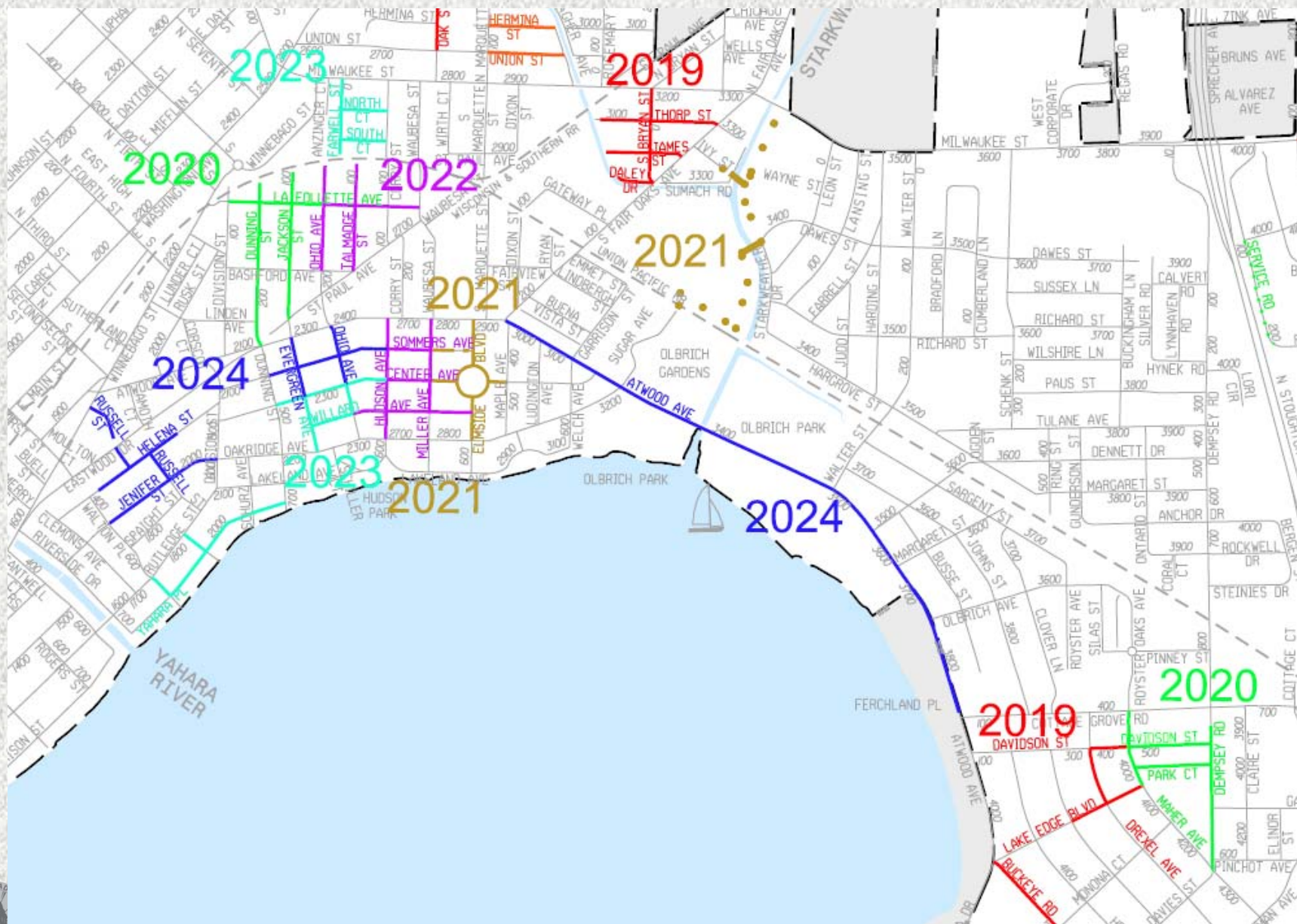

John Nolen Dr

2024 RECONSTRUCTION & BRIDGE REPLACEMENT

2019 CONCRETE REPAIRS NB

2019 RESURFACING CITY OF MONROE

2020 CEDAR ST

2022

2019 CONCRETE REPAIRS SB



City of Madison Engineering

Pavement rating = 5

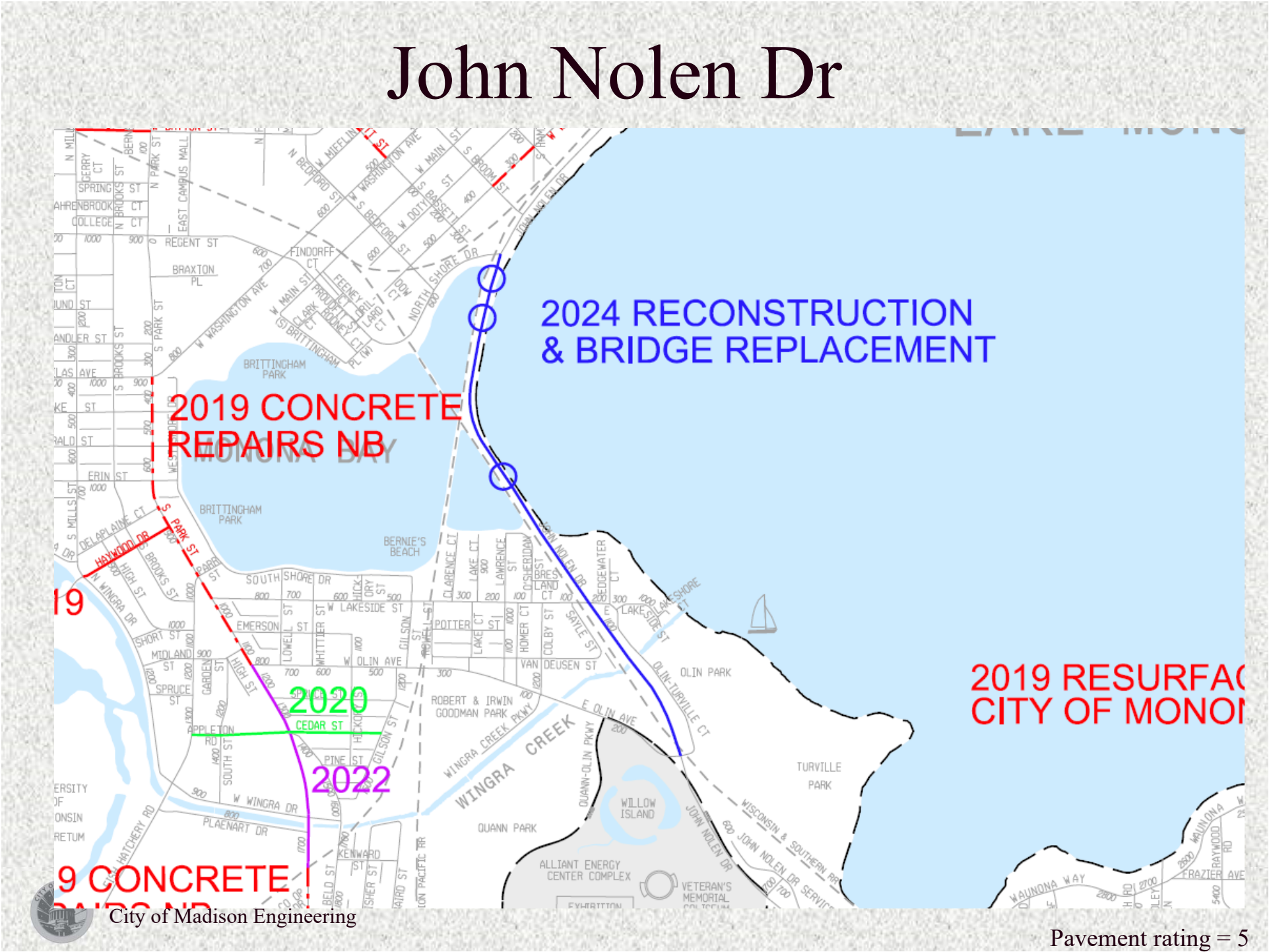

Troy Dr Underpass



Autumn Ridge Path

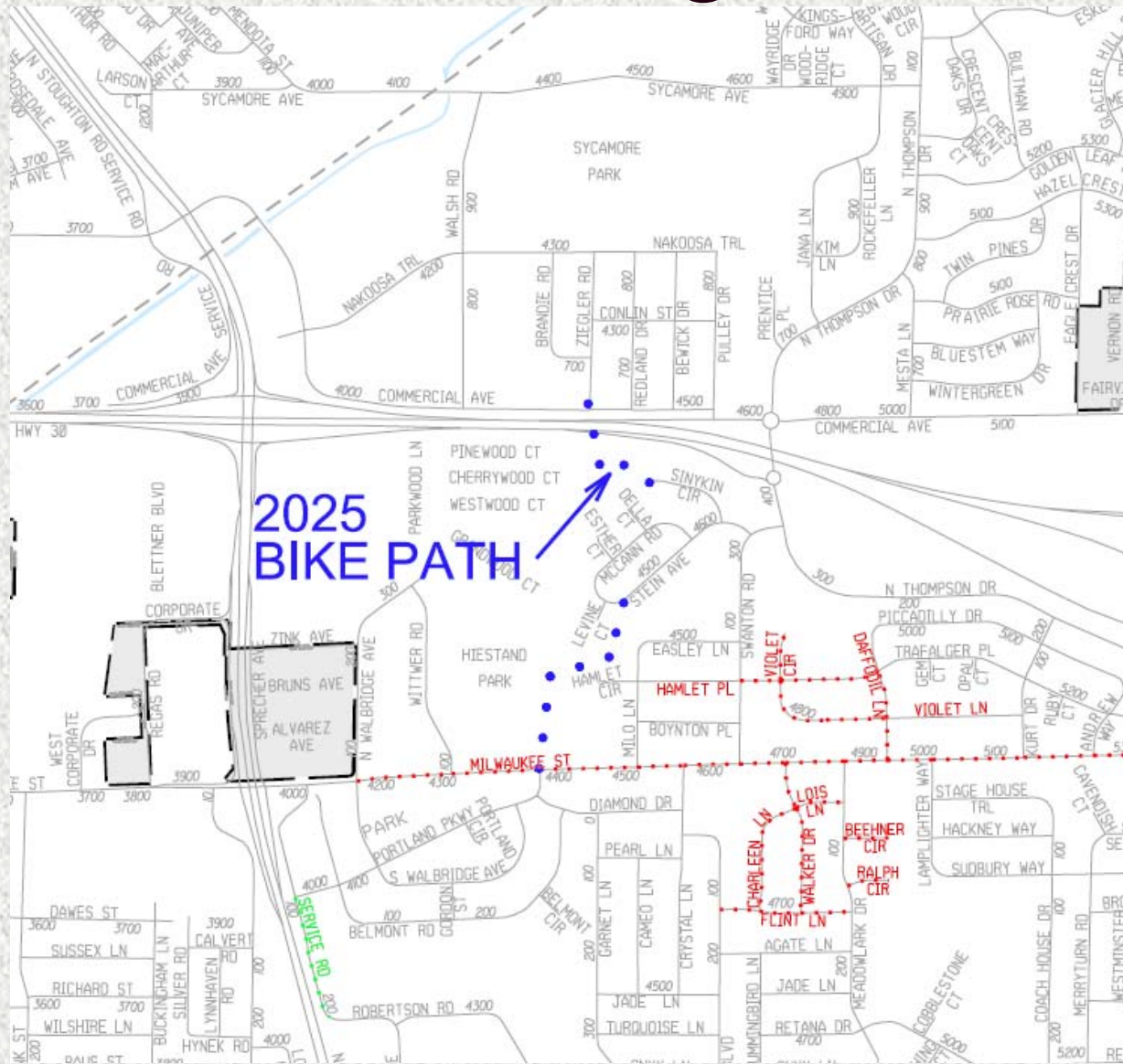

Pleasant View Rd

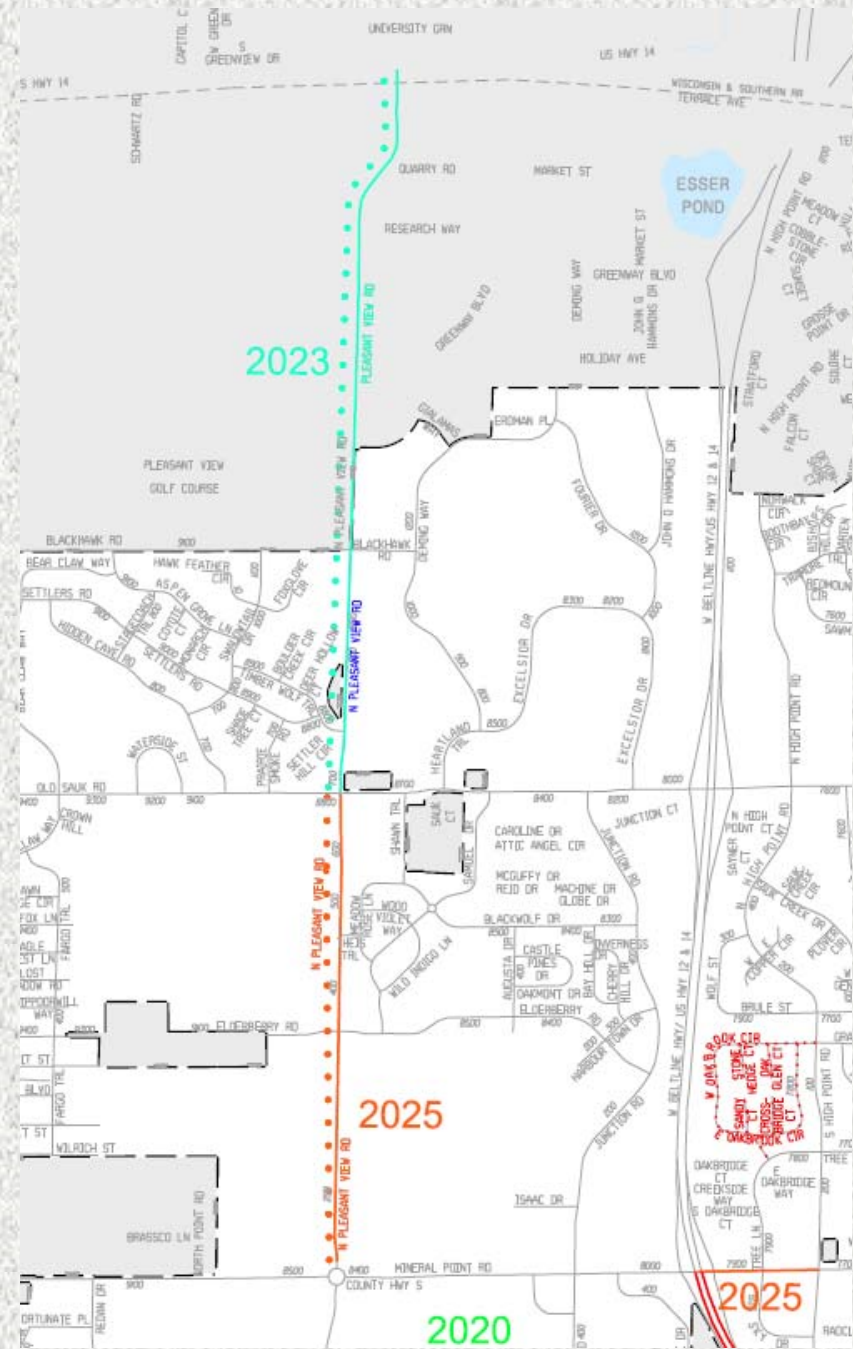

Reconstruct Streets 2020

- Reconstruct 4.1 mi
- N Ingersoll St/Elizabeth St
- Dunning St/Jackson St/LaFollete Ave
- Vilas Ave/Campbell St
- Gregory St/Copeland St/Cross St/Western Ave
- Cedar St
- City View Dr
- Rethke Dr
- Alley 1900 Block Adams/Jefferson/Vilas
- Alley 1200 Block Chandler/Vilas
- Belin St/Park Way
- Davidson St/Park Ct/Dempsey Rd/Maher Ave
- Rockstream Dr
- S Livingston



Pavement Management 2020

- Chip Seal 50-70 mi
- Crack Seal 50-100 mi
- Resurface 6.2 mi
- Old Middleton Rd/Craig Ave
- S Stoughton Service Rd
- Hathaway Dr/Strathmore Ln/Greenwich Dr/Devon Ct/Davenport Dr/Glenbrook Cir
- Ellen Ave/Aaron Ct/Sams Ct/Camilla Rd/Pebblebrook Dr/Hollybrook Ct
- E Dayton St
- Holly Ave/ Euclid Ave/Toepfer Ave/ St Clair St
- Lien Rd
- Anderson St
- S Brooks St
- Independence Ln
- High Crossing Blvd



Bikeways Program

- Resurfacing & Smaller Path Projects
- Wayfinding & Signature Route Improvements
- 2019 Portage Rd Path / Eastlawn Plat Bridge
- 2020 SW Path Resurfacing
- Candidate Future Projects:
 - Riverside Diagonal Crossing
 - Demetral Path & Lighting
 - Sauk Creek Path



Sidewalk Program

- 2019 District 1 – McKinney
 District 7 – Hurd Moreland
 District 9 - Skidmore
- 2020 District 4 - Verveer
 District 8 – Reddy
- 2021 District 13 - Evers
 District 14 - Carter



Safety Program

- Proposed new program to fund projects which can help reduce severe crashes



State of Our Local Streets

	Local	2001	2010	2013	2014	2015	2016	2017	2018
	% Miles at or below Cond State 10	100.0%	100.0%	100.0%	100.0%	100.0%	100.0%	100.0%	100.0%
	% Miles at or below Cond State 9	93.9%	98.6%	98.3%	98.8%	98.1%	98.1%	96.6%	94.6%
	% Miles at or below Cond State 8	88.3%	92.6%	92.9%	93.6%	94.9%	95.2%	94.3%	92.2%
	% Miles at or below Cond State 7	68.2%	56.0%	59.0%	70.8%	64.1%	61.6%	61.8%	53.2%
	% Miles at or below Cond State 6	61.8%	40.7%	35.8%	39.0%	41.8%	43.7%	45.9%	44.3%
Goal 30%	% Miles at or below Cond State 5	34.9%	28.5%	28.1%	27.9%	27.6%	28.4%	27.8%	25.9%
	% Miles at or below Cond State 4	11.6%	6.7%	12.4%	16.2%	17.5%	18.8%	18.2%	16.2%
	% Miles at or below Cond State 3	2.4%	0.6%	1.1%	2.8%	2.7%	2.9%	3.5%	3.1%
	% Miles at or below Cond State 2	0.9%	0.0%	0.0%	0.1%	0.1%	0.2%	0.2%	0.2%
	% Miles at or below Cond State 1	0.8%	0.0%	0.0%	0.0%	0.0%	0.0%	0.0%	0.0%
	% Miles at or below Cond State 0	0.4%	0.0%	0.0%	0.0%	0.0%	0.0%	0.0%	0.0%

Goal: less than 30% of total miles of local streets at or below 5



State of Our Collector Streets

	Collector	2001	2010	2013	2014	2015	2016	2017	2018
	% Miles at or below Cond State 10	100.0%	100.0%	100.0%	100.0%	100.0%	100.0%	100.0%	100.0%
	% Miles at or below Cond State 9	94.2%	96.9%	98.8%	98.2%	96.4%	97.1%	96.7%	95.1%
	% Miles at or below Cond State 8	86.1%	89.0%	90.9%	92.3%	90.8%	93.1%	93.0%	91.5%
	% Miles at or below Cond State 7	58.3%	48.5%	51.4%	64.6%	58.8%	51.7%	61.5%	53.1%
	% Miles at or below Cond State 6	48.6%	32.4%	33.1%	39.8%	39.0%	41.4%	44.3%	43.1%
Goal 20%	% Miles at or below Cond State 5	27.8%	19.3%	21.1%	21.7%	18.9%	22.7%	23.1%	21.3%
	% Miles at or below Cond State 4	6.0%	4.7%	9.1%	10.9%	9.1%	9.5%	10.2%	9.5%
	% Miles at or below Cond State 3	0.3%	0.8%	1.0%	4.8%	2.9%	2.8%	3.2%	3.0%
	% Miles at or below Cond State 2	0.0%	0.0%	0.0%	0.0%	0.0%	0.0%	0.0%	0.2%
	% Miles at or below Cond State 1	0.0%	0.0%	0.0%	0.0%	0.0%	0.0%	0.0%	0.2%
	% Miles at or below Cond State 0	0.0%	0.0%	0.0%	0.0%	0.0%	0.0%	0.0%	0.2%

Goal: less than 20% of total miles of collector streets at or below 5



State of Our Arterial Streets

	Arterial	2001	2010	2013	2014	2015	2016	2017	2018
	% Miles at or below Cond State 10	100.0%	100.0%	100.0%	100.0%	100.0%	100.0%	100.0%	100.0%
	% Miles at or below Cond State 9	98.3%	92.0%	97.3%	97.6%	98.0%	97.9%	97.8%	95.1%
	% Miles at or below Cond State 8	87.0%	76.6%	80.0%	84.7%	89.8%	89.7%	93.6%	90.7%
	% Miles at or below Cond State 7	58.4%	47.0%	44.7%	60.4%	56.4%	46.1%	53.8%	42.5%
	% Miles at or below Cond State 6	46.3%	28.2%	24.4%	32.7%	37.8%	38.9%	37.8%	36.5%
Goal 15%	% Miles at or below Cond State 5	23.3%	15.8%	11.8%	16.5%	18.4%	23.0%	26.3%	24.6%
	% Miles at or below Cond State 4	2.0%	8.1%	5.0%	6.3%	7.1%	7.5%	8.8%	6.9%
	% Miles at or below Cond State 3	0.5%	0.8%	0.2%	1.9%	2.4%	2.3%	2.5%	1.6%
	% Miles at or below Cond State 2	0.5%	0.0%	0.0%	0.0%	0.0%	0.0%	0.0%	0.0%
	% Miles at or below Cond State 1	0.5%	0.0%	0.0%	0.0%	0.0%	0.0%	0.0%	0.0%
	% Miles at or below Cond State 0	0.5%	0.0%	0.0%	0.0%	0.0%	0.0%	0.0%	0.0%

Goal: less than 15% of total miles of arterial streets at or below 5



State of Our Paths

All Paths	2006	2007	2008	2009	2010	2011	2012	2013	2014	2015	2016	2017	2018
% Miles at or below Cond State 10	100.0%	#DIV/0!	100.0%	100.0%	100.0%	100.0%	100.0%	100.0%	100.0%	100.0%	100.0%	100.0%	100.0%
% Miles at or below Cond State 9	92.8%	#DIV/0!	78.9%	78.2%	97.0%	91.7%	86.5%	81.8%	78.9%	92.7%	90.9%	89.0%	94.7%
% Miles at or below Cond State 8	77.8%	#DIV/0!	61.0%	60.6%	73.3%	68.6%	65.0%	60.0%	57.5%	69.8%	68.3%	67.5%	76.4%
% Miles at or below Cond State 7	39.6%	#DIV/0!	22.2%	22.1%	36.8%	32.6%	29.8%	26.2%	24.4%	46.3%	45.1%	44.7%	57.6%
% Miles at or below Cond State 6	31.9%	#DIV/0!	21.8%	21.7%	20.3%	16.6%	14.4%	11.7%	10.2%	20.0%	19.0%	18.4%	25.7%
% Miles at or below Cond State 5	15.1%	#DIV/0!	8.0%	7.9%	9.9%	6.6%	5.6%	3.7%	2.3%	4.7%	4.3%	4.3%	11.1%
% Miles at or below Cond State 4	2.9%	#DIV/0!	0.5%	0.5%	0.5%	0.5%	0.5%	0.8%	0.1%	1.1%	1.1%	1.1%	1.5%
% Miles at or below Cond State 3	0.5%	#DIV/0!	0.0%	0.0%	0.0%	0.0%	0.0%	0.3%	0.1%	0.3%	0.3%	0.3%	0.0%
% Miles at or below Cond State 2	0.0%	#DIV/0!	0.0%	0.0%	0.0%	0.0%	0.0%	0.3%	0.1%	0.3%	0.3%	0.3%	0.0%
% Miles at or below Cond State 1	0.0%	#DIV/0!	0.0%	0.0%	0.0%	0.0%	0.0%	0.3%	0.1%	0.3%	0.3%	0.3%	0.0%
% Miles at or below Cond State 0	0.0%	#DIV/0!	0.0%	0.0%	0.0%	0.0%	0.0%	0.3%	0.1%	0.3%	0.3%	0.3%	0.0%



How to get info

- <http://www.cityofmadison.com/engineering/projects>
- Chris Petykowski 267-8678
cpetykowski@cityofmadison.com



Comments or Project Suggestions

