

Consultant

Notes

1. A SIDE WALK WITH A PITCH GREATER THAN 1:20 IS A RAMP. THE MAXIMUM PITCH OF ANY RAMP OR WALK SHALL BE 1:12. RAMPS OVERCOMING MORE THAN 6" CHANGE IN ELEVATION TO HAVE HANDRAILS ON BOTH SIDES.
2. ALL DRIVEWAYS, CURB ADJACENT TO DRIVEWAYS, AND SIDEWALK CONSTRUCTION WITHIN THE PUBLIC RIGHT-OF-WAY, SHALL BE COMPLETED IN ACCORDANCE WITH CITY OF MADISON STANDARD SPECIFICATIONS FOR PUBLIC WORKS CONSTRUCTION BY A CONTRACTOR CURRENTLY LICENSED BY THE CITY.
3. ALL NEW DRIVES TO BE CONSTRUCTED WITH CLASS III APPROACHES IN ACCORDANCE WITH MADISON GENERAL ORDINANCE SECTION 10.08(4).
4. ALL TRASH AND RECYCLING TO BE COLLECTED IN TRASH ROOMS IN THE BUILDING BASEMENTS.
5. SEE SITE GRADING AND UTILITY PLANS FOR ADDITIONAL INFORMATION.
6. ALL WORK IN THE RIGHT OF WAY SHALL BE PERFORMED BY A CITY OF MADISON LICENSED CONTRACTOR.
7. BIKE STALLS TO BE IN ACCORDANCE TO MADISON GENERAL ORDINANCE 28.11, (SEE SUBSECTIONS (B)(a) AND (B)(1)(g)).
8. ALL CITY SIDEWALK, CURB, AND GUTTER WHICH IS DAMAGED DURING CONSTRUCTION OR THAT THE CITY ENGINEER DETERMINES TO BE NECESSARY SHALL BE REPLACED.

Revisions

Amended FUD-SIP Submittal - January 6, 2004  
 Informational UDC Submittal - January 21, 2010  
 Initial UDC Submittal - February 10, 2010  
 FUD-SIP Submittal - March 20, 2013

Project Title  
**Lot 95, 2nd Addition to  
 Midtown Commons**  
 1723 Waldorf Drive  
 Madison, Wisconsin

Drawing Title  
**Site Plan**

Project No. **0466** Drawing No. **C-1.1**

This document contains confidential or proprietary information of Knothe & Bruce Architects. Neither the document nor the information herein is to be reproduced, distributed, used, or disclosed other than in whole or in part, except as expressly authorized by Knothe & Bruce Architects. Knothe & Bruce Architects is a Limited Liability Company of Wisconsin.

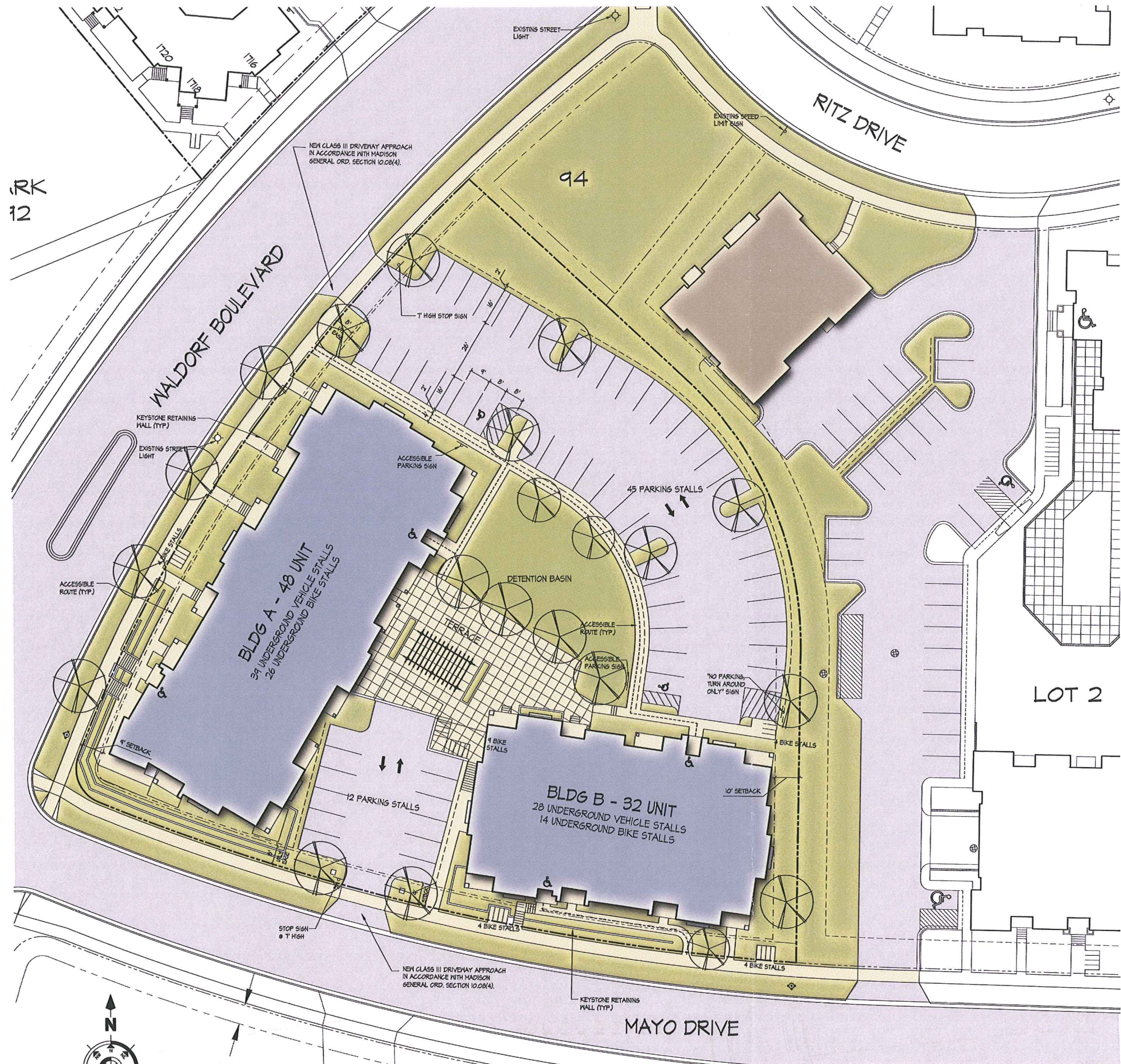

**SITE PLAN**  
 1" = 20'  
 Revised

Consultant

Notes



- TYPICAL MATERIALS
- ASPHALT SHINGLES
  - ALUMINUM SOFFIT AND FASCIA
  - COMPOSITE TRIM
  - COMPOSITE SIDING
  - PRECAST BAND
  - VINYL WINDOWS
  - COMPOSITE PANELS
  - ALUMINUM RAILINGS
  - PRECAST WINDOW SILLS
  - BRICK VENEER
  - PRECAST BAND
  - GROUND FACED CMU

FRONT ELEVATION ALONG WALDORF BLVD.  
3/8" = 1'-0"



END ELEVATION ALONG MAYO DRIVE  
3/8" = 1'-0"



END ELEVATION  
3/8" = 1'-0"



REAR ELEVATION  
3/8" = 1'-0"

Revisions

PLD-SIP Submittal - March 20, 2018

Project Title  
Lot 95, 2nd Addition to  
Midtown Commons  
1723 Waldorf Drive  
Madison, Wisconsin

Drawing Title  
Elevations  
Building #A

Project No.  
0466

Drawing No.  
A-2.1A

This document contains confidential or proprietary information of Knothe & Bruce Architects. Neither the document nor the information herein is to be reproduced, distributed, used, or disclosed, either in whole or in part, except as specifically authorized by Knothe & Bruce Architects. Knothe & Bruce Architects is a Limited Liability Company of Wisconsin.