

Babcock Dairy Plant and Center for Dairy Research

Division of Facilities Development
DFD Project No. 13A2U

1605 Linden Drive
Madison, WI 53706

September 10, 2015 City of Madison-Municipal Review



zimmerman
ARCHITECTURAL STUDIOS, INC.
2122 West Mount Vernon Avenue, Milwaukee, WI 53233
Voice: (414) 476-9500
Website: www.zastudios.com

Architect/Landscape Architect:

Zimmerman Architectural Studios
2122 West Mount Vernon Ave
Milwaukee, WI 53233
Office (414) 476-9500
info@zastudios.com

Civil, Structural, Mechanical, Plumbing:

HARWOOD
ENGINEERING
CONSULTANTS
Harwood Engineering
255 N. 21st St.
Milwaukee, WI 53233
Office (414) 475-5554
harwood@hed.com

Electrical:

Zoe Engineering LLC
8432 West Auer Avenue
Milwaukee, WI 53222
Office (414) 475-2715
info@zoeeng.com

Equipment Consultant:

W.M. Sprinkman Corporation
4234 Courtney Road
Franksville, Wisconsin 53126
(262) 835-2390 phone
sales@sprinkman.com

Kitchen Consultant:

Stewart
Design Associates, Inc.
2934 Fish Hatchery Road, Suite 212
Madison, Wisconsin 53713
(608) 271-8554 phone
mail@stewdesign.com

Commissioning Agent:

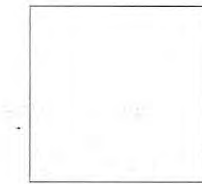

ARCHITECTURAL 'A' SERIES

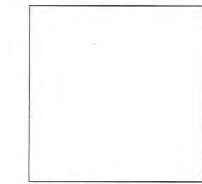

STRUCTURAL 'S' SERIES

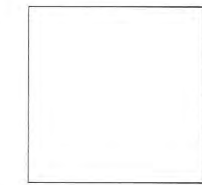

PLUMBING 'P' SERIES

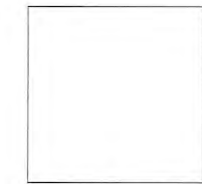

MECHANICAL 'M' SERIES

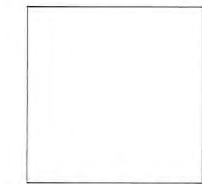

ELECTRICAL 'E' SERIES

SHEET INDEX:

Sheet List - Civil/Landscape

C1.00	SITE PLAN
C1.01	GRADING PLAN
C1.02	DEMO PLAN
C1.03	EXISTING SITE SURVEY
C5.00	CONSTRUCTION DETAILS
C6.00	OVERALL LANDSCAPE PLAN
C7.00	LANDSCAPE ENLARGEMENT
C8.00	LANDSCAPE DETAILS, SCHEDULES & NOTES

Architectural_MR

T1.01_MR	T1.01_MR
A2.000	GROUND FLOOR ADDITION
A2.010	FIRST FLOOR ADDITION
A2.020	SECOND FLOOR ADDITION
A2.030	PENTHOUSE PLAN ADDITION
A2.040	ROOF PLAN ADDITION
A4.00	EXTERIOR ELEVATIONS
A4.01	EXTERIOR ELEVATIONS
DRB.021	NORTH ELEVATION
DRB.022	WEST ELEVATION
DRB.023	SOUTH ELEVATION

State of Wisconsin
Department of Administration
Division of Facilities Development
Project Address:
1605 Linden Drive
Madison, WI 53706

Project Title:
Babcock Dairy Plant and Center for Dairy
Research
Agency:
University of Wisconsin - Madison
Sheet Title: T1.01_MR

REVISIONS

No.	Date	Description
09/10/15		Muni. Review

Graphic:
DFD Number: 13A2U
ZAS No: 130153.00
Set Type:
Issue Date: September 10, 2015
Sheet Number: T1.01_MR

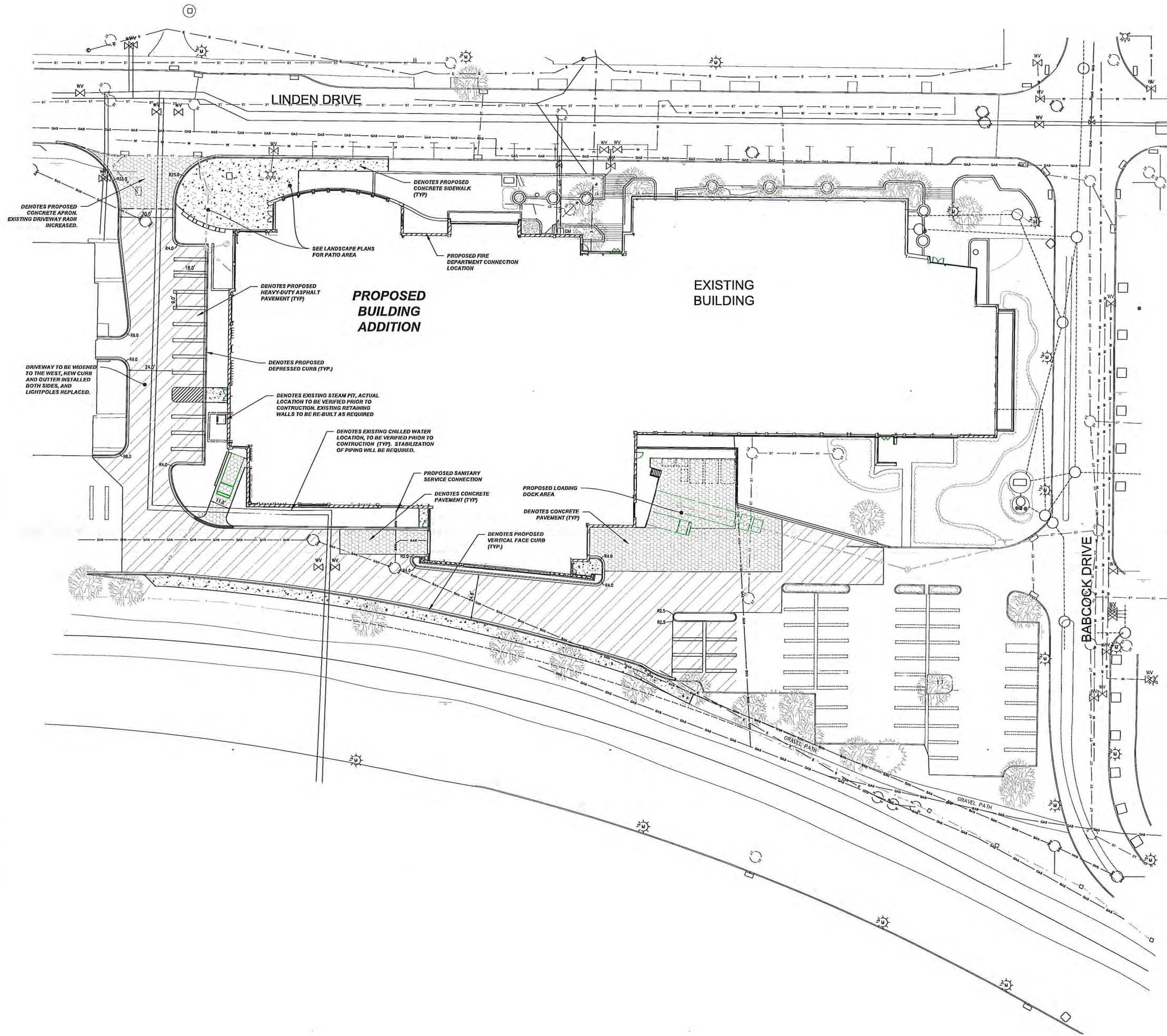

HATCH LEGEND

	PROPOSED CONCRETE SIDEWALK
	PROPOSED HEAVY DUTY ASPHALT PAVEMENT
	PROPOSED REGULAR DUTY ASPHALT PAVEMENT
	PROPOSED DEPRESSED CURB
	PROPOSED TAPER CURB
	PROPOSED REVERSE CURB

UTILITY LEGEND

SYMBOL	DESCRIPTION
	EXISTING WATER MAIN
	PROPOSED WATER SERVICE
	EXISTING ELECTRICAL LINE
	PROPOSED ELECTRICAL LINE
	EXISTING GAS MAIN
	PROPOSED GAS MAIN
	EXISTING SANITARY SEWER
	PROPOSED SANITARY SEWER
	EXISTING STORM SEWER
	PROPOSED STORM SEWER
	OVERHEAD WIRES
	EXISTING POWER POLES
	EXISTING LIGHT POLES
	SANITARY MANHOLE
	FIRE HYDRANT
	EXISTING WATER VALVE
	PROPOSED WATER VALVE
	EXISTING STORM STRUCTURE
	PROPOSED STORM STRUCTURE
	DENOTES EMERGENCY OVERFLOW ROUTE/ DRAINAGE PATH
	PROPOSED & EXISTING SPOT GRADE

DISBUR'S ROUTE
1-800-242-8811

IN ACCORDANCE WITH WISCONSIN STATUTE 182.0175, DAMAGE TO BRIDGEWORK FACILITIES, EXCAVATOR SHALL BE SOLELY RESPONSIBLE TO PROVIDE ADVANCE NOTICE TO BE DESIGNATED FOR CALL STOP OF NOT LESS THAN THREE WORKING DAYS PRIOR TO COMMENCEMENT OF ANY EXCAVATION REQUIRED TO PERFORM WORK CONTAINED ON THESE DRAWINGS, AND FURNISH EXCAVATOR SHALL COMPLY WITH ALL OTHER REQUIREMENTS OF THIS STATUTE RELATIVE TO EXCAVATOR'S WORK.

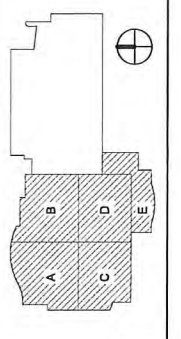

REVISIONS

No.	Date	Description
	09/10/15	Muni. Review

Graphic: 0' 5' 10' 20' 30'

DFD Number: 13A2U

Set Type: PR

Issue Date: August 11, 2015

Sheet Number: C1.00

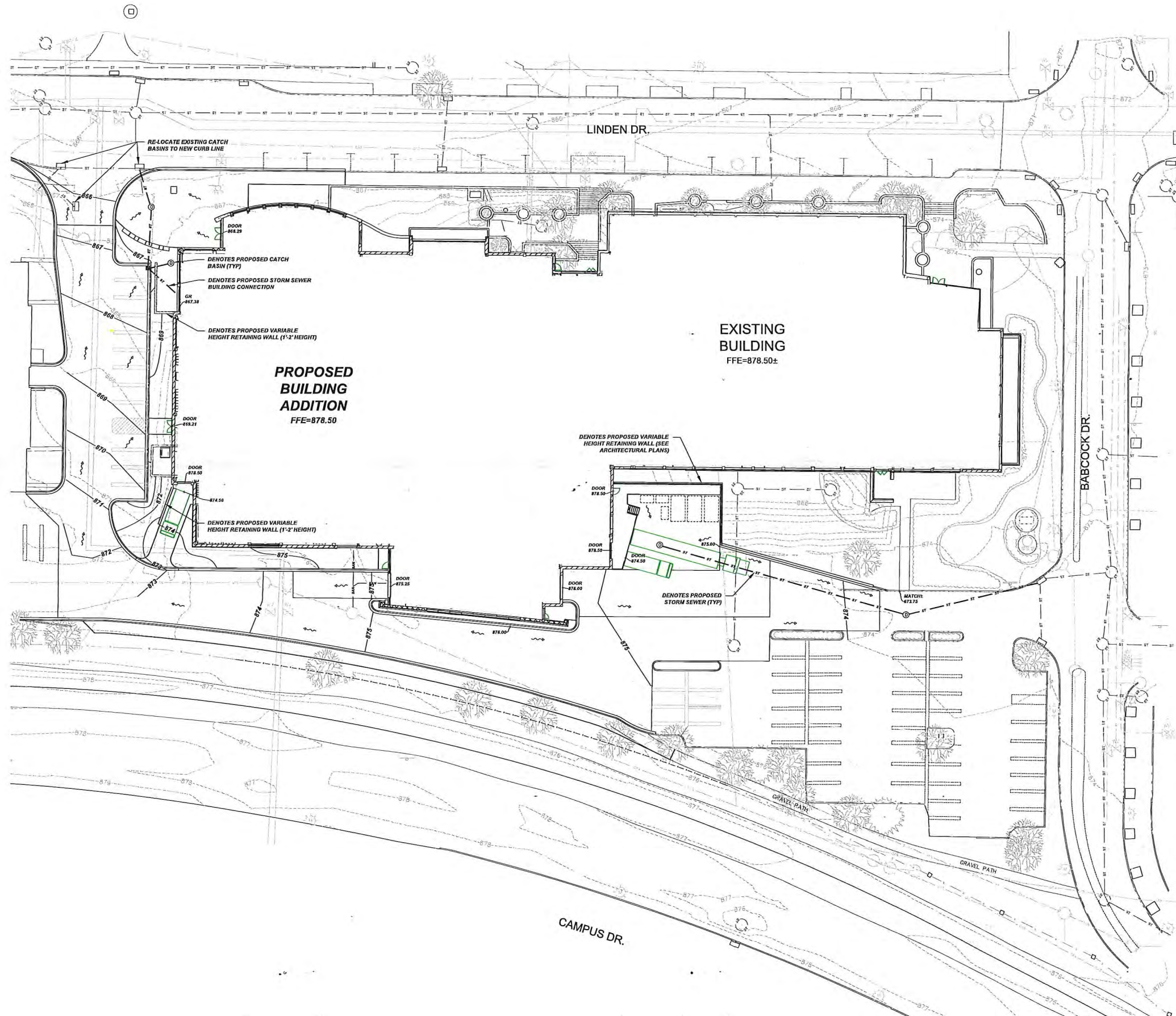

UTILITY LEGEND	
SYMBOL	DESCRIPTION
— W — W	EXISTING WATER MAIN
— E — E	PROPOSED WATER SERVICE
— E — E	EXISTING ELECTRICAL LINE
— E — E	PROPOSED ELECTRICAL LINE
— GAS — GAS	EXISTING GAS MAIN
— GAS — GAS	PROPOSED GAS MAIN
— SAN — SAN	EXISTING SANITARY SEWER
— SAN — SAN	PROPOSED SANITARY SEWER
— SI — SI	EXISTING STORM SEWER
— SI — SI	PROPOSED STORM SEWER
— CHA — CHA	OVERHEAD WIRES
⊙	EXISTING POWER POLES
⊙	EXISTING LIGHT POLES
⊙	SANITARY MANHOLE
⊙	FIRE HYDRANT
⊙	EXISTING WATER VALVE
⊙	PROPOSED WATER VALVE
⊙	EXISTING STORM STRUCTURE
⊙	PROPOSED STORM STRUCTURE
⊙	DENOTES EMERGENCY OVERFLOW ROUTE / DRAINAGE PATH
⊙	PROPOSED & EXISTING SPOT GRADE

PROPERTY'S BOUNDARY

IN ACCORDANCE WITH WISCONSIN STATUTE 182.07(2), DAMAGE TO ENVIRONMENTAL FEATURES, EXCAVATOR SHALL BE SOLELY RESPONSIBLE TO PROVIDE ADVANCE NOTICE TO THE DESIGNATED TREE CALL SYSTEM NOT LESS THAN THREE WORKING DAYS PRIOR TO COMMENCEMENT OF ANY EXCAVATION REQUIRED TO PERFORM WORK CONTAINED ON THESE DRAWINGS, AND FURTHER, EXCAVATOR SHALL COMPLY WITH ALL OTHER REQUIREMENTS OF THIS STATUTE RELATIVE TO EXCAVATOR'S WORK.

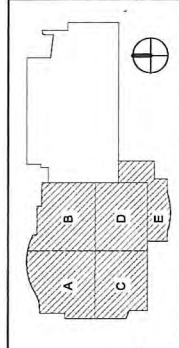

State of Wisconsin
Department of Administration
Division of Facilities
Development

Project Address:
1805 Linden Drive
Madison, WI 53706

Project Title:
Babcock Dairy Plant and Center for Dairy
Research

Agency/Institution:
University of Wisconsin - Madison

Sheet Title:
Grading Plan

REVISIONS		
No.	Date	Description
09/10/15	Muni. Review	

Graphical:	0' 5' 10' 20' 30'
DFD Number:	13A2U
Set Type:	PR
Issue Date:	August 11, 2015
Sheet Number:	C1.01

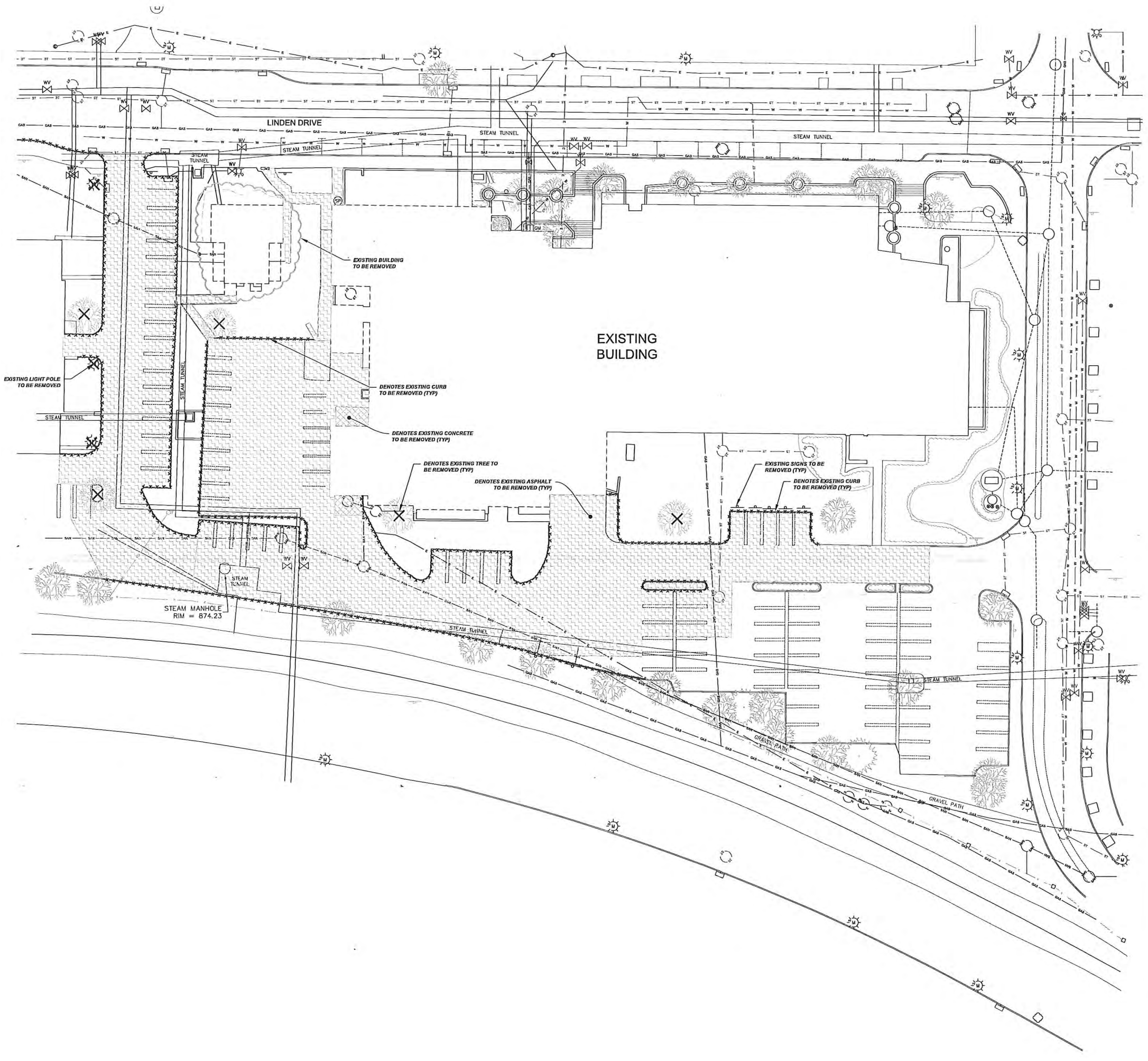

DEMOLITION LEGEND

- DENOTES ITEM TO BE REMOVED OR DEMOLISHED
- DENOTES PAVEMENT REMOVAL AREA
- DENOTES CONCRETE SIDEWALK REMOVAL AREA
- DENOTES ITEM TO BE ABANDONED OR REMOVED
- DENOTES TREE TO BE REMOVED

UTILITY LEGEND

SYMBOL	DESCRIPTION
	EXISTING WATER MAIN
	PROPOSED WATER SERVICE
	EXISTING ELECTRICAL LINE
	PROPOSED ELECTRICAL LINE
	EXISTING GAS MAIN
	PROPOSED GAS MAIN
	EXISTING SANITARY SEWER
	PROPOSED SANITARY SEWER
	EXISTING STORM SEWER
	PROPOSED STORM SEWER
	OVERHEAD WIRES
	EXISTING POWER POLES
	EXISTING LIGHT POLES
	SANITARY MANHOLE
	FIRE HYDRANT
	EXISTING WATER VALVE
	PROPOSED WATER VALVE
	EXISTING STORM STRUCTURE
	PROPOSED STORM STRUCTURE
	DENOTES EMERGENCY OVERFLOW ROUTE / DRAINAGE PATH
	PROPOSED & EXISTING SPOT GRADE



IN ACCORDANCE WITH WISCONSIN STATUTE 182.0175, DAMAGE TO TRANSMISSION FACILITIES, EXCAVATOR SHALL BE SOLELY RESPONSIBLE TO PROVIDE ADVANCE NOTICE TO THE DESIGNATED "ONE CALL SYSTEM" NOT LESS THAN THREE WORKING DAYS PRIOR TO COMMENCEMENT OF ANY EXCAVATION REQUIRED TO PERFORM WORK CONTAINED ON THESE DRAWINGS, AND FURTHER, EXCAVATOR SHALL COMPLY WITH ALL OTHER REQUIREMENTS OF THIS STATUTE RELATIVE TO EXCAVATOR'S WORK.

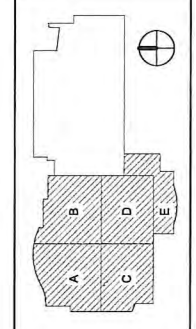

State of Wisconsin
Department of Administration
Division of Facilities
Development
Project Address:
1805 Linden Drive
Madison, WI 53706

Project Title:
Babcock Dairy Plant and Center for Dairy Research
Agency/Institution:
University of Wisconsin - Madison
Sheet Title:
Demo Plan

REVISIONS

No.	Date	Description
09/10/15	Muni.	Review

Graphic: 0' 5' 10' 20' 30'
DFD Number: **13A2U**
Set Type: **PR**
Issue Date: August 11, 2015
Sheet Number: **C1.02**

GENERAL NOTES AND SPECIFICATIONS

- THE EXISTING SITE INFORMATION ON THIS PLAN WAS TAKEN FROM A SITE SURVEY PROVIDED BY CAPITOL SURVEY ENTERPRISES. THE ENGINEER MAKES NO WARRANTY OR REPRESENTATION WITH REFERENCE TO THE ACCURACY AND COMPLETENESS OF THE EXISTING CONDITIONS INDICATED OR NOT INDICATED ON THE ENGINEERING PLANS PROVIDED. THE CONTRACTOR SHALL VERIFY THE LOCATION OF ALL EXISTING SITE CONDITIONS INCLUDING UNDERGROUND UTILITIES, UNDERGROUND UTILITY ELEVATIONS, BUILDING SETBACKS AND EXISTING BUILDING LOCATIONS. THE CONTRACTOR SHALL INFORM THE OWNER AND ENGINEER OF ANY DISCREPANCIES PRIOR TO COMMENCING WORK. QUESTIONS REGARDING THE EXISTING SURVEY SHALL BE DIRECTED TO THE PARTIES LISTED ABOVE.
- BEFORE PROCEEDING WITH ANY UTILITY CONSTRUCTION, CONTRACTOR SHALL EXCAVATE EACH EXISTING LATERAL TO BE CONNECTED TO VERIFYING ELEVATION, LOCATION AND SIZE. SHOULD THE EXISTING UTILITY NOT BE AS INDICATED ON THE PLAN, THE ENGINEER SHALL BE NOTIFIED IMMEDIATELY FOR EVALUATION.
- ALL UTILITY CONSTRUCTION SHALL ADHERE TO THE STANDARD SPECIFICATIONS FOR SEWER AND WATER CONSTRUCTION IN WISCONSIN (2003), AS WELL AS, THE CITY OF MADISON CONSTRUCTION STANDARDS AND THE DEPT. OF SAFETY AND PROFESSIONAL SERVICES SEC. 392.387.
- ALL UTILITY PERMITS MUST BE RECEIVED FROM THE CITY OF MADISON PRIOR TO THE START OF CONSTRUCTION.
- NOTIFY THE PUBLIC WORKS INSPECTION DEPT. AT LEAST 48 HOURS BEFORE STARTING CONSTRUCTION.
- BACKFILL REQUIREMENTS AND ROADWAYS/DEWALK RESTORATION SHALL ADHERE TO LOCAL STANDARDS (GRANULAR BACKFILL UNDER OR WITHIN 5' OF CURBS, SIDEWALK, OR PAVEMENT. SPOIL MAY BE USED ELSEWHERE. SLURRY BACKFILL WILL BE REQUIRED IN PUBLIC ROADWAYS.)
- ALL BUILDING UTILITIES SHALL BE VERIFIED WITH THE ARCHITECTURAL PLANS PRIOR TO CONSTRUCTION.
- ALL PROPOSED WATERMAIN SHALL BE PVC SDR 18, CLASS 150, AWWA C900 WITH ELASTOMERIC JOINTS.
- PROPOSED SANITARY SEWER PIPE SHALL BE PVC, ASTM D-3034, SDR 35 WITH RUBBER GASKETED JOINTS CONFORMING TO ASTM D-3212.
- PROPOSED STORM SEWER SHALL BE PVC, ASTM D-3034, SDR 35 WITH RUBBER ELASTOMERIC JOINTS CONFORMING TO ASTM D-3212 (UNLESS OTHERWISE NOTED).
- UTILITY TRENCHES SHALL BE MECHANICALLY COMPACTED IN ACCORDANCE WITH THE STANDARD SPECIFICATIONS FOR SEWER AND WATER CONSTRUCTION IN WISCONSIN.
- SILT FENCE AND ALL OTHER EROSION CONTROL METHODS MUST BE INSTALLED PRIOR TO COMMENCEMENT OF CONSTRUCTION. ALSO, CONTRACTOR IS RESPONSIBLE FOR REMOVING EROSION CONTROL METHODS ONCE THE SITE IS STABILIZED.
- THE PROPOSED SITE LOCATION AND SURROUNDING STREETS MUST BE KEPT DEBRIS FREE. SWEEP STREETS AS NEEDED TO MAINTAIN CLEAN STREETS.
- ALL EXCAVATED OR STRIPPED MATERIALS NOT BEING REPLACED IN UTILITY TRENCHES OR BEING USED FOR FILL SHALL BE REMOVED FROM THE SITE, UNLESS OTHERWISE DIRECTED BY THE OWNER.
- ALL DISTURBED GRASS AREAS SHALL BE STABILIZED (PER DNR TECHNICAL STANDARDS) WITHIN 7 DAYS OF COMPLETION. DISTURBED GRASS AREAS SHALL BE TOPSOILED (6"), RESEEDED AND STABILIZED. AREAS WITH A SLOPE OF 3H:1V OR STEEPER SHALL BE COVERED WITH A CLASS 1 - TYPE A EROSION FABRIC. (SEE SPECIFICATIONS)
- SEE ARCHITECTURAL PLANS FOR EXACT BUILDING & FOUNDATION DETAILS AND ORIENTATION.
- ALL ON-SITE CONCRETE CURB AND GUTTER TO BE 18" WIDE VERTICAL FACE, UNLESS OTHERWISE NOTED. REVERSE OR REGULAR STYLE CURB DETAILED ON PLANS.
- ALL CURB ELEVATIONS ARE EDGE OF PAVEMENT UNLESS OTHERWISE NOTED. SEE CURB DETAIL FOR TOP OF CURB ELEVATIONS.
- ALL CURB RADII ARE MEASURED TO THE FACE OF CURB UNLESS OTHERWISE NOTED.
- CONTRACTOR SHALL MATCH PROPOSED CONCRETE CURB AND GUTTER, SIDEWALK AND PAVEMENT TO EXISTING IN ELEVATION AND ALIGNMENT.
- REMOVAL OF CURB AND GUTTER, SIDEWALK AND PAVEMENT SHALL BE IN ACCORDANCE WITH THE STANDARD SPECIFICATIONS OF THE WISCONSIN D.O.T.
- ALL CONCRETE FOR CURB AND GUTTER, ROADWAY AND SIDEWALKS MUST CONFORM TO THE STANDARD SPECIFICATIONS FOR READY MIXED CONCRETE. MINIMUM 28 DAY COMPRESSIVE STRENGTH TEST MUST EQUAL 4000 PSI.
- CONTRACTOR IS RESPONSIBLE FOR PROTECTING ALL PROPERTY CORNERS.
- CONTRACTOR IS RESPONSIBLE FOR REPAIRING ANY DAMAGE TO EXISTING UTILITIES OR SITE IMPROVEMENTS. CONTRACTOR SHALL DOCUMENT ALL EXISTING DAMAGE PRIOR TO START OF CONSTRUCTION AND NOTIFY CONSTRUCTION MANAGER OF ANY FINDINGS.
- PROJECT SAFETY ON-SITE SHALL BE THE SOLE RESPONSIBILITY OF THE CONTRACTOR.
- CONTRACTOR IS RESPONSIBLE FOR VERIFYING EXISTING SOIL CONDITIONS, CONSTRUCTION MANAGER MAY HAVE SOILS REPORT FOR MORE INFO.
- CONTRACTOR IS RESPONSIBLE FOR PROVIDING THE OWNER WITH A SET OF MARKED UP PLANS (AS-BUILTS) SHOWING ANY CHANGES DURING CONSTRUCTION.

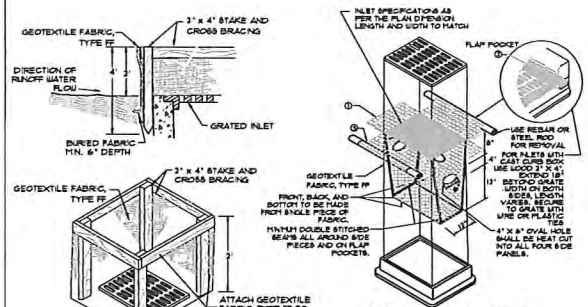

01 INLET PROTECTION TYPE A
NTS

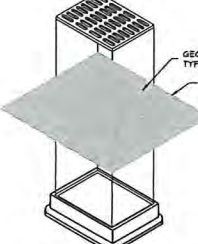

02 INLET PROTECTION TYPE B (WITHOUT CURB BOX)
NTS

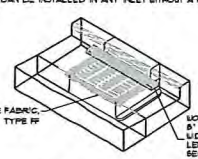

03 INLET PROTECTION TYPE C (WITH CURB BOX)
NTS

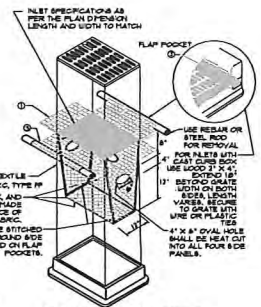

INLET PROTECTION TYPE D
(CAN BE INSTALLED IN ANY INLET WITH OR WITHOUT A CURB BOX AS PER NOTE 10)

GENERAL NOTES:

INLET PROTECTION DEVICES SHALL BE MAINTAINED OR REPLACED AT THE DISCRETION OF THE ENGINEER.

MANUFACTURED ALTERNATIVES APPROVED AND LISTED ON THE DEPARTMENT'S EROSION CONTROL PRODUCT ACCEPTABILITY LIST MAY BE SUBSTITUTED.

WHEN REMOVING INLET PROTECTION, CARE SHALL BE TAKEN SO THAT SEDIMENT TRAPPED ON THE GEOTEXTILE FABRIC DOES NOT FALL ON THE INLET. ANY MATERIAL FALLING INTO THE INLET SHALL BE REMOVED IMMEDIATELY.

FINISHED SIZE, INCLUDING FLAP POCKETS WHERE REQUIRED, SHALL EXTEND A MINIMUM OF 10" AROUND THE PERIMETER TO FACILITATE MAINTENANCE OR REMOVAL.

FOR INLET PROTECTION TYPE C WITH CURB BOX, AN ADDITIONAL 18" OF FABRIC IS WRAPPED AROUND THE CURB AND SECURED WITH STAPLES. THE WOOD FLAP HAND HOLDS THE ENTIRE HEIGHT OF THE CURB BOX OPENING.

FLAP POCKETS SHALL BE LARGE ENOUGH TO ACCEPT WOOD SKI.

INSTALLATION NOTES:

TYPES B & C: TRIM EXCESS FABRIC IN THE FLOW LINE TO WITHIN 3" OF THE GRATE. THE CONTRACTOR SHALL DEMONSTRATE A METHOD OF MAINTENANCE USING A CLEAN FLAP HAND HOLD OR OTHER METHOD TO PREVENT ACCUMULATED SEDIMENT FROM ENTERING THE INLET.

DO NOT INSTALL INLET PROTECTION TYPE D IN AREAS SHALL BE CLEARER THAN 30" MEASURED FROM THE BOTTOM OF THE INLET TO THE TOP OF THE GRATE. TRIM EXCESS FABRIC IN THE FLOW LINE TO WITHIN 3" OF THE GRATE.

THE INSTALLED BAG SHALL HAVE A MINIMUM SIDE CLEARANCE BETWEEN THE INLET WALLS AND THE BAG MEASURED AT THE BOTTOM OF THE OVERFLOW HOLES OF 3". WHERE NECESSARY, THE CONTRACTOR SHALL CNCH THE BAG USING PLASTIC ZIP TIES TO ACHIEVE THE 3" CLEARANCE. THE TIES SHALL BE PLACED AT A MAXIMUM # 4" FROM THE BOTTOM OF THE BAG.

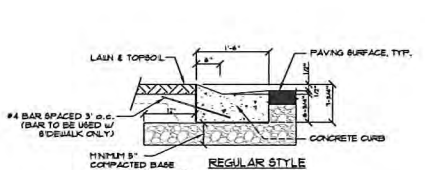

06 DEPRESSED CURB - 18 WIDE
NTS

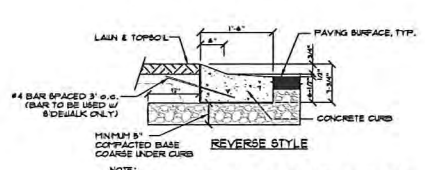

07 REGULAR DUTY PAVEMENT
NTS

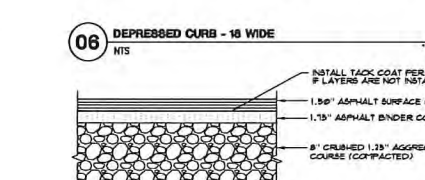

08 HEAVY DUTY PAVEMENT
NTS

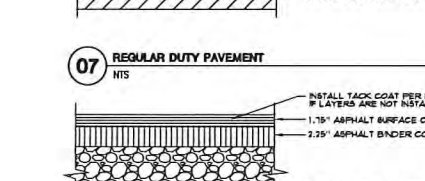

09 CONCRETE PAVEMENT
NTS

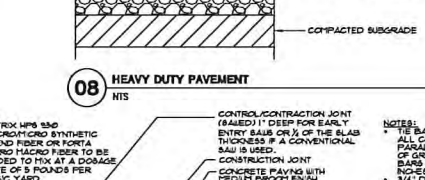

10 CONCRETE SIDEWALK
NTS

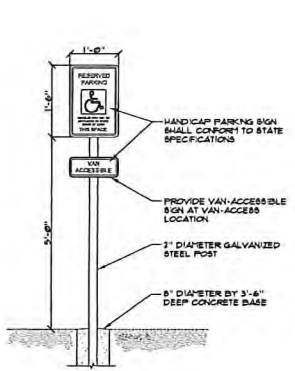

11 HANDICAP SIGN
NTS

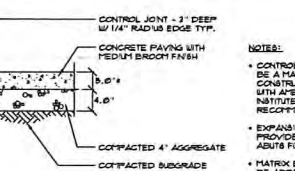

12 CONCRETE SIDEWALK
NTS

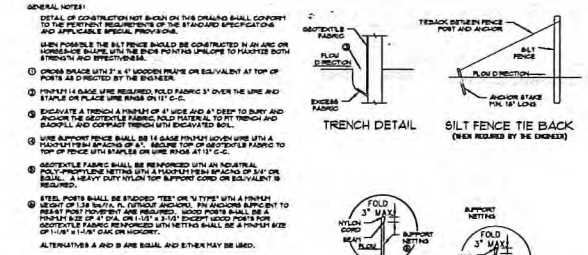

01 SILT FENCE
NTS

02 TRACKING PAD
NTS

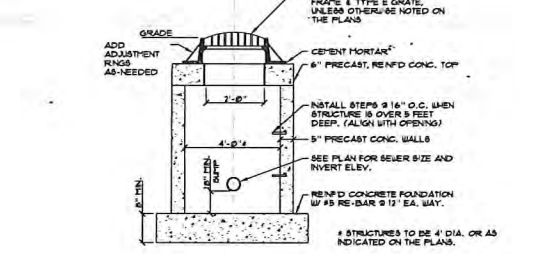

04 CATCH BASIN
NTS

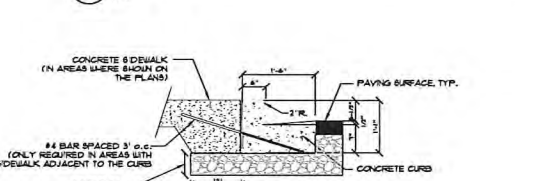

REGULAR STYLE

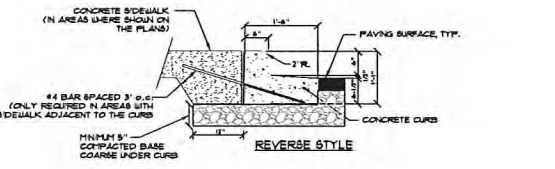

REVERSE STYLE

05 VERTICAL FACE CURB - 18 WIDE
NTS

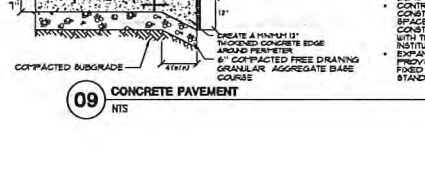

09 CONCRETE PAVEMENT
NTS

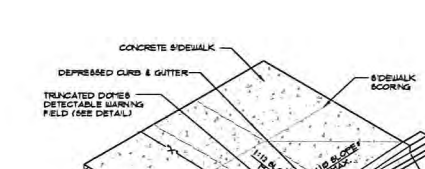

10 HANDICAP RAMP
NTS

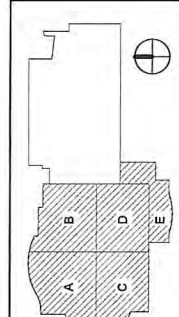

REVISIONS		
No.	Date	Description

Graphic:	
DFD Number:	13A2U
Set Type:	PR
Issue Date:	August 11, 2015
Sheet Number:	C5.00

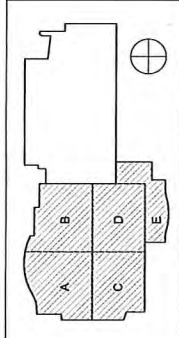
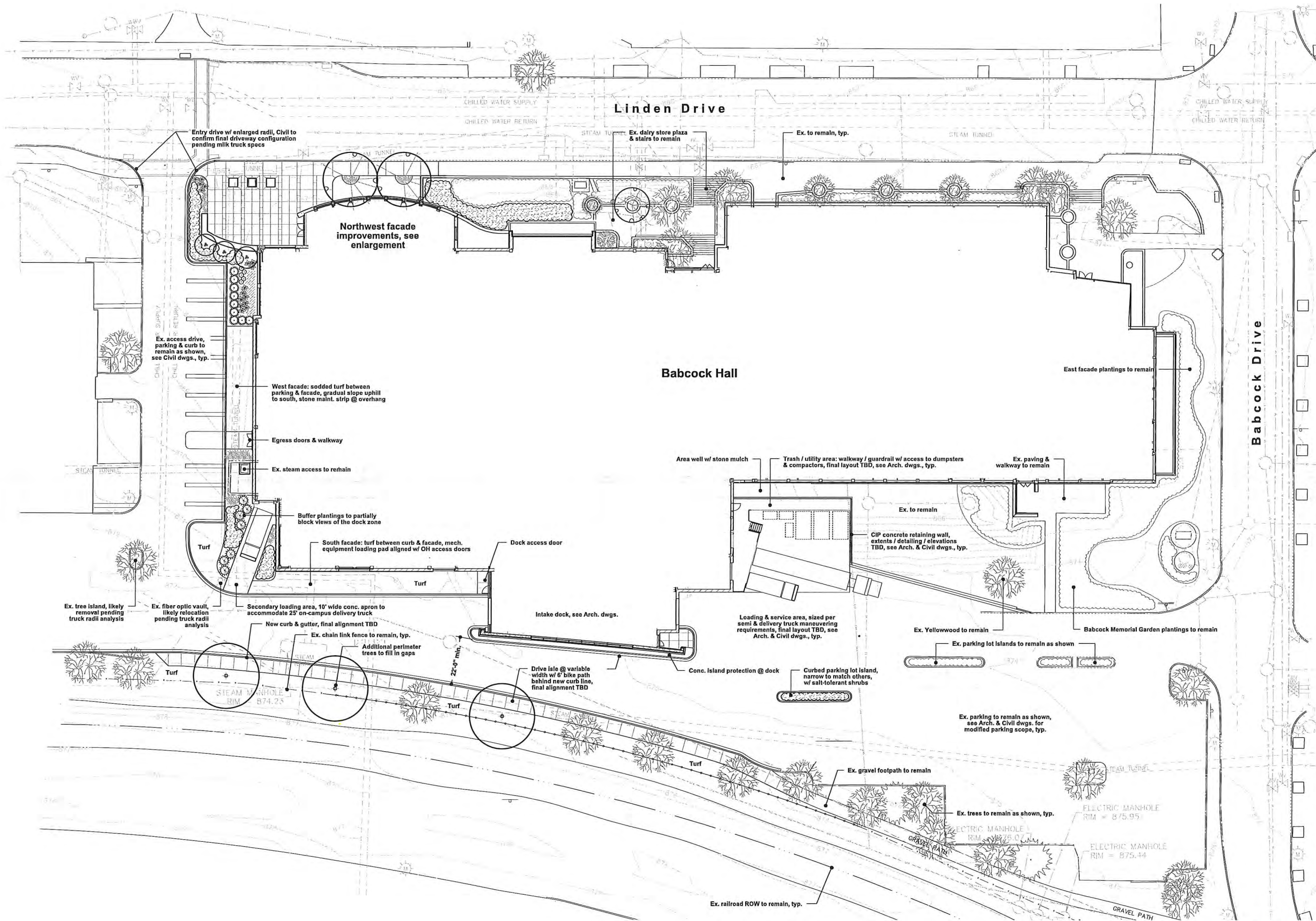

REVISIONS		
No.	Date	Description
09/10/15	Muni. Review	

Graphic:	
DFD Number:	13A2U
ZAS No:	130153.00
Set Type:	PR SET
Issue Date:	September 03, 2015
Sheet Number:	C6.00

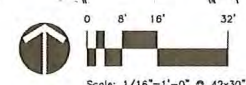

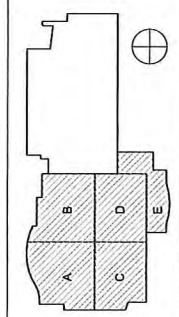
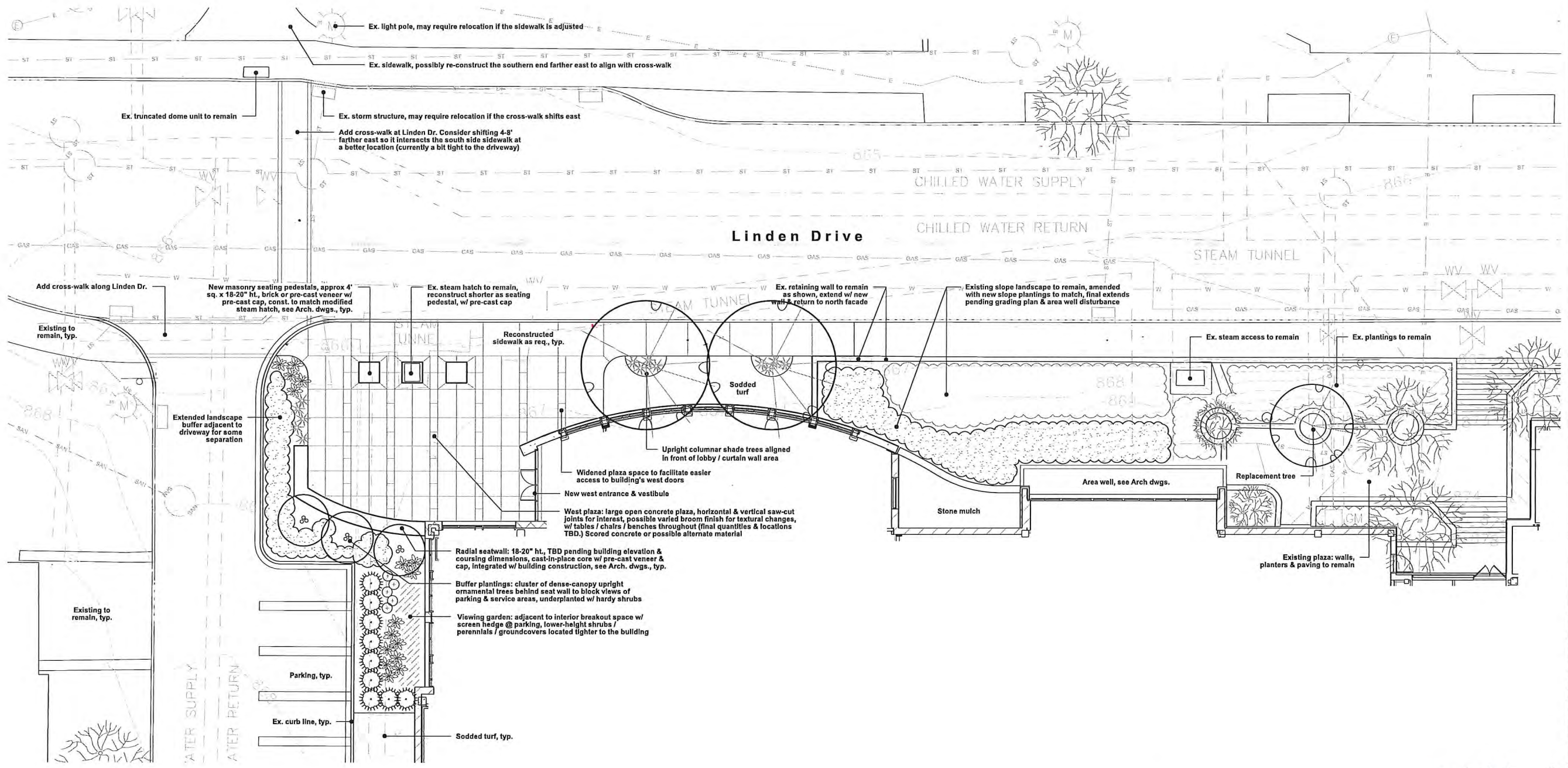

State of Wisconsin
Department of Administration
Division of Facilities Development
Project Address:
1605 Linden Drive
Madison, WI 53706

Project Title:
Babcock Dairy Plant and Center for Dairy Research
University of Wisconsin - Madison
Sheet Title: **LANDSCAPE ENLARGEMENT**
Draft DRB Re-submittal

REVISIONS		
No.	Date	Description
09/10/15		Muni. Review

Graphic:	
DFD Number:	13A2U
ZAS No:	130153.00
Set Type:	PR SET
Issue Date:	September 03, 2015
Sheet Number:	C7.00

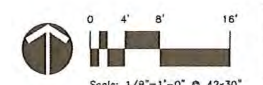

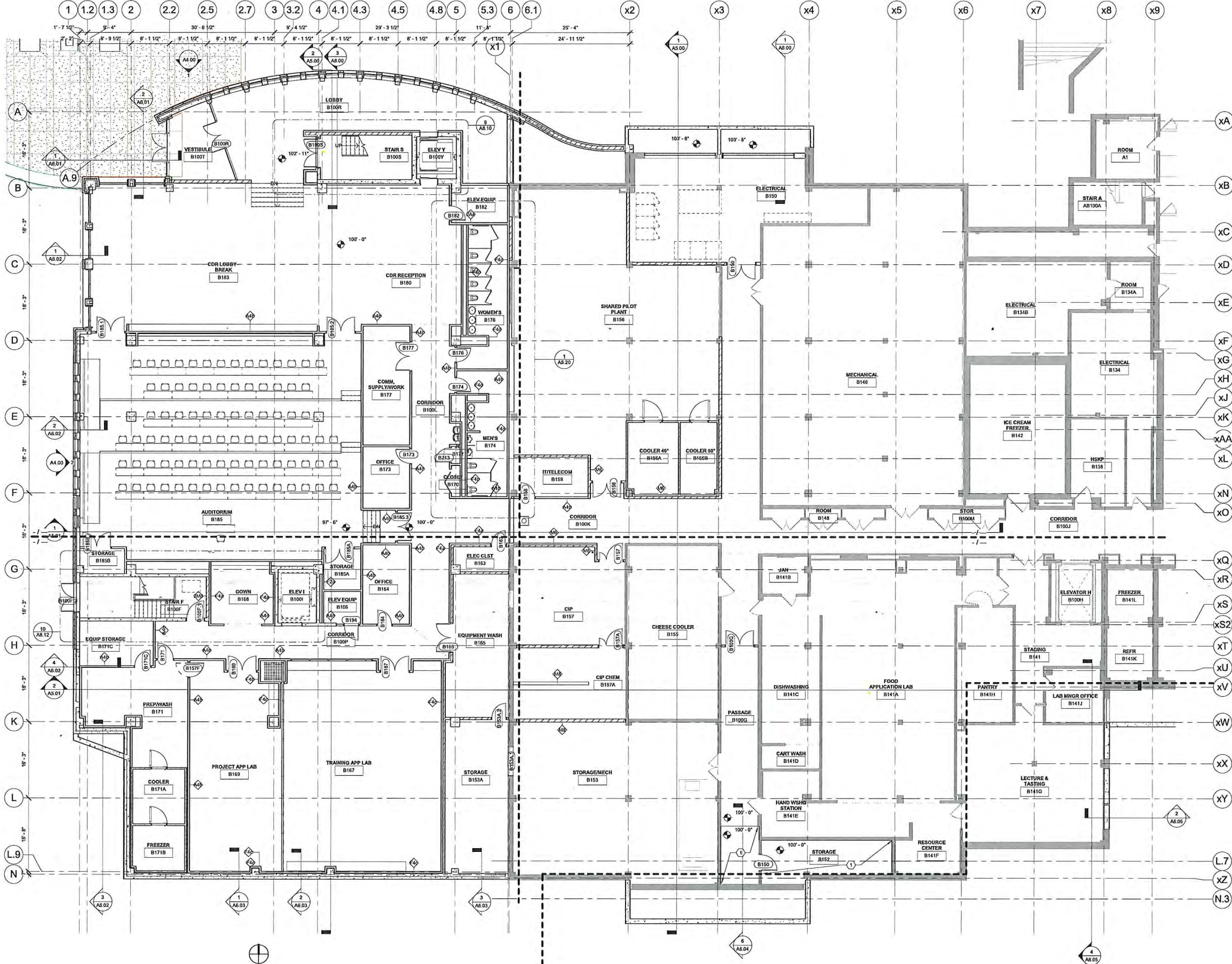

GENERAL NOTES:

- 1) SEE SHEET A4.018 FOR CODE/REGULATORY INFORMATION, ABBREVIATIONS, AND SYMBOLS.
- 2) THE CONTRACTOR SHALL FIELD VERIFY THE EXISTENCE AND LOCATION OF ALL UTILITIES BEFORE COMMENCING WORK. EXCAVATIONS NEAR UTILITIES SHALL BE PERFORMED BY HAND.
- 3) SHORING OR UNDERPINNING OF EXISTING STRUCTURES TO FACILITATE EXCAVATION IS THE CONTRACTOR'S RESPONSIBILITY.
- 4) DAMAGE TO EXISTING STRUCTURES IS THE CONTRACTOR'S RESPONSIBILITY.
- 5) REPAIR ANY WATERPROOFING, EXISTING OR NEW, COMPROMISED DURING CONSTRUCTION ACTIVITIES.
- 6) ARCHITECT TO REVIEW AND APPROVE PHYSICAL LAYOUT OF CO-UTILITIES LOCATIONS PRIOR TO PLACEMENT.
- 7) FOR CLARITY OF DRAWINGS, FIRE PROOFING HAS NOT BEEN SHOWN ON THE PLANS. HOURLY RATINGS FOR STRUCTURAL COMPONENTS IS TO BE PROVIDED PER THE REGULATORY DATA ON SHEET A4.019.
- 8) GENERAL CONTRACTOR AND SUBCONTRACTORS TO FIELD VERIFY ALL DIMENSIONS AND CONDITIONS OF PROJECT WHERE FIRE RATED ASSEMBLY DESIGNS ARE SPECIFIED. CONTRACTOR IS REQUIRED TO MEET THE CONSTRUCTION CRITERIA FOR EACH ASSEMBLY AS SPECIFIED BY THE CURRENT INDEPENDENT TESTING AGENCY'S FIRE RESISTANCE DIRECTORY.
- 9) EXTEND ALL WALL COMPONENTS TO STRUCTURAL DECK UNLESS NOTED OTHERWISE.
- 10) COORDINATE REQUIRED BLOCKING HEIGHT FOR SYSTEMS FURNITURE, CASEWORK, FIRE EXTINGUISHER CABINETS, ELECTRICAL PANELS, TOILET ROOM ACCESSORIES, ETC.
- 11) AT FIRE RATED PARTITIONS, PROVIDE CONTINUOUS FIRE RATED SEALANT AT ALL VERTICAL EDGES AND AT PENETRATIONS IN ACCORDANCE WITH THE CURRENT INDEPENDENT TESTING AGENCY'S FIRE RESISTANCE DIRECTORY.
- 12) ITEMS SHOWN IN GRAY ARE EXISTING TO REMAIN.

PLAN NOTES:

- 1) ROOF INSULATION THICKNESS SHOWN ON THE PLAN ARE FROM THE TOP OF THE APPROVED SUBSTRATE MATERIAL.
- 2) COORDINATE ALL ROOF AND FLOOR DRAWINGS WITH STRUCTURAL AND PLUMBING.
- 3) COORDINATE ALL MECHANICAL WITH CEILING AND STRUCTURAL.

KEYED NOTES:

- 1) INFILL SLAB. SEE STRUCTURAL.
- 2) TUBULAR SKYLIGHT.
- 3) FULLY ADHERED EPDM ON TAPERED XPS TO TIE INTO EXISTING ROOFING SYSTEM.

zimmerman
ARCHITECTURAL STUDIOS, INC.
2123 West North Vernon Avenue, Milwaukee, WI 53233
Voice: 414.478.8600
Website: www.zimmerman.com

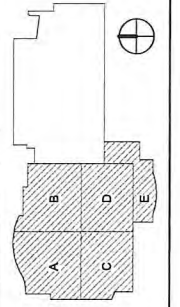

**State of Wisconsin
Department of Administration
Division of Facilities Development**

Project Title: Babcock Dairy Plant and Center for Dairy Research
University of Wisconsin - Madison
Sheet Title: GROUND FLOOR ADDITION

REVISIONS		
No.	Date	Description
09/10/15		Muni. Review

Graphic: _____
DFD Number: 13A2U
ZAS No: 130153.00
Set Type: PR SET
Issue Date: September 10, 2015
Sheet Number: A2.000

1 ENLARGED PLAN - GROUND FLOOR
1/8" = 1'-0"

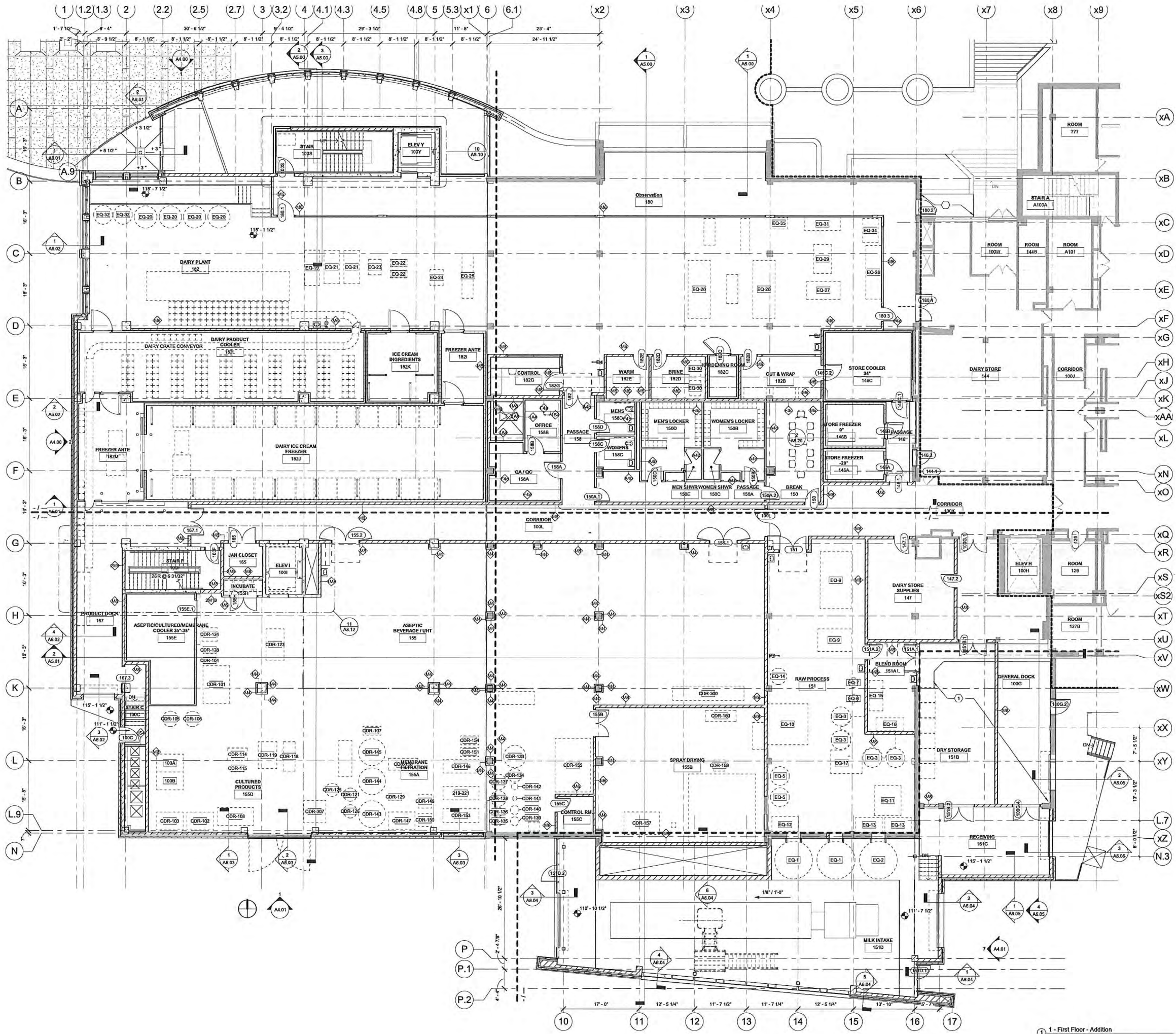

- GENERAL NOTES:**
- SEE SHEET A8.01 FOR CODE REGULATORY INFORMATION, ABBREVIATIONS, AND SYMBOLS
 - THE CONTRACTOR SHALL FIELD VERIFY THE EXISTENCE AND LOCATION OF ALL UTILITIES BEFORE COMMENCING WORK. EXCAVATIONS NEAR UTILITIES SHALL BE PERFORMED BY HAND
 - SHORING OR UNDERPINNING OF EXISTING STRUCTURES TO FACILITATE EXCAVATION IS THE CONTRACTOR'S RESPONSIBILITY
 - DAMAGE TO EXISTING STRUCTURES IS THE CONTRACTOR'S RESPONSIBILITY
 - REPAIR ANY WATERPROOFING EXISTING OR NEW, COMPROMISED DURING CONSTRUCTION ACTIVITIES
 - ARCHITECT TO REVIEW AND APPROVE PHYSICAL LAYOUT OF COLUMN FOOTING LOCATIONS PRIOR TO PLACEMENT
 - FOR CLARITY OF DRAWINGS, FIRE PROOFING HAS NOT BEEN SHOWN ON THE PLANS. HOURLY RATINGS FOR STRUCTURAL COMPONENTS IS TO BE PROVIDED PER THE REGULATORY DATA ON SHEET A8.01
 - GENERAL CONTRACTOR AND SUBCONTRACTORS TO FIELD VERIFY ALL DIMENSIONS AND CONDITIONS OF PROJECT EXISTATIONS IN ACCORDANCE WITH THE CURRENT ROBERTSON TESTING AGENCY'S FIRE RESISTANCE DIRECTORY
 - EXTEND ALL WALL COMPONENTS TO STRUCTURAL DECK UNLESS NOTED OTHERWISE
 - COORDINATE REQUIRED BLOCKING HEIGHT FOR SYSTEMS FURNITURE, CASEWORK, FIRE EXTINGUISHER CABINETS, ELECTRICAL PANELS, TOILET ROOM ACCESSORIES, ETC.
 - AT FIRE RATED PARTITIONS, PROVIDE CONTINUOUS FIRE RATED SEALANT AT ALL VERTICAL EDGES AND AT PENETRATIONS IN ACCORDANCE WITH THE CURRENT ROBERTSON TESTING AGENCY'S FIRE RESISTANCE DIRECTORY
 - ITEMS SHOWN IN GRAY ARE EXISTING TO REMAIN

- PLAN NOTES:**
- ROOF INSULATION THICKNESS SHOWN ON THE PLAN ARE FROM THE TOP OF THE APPROVED SUBSTRATE MATERIAL
 - COORDINATE ALL ROOF AND FLOOR DRAWINGS WITH STRUCTURAL AND FLUING
 - COORDINATE ALL MECHANICAL WITH CEILINGS AND STRUCTURAL

- KEYED NOTES:**
- INFILL SLAB, SEE STRUCTURAL
 - TUBULAR SKYLIGHT
 - FULLY ADHERED EPDM ON TAPERED XPS TO TIE INTO EXISTING ROOFING SYSTEM.

zimmerman
ARCHITECTURAL STUDIOS, INC.
2122 West Mount Vernon Avenue Milwaukee, WI 53233
Voice: 414.478.6500
Website: www.zimmerman.com

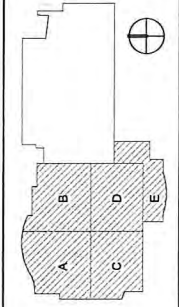

State of Wisconsin
Department of Administration
Division of Facilities Development

Project Title: Babcock Dairy Plant and Center for Dairy Research
Agency/Institution: University of Wisconsin - Madison
Sheet Title: FIRST FLOOR ADDITION

REVISIONS

No.	Date	Description
09/10/15		Muni. Review

Graphic:

DFD Number: 13A2U
ZAS No: 130153.00
Set Type: PR SET
Issue Date: September 10, 2015
Sheet Number: A2.010

1 - First Floor - Addition
1/8" = 1'-0"

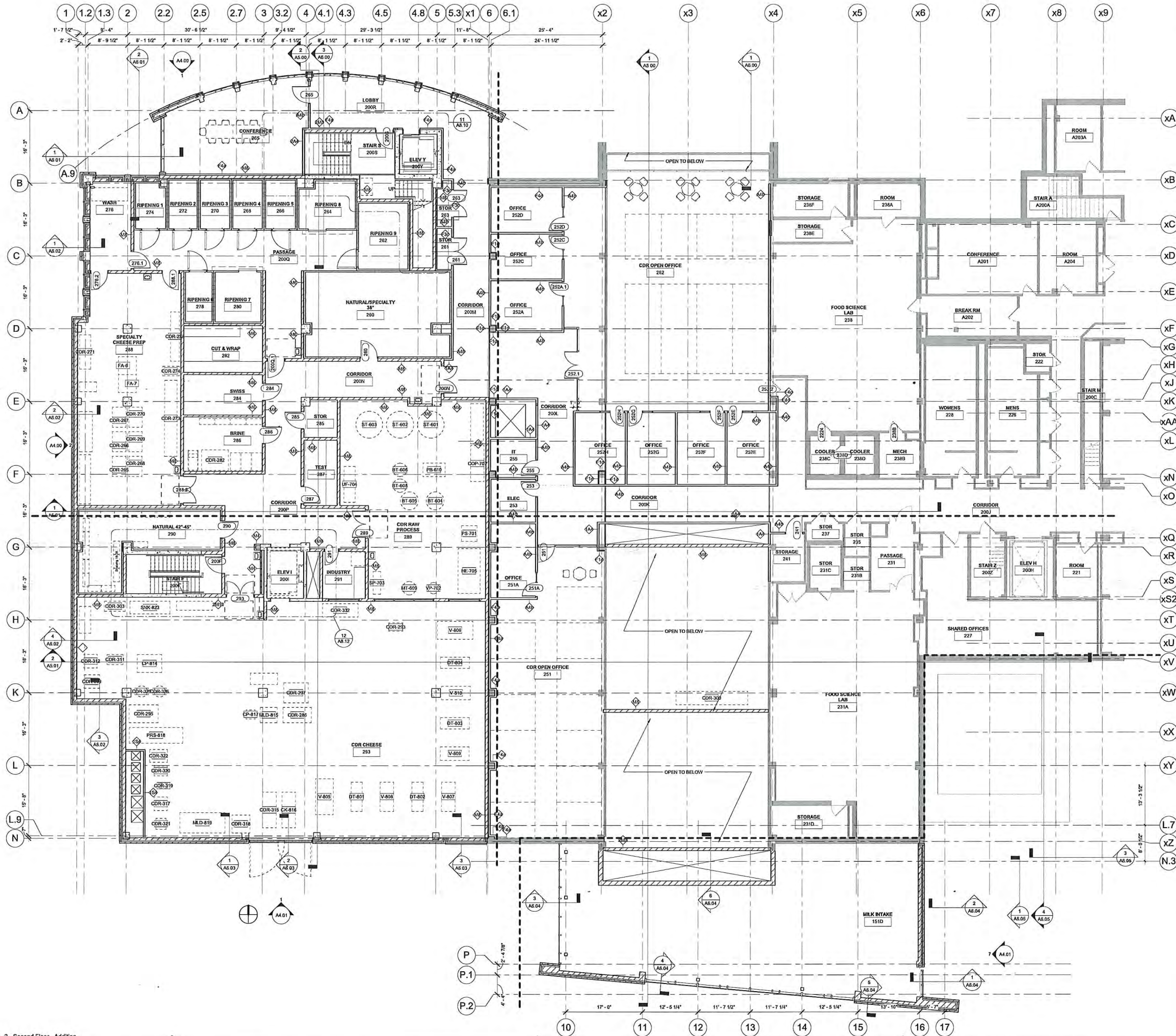

GENERAL NOTES:

- SEE SHEET A8.010 FOR CODE REGULATORY INFORMATION, ABBREVIATIONS, AND SYMBOLS
- THE CONTRACTOR SHALL FIELD VERIFY THE EXISTENCE AND LOCATION OF ALL UTILITIES BEFORE COMMENCING WORK. EXCAVATIONS NEAR UTILITIES SHALL BE PERFORMED BY HAND
- SHORING OR UNDERPINNING OF EXISTING STRUCTURES TO FACILITATE EXCAVATION IS THE CONTRACTOR'S RESPONSIBILITY
- DAMAGE TO EXISTING STRUCTURES IS THE CONTRACTOR'S RESPONSIBILITY
- REPAIR ANY WATERPROOFING, EXISTING OR NEW, COMPROMISED DURING CONSTRUCTION ACTIVITIES
- ARCHITECT TO REVIEW AND APPROVE PHYSICAL LAYOUT OF COLUMN/FOOTING LOCATIONS PRIOR TO PLACEMENT
- FOR CLARITY OF DRAWINGS, FIRE PROOFING HAS NOT BEEN SHOWN ON THE PLANS. HOURLY RATINGS FOR STRUCTURAL COMPONENTS IS TO BE PROVIDED PER THE REGULATORY DATA ON SHEET A8.016
- GENERAL CONTRACTOR AND SUBCONTRACTORS TO FIELD VERIFY ALL DIMENSIONS AND CONDITIONS OF PROJECT
- WHERE FIRE RATED ASSEMBLY DESIGNS ARE SPECIFIED, CONTRACTOR IS REQUIRED TO MEET THE CONSTRUCTION CRITERIA FOR EACH ASSEMBLY AS SPECIFIED BY THE CURRENT INDEPENDENT TESTING AGENCY'S FIRE RESISTANCE DIRECTORY
- EXTEND ALL WALL COMPONENTS TO STRUCTURAL DECK UNLESS NOTED OTHERWISE
- COORDINATE REQUIRED BLOCKING HEIGHT FOR SYSTEMS FURNITURE, CASEWORK, FIRE EXTINGUISHER CABINETS, ELECTRICAL PANELS, TOILET ROOM ACCESSORIES, ETC
- AT FIRE RATED PARTITIONS, PROVIDE CONTINUOUS FIRE RATED SEALANT AT ALL VERTICAL EDGES AND AT PENETRATIONS IN ACCORDANCE WITH THE CURRENT INDEPENDENT TESTING AGENCY'S FIRE RESISTANCE DIRECTORY
- ITEMS SHOWN IN GRAY ARE EXISTING TO REMAIN

PLAN NOTES:

- ROOF INSULATION THICKNESS SHOWN ON THE PLAN ARE FROM THE TOP OF THE APPROVED SUBSTRATE MATERIAL
- COORDINATE ALL ROOF AND FLOOR DRAWINGS WITH STRUCTURAL AND PLUMBING
- COORDINATE ALL MECHANICAL WITH CEILINGS AND STRUCTURAL

KEYED NOTES:

- IN FILL SLAB. SEE STRUCTURAL
- TUBULAR SKYLIGHT
- FULLY ADHERED EPDM ON TAPERED XPS TO THE INTO EXISTING ROOFING SYSTEM

zimmerman
ARCHITECTURAL STUDIO, INC.
2123 West Mount Vernon Avenue Milwaukee, WI 53233
Voice: 414.978.8500
Website: www.zimmermanstudio.com

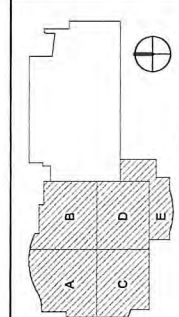

State of Wisconsin
Department of Administration
Division of Facilities Development

Project Title: Babcock Dairy Plant and Center for Dairy Research
Agency/Institution: University of Wisconsin - Madison
Sheet Title: SECOND FLOOR ADDITION

REVISIONS		
No.	Date	Description
09/10/15		Muni. Review

Graphic: _____
DFD Number: 13A2U
Set Type: ZAS No: 130153.00
PR SET
Issue Date: September 10, 2015
Sheet Number: A2.020

2 - Second Floor - Addition

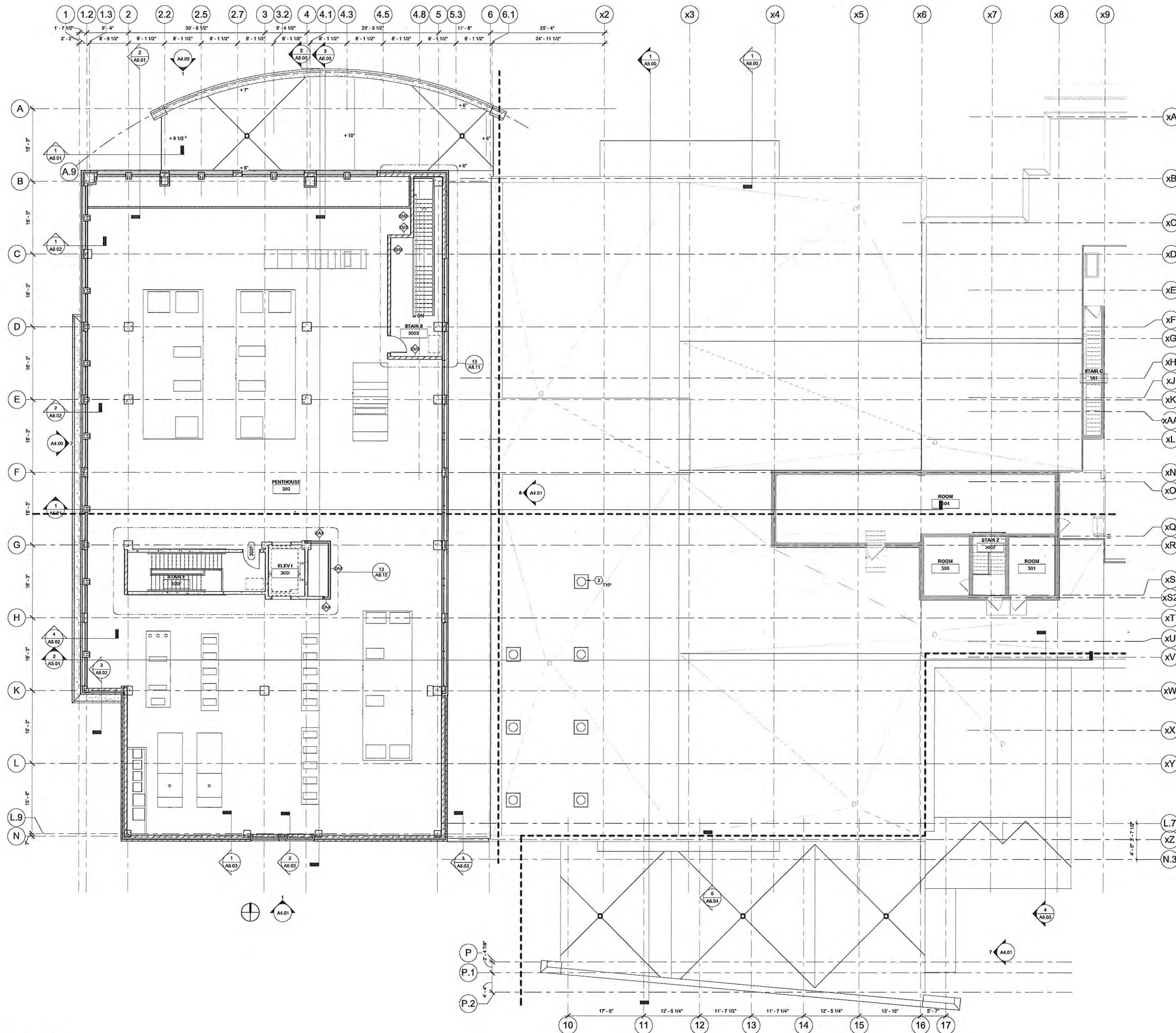

GENERAL NOTES:

- 1) SEE SHEET A0.10 FOR CODE/REGULATORY INFORMATION, ABBREVIATIONS, AND SYMBOLS.
- 2) THE CONTRACTOR SHALL FIELD VERIFY THE EXISTENCE AND LOCATION OF ALL UTILITIES BEFORE COMMENCING WORK. EXERCISE CARE TO PROTECT EXISTING UTILITIES. EXCAVATIONS NEAR UTILITIES SHALL BE PERFORMED BY HAND.
- 3) SHORING OR UNDERPINNING OF EXISTING STRUCTURES TO FACILITATE EXCAVATION IS THE CONTRACTOR'S RESPONSIBILITY.
- 4) DAMAGE TO EXISTING STRUCTURES IS THE CONTRACTOR'S RESPONSIBILITY.
- 5) REPAIR ANY WATERPROOFING, EXISTING OR NEW, COMPROMISED DURING CONSTRUCTION ACTIVITIES.
- 6) ARCHITECT TO REVIEW AND APPROVE PHYSICAL LAYOUT OF COLUMN FOOTING LOCATIONS PRIOR TO PLACEMENT.
- 7) FOR CLARITY OF DRAWINGS, FIRE PROOFING HAS NOT BEEN SHOWN ON THE PLANS. HOURLY RATINGS FOR STRUCTURAL COMPONENTS IS TO BE PROVIDED PER THE REGULATORY DATA ON SHEET A0.01.
- 8) GENERAL CONTRACTOR AND SUBCONTRACTORS TO FIELD VERIFY ALL DIMENSIONS AND CONDITIONS OF PROJECT.
- 9) WHERE FIRE RATED ASSEMBLY DESIGNS ARE SPECIFIED, CONTRACTOR IS REQUIRED TO MEET THE CONSTRUCTION CRITERIA FOR EACH ASSEMBLY AS SPECIFIED BY THE CURRENT INDEPENDENT TESTING AGENCY'S FIRE RESISTANCE DIRECTORY.
- 10) EXTEND ALL WALL COMPONENTS TO STRUCTURAL DECK UNLESS NOTED OTHERWISE.
- 11) COORDINATE REQUIRED BLOCKING HEIGHT FOR SYSTEMS FURNITURE, CASEWORK, FIRE EXTINGUISHER CABINETS, ELECTRICAL PANELS, TOILET ROOM ACCESSORIES, ETC.
- 12) AT FIRE RATED PARTITIONS, PROVIDE CONTINUOUS FIRE RATED SEALANT AT ALL VERTICAL EDGES AND AT PENETRATIONS IN ACCORDANCE WITH THE CURRENT INDEPENDENT TESTING AGENCY'S FIRE RESISTANCE DIRECTORY.
- 13) ITEMS SHOWN IN GRAY ARE EXISTING TO REMAIN.

PLAN NOTES:

- 1) ROOF INSULATION THICKNESS SHOWN ON THE PLAN ARE FROM THE TOP OF THE APPROVED SUBSTRATE MATERIAL.
- 2) COORDINATE ALL ROOF AND FLOOR DRAWINGS WITH STRUCTURAL AND PLUMBING.
- 3) COORDINATE ALL MECHANICAL WITH CEILINGS AND STRUCTURAL.

KEYED NOTES:

- ① INFILL SLAB. SEE STRUCTURAL.
- ② TUBULAR SKYLIGHT.
- ③ FULLY ADHERED EPDM ON TAPERED XPS TO TIE INTO EXISTING ROOFING SYSTEM.

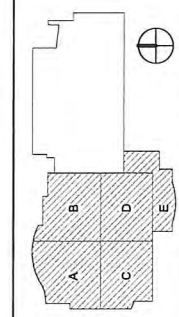

REVISIONS

No.	Date	Description
09/10/15		Muni. Review

3 - Penthouse - Addition

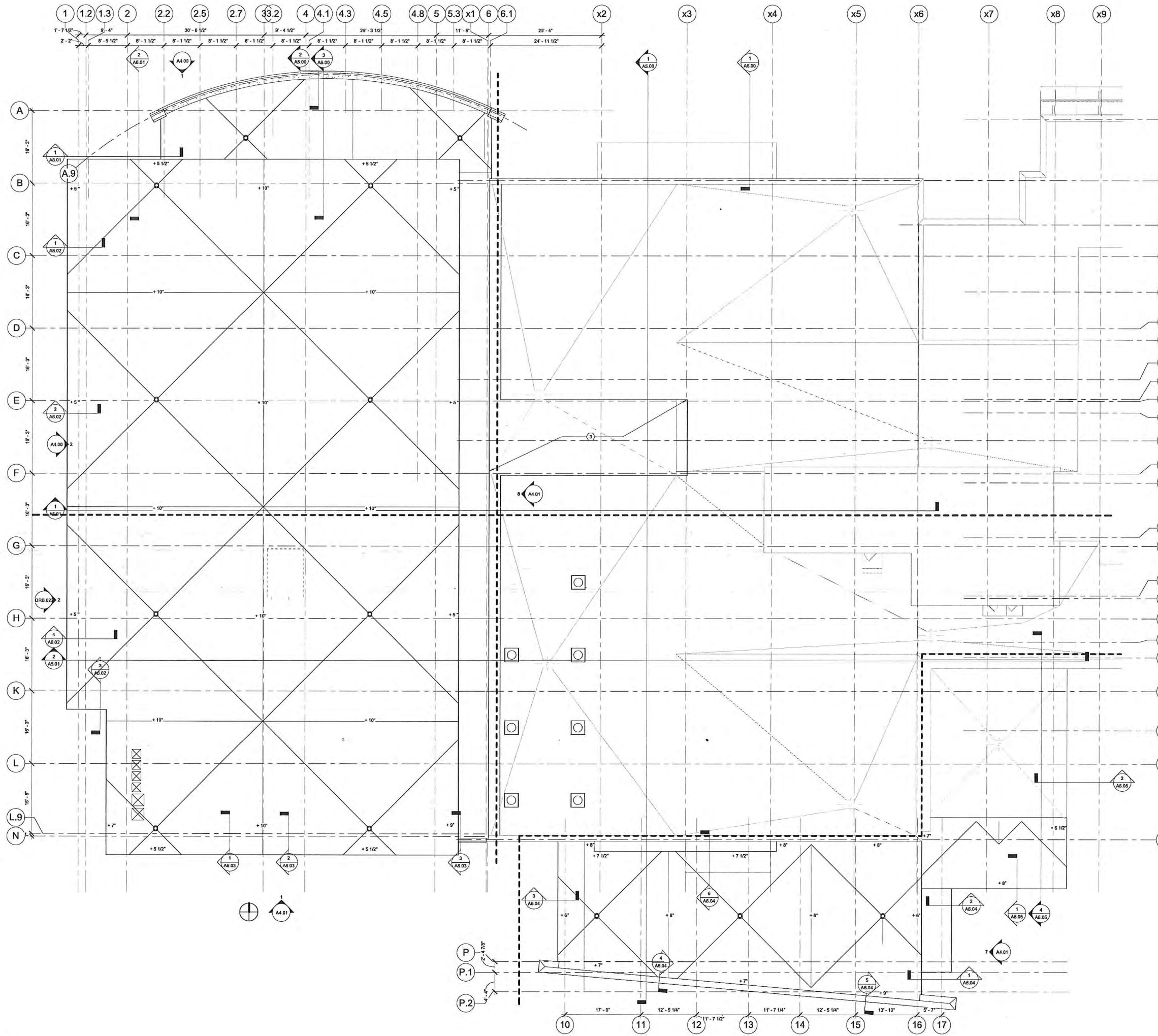

GENERAL NOTES:

- 1) SEE SHEET A0.810 FOR CODE REGULATORY INFORMATION, ABBREVIATIONS, AND SYMBOLS
- 2) THE CONTRACTOR SHALL FIELD VERIFY THE EXISTENCE AND LOCATION OF ALL UTILITIES BEFORE COMMENCING WORK. EXCAVATIONS NEAR UTILITIES SHALL BE PERFORMED BY HAND
- 3) SHORING OR UNDERPINNING OF EXISTING STRUCTURES TO FACILITATE EXCAVATION IS THE CONTRACTORS RESPONSIBILITY
- 4) DAMAGE TO EXISTING STRUCTURES IS THE CONTRACTORS RESPONSIBILITY
- 5) REPAIR ANY WATERPROOFING, EXISTING OR NEW, COMPROMISED DURING CONSTRUCTION ACTIVITIES
- 6) ARCHITECT TO REVIEW AND APPROVE PHYSICAL LAYOUT OF COLUMN/FOOTING LOCATIONS PRIOR TO PLACEMENT
- 7) FOR CLARITY OF DRAWINGS, FIRE PROOFING HAS NOT BEEN SHOWN ON THE PLANS. HOURLY RATINGS FOR STRUCTURAL COMPONENTS IS TO BE PROVIDED PER THE REGULATORY DATA ON SHEET A0.810
- 8) GENERAL CONTRACTOR AND SUBCONTRACTORS TO FIELD VERIFY ALL DIMENSIONS AND CONDITIONS OF PROJECT
- 9) WHERE FIRE RATED ASSEMBLY DESIGNS ARE SPECIFIED, CONTRACTOR IS REQUIRED TO MEET THE CONSTRUCTION CRITERIA FOR EACH ASSEMBLY AS SPECIFIED BY THE CURRENT INDEPENDENT TESTING AGENCY'S FIRE RESISTANCE DIRECTORY
- 10) EXTEND ALL WALL COMPONENTS TO STRUCTURAL DECK UNLESS NOTED OTHERWISE
- 11) COORDINATE REQUIRED BLOCKING HEIGHT FOR SYSTEMS FURNITURE, GASEWORK, FIRE EXTINGUISHER CABINETS, ELECTRICAL PANELS, TOILET ROOM ACCESSORIES, ETC
- 12) AT FIRE RATED PARTITIONS, PROVIDE CONTINUOUS FIRE RATED SEALANT AT ALL VERTICAL EDGES AND AT PENETRATIONS IN ACCORDANCE WITH THE CURRENT INDEPENDENT TESTING AGENCY'S FIRE RESISTANCE DIRECTORY
- 13) ITEMS SHOWN IN GRAY ARE EXISTING TO REMAIN

PLAN NOTES:

- 1) ROOF INSULATION THICKNESS SHOWN ON THE PLAN ARE FROM THE TOP OF THE APPROVED SUBSTRATE MATERIAL
- 2) COORDINATE ALL ROOF AND FLOOR DRAWINGS WITH STRUCTURAL AND PLUMBING
- 3) COORDINATE ALL MECHANICAL WITH CEILINGS AND STRUCTURAL

KEYED NOTES:

- ① INFILL SLAB, SEE STRUCTURAL
- ② TUBULAR SKYLIGHT
- ③ FULLY ADHERED EPDM ON TAPERED XPS TO TIE INTO EXISTING ROOFING SYSTEM.

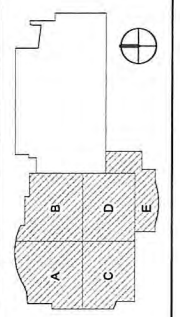

REVISIONS		
No.	Date	Description
09/10/15	Muni. Review	

Graphic:

DFD Number: 13A2U
ZAS No: 130153.00
Set Type: PR SET
Issue Date: September 10, 2015
Sheet Number: A2.040

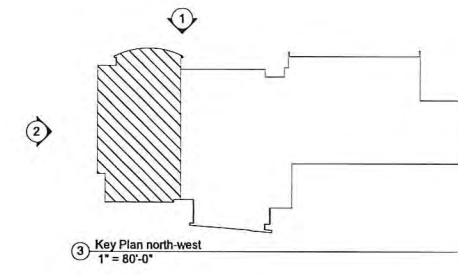

BUILDING MATERIALS

- ① BRICK TO MATCH EXISTING
- ② BRICK JOINT (HORIZONTAL)
- ③ BRICK CONTROL JOINT (VERTICAL)
- ④ BRICK SOLDIER COURSE
- ⑤ ARCHITECTURAL PRECAST CONCRETE PANEL
- ⑥ ALUMINUM FRAMING SYSTEM
- ⑦ CURTAIN WALL
- ⑧ STOREFRONT
- ⑨ GLAZING
- ⑩ VISION
- ⑪ MLK GLASS
- ⑫ METAL PANEL
- ⑬ FLUSH METAL PANEL
- ⑭ RIBBED METAL PANEL
- ⑮ METAL SOFFIT
- ⑯ PREFINISHED METAL LOUVERS
- ⑰ PREFINISHED METAL COPING / TRIM
- ⑱ PRECAST COPING / SILL / TRIM
- ⑲ PRECAST SILL
- ⑳ PRECAST COPING
- ㉑ CAST IN PLACE CONCRETE
- ㉒ PRECAST FIN / FACADE
- ㉓ METAL GUARDRAIL / HANDRAIL
- ㉔ INSULATED EQUIPMENT ACCESS DOORS CLAD IN METAL PANEL

zimmerman
ARCHITECTURAL STUDIOS, INC.
2122 West Mount Vernon Avenue Milwaukee, WI 53233
Phone: 414.476.6500
Website: www.zimmermanstudios.com

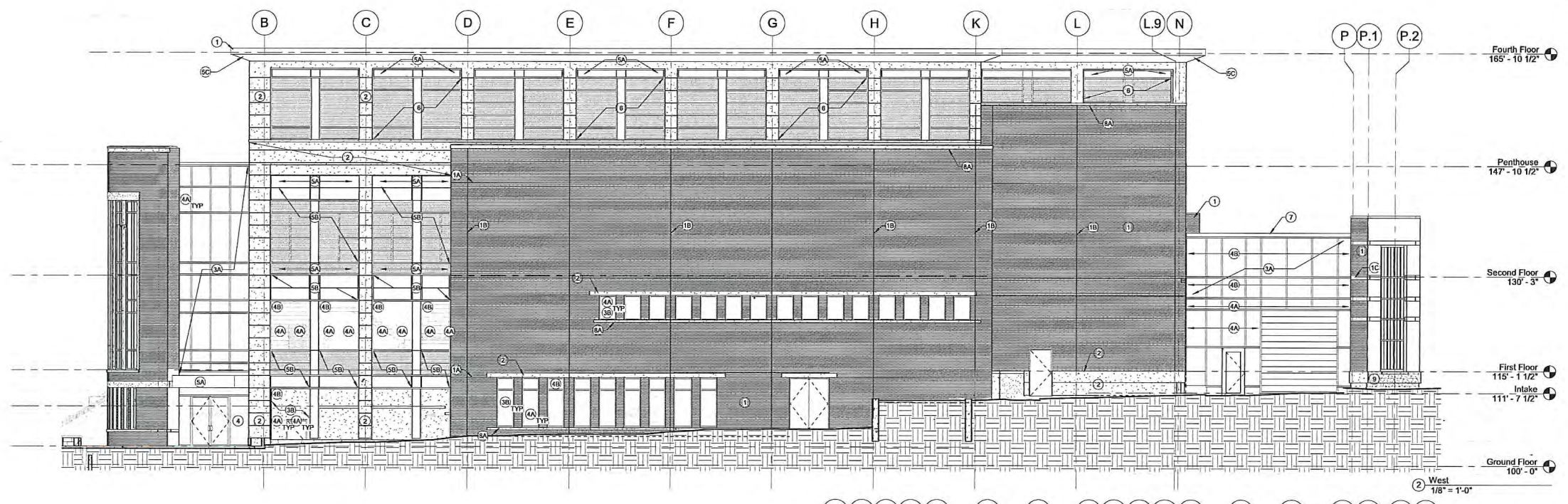

- 6.1
- 6
- 5.3
- 5
- 4.8
- 4.5
- 4.3
- 4.1
- 4
- 3.2
- 3
- 2.7
- 2.5
- 2.2
- 2
- 1.3
- 1.2
- 1

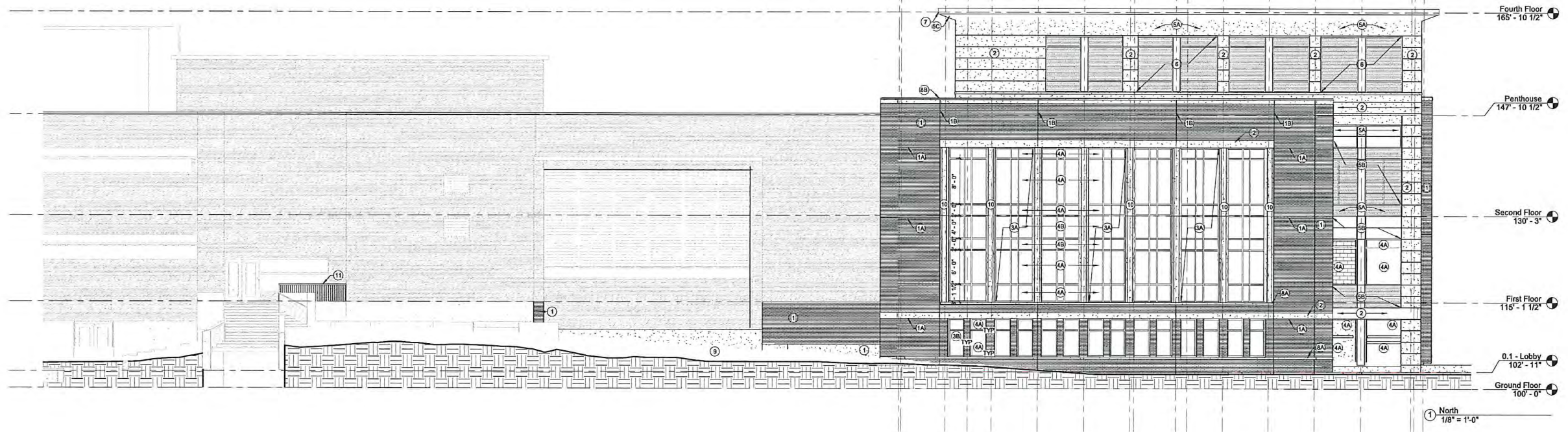

State of Wisconsin
Department of Administration
Division of Facilities Development

Project Title:
Babcock Dairy Plant and Center for Dairy Research
Agency/Institution:
University of Wisconsin - Madison

Project Address:
1685 Linden Drive
Madison, WI 53706

Sheet Title: **EXTERIOR ELEVATIONS**

REVISIONS		
No.	Date	Description
	09/10/15	Muni. Review

Graphic:	
DFD Number:	13A2U
ZAS No:	130153.00
Set Type:	PR SET
Issue Date:	September 10, 2015
Sheet Number:	A4.00

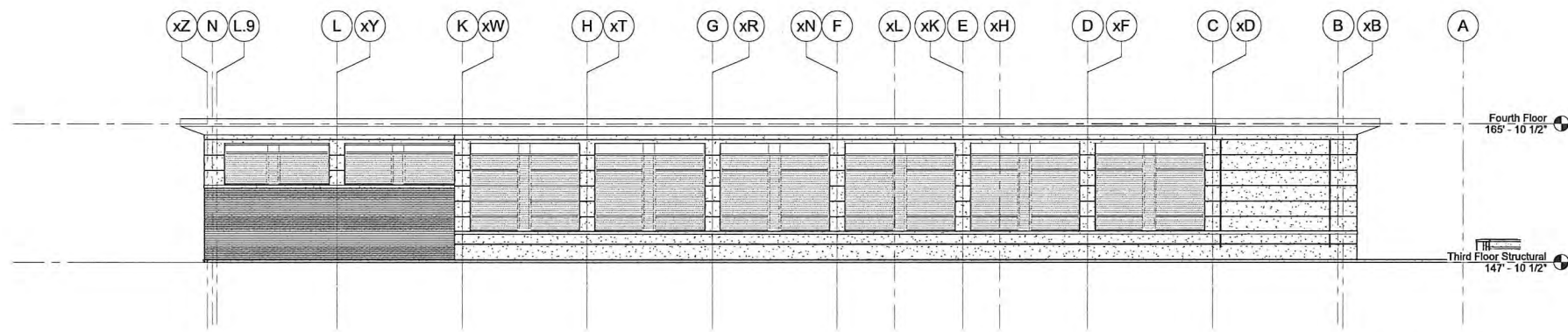

8 East Penthouse Elevation
1/8" = 1'-0"

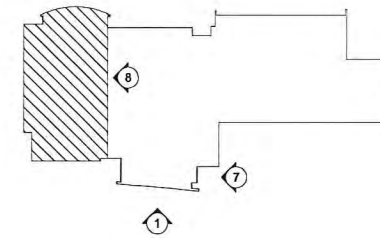

2 Key Plan south
1" = 80'-0"

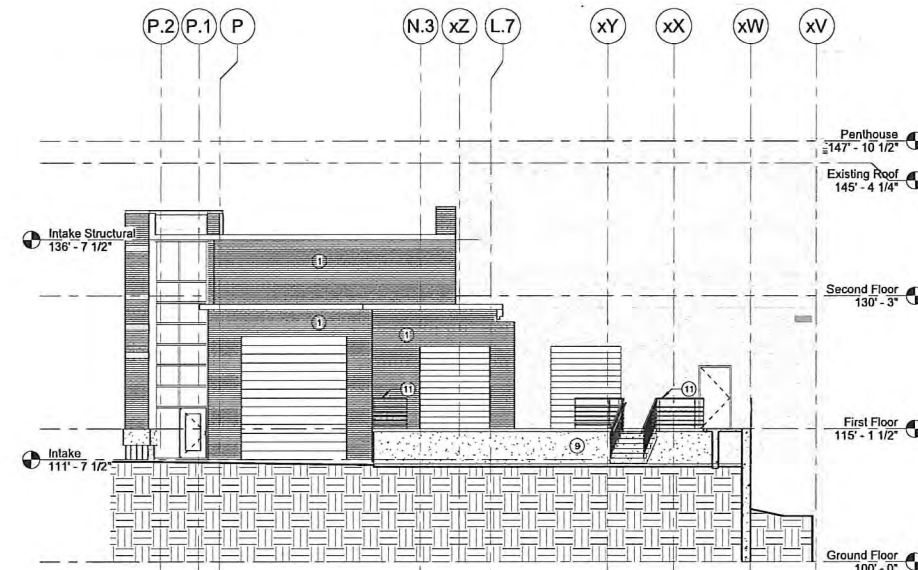

7 Intake East Elevation
1/8" = 1'-0"

BUILDING MATERIALS

- 1 BRICK TO MATCH EXISTING
- 1A BRICK JOINT (HORIZONTAL)
- 1B BRICK CONTROL JOINT (VERTICAL)
- 1C BRICK SOLDIER COURSE
- 2 ARCHITECTURAL PRECAST CONCRETE PANEL
- 3 ALUMINUM FRAMING SYSTEM
- 3A CURTAIN WALL
- 3B STOREFRONT
- 4 GLAZING
- 4A VISION
- 4B MILK GLASS
- 5 METAL PANEL
- 5A FLUSH METAL PANEL
- 5B RIBBED METAL PANEL
- 5C METAL SOFFIT
- 6 PREFINISHED METAL LOUVERS
- 7 PREFINISHED METAL COPING / TRIM
- 8 PRECAST COPING / SILL / TRIM
- 8A PRECAST SILL
- 8B PRECAST COPING
- 9 CAST IN PLACE CONCRETE
- 10 PRECAST FIN / FACADE
- 11 METAL GUARDRAIL / HANDRAIL
- 12 INSULATED EQUIPMENT ACCESS DOORS CLAD IN METAL PANEL

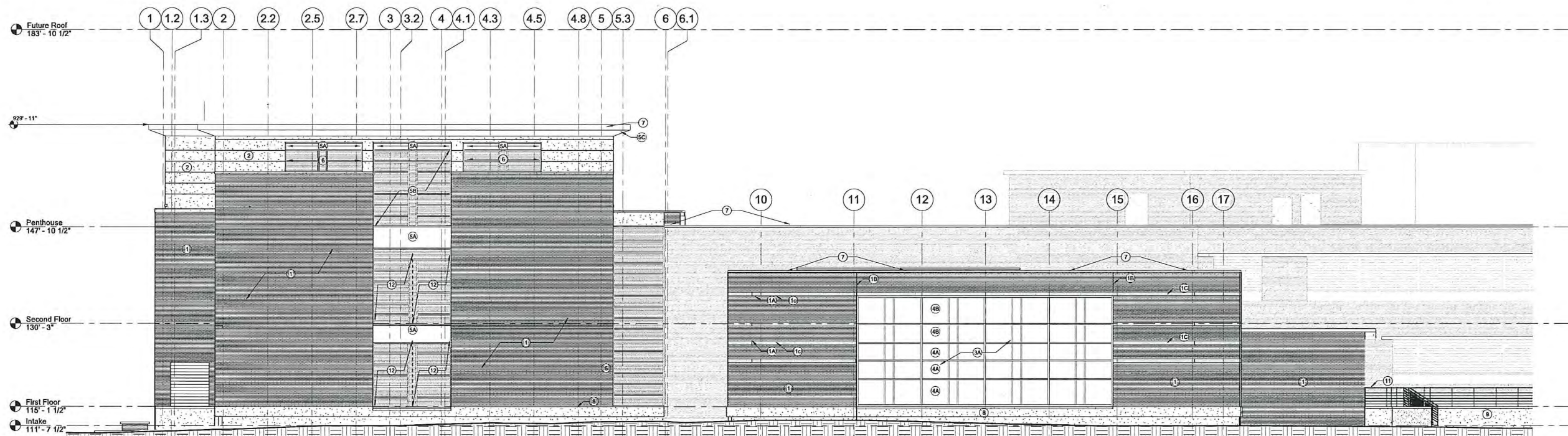

1 South
1/8" = 1'-0"

REVISIONS

No.	Date	Description
09/10/15	Muni. Review	

Graphic:	
DFD Number:	13A2U
ZAS No:	130153.00
Set Type:	PR SET
Issue Date:	September 10, 2015

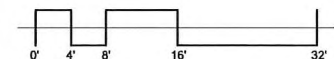
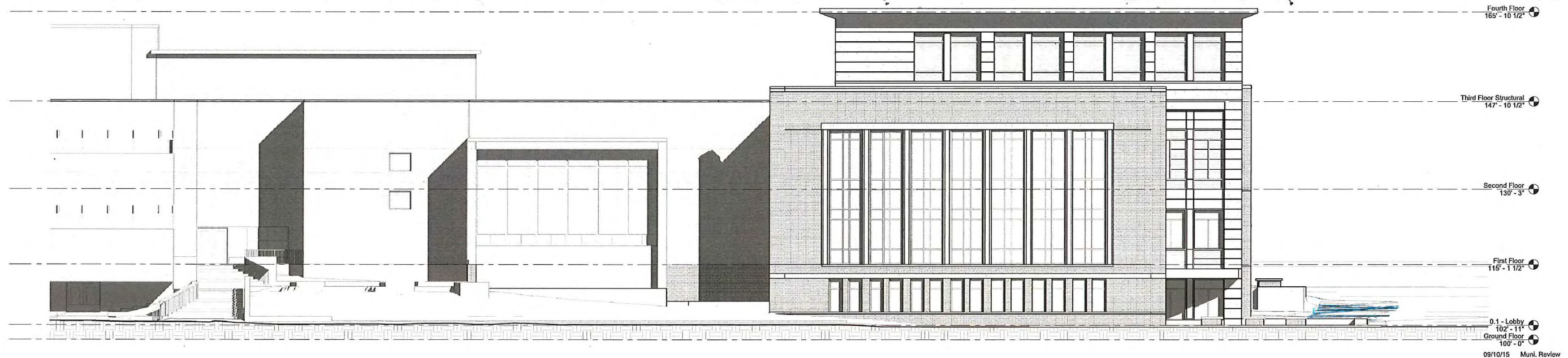

North Elevation

09/10/15
 Zimmerman Project # 130153.00
 Wisconsin DFD Project # 13A2U

Babcock Dairy Plant and Center for Dairy Research

University of Wisconsin - Madison



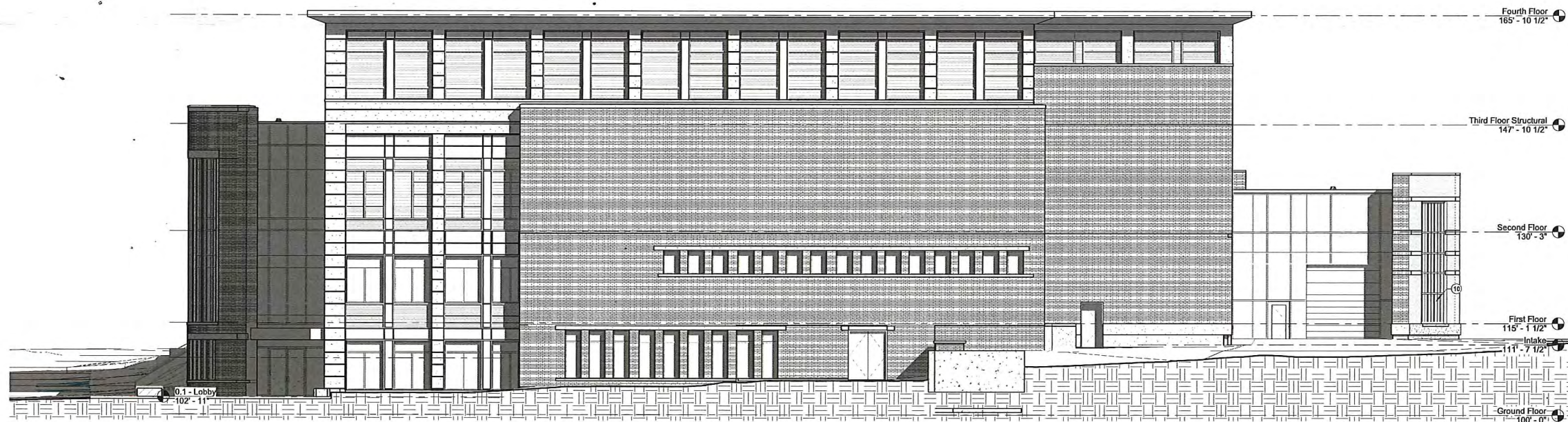

09/10/15 Muni. Review

West Elevation

07/21/15
Zimmerman Project # 130153.00
Wisconsin DFD Project # 13A2U

Babcock Dairy Plant and Center for Dairy Research

University of Wisconsin - Madison



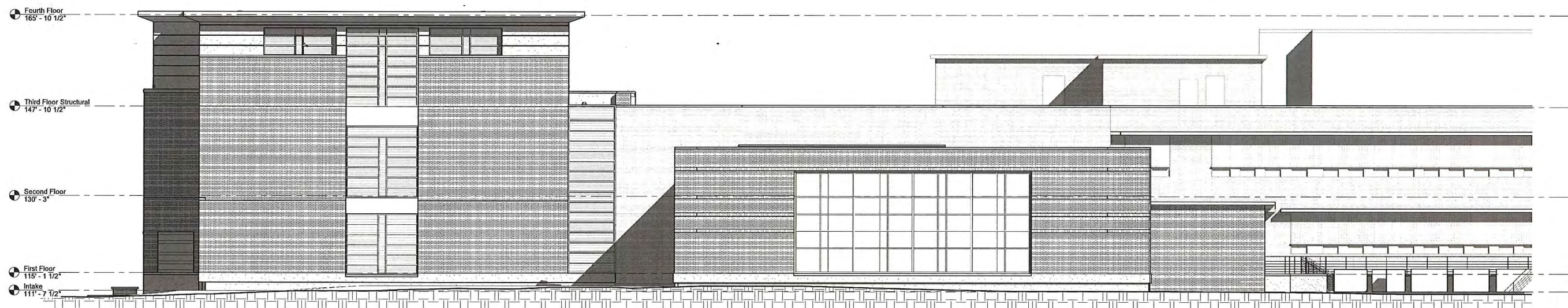

09/10/15 Muni. Review

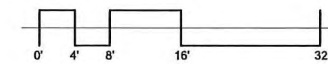

South Elevation

07/21/15
Zimmerman Project # 130153.00
Wisconsin DFD Project # 13A2U

Babcock Dairy Plant and Center for Dairy Research

University of Wisconsin - Madison

