



Department of Public Works
Engineering Division

Residential Survey
Kroncke Drive, Lanett Circle, and Tanager Trail Assessment District – 2021

This survey can also be completed on-line. The link can to the survey can be found on the City's project page at:
<https://www.cityofmadison.com/engineering/projects/kroncke-drive-lanett-circle-tanager-trail-resurfacing-w-utilities>

To mail in a hard copy submission, please send your completed survey to:

Reid Stiteley
City of Madison Engineering
210 Martin Luther King, Jr. Blvd, Rm 115
Madison, WI 53703

Residents have indicated that speeding is a moderate to high concern on Kroncke Drive. The installation of a concrete speed hump has been proposed to deter speeding. The proposed speed hump would be located at approximately 5725 Kroncke Drive because this location is centralized, has sufficient grade for surface water drainage, and is located away from driveways. Only one speed hump is being considered at this time and potential locations are limited due to site conditions. Responses to this survey will be used to gauge neighborhood support and help decide if the issue is brought before the Traffic Commission for input and approval.

Questions

1) Please provide your contact information in case there are any follow up questions from City staff.	
Name (Print)	
Home Address:	
Phone Number:	
Email Address:	

2) Do you support the installation of a concrete speed hump at approximately 5725 Kroncke Drive? The speed hump would be installed during the upcoming street resurfacing and utility project. <input type="checkbox"/> Yes <input type="checkbox"/> No

Summary	
Total # Responses	10
Total "Yes" Responses	7
Total "No" Responses	3

Site Code: 9195P1N1
 Station ID: WO 71388- 5734 Kroncke Dr

File Name: 9195P1N1
 Date Printed: 9/22/2020
 Start Date: 9/15/2020
 End Date: 9/15/2020
 GPS Accuracy: 39.75 ft
 Location Verified: Yes

Latitude: 43.027723
 Longitude: -89.477975
 Direction: Combined

9/15/2020	> 14 -	> 17 -	> 20 -	> 23 -	> 25 -	> 27 -	> 30 -	> 32 -	> 35 -	> 37 -	> 40 -	> 45 -	> 55
Time	0 - 14	17	20	23	25	27	30	32	35	37	40	45	55
	MPH	MPH	MPH	MPH	MPH	MPH	MPH	MPH	MPH	MPH	MPH	MPH	MPH
12:00 AM	0	0	0	0	0	0	0	0	0	0	0	0	0
1:00	0	0	1	0	0	0	0	0	0	0	0	0	0
2:00	0	1	0	0	0	0	0	0	0	0	0	0	0
3:00	0	0	0	0	0	0	0	0	0	0	0	0	0
4:00	0	0	0	0	0	0	0	0	0	0	0	0	0
5:00	0	0	0	0	0	0	0	0	0	0	0	0	0
6:00	0	0	3	3	2	0	1	1	0	0	0	0	0
7:00	2	1	2	2	0	1	0	0	0	1	0	0	0
8:00	4	0	2	2	3	3	0	1	0	0	0	0	0
9:00	1	0	0	0	0	0	0	1	1	0	0	0	0
10:00	0	1	3	1	2	1	0	0	0	0	0	0	0
11:00	1	0	1	4	1	1	2	0	0	1	0	0	0
12:00 PM	2	1	0	3	0	0	1	0	0	0	0	0	0
1:00	0	0	0	3	2	0	1	0	0	0	0	0	0
2:00	0	1	1	4	1	0	1	0	0	0	0	0	0
3:00	0	1	0	3	3	3	4	0	0	0	0	0	0
4:00	0	2	5	3	1	1	0	1	1	0	0	0	0
5:00	1	0	4	6	1	2	1	2	0	0	0	0	0
6:00	0	1	1	4	3	0	0	0	0	0	0	0	0
7:00	0	0	0	3	1	2	0	0	0	0	0	0	0
8:00	0	1	2	1	0	0	0	0	0	0	0	0	0
9:00	0	1	0	0	1	0	0	0	0	0	0	0	0
10:00	0	0	0	1	1	1	0	0	0	0	0	0	0
11:00	0	0	0	1	0	0	1	0	1	0	0	0	0
Total	11	11	25	44	22	15	12	6	3	2	0	0	0

Percentile	15th	50th	85th	95th
Speed	17.2	21.9	27	30.8
Mean Speed (Average)	22.9			
10 MPH Pace Speed	17-26			
Number in Pace	106			
Percent in Pace	75.0%			
Number > 30 MPH	11			
Percent > 30 MPH	7.9%			

Grand Total	11	11	25	44	22	15	12	6	3	2	0	0	0	0	151
--------------------	-----------	-----------	-----------	-----------	-----------	-----------	-----------	----------	----------	----------	----------	----------	----------	----------	------------

Stats	Percentile	15th	50th	85th	95th
	Speed	17.2	21.9	27	30.8
	Mean Speed (Average)	22.9			
	10 MPH Pace Speed	17-26			
	Number in Pace	106			
	Percent in Pace	75.0%			
	Number > 30 MPH	11			
	Percent > 30 MPH	7.9%			

Results - Kroncke Dr Speed Study 2020

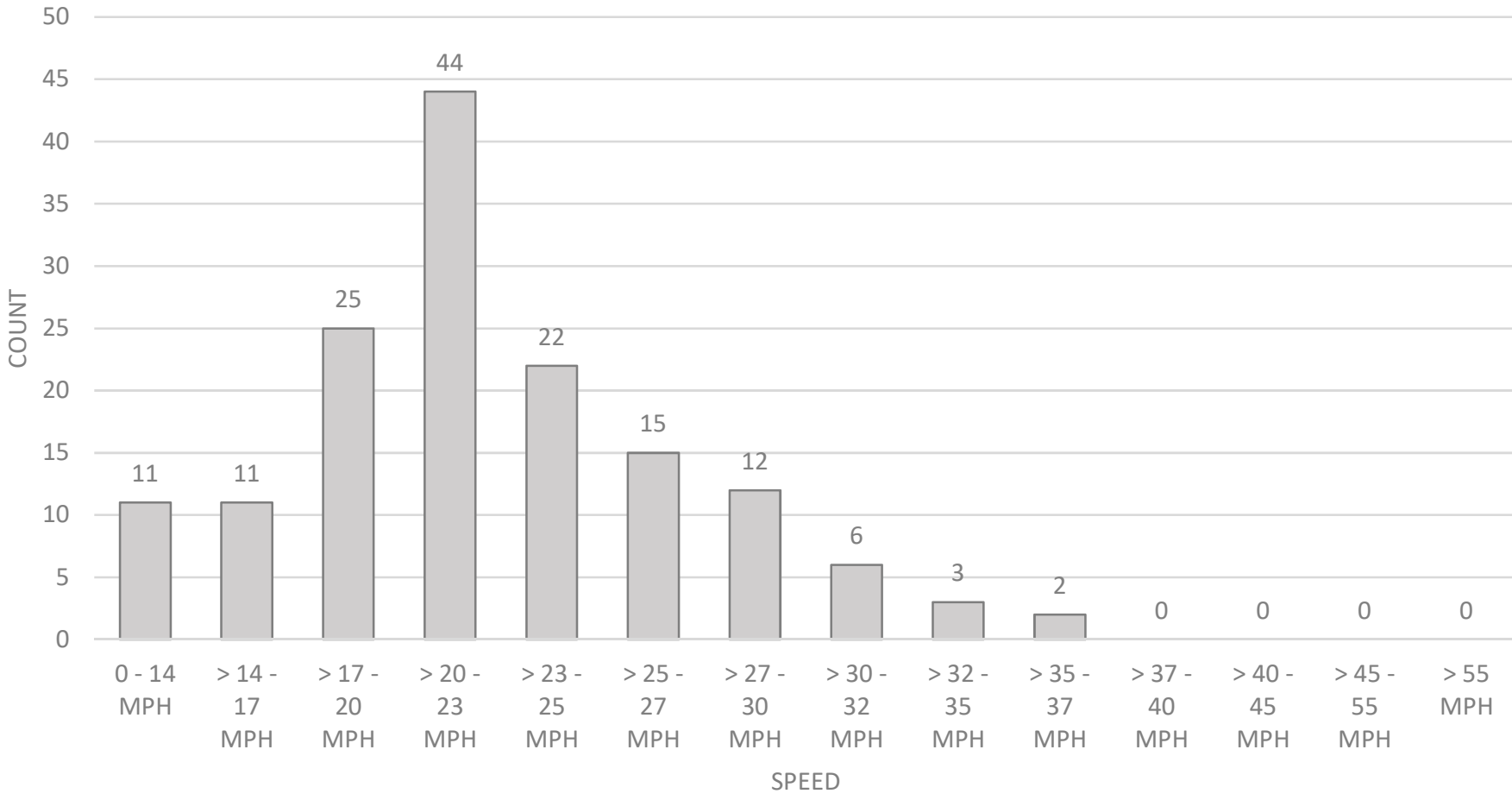

MATCH LINE 205+50.00

MATCH LINE 211+00.00

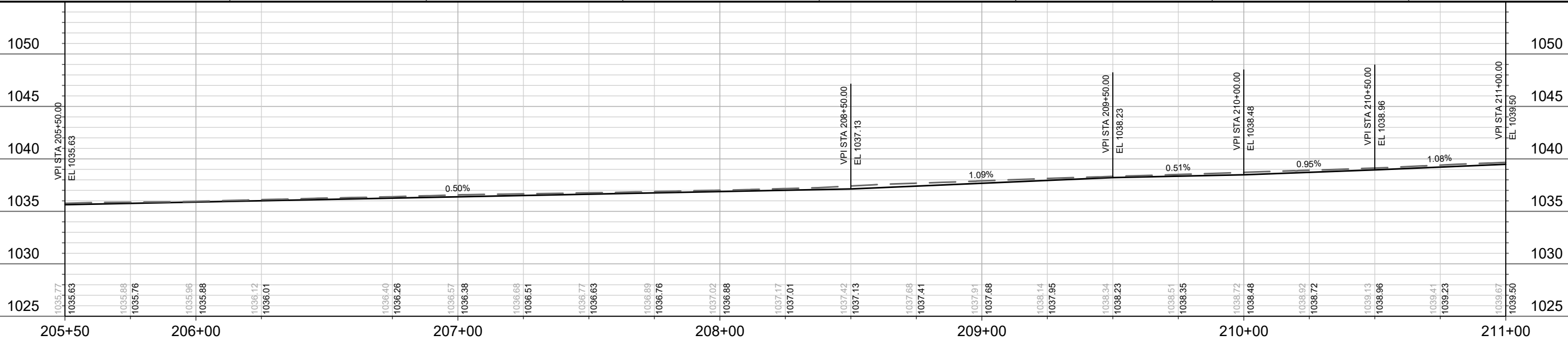
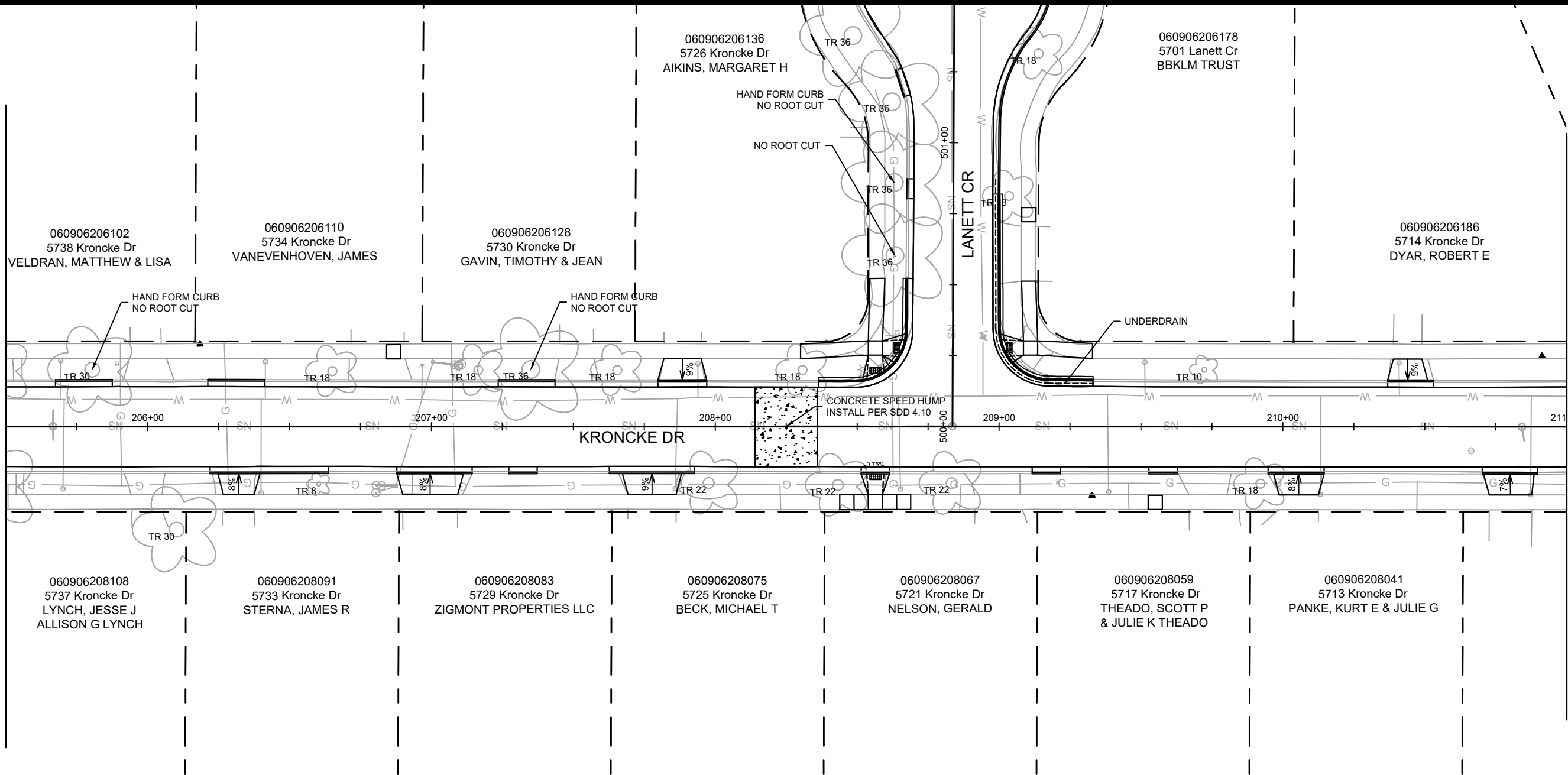

MARK	REVISION	DATE	BY
13179 <td>4/29/2022 4:53 PM <td></td> <td>P-5</td> </td>	4/29/2022 4:53 PM <td></td> <td>P-5</td>		P-5

13179
 STREET PLAN & PROFILE - KRONCKE DR
 KRONCKE DR, LANETT CR, AND Tanager TR ASSESSMENT DISTRICT - 2021MADISON, WI
 CONTRACT NO: 8573
 M:\DESIGN\Projects\13179\CAD\Streets\13179EN-Corridor.dwg

13179
P-5