

James Madison Park Master Plan

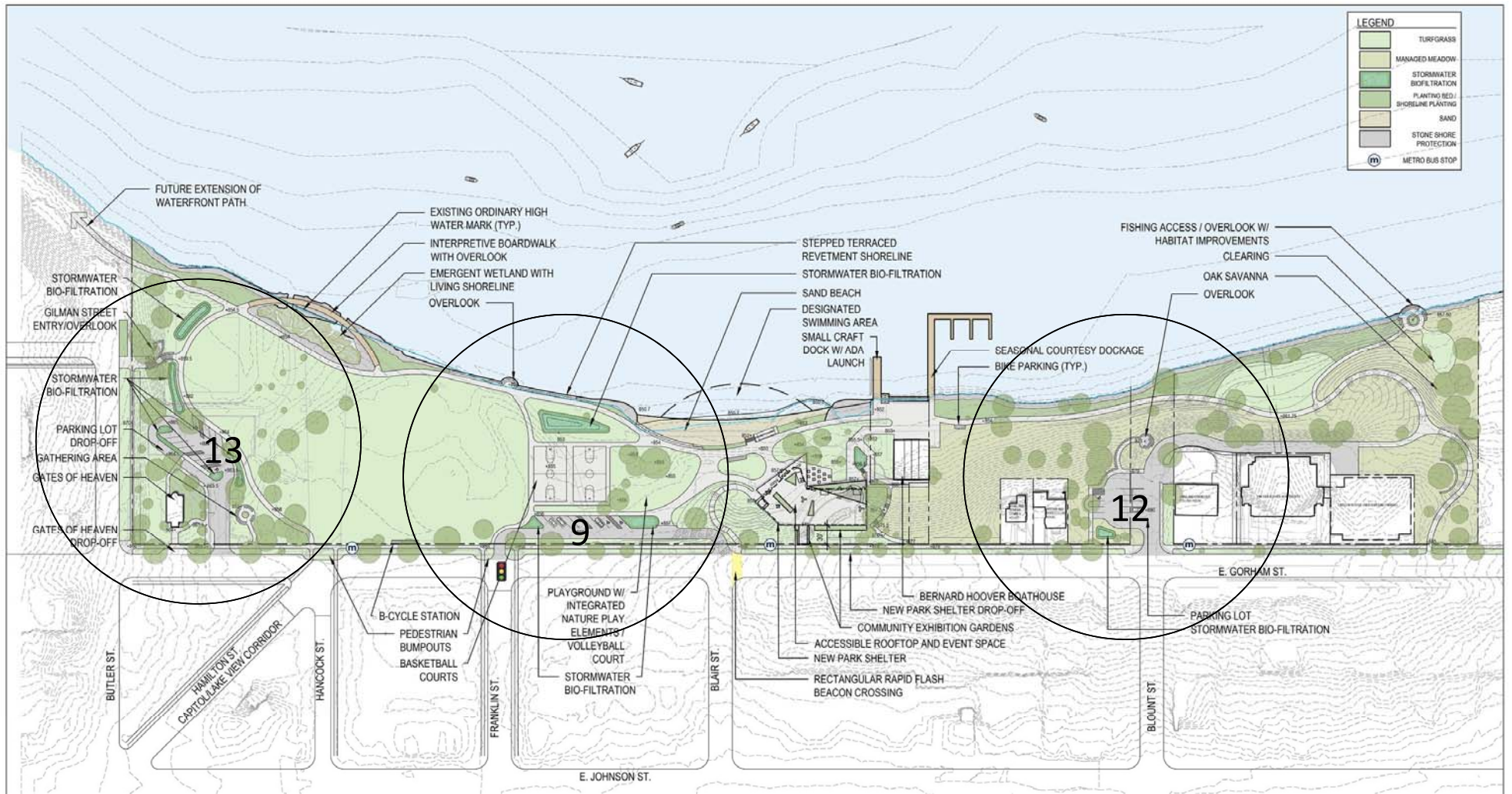

Board of Park Commissioners | February 13, 2019





1 JAMES MADISON PARK MASTER PLAN - FINAL MASTER PLAN
SCALE: 1" = 80'-0"



FINAL MASTER PLAN

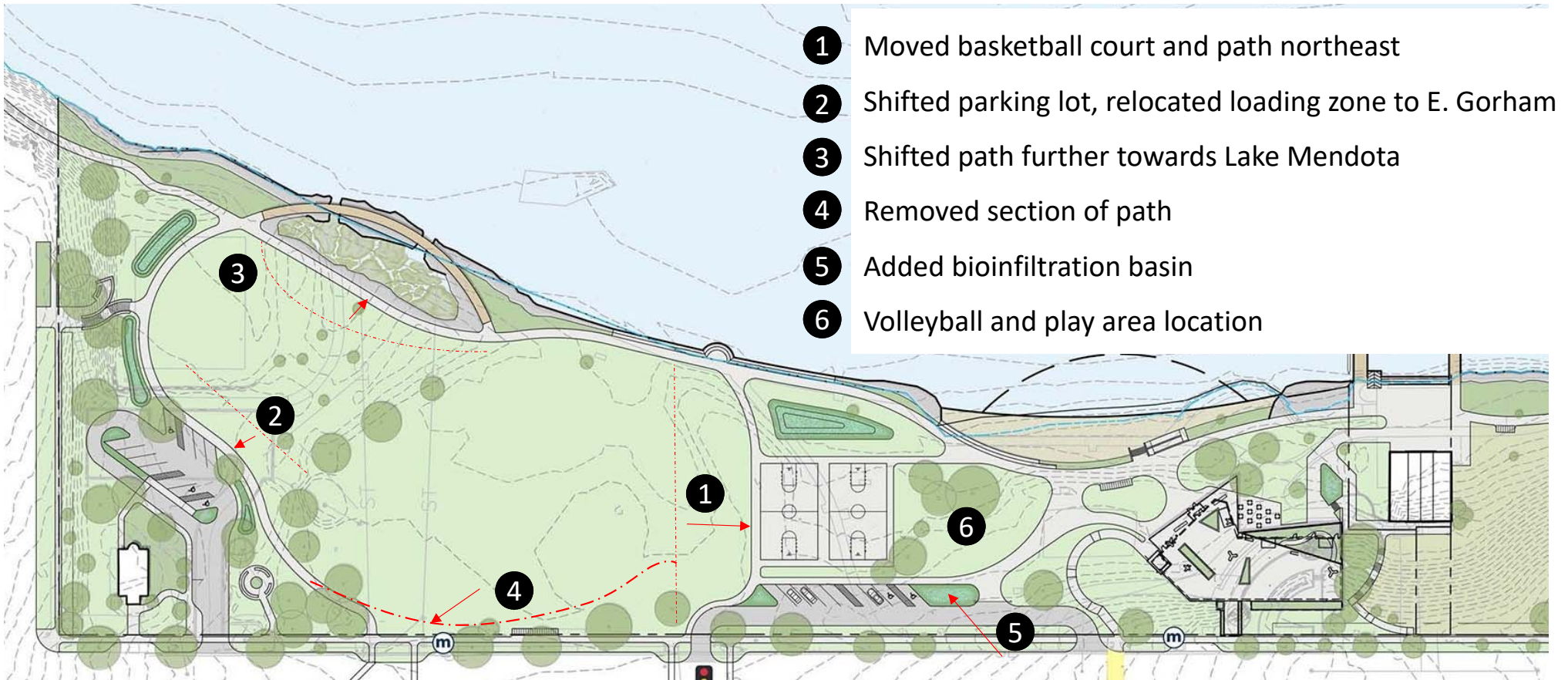

FINAL MASTER PLAN

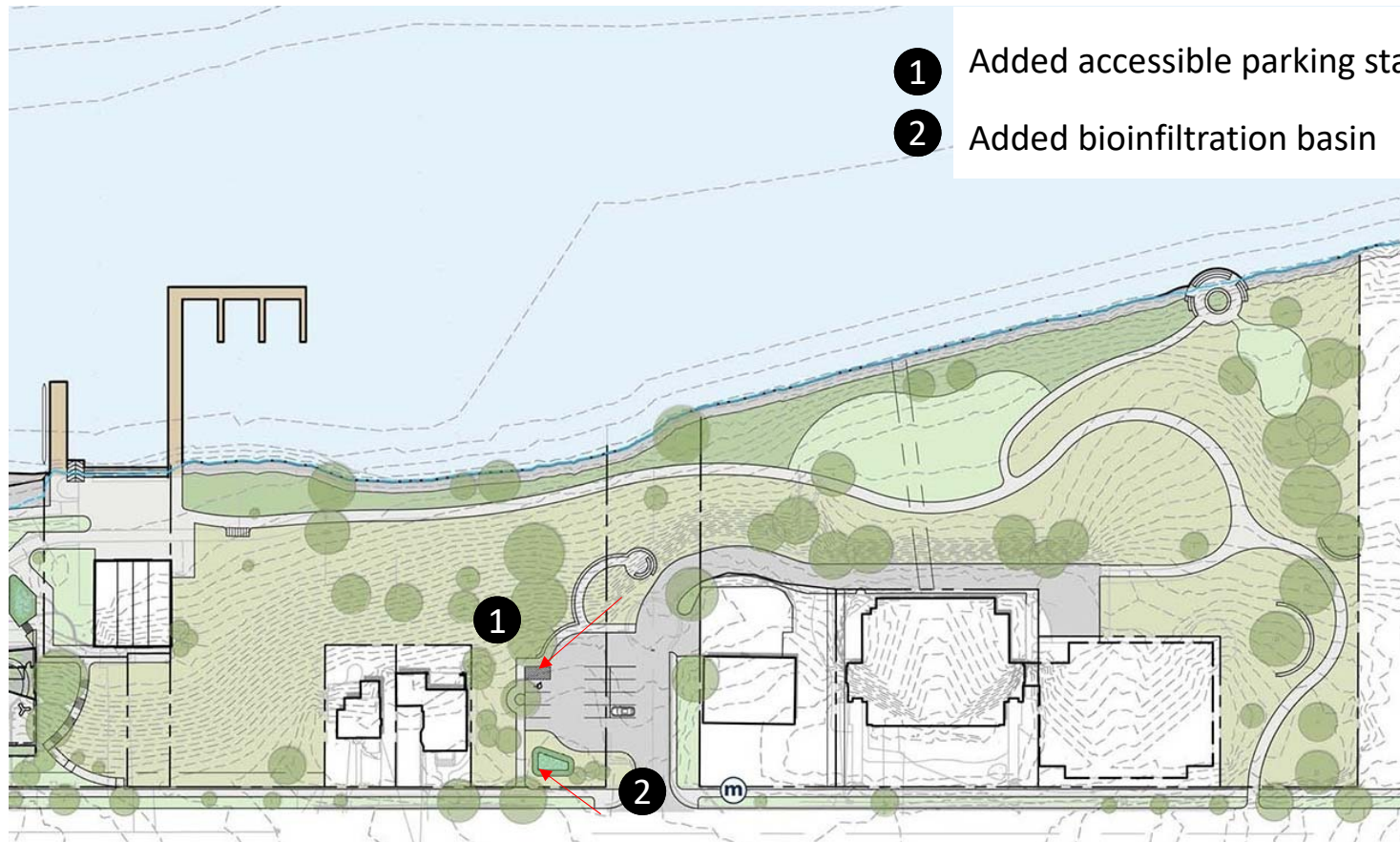

Additional Information

- Trees
- Views
- Surface Area Comparison
- Supporting Plans



Trees

- > 150 trees surveyed
- Change from 16 (December draft plan) to 12 trees (February draft plan) for potential conflict
- 8 of 12 trees are invasive, poor health, or ash
- Continue to allow neighborhood to adopt ash trees until plan is implemented

Views along E. Gorham



Lincoln School and
Garage

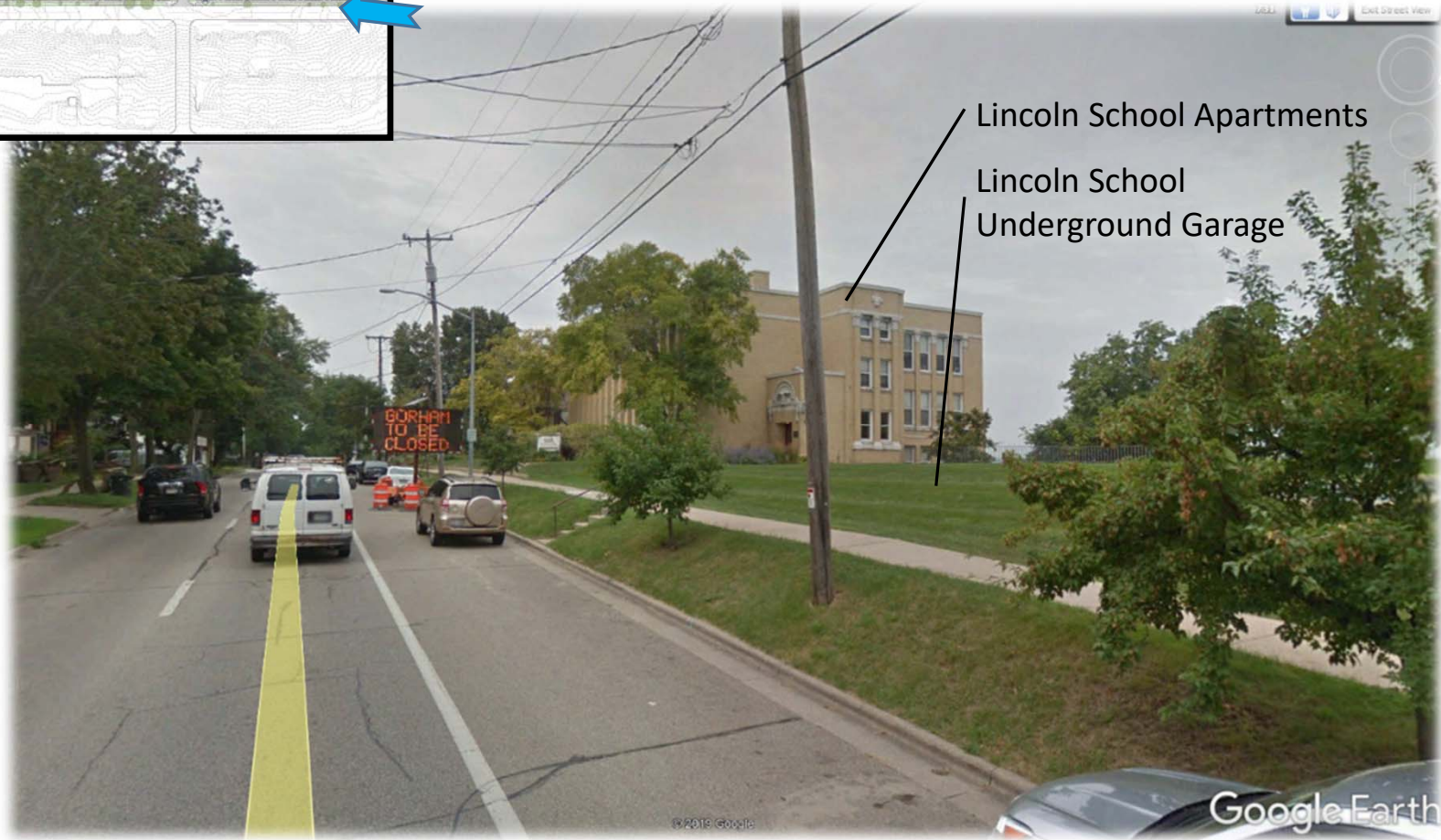

Lincoln School Apartments
Lincoln School
Underground Garage

Views along E. Gorham St.



Mendota Lake House
B&B



Mendota Lake
House Bed
and Breakfast

Google Earth

Views along E. Gorham St.

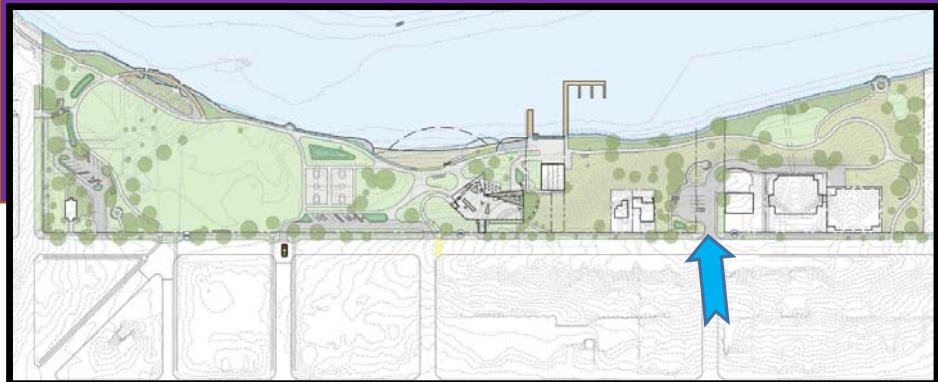

N. Blount Street



Bioinfiltration

Parking Lot Expanded

Overlook

Google Earth

Views along E. Gorham St.

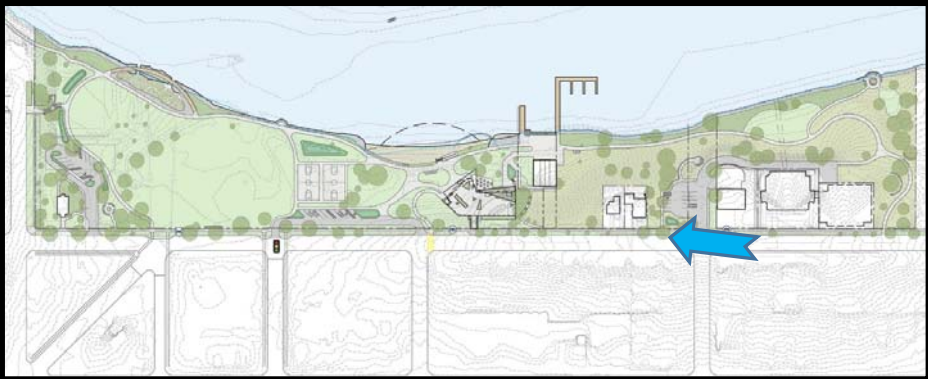

640 E. Gorham Street

646 E. Gorham Street



Historic Home
Single Family
Residence

Historic Home
Multi-family
Apartment
Building

Google Earth

Views along E. Gorham St.

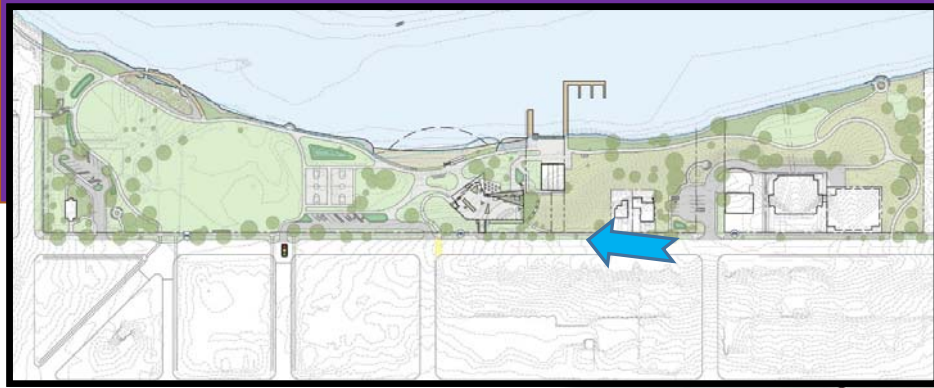

Bernard – Hoover
Boathouse

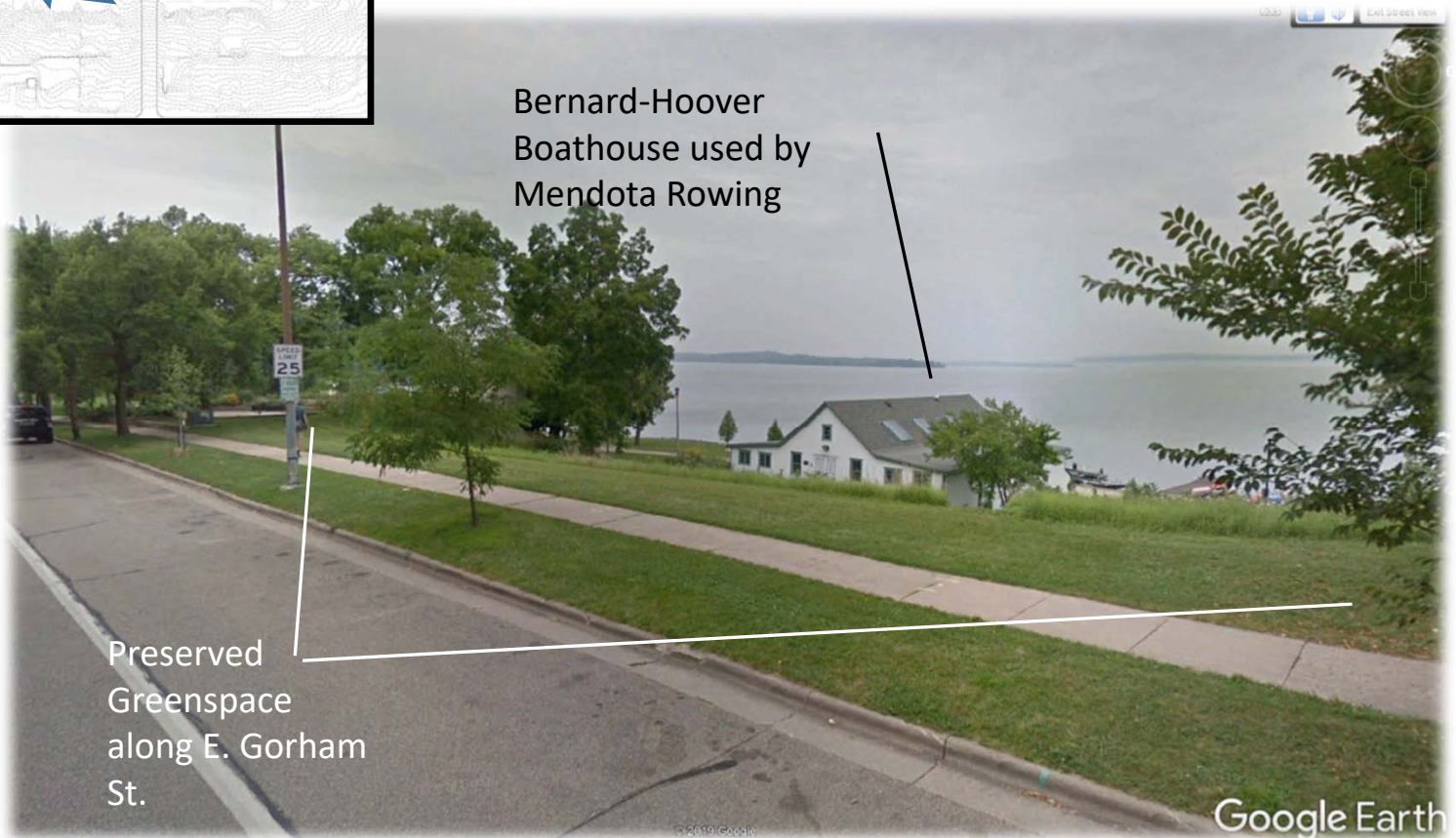

Bernard-Hoover
Boathouse used by
Mendota Rowing

Preserved
Greenspace
along E. Gorham
St.

Google Earth

Views along E. Gorham St.

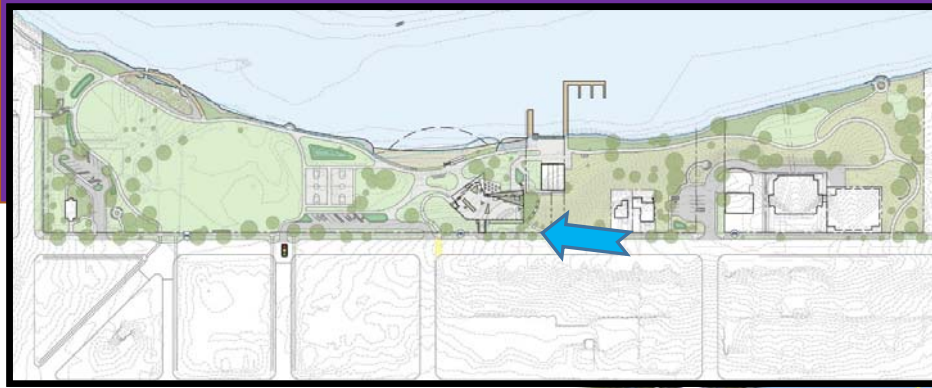

Park Shelter

This image is intended to reflect general building scale and massing relationships only to give a general impression of context, and does not necessarily reflect exact conditions. Tree sizes and shape do not reflect existing conditions.

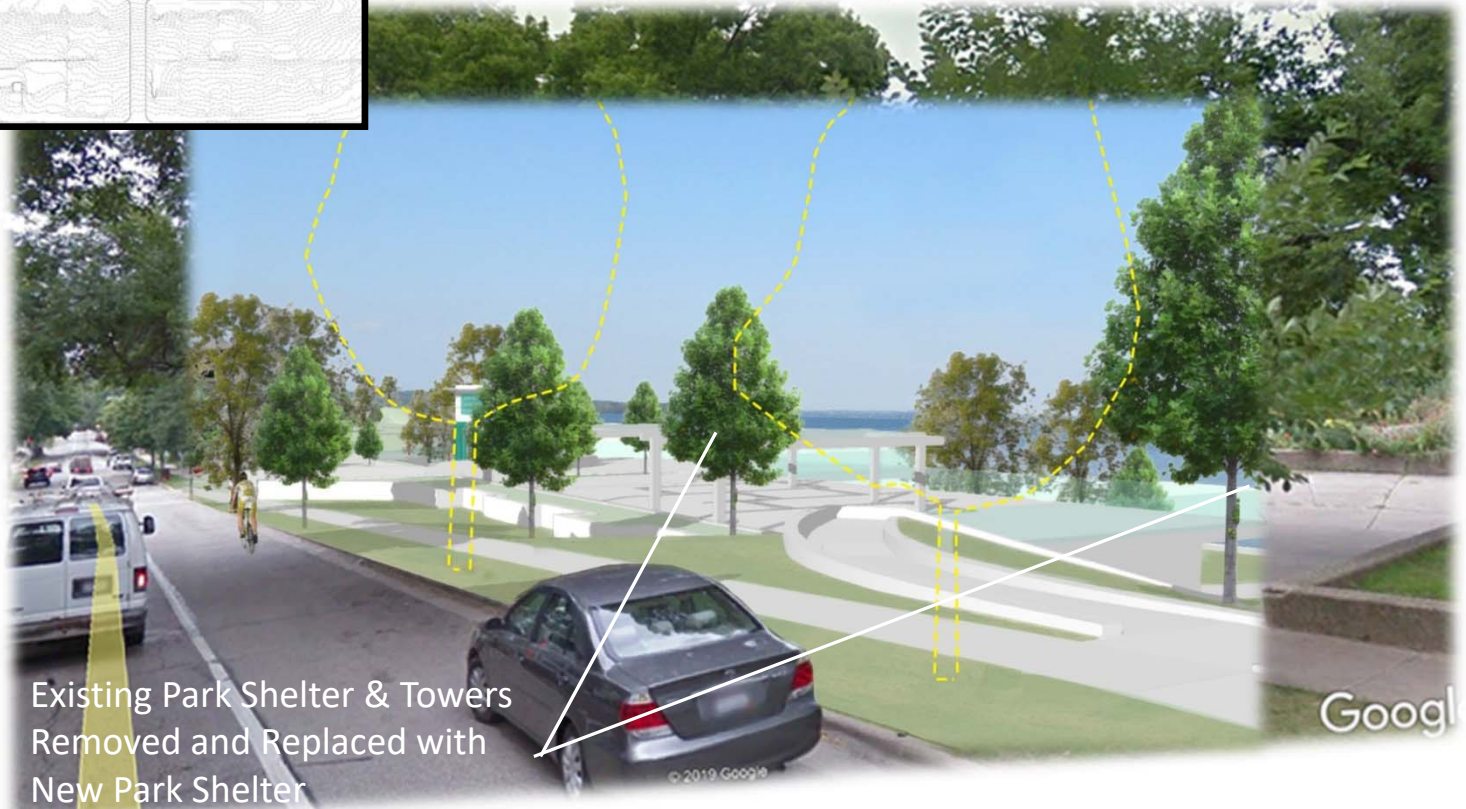

Existing Park Shelter & Towers
Removed and Replaced with
New Park Shelter

Views along E. Gorham St.

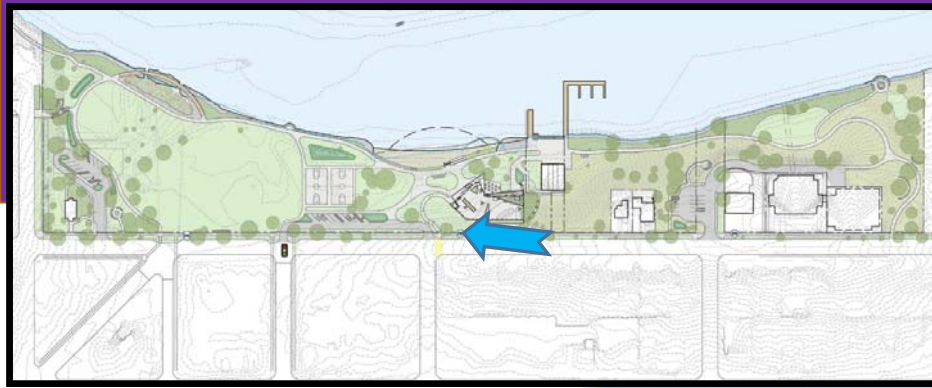

Central Activity Zone

This image is intended to reflect general building scale and massing relationships only to give a general impression of context, and does not necessarily reflect exact conditions. Tree sizes and shape do not reflect existing conditions.

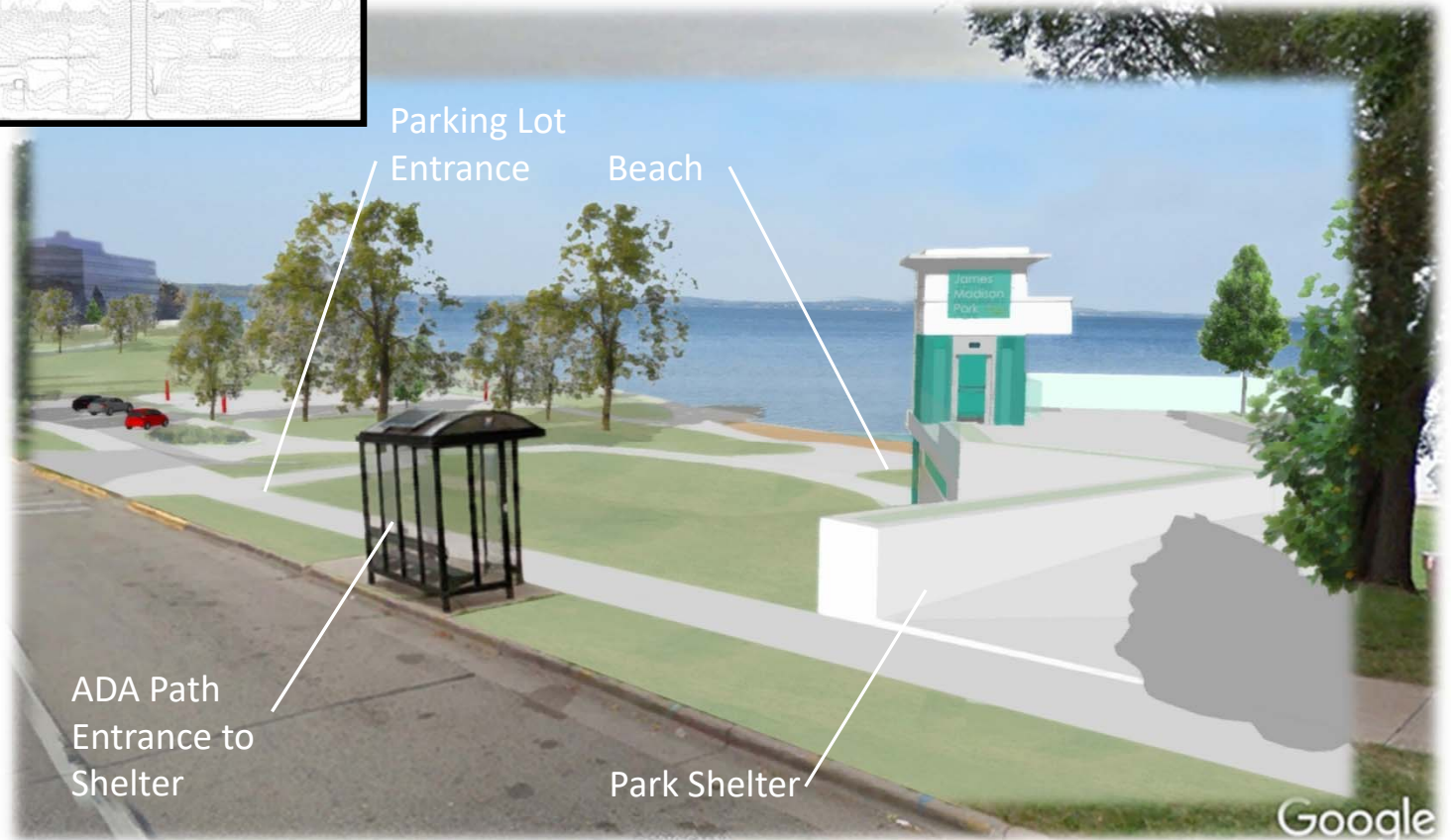

Views along E. Gorham St.

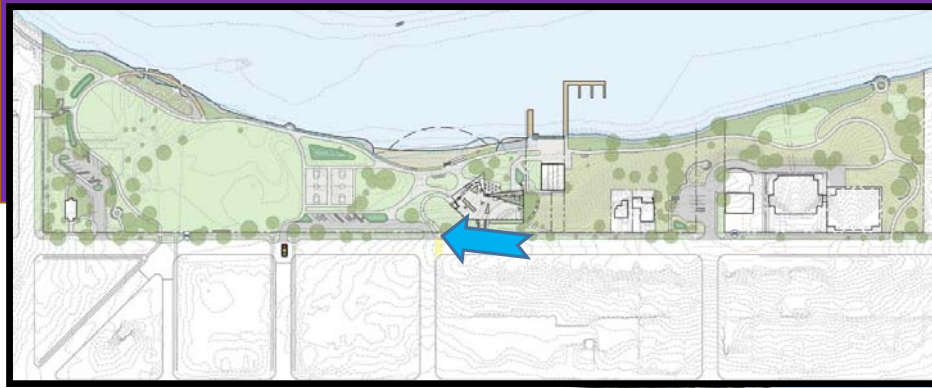

Central Activity Zone

This image is intended to reflect general building scale and massing relationships only to give a general impression of context, and does not necessarily reflect exact conditions. Tree sizes and shape do not reflect existing conditions.

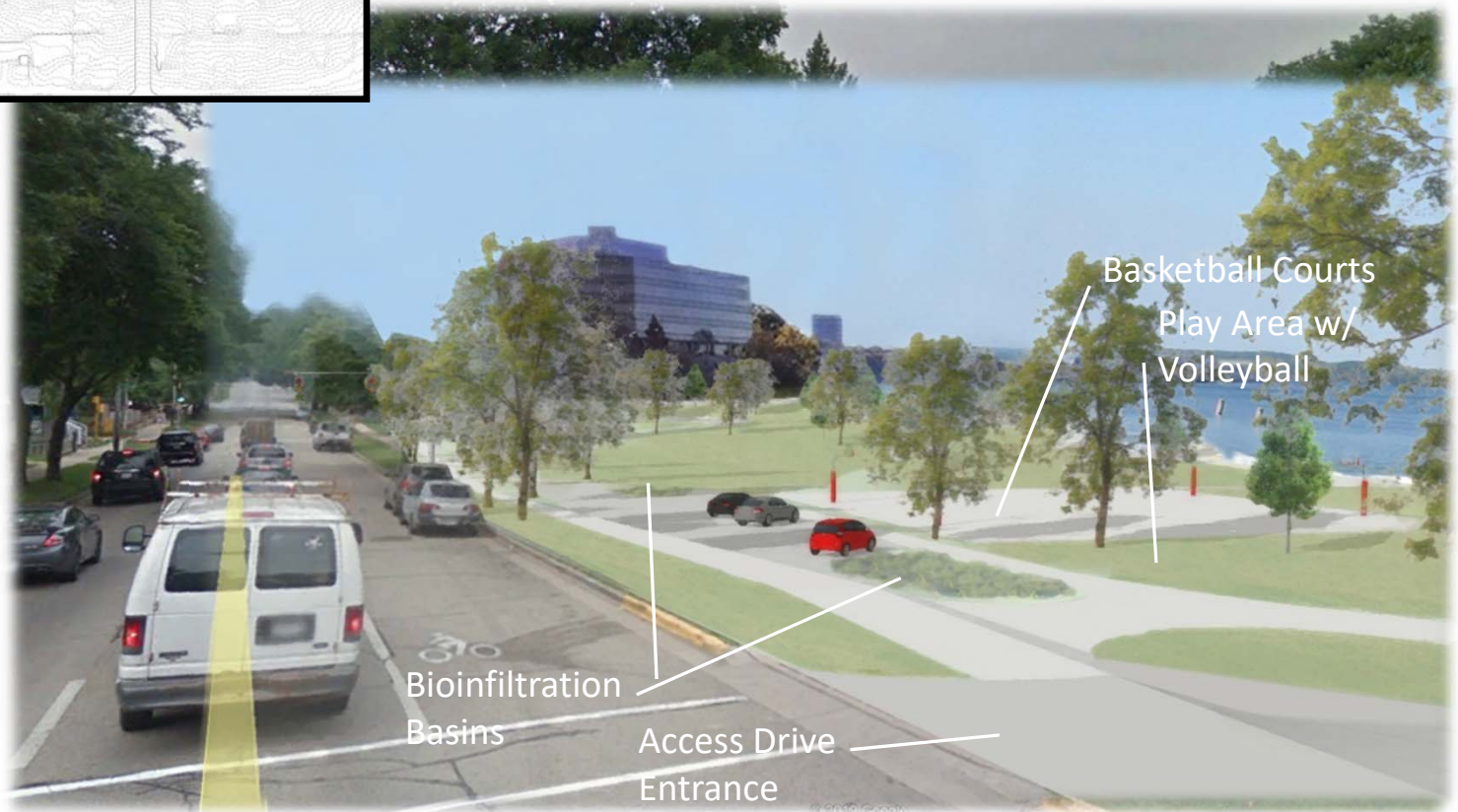

Views along E. Gorham St.

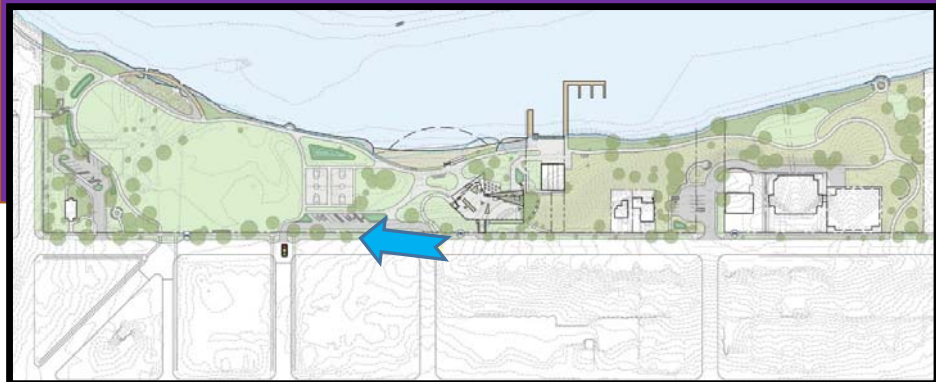

Central Activity Zone

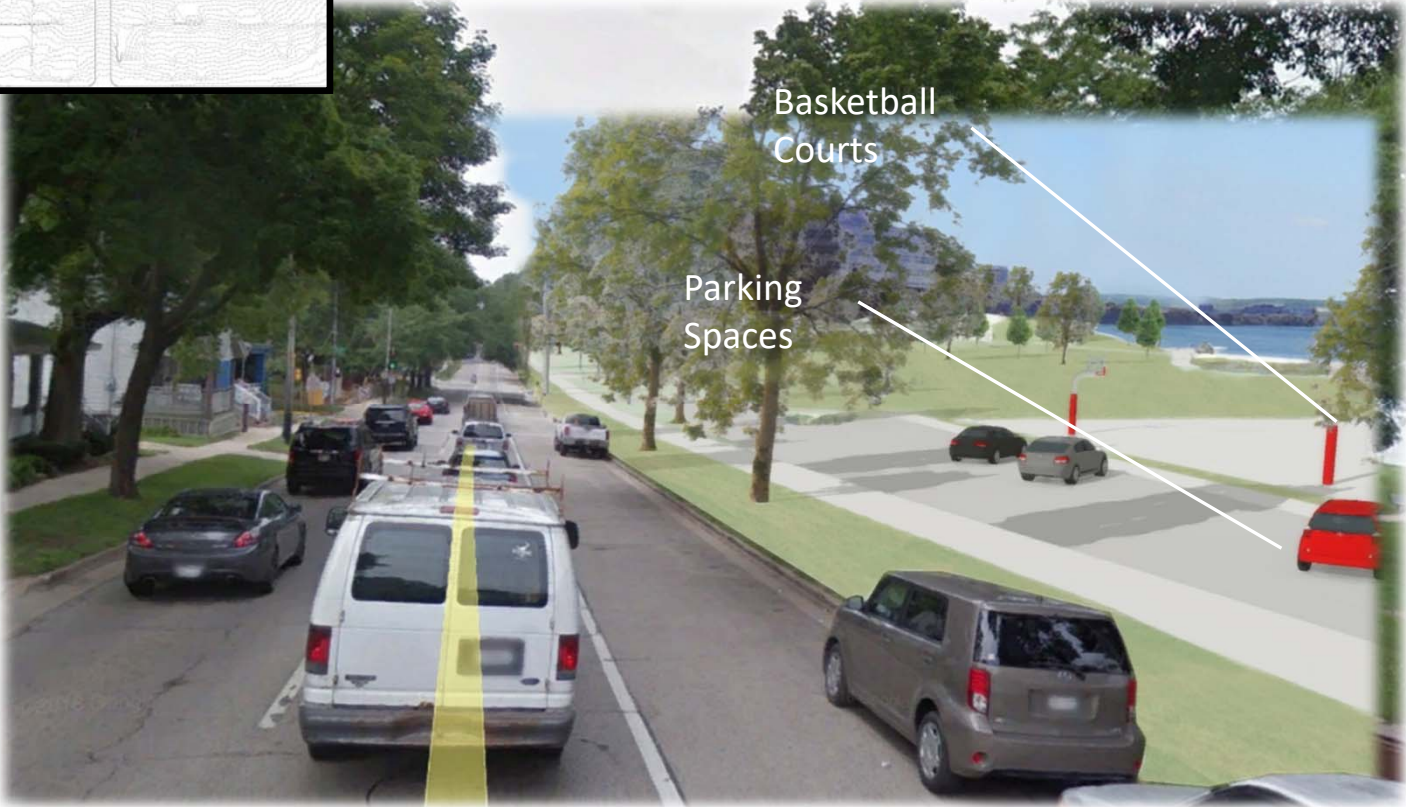

Views along E. Gorham St.

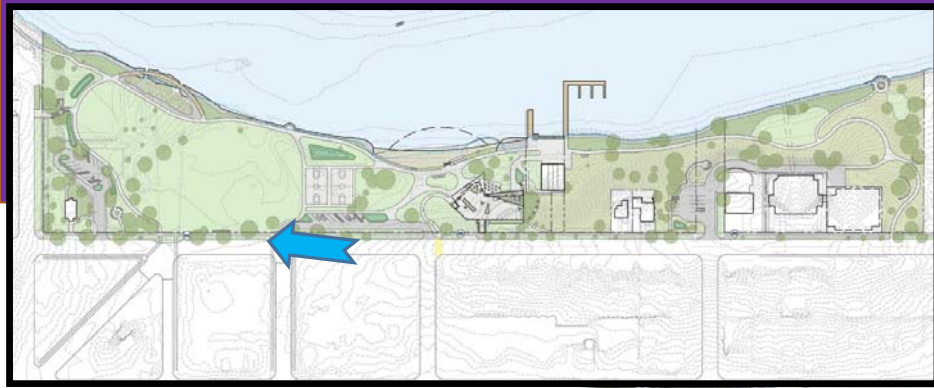

Franklin Street to
Hancock Street

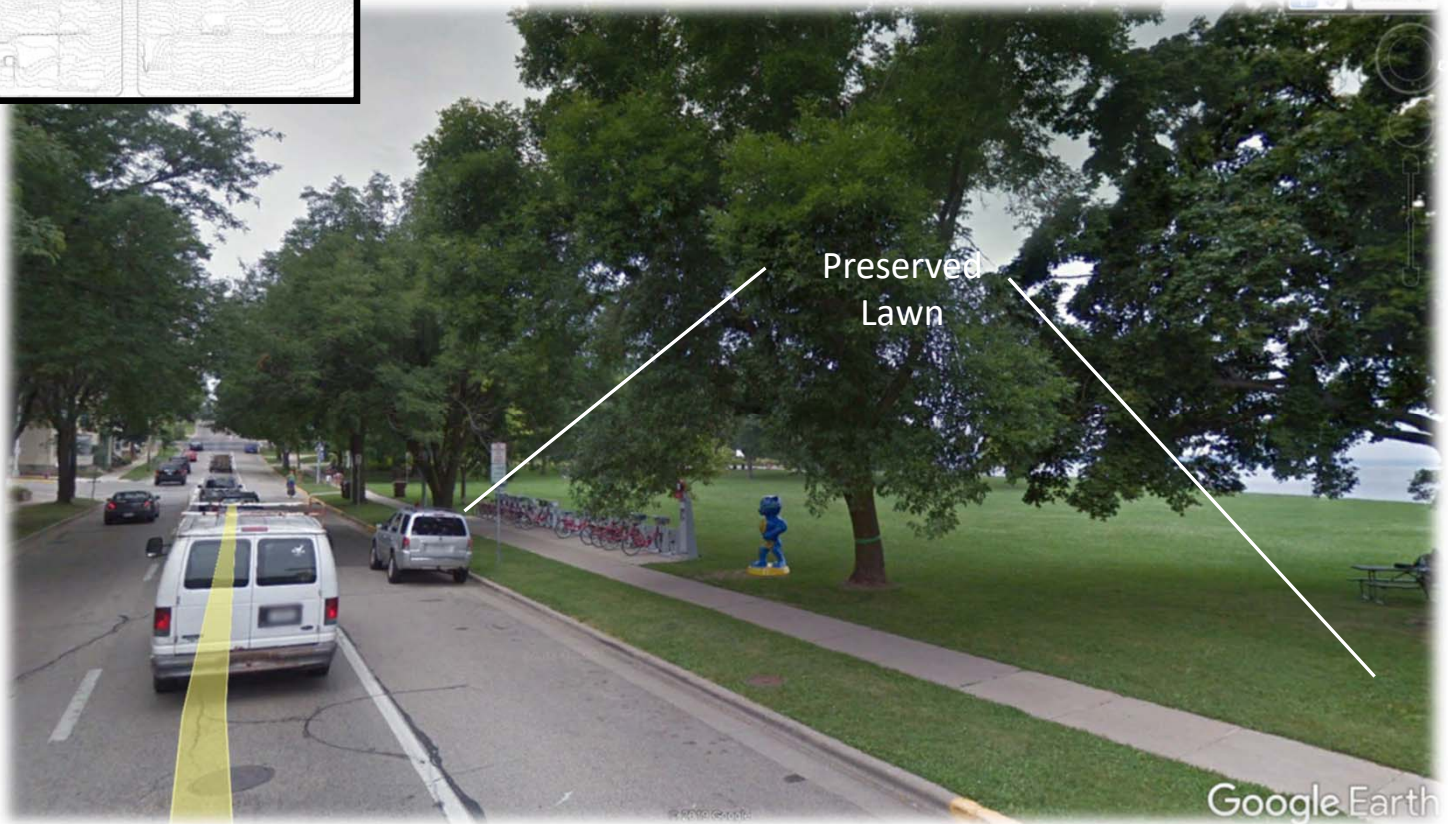

Preserved
Lawn

Google Earth

Views along E. Gorham St.

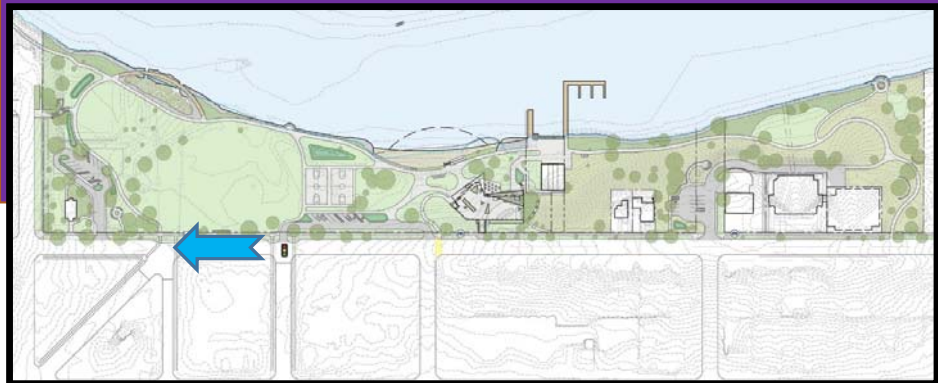

Hancock
St./Hamilton St.
Intersection



Views at Hamilton/Hancock



Surface Comparison

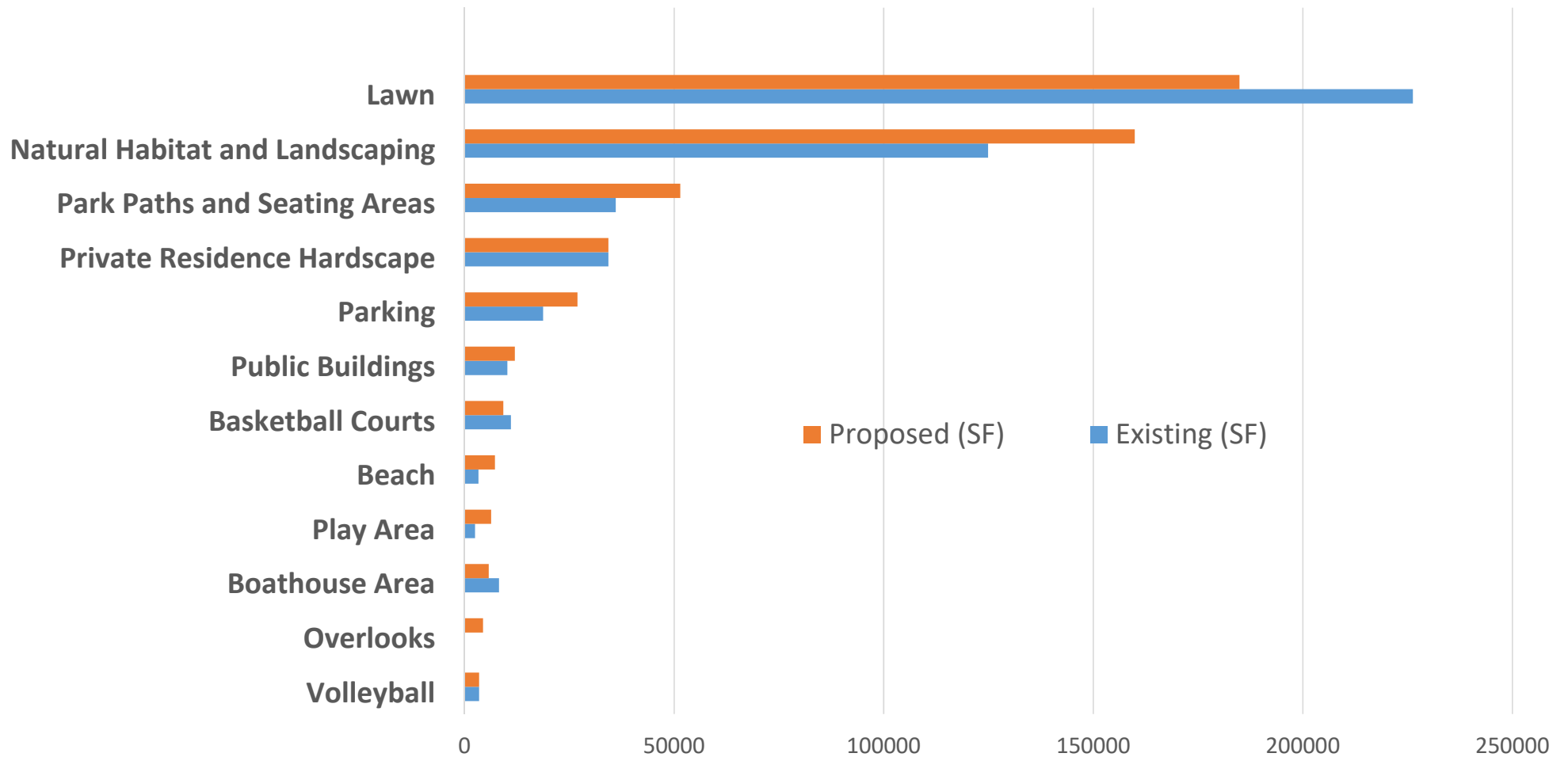



Gates of Heaven
Capacity: 98
2017 Reservations: 154



Ex. Park Shelter
Capacity: 60
2017 Reservations: 55

Supporting Plans – Equity Guiding Lens

Dane County 2018-2023 Parks and Open Space Plan

- Provide an inclusive parks system for all Dane County residents...

City of Madison Comprehensive Plan

- Maintain downtown Madison as a major Activity Center for the region, while improving access and inclusivity.
- Create safe and affirming community spaces that bring people together and provide social outlets for underrepresented groups.
- Acquire parkland and upgrade park facilities to accommodate more diverse activities and gatherings.

2018-2023 City of Madison Park and Open Space Plan

- Design park facilities to accommodate diverse activities and populations.
- Create equitable access and funding for parks.
- Increase connectivity between parks to enhance access.
- Increase engagement with groups and organizations and develop new ones.



Supporting Plans – Public Health Guiding Lens

Dane County 2018-2023 Parks and Open Space Plan

- Provide sufficient park land and recreational facilities to meet demand...
- Protect lakes, rivers and streams....to maintain high water quality, manage water quantity, and sustain water-based recreation throughout Dane County.



City of Madison Comprehensive Plan

- Improve public access to lakes.
- Support sustainable farming and gardening practices that protect the ecosystem and public health.

2018-2023 City of Madison Park and Open Space Plan

- Improve public access to lakes.
- Create equitable access and funding for parks.
- Increase engagement with groups and organizations and develop new ones.

City of Madison Downtown Plan

- Incorporate Crime Prevention through Environmental Design techniques to create safer pedestrian and living experiences.

City of Madison Tenney-Lapham Neighborhood Plan

- Ensure safety in all parks.
- Provide a balance of passive and active recreational activities in all neighborhood parks.

Supporting Plans – Sustainability Guiding Lens

Dane County 2018-2023 Parks and Open Space Plan

- Protect lakes, rivers and streams, including shorelines, wetlands, high infiltration areas, ...

City of Madison Comprehensive Plan

- Improve public access to lakes.
- Increase the use and accessibility of energy efficient upgrades and renewable energy.
- Improve and preserve urban biodiversity through an interconnected greenway and habitat system.
- Develop a healthy and diverse urban tree canopy.

2018-2023 City of Madison Park and Open Space Plan

- Protect and enhance natural and cultural resources
- Ensure that new park development occurs in a fiscally sustainable matter.
- Ensure that existing levels of service are maintained and supported through the park system and are increased as new parks and facilities are developed.

City of Madison Downtown Plan

- Become a model of sustainability

City of Madison Tenney-Lapham Neighborhood Plan

- Ensure safety in all parks.



Supporting Plans – Adaptability Guiding Lens

Dane County 2018-2023 Parks and Open Space Plan

- Provide sufficient park land and recreational facilities to meet demand...

City of Madison Comprehensive Plan

- Develop a healthy and diverse urban tree canopy.

2018-2023 City of Madison Park and Open Space Plan

- Ensure that new park development occurs in a fiscally sustainable matter.
- Ensure that existing levels of service are maintained and supported through the park system and are increased as new parks and facilities are developed.
- Improve the park system's capacity to withstand future environmental changes.

City of Madison Downtown Plan

- Expand recreational, cultural, and entertainment offerings...designed and programmed to meet the residents of an increasingly dense Downtown...

City of Madison Tenney-Lapham Neighborhood Plan

- Ensure safety in all parks.



Questions?

