

# Georgeson Property Neighborhood Concept

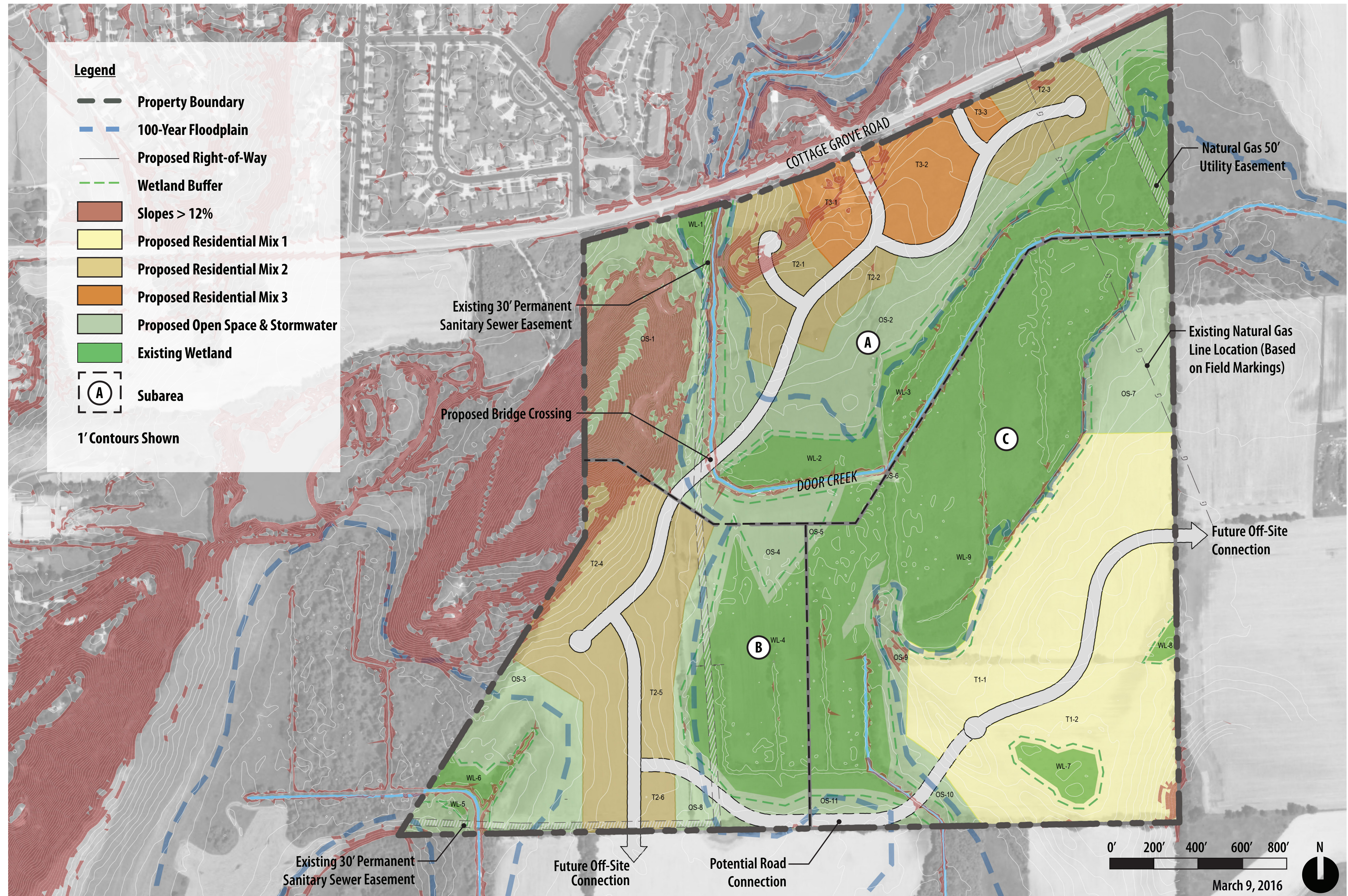



# Georgeson Property Neighborhood Concept

## Development Summary Charts

### North Parcel (Site A)

LAND USE	SQUARE FOOTAGE	NET ACRES	NET %	NET DENSITY RANGE	PROJECTED UNIT TOTALS	OPEN SPACE DEDICATION RATE	REQ. OS DEDICATION				
						(square feet)	(acres)				
T-2 RESIDENTIAL		9.8	13.6%		78	156	1.3	2.5			
T2-1	194,154	4.5		8.0 - 16.0	36	-	71	700	0.6	-	1.15
T2-2	72,584	1.7		8.0 - 16.0	13	-	27	700	0.2	-	0.43
T2-3	158,409	3.6		8.0 - 16.0	29	-	58	700	0.5	-	0.94
T-3 RESIDENTIAL		7.6	10.6%		121	189		1.9	3.0		
T3-1	107,598	2.5		16.0 - 25.0	40	-	62	700	0.6	-	0.99
T3-2	198,385	4.6		16.0 - 25.0	73	-	114	700	1.2	-	1.83
T3-3	24,169	0.6		16.0 - 25.0	9	-	14	700	0.1	-	0.22
OPEN SPACE		33.0	46.0%								
OS-1	754,570	17.3									
OS-2	681,036	15.6									
WETLAND		16.0	22.4%								
WL-1	34,203	0.8									
WL-2	126,952	2.9									
WL-3	537,741	12.3									
ROAD ROW		5.3	7.4%								
ROW	230,696	5.3									
<b>GRAND TOTAL</b>		<b>71.6</b>	<b>100.0%</b>		<b>199</b>	<b>-</b>	<b>346</b>		<b>3.2</b>		<b>5.6</b>

### Southeast Parcel (Site C)

LAND USE	SQUARE FOOTAGE	NET ACRES	NET %	NET DENSITY RANGE	PROJECTED UNIT TOTALS	OPEN SPACE DEDICATION RATE	REQ. OS DEDICATION				
						(square feet)	(acres)				
T-1 RESIDENTIAL		32.2	39.8%		16	64	0.4	1.6			
T1-1	724,776	16.6		0.5 - 2.0	8	-	33	1100	0.2	-	0.84
T1-2	679,477	15.6		0.5 - 2.0	8	-	31	1100	0.2	-	0.79
OPEN SPACE		11.6	14.3%								
OS-5	7,547	0.2									
OS-6	3,052	0.1									
OS-7	260,832	6.0									
OS-9	148,555	3.4									
OS-10	42,827	1.0									
OS-11	41,133	0.9									
WETLAND		34.1	42.0%								
WL-7	60,316	1.4									
WL-8	12,933	0.3									
WL-9	1,411,148	32.4									
ROAD ROW		3.2	3.9%								
ROW	87,959	2.0									
FUTURE ROW	51,515	1.2									
<b>GRAND TOTAL</b>		<b>81.1</b>	<b>100%</b>		<b>16</b>	<b>-</b>	<b>64</b>		<b>0.4</b>		<b>1.6</b>

### Southwest Parcel (Site B)

LAND USE	SQUARE FOOTAGE	NET ACRES	NET %	NET DENSITY RANGE	PROJECTED UNIT TOTALS	OPEN SPACE DEDICATION RATE	REQ. OS DEDICATION				
						(square feet)	(acres)				
T-2 RESIDENTIAL		16.3	35.2%		109	175	1.8	2.8			
T2-4	472,900	10.9		6.0 - 8.0	65	-	87	700	1.0	-	1.40
T2-5	198,370	4.6		8.0 - 16.0	36	-	73	700	0.6	-	1.17
T2-6	40,747	0.9		8.0 - 16.0	7	-	15	700	0.1	-	0.24
OPEN SPACE		15.0	32.2%								
OS-3	373,126	8.6									
OS-4	230,372	5.3									
OS-8	48,363	1.1									
WETLAND		11.5	24.7%								
WL-4	451,355	10.4									
WL-5	2,150	0.0									
WL-6	45,913	1.1									
ROAD ROW		3.7	8.0%								
ROW	111,127	2.6									
FUTURE ROW	49,827	1.1									
<b>GRAND TOTAL</b>		<b>46.5</b>	<b>100.0%</b>		<b>109</b>	<b>-</b>	<b>175</b>		<b>1.8</b>		<b>2.8</b>