

To whom it may concern,

This letter serves as formal notice to the City of Madison regarding a change in ownership for **Cambria Hotel Madison East**, located at **5045 Eastpark Boulevard, Madison, WI**, effective **April 14, 2026**, related to the establishment's **bar/liquor license**.

Please be advised that **this change affects ownership only**. There will be **no changes to hotel or bar operations**, management, staffing, hours, branding, or day-to-day business activities. The hotel and bar will continue to operate without interruption and in full compliance with all City of Madison and State of Wisconsin regulations governing alcohol service.

All existing operational practices will remain in place, and the premises will continue to meet all requirements associated with the issued liquor license.

If additional information or documentation is required to process this ownership change, please feel free to contact me.

Thank you for your time and consideration.

Sincerely,

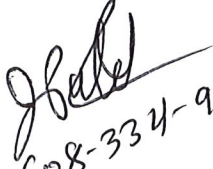
608-334-9684

HOTEL LAYOUT

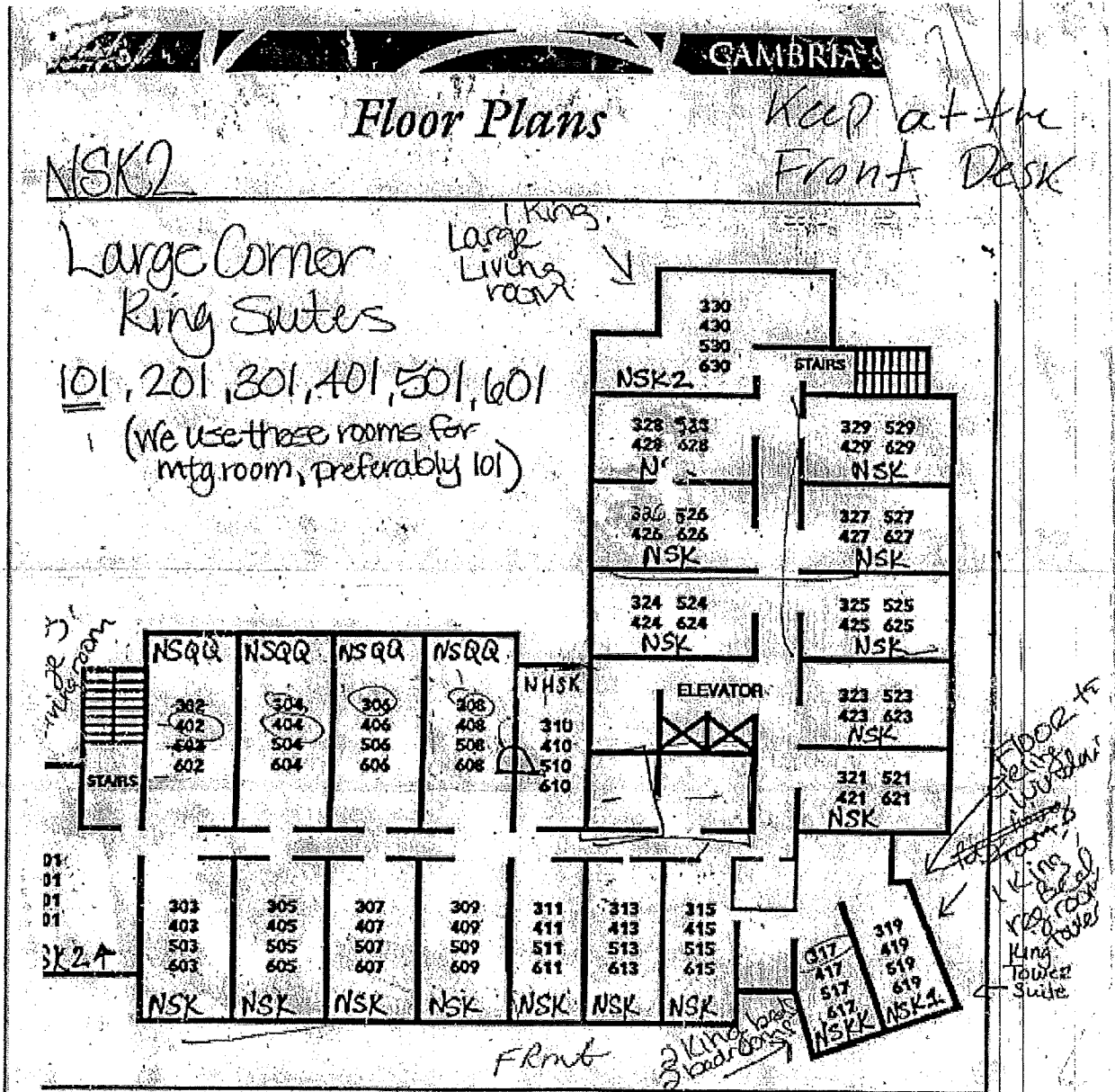

or plan for floors 3-6 follow the same layout as the floor plan shown.
 Each room number begins with the floor number and is followed by room number as listed in the above.

- NNSK
- NNSK2
- NNSQR
- 76 - NSK
- 4 - NSK1
- 10 - NSK2
- 4 - NSKK
- 20 - NSQR

ROOM TYPES

NHSK		<p><u>ONE KING BED</u> Handicap accessible, Only 5 on property. (105, 310, 410, 510, and 610) 4</p>
NHSK2		<p><u>ONE KING BED</u> Handicap accessible, Roll in shower, only one of these rooms on property Room 101 1</p>
NHSQQ		<p><u>TWO QUEEN BEDS</u> Handicap accessible with bathtub, only one of these rooms on property (Room 215) 1</p>
NSK		<p><u>ONE KING BED</u> Standard king room, One room suite 76</p>
NSK1		<p><u>ONE KING BED</u> Tower Suite, Only 4 on property (319, 419, 519, and 619) 4</p>
NSK2		<p><u>ONE KING BED</u> Corner Suite, only 4 on property (601, 630, 530, 501) 10</p>
NSKK		<p><u>TWO KING BEDS</u> This room is a 2 bedroom suite, there is a wall that separates the two beds. 4</p>
NSQQ		<p><u>TWO QUEEN BEDS</u> Standard Room, One room suite 20</p>

Exception:
Rm 409 Does NOT have pullout sofa sleeper in room.

<u>CONNECTING ROOMS</u>
103/105
308/310
408/410
508/510
608/610

CAMBRIA®

COCKTAILS

- Margarita | tequila, lime, agave nectar | 12
Apple Martini | vodka, apple pucker, sweet + sour, sprite | 12
Wisconsin Old Fashioned | brandy, orange, cherry, sprite | 12
Planters Punch | dark rum, orange, pomegranate | 12
Bay Creek | gin, lemongrass syrup, vanilla liqueur, lemon juice, ginger beer | 12
Greenbush | vodka, cucumber syrup, lime juice, club soda | 12
Cambria Cooler | vodka, campari, agave nectar | 12

CRAFT BEER

- Spotted Cow | New Glarus Brewing Co. | 7
Sam Adams Seasonal | Boston Beer Company | 7 draft
Boston Lager | Boston Beer Company | 7 draft
Dogfish Head 60 min IPA | Dogfish Head Brewery | 7 draft
Kona Big Wave | Kona Brewing Co. | 7 draft

ADDITIONAL BEERS

- Bud Light, Budweiser, Michelob Ultra, Stella Artois | 6
Michelob Ultra Zero, Run Wild N/A Beer | 6
Twisted Tea | 6
Assorted Hard Seltzers | 6.5
Cutwater Cocktails | 7.5

ADDITIONAL BEVERAGES

- Coke, Diet Coke, Sprite, Dr. Pepper | 2.5
Apple, Orange, Cranberry | 4
Red Bull | 7

WINE

Scan to learn more about



Cambria wines

	6oz	bottle
Cambria Winery Chardonnay	9	35
Cambria Winery Pinot Noir	9	35
Coppola Diamond Collection Cabernet Sauvignon	9	35
Benvolio Sparkling	9	35