

**FLOOR PLAN**  
 SCALE: 1/8" = 1'-0"  
 NORTH

NOTE: ALL INTERIOR DOORS 3048 WOOD INTERIOR PRE HUNG AND PRE FINISHED

**JAMES M. TRIATIK**  
 A-7516  
 Madison  
 Wisconsin  
 ARCHITECT

*James M. Triatik*

REVISIONS

**MR II**  
 1108 Post Road  
 Madison, WI 53713

**James M. Triatik**  
**Sullivan**  
 DESIGN BUILD  
 GENERAL CONTRACTORS CO.  
 1314 EXHL ST. E.  
 MADISON, WI 53725-2463  
 TEL. BOX 25946 608-257-5689  
 FAX 608-257-5286

DRAWING NAME  
 1/4" FLOOR PLAN  
 DRAWN BY: RWD  
 DATE: 8-2-23

SHEET  
**A-1**  
 PROJ # 205-053

06/03/2005 11:32:04 SMP X Site Plan SP-4 (1) copyright 2005 Kenneth F. Sullivan Co.

LATHAM DRIVE

EXISTING BUILDING @ 3224 KINGSLEY WAY

LOT 41, WATSON'S FINAL ADDITION, IN THE CITY OF MADISON, DANE COUNTY, WI

PARKING LOT PLAN SITE INFORMATION BLOCK	
SITE ADDRESS	1108 POST ROAD
SITE ACREAGE	32,245 SQ. FT.
NUMBER OF BUILDING STORIES ( ABOVE GRADE)	1
BUILDING HEIGHT	16'
DILHR TYPE OF CONSTRUCTION	TYPE IIB - METAL FRAME UNPROT.
TOTAL SQUARE FOOTAGE OF BUILDING	13,120 SF.
USE OF PROPERTY	WAREHOUSE
GROSS SQUARE FEET OF OFFICE	N/A
GROSS SQUARE FEET OF RETAIL AREA	N/A
NUMBER OF EMPLOYEES IN WAREHOUSE	8
NUMBER OF EMPLOYEES IN PRODUCTION AREA	N/A
CAPACITY OF RESTAURANT / PLACE OF ASSEMBLY	N/A
NUMBER OF BICYCLE STALLS SHOWN	1 BIKE RACK (2 STALLS REQ.)
NUMBER OF PARKING STALLS	17 TOTAL (INCLUDES 1 VAN ACCESSIBLE STALL)
NUMBER OF TREES SHOWN	SEE SHT. L-1, LANDSCAPE PLAN

EXISTING DETENTION POND

LOT 42, WATSON'S FINAL ADDITION, IN THE CITY OF MADISON, DANE COUNTY, WI

Per #103 Approved 5/10/05
PLAN PARKING FACILITY APPROVAL
ADDRESS 1102-1108 Post Rd
ID# 192 DATE SUBMITTED 4/8/05
ORIGINAL X REVISION# D
FINAL SIGN OFF DATE
SIGNED

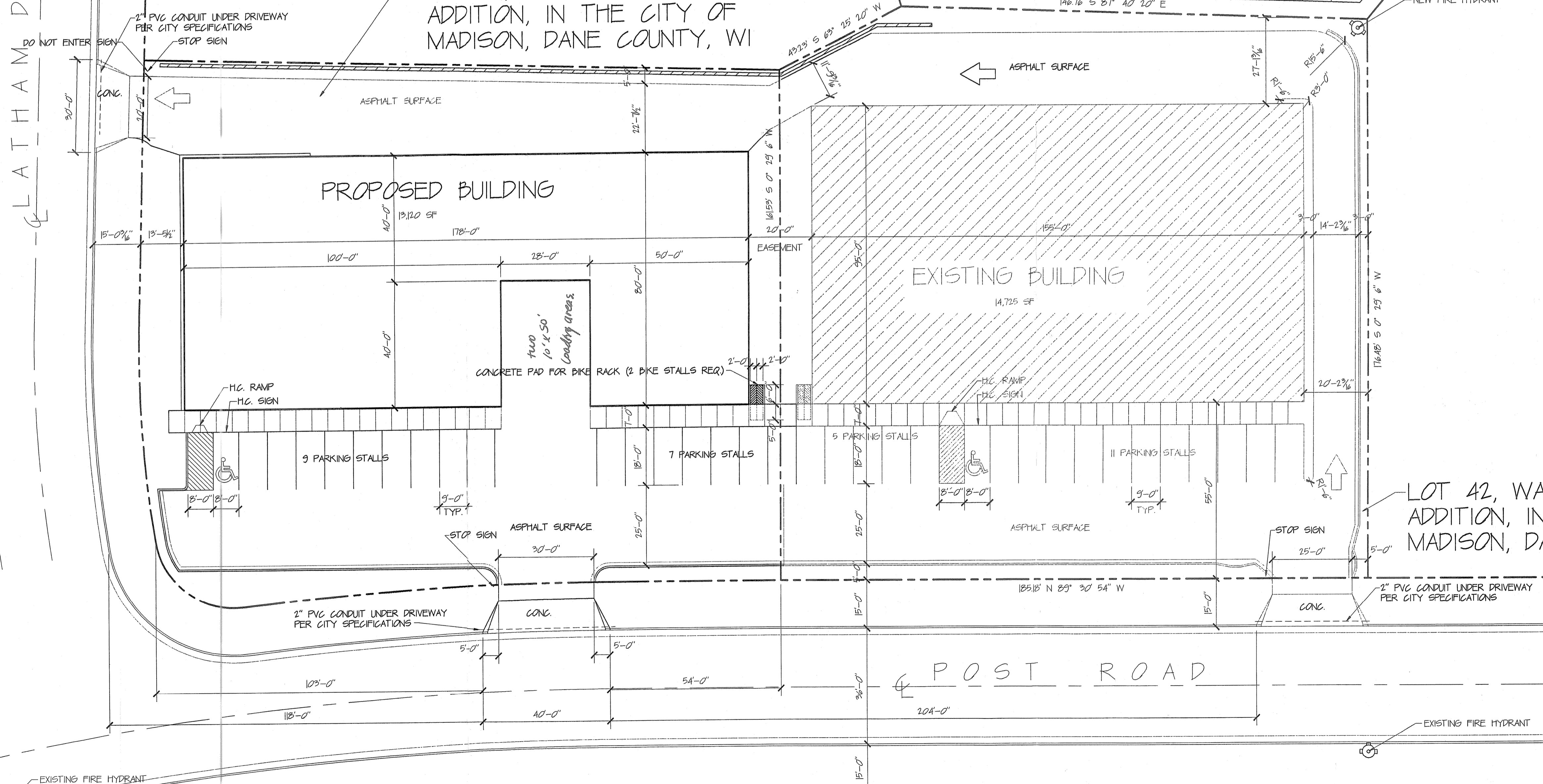

SITE PLAN  
SCALE: 1"=20'-0"

REVISIONS	06/03/05 REVISED DRIVEWAY
SMP X	
1108 Post Road Madison, WI 53713	
 GENERAL CONTRACTORS CO. 1314 EML ST. MADISON, WI 53713 608/257-2289	
DRAWING NAME	PROPOSED SITE PLAN
DRAWN BY:	MJW
DATE:	04/04/05
STREET	SP-4
PROJ. #	105-???