



Segoe Road Proposed Remarking Plan

***Midvale Heights Community
July 13, 2011***



*City of Madison Traffic Engineering Division
Madison, Wisconsin*

Presentation Outline

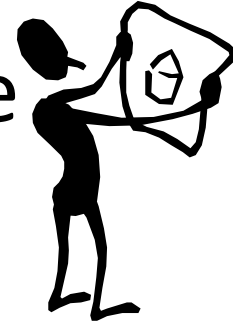

1. Why Are We Here
 2. Overview of Segoe Road Traffic Volumes
 3. Review Traffic
 4. Review Marking Plan
 5. Take Questions
-

Buffered Bike Lanes



Segoe Rd

North of Mineral Point



Segoe Rd

North of Mineral Point





Why Bike Lanes

- Bike Route
- Connections
- Increased Bicycling by Entry Level Bicyclist
- Some Reduction In Speed of Traffic

Bike Facilities

Bicycling Network

-  Off street paved path
-  Bicycle boulevard
-  Bike lane or paved shoulder
-  Wide curb lane
-  On street route
-  Off street unpaved path
-  Bicycle route on sidewalk

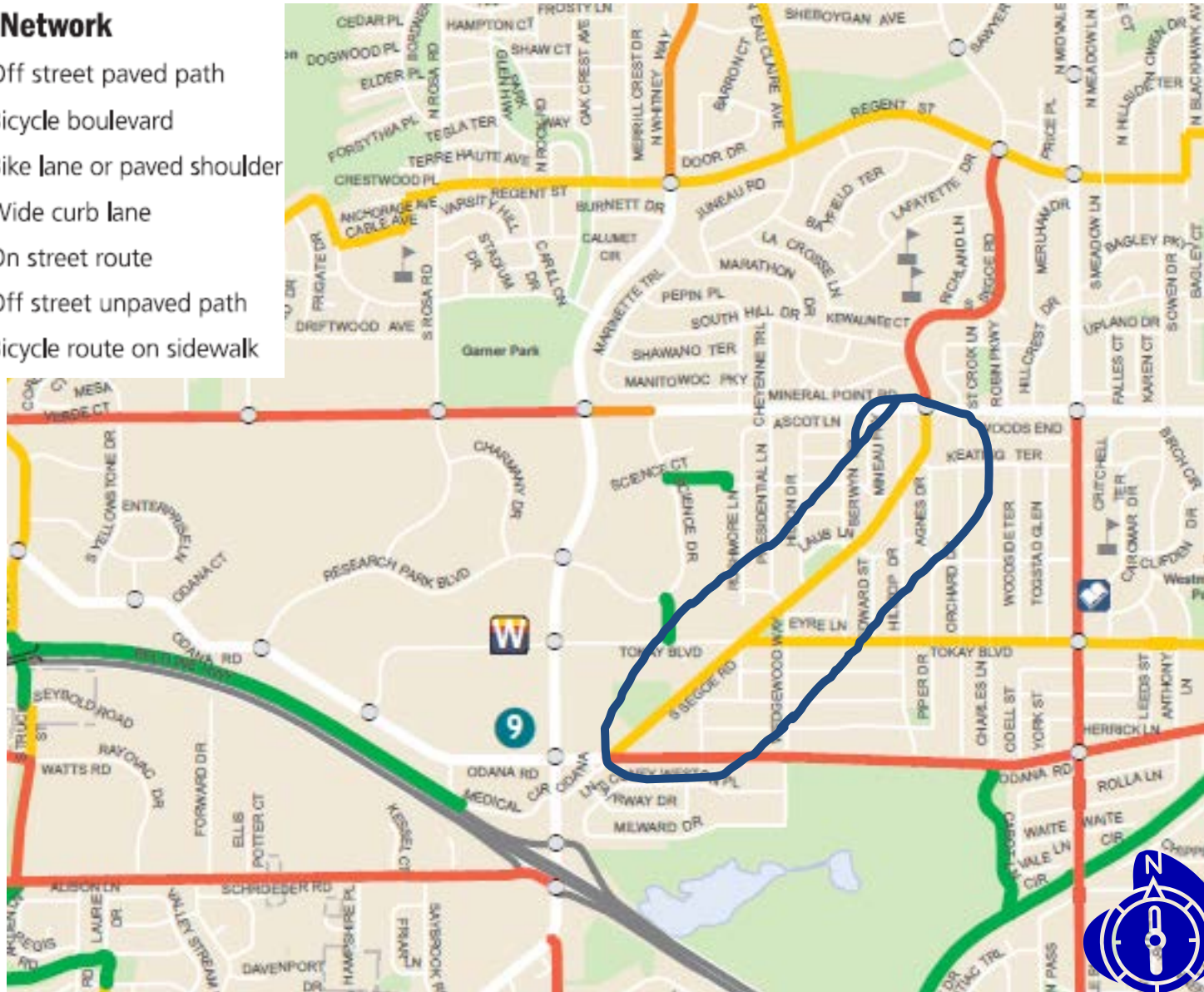

Why Bike Lanes

- Like motorized vehicles bikes are an important component of the transportation system
- Can provide Important public health, recreation benefits
- Environmental benefits
- With continual route improvements we anticipate increased ridership

Buffered Bike Lanes

- Benefits
 - Provides separation between motor vehicles and bicyclist
 - Allows bicyclist to ride further from parked cars
 - Can be more comfortable for riders

Segoe Rd



2 Lane Versus 4 Lanes Roadways

- 2 Lane Urban Roadway general capacity
~13,000 vpd
- Urban Intersections Generally Are Critical Points

Functional Class

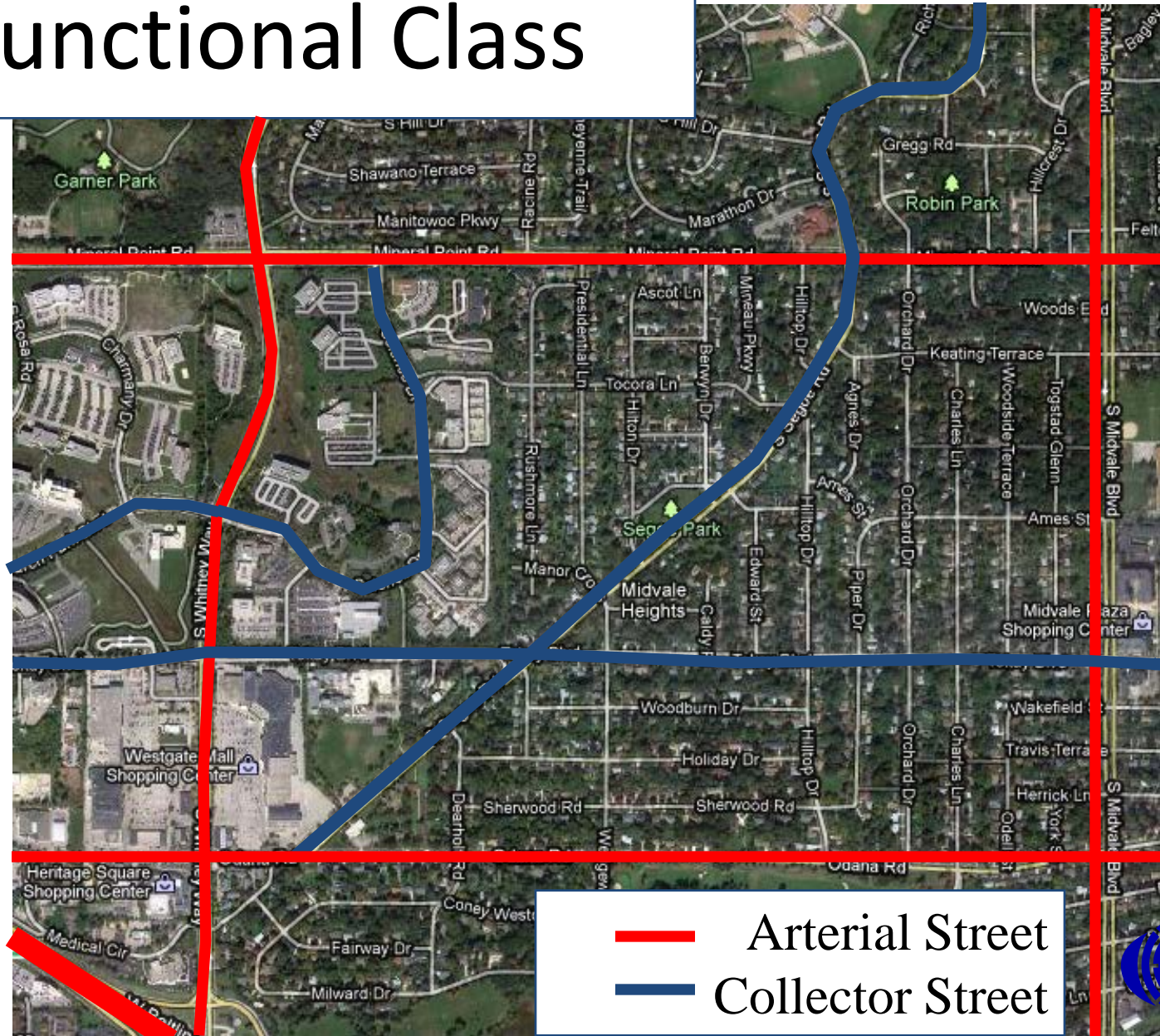

Current Traffic Volume

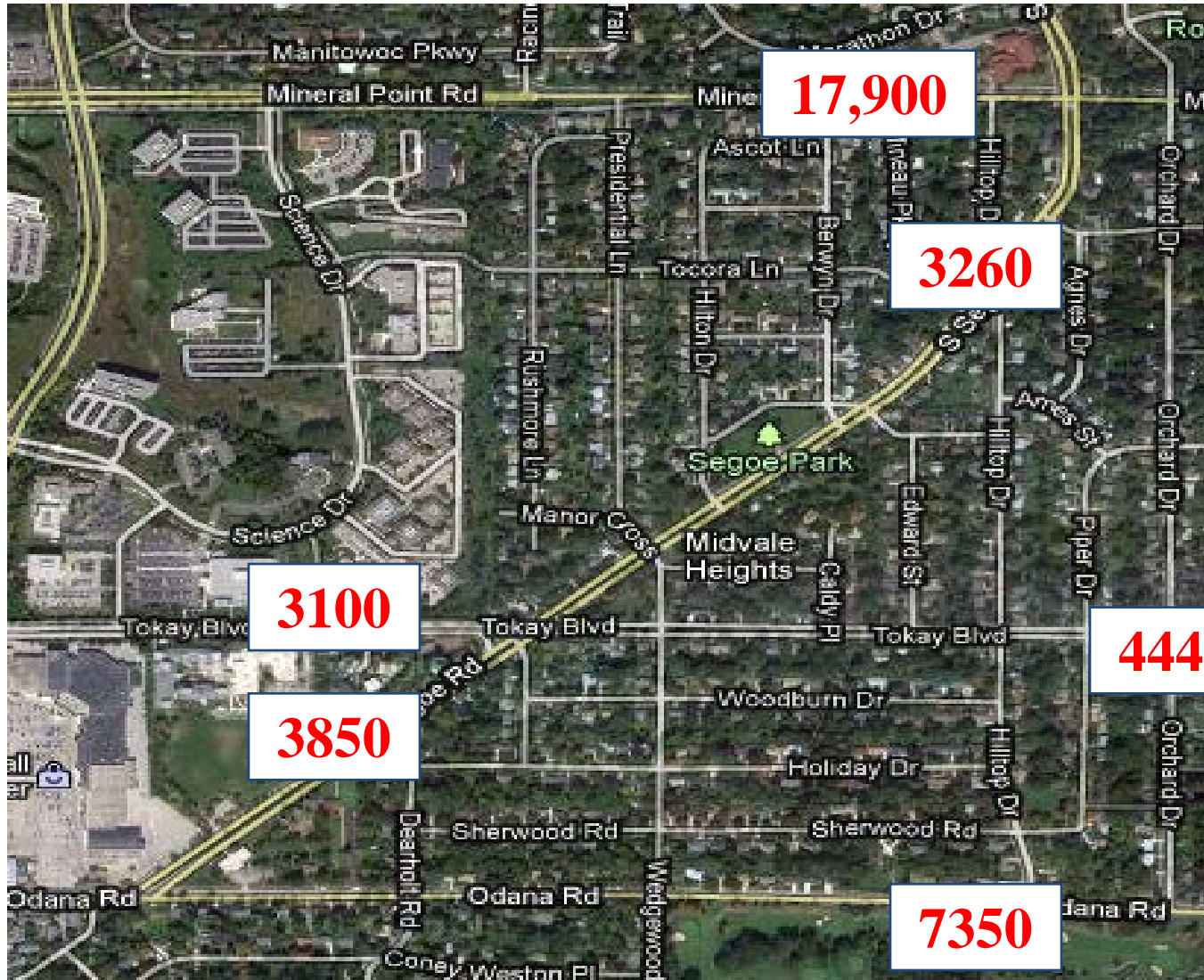

Current Traffic Volume As Percent of Theoretical Capacity of 2 Ln Urban Street

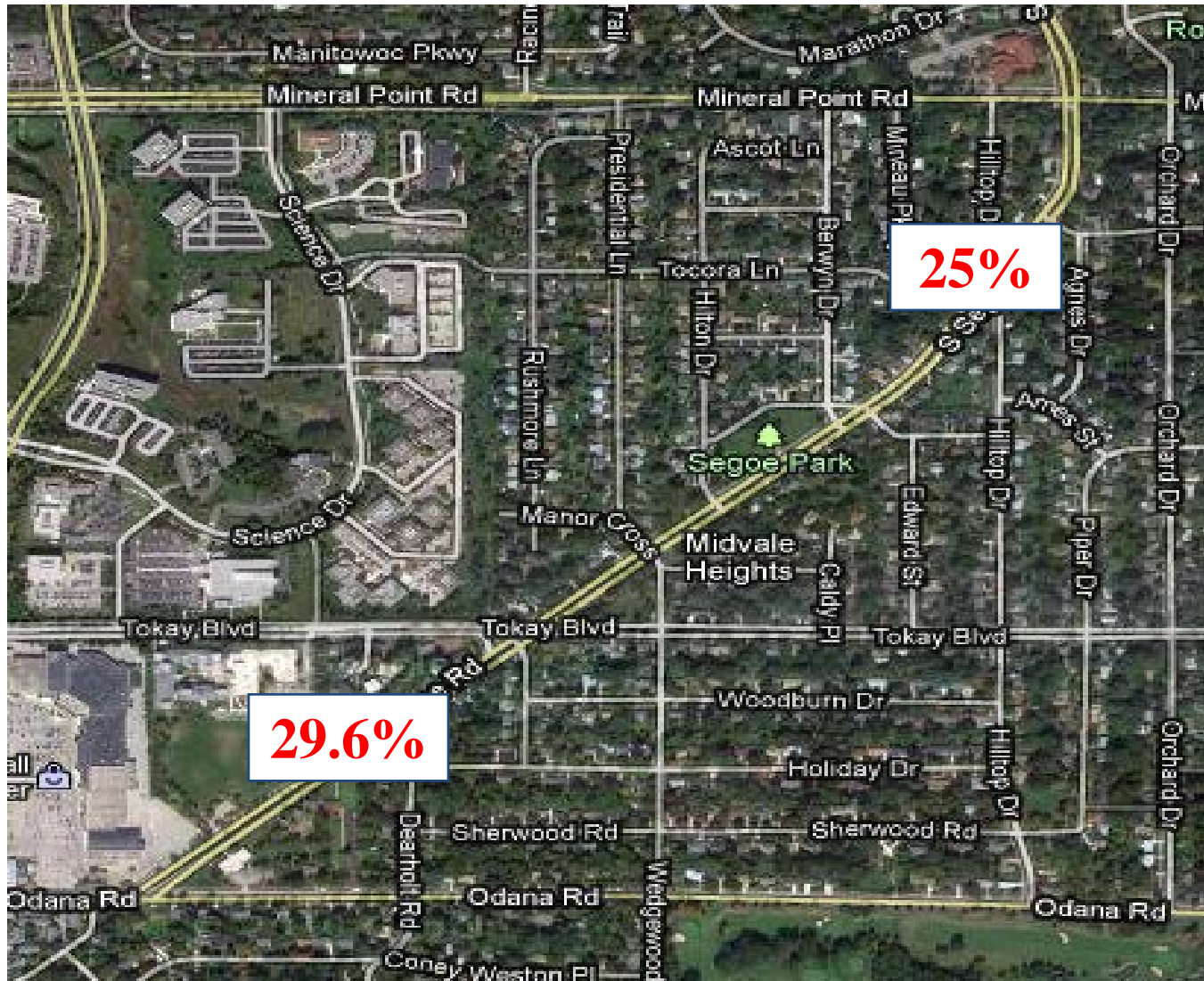

2035 Projected Traffic Volume

Vehicles per Day per Madison MPO

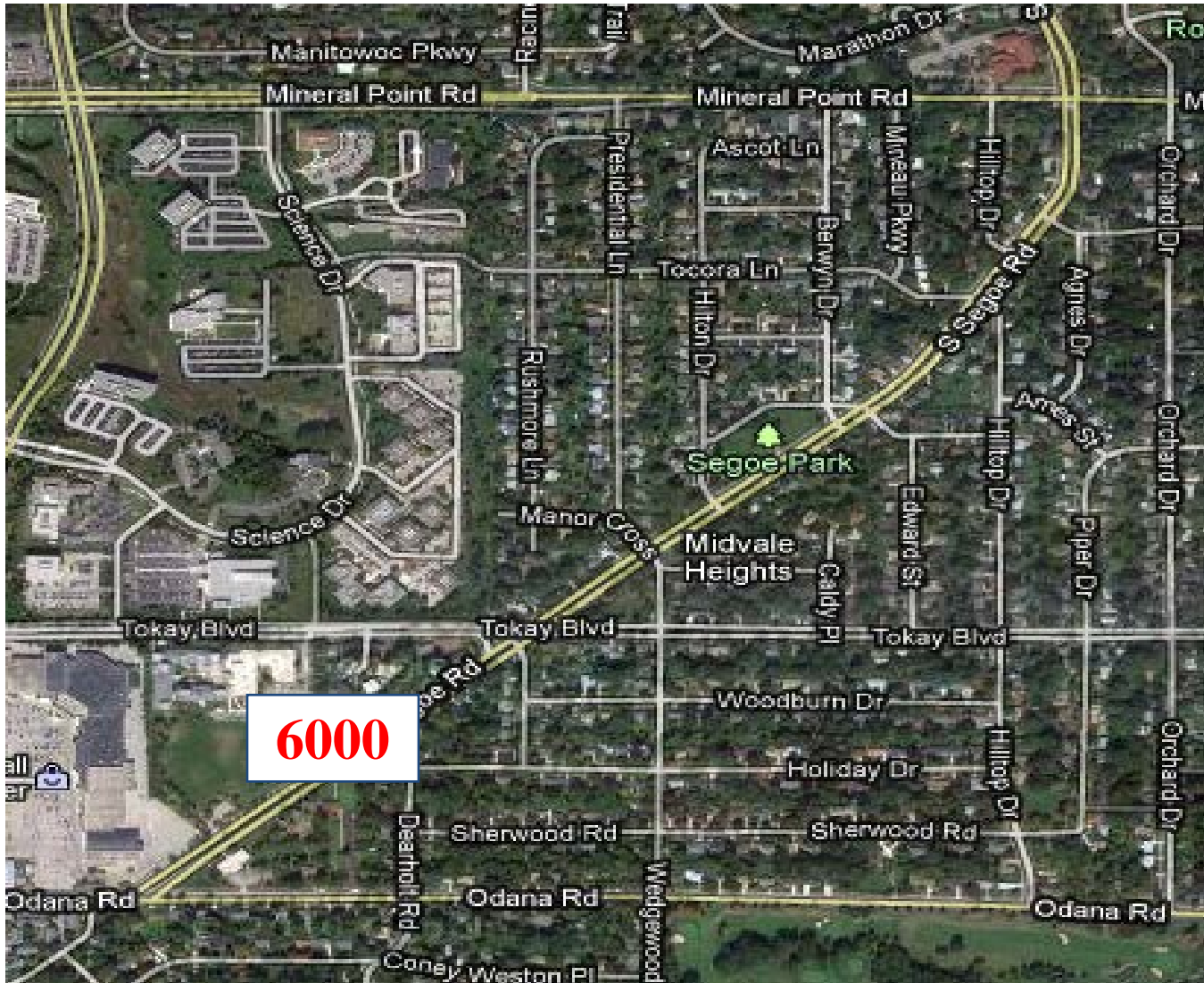

Current Speed

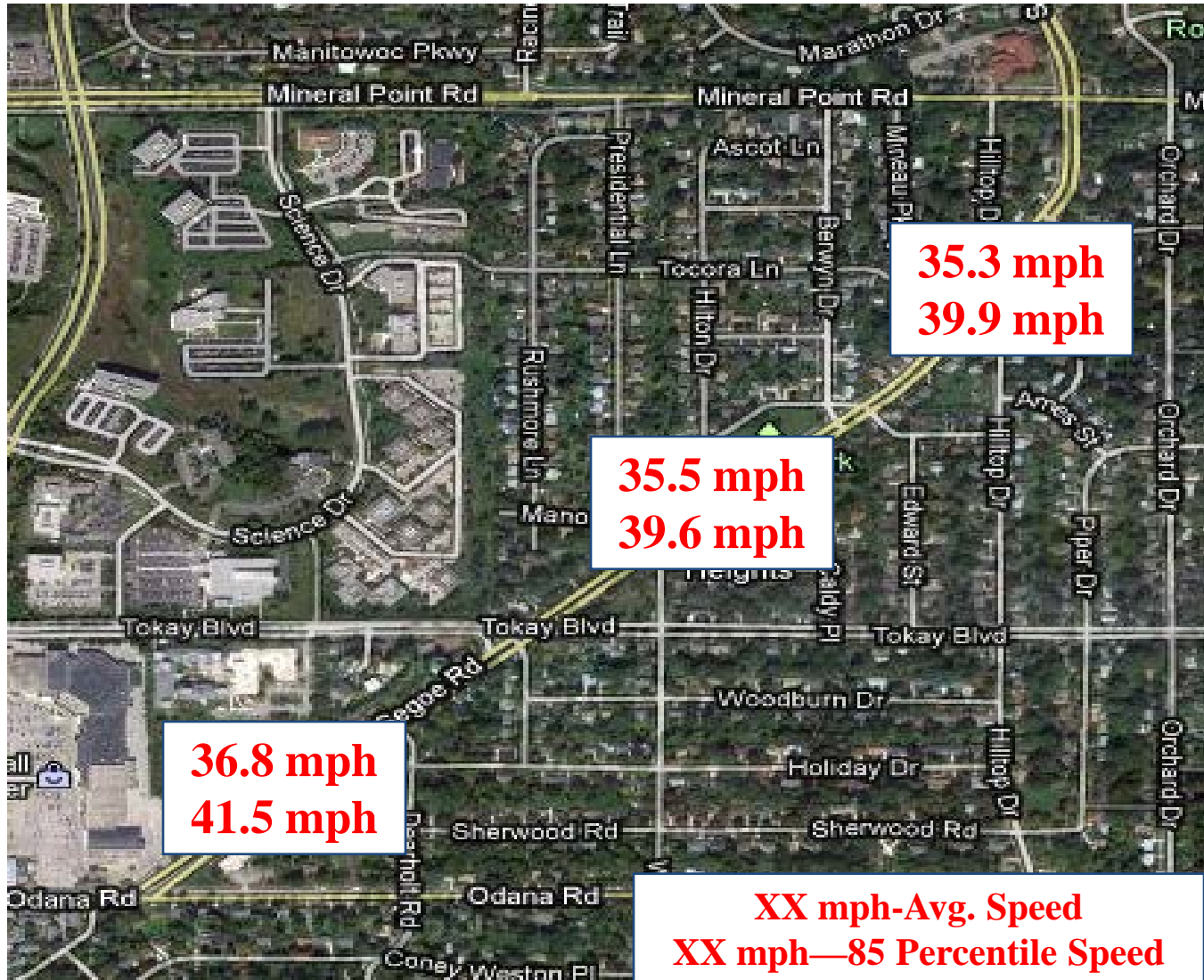

Traffic Volume Before and After Buffered Bike Lane

XXXX Before
XXXX After



Average Speed Before and After Buffered Bike Lane

XX Before
XX After



Proposed Cross Section

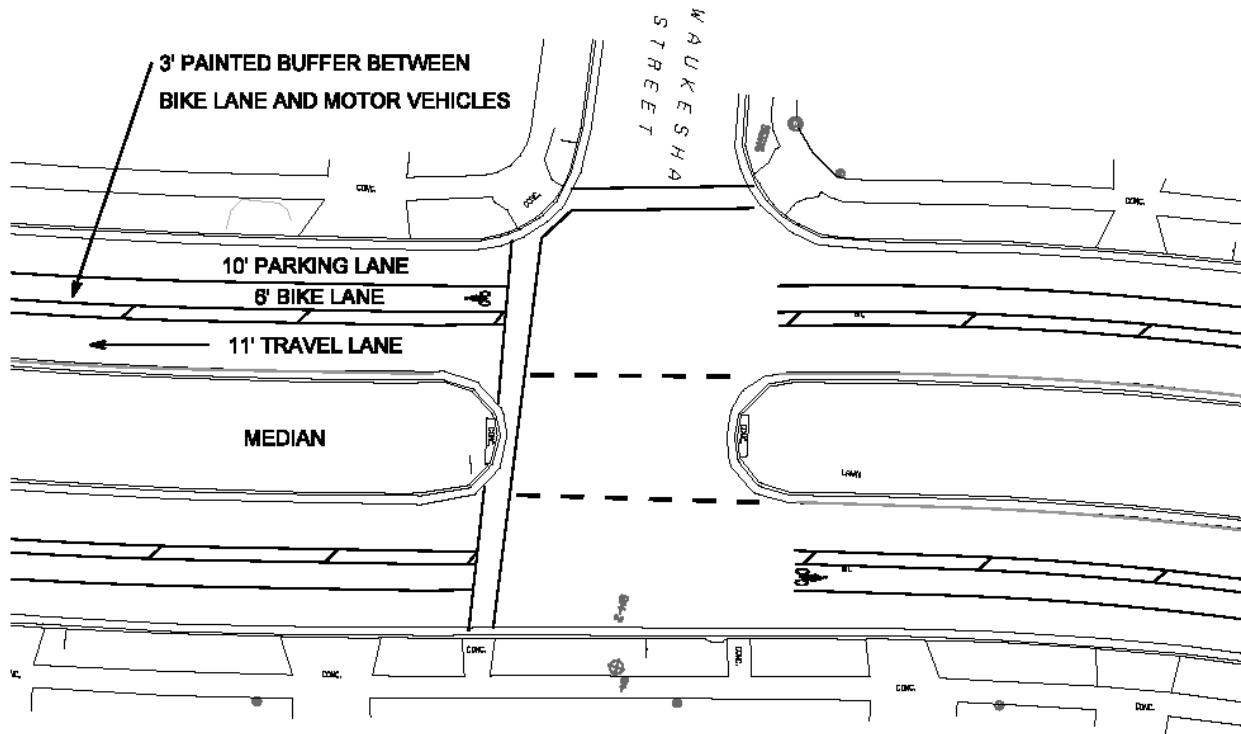

Conclusion

- 4 lanes not needed for motor vehicle traffic
- Long range projections do not warrant 4 traffic lanes
- Parking is maintained
- Cycling conditions are improved
- Cycling connections are improved
- Do not expect severe traffic diversion

Questions?



City Traffic Engineering Division:
tmohr@cityofmadison.com

Segoe and Tokay Crashes

