



ARO EBERLE
ARCHITECTS

BALLINGER

DRAFT
04/16/20

UNIVERSITY OF WISCONSIN – MADISON
COLLEGE OF ENGINEERING
ENGINEERING BUILDING
ADVANCED PLANNING – 19J4J

Joint Campus Area
Committee Presentation
April 29, 2020

Overview

- Engineering Building Advanced Planning Study:**
 - Study Conducted Between January and April of 2020
 - Aro Eberle / Ballinger Design Team, DFDM, UW-System, the College of Engineering and UW-Madison Facility Planning and Management
- New Facilities for College of Engineering:**
 - Strategic University Initiative to Support Increasing Demand For Engineers in the State of Wisconsin / Nationally
 - Support College of Engineering Planned Undergraduate Population Growth to 6,000 Students with Increased Faculty and Research
- Conceptual Programming and Planning:**
 - 340,000 GSF of State of the Art, Flexible Teaching and Research Facilities
 - Implementation in Two Interconnected 170,000 GSF Building Phases
 - Blend of Teaching and Research Environments
 - 6 Stories Above Grade / 1 Story Below Grade / Penthouse + LL Service Tunnel
- Engineering Campus Site:**
 - Iconic, Front-Door Prominent Site for College of Engineering Identity
 - Site Bounded by Campus Drive, North Randall Avenue and Engineering Drive
- Funding:**
 - Blend of GF SB and University / College Gift Funding
 - Anticipated Enumeration:
 - Phase I: 2021 - 2023 Biennium
 - Phase II: 2023 - 2025 Biennium
- Anticipated Schedule:**
 - Phase I: Fall 2020 Start of Design / Spring 2025 Completion of Construction
 - Phase II: Fall 2022 Start of Design / Spring 2027 Completion of Construction

OVERALL PROJECT
PHASE I + PHASE II
340,000 GSF
187,000 ASF
55% N/G

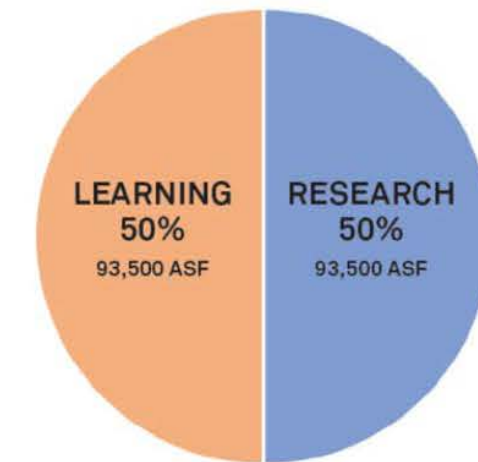

PHASE I
170,000 GSF
93,500 ASF
55% N/G

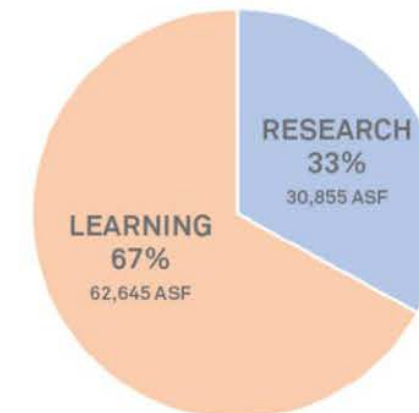

PHASE II
170,000 GSF
93,500 ASF
55% N/G

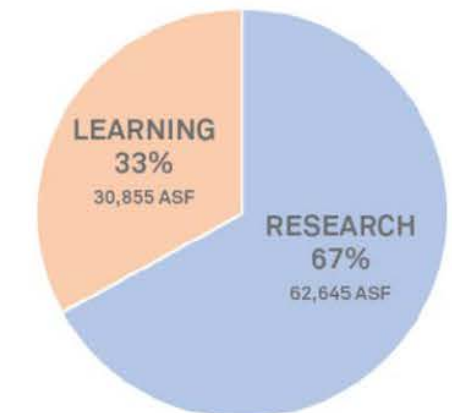

Project Goals / Campus Location

- **Exceptional Engineering Learning + Research Environments to Attract and Retain the Best Students and Faculty In Support of the Future Workforce in the State of Wisconsin**
- **Interdisciplinary Engineering Spaces That Are Highly Flexible For Dynamic Change Over the Long Term**
- **A Vibrant Campus Place That Promotes the Identity of the College of Engineering Within the University and Community**
- **A Transformative Campus Experience Symbolic of Engineering**
- **Embrace Planning, Massing and Guideline Objectives Established by University and College of Engineering Masterplans**
- **Sustainable and Operationally Efficient Facilities**



Context Imagery

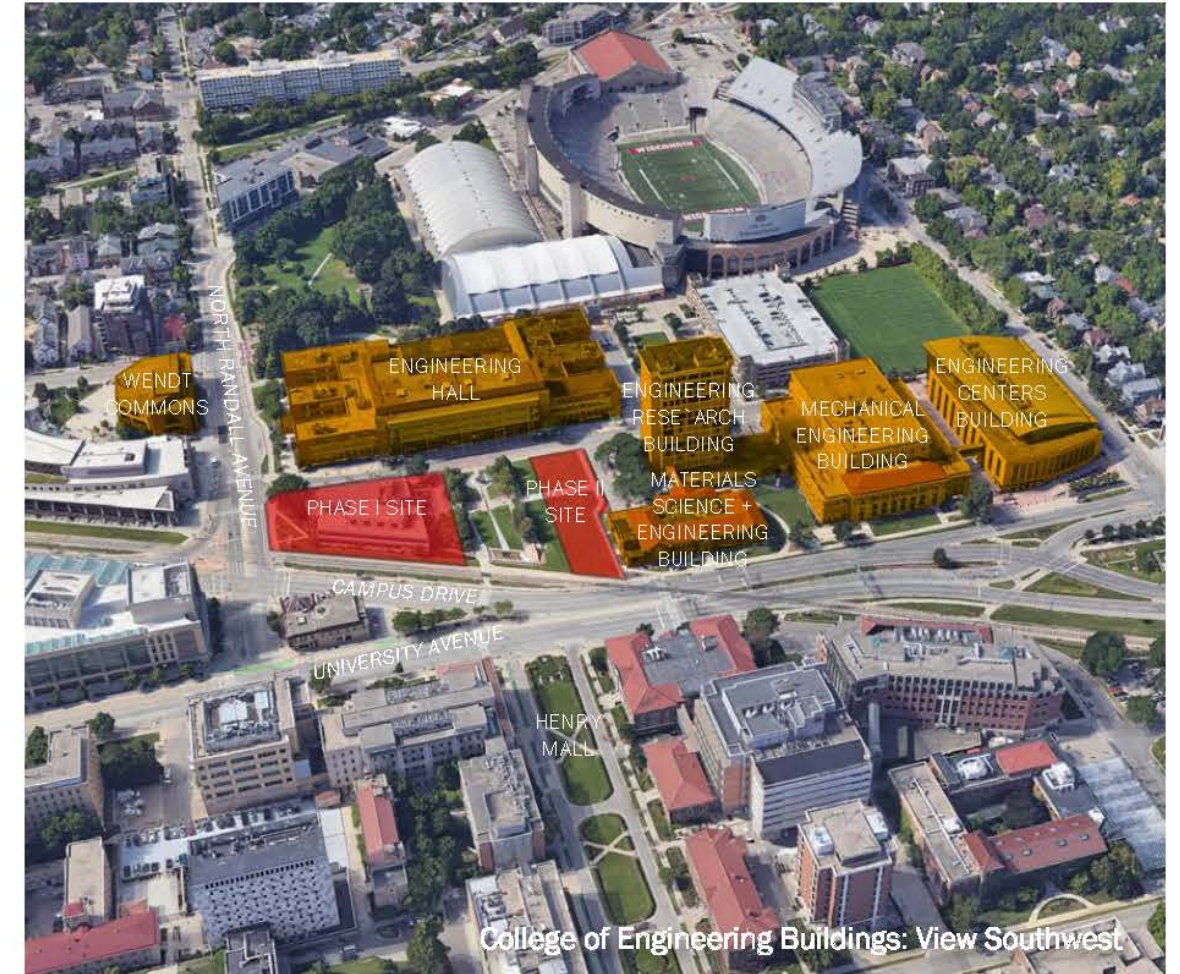

Phase I +II: Context Plan / Imagery

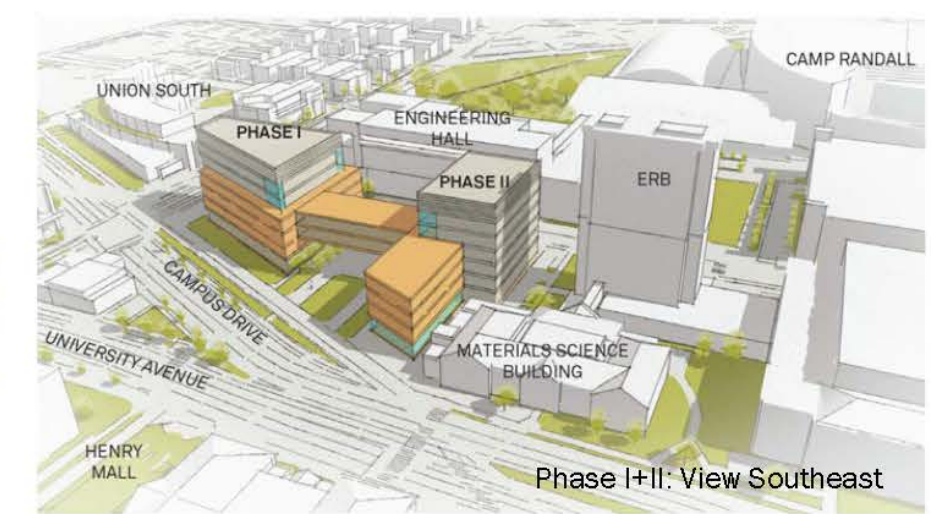
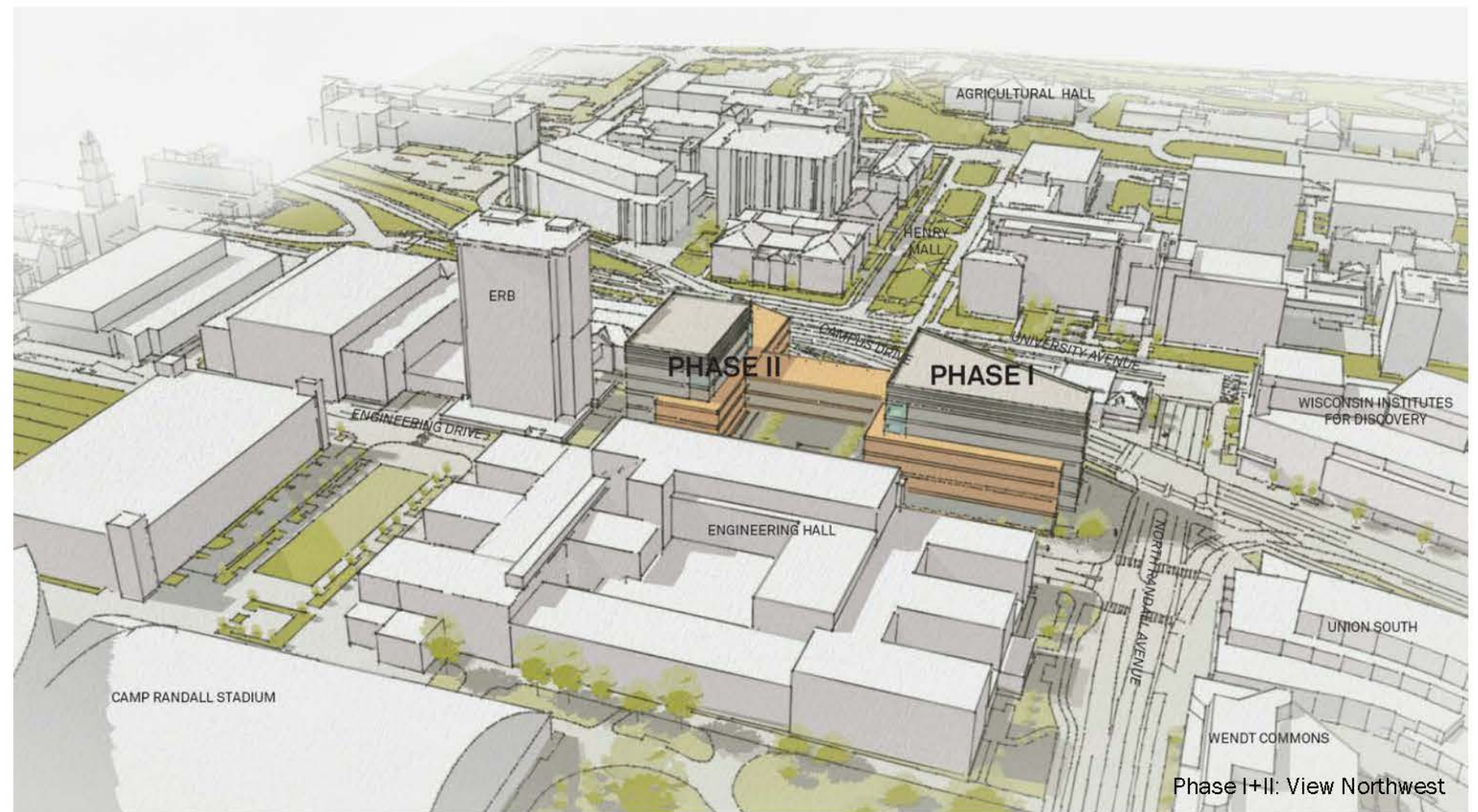
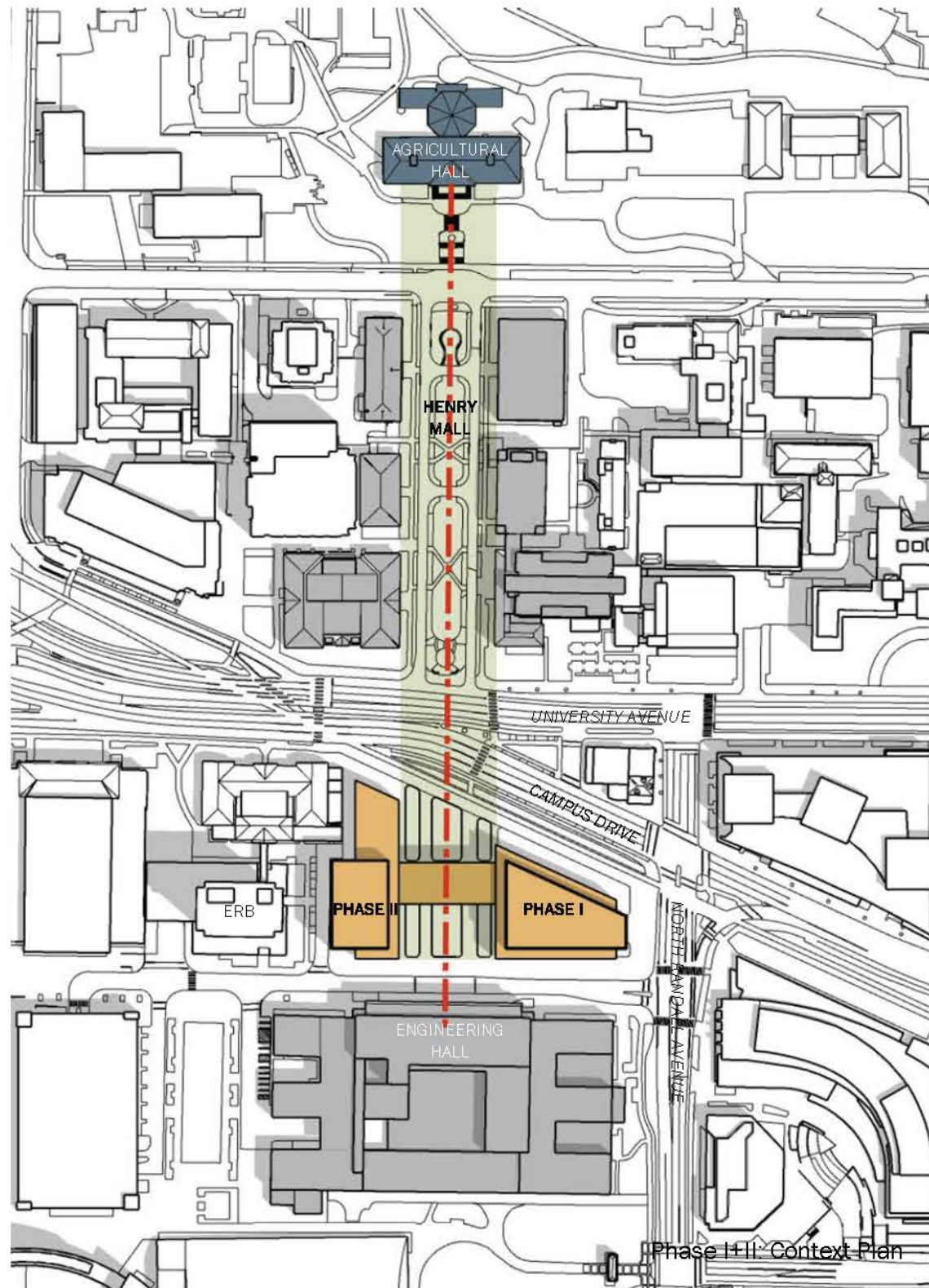

Phase I: Site Plan

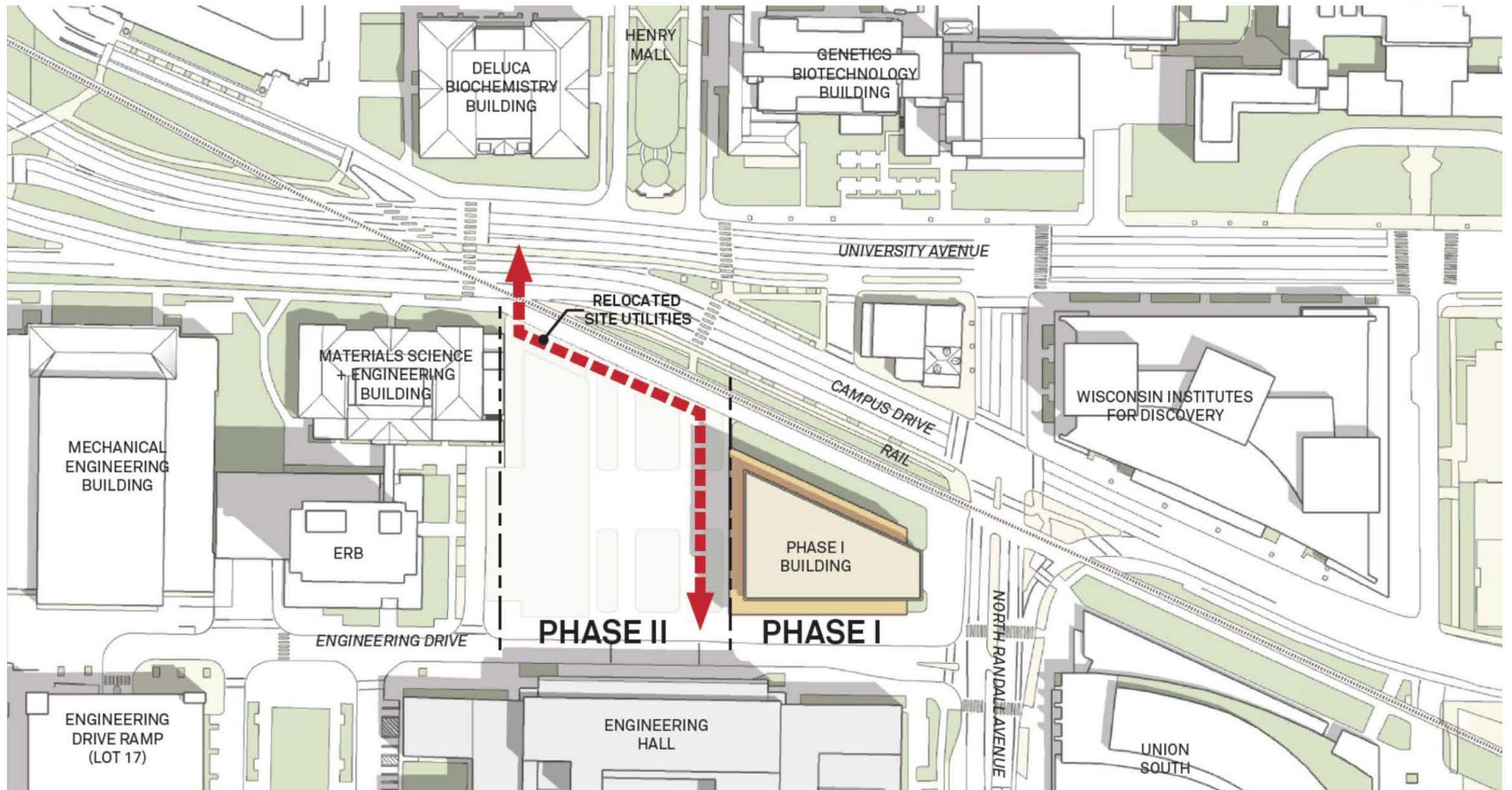

Phase I: Site Section View North

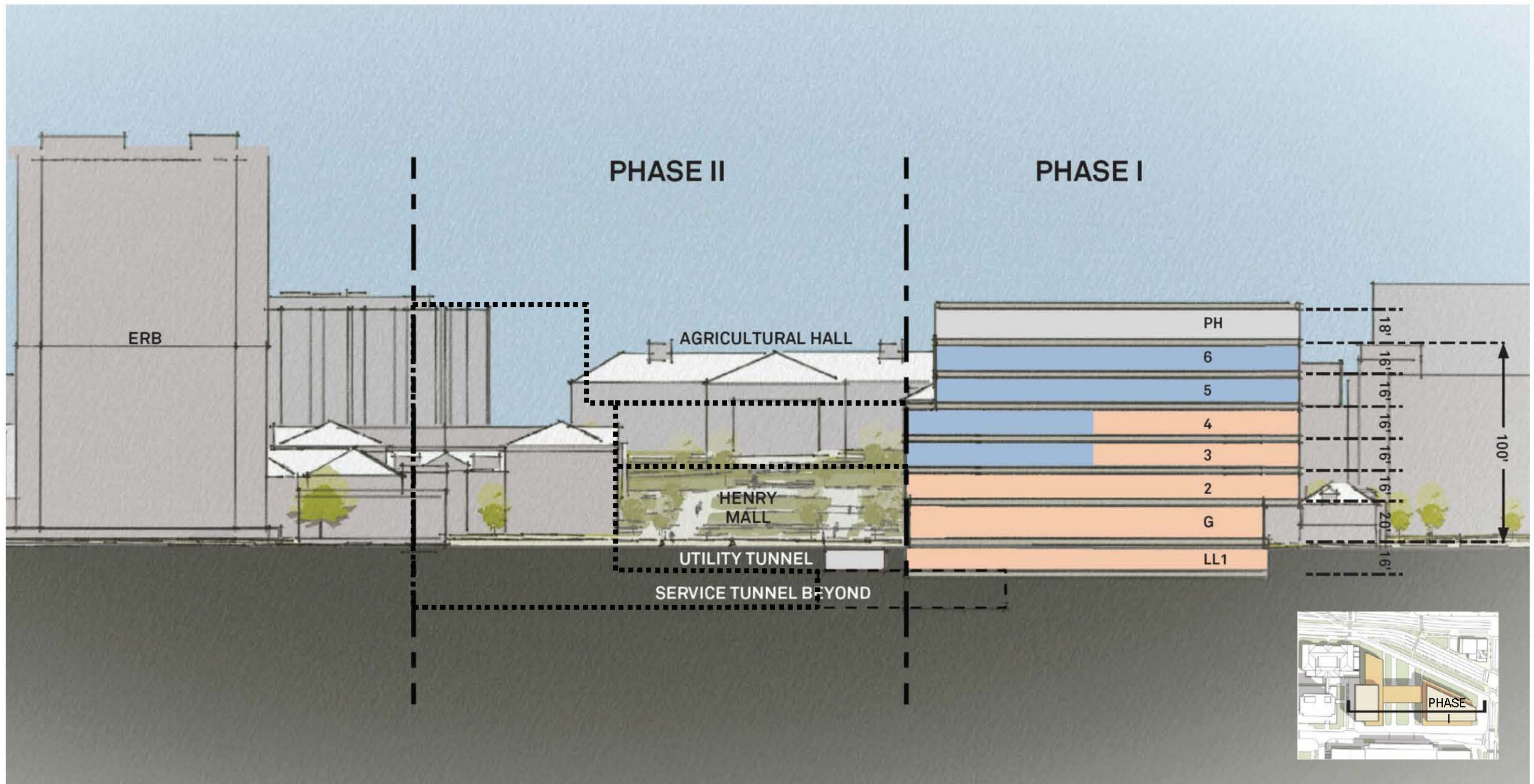

Phase I Massing: View Southwest

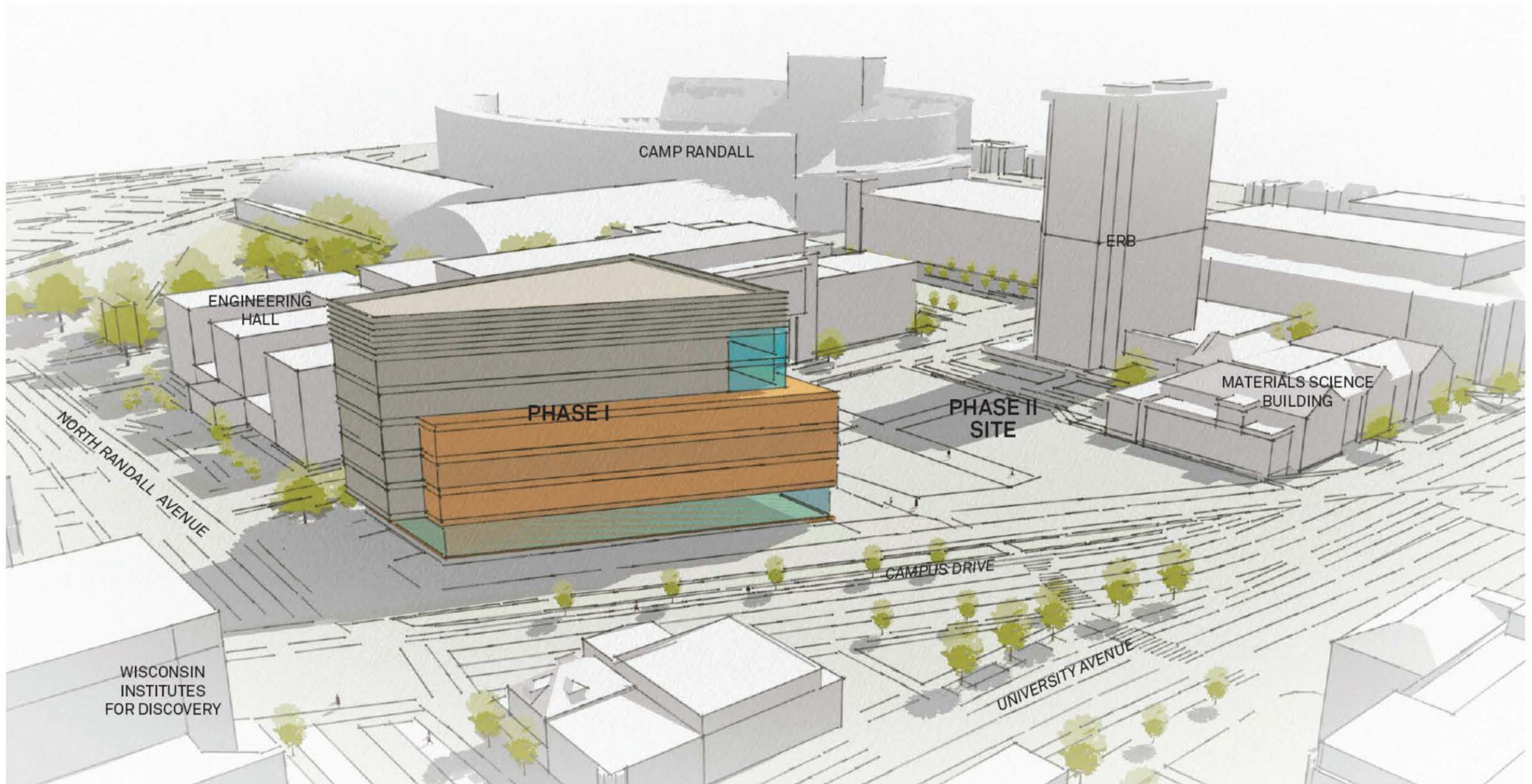

Phase I: Massing

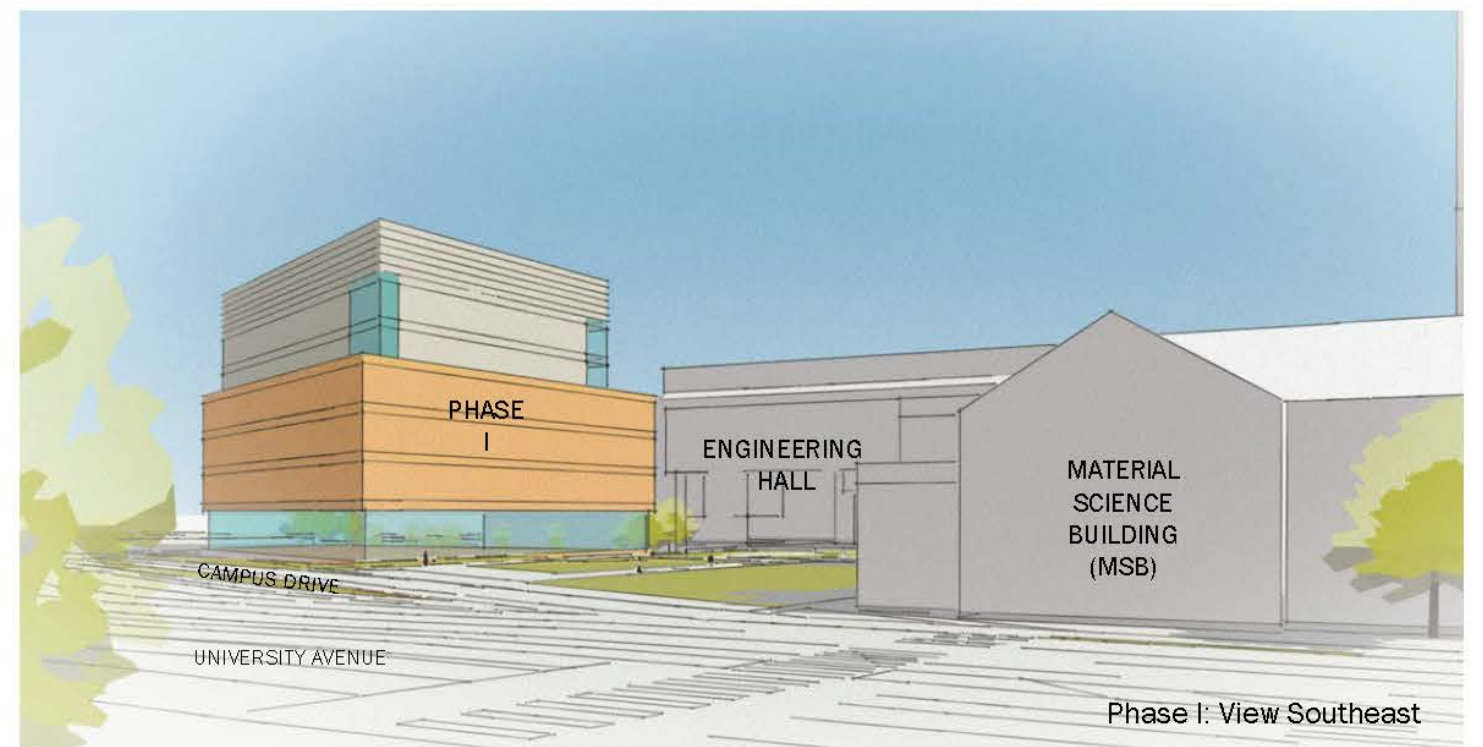
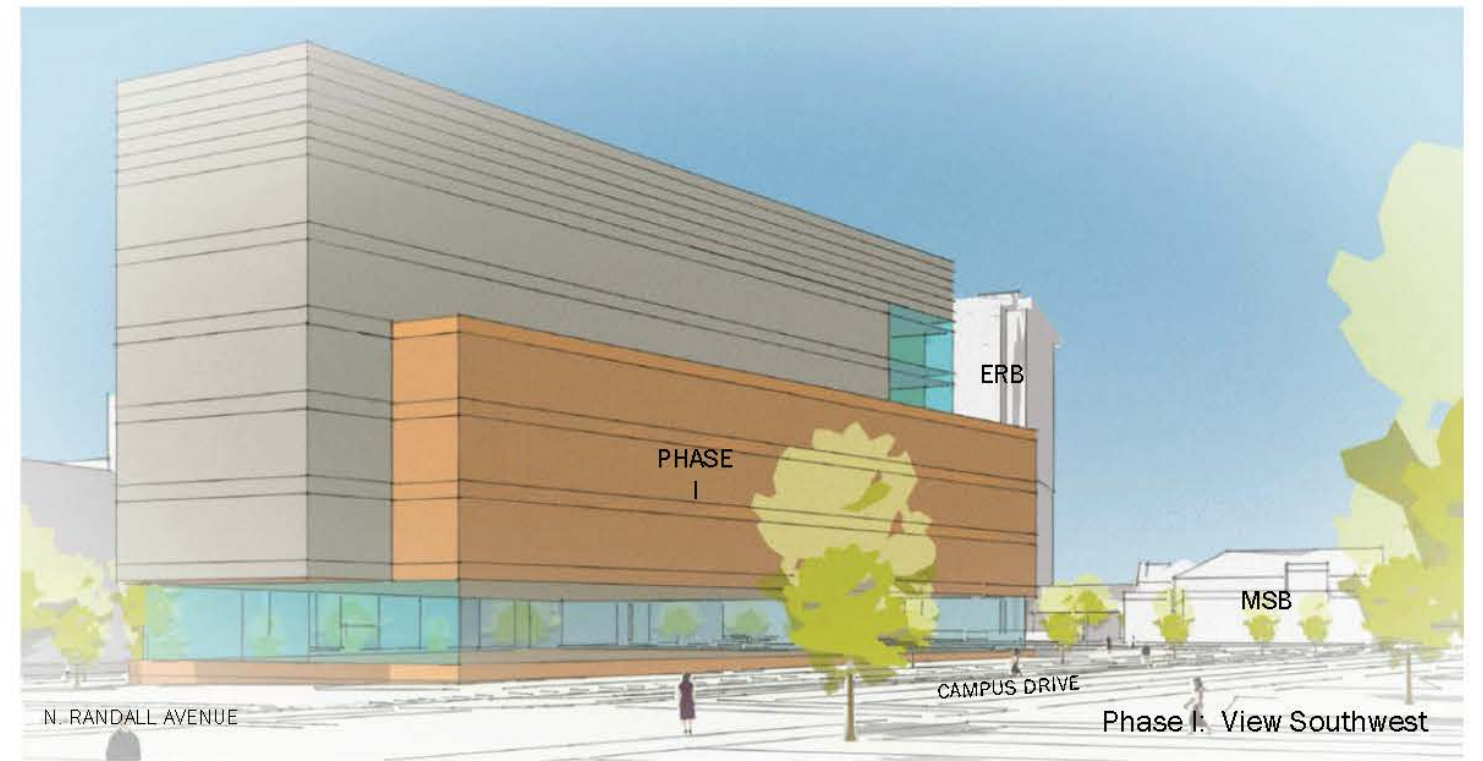
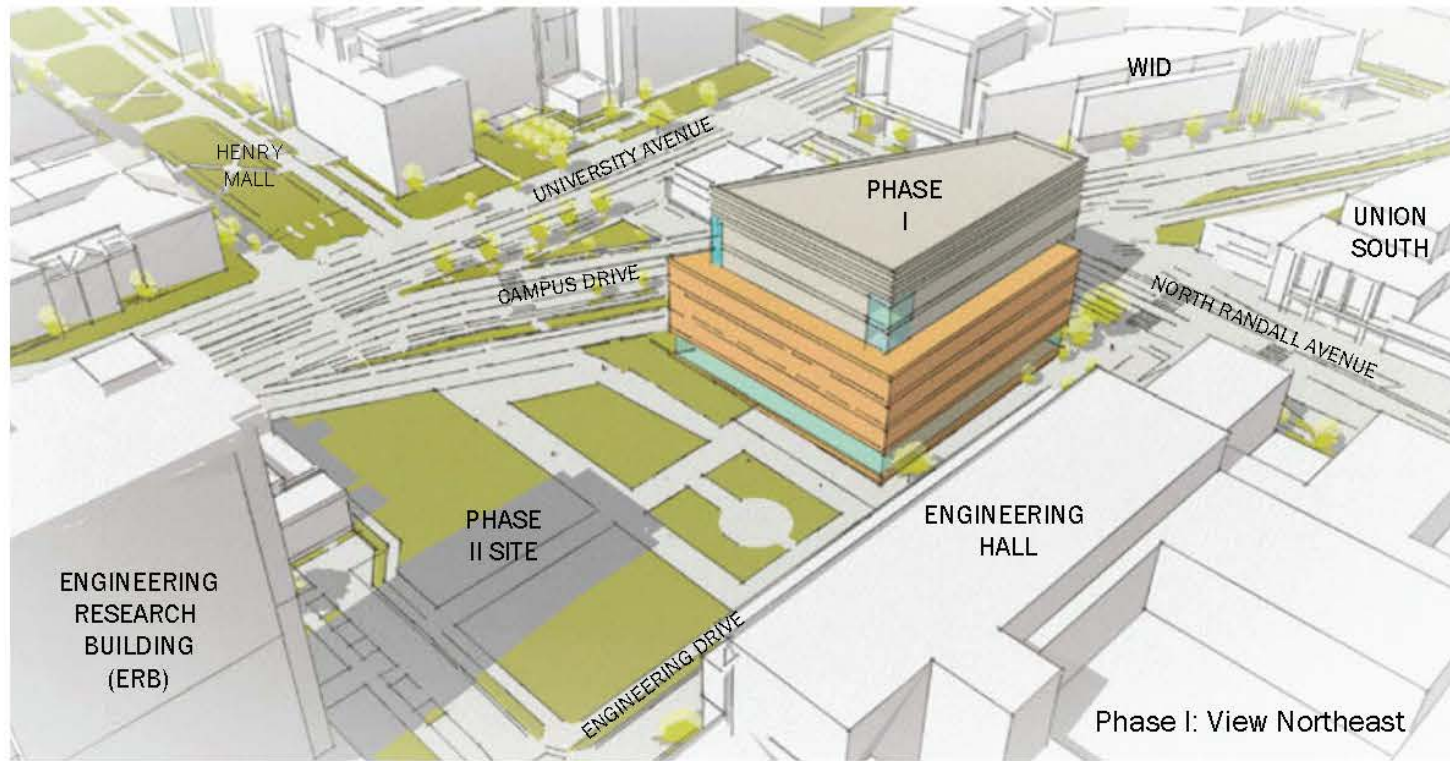

Phase I + Phase II: Views at Henry Mall

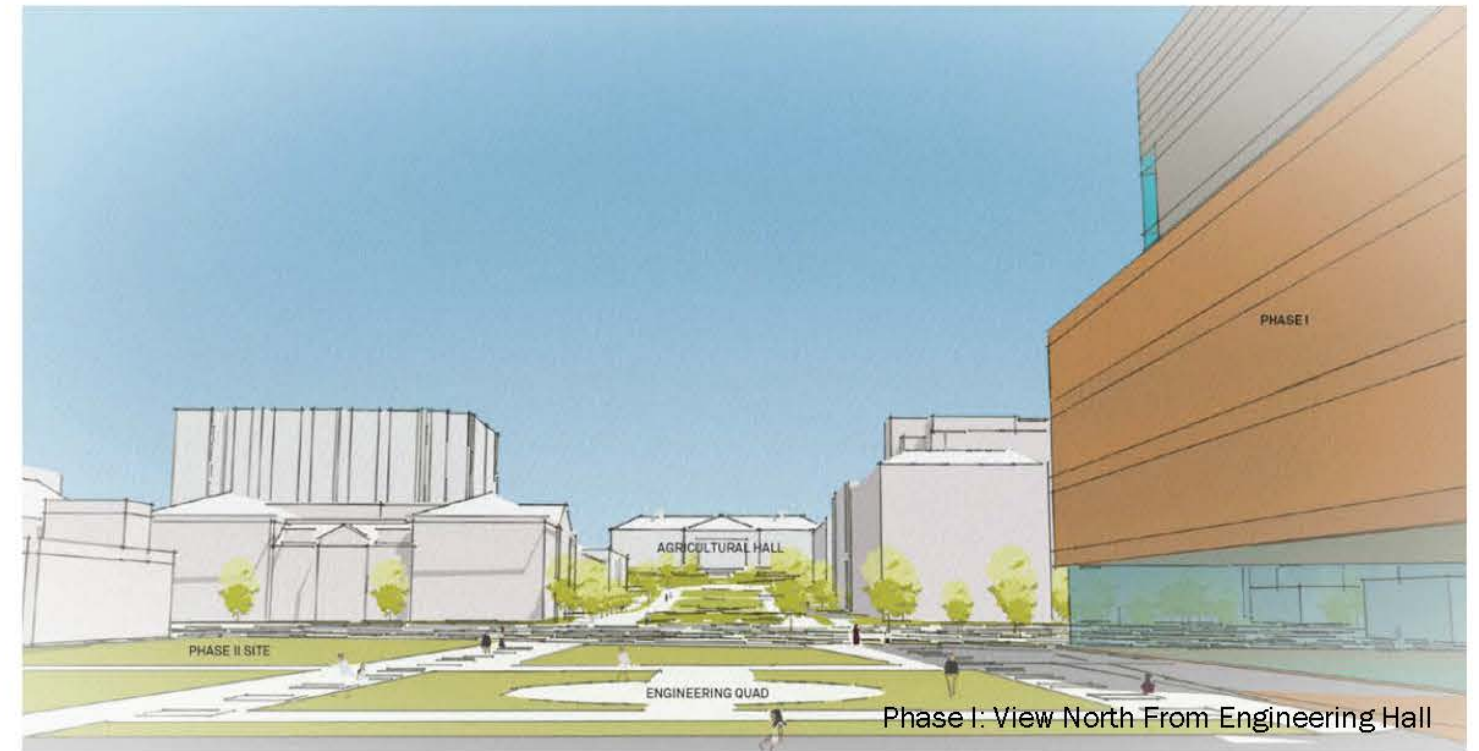

Phase I+II: In Context of University Masterplan Future Buildings

