

MTCCC

New Resinous Floor

May 15, 2013

Project No. 5 Description: Application of new composition resinous floor surfacing system over existing resinous flooring and base.

Potter Lawson No. 2013.07.00

Potter Lawson

Page Intentionally Left Blank

PROJECT: MTCCC
NEW RESINOUS FLOOR

OWNER: MONONA TERRACE COMMUNITY AND
CONVENTION CENTER
ONE JOHN NOLEN DRIVE
MADISON, WISCONSIN 53703

ARCHITECT: POTTER LAWSON, INC.
15 ELLIS POTTER COURT (53711)
P.O. BOX 44964
MADISON, WI 53744-4964
PHONE (608) 274-2741

Page Intentionally Left Blank

TABLE OF CONTENTS

1
2
3
4
5
6
7
8
9
10
11
12
13
14
15
16
17
18
19
20

SPECIFICATIONS

00 01 01 Project Title Page
00 01 10 Table of Contents
09 67 23 Resinous Flooring

PAGES
THROUGH

00 01 01-1
00 01 10-1
09 67 23-4

DRAWINGS

A101 New Resinous Floor Plan

End of Table of Contents

Page Intentionally Left Blank

SECTION 09 67 23 - RESINOUS FLOORING

1
2
3
4
5
6
7
8
9
10
11
12
13
14
15
16
17
18
19
20
21
22
23
24
25
26
27
28
29
30
31
32
33
34
35
36
37
38
39
40
41
42
43
44
45
46
47
48
49
50
51
52
53
54
55
56
57

PART ONE - GENERAL

DESCRIPTION

Composition resinous floor surfacing system applied over existing resinous flooring and base where indicated on Drawing A101.

RELATED WORK AND REQUIREMENTS

COORDINATION

Coordinate with Owner’s Project Representative for the removal of existing moveable equipment and fixed equipment to remain in place to permit substrate preparation and new flooring installation.

SUBMITTALS

Product Data: Submit manufacturer's technical data, preparation and installation instructions, and general recommendations for each resinous flooring material required. Include certification indicating compliance of materials with requirements.

Samples: Submit 6-inch square samples of each type of resinous flooring including inside and outside cove base corners, applied to a rigid backing, in color and texture matching existing flooring.

Qualification Data: Submit installer qualifications.

Maintenance Instructions: Submit manufacturer’s written instructions for recommended maintenance practices for each flooring system specified.

QUALITY ASSURANCE

Installer Qualifications: Engage an Installer who is acceptable to manufacturer of primary materials and who has successfully completed within the last 5 years at least 3 resinous flooring applications similar in type and size to that of this project and who will assign mechanics from these earlier applications to this project, of which one will serve as lead mechanic.

Single Source Responsibility: Obtain resinous flooring materials, including primers, resins, hardening agents, and finish coats from a single manufacturer.

Mockups: Minimum 100 sq. ft. of flooring in location directed by Owner to demonstrate aesthetic effects and set quality standards for materials and execution.

DELIVERY, STORAGE AND HANDLING

Deliver materials in original packages and containers with seals unbroken and bearing manufacturer's labels containing brand name and directions for storage and mixing with other components.

Store materials to comply with manufacturer's directions to prevent deterioration from moisture, heat, cold, direct sunlight, or other causes.

PROJECT CONDITIONS

Environmental Conditions: Comply with resinous flooring manufacturer's directions for maintenance of substrate temperatures, ventilation, and other conditions required to execute and protect work.

1 Control and collect dust produced by floor preparation operations. Protect adjacent surfaces from detrimental
2 effects of floor preparation operations.

3
4 Provide dustproof partitions and temporary enclosures to limit dust migration.
5

6 7 **PART TWO - PRODUCTS**

8 9 RESINOUS FLOORING

10
11 Basis-of-Design Product: Subject to compliance with requirements, provide Crossfield Products Corporation;
12 Dex-O-Tex Decor-Flor Broadcast Epoxy Floor with Dexside anti-microbial additive flooring system or an
13 equivalent flooring system by, but not limited to, one of the following:

14
15 General Polymers
16 Industrial Protective Coatings
17 Key Resin Company
18 Micor Company, Inc.
19 Sika Corporation
20 Stonhard, Inc.
21 Tnemec Co., Inc.
22

23 MATERIALS

24
25 Flooring System: Troweled and broadcast decorative resin composition floor surfacing system consisting of
26 prime coat, topping including epoxy resin, hardener, and ceramic coated quartz aggregate and topcoats.
27

28 Prime Coat: Dex-O-Tex Cheminert C-Bond or other product recommended by manufacturer for existing
29 substrate and use indicated.
30

31 Epoxy Resins: Manufacturer's standard recommended for use indicated.
32

33 Sealing Coat: Dex-O-Tex Quick-Glaze or other sealer product recommended by manufacturer.
34

35 Sealants: Type recommended or produced by manufacturer of resinous flooring system for type of service and
36 joint condition.
37

38 COLOR AND FINISH

39
40 Color and texture to match existing resinous flooring.
41
42

43 **PART THREE - EXECUTION**

44 45 INSPECTION

46
47 It is the Bidder's responsibility to determine the quantities of materials and labor required to complete all the
48 Work of this Section.
49

50 Before submitting a bid, each Bidder shall visit and inspect the project site to become acquainted with the
51 adjacent areas, means of approach to the site, conditions of actual job site, and facilities for delivering, storing,
52 placing, and handling of materials and equipment.
53

54 Failure to visit the project site or failure to examine any and all Contract Documents will in no way relieve the
55 successful Bidder from necessity of furnishing any materials or equipment, or performing any work, that may be
56 required to complete the work in accordance with the Contract Documents. Neglect of above requirements will
57 not be accepted as reason for delay in the work or additional compensation.

1 SUBSTRATE PREPARATION

2

3 Perform preparation and cleaning procedures in compliance with flooring manufacturer's instructions for
4 particular existing substrate conditions indicated to receive resinous flooring. Provide clean, dry, and neutral
5 substrate for flooring application.

6

7 Existing Resinous Floor and Base Finish:

8

9 Prepare substrates to receive resinous flooring and cove base.

10

11 Lightly shot-blast or diamond grind existing flooring surfaces as required to obtain optimum bond of new
12 flooring to existing flooring. Remove sufficient material to provide a sound surface free of any bond-
13 inhibiting materials or compounds. Remove dust, dirt, grease, oil, and other contaminants incompatible
14 with resinous flooring.

15

16 Repair damaged and deteriorated resinous flooring and base to acceptable condition according to resinous
17 flooring manufacturer's written recommendations.

18

19 Protect other building areas and equipment from dust generated by substrate preparation operations. Erect and
20 maintain temporary enclosures and other suitable methods to limit dust migration to other areas of the building.

21

22 MATERIALS PREPARATION

23

24 Carefully mix and prepare materials used in resinous flooring system in strict compliance with manufacturer's
25 instructions.

26

27 APPLICATION

28

29 General: Apply each component of resinous flooring system in compliance with manufacturer's directions to
30 produce a uniform monolithic wearing surface of thickness indicated, uninterrupted except at existing floor
31 control, expansion, and other types of joints (if any).

32

33 Prime Coat: Trowel apply a primer coat of Cheminert C-Bond with a grout powder (silica flour) additive over
34 prepared existing substrates at manufacturer's recommended thickness to fill in low spots, cracks, joints, holes,
35 and other minor surface irregularities to ensure a uniform floor surface. Install 8 oz. fiberglass cloth embedded in
36 epoxy resin over cracks and joints prior to application of primer.

37

38 Topping Mix (Double Broadcast Application): Trowel apply self-leveling epoxy adhesion coat over freshly
39 applied primer at predetermined rates recommended by manufacturer. Saturate wet adhesion coat with aggregate
40 by broadcast method. Scrape off and remove excess aggregate. Apply second adhesion coat and aggregate in
41 same method as first application to produce a total flooring thickness of 1/16- to 1/8-inch.

42

43 Cove Base: Trowel apply floor system to wall surfaces, columns, and similar surfaces to form base with cove or
44 radius and a height to match existing. Round all interior and external corners. Provide 1/8 inch non-rusting metal
45 or zinc termination cap strip at top of base. Apply continuous fillet of sealant along top of metal termination cap
46 strip and tool to form smooth uniform bead.

47

48 Joints: Where expansion or control joints interrupt substrate, provide joint in resinous flooring to comply with
49 details recommended by resinous flooring manufacturer.

50

51 Finish Coat: After topping coat has cured sufficiently, sand floor, base and corners to eliminate trowel marks,
52 high spots, and other surface irregularities. Apply two coats of clear sealer of type and spreading rates
53 recommended by manufacturer to produce color and textured finishes to match approved mockup. Obtain
54 Owner's approval of resinous flooring after application of first sealer coat and prior to application of final sealer
55 coat.

56

57 Sealant: Apply joint sealant materials to comply with resinous flooring manufacturer's recommendations.

1 CURING, CLEANING AND PROTECTION

2

3 Cure resinous flooring materials in compliance with manufacturer's directions, taking care to prevent
4 contamination during stages of application and prior to completion of curing process.

5

6 Protect resinous flooring materials from damage and wear during construction operation. Where temporary
7 covering is required for this purpose comply with manufacturer's recommendations for protective materials and
8 method of application. Remove temporary covering just prior to cleaning for final inspection.

9

10 Clean resinous flooring just prior to final inspections. Use cleaning materials and procedures recommended by
11 resinous flooring manufacturer.

12

13

14

15

End of Section

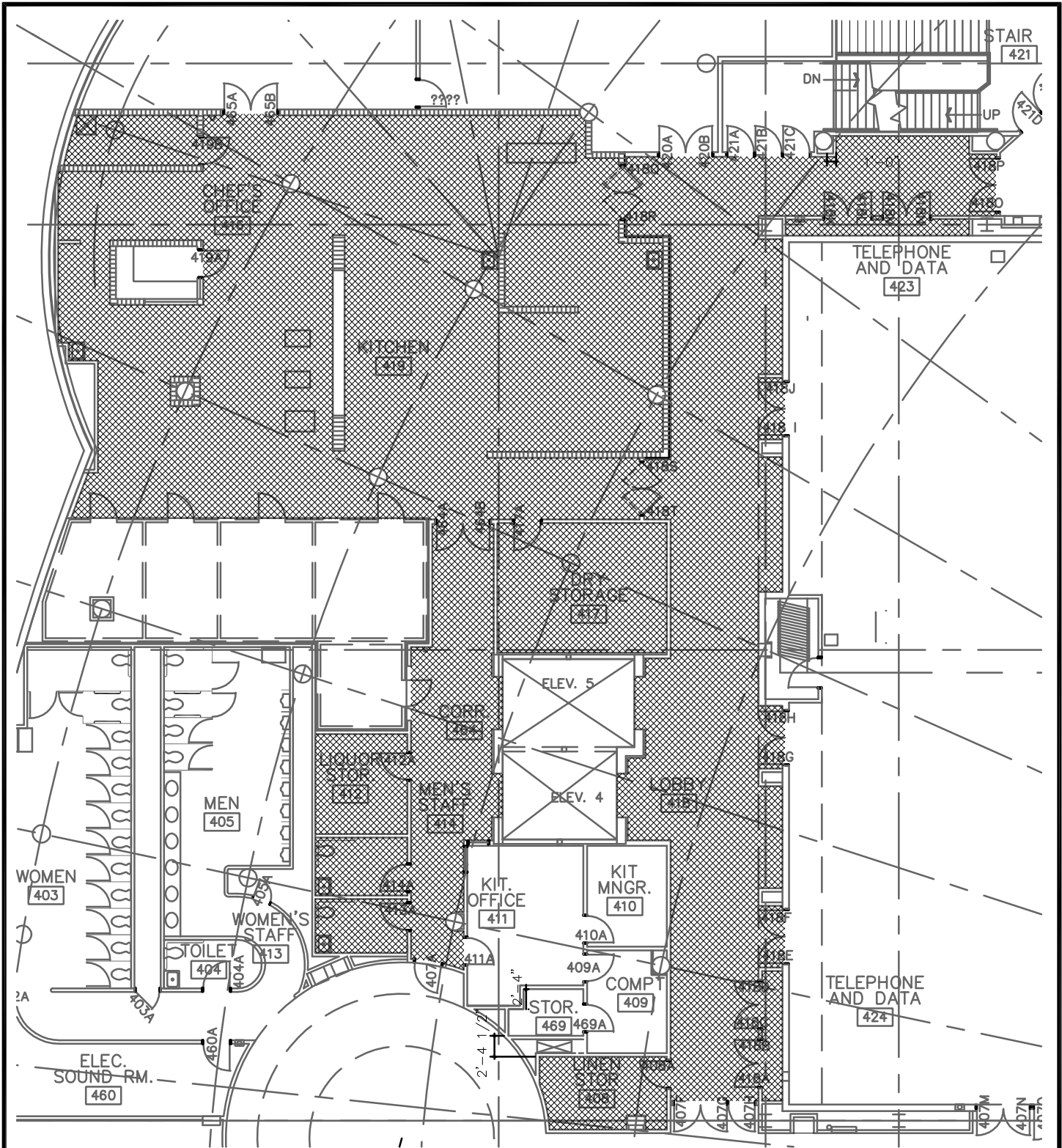

1 ENLARGED LEVEL +40' FLOOR PLAN
 1/16 = 1'-0"

SHADED AREAS REPRESENT EXISTING RESINOUS FLOOR AND BASE FINISH TO RECEIVE NEW RESINOUS FLOOR AND BASE FINISH.