

# PHASE 1

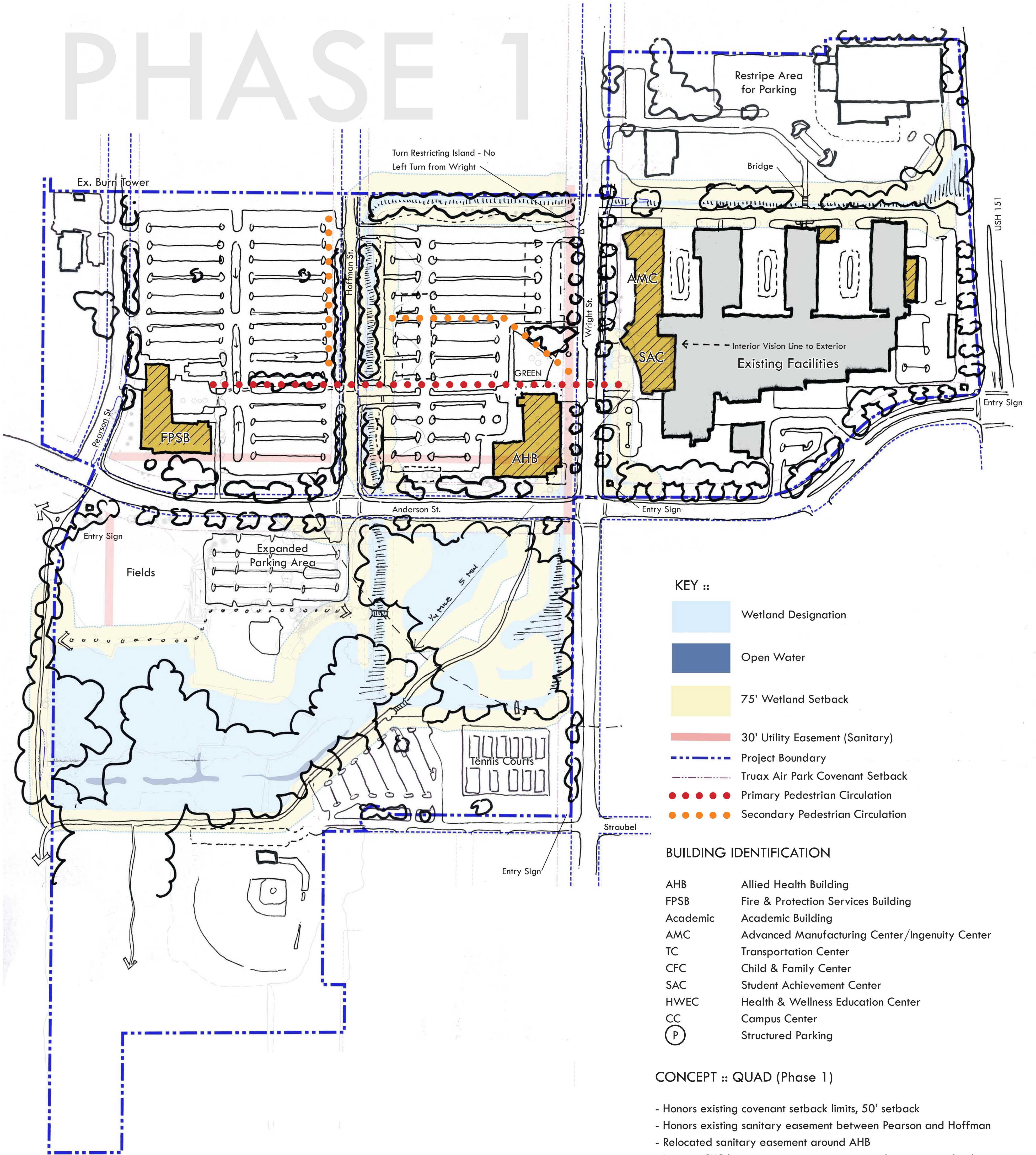

**KEY ::**

- Wetland Designation
- Open Water
- 75' Wetland Setback
- 30' Utility Easement (Sanitary)
- Project Boundary
- Truax Air Park Covenant Setback
- Primary Pedestrian Circulation
- Secondary Pedestrian Circulation

**BUILDING IDENTIFICATION**

- AHB Allied Health Building
- FPSB Fire & Protection Services Building
- Academic Academic Building
- AMC Advanced Manufacturing Center/Ingenuity Center
- TC Transportation Center
- CFC Child & Family Center
- SAC Student Achievement Center
- HWEC Health & Wellness Education Center
- CC Campus Center
- (P) Structured Parking

**CONCEPT :: QUAD (Phase 1)**

- Honors existing covenant setback limits, 50' setback
- Honors existing sanitary easement between Pearson and Hoffman
- Relocated sanitary easement around AHB
- Locates CFC between sanitary easement and covenant setback
- Wetland setback encroached upon by AHB
- Removes wetlands on east side of Wright St.
- Northern area remains in current condition, restripe for max. parking
- Buildings pushed up against easement along Wright St.
- Enhanced stormwater conveyance channel (dashed line shown for future)
- Primary pedestrian circulation into southern portion of SAC
- Beginnings of Quad started
- Wright St. to be restriped with two travel lanes, two bus lanes, two bike lanes
- Pedestrian crossing narrowed to 2 travel lanes + 2 bike lane widths
- Softball field parking lot is expanded upon (if necessary)
- SAC plaza replicated west of Wright St.
- Primary identification signage shown at campus entry points
- Realign trail/walk access from Tennis Court Parking area

## CONCEPT :: QUAD (PHASE 1)

# BUILD OUT

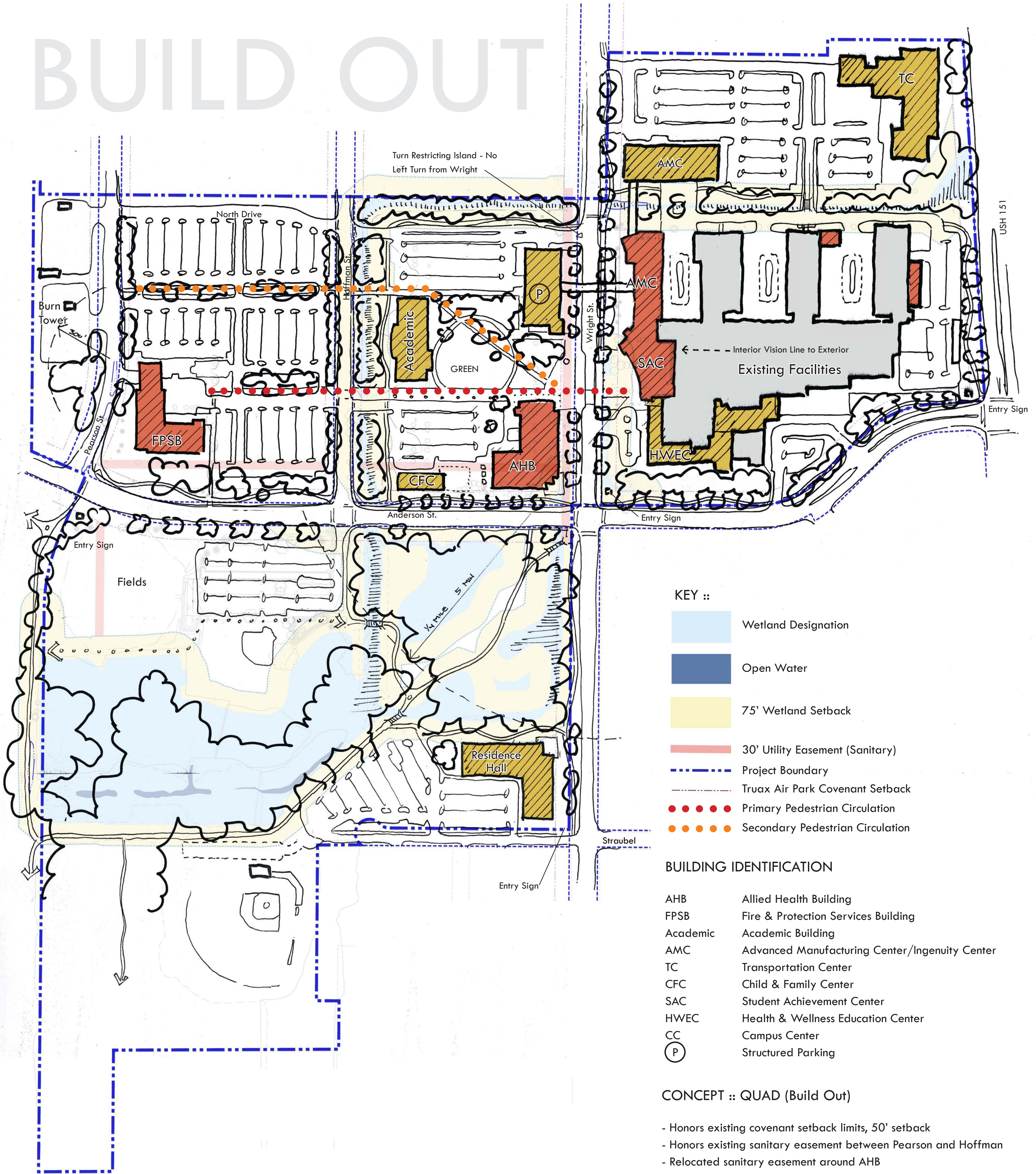

- KEY ::**
- Wetland Designation
  - Open Water
  - 75' Wetland Setback
  - 30' Utility Easement (Sanitary)
  - Project Boundary
  - Truax Air Park Covenant Setback
  - Primary Pedestrian Circulation
  - Secondary Pedestrian Circulation

- BUILDING IDENTIFICATION**
- AHB Allied Health Building
  - FPSB Fire & Protection Services Building
  - Academic Academic Building
  - AMC Advanced Manufacturing Center/Ingenuity Center
  - TC Transportation Center
  - CFC Child & Family Center
  - SAC Student Achievement Center
  - HWEC Health & Wellness Education Center
  - CC Campus Center
  - (P) Structured Parking

- CONCEPT :: QUAD (Build Out)**
- Honors existing covenant setback limits, 50' setback
  - Honors existing sanitary easement between Pearson and Hoffman
  - Relocated sanitary easement around AHB
  - Locates CFC between sanitary easement and covenant setback
  - Wetland setback encroached upon by AHB
  - Northern area built out with access drive aligned with building bay
  - Buildings pushed up against easement along Wright St.
  - Enhanced stormwater conveyance channel (path, trees, nodes)
  - Primary pedestrian circulation into southern portion of SAC
  - Traditional campus 'Quad' fully built out and defined by architecture
  - Wright St. be restiped with two travel lanes, two bus lanes, two bike lanes
  - Urbanize corridor along Wright St. Implement 'green street' principles
  - Pedestrian crossing narrowed to 2 travel lanes + 2 bike lane widths
  - Academic building addresses conveyence corridor with outdoor plaza
  - Softball field parking lot is expanded upon
  - Sidewalks broadly meander along campus edges and follow R/W on interior

