



Department of Public Works

Streets Division – Urban Forestry

Charlie Romines, Superintendent

1402 Wingra Creek Pkwy.

Madison, WI 53715

Phone: (608) 266-4816 | Fax: (608) 267-8696

streets@cityofmadison.com

cityofmadison.com/forestry

Street Tree Report – Land Use Application

In exercising its responsibility under the foregoing ordinances and Department Of Public Works construction specifications, the Forestry Section requires the applicant to submit a Street Tree Report from a certified arborist as part of a Land Use Application submittal. The Forestry Section will evaluate the report below for street tree protection during construction activities, proposed tree removals and deposits for developers' agreements as part of the forestry approval process. If it is necessary to remove a street tree, a separate permit from Forestry will be required. The Forestry Section must be informed of any change in this information as it could impact the Forestry Section's report and approval.

Please note on the **proposed plan** any pruning beyond what is considered to be acceptable by **ANSI A300 pruning standards** or if street tree removal may be necessary due to the impacts of construction, staging/delivery areas, or other activities.

SECTION 1 – APPLICANT AND CERTIFIED ARBORIST INFORMATION

APPLICANT

NAME Drury Madison, LLC

BUSINESS PHONE 573-335-3134 CELL PHONE _____ EMAIL bruce.pfeifer@drurysouthwest.com

MAILING ADDRESS 101 S Farrar Dr

CITY Cape Girardeau STATE MO ZIP 63702

CONSULTING CERTIFIED ARBORIST

NAME Jeremy Kane CERTIFIED ARBORIST NUMBER WI-1308A Master Arborist

BUSINESS PHONE 845-532-4694 CELL PHONE _____ EMAIL jkane.uta@gmail.com

MAILING ADDRESS 14 Wakeman St

CITY Madison STATE WI ZIP 53705

WORK LOCATION:

STREET ADDRESS 200 Wisconsin Ave

CROSS STREETS W Johnson & E Dayton

SECTION 2 – STREET TREE INVENTORY AND CONSTRUCTION IMPACT

STREET TREE NUMBER	Tree Species (Common Name)	Trunk Diameter (DBH)	Canopy Spread (Ft)	Trunk/Roots: General Structure/Health/ Condition	Removal (R) Requested by Applicant? (Yes or No) *Photos required*	Pruning by City Forestry requested (Yes or No). Note: Any Pruning must follow ANSI A300 Standards.	What are the impacts of proposed building? i.e., construction, staging, underground vaults, concrete pumps, scaffolding, new underground utilities, etc.	What are the earth retention impacts to the street trees?
1	green ash	24"	56'	Excellent. Minimal, typical deadwood in canopy. Treated. Raised root collar.	<input type="checkbox"/> Yes <input checked="" type="checkbox"/> No	<input checked="" type="checkbox"/> Yes <input type="checkbox"/> No		None
2	green ash	24"	48'	Excellent. Treated	<input type="checkbox"/> Yes <input checked="" type="checkbox"/> No	<input checked="" type="checkbox"/> Yes <input type="checkbox"/> No		None
3	green ash	16"	48'	Good. Constrained rootzone- concrete walk and curb withing 4ft of tree on two sides. Flag pole in rooting zone. Treated	<input type="checkbox"/> Yes <input checked="" type="checkbox"/> No	<input checked="" type="checkbox"/> Yes <input type="checkbox"/> No		None
4	green ash	12"	42'	Good. Utility boxes within the rooting zone.	<input type="checkbox"/> Yes <input checked="" type="checkbox"/> No	<input checked="" type="checkbox"/> Yes <input type="checkbox"/> No		None
5	honey locust	3"	9"	Fair. Irregular, stunted canopy form. Approx 4'x8' rooting zone in tree pit.	<input type="checkbox"/> Yes <input checked="" type="checkbox"/> No	<input checked="" type="checkbox"/> Yes <input type="checkbox"/> No		None
6					<input type="checkbox"/> Yes <input type="checkbox"/> No	<input type="checkbox"/> Yes <input type="checkbox"/> No		
7					<input type="checkbox"/> Yes <input type="checkbox"/> No	<input type="checkbox"/> Yes <input type="checkbox"/> No		
8					<input type="checkbox"/> Yes <input type="checkbox"/> No	<input type="checkbox"/> Yes <input type="checkbox"/> No		
9					<input type="checkbox"/> Yes <input type="checkbox"/> No	<input type="checkbox"/> Yes <input type="checkbox"/> No		

10					<input type="checkbox"/> Yes <input type="checkbox"/> No	<input type="checkbox"/> Yes <input type="checkbox"/> No		
----	--	--	--	--	---	---	--	--

Please attach a **plan** of the proposed project site that includes street trees corresponding to the street tree listed in Section 2 of Street Tree Inventory.

Additional notes:

Describe impacts and any mitigation actions employed:

See Drury Tree Protection Exhibit

SECTION 3 – PHOTO DOCUMENTATION

Please attach photos. The group of photos must include:

- A photo to best depict the street tree relative to the proposed project.
- Date and timestamp of when photo was taken.

SIGNATURE CERTIFICATION

I hereby certify that I have presented an accurate and truthful representation of the proposed building and construction impacts to City street trees and a complete inventory of affected street trees and their condition herein, and that I will update this information and this report should any of this information change. I have worked to ensure compliance with all accepted professional standards in arboricultural practices and to ensure compliance with all applicable laws, regulations, policies and ethical standards. In the event the contractor has failed to comply with all applicable laws, regulations, policies and ethical standards; or created conditions that may present a hazard to people or property, I have immediately notified the appropriate representative of City of Madison Forestry Section at (608)266-4816.



CONSULTING ARBORIST SIGNATURE

WI-1308A

ISA CERTIFICATION #

DEVELOPER APPLICANT SIGNATURE

DO NOT WRITE BELOW THIS LINE

CITY OF MADISON FORESTRY SECTION OFFICE USE ONLY:

CONSULTING ARBORIST REPORT

☐ APPROVED ☐ REJECTED

DATE: _____

☐ REVISED DATE _____

CITY EMPLOYEE NAME _____

TITLE _____

SIGNATURE OF CITY EMPLOYEE _____ DEPOSIT REQUIRED \$ _____

LIST OF ADDITIONAL STREET TREE INVENTORY AND CONSTRUCTION IMPACT

STREET TREE NUMBER	Tree Species (Common Name)	Trunk Diameter (DBH)	Canopy Spread (Ft)	Trunk/Roots: General Structure/Health/ Condition	Removal (R) Requested by Applicant? (Yes or No) <i>*Photos required*</i>	Pruning by City Forestry requested (Yes or No). <i>Note: Any Pruning must follow ANSI A300 Standards.</i>	What are the impacts of proposed building? i.e., construction, staging, underground vaults, concrete pumps, scaffolding, new underground utilities, etc.	What are the earth retention impacts to the street trees?
					<input type="checkbox"/> Yes <input type="checkbox"/> No	<input type="checkbox"/> Yes <input type="checkbox"/> No		
					<input type="checkbox"/> Yes <input type="checkbox"/> No	<input type="checkbox"/> Yes <input type="checkbox"/> No		
					<input type="checkbox"/> Yes <input type="checkbox"/> No	<input type="checkbox"/> Yes <input type="checkbox"/> No		
					<input type="checkbox"/> Yes <input type="checkbox"/> No	<input type="checkbox"/> Yes <input type="checkbox"/> No		
					<input type="checkbox"/> Yes <input type="checkbox"/> No	<input type="checkbox"/> Yes <input type="checkbox"/> No		
					<input type="checkbox"/> Yes <input type="checkbox"/> No	<input type="checkbox"/> Yes <input type="checkbox"/> No		
					<input type="checkbox"/> Yes <input type="checkbox"/> No	<input type="checkbox"/> Yes <input type="checkbox"/> No		
					<input type="checkbox"/> Yes <input type="checkbox"/> No	<input type="checkbox"/> Yes <input type="checkbox"/> No		
					<input type="checkbox"/> Yes <input type="checkbox"/> No	<input type="checkbox"/> Yes <input type="checkbox"/> No		
					<input type="checkbox"/> Yes <input type="checkbox"/> No	<input type="checkbox"/> Yes <input type="checkbox"/> No		

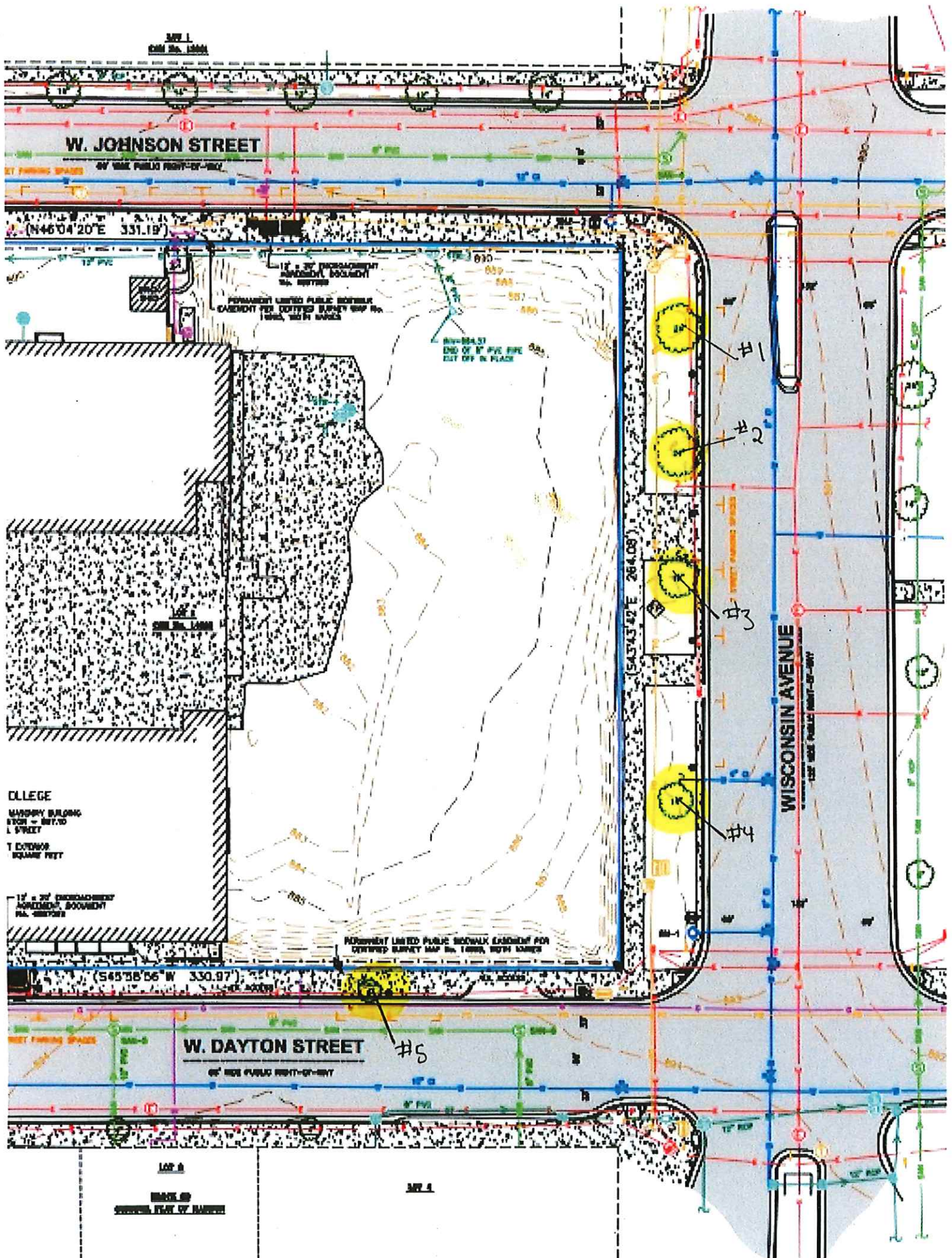

MAP 1
CEN. No. 1000

W. JOHNSON STREET

40' SIDE PUBLIC RIGHT-OF-WAY

(N46°04'20"E 331.19')

12" x 20" ENCASEMENT
AGREEMENT, DOCUMENT
No. 10000

PERMANENT LIMITED PUBLIC RIGHT-OF-WAY
ENCASEMENT FOR LIMITED SURVEY MAP No. 1000, WITH NOTES

END OF 12" P.V.C. PIPE
SET OFF IN PLACE

#1

#2

#3

#4

WISCONSIN AVENUE

120' SIDE PUBLIC RIGHT-OF-WAY

PERMANENT LIMITED PUBLIC RIGHT-OF-WAY
ENCASEMENT FOR LIMITED SURVEY MAP No. 1000, WITH NOTES

(S45°38'56"W 330.97')

W. DAYTON STREET

40' SIDE PUBLIC RIGHT-OF-WAY

#5

LOT A

SCALE OF
SURVEY PLAN OF MAP

MAP 1